



US00D781920S

(12) **United States Design Patent**
Hsu

(10) **Patent No.:** **US D781,920 S**
(45) **Date of Patent:** **** Mar. 21, 2017**

(54) **ENGINE**

(71) Applicant: **Kevin Hsu, Puzi (TW)**

(72) Inventor: **Kevin Hsu, Puzi (TW)**

(73) Assignees: **Zhejiang Yongkang Top IMP,**
Yongkang, Zhejiang (CN); EXP CO.,
Ltd., Yongkang, Zhejiang (CN)

(**) Term: **15 Years**

(21) Appl. No.: **29/560,109**

(22) Filed: **Apr. 4, 2016**

(51) **LOC (10) Cl.** **15-01**

(52) **U.S. Cl.**

USPC **D15/3**

(58) **Field of Classification Search**

USPC D15/1-5, 11, 12, 17, 14, 149;
D32/15-19, 21, 25; D23/213, 383
CPC F01P 5/02; F01P 1/02; F01P 1/06; F01P
2001/023; F02B 75/007; F02B 63/02;
F02B 75/02; F02B 2075/022; F02B
75/16; F02B 2075/025; F02B 75/18;
F02B 2075/027; F02B 61/02; F02B
61/06; B62M 9/10; B62K 2202/00

See application file for complete search history.

(56) **References Cited**

U.S. PATENT DOCUMENTS

4,671,782 A * 6/1987 Ochiai B62M 7/06
474/93
D294,264 S * 2/1988 Davidson D15/3

5,263,463 A * 11/1993 Perry F02B 33/38
123/559.1
2007/0017466 A1 * 1/2007 Leppanen F02N 15/022
123/179.25
2012/0000720 A1 * 1/2012 Honda B62K 11/10
180/65.1
2013/0228389 A1 * 9/2013 Nakashima B62K 11/10
180/220
2014/0345551 A1 * 11/2014 Miyoshi F01M 11/02
123/90.31
2016/0090907 A1 * 3/2016 Sotani F01M 13/04
123/195 C

* cited by examiner

Primary Examiner — T. Chase Nelson
Assistant Examiner — Ania Aman

(57) **CLAIM**

The ornamental design for an engine, as shown and described.

DESCRIPTION

FIG. 1 is a perspective view of the engine showing my new design;
FIG. 2 is a front elevation view thereof;
FIG. 3 is a rear elevation view thereof;
FIG. 4 is a left side elevation view thereof;
FIG. 5 is a right side elevation view thereof;
FIG. 6 is a top plan view thereof; and,
FIG. 7 is a bottom plan view thereof.

1 Claim, 7 Drawing Sheets

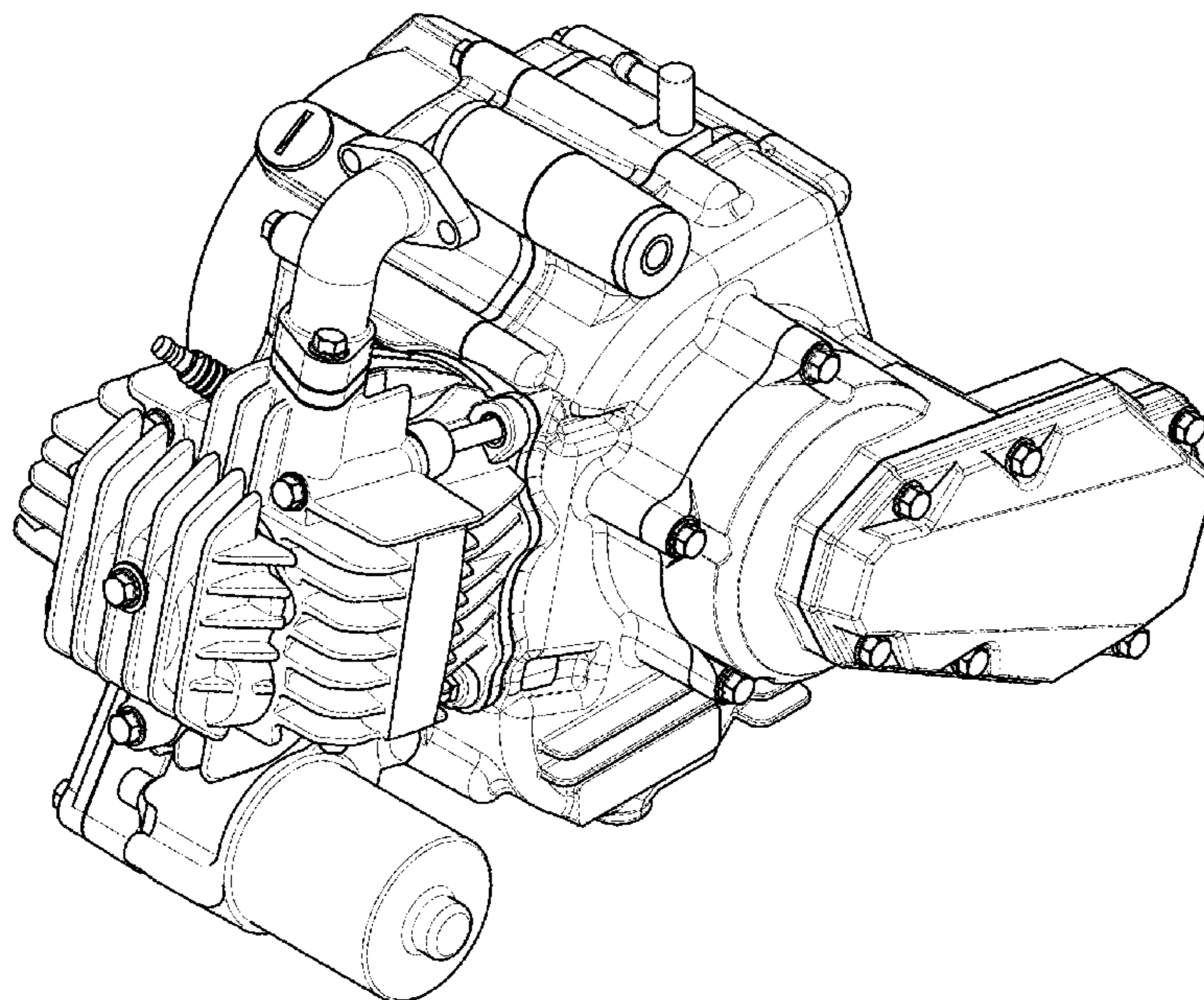

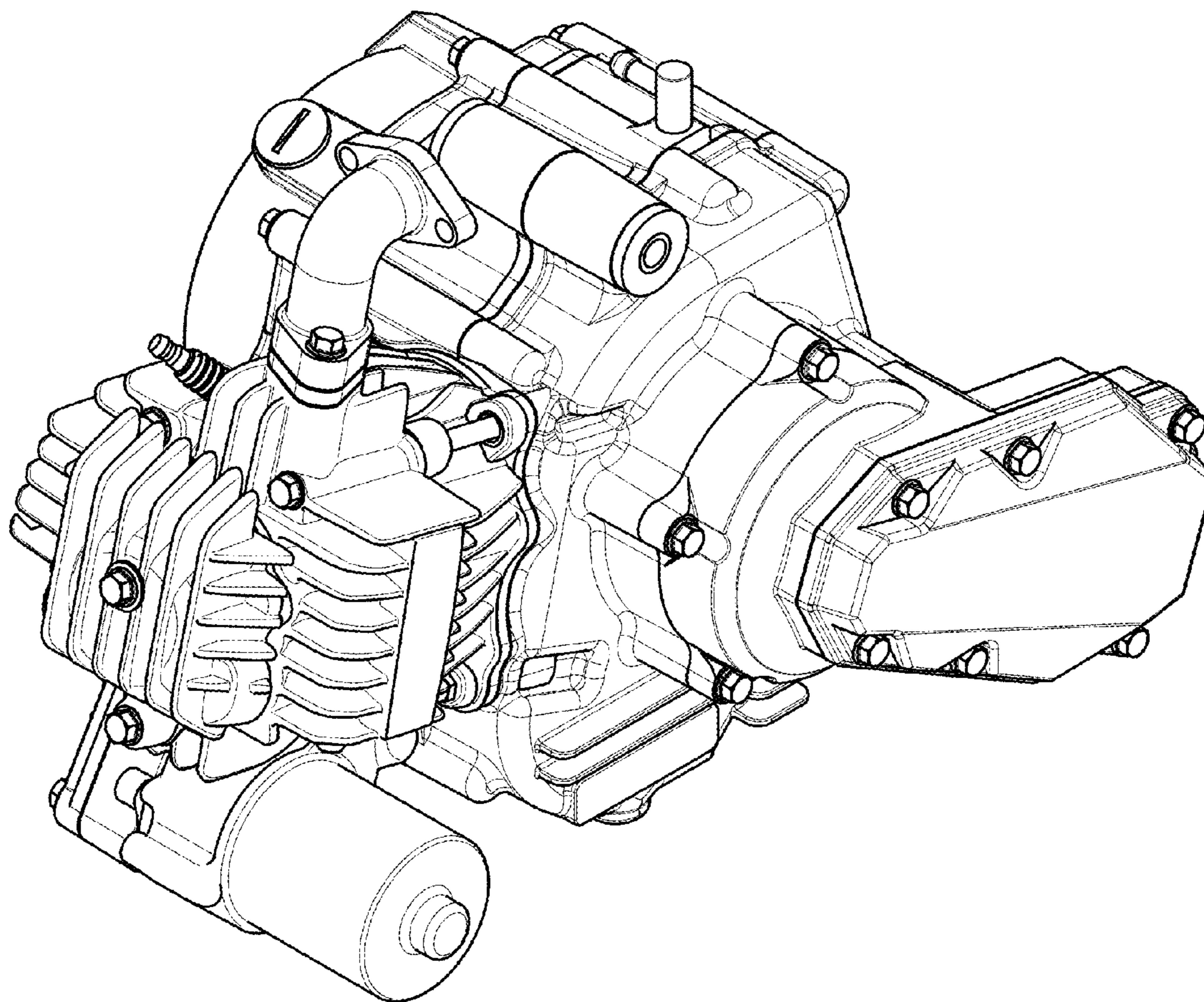

F I G . 1

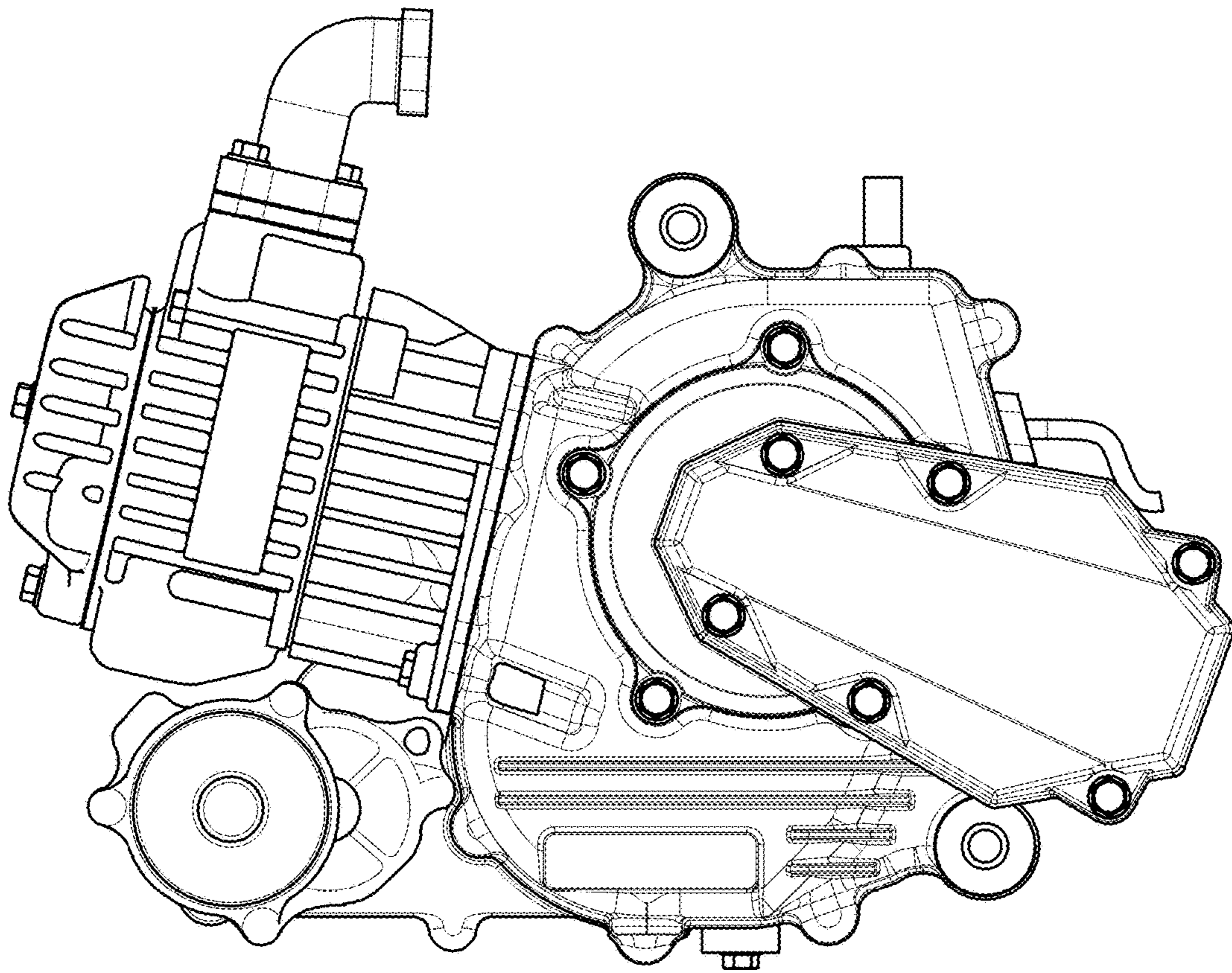
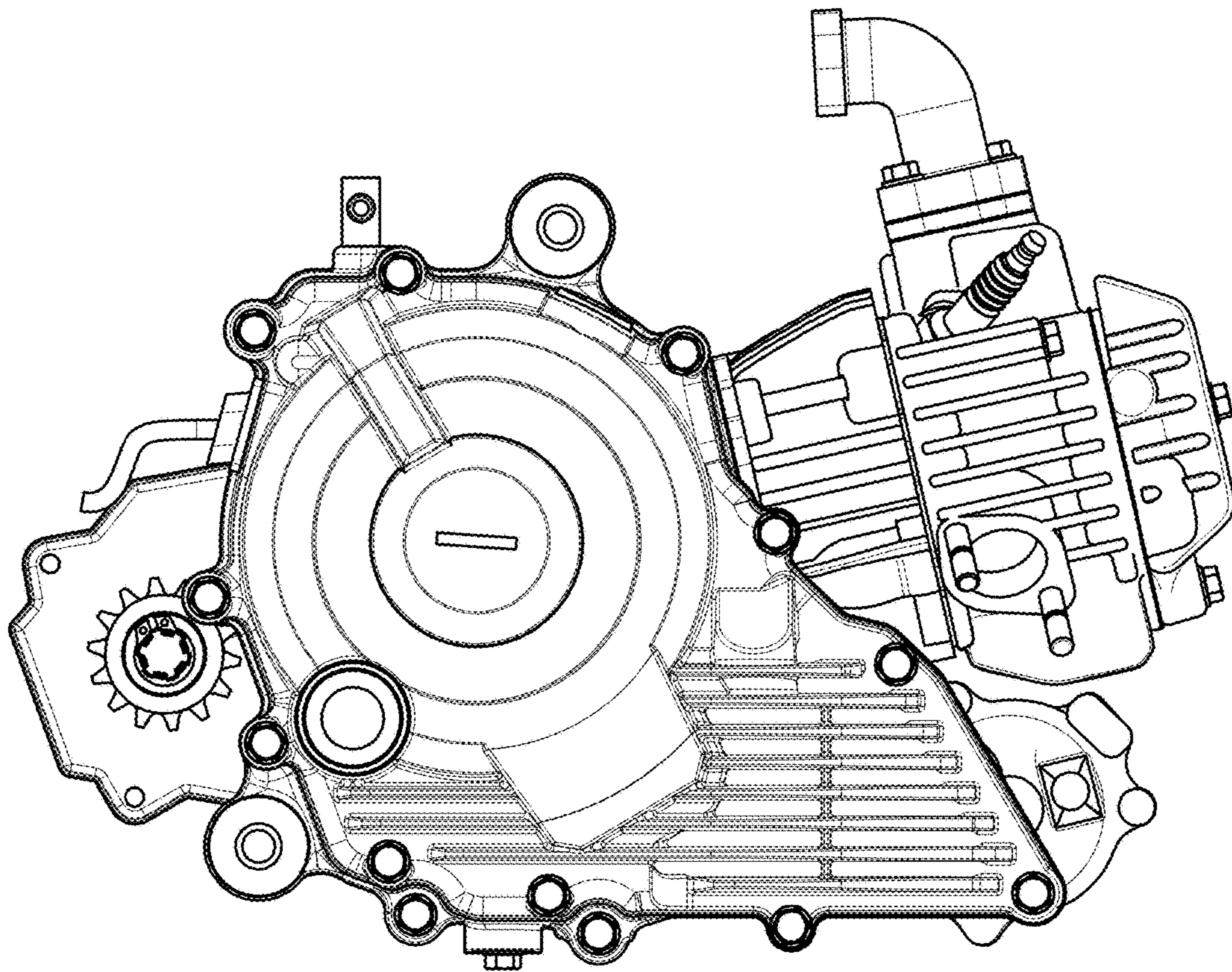
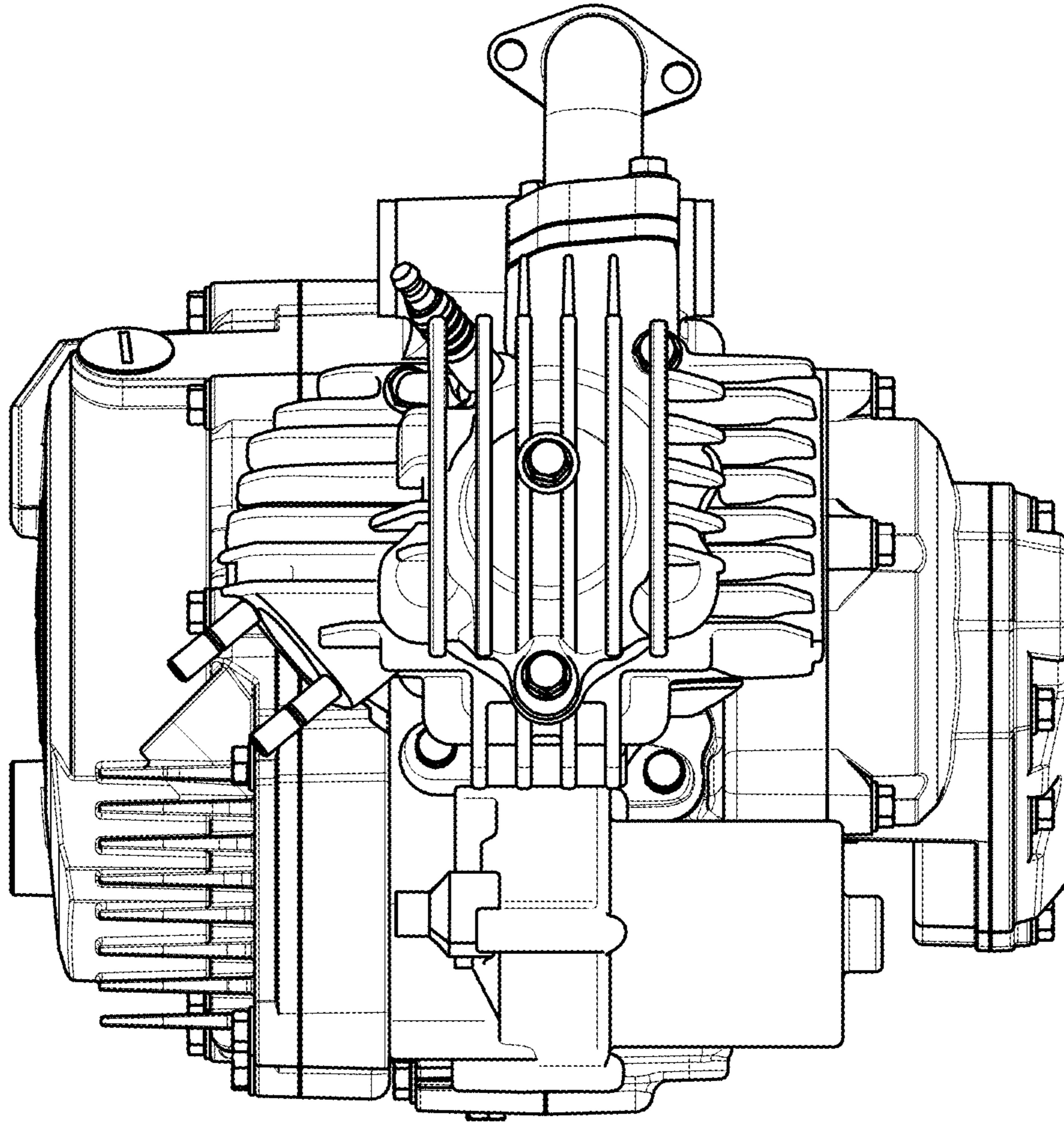

FIG. 2



F I G . 3



F I G . 4

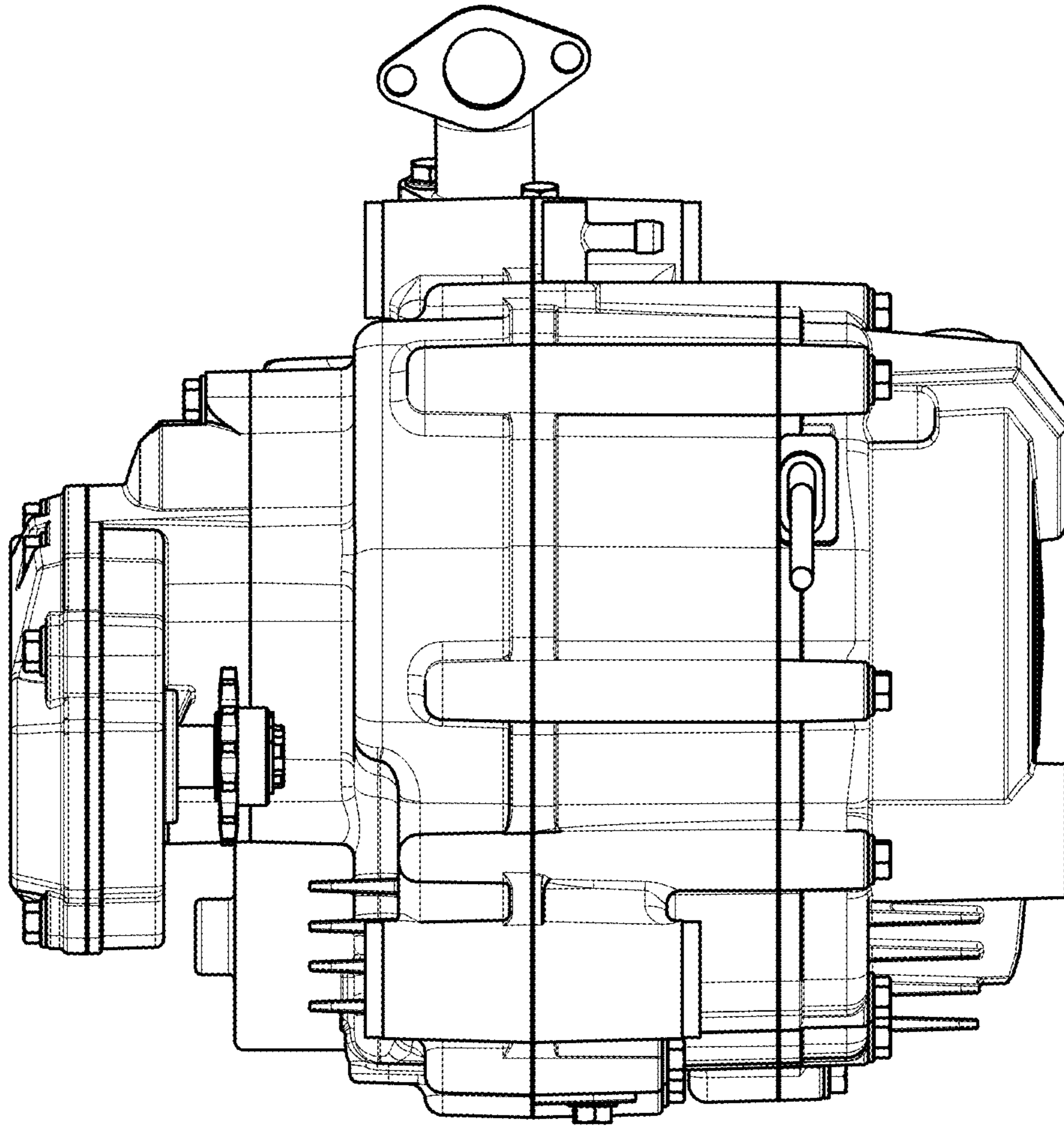

F I G . 5

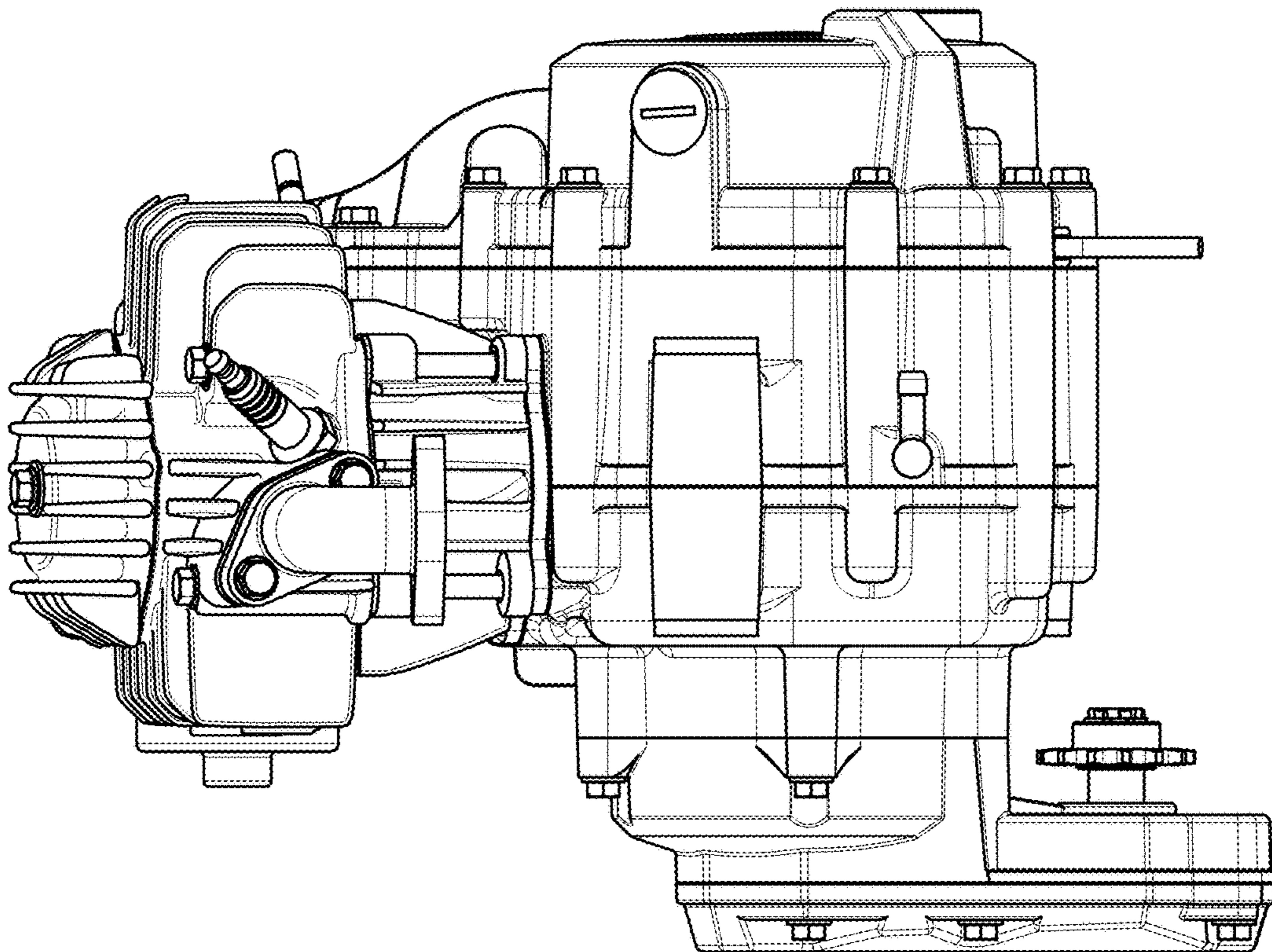

FIG. 6

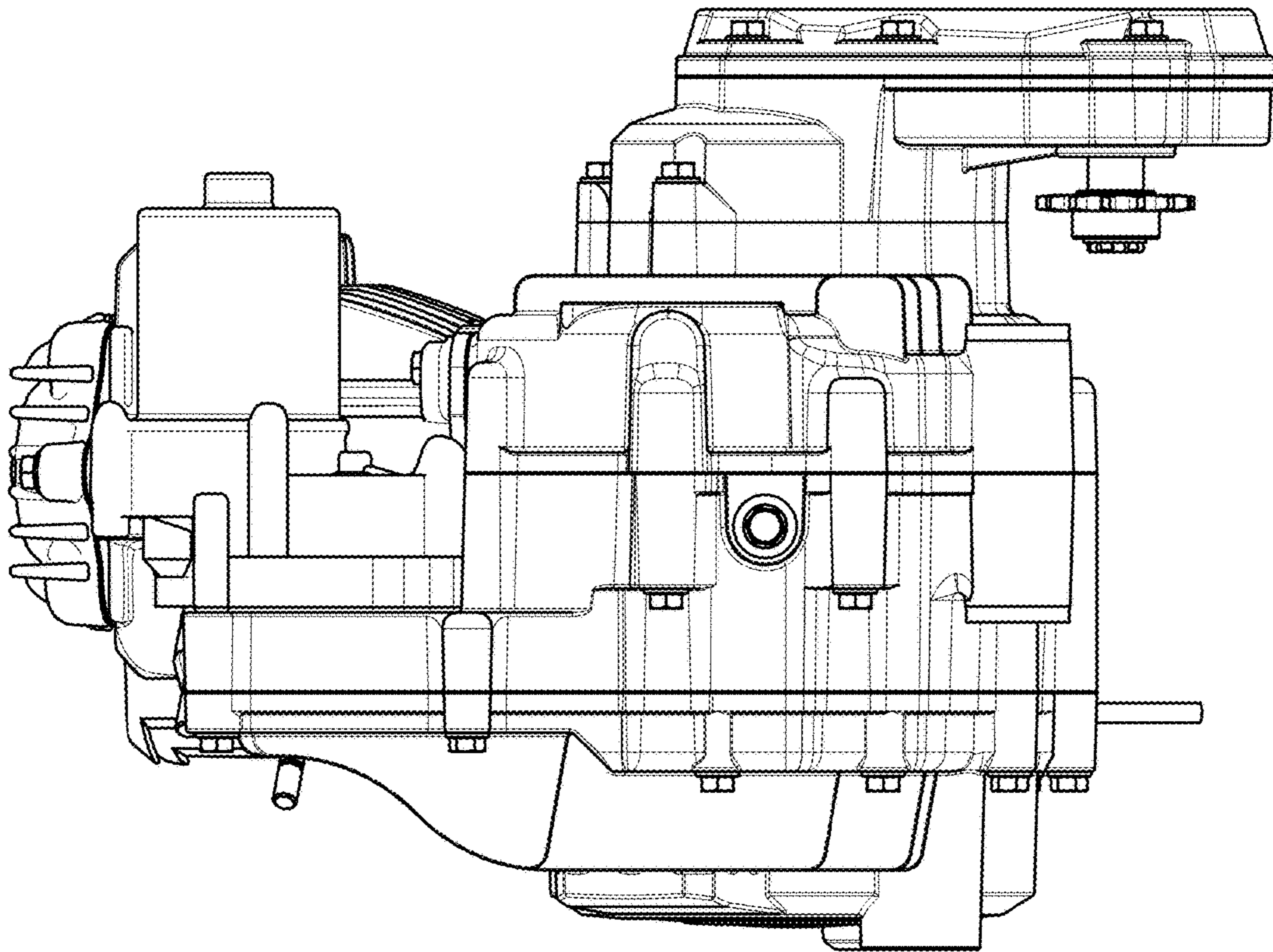

FIG. 7