



US00D781622S

(12) **United States Design Patent** (10) **Patent No.:** **US D781,622 S**
Horsky et al. (45) **Date of Patent:** **** Mar. 21, 2017**

(54) **DISPLAY UNIT**

(71) Applicant: **Cadbury UK Limited**, Birmingham (GB)
 (72) Inventors: **Gil Horsky**, Glattpark (CH); **Alan Flude**, Glattpark (CH); **Filipa Guerra**, Glattpark (CH); **Julian Sellers**, Birmingham (GB); **Amy Wetton**, Birmingham (GB); **Robert Monaghan**, London (GB); **Gert DeSmedt**, Berkshire (GB); **David Ames**, Berkshire (GB)

(73) Assignee: **CADBURY UK LIMITED**, Birmingham, West Midlands (GB)

(**) Term: **14 Years**

(21) Appl. No.: **29/517,410**

(22) Filed: **Feb. 12, 2015**

(30) **Foreign Application Priority Data**

Aug. 14, 2014 (EM) 002520080-0001
 Aug. 14, 2014 (EM) 002520080-0002
 Aug. 14, 2014 (EM) 002520080-0003

(51) **LOC (10) Cl.** **06-06**

(52) **U.S. Cl.**
USPC **D6/675.4**

(58) **Field of Classification Search**
 USPC D6/672, 675, 675.1, 678, 678.1, 678.2
 CPC A47B 63/00; A47B 63/02; A47B 65/00;
 A47B 43/00; A47B 49/00

See application file for complete search history.

(56) **References Cited**

U.S. PATENT DOCUMENTS

1,937,935	A *	12/1933	Zimmerman	A47B 57/16
					108/110
D247,696	S *	4/1978	Eisen	D6/662.1
5,855,175	A *	1/1999	Forbes	A47B 47/042
					100/42
D450,488	S *	11/2001	Stone	D6/675.1
D541,557	S *	5/2007	Weatherly	D6/675.3
D586,153	S *	2/2009	Maly	D6/683.1
D658,405	S *	5/2012	O'Brien	D6/675.1
D691,838	S *	10/2013	Hinkle	D6/675.1
D722,459	S *	2/2015	Schluetter	D6/675.3
D734,068	S *	7/2015	Dworman	D6/662.1
D744,773	S *	12/2015	Yoon	D6/678

* cited by examiner

Primary Examiner — Kelley Donnelly

(74) *Attorney, Agent, or Firm* — Cantor Colburn LLP

(57) **CLAIM**

The ornamental design for a display unit, as shown and described.

DESCRIPTION

FIG. 1 is a perspective view of a display unit showing our new design;

FIG. 2 is a front view thereof;

FIG. 3 is a rear view thereof;

FIG. 4 is a side view thereof;

FIG. 5 is another side view thereof;

FIG. 6 is a top view thereof; and,

FIG. 7 is a bottom view thereof.

1 Claim, 7 Drawing Sheets

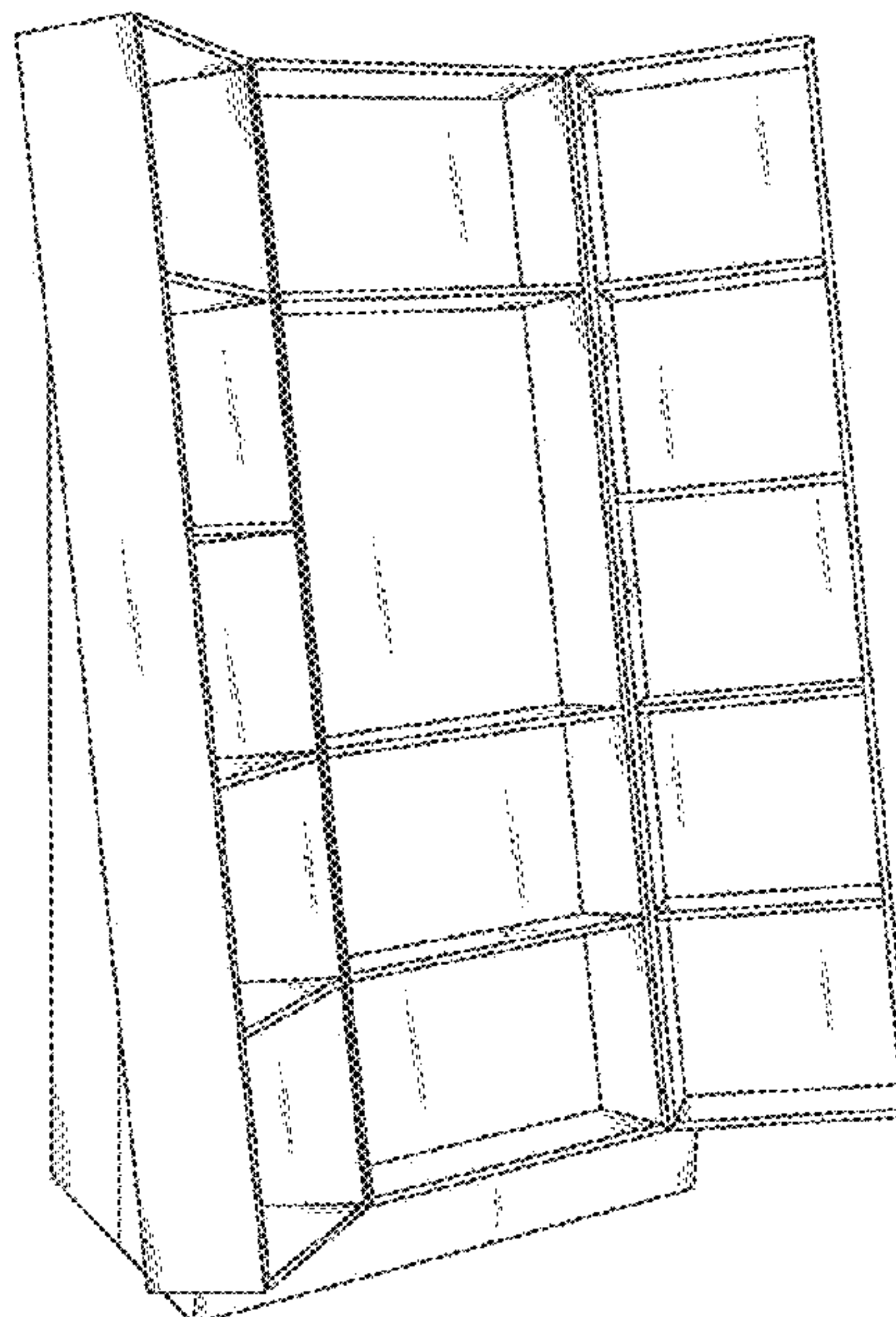

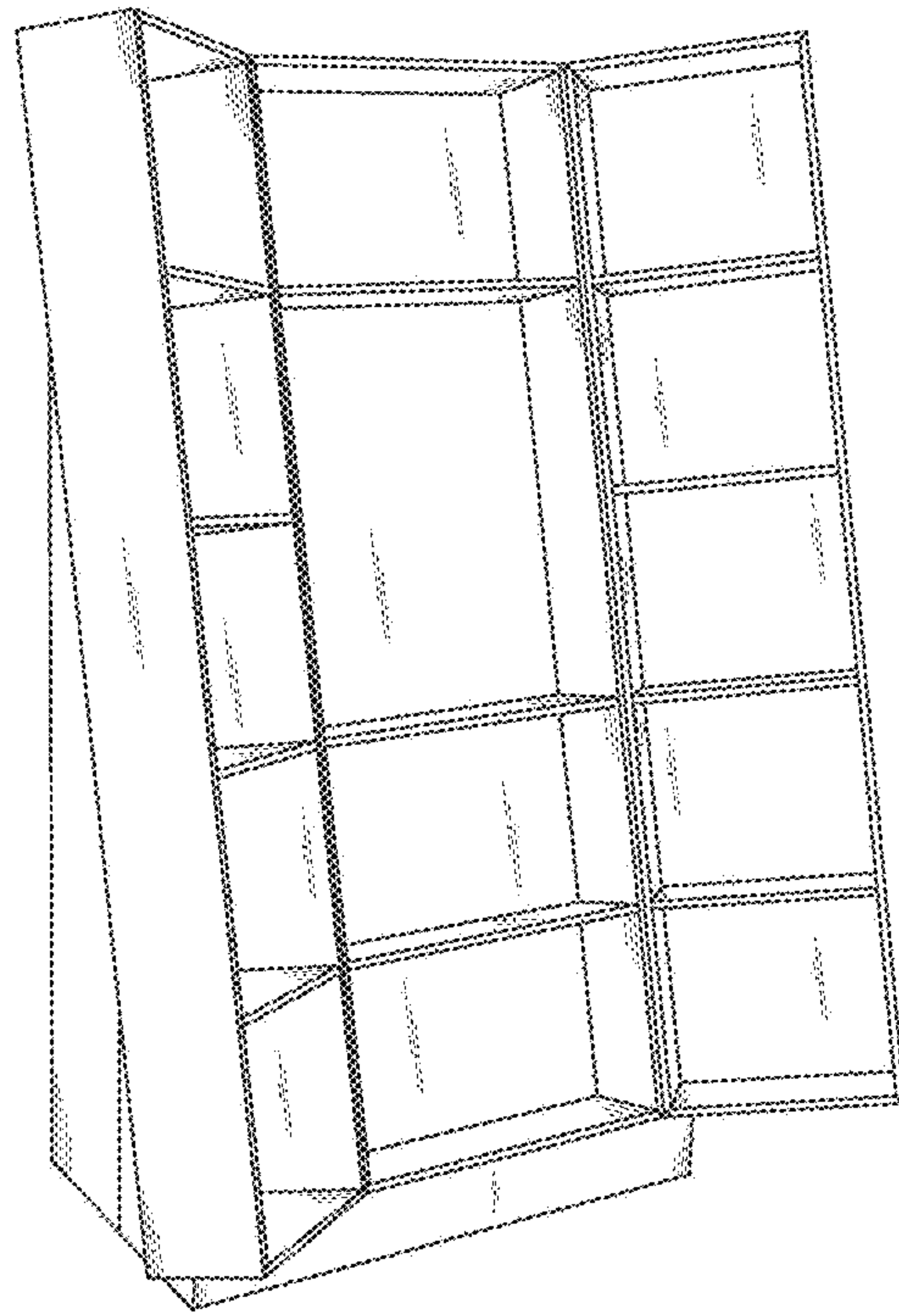

Figure 1

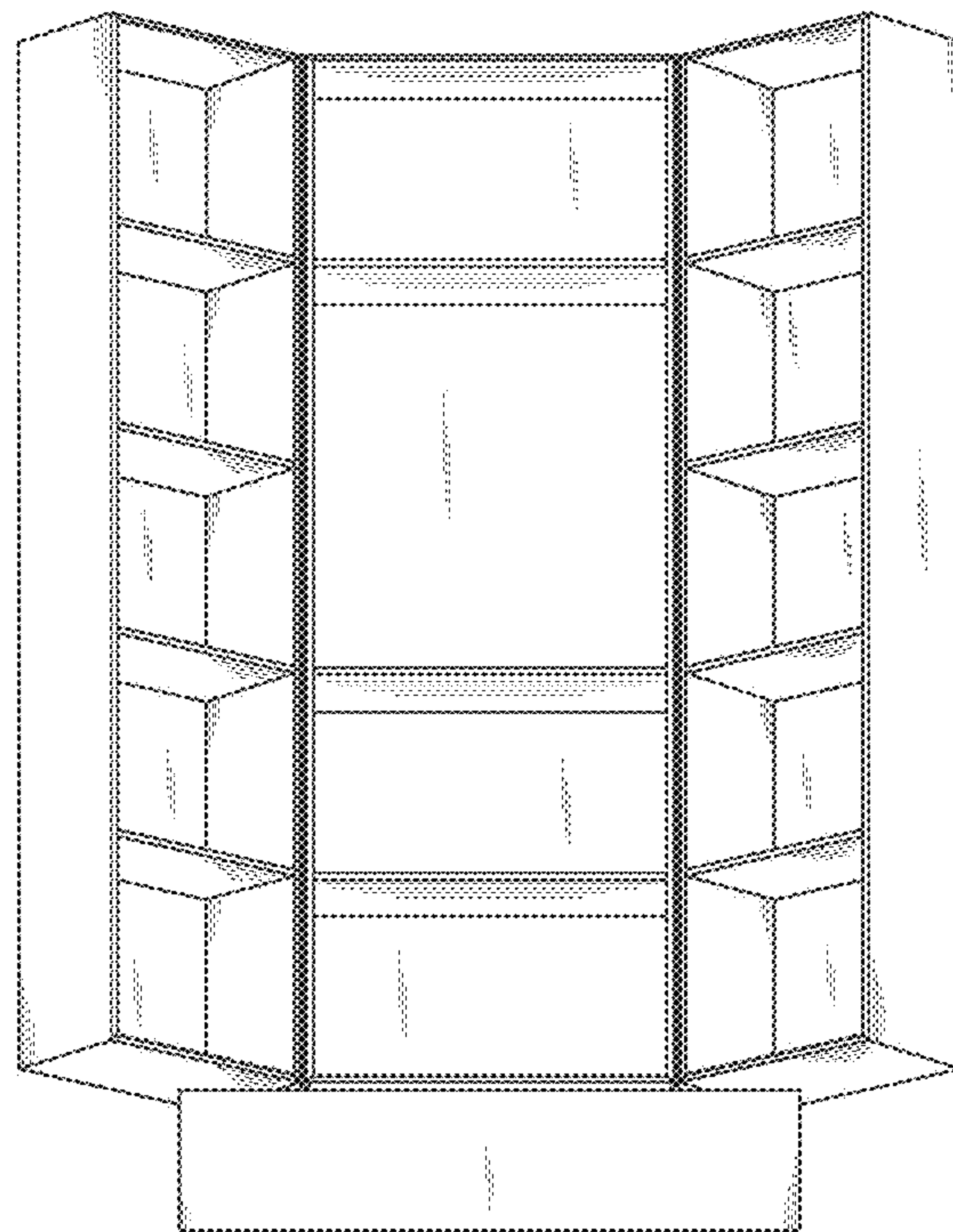

Figure 2

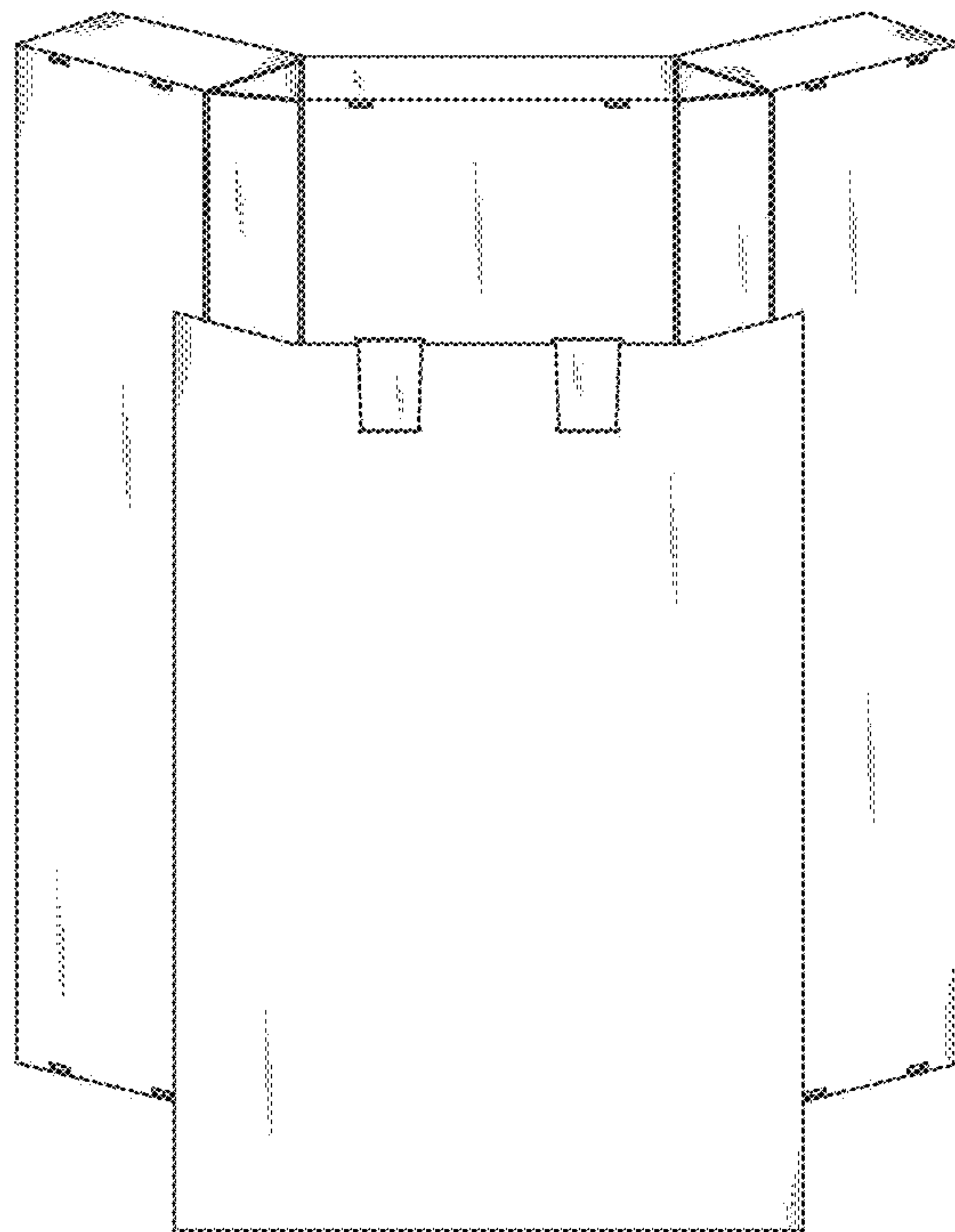

Figure 3

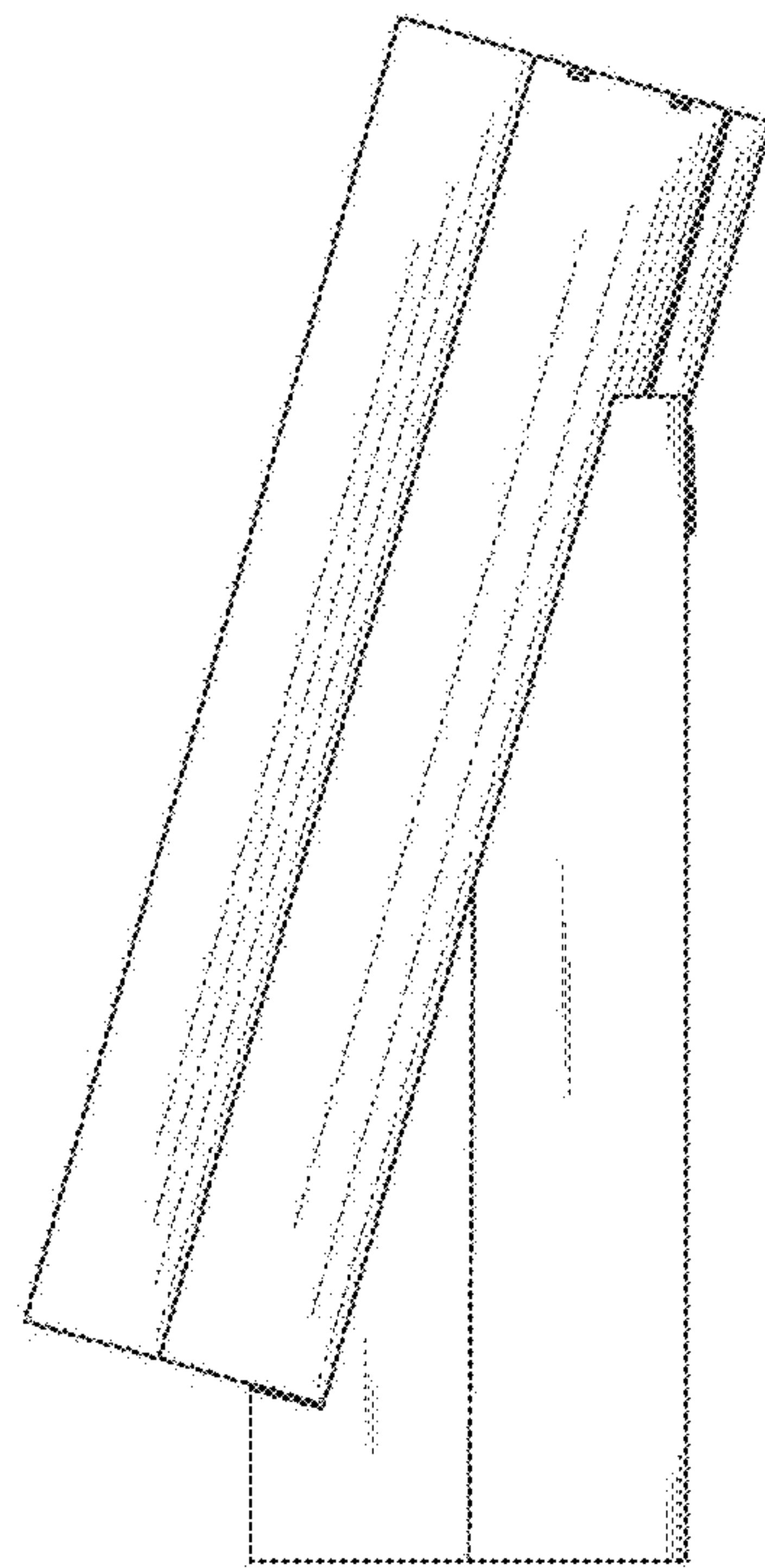

Figure 4

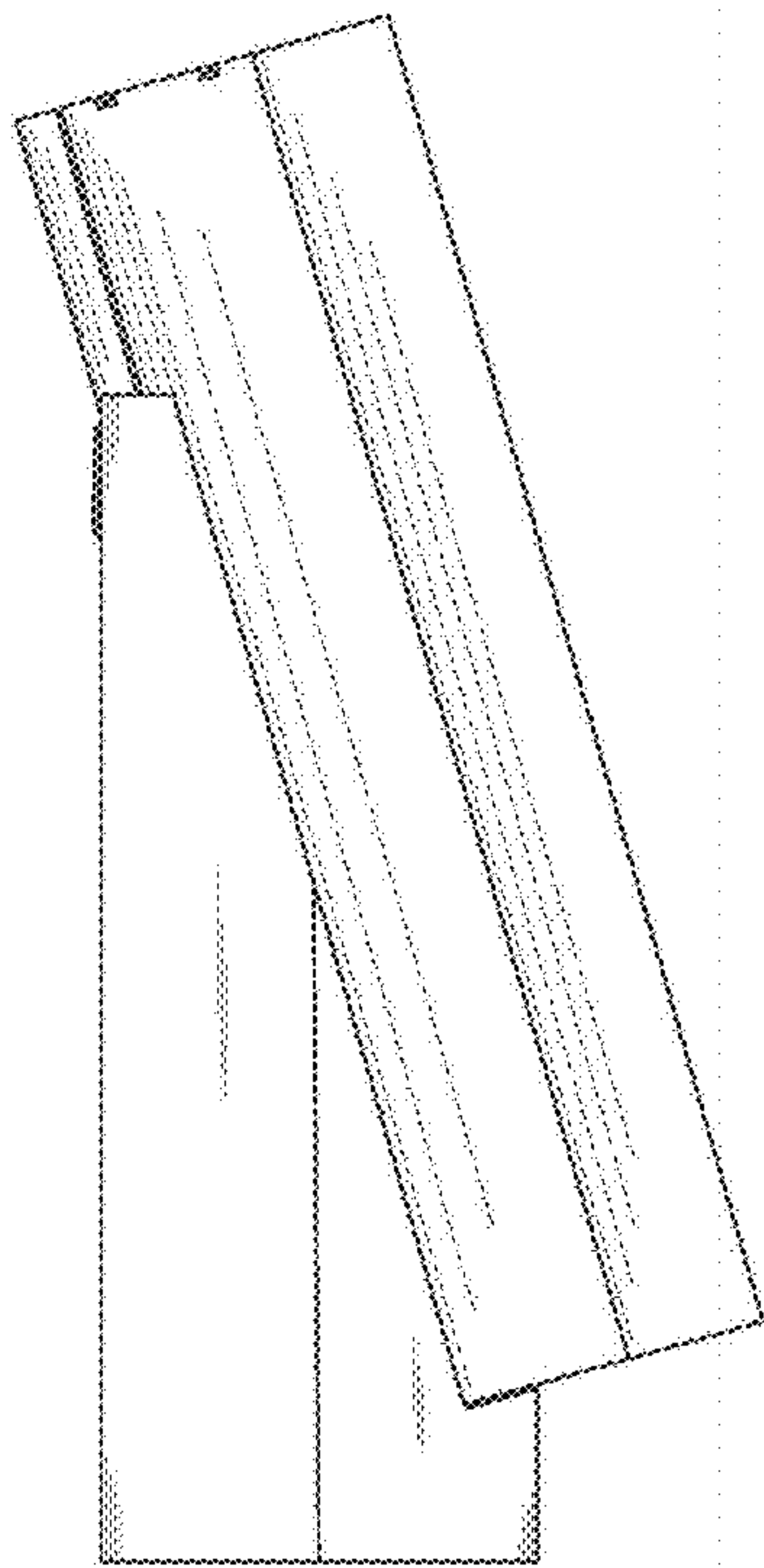

Figure 5

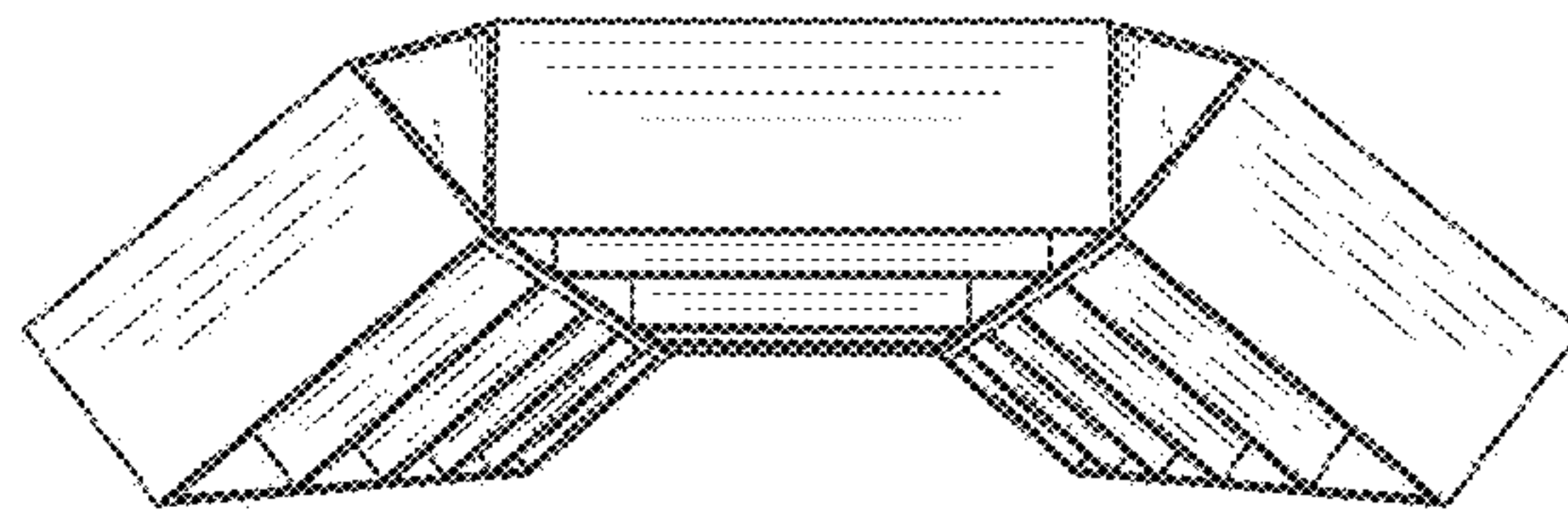

Figure 6

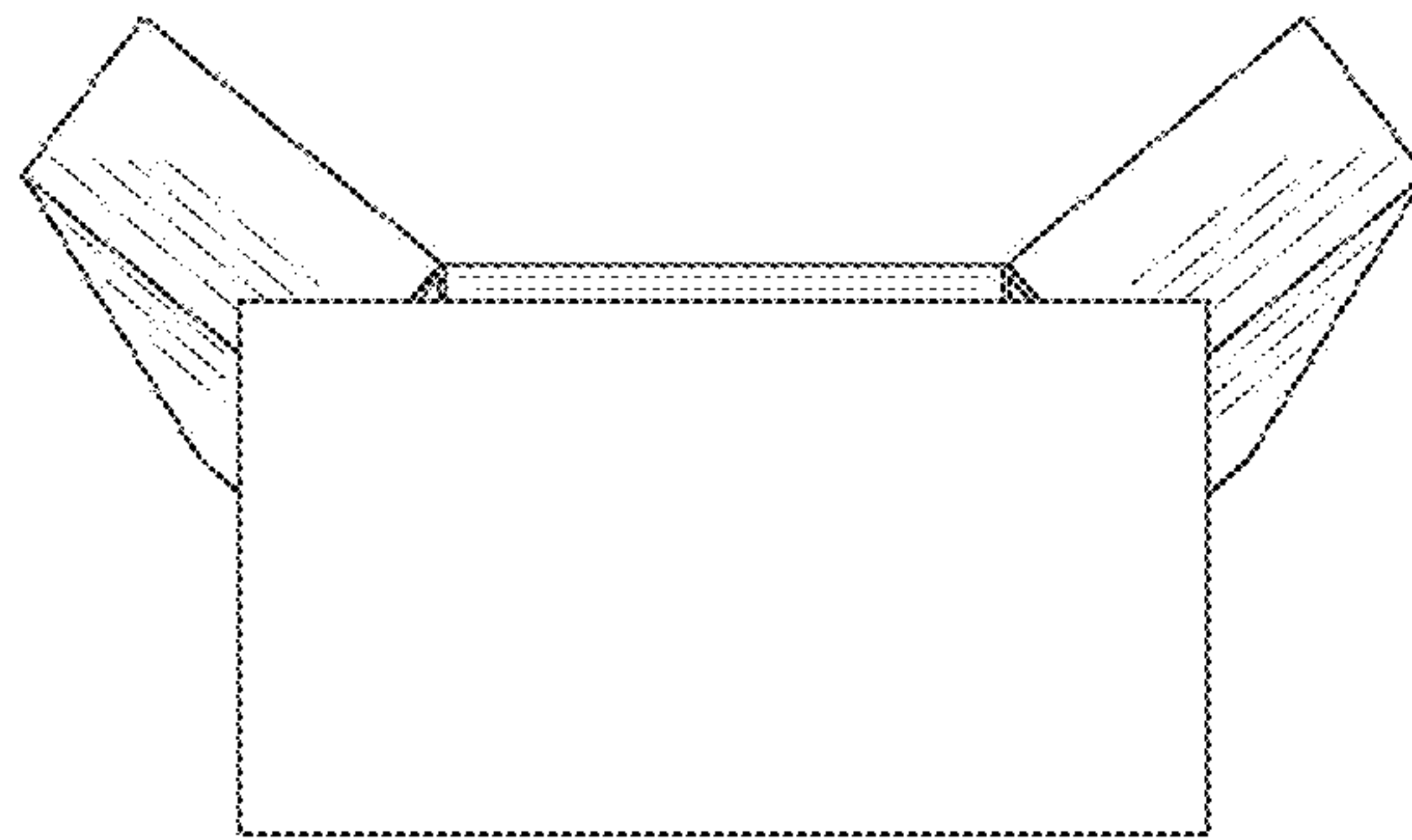

Figure 7