



US00D781081S

(12) **United States Design Patent**  
**Domenech Grau**

(10) **Patent No.:** **US D781,081 S**

(45) **Date of Patent:** **\*\* Mar. 14, 2017**

(54) **SELF-SERVICE STATION WITH BOWLS SUPPORT**

D704,943 S *	5/2014	Saba	.....	D6/349
D712,181 S *	9/2014	Martell	.....	D6/675.1
D764,843 S *	8/2016	Peden	.....	D6/675.3
D768,418 S *	10/2016	Sock	.....	D6/690
2008/0237319 A1 *	10/2008	Hensey	.....	A47B 3/00 229/103

(71) Applicant: **Miguel Pujadas, S.A.**, Santa Coloma de Farners, Girona (ES)

(72) Inventor: **Daniel Domenech Grau**, Girona (ES)

\* cited by examiner

(73) Assignee: **MIGUEL PUJADAS, S.A.**, Santa Cooma de Famers (Girona) (ES)

*Primary Examiner* — Kelley Donnelly

(74) *Attorney, Agent, or Firm* — Robert J. Hess; Hess Patent Law Firm

(\*\*) Term: **15 Years**

(21) Appl. No.: **29/505,770**

(22) Filed: **Feb. 1, 2016**

(51) **LOC (10) Cl.** ..... **06-06**

(52) **U.S. Cl.**  
USPC ..... **D6/675.3**

(58) **Field of Classification Search**  
USPC ..... D6/672, 673, 675, 675.1, 675.3;  
D7/601-602  
CPC ... A47F 2003/066; A47F 5/0018; A47F 5/106  
See application file for complete search history.

(57) **CLAIM**

I claim an ornamental design for a self-service station with bowls support, as shown and described.

**DESCRIPTION**

FIG. 1 is an isometric view of a self-service station with bowls support in accordance with our invention;  
FIG. 2 is a front plan view thereof;  
FIG. 3 is a top plan view thereof;  
FIG. 4 is a rear plan view thereof;  
FIG. 5 is a bottom plan view thereof;  
FIG. 6 is a right side plan view thereof; and,  
FIG. 7 is a left side plan view thereof.

The broken lines showing is included for the purpose of illustrating environment and forms no part of the claimed design.

(56) **References Cited**

**U.S. PATENT DOCUMENTS**

D527,558 S *	9/2006	Ng	.....	D6/678
D697,344 S *	1/2014	Kerian	.....	D6/675.1

**1 Claim, 6 Drawing Sheets**

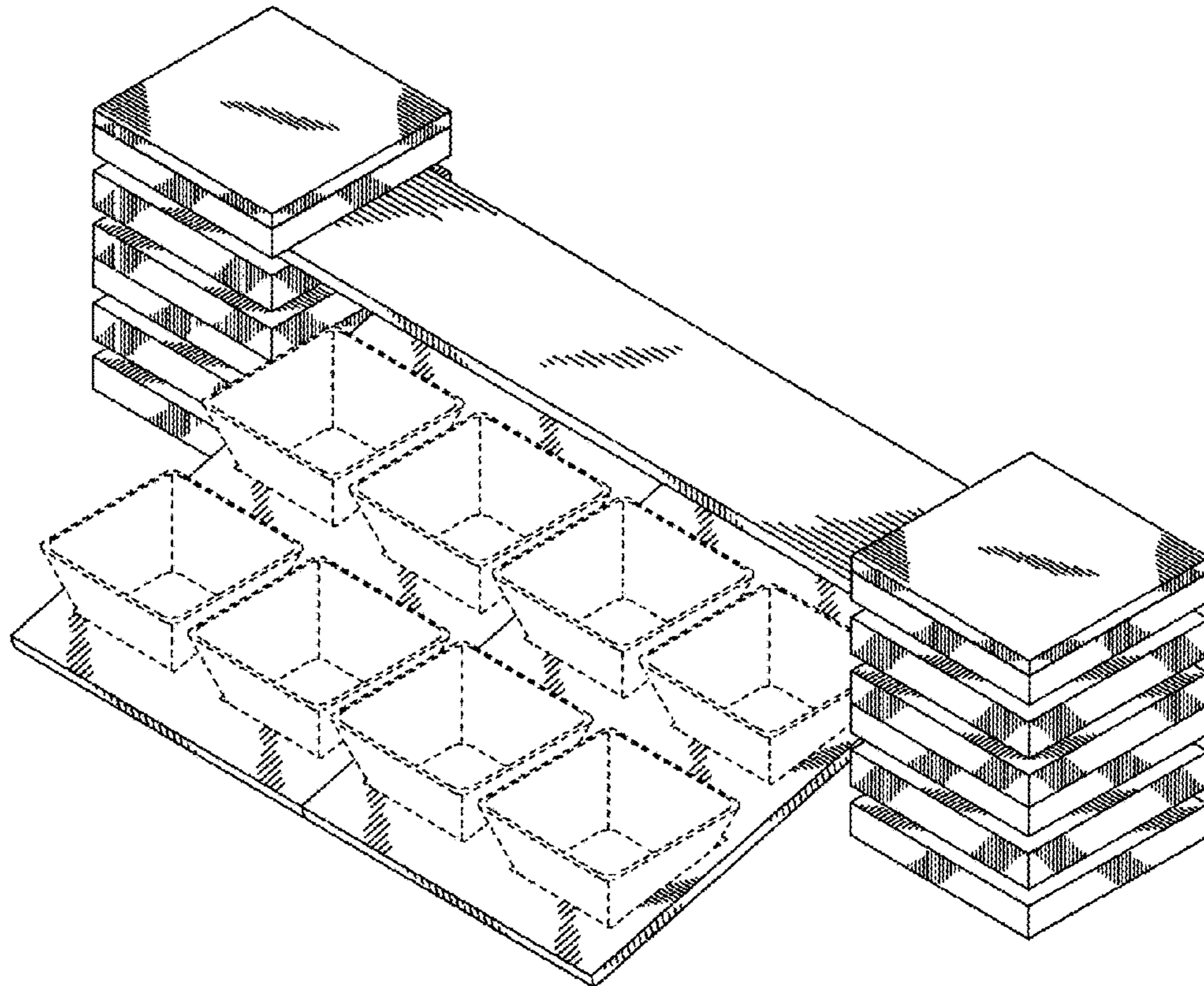

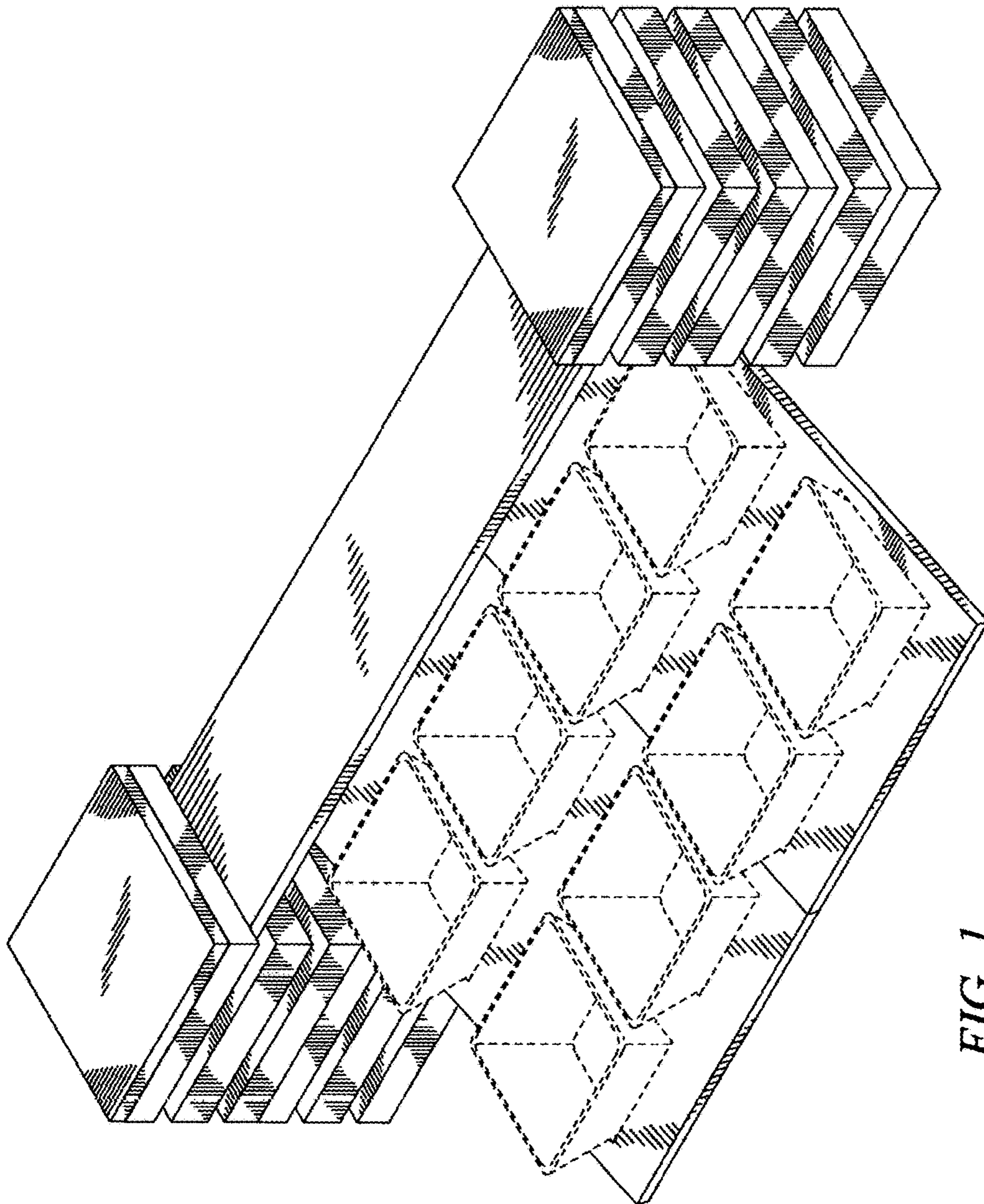

FIG. 1

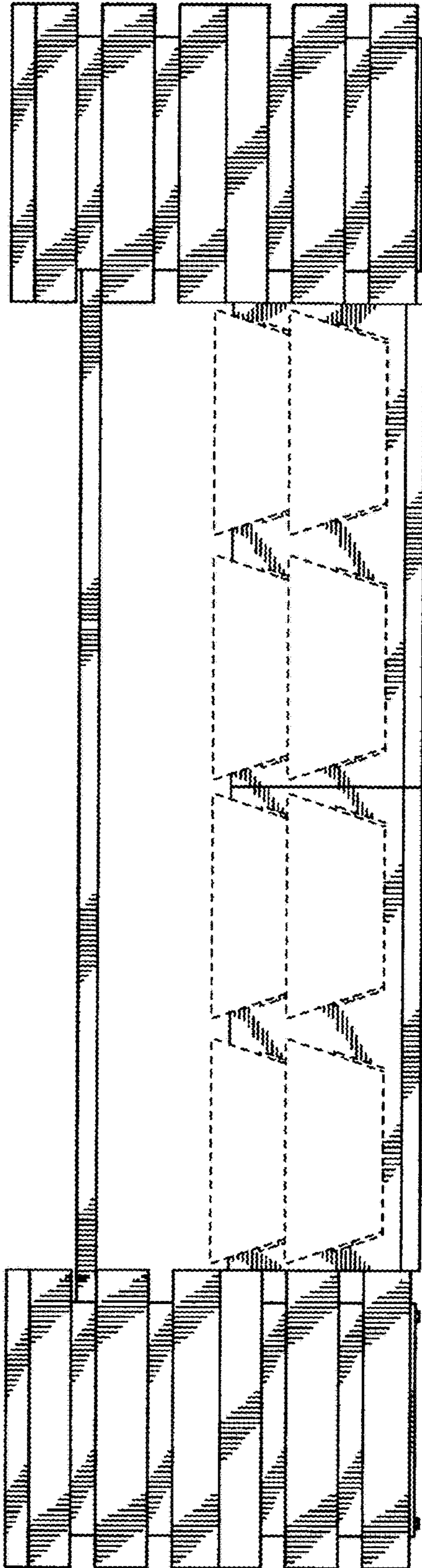

FIG. 2

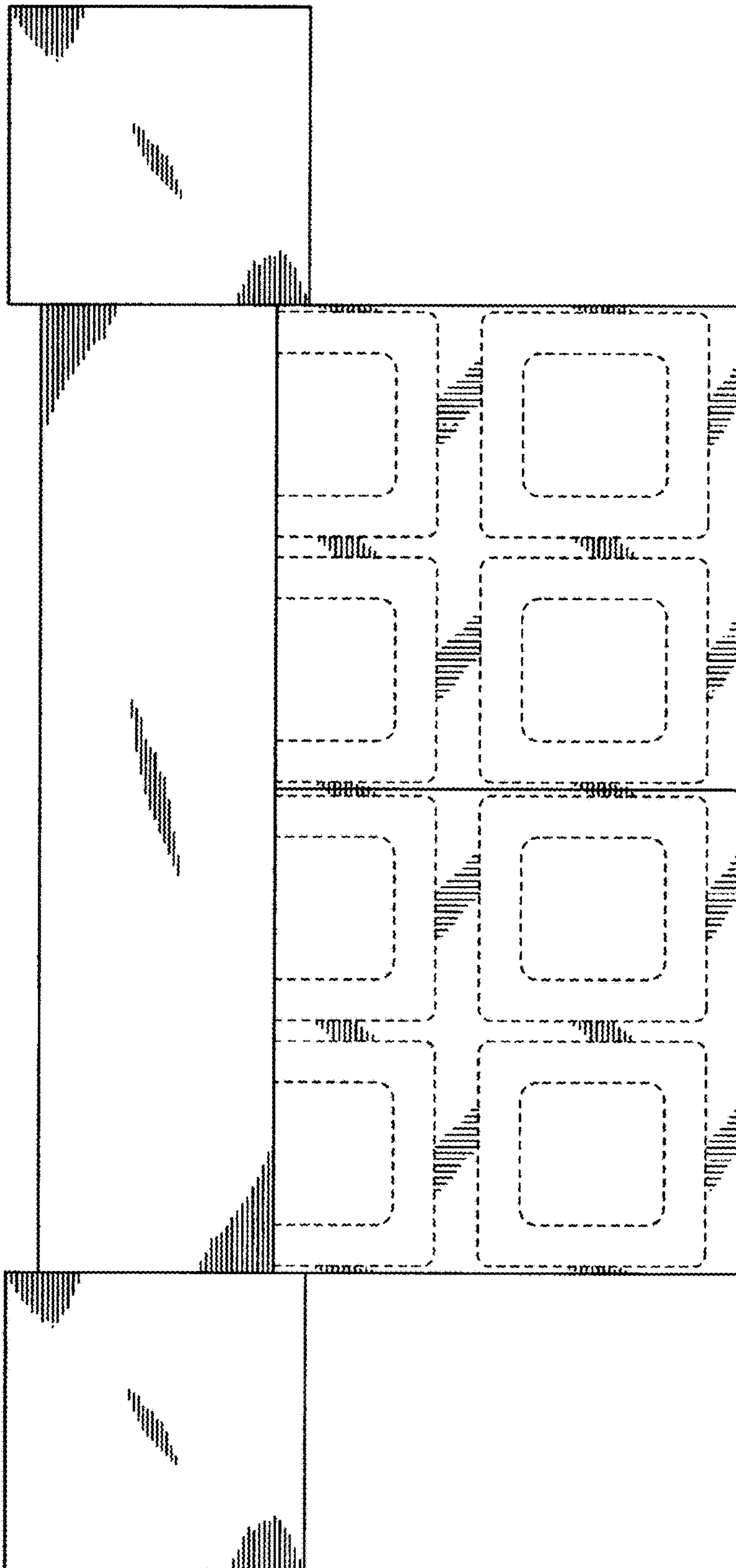

FIG. 3

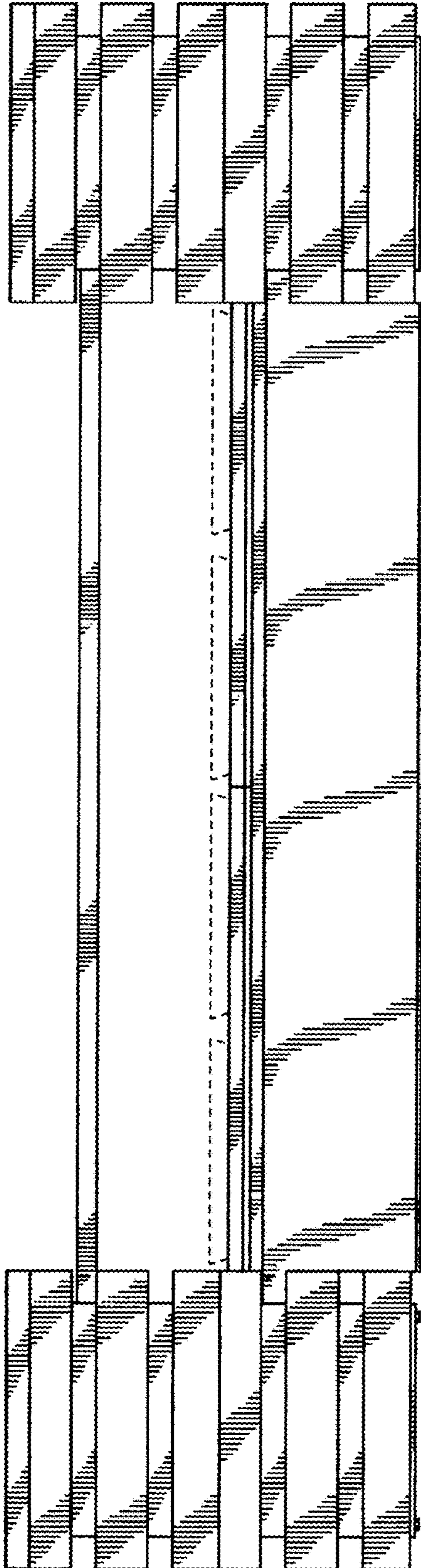

FIG. 4

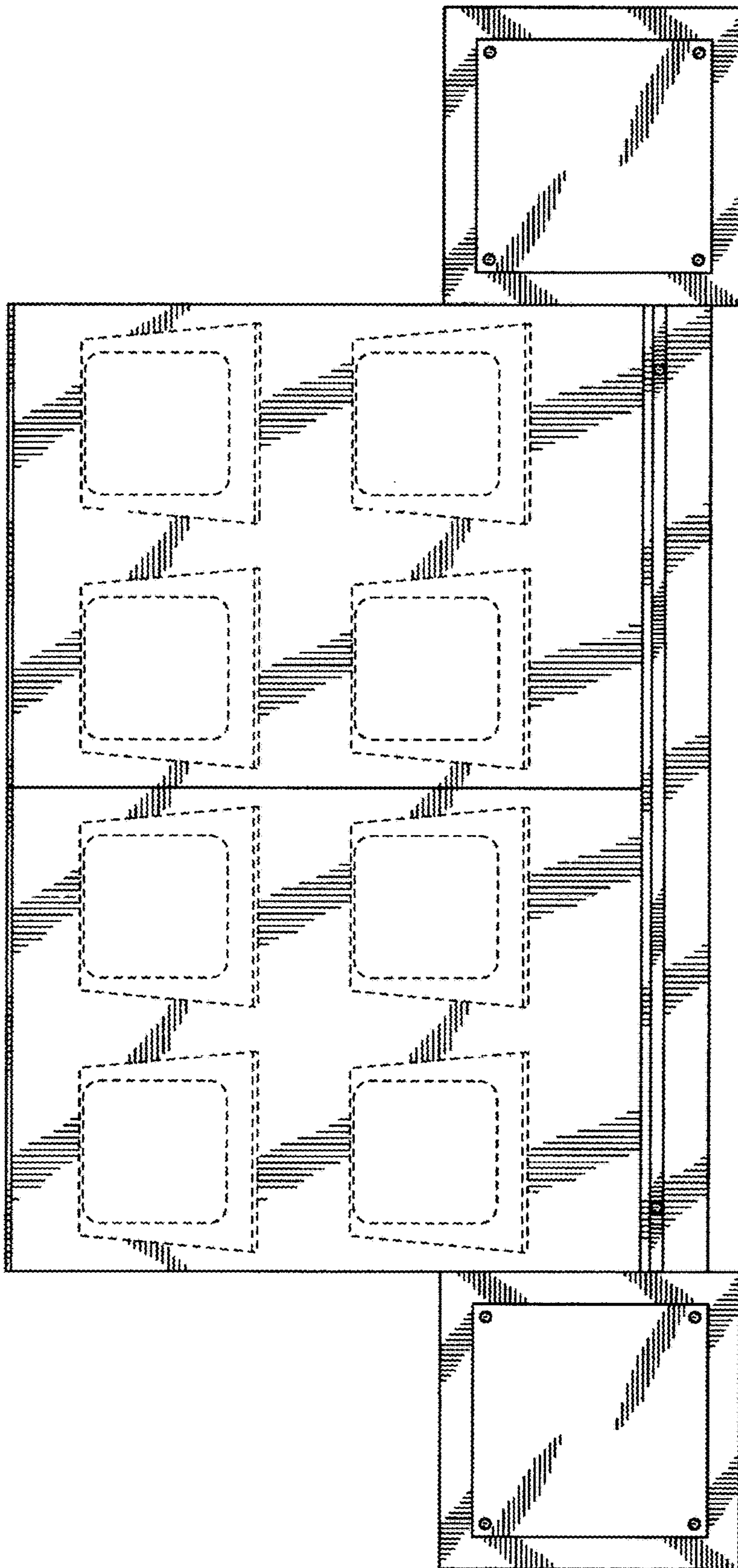

FIG. 5

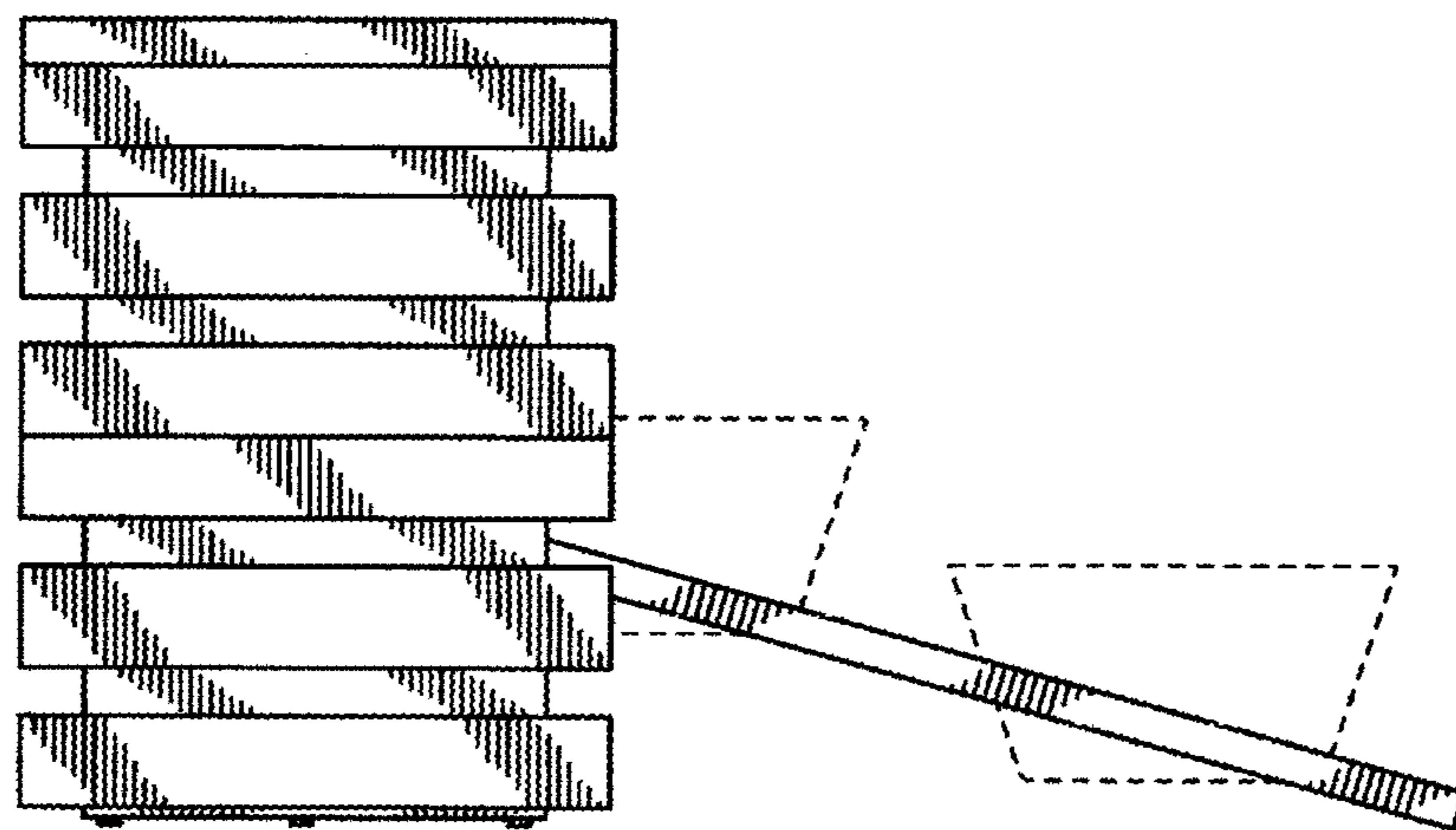

FIG. 6

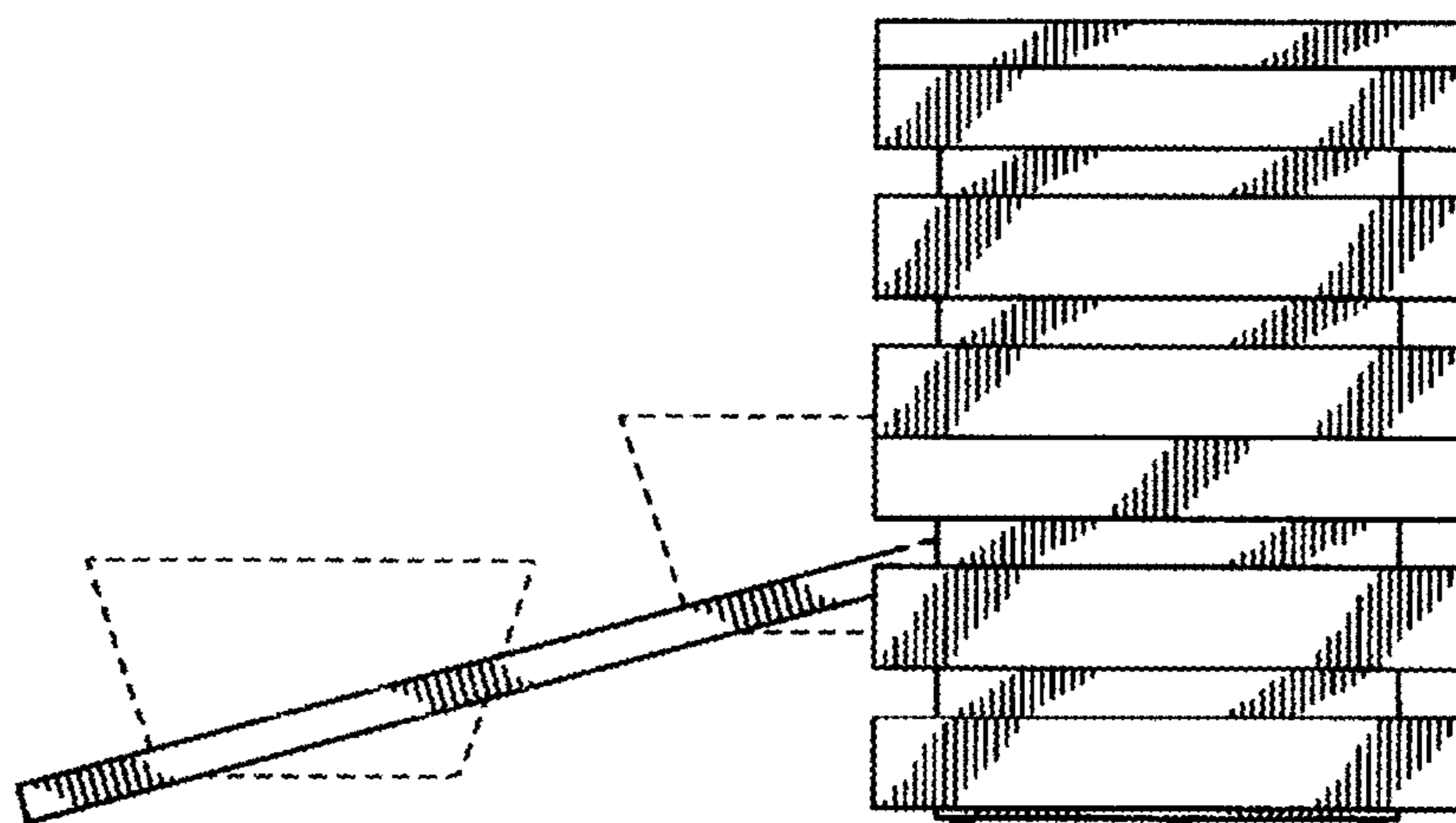

FIG. 7