



US00D780486S

(12) **United States Design Patent**
Arthur et al.

(10) **Patent No.:** **US D780,486 S**
(45) **Date of Patent:** **** Mar. 7, 2017**

(54) **WORKSTATION**

(71) Applicant: **Williams-Sonoma, Inc.**, San Francisco, CA (US)

(72) Inventors: **Emily S. Arthur**, Los Angeles, CA (US); **Jeffrey C. Hannoosh**, Brooklyn, NY (US)

(73) Assignee: **Williams-Sonoma, Inc.**, San Francisco, CA (US)

(**) Term: **15 Years**

(21) Appl. No.: **29/555,209**

(22) Filed: **Feb. 19, 2016**

(51) **LOC (10) Cl.** **06-03**

(52) **U.S. Cl.**
USPC **D6/641; D6/644**

(58) **Field of Classification Search**
USPC D6/641, 644, 648, 648.1, 648.2, 648.4, D6/699

CPC A47B 21/00; A47B 45/00; A47B 17/02; A47B 19/06; A47B 41/02; A47B 2200/0043; A47B 85/02

See application file for complete search history.

(56) **References Cited**

U.S. PATENT DOCUMENTS

2,223,405 A * 12/1940 Cain A47B 19/06 108/3
D192,009 S * 1/1962 Deaton D6/648.4

D208,412 S * 8/1967 Book D18/39
D239,751 S * 5/1976 Fusselman D6/657
D259,686 S * 6/1981 West D6/671.1
D476,503 S * 7/2003 Chesser D6/641
D526,812 S * 8/2006 Chen D6/648.4
D626,759 S * 11/2010 Joh D6/648.1
D627,577 S * 11/2010 Joh D6/648.1
D648,568 S * 11/2011 Cortivo D6/648
D724,356 S * 3/2015 Weatherly D6/661
D742,149 S * 11/2015 Leduc D6/705

* cited by examiner

Primary Examiner — Rosemary K Tarcaza

Assistant Examiner — Alison Ofstun

(74) *Attorney, Agent, or Firm* — Cook Alex Ltd.; R. Blake Johnston

(57) **CLAIM**

The ornamental design for a workstation, as shown and described.

DESCRIPTION

FIG. 1 is a perspective view of the workstation; FIG. 2 is a front elevational view of the workstation; FIG. 3 is a rear elevational view of the workstation; FIG. 4 is a left side elevational view of the workstation; FIG. 5 is a right side elevational view of the workstation; FIG. 6 is a top plan view of the workstation; and, FIG. 7 is a bottom plan view of the workstation. The broken lines in the figures represent portions of the workstation which form no part of the claim.

1 Claim, 6 Drawing Sheets

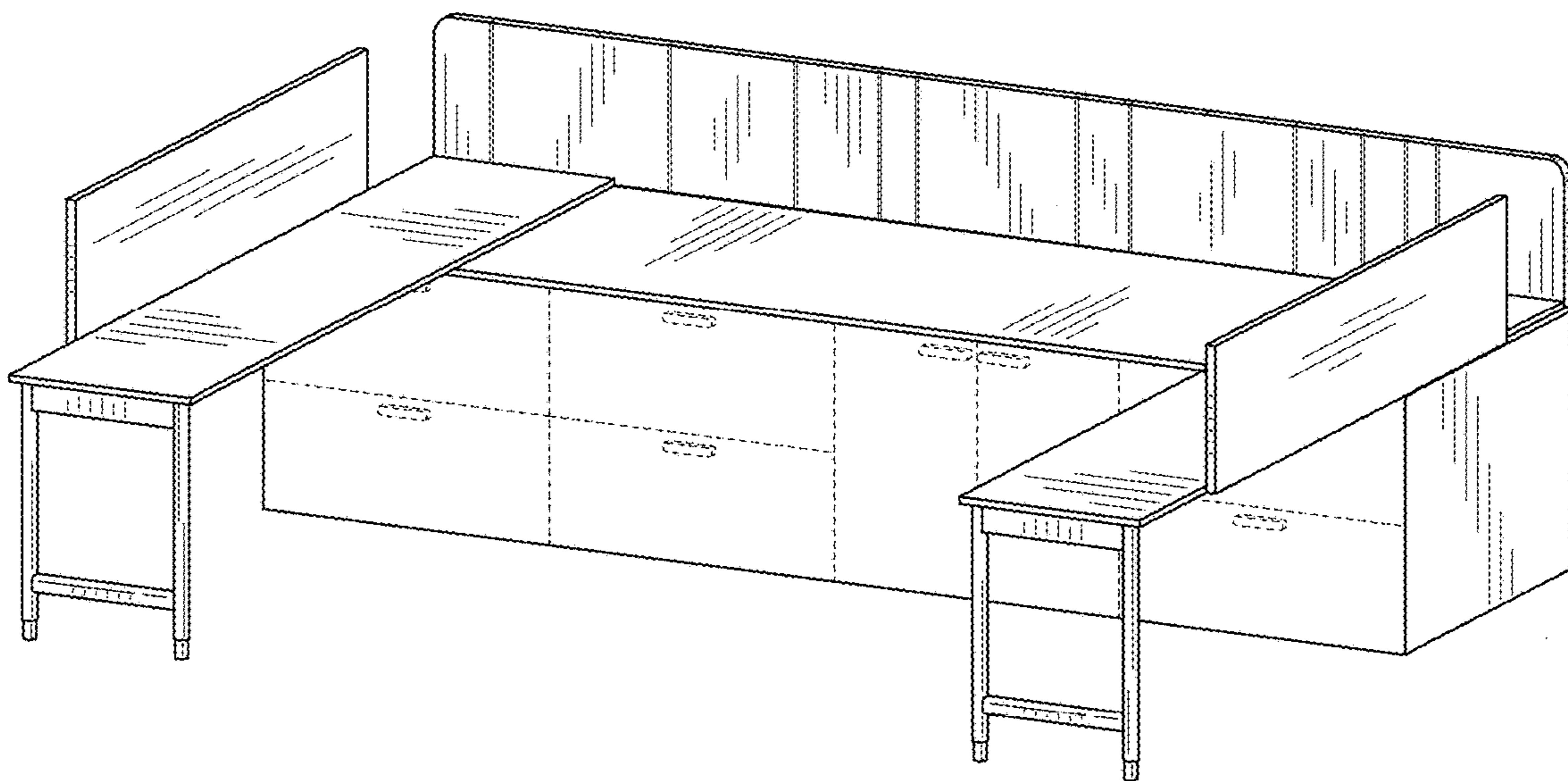

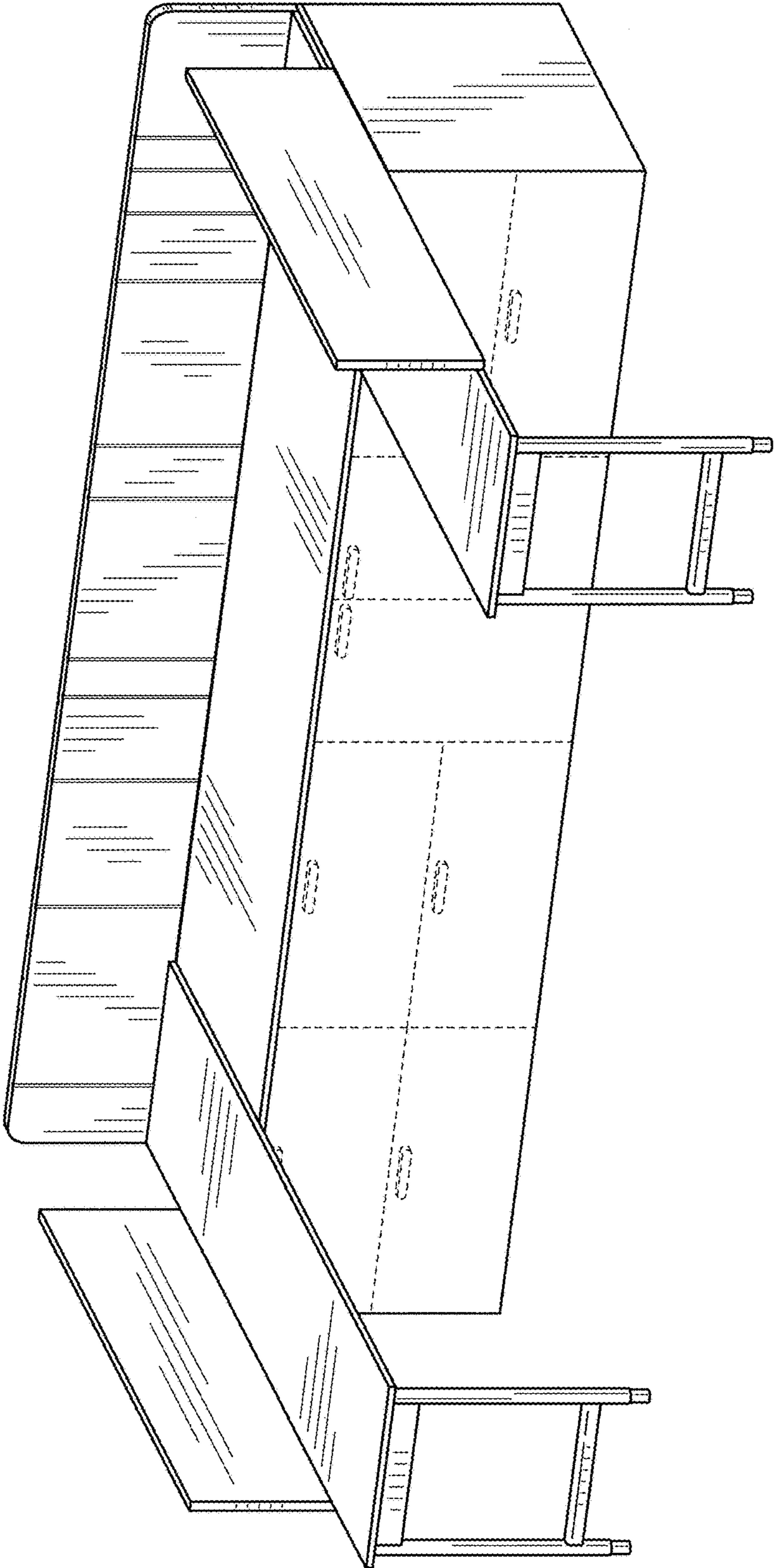

FIG. 1

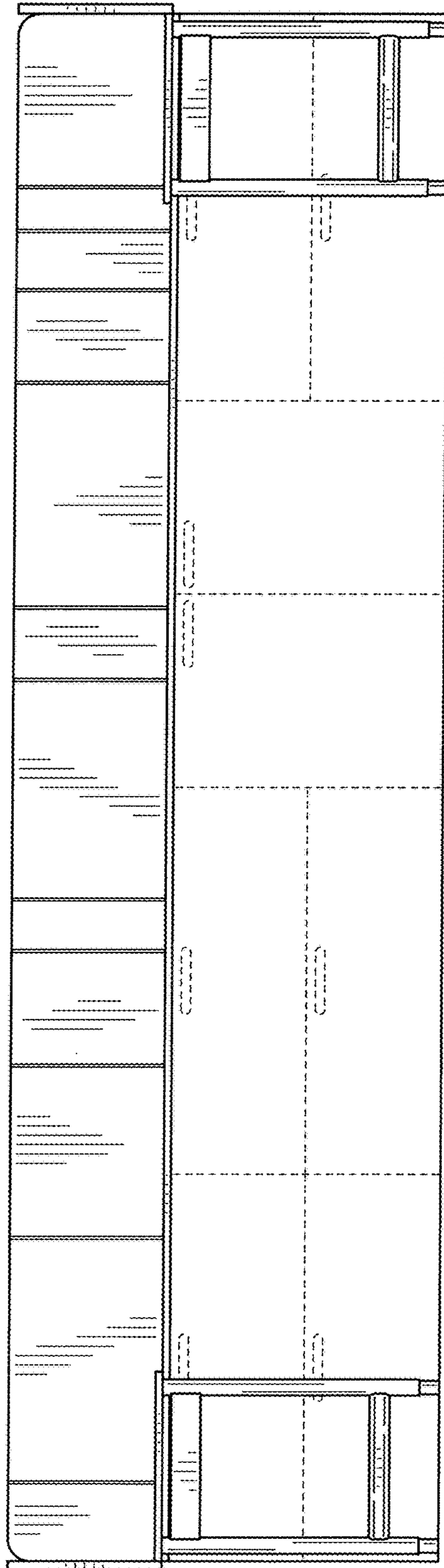

FIG. 2

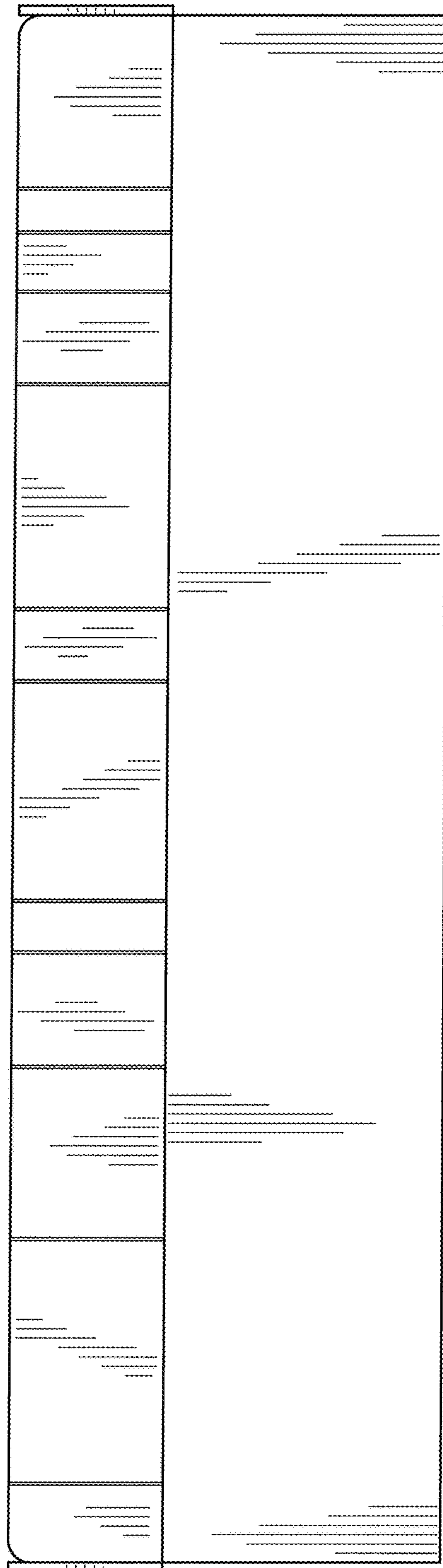

FIG. 3

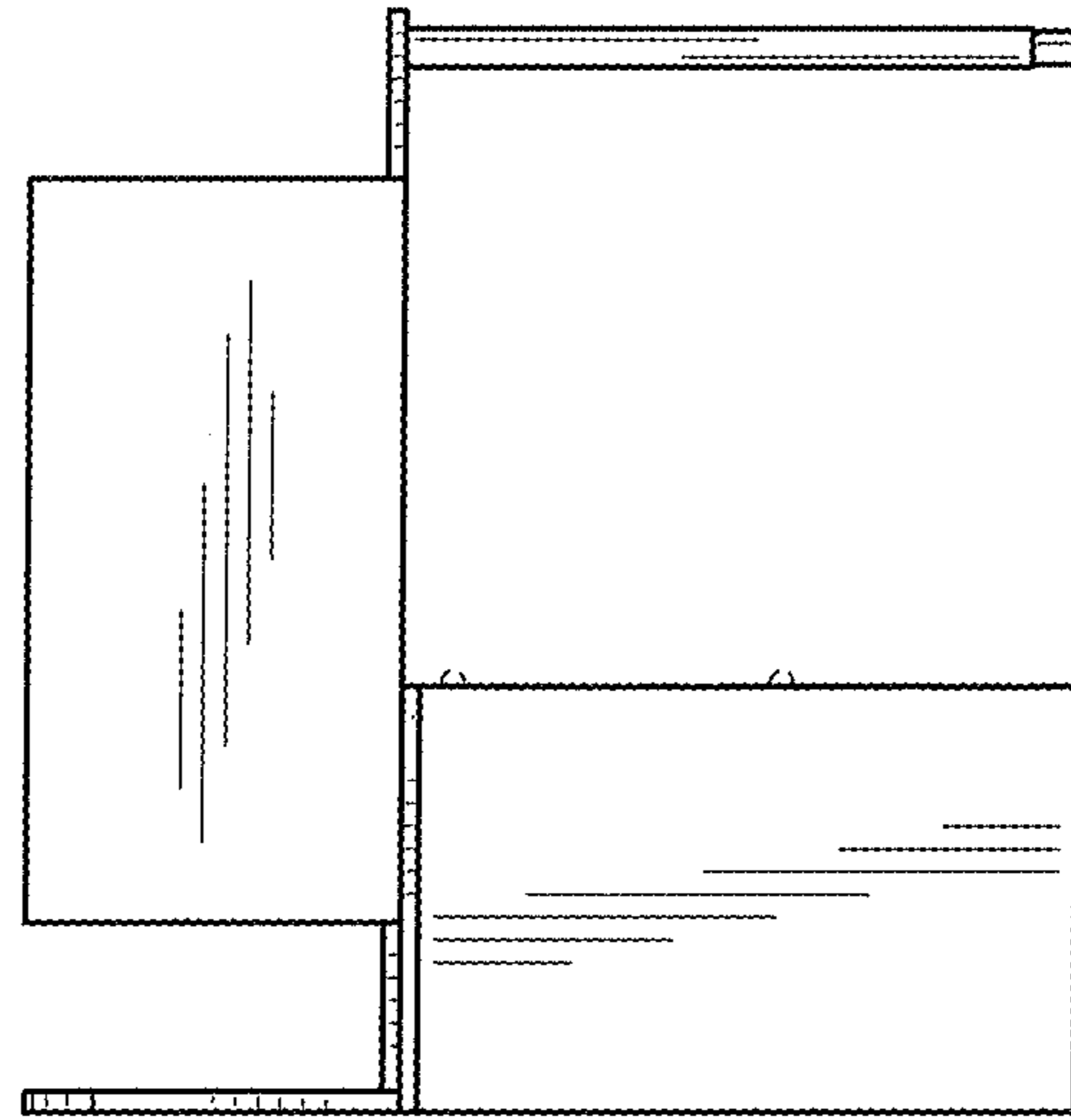

FIG. 5

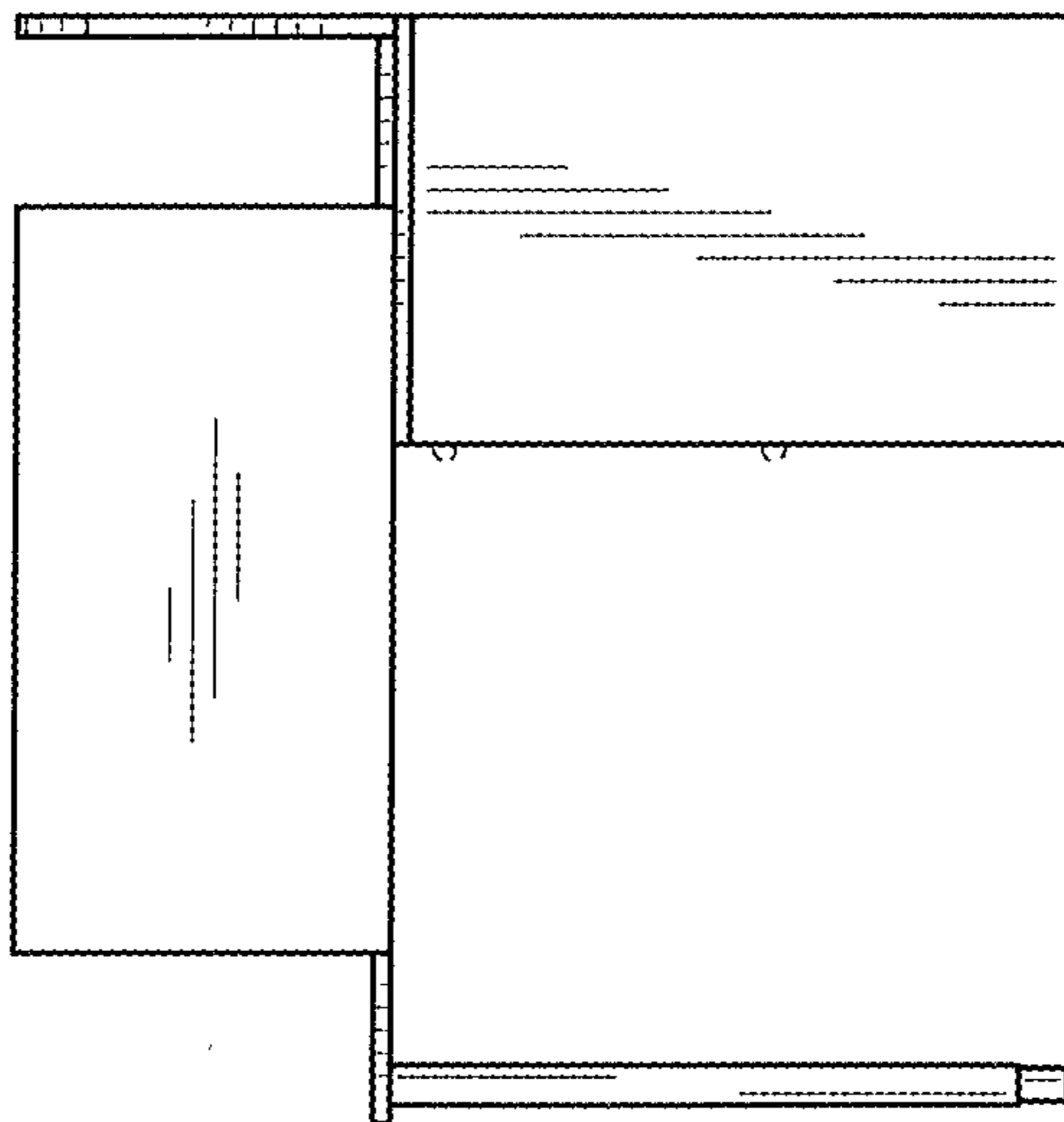

FIG. 4

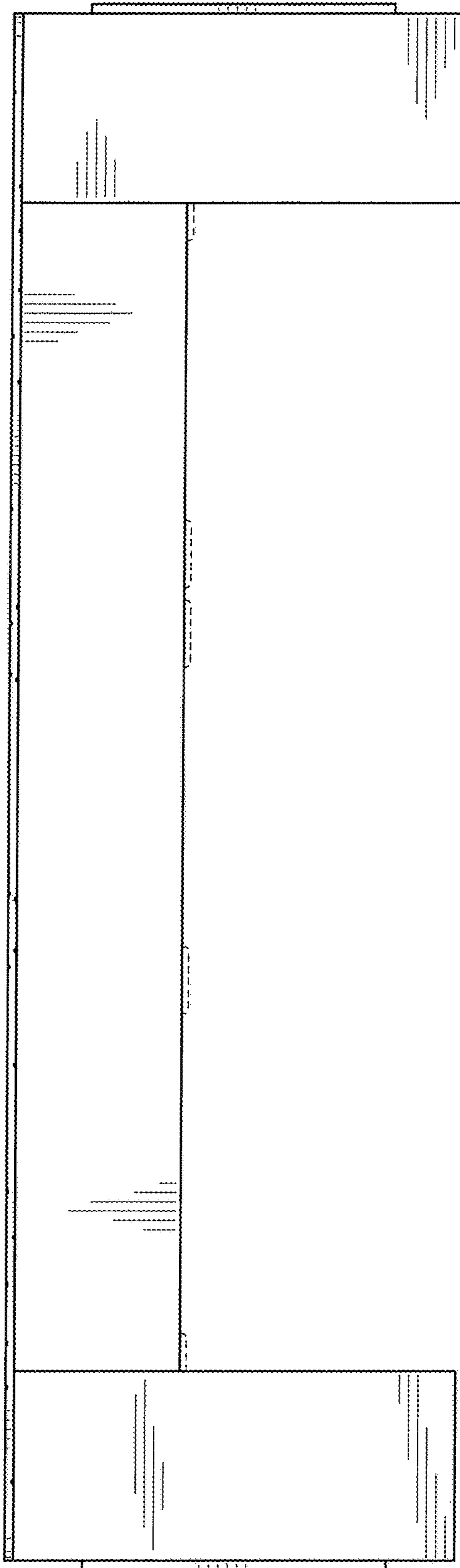

FIG. 6

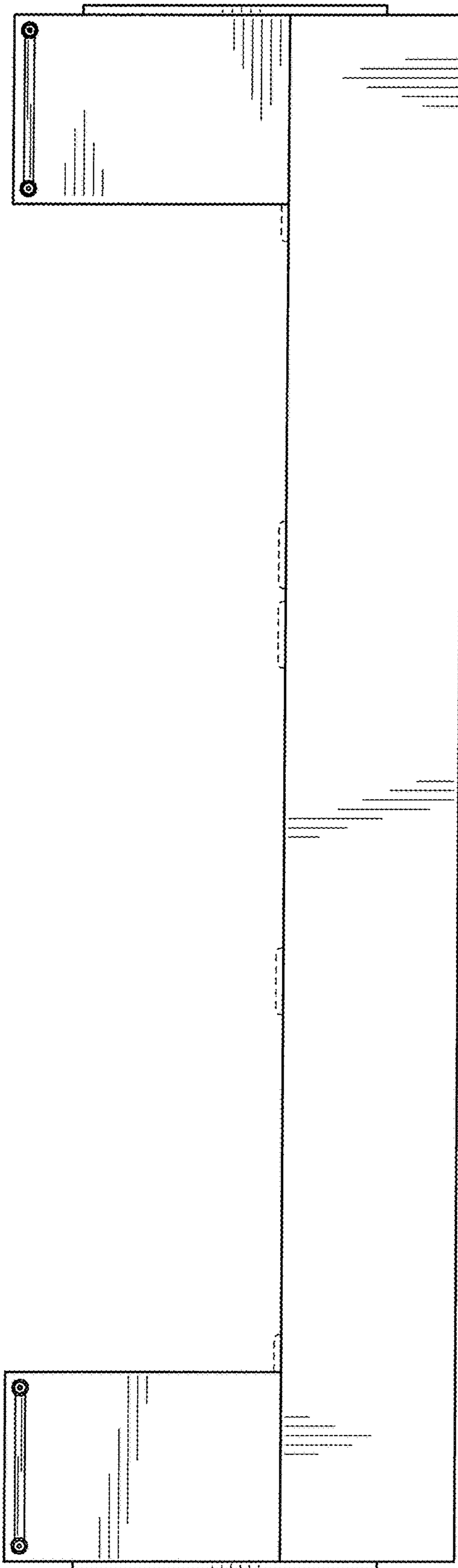

FIG. 7