



US00D780456S

(12) **United States Design Patent**
Shigeno et al.

(10) **Patent No.:** **US D780,456 S**
(45) **Date of Patent:** **** Mar. 7, 2017**

(54) **ELECTRIC TOOTHBRUSH**

A46D 1/10; A61C 15/048; A61C 17/34;
A61C 17/222

See application file for complete search history.

(71) Applicants: **COLGATE-PALMOLIVE COMPANY**, New York, NY (US);
OMRON HEALTHCARE CO., LTD.,
Kyoto (JP)

(56) **References Cited**

U.S. PATENT DOCUMENTS

5,613,259	A	3/1997	Craft et al.
5,974,615	A	11/1999	Schwarz-Hartmann et al.
5,987,681	A	11/1999	Hahn et al.
6,140,802	A	10/2000	Lunmdell et al.
D458,028	S	6/2002	McCurrach
D480,563	S	10/2003	Hensel
D503,852	S	4/2005	Hensel
D636,604	S	4/2011	Zhuan
8,089,227	B2	1/2012	Baertschi et al.
8,418,300	B2	4/2013	Miller et al.
8,453,285	B2	6/2013	Dickie

(Continued)

FOREIGN PATENT DOCUMENTS

EM	001787714-003	11/2010
JP	D1472455	6/2013

Primary Examiner — Keli L Hill

(72) Inventors: **Takashi Shigeno**, Kanagawa (JP);
Kazuya Andachi, Tokyo (JP); **Feilang Tseng**,
Kyoto (JP); **Tamaki Ito**, Kyoto (JP)

(73) Assignees: **COLGATE-PALMOLIVE COMPANY**,
New York, NY (US); **OMRON HEALTHCARE CO, LTD**
(JP)

(**) Term: **15 Years**

(21) Appl. No.: **29/563,532**

(22) Filed: **May 5, 2016**

Related U.S. Application Data

(62) Division of application No. 29/489,074, filed on Apr.
25, 2014, now Pat. No. Des. 758,736.

(51) **LOC (10) Cl.** **04-02**

(52) **U.S. Cl.**
USPC **D4/101**

(58) **Field of Classification Search**
USPC D4/100-102, 104-113, 127, 128;
D24/152, 176; 15/167.1-167.2;
32/308-311
CPC .. A45D 44/18; A46B 5/0095; A46B 15/0055;
A46B 15/0071; A46B 15/0081; A46B
15/0087; A46B 17/04; A46B 2200/1066;

(57) **CLAIM**

The ornamental design for an electric toothbrush, as shown
and described.

DESCRIPTION

FIG. 1 is a front right perspective view of an electric
toothbrush according to the new design;
FIG. 2 is a rear left perspective view thereof;
FIG. 3 is a front view thereof;
FIG. 4 is a right side view thereof, the left side view being
a mirror image of the same;
FIG. 5 is a left side view thereof;
FIG. 6 is a rear view thereof;
FIG. 7 is a top view thereof; and,
FIG. 8 is a bottom view thereof.

(Continued)

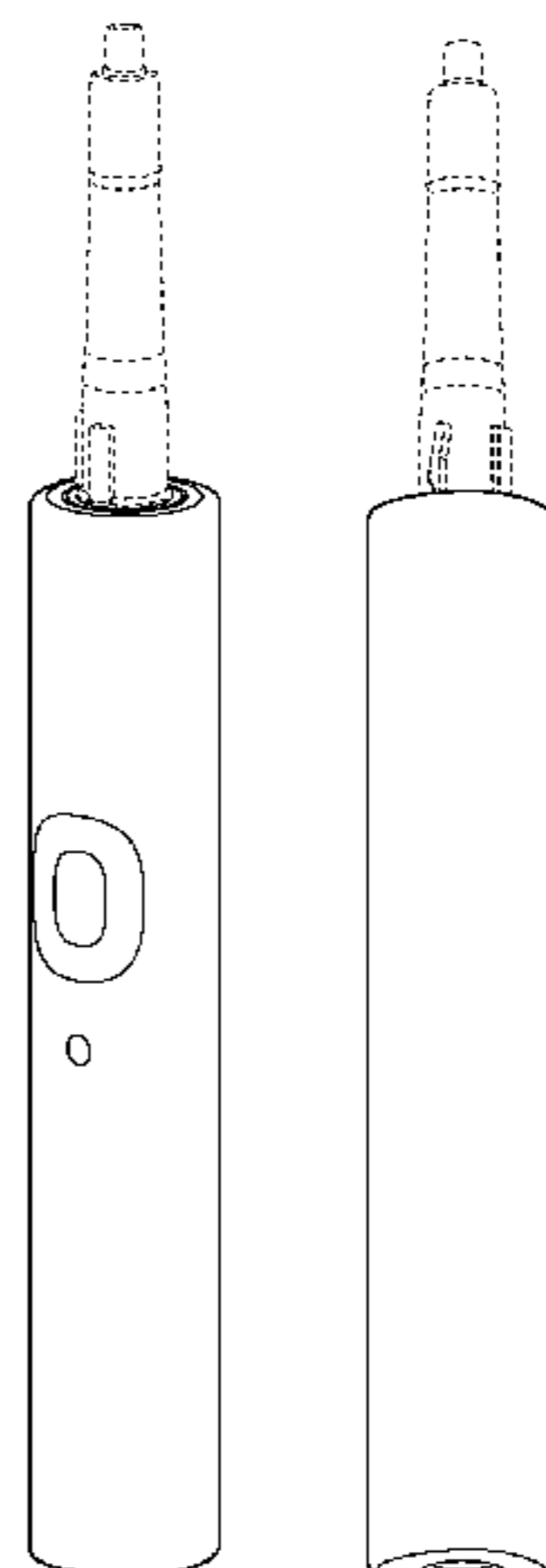

All broken lines shown in the drawings are for environmental purposes only and form no part of the claimed design.

1 Claim, 5 Drawing Sheets

(56) **References Cited**

U.S. PATENT DOCUMENTS

D688,464	S	8/2013	Hara	
8,590,092	B2	11/2013	Dickie	
D696,023	S	12/2013	Gebski	
D696,517	S	12/2013	Gebski	
D702,946	S	4/2014	Shigeno	
D718,056	S	11/2014	Massee	
D767,896	S	* 10/2016	Shigeno D4/101
2009/0031510	A1	2/2009	Hilscher	
2010/0071142	A1	3/2010	Boll et al.	
2012/0024323	A1	2/2012	Klemm et al.	
2012/0216358	A1	8/2012	Kloster	
2012/0246845	A1	10/2012	Kloster	
2012/0272468	A1	11/2012	Weisman et al.	
2012/0279002	A1	11/2012	Sokol et al.	
2013/0025078	A1	1/2013	Heil et al.	
2013/0125320	A1	5/2013	Bovenkamp	
2013/0177863	A1	7/2013	Shreve	
2015/0020325	A1	1/2015	Yoshida	

* cited by examiner

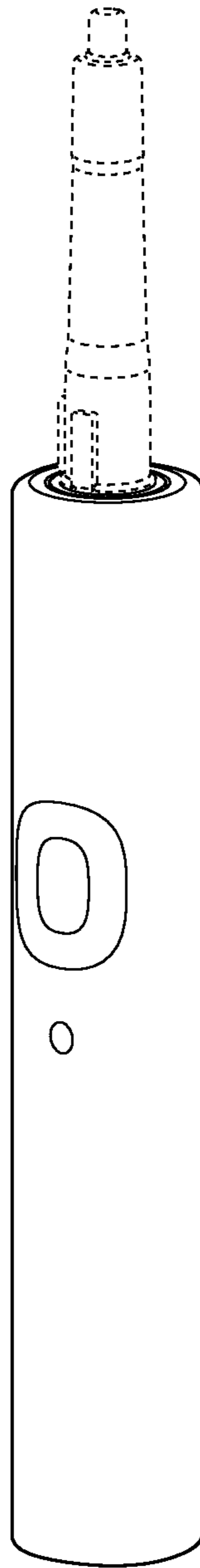

FIG. 1



FIG. 2

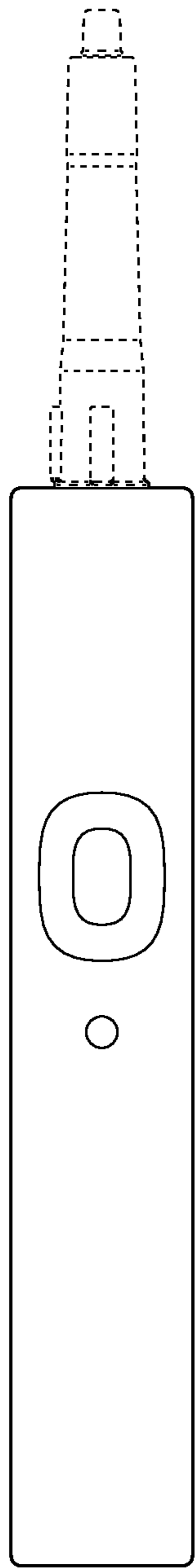

FIG. 3

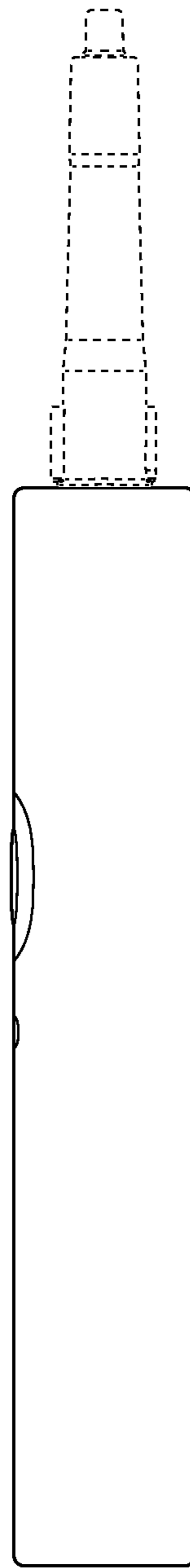

FIG. 4

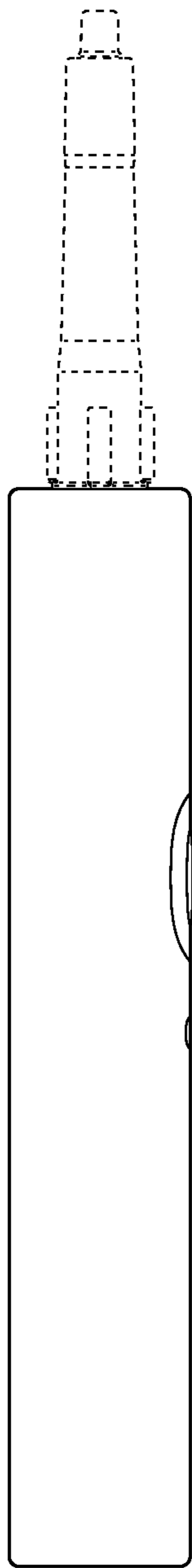

FIG. 5



FIG. 6

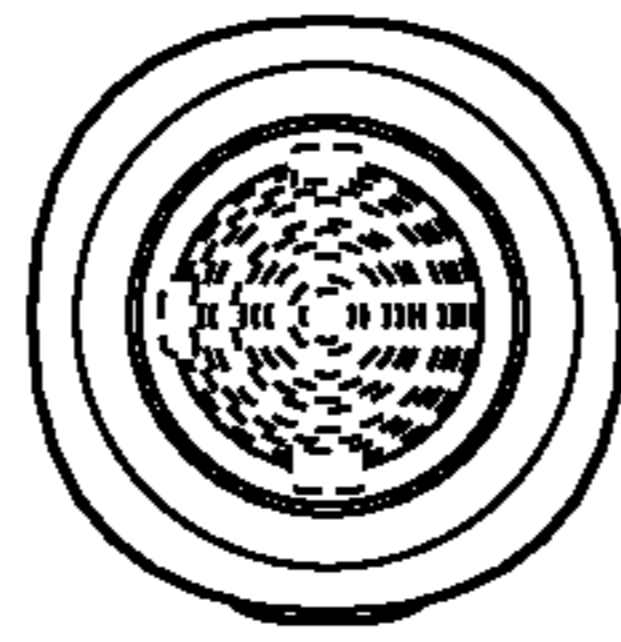

FIG. 7

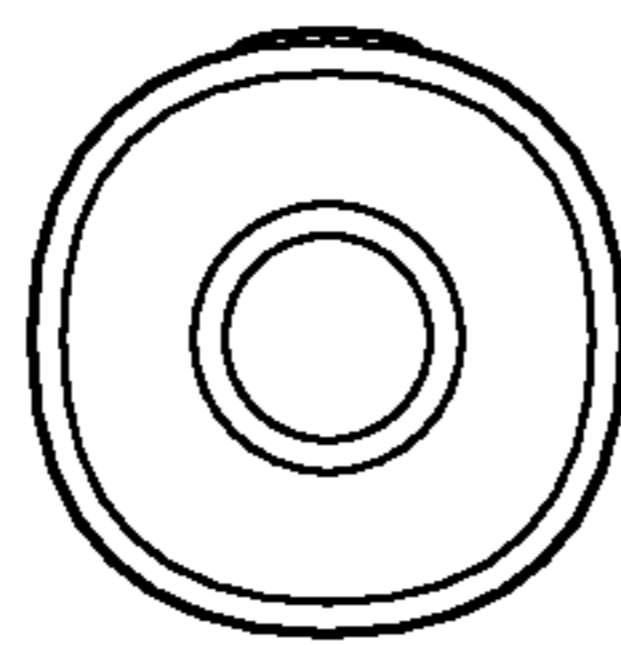

FIG. 8