



US00D779864S

(12) **United States Design Patent**  
**Everson et al.**

(10) **Patent No.:** **US D779,864 S**  
(45) **Date of Patent:** **\*\* Feb. 28, 2017**

- (54) **TABLE**
- (71) Applicant: **Ashley Furniture Industries, Inc.**,  
Arcadia, WI (US)
- (72) Inventors: **Terry A. Everson**, Blair, WI (US);  
**Randy D. Domack**, Holmen, WI (US);  
**Craig C. Bacon**, Trempealeau, WI (US)
- (73) Assignee: **ASHLEY FURNITURE**  
**INDUSTRIES, INC.**, Arcadia, WI (US)
- (\*\*) Term: **15 Years**
- (21) Appl. No.: **29/543,555**
- (22) Filed: **Oct. 26, 2015**

- 3,463,099 A \* 8/1969 Doucette ..... A47B 3/12  
108/167
- D229,467 S \* 12/1973 Ginsberg ..... D6/651
- D267,058 S 11/1982 Maugirard
- D303,052 S \* 8/1989 Rosen ..... D6/691.5
- D322,371 S \* 12/1991 Rosen ..... D6/691
- D341,498 S 11/1993 Ball
- D376,054 S 12/1996 Bergelin
- D422,430 S \* 4/2000 Wilton ..... D6/691
- D443,432 S 6/2001 Vaaler
- D443,447 S 6/2001 Draheim et al.
- D448,211 S \* 9/2001 Schulte ..... D6/686
- D453,083 S \* 1/2002 Hokanson ..... D6/691
- D479,063 S \* 9/2003 Juneau ..... D6/691
- 6,626,119 B2 \* 9/2003 Wilton ..... A47F 5/10  
108/118
- D511,911 S \* 11/2005 Light ..... D6/691.6
- D662,724 S 7/2012 Kemppainen
- D742,146 S \* 11/2015 Lin ..... D6/691

\* cited by examiner

**Related U.S. Application Data**

- (63) Continuation of application No. 29/480,414, filed on  
Jan. 25, 2014, now Pat. No. Des. 741,636.
- (51) **LOC (10) Cl.** ..... **06-03**
- (52) **U.S. Cl.**  
USPC ..... **D6/702**
- (58) **Field of Classification Search**  
USPC ..... D6/663, 671, 671.1, 691, 691.1, 691.9,  
D6/694, 694.2, 641, 685, 686, 691.2,  
D6/691.8, 702, 707.17, 707.24  
CPC ..... A47B 67/00; A47B 79/00; A47B 2067/00;  
A47B 7/00; A47B 13/00  
See application file for complete search history.

(56) **References Cited**

**U.S. PATENT DOCUMENTS**

- D98,615 S 2/1936 Pumphrey
- D153,738 S \* 5/1949 Wallance ..... D6/686
- D182,910 S \* 5/1958 Lubberts et al. .... D6/686

*Primary Examiner* — Mary Ann Calabrese

(74) *Attorney, Agent, or Firm* — McAndrews, Held &  
Malloy, Ltd.

(57) **CLAIM**

The ornamental design for a table, as shown and described.

**DESCRIPTION**

FIG. 1 is a front elevation view of a table showing our new design;  
 FIG. 2 is a rear elevation view thereof;  
 FIG. 3 is a right side elevation view thereof;  
 FIG. 4 is a left side elevation view thereof; and,  
 FIG. 5 is a top plan view thereof.  
 The broken lines in the figures illustrate portions of the table that form no part of the claimed design.  
 Any views not shown in the figures form no part of the claimed design.

**1 Claim, 5 Drawing Sheets**

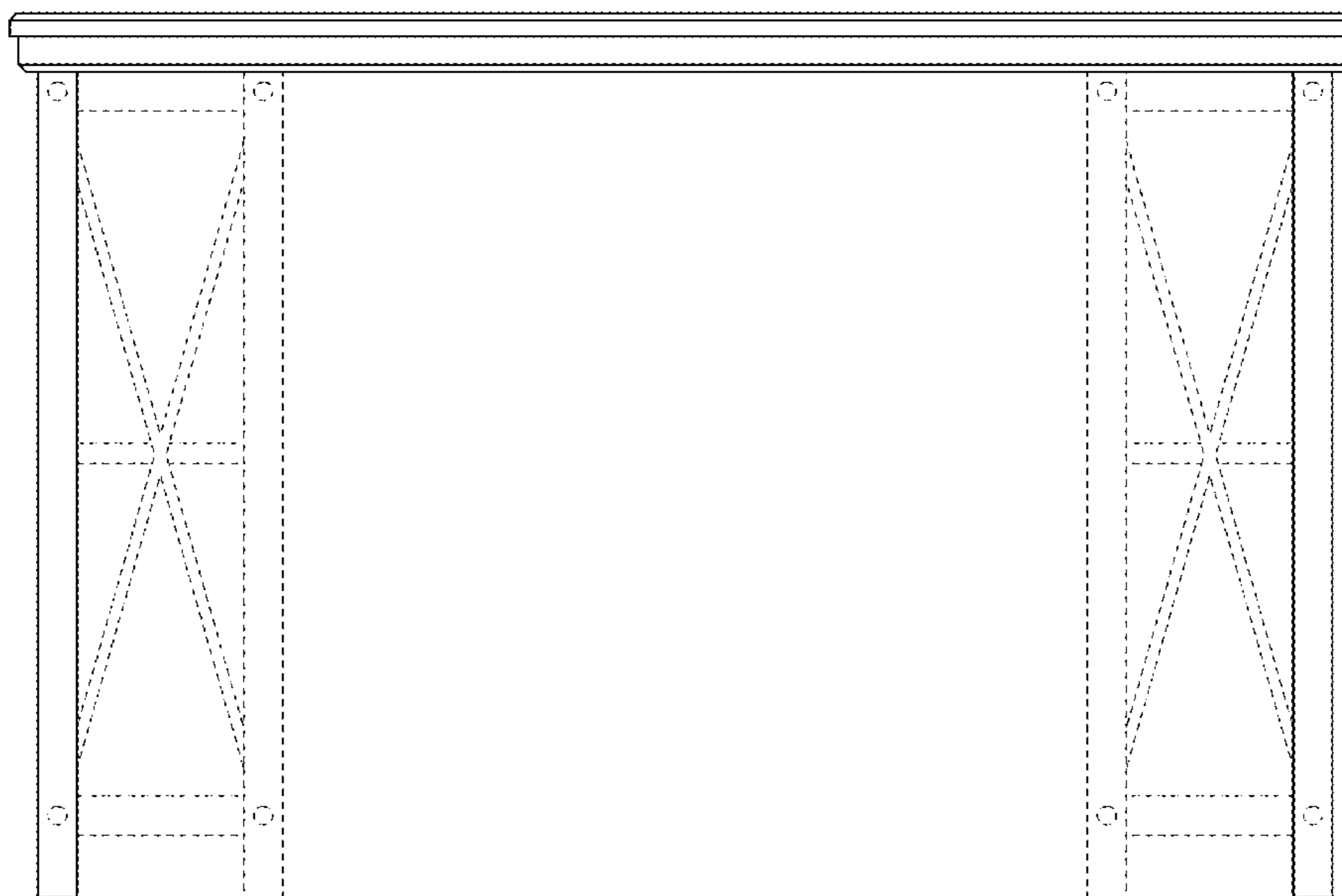

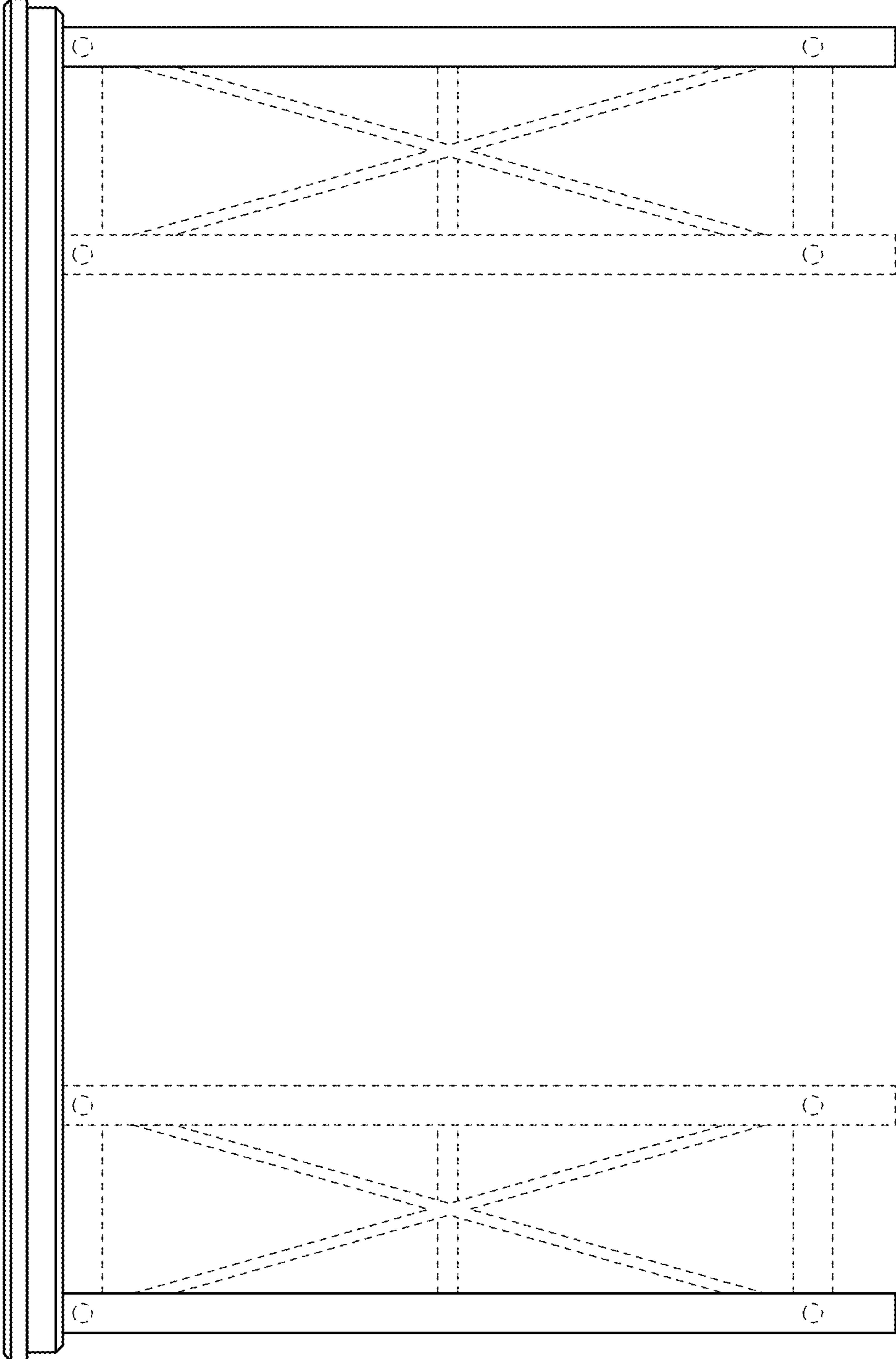

FIG. 1

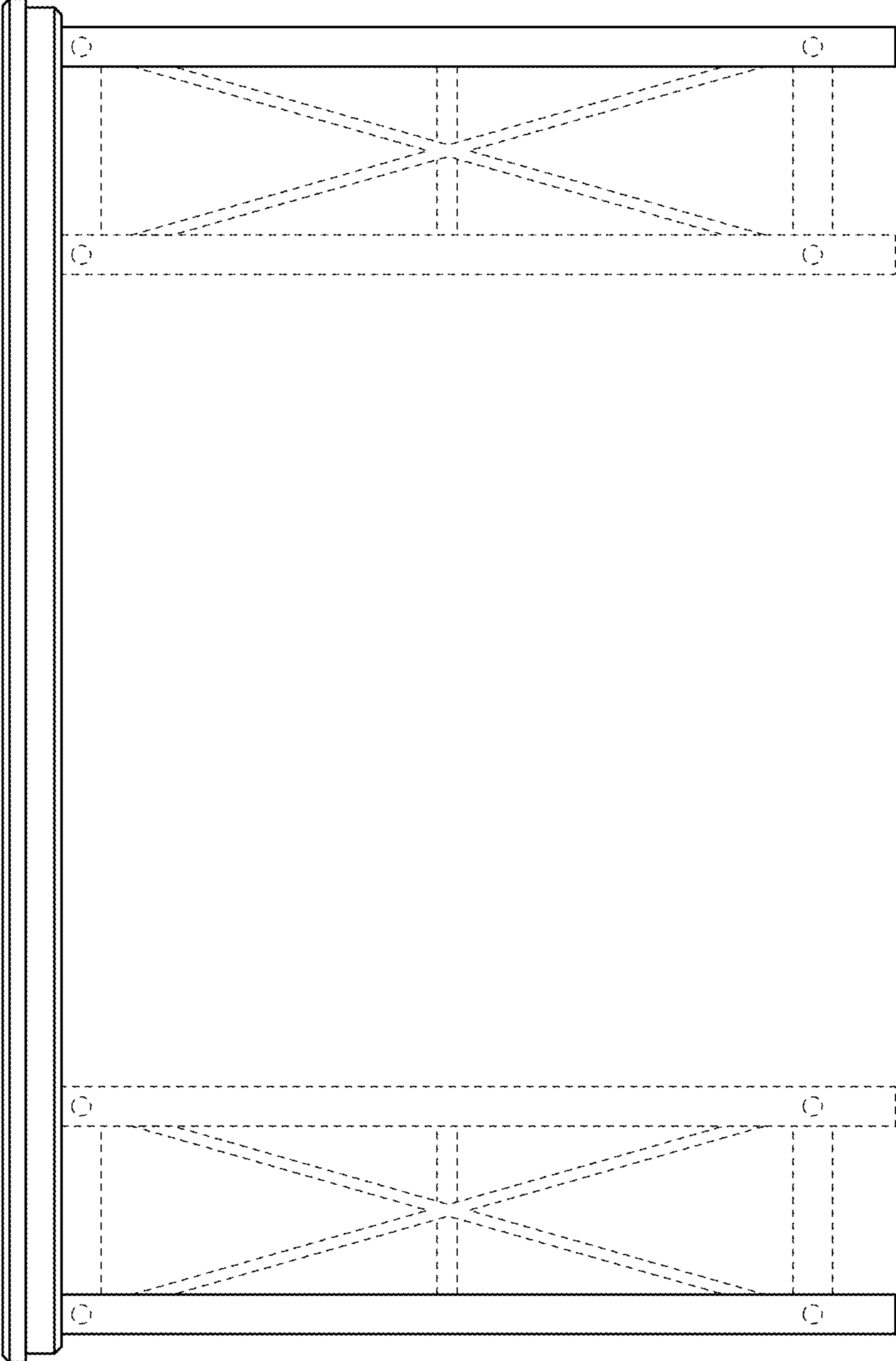

FIG. 2

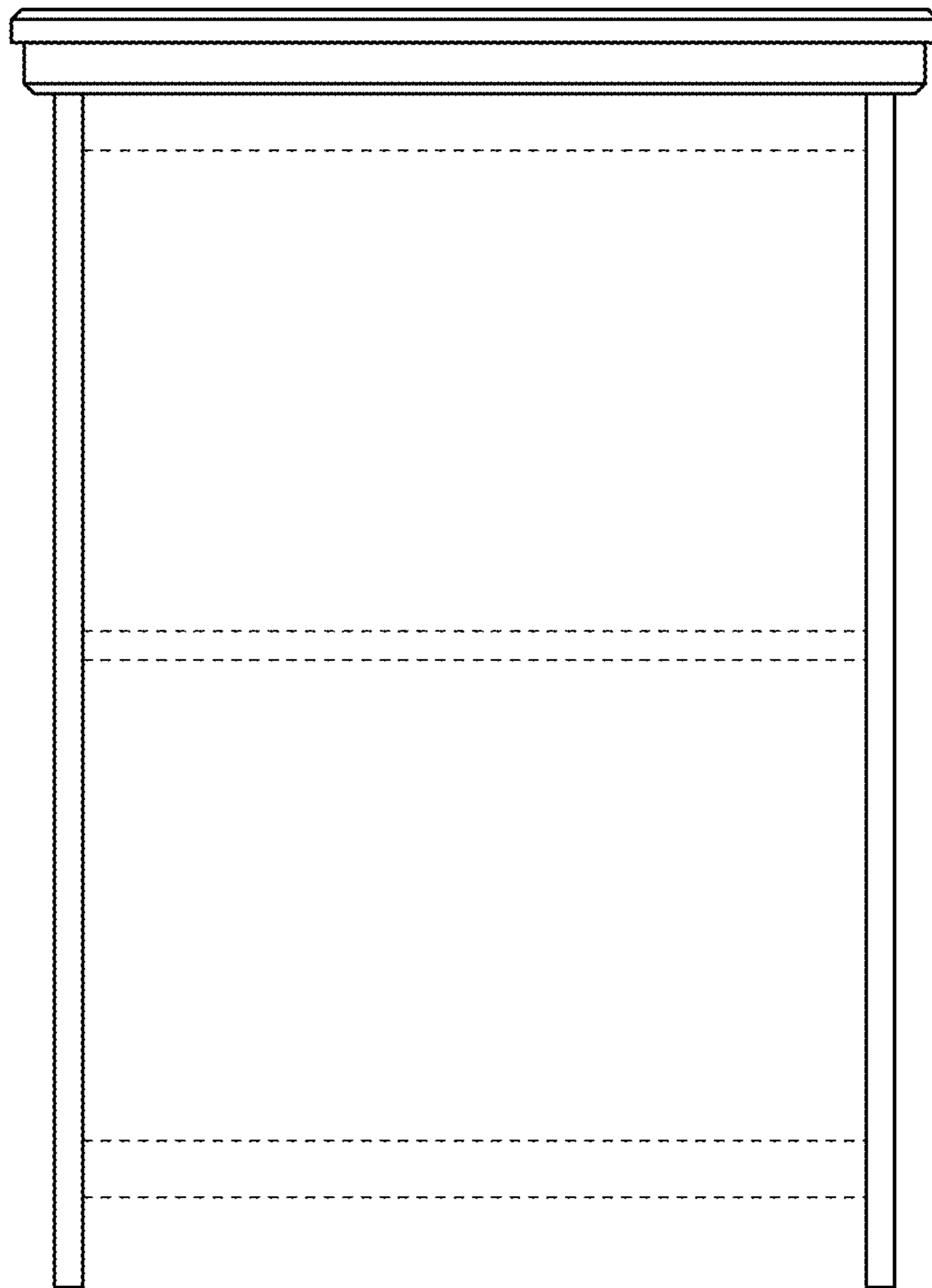

FIG. 3

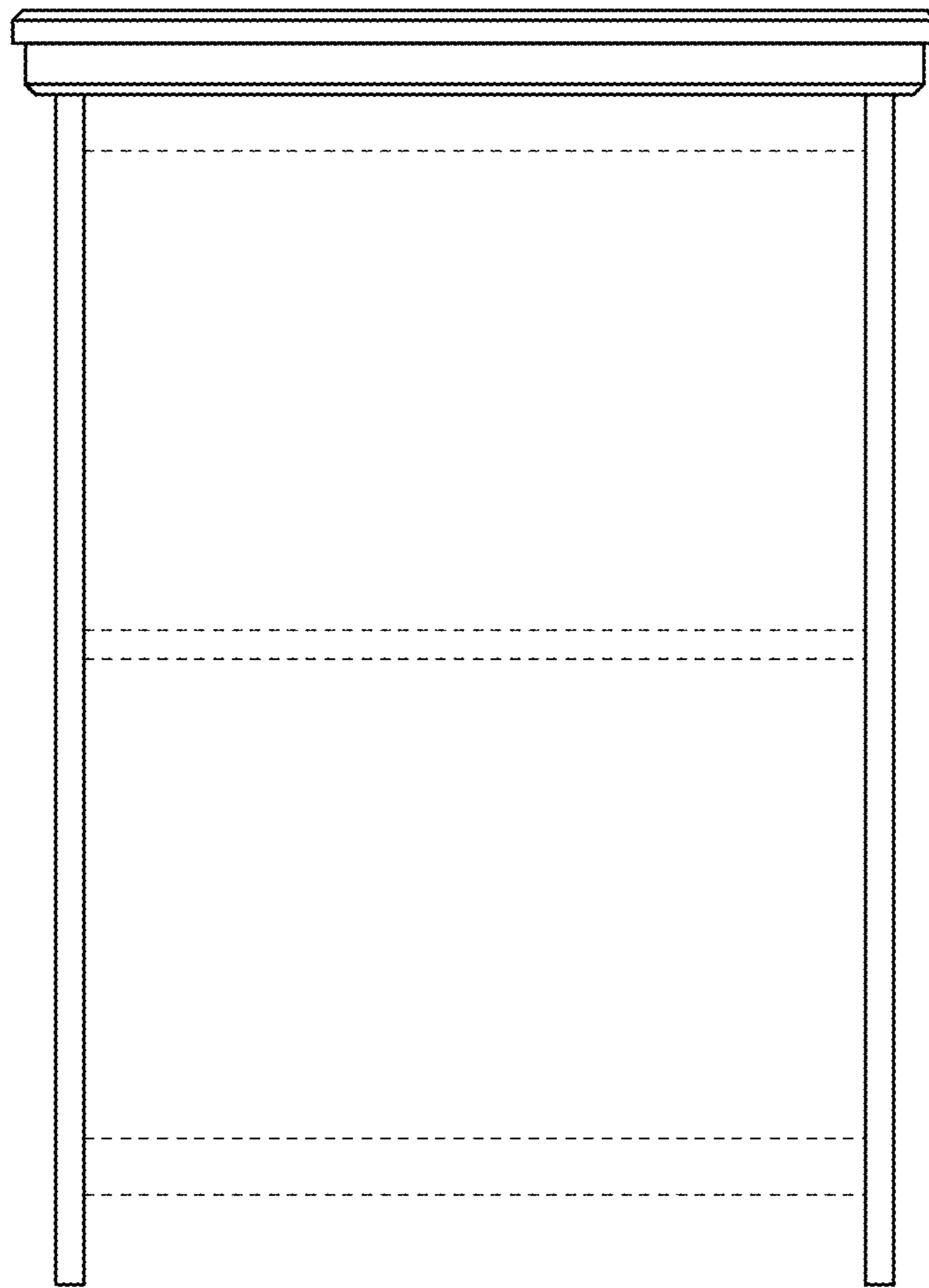

FIG. 4

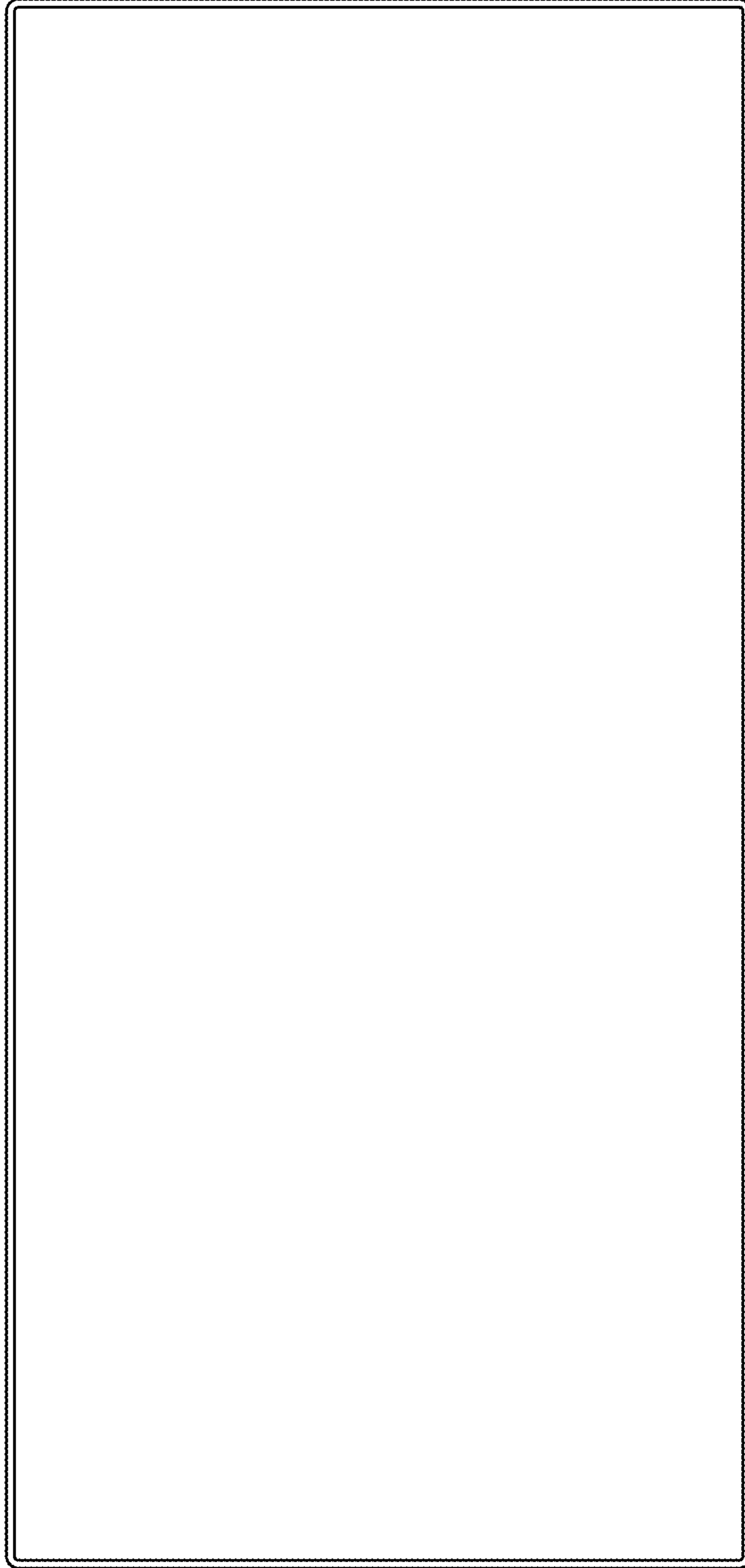

FIG. 5