



US00D779406S

(12) **United States Design Patent**  
**Park et al.**

(10) **Patent No.:** **US D779,406 S**

(45) **Date of Patent:** **\*\* Feb. 21, 2017**

(54) **TAILGATE PANEL FOR AUTOMOBILE**

(71) Applicant: **Kia Motors Corporation**, Seoul (KR)

(72) Inventors: **Jung Hun Park**, Gyeonggi-do (KR);  
**Mun Hyo Yoon**, Gyeonggi-do (KR)

(73) Assignee: **Kia Motors Corporation**, Seoul (KR)

(\*\*) Term: **15 Years**

(21) Appl. No.: **29/547,373**

(22) Filed: **Dec. 3, 2015**

(30) **Foreign Application Priority Data**

Jul. 16, 2015 (KR) ..... 30-2015-0035975

(51) **LOC (10) Cl.** ..... **12-16**

(52) **U.S. Cl.**  
USPC ..... **D12/196**

(58) **Field of Classification Search**

USPC ..... D12/190, 192, 196, 83, 181, 163, 164,  
D12/169, 167, 171, 216, 86, 90, 91, 92

CPC ..... B62D 24/00; B62D 24/02; B62D 25/02;  
B62D 25/18; B62D 25/08; B62D 35/00;  
B60J 5/04; B60R 19/02; B60R 19/04

See application file for complete search history.

(56) **References Cited**

**U.S. PATENT DOCUMENTS**

D684,514 S \* 6/2013 McCabe ..... D12/196  
D706,191 S \* 6/2014 Choi ..... D12/196

D725,566 S \* 3/2015 Rugar ..... D12/196  
D726,615 S \* 4/2015 Wolff ..... D12/196  
D736,128 S \* 8/2015 Blanski ..... D12/196  
D738,802 S \* 9/2015 Mueller-Stolz ..... D12/196  
D749,480 S \* 2/2016 Yu ..... D12/196  
D751,014 S \* 3/2016 Wolff ..... D12/196  
D760,634 S \* 7/2016 Messale ..... D12/196  
D761,177 S \* 7/2016 Behmer ..... D12/196  
D764,994 S \* 8/2016 Jo ..... D12/196  
D764,996 S \* 8/2016 Lee ..... D12/196

\* cited by examiner

*Primary Examiner* — Daniel Bui

*Assistant Examiner* — Andrew Kerr

(74) *Attorney, Agent, or Firm* — Mintz Levin Cohn Ferris  
Glovsky and Popeo, P.C.; Kongsik Kim

(57) **CLAIM**

The ornamental design for a tailgate panel for automobile, as shown and described.

**DESCRIPTION**

FIG. 1 is a perspective view of a tailgate panel for automobile according to the present invention.

FIG. 2 is a front view thereof.

FIG. 3 is a rear view thereof.

FIG. 4 is a left side view thereof.

FIG. 5 is a right side view thereof.

FIG. 6 is a top view thereof; and,

FIG. 7 is a bottom view thereof.

**1 Claim, 7 Drawing Sheets**

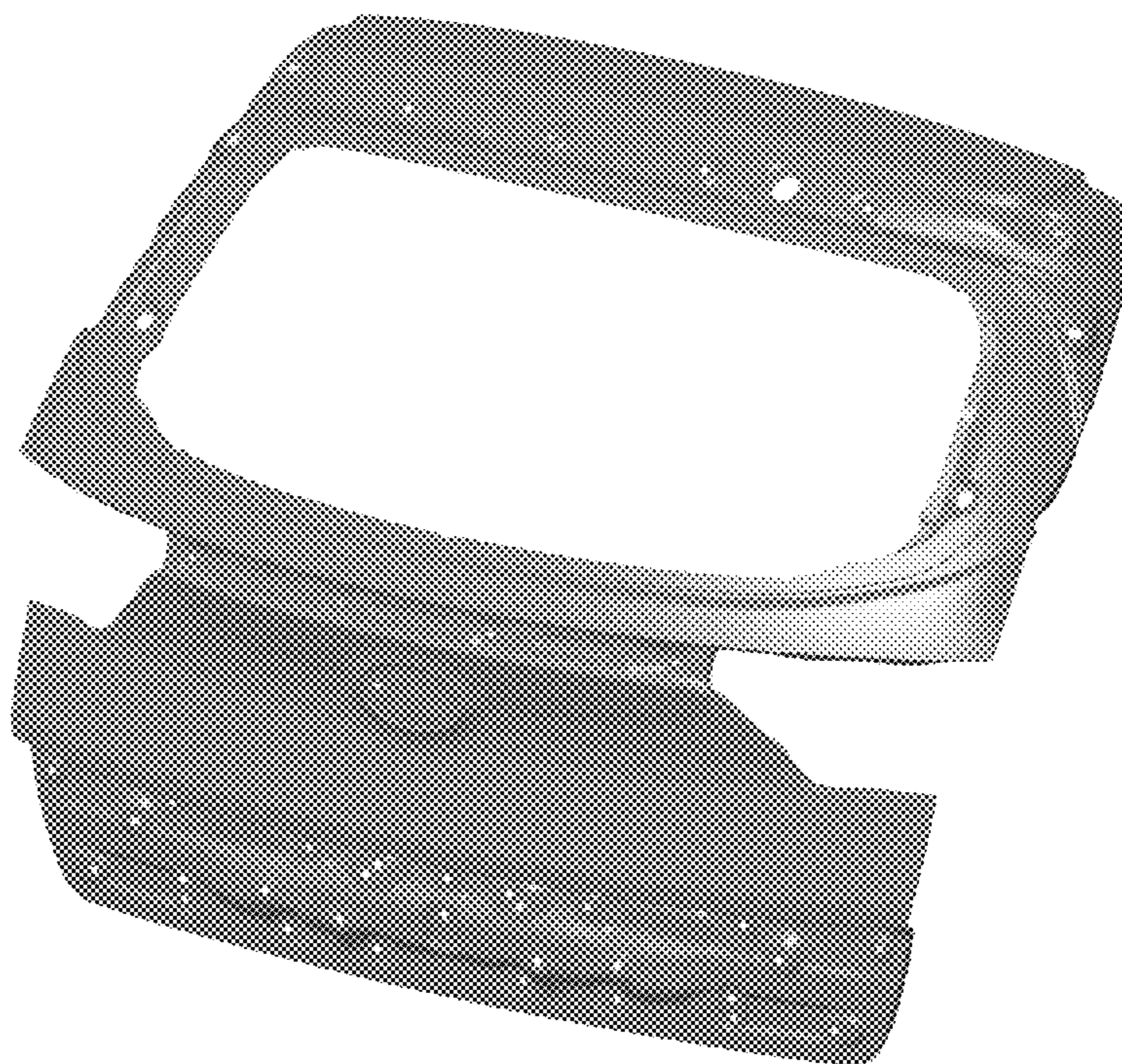

**FIG. 1**



FIG. 2

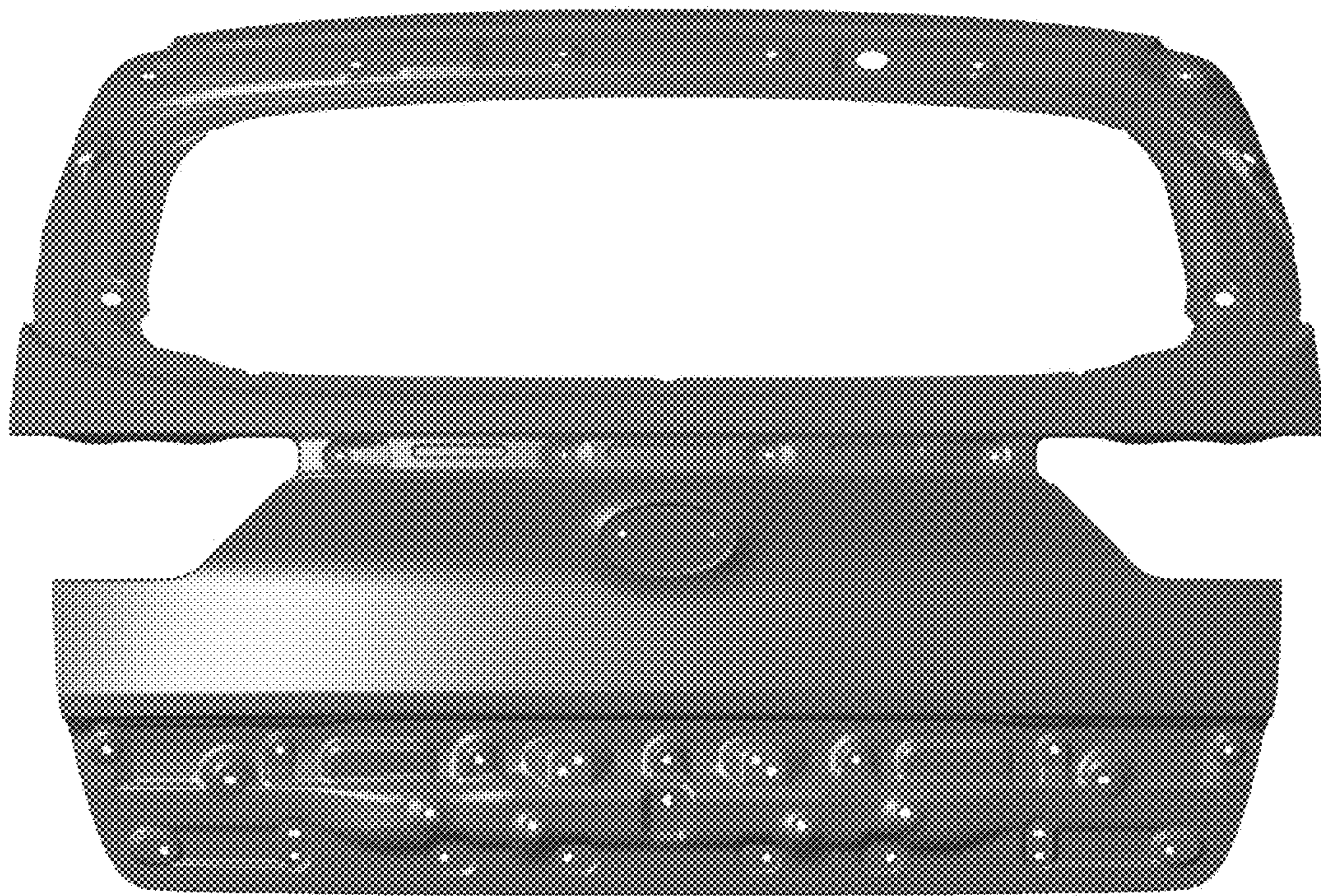
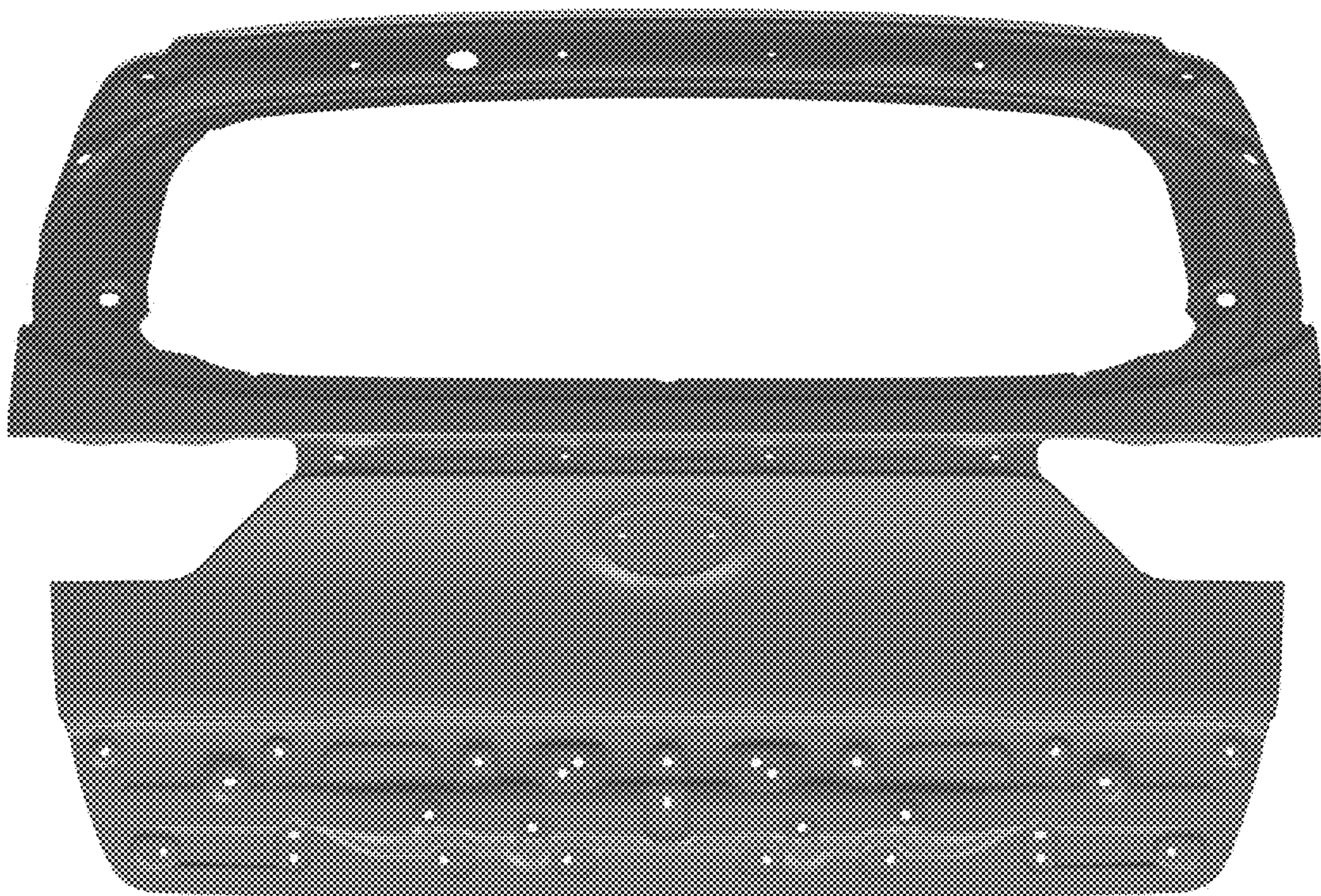
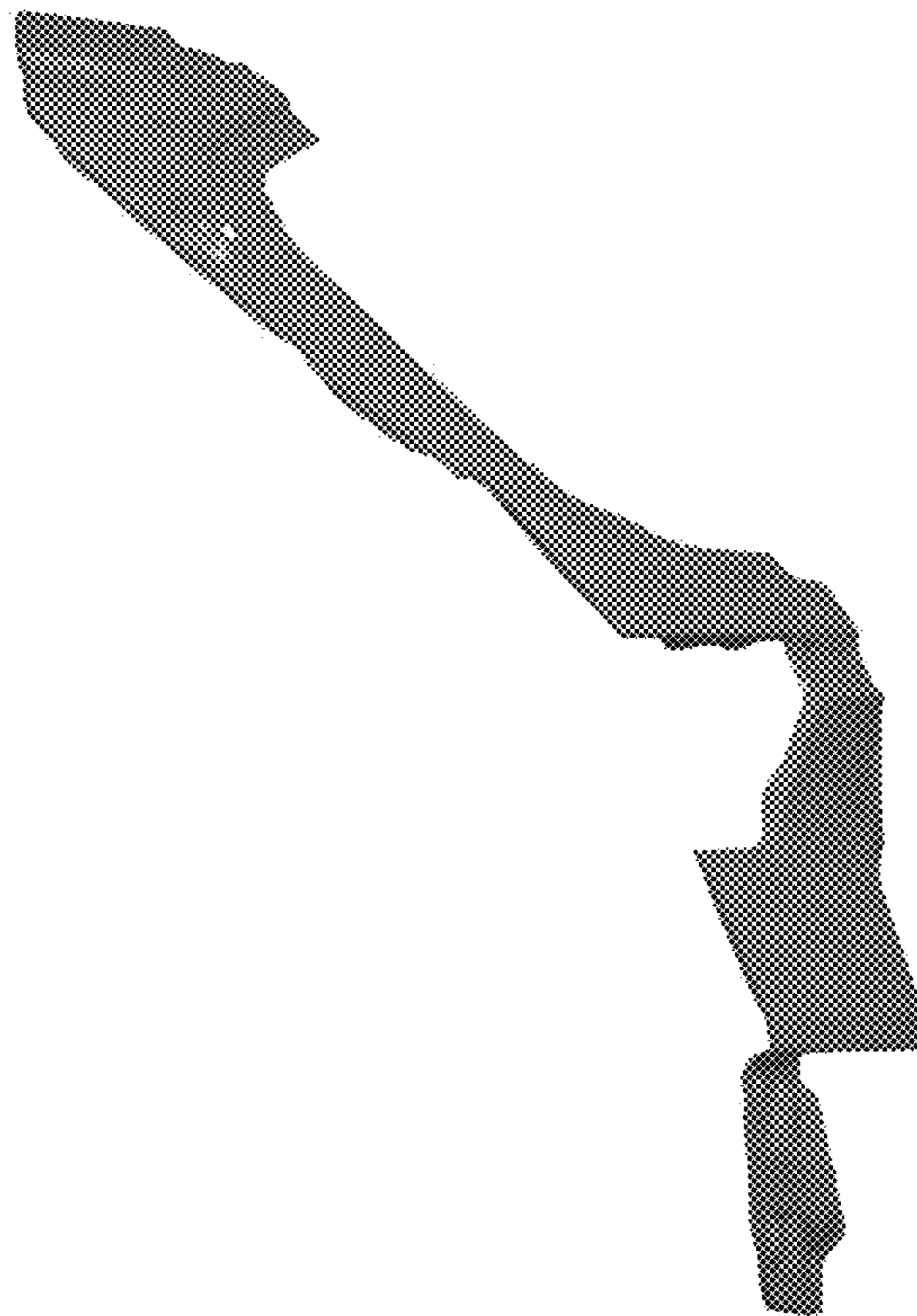

FIG. 3



**FIG. 4**



**FIG. 5**

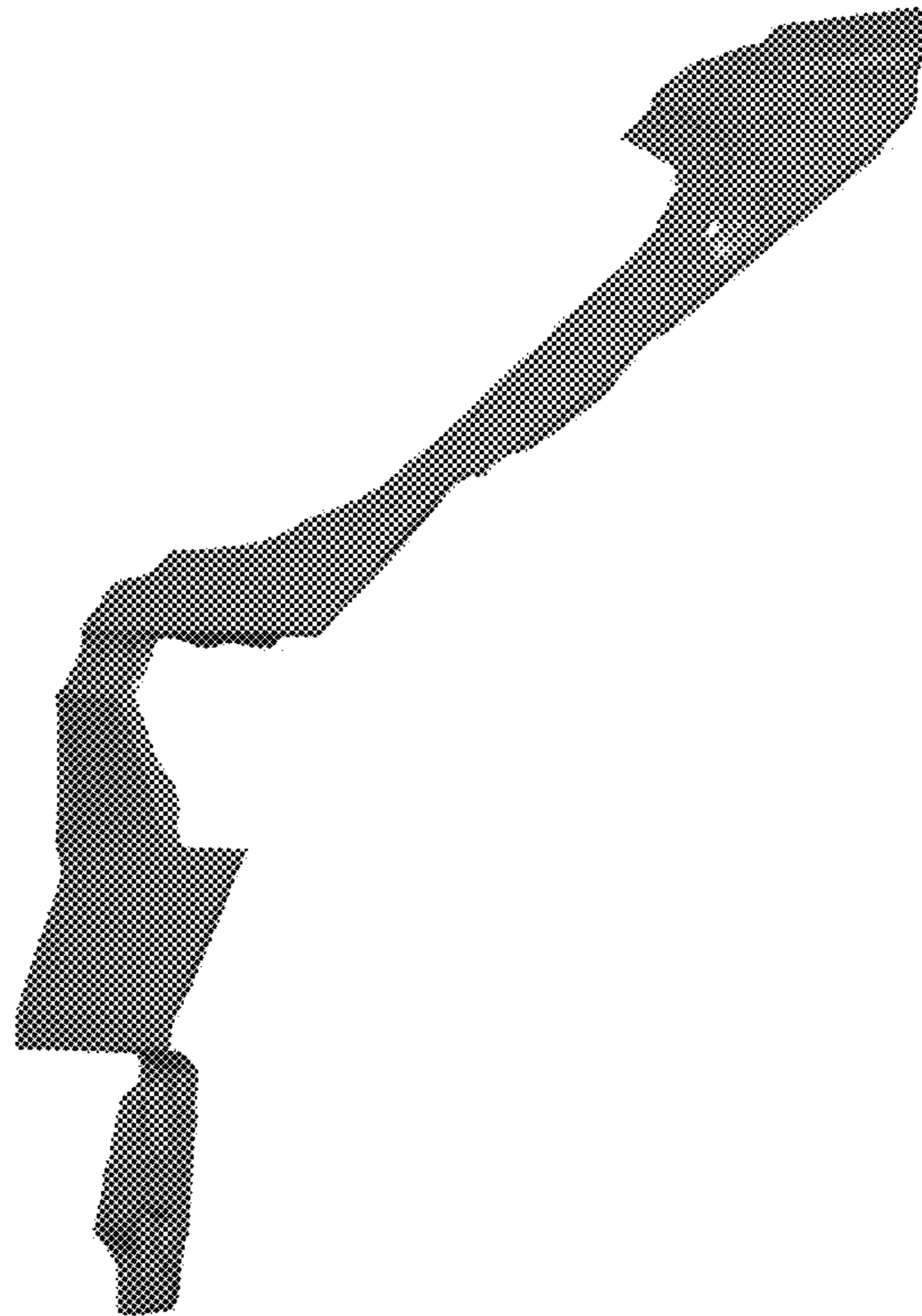
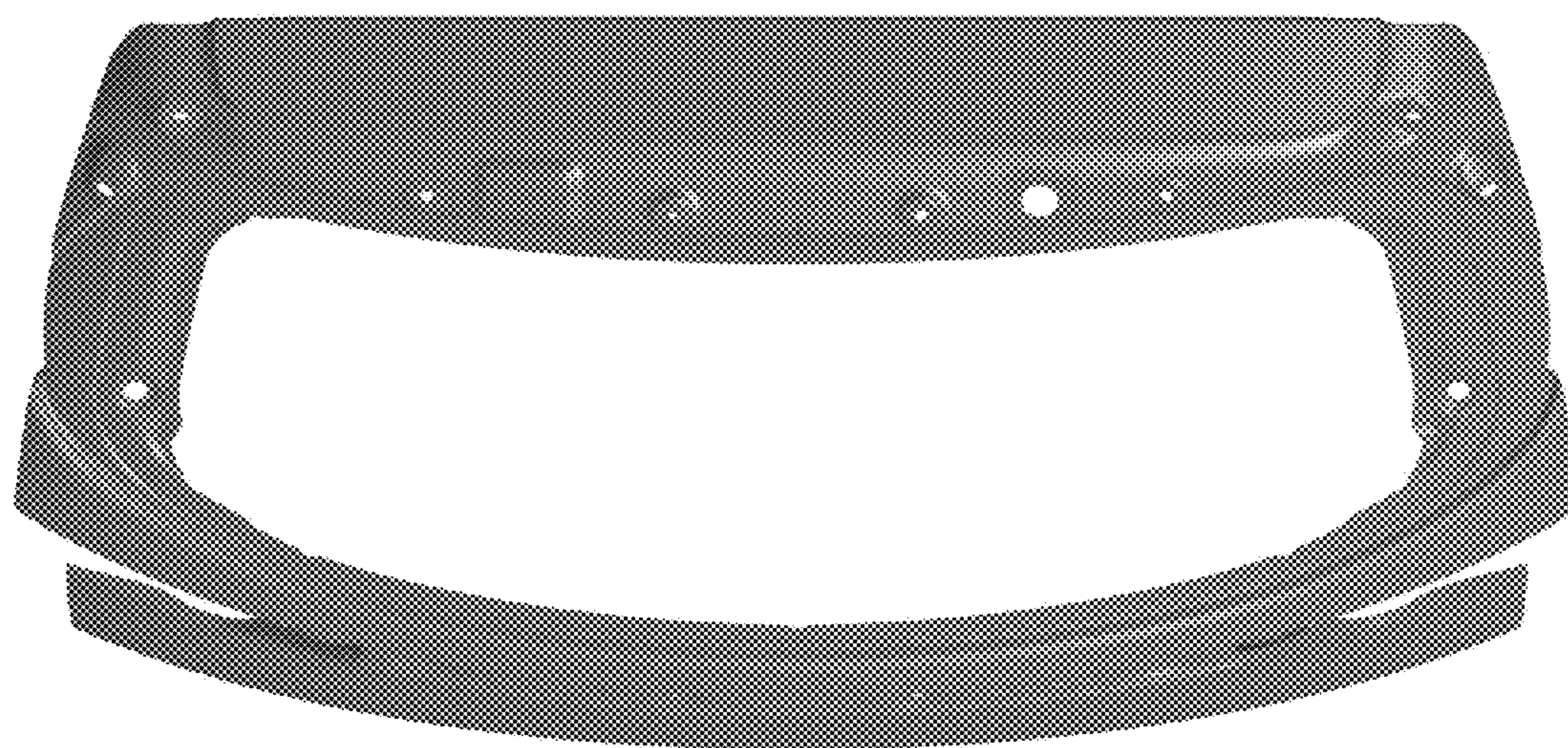

FIG. 6



**FIG. 7**

