



US00D778524S

(12) **United States Design Patent**  
**Kang**

(10) **Patent No.:** **US D778,524 S**

(45) **Date of Patent:** **\*\* Feb. 7, 2017**

(54) **FORKLIFT**

(71) Applicant: **DOOSAN CORPORATION**, Seoul  
(KR)

(72) Inventor: **Sung Kyu Kang**, Gyeonggi-do (KR)

(73) Assignee: **DOOSAN CORPORATION**, Republic  
Of Seoul

(\*\*) Term: **15 Years**

(21) Appl. No.: **29/550,083**

(22) Filed: **Dec. 30, 2015**

(51) **LOC (10) Cl.** ..... **12-05**

(52) **U.S. Cl.**  
USPC ..... **D34/34**

(58) **Field of Classification Search**  
USPC ..... D15/23-33; D34/33, 34, 37; 187/222,  
187/237, 238; 414/631, 592  
CPC ..... B66F 9/06; B66F 9/24; B66F 9/12;  
B66F 9/0755; B66F 9/07572; B66F  
17/003

See application file for complete search history.

(56) **References Cited**

**U.S. PATENT DOCUMENTS**

D393,134 S	*	3/1998	Mariano	.....	D34/28
D395,115 S	*	6/1998	Russey	.....	D34/34
D427,409 S	*	6/2000	Sato	.....	D34/34
D468,885 S	*	1/2003	Salin	.....	D34/34

D471,339 S	*	3/2003	Mori	.....	D34/34
D538,004 S	*	3/2007	Kouyama	.....	D34/34
D557,474 S	*	12/2007	Kouyama	.....	D34/34
D634,504 S	*	3/2011	Radaelli	.....	D34/34
D657,932 S	*	4/2012	Kazaoka	.....	D34/34
D663,502 S	*	7/2012	Lin	.....	D34/34
D663,503 S	*	7/2012	Lin	.....	D34/34
D694,984 S	*	12/2013	Kawakami	.....	D34/34
D725,863 S	*	3/2015	Kazaoka	.....	D34/34
D731,736 S	*	6/2015	Kurihara	.....	D34/34
D731,737 S	*	6/2015	Seimiya	.....	D34/34
D741,565 S	*	10/2015	Schweig	.....	D34/34
D756,058 S	*	5/2016	Kang	.....	D34/34
D756,059 S	*	5/2016	Kang	.....	D34/34

\* cited by examiner

*Primary Examiner* — Mark Goodwin

(74) *Attorney, Agent, or Firm* — Volpe and Koenig, P.C.

(57) **CLAIM**

The ornamental design for forklift, as shown and described.

**DESCRIPTION**

FIG. 1 is a perspective view of the forklift;  
FIG. 2 is a front view of the forklift;  
FIG. 3 is a rear view of the forklift;  
FIG. 4 is a left side view of the forklift;  
FIG. 5 is a right side view of the forklift;  
FIG. 6 is a top view of the forklift; and,  
FIG. 7 is a bottom view of the forklift.

**1 Claim, 5 Drawing Sheets**

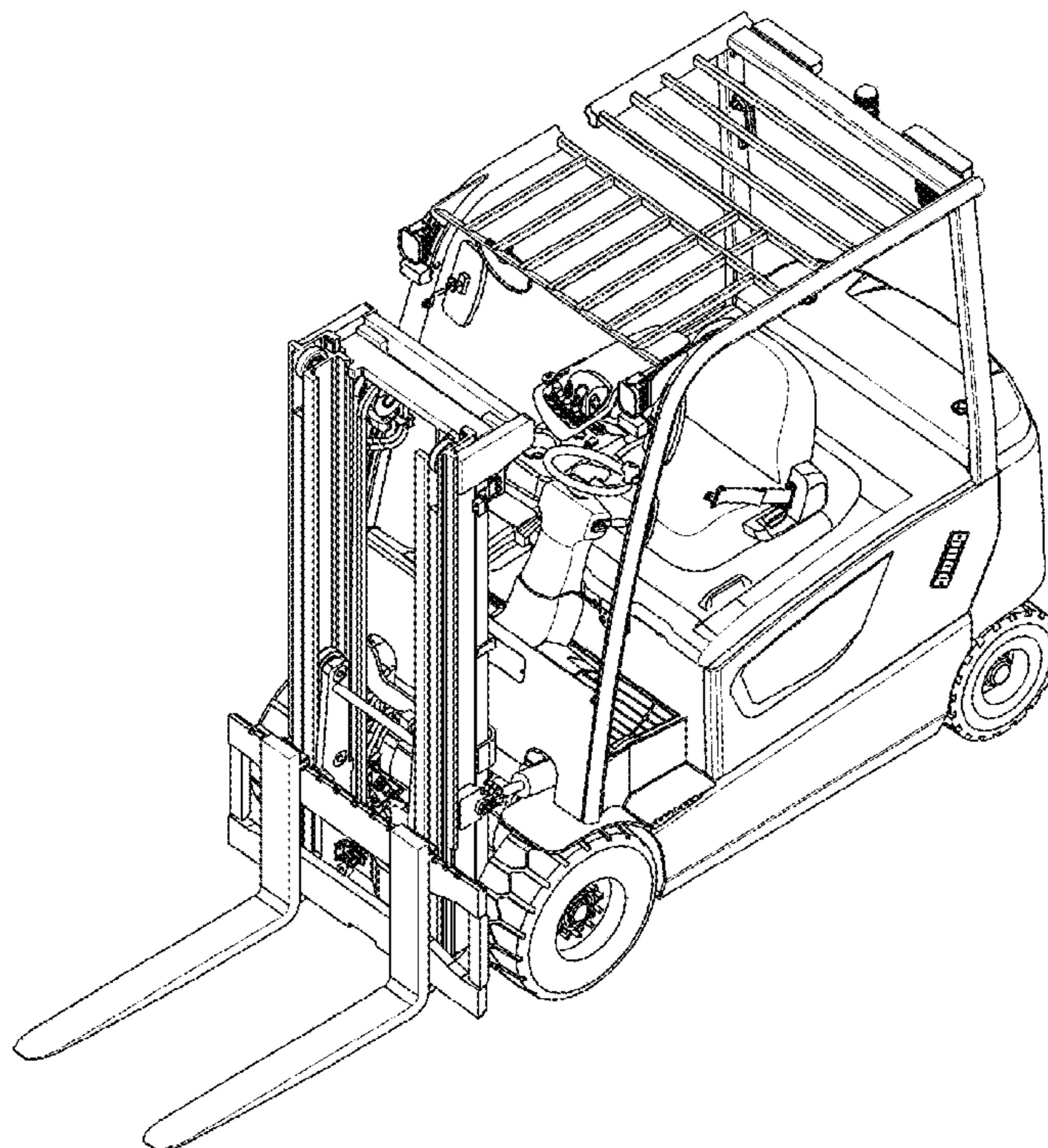

FIG. 1

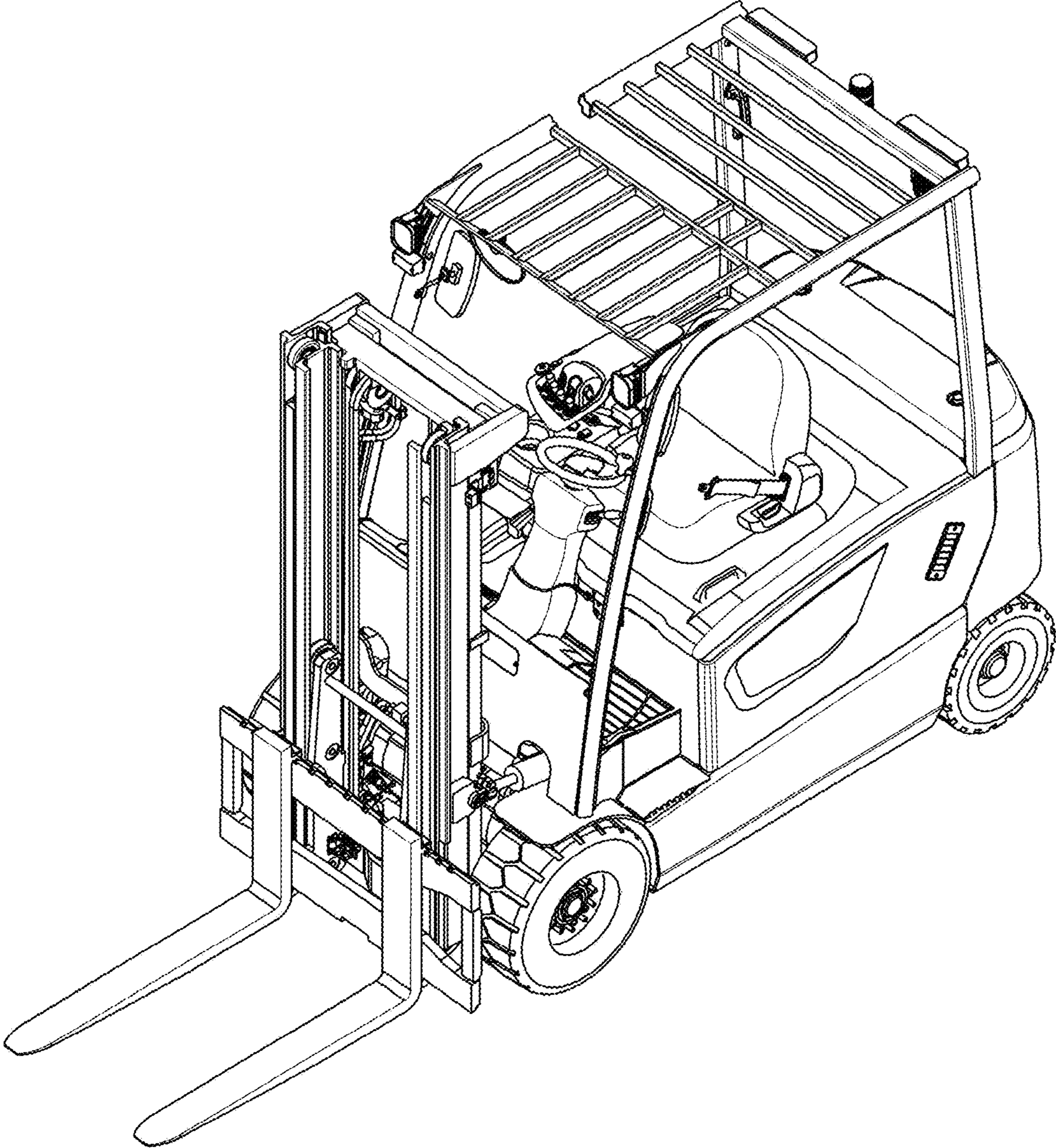

FIG. 2

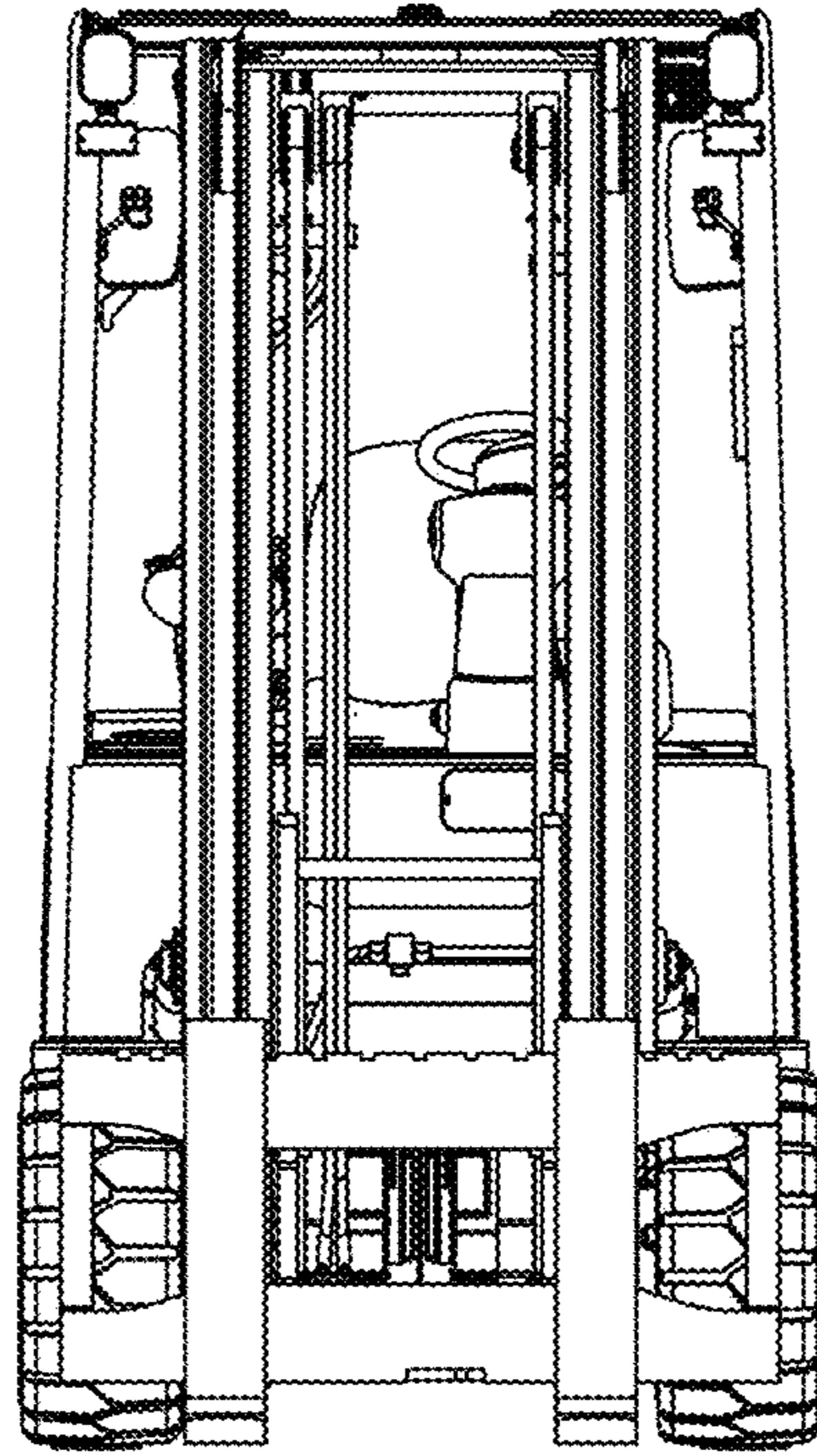

FIG. 3

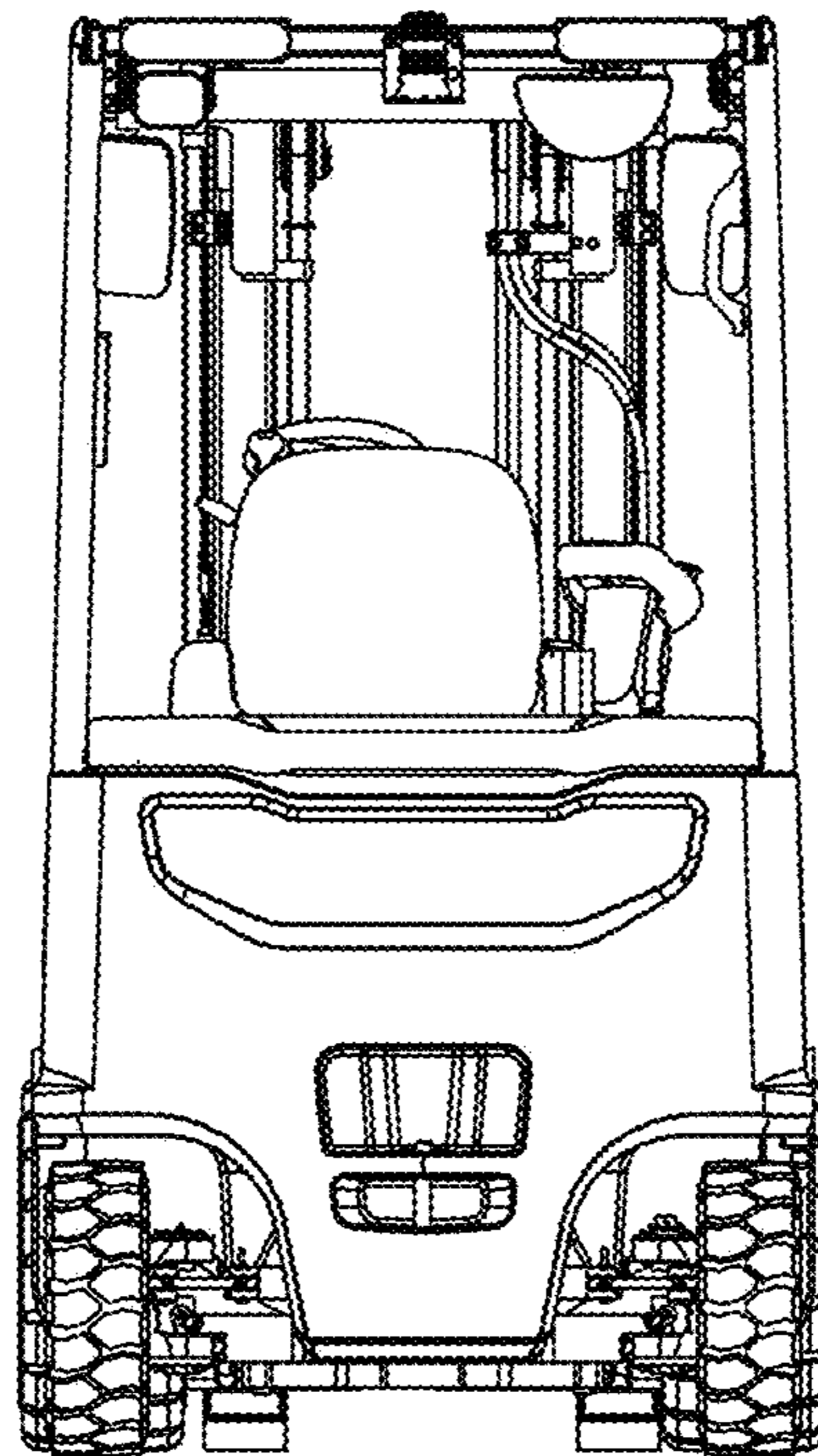

FIG. 4

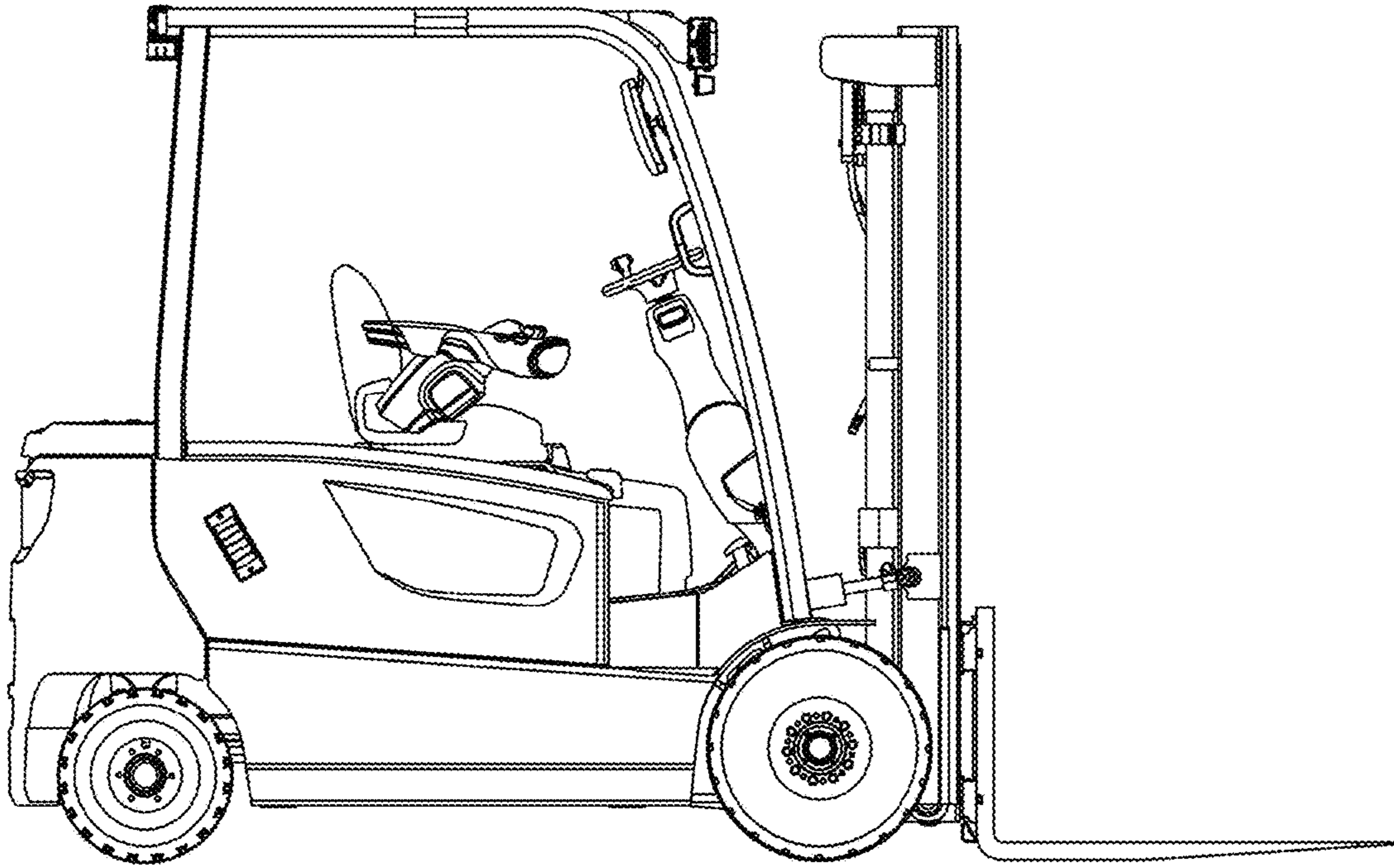

FIG. 5

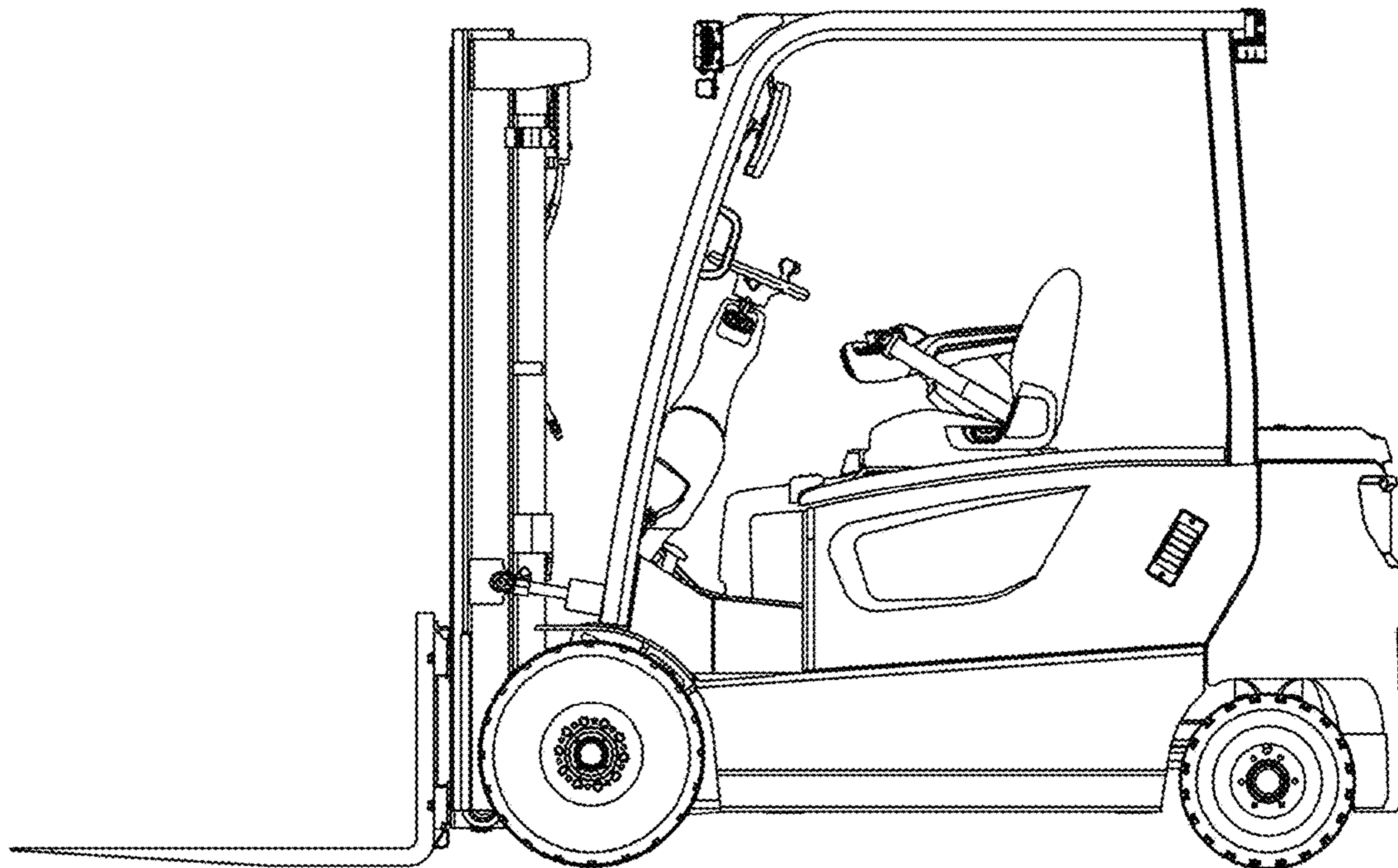

FIG. 6

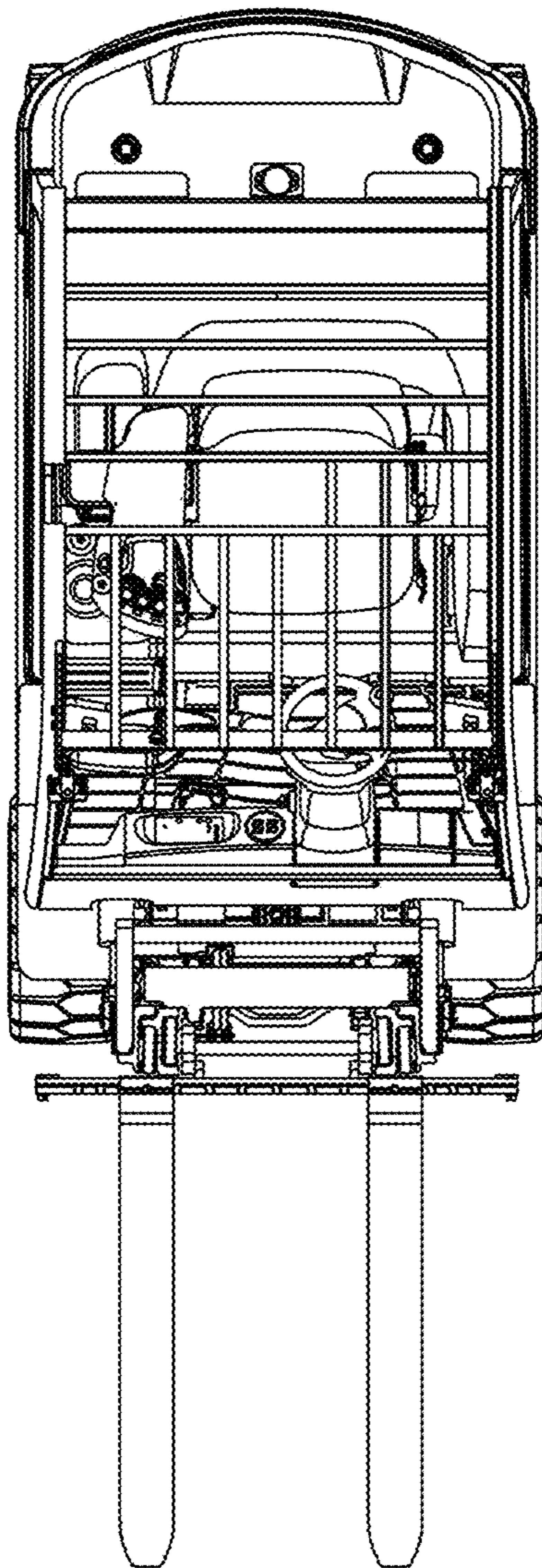

FIG. 7

