



US00D778202S

(12) **United States Design Patent**
Aikin

(10) **Patent No.:** **US D778,202 S**

(45) **Date of Patent:** **** Feb. 7, 2017**

- (54) **CHRISTMAS TREE**
- (71) Applicant: **Stephen Marshall Aikin**, West Valley City, UT (US)
- (72) Inventor: **Stephen Marshall Aikin**, West Valley City, UT (US)
- (**) Term: **15 Years**
- (21) Appl. No.: **29/546,827**
- (22) Filed: **Nov. 25, 2015**
- (51) **LOC (10) Cl.** **11-04**
- (52) **U.S. Cl.**
USPC **D11/118**
- (58) **Field of Classification Search**
USPC D11/117, 118, 121, 125, 130, 131, 132, D11/133, 139, 157
CPC A47G 33/00; A47G 33/04; A47G 33/06; B44C 5/00; B44C 5/06; A41G 1/00; A41G 1/007
See application file for complete search history.

4,196,239 A *	4/1980	Sawyer	A41G 1/00
				156/61
4,315,376 A *	2/1982	Eichenauer	G09F 1/14
				40/124.19
D324,832 S *	3/1992	Boschetto	D11/118
D325,134 S *	4/1992	Bustos	D11/118
D344,248 S *	2/1994	Wiggins	D11/117
D354,928 S *	1/1995	Hoffman	D11/118
D357,432 S *	4/1995	Snodgrass	D11/118
D379,075 S *	5/1997	Edler	D11/118
D379,941 S *	6/1997	Scott	D11/118
D462,031 S *	8/2002	Ng	D11/118
D549,130 S *	8/2007	Steiger	D11/118
D658,092 S *	4/2012	Favretto	D11/118
D763,727 S *	8/2016	Hung	D11/118

* cited by examiner

Primary Examiner — Elizabeth J Oswecki
(74) *Attorney, Agent, or Firm* — Dunlap Bennett & Ludwig PLLC

(57) **CLAIM**

The ornamental design for an ornamental Christmas tree, as shown and described.

DESCRIPTION

FIG. 1 is a front perspective view of an ornamental Christmas tree, showing my new design;
FIG. 2 is a front elevation view thereof; the rear elevation view being a mirror image thereof;
FIG. 3 is a right elevation view thereof, the left elevation view being a mirror image thereof;
FIG. 4 is a top plan view thereof; and,
FIG. 5 is a bottom plan view thereof.
The broken lines shown in the drawings depict portions of the ornamental Christmas tree that form no part of the claimed design.

1 Claim, 4 Drawing Sheets

(56) **References Cited**

U.S. PATENT DOCUMENTS

D43,757 S *	4/1913	Chase	D11/118
D65,109 S *	7/1924	Dieperink	D11/118
D93,006 S *	8/1934	Dunkelberger	D11/118
D97,288 S *	10/1935	Hollem	D11/118
2,129,563 A *	9/1938	Bublitz	A47G 33/06
				362/123
D157,082 S *	1/1950	Patton	211/50
D166,135 S *	3/1952	Stark	D11/118
2,916,843 A *	12/1959	Meyer	A47G 33/06
				40/124.4
3,797,149 A *	3/1974	Morrison	G09F 1/14
				40/124.2
D252,577 S *	8/1979	Leopoldi	401/131

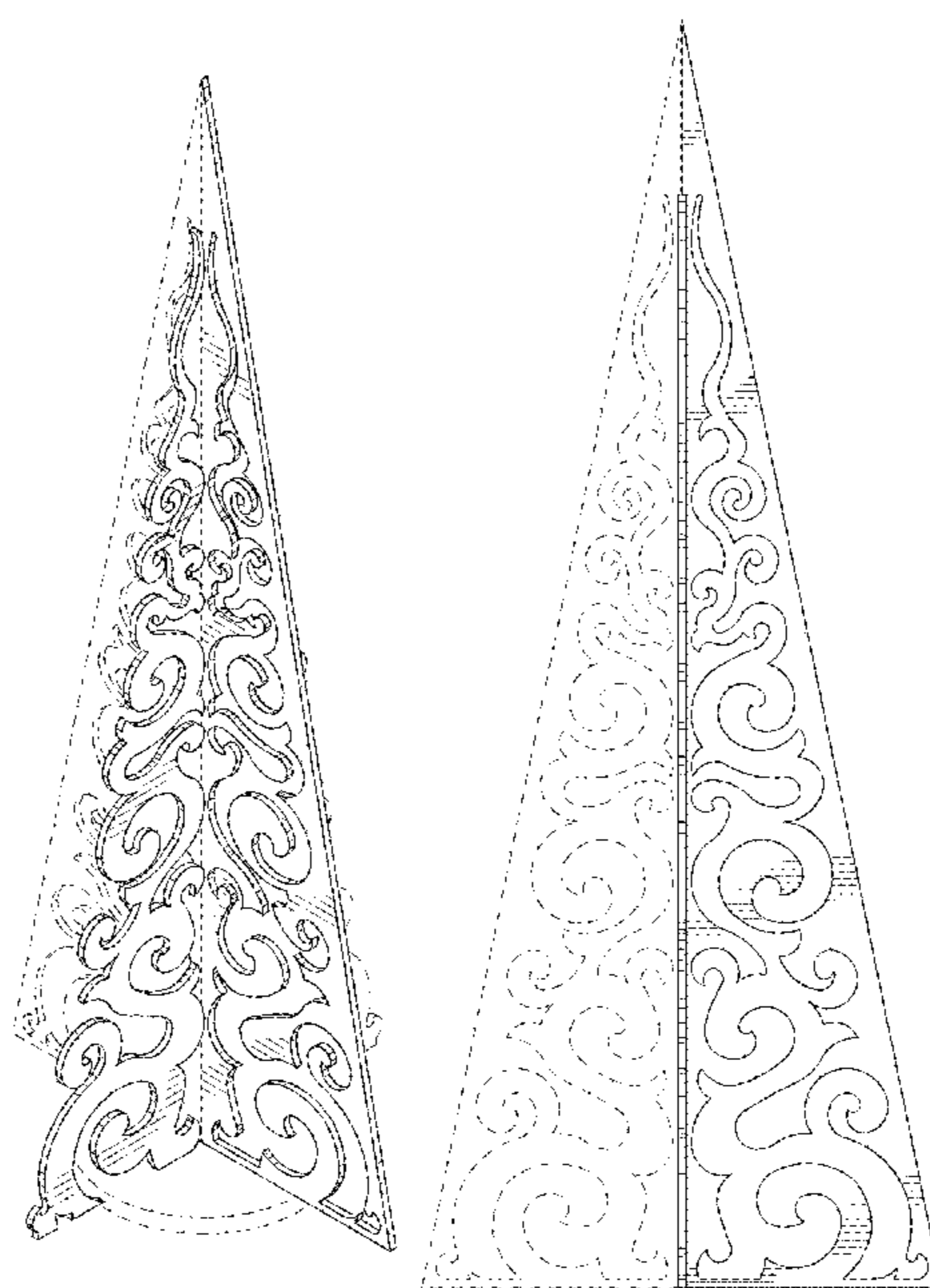

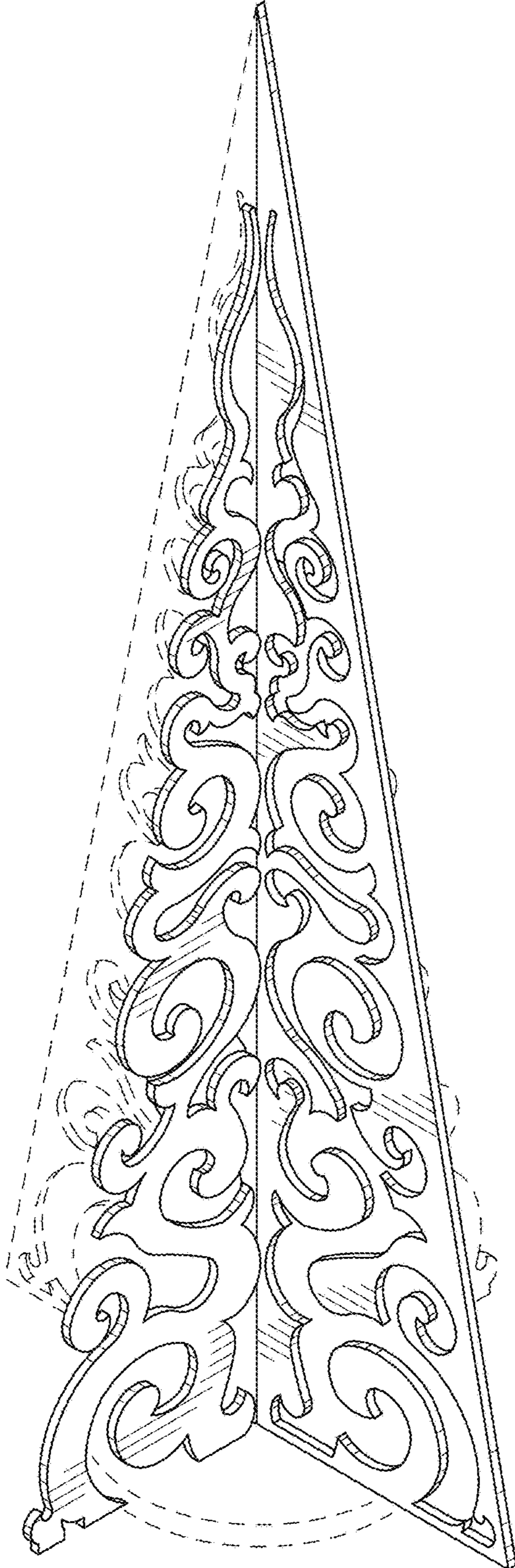

FIG. 1

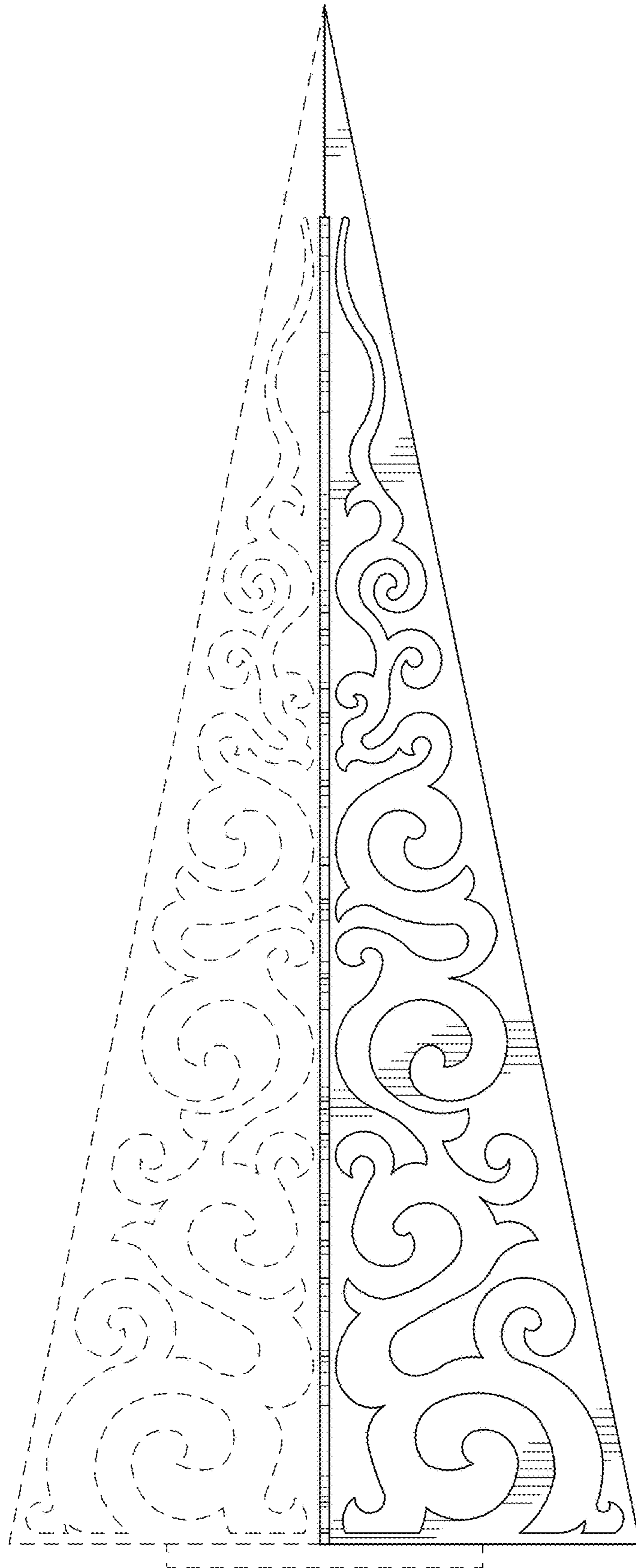

FIG. 2

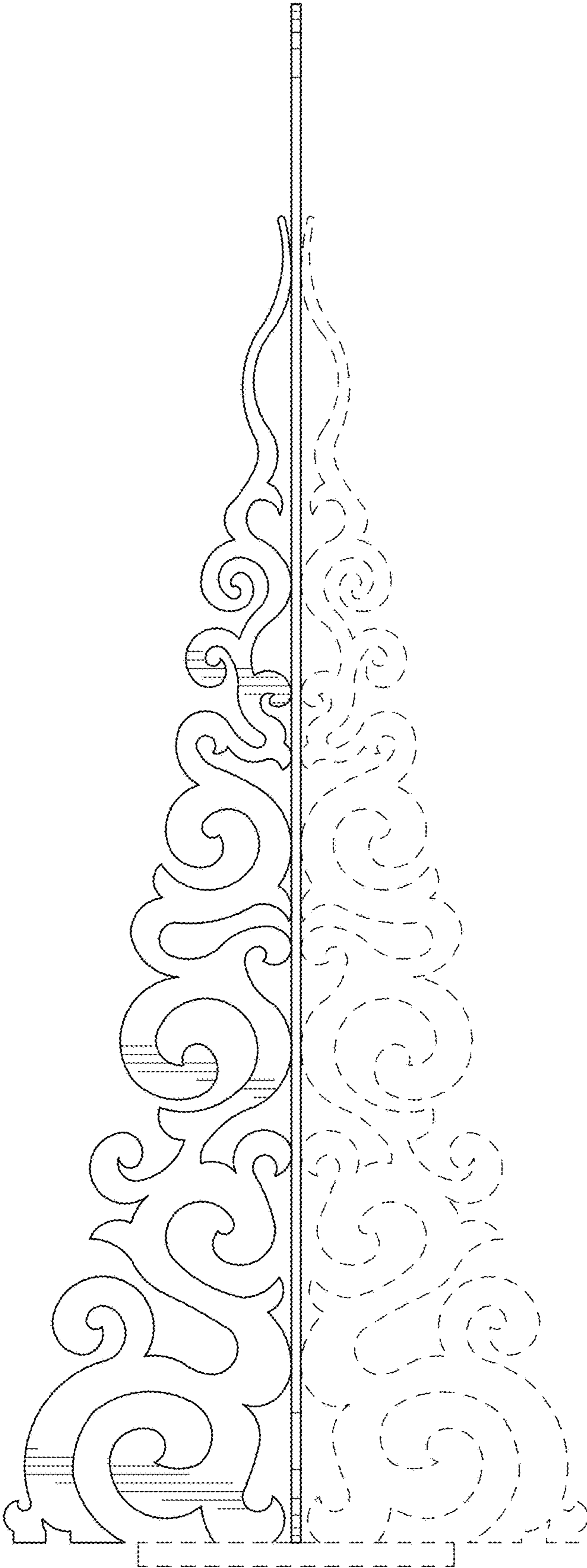

FIG.3

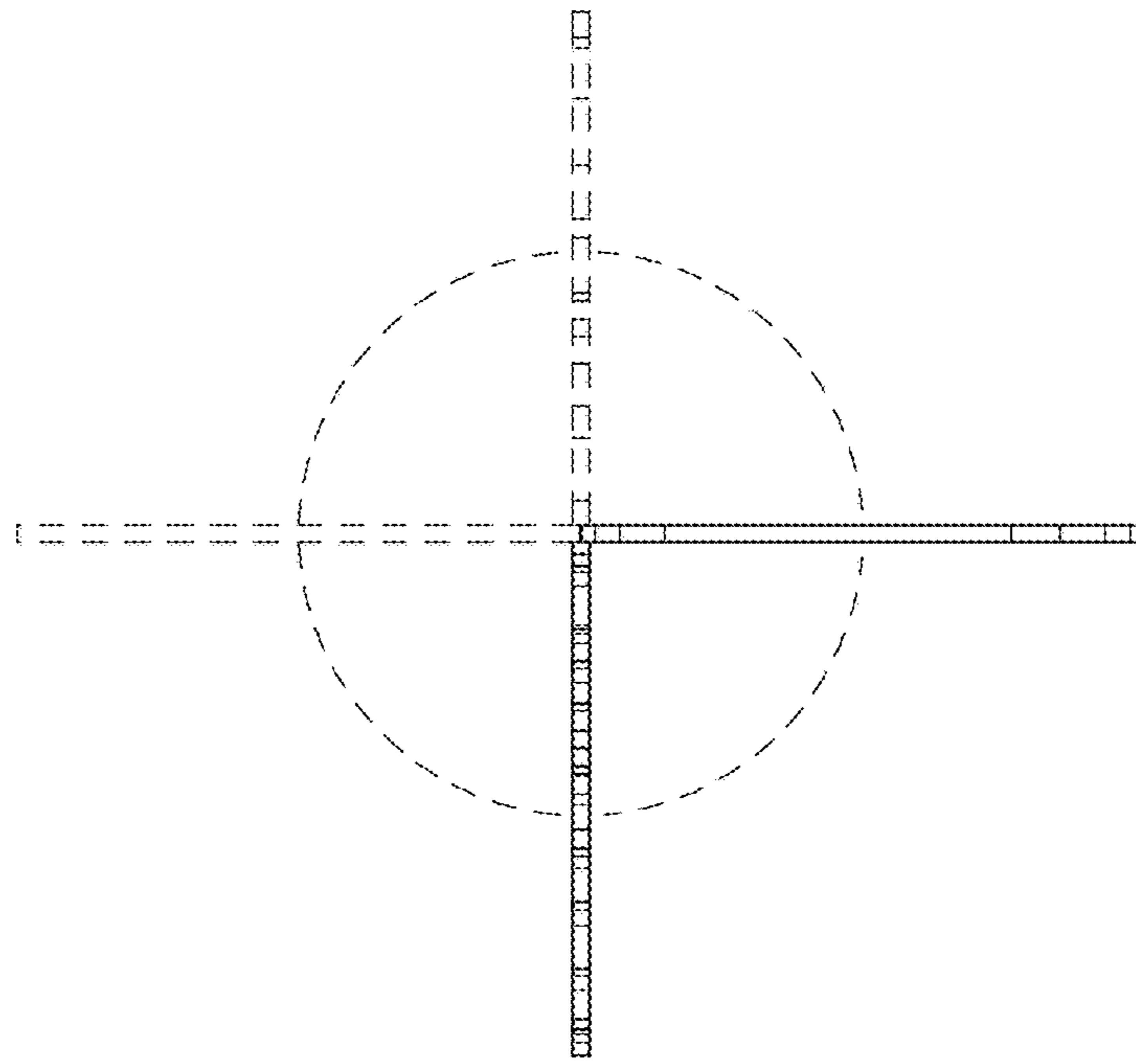

FIG. 4

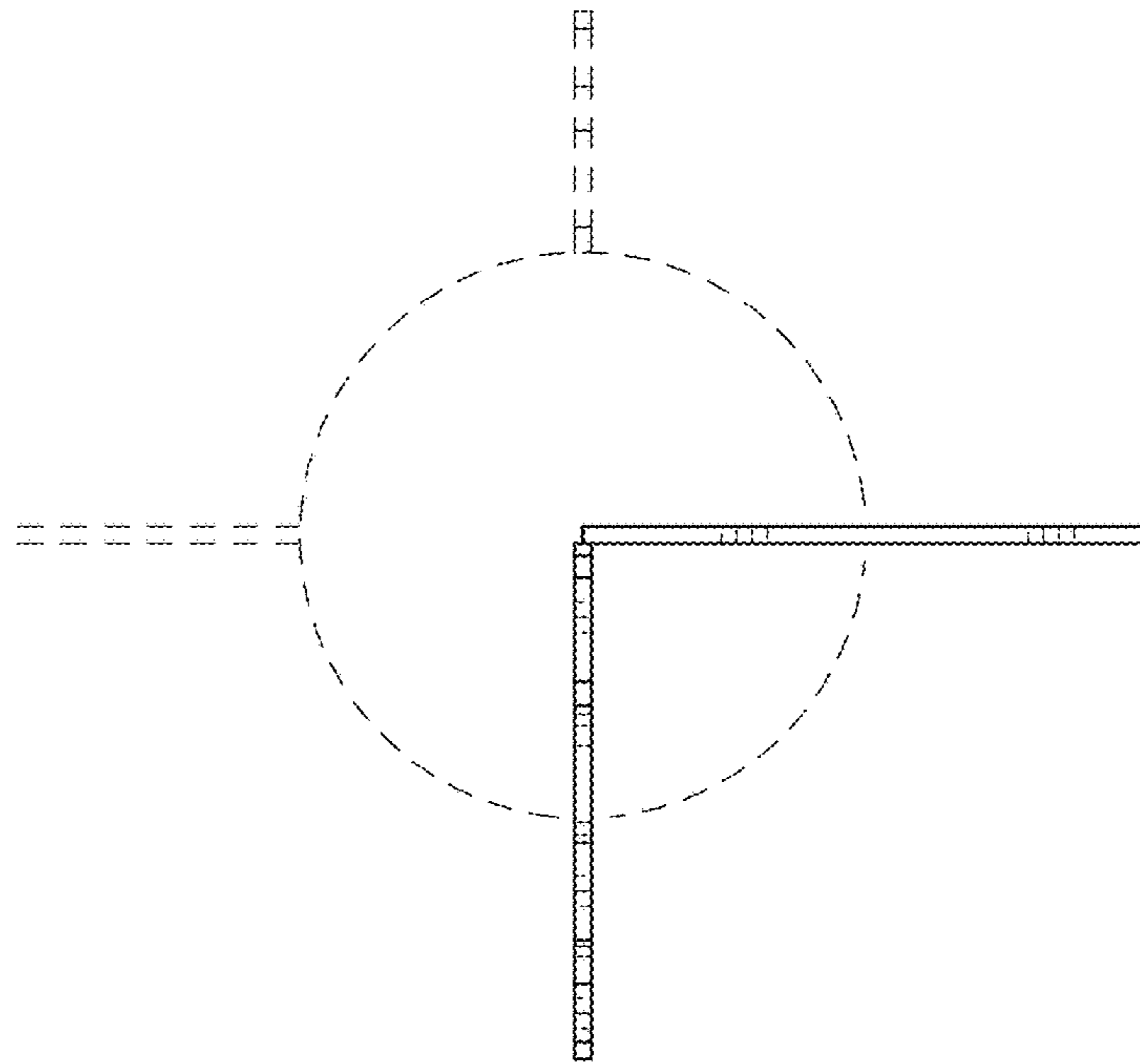

FIG. 5