



US00D777815S

(12) **United States Design Patent**
Ebner

(10) **Patent No.:** **US D777,815 S**

(45) **Date of Patent:** **** Jan. 31, 2017**

(54) **GEARBOX**

(71) Applicant: **Wittenstein AG**, Igersheim (DE)

(72) Inventor: **Siegfried Ebner**, Zell am See (AT)

(73) Assignee: **Wittenstein SE**, Igersheim (DE)

(**) Term: **14 Years**

(21) Appl. No.: **29/502,920**

(22) Filed: **Sep. 22, 2014**

(30) **Foreign Application Priority Data**

Jun. 30, 2014 (EP) 002493221

(51) **LOC (10) Cl.** **15-09**

(52) **U.S. Cl.**
USPC **D15/148**

(58) **Field of Classification Search**

USPC D15/148, 149, 5; D12/122-127, 180;
192/223.2, 38; 475/331; 92/71; 74/640
CPC F16D 41/105; F16D 41/061-41/064;
F16D 41/067; F16D 41/07; F16D 41/066;
F16H 1/28; F16H 1/46; F16H
57/029; F16H 57/033; F16H
57/0482; F16H 57/082; F16H 49/001
See application file for complete search history.

(56) **References Cited**

U.S. PATENT DOCUMENTS

D479,541 S * 9/2003 Lannoch D15/148
D479,542 S * 9/2003 Lannoch D15/148
D497,374 S * 10/2004 Wittenstein D15/148
D514,607 S * 2/2006 Wittenstein D15/148
D529,939 S * 10/2006 Wilhelm D15/148

D543,565 S * 5/2007 Kopecki D15/149
D618,263 S * 6/2010 Siegfried D15/148
D683,775 S * 6/2013 Farrenkopf D15/148
D703,253 S * 4/2014 Lannoch D15/148
D704,756 S * 5/2014 Voelker D15/148
8,950,565 B2 * 2/2015 Adams F16D 41/105
192/223.2
2004/0166986 A1 * 8/2004 Bayer F16H 1/28
475/331
2006/0096412 A1 * 5/2006 Wittenstein F16H 1/28
74/606 R

* cited by examiner

Primary Examiner — Susan Bennett Hattan

Assistant Examiner — Brett Miller

(74) *Attorney, Agent, or Firm* — Bachman & LaPointe,
PC

(57) **CLAIM**

The ornamental design of gearbox, as shown.

DESCRIPTION

FIG. 1 is a perspective view showing the ornamental design of a first embodiment of a gearbox in accordance with the present invention;

FIG. 2 is a side view of the embodiment of FIG. 1;

FIG. 3 is a front view of the embodiment of FIG. 1;

FIG. 4 is a back view of the embodiment of FIG. 1;

FIG. 5 is a perspective view showing the ornamental design of a second embodiment of a gearbox in accordance with the present invention;

FIG. 6 is a side view of the embodiment of FIG. 5;

FIG. 7 is a front view of the embodiment of FIG. 5; and,

FIG. 8 is a back view of the embodiment of FIG. 5.

The broken lines depict portions of the gearbox that form no part of the claim.

1 Claim, 8 Drawing Sheets

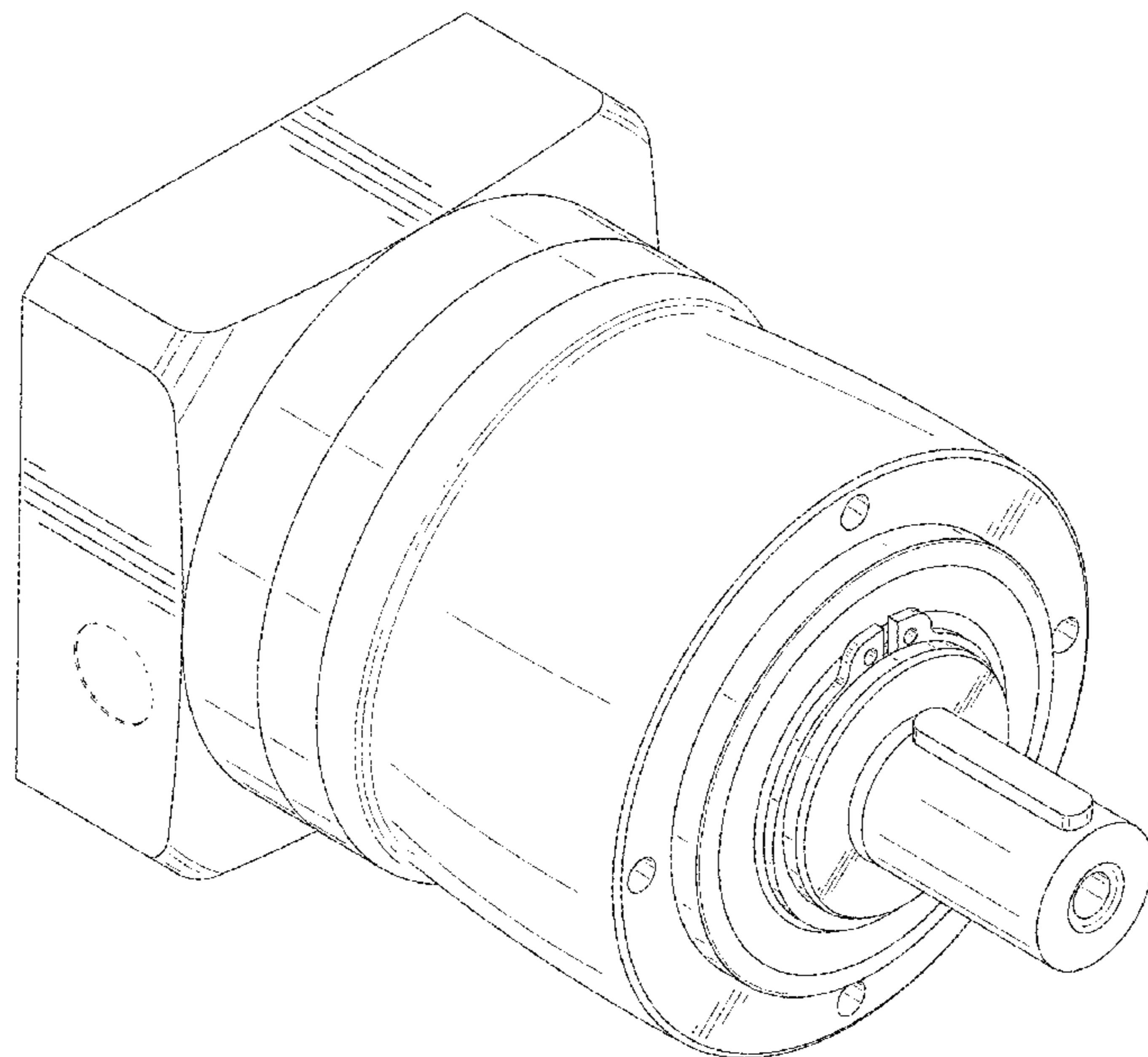

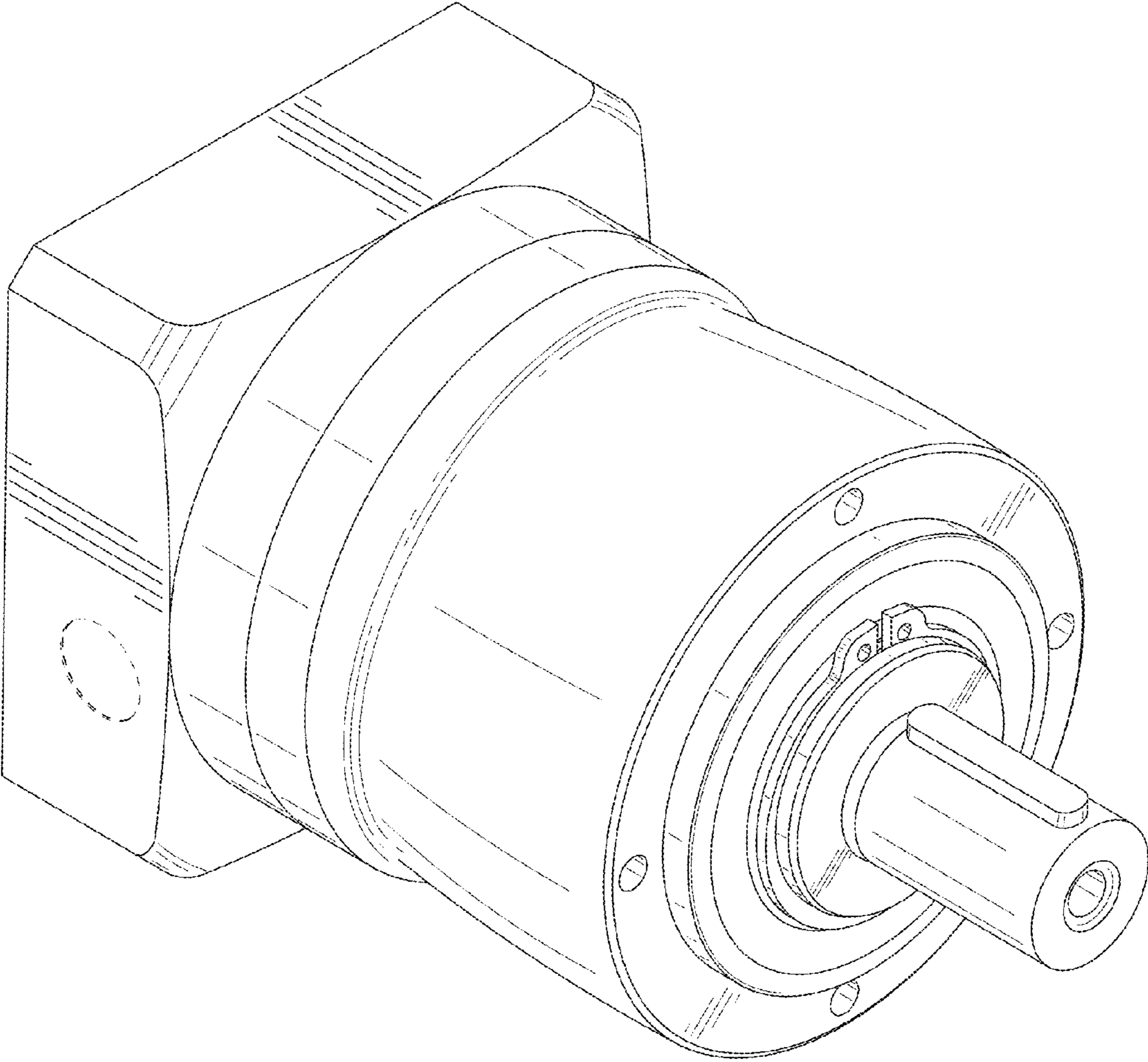

FIG. 1

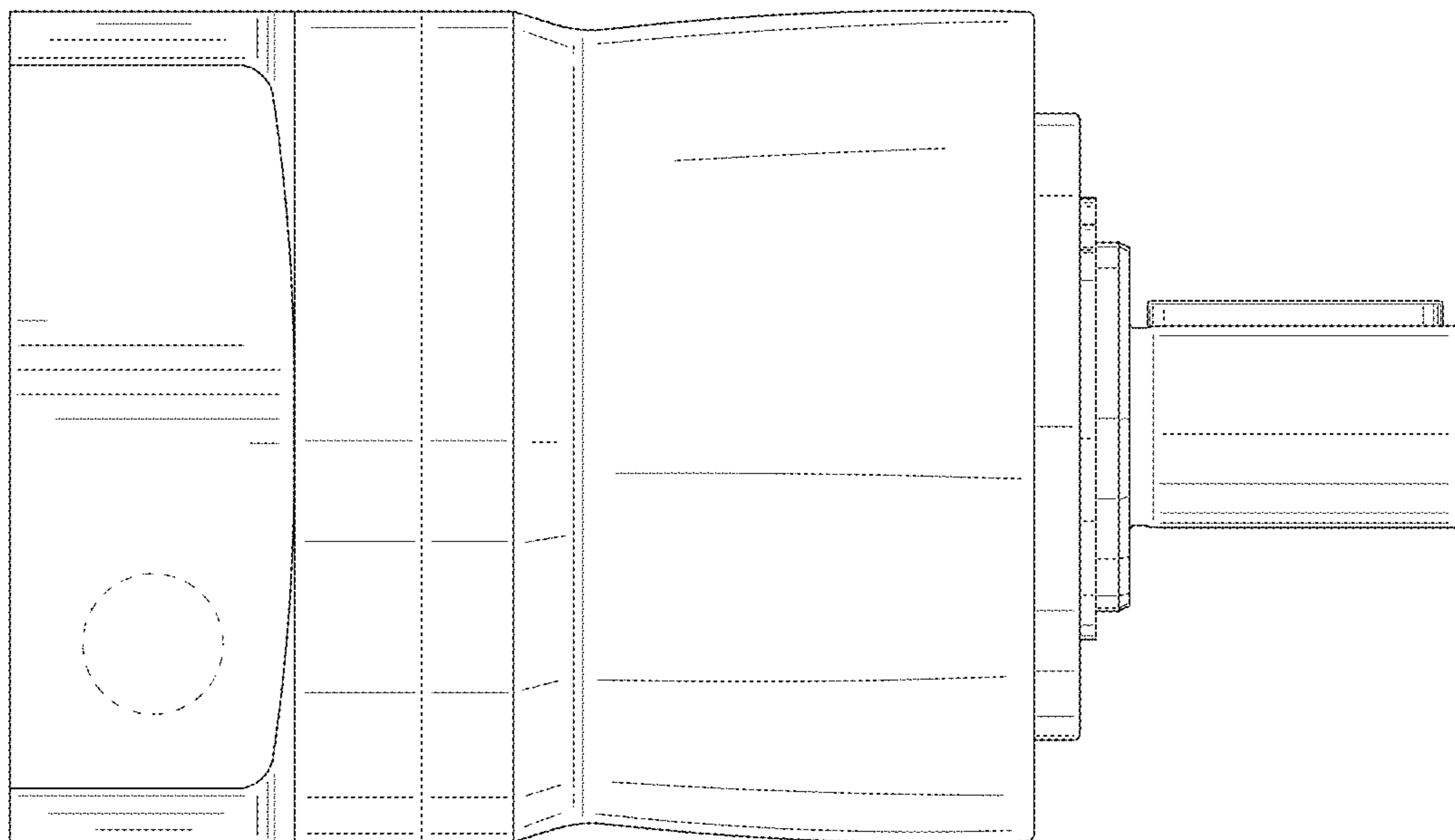

FIG. 2

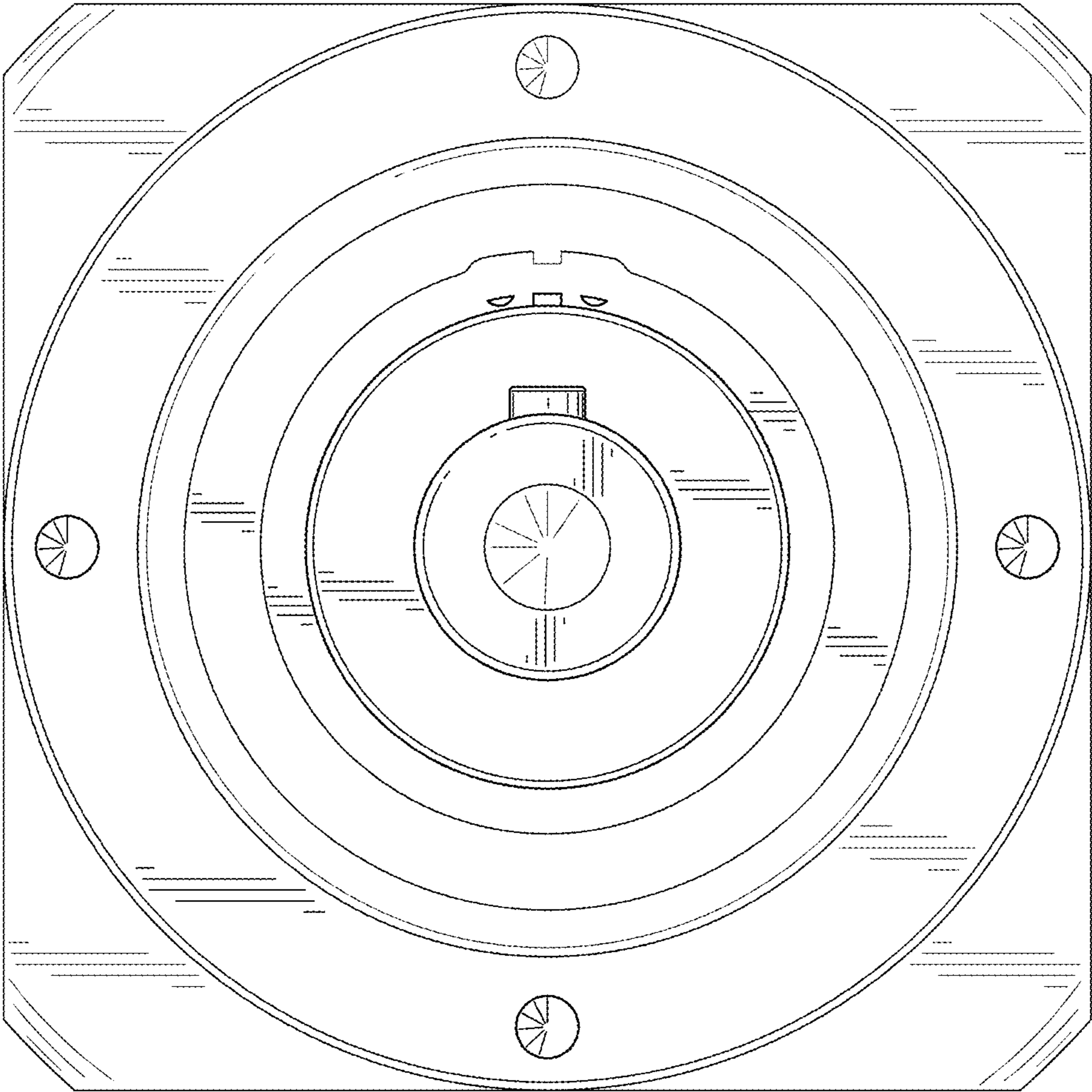

FIG. 3

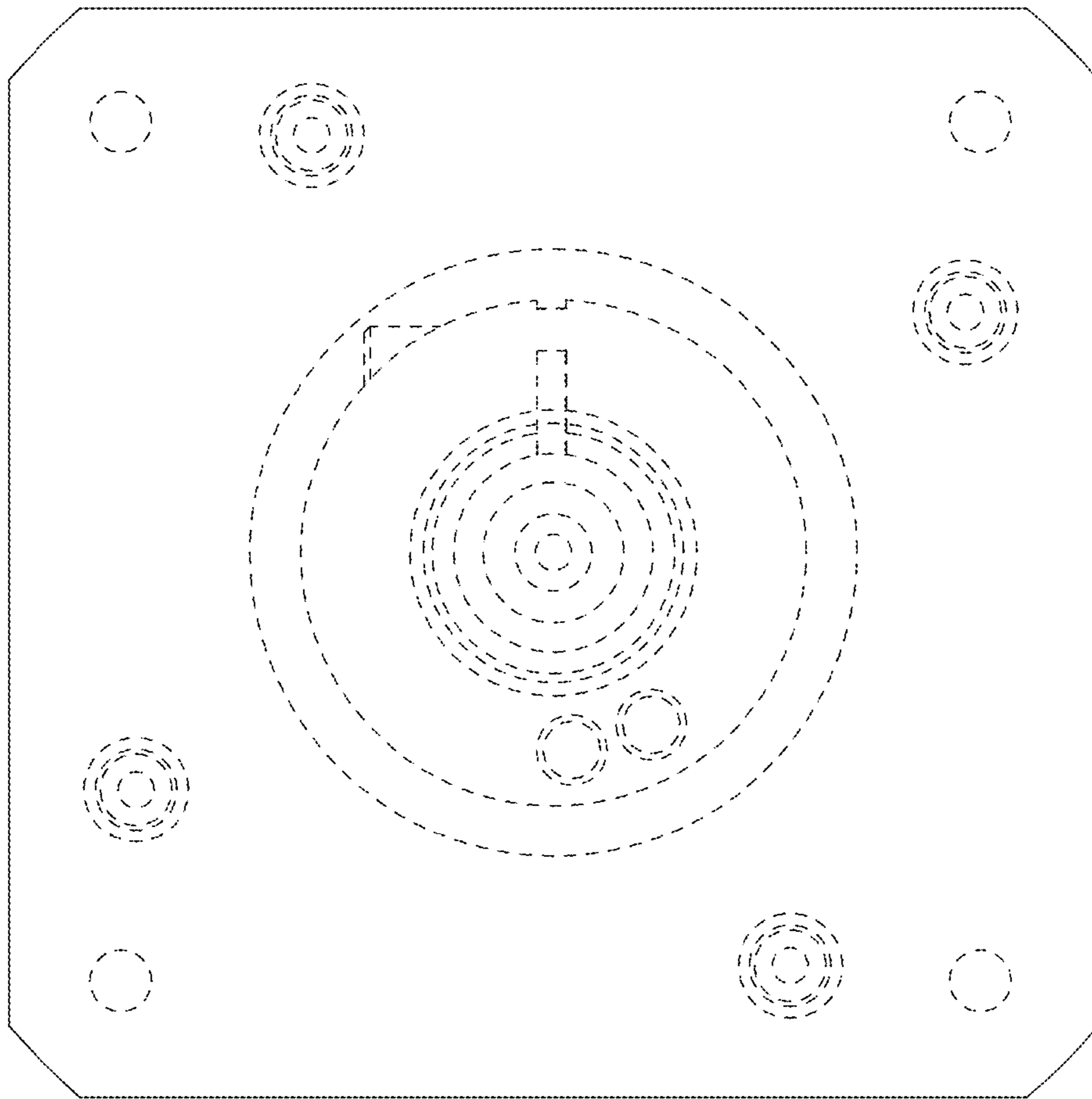

FIG. 4

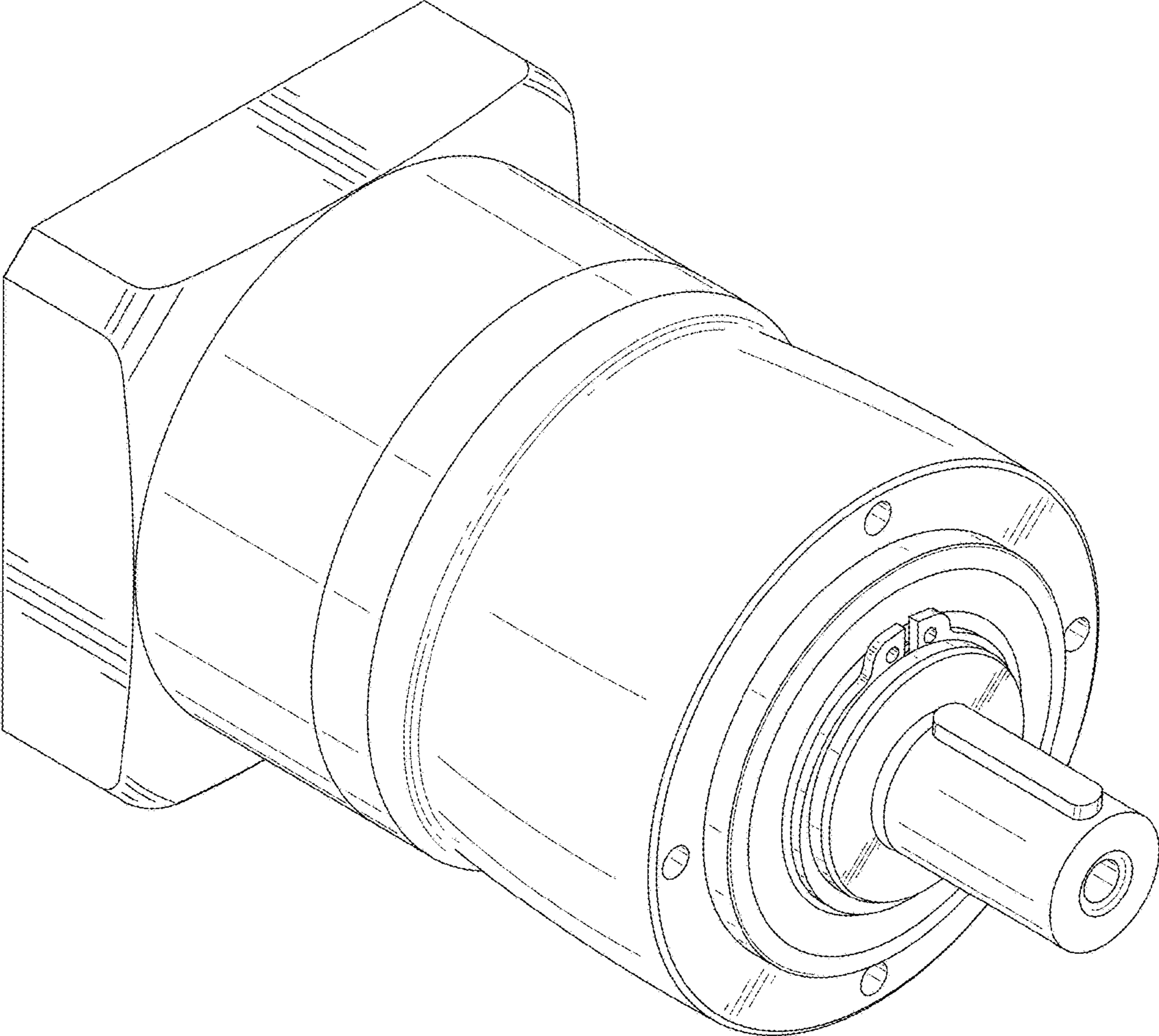

FIG. 5

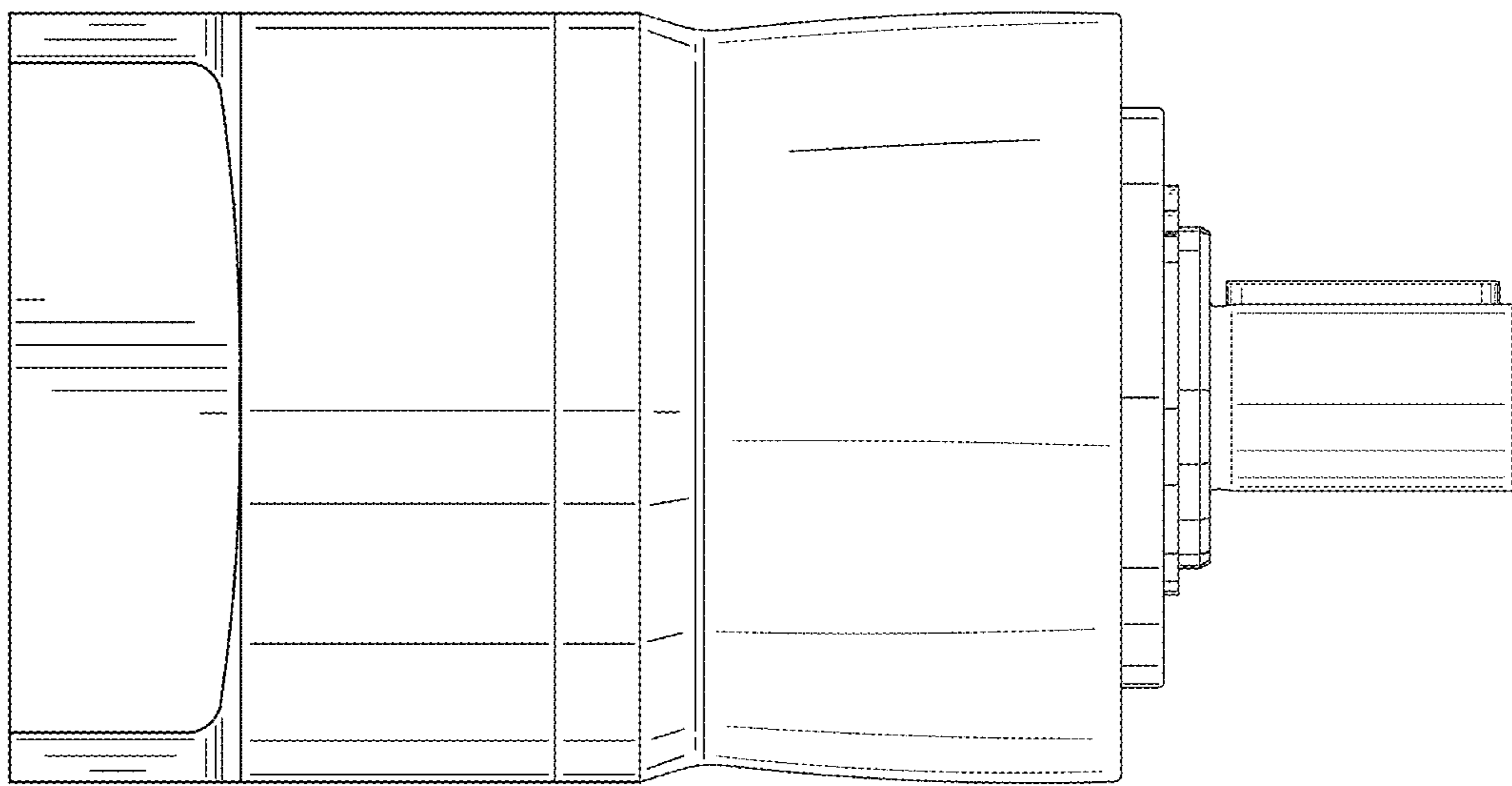

FIG. 6

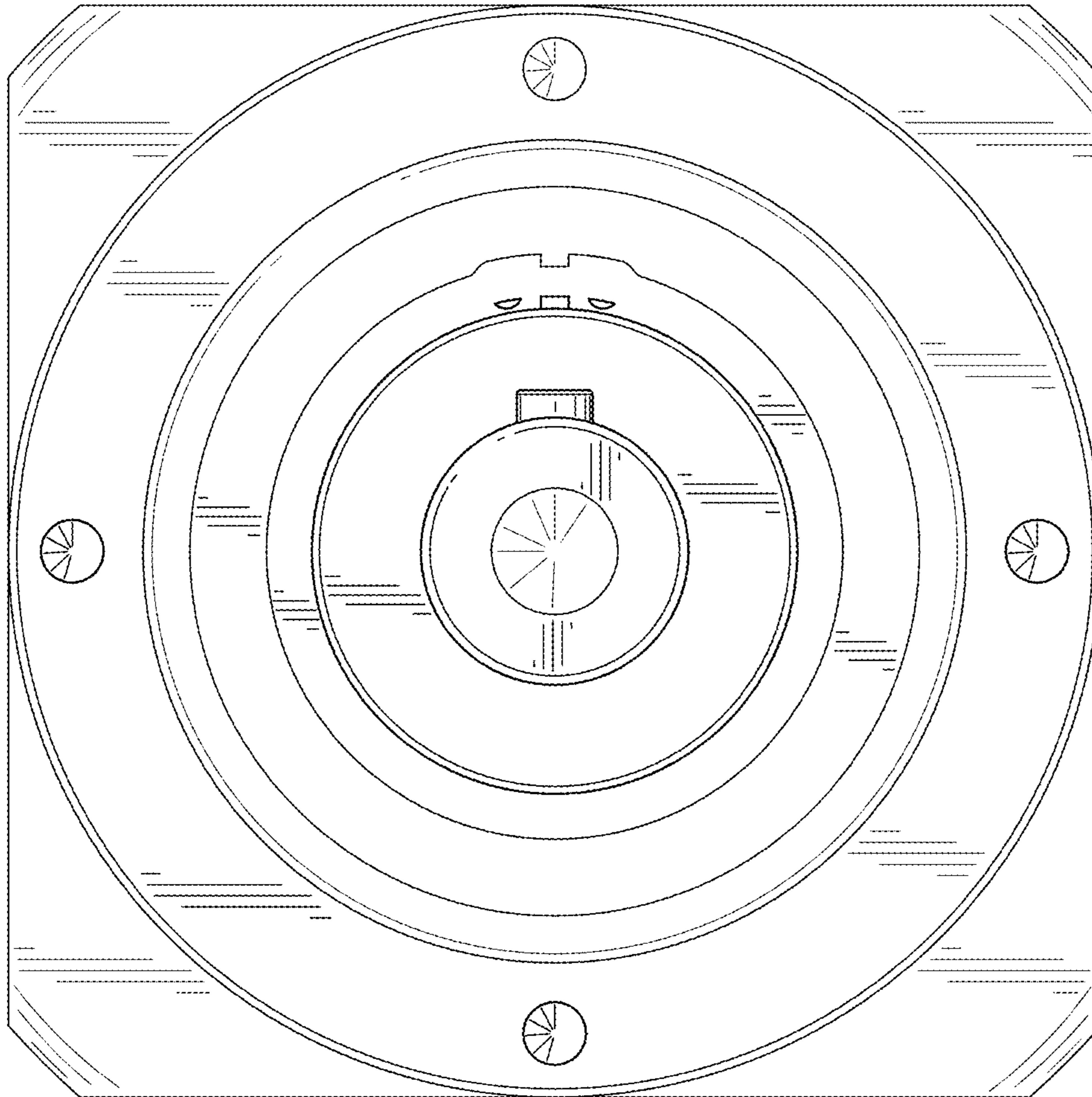

FIG. 7

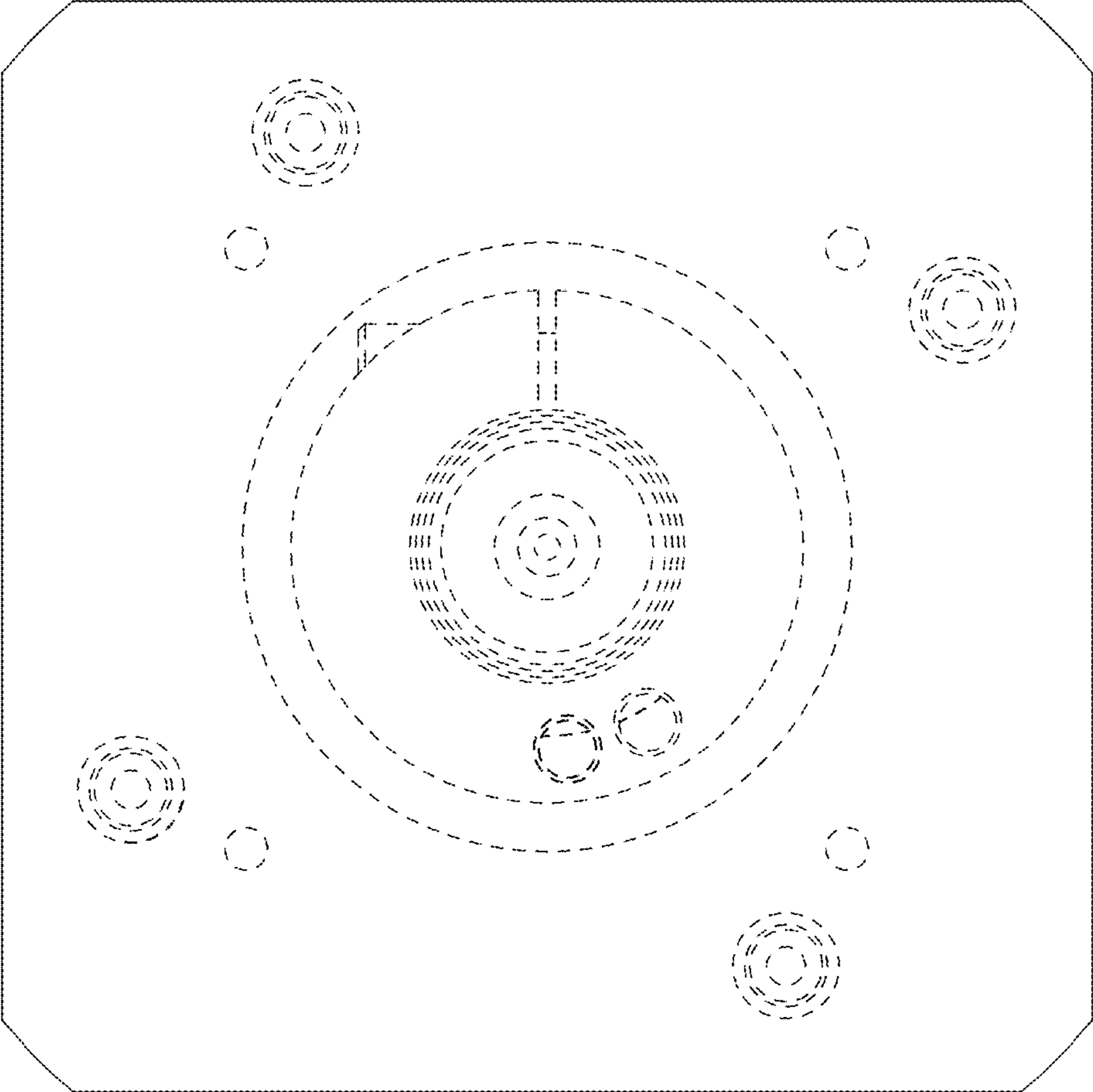

FIG. 8