



US00D776721S

(12) **United States Design Patent**  
**Martin et al.**

(10) **Patent No.:** **US D776,721 S**  
(45) **Date of Patent:** **\*\* Jan. 17, 2017**

(54) **SNOWTHROWER CHUTE CONTROL**

(71) Applicant: **THE TORO COMPANY**,  
Bloomington, MN (US)

(72) Inventors: **David J. Martin**, Eden Prairie, MN  
(US); **Philip C. Dretzka**, Woodbury,  
MN (US); **Kevin D. Docken**, Victoria,  
MN (US); **Nathan J. Friberg**,  
Bloomington, MN (US)

(73) Assignee: **The Toro Company**, Bloomington, MN  
(US)

(\*\*) Term: **15 Years**

(21) Appl. No.: **29/541,333**

(22) Filed: **Oct. 2, 2015**

(51) **LOC (10) Cl.** ..... **12-09**

(52) **U.S. Cl.**  
USPC ..... **D15/11**

(58) **Field of Classification Search**  
USPC .. D15/10, 11, 15, 17, 22, 23, 25, 26, 28, 30  
CPC ..... E02F 9/0841; E02F 3/3411; E02F 3/76;  
E02F 3/34; E02F 3/00; E02F 7/00; E02F  
9/16; E02F 9/163; B66C 13/54; B60J  
7/00; B60J 1/004; B62D 33/0617; B62D  
49/00; B62D 49/0815; B62D  
21/186; B62D 53/028; B62D  
33/00; B62D 33/06; B62D 33/0633;  
B62D 25/00

See application file for complete search history.

(56) **References Cited**

**U.S. PATENT DOCUMENTS**

2,688,224 A \* 9/1954 Hainke ..... A01D 34/6806  
180/19.1  
3,363,345 A 1/1968 Ober  
3,468,041 A 9/1969 Mattson et al.

3,913,247 A 10/1975 Ruhl  
4,068,397 A 1/1978 Bacon  
4,203,237 A 5/1980 Enters et al.  
4,294,027 A 10/1981 Edwards  
4,322,896 A 4/1982 Miyazawa et al.  
(Continued)

**OTHER PUBLICATIONS**

U.S. Appl. No. 14/547,740, filed Nov. 19, 2014, Friberg et al.  
(Continued)

*Primary Examiner* — Ian Simmons  
*Assistant Examiner* — Khawaja Anwar  
(74) *Attorney, Agent, or Firm* — Mueting, Raasch &  
Gebhardt, P.A.

(57) **CLAIM**

The ornamental design for a snowthrower chute control, as  
shown and described.

**DESCRIPTION**

FIG. 1 is a left front upper perspective view of a  
snowthrower chute control showing our new design;  
FIG. 2 is an enlarged left front upper perspective view  
thereof;  
FIG. 3 is a right rear perspective view thereof;  
FIG. 4 is a right side elevation view thereof;  
FIG. 5 is a left side elevation view thereof;  
FIG. 6 is a rear elevation view thereof;  
FIG. 7 is a front elevation view thereof;  
FIG. 8 is a top plan view thereof; and,  
FIG. 9 is a bottom plan thereof.

The dash-dash broken lines in the figures depict environ-  
ment (e.g., handle, snowthrower powerhead in FIG. 1) or  
portions of the snowthrower chute control that form no part  
of the claimed design. The dot-dash broken line in FIGS. 7  
and 9 depicts a boundary, the area inside of which forms no  
part of the claimed design.

**1 Claim, 9 Drawing Sheets**

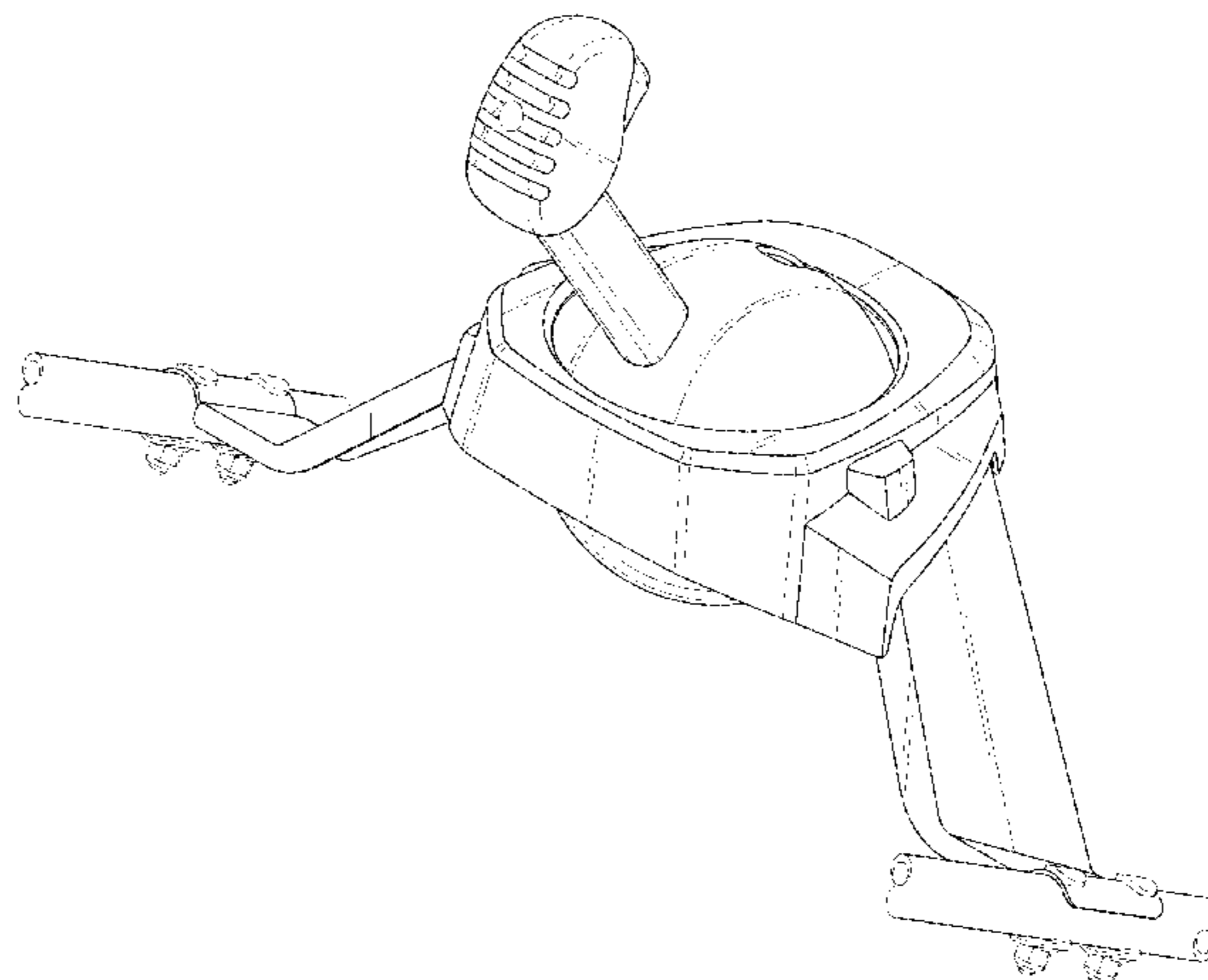
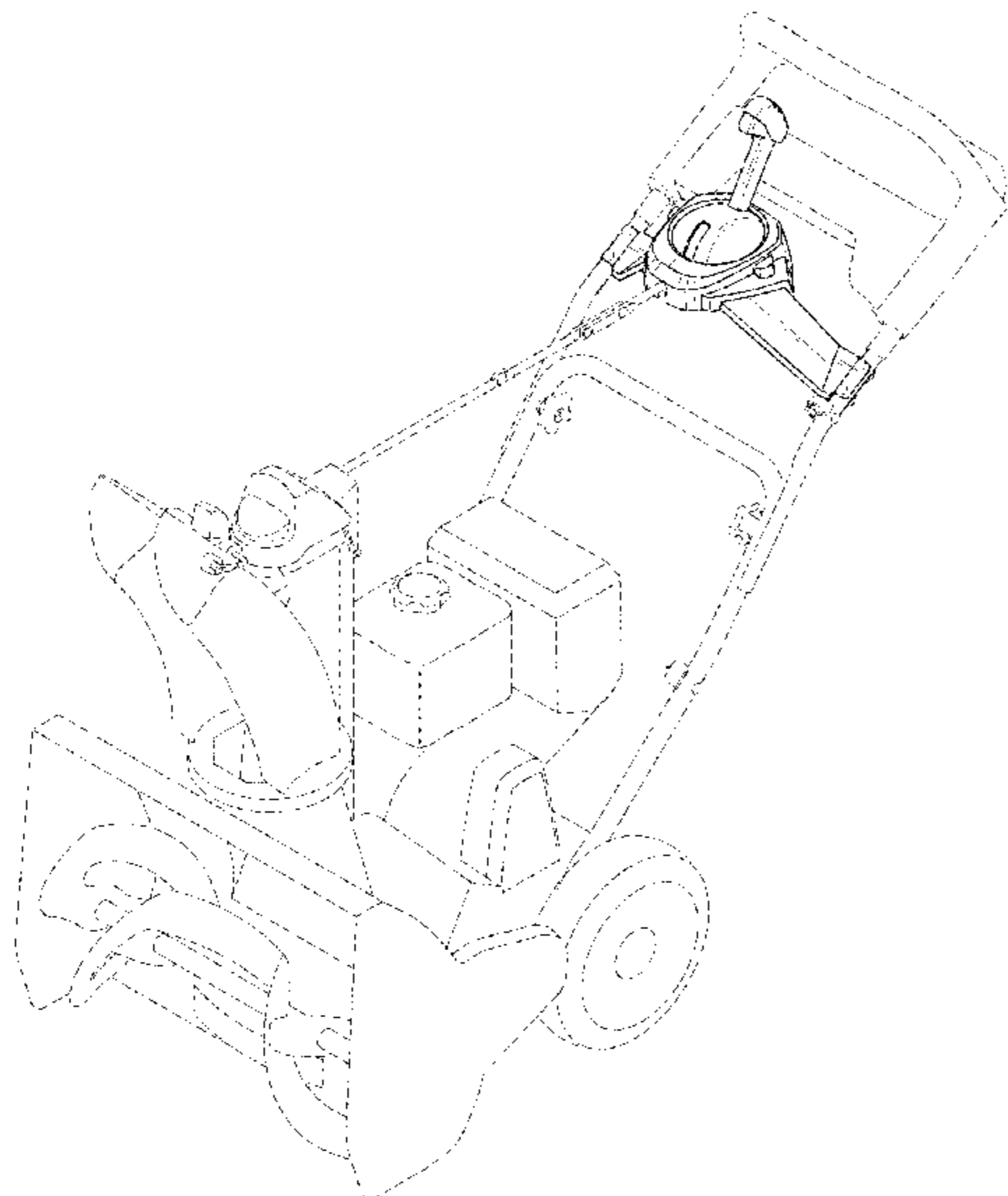

(56)

References Cited

U.S. PATENT DOCUMENTS

D270,057 S 8/1983 Nakamura  
 4,476,643 A 10/1984 Hilchey et al.  
 4,694,594 A 9/1987 Thorud et al.  
 4,862,607 A 9/1989 Wacker  
 D305,125 S 12/1989 Hinklin  
 4,899,471 A 2/1990 Sasaki et al.  
 4,908,968 A 3/1990 Thorud et al.  
 RE33,726 E 10/1991 Thorud et al.  
 D320,993 S 10/1991 Pink et al.  
 5,052,135 A 10/1991 Fontaine  
 5,127,174 A 7/1992 Takeshita  
 5,488,818 A \* 2/1996 Powers ..... A01D 34/6806  
 180/6.48  
 5,511,367 A \* 4/1996 Powers ..... A01D 34/6806  
 180/19.3  
 6,327,798 B1 12/2001 Sakai et al.  
 6,745,548 B1 6/2004 Phillip et al.  
 D494,193 S 8/2004 Martin et al.  
 D494,985 S \* 8/2004 Kim ..... D15/17  
 D498,770 S 11/2004 Yuzuriha  
 7,032,333 B2 4/2006 Friberg et al.

D544,501 S \* 6/2007 Chung Lee ..... D15/14  
 7,305,777 B2 12/2007 Kettering et al.  
 7,401,425 B2 7/2008 Friberg et al.  
 7,624,521 B2 12/2009 White, III et al.  
 D642,595 S \* 8/2011 Martin ..... D15/11  
 8,011,120 B1 9/2011 Hipple  
 D676,876 S \* 2/2013 Martin ..... D15/11  
 D692,027 S \* 10/2013 Martin ..... D15/17  
 D700,629 S 3/2014 Fujiki  
 9,096,980 B2 8/2015 Ricketts  
 9,096,981 B2 8/2015 Wians et al.  
 2003/0159317 A1 8/2003 Dowe et al.  
 2003/0226738 A1 12/2003 Eakins et al.  
 2004/0255492 A1 12/2004 White, III et al.  
 2008/0209771 A1 9/2008 Jerger  
 2014/0157633 A1 6/2014 Hansen et al.

OTHER PUBLICATIONS

U.S. Appl. No. 14/547,812, filed Nov. 19, 2014, Friberg.  
 U.S. Appl. No. 14/547,653, filed Nov. 19, 2014, Duchscherer et al.  
 U.S. Appl. No. 29/539,493, filed Sep. 15, 2015, Dretzka et al.  
 U.S. Appl. No. 29/539,495, filed Sep. 15, 2015, Martin et al.

\* cited by examiner

*Fig. 1*

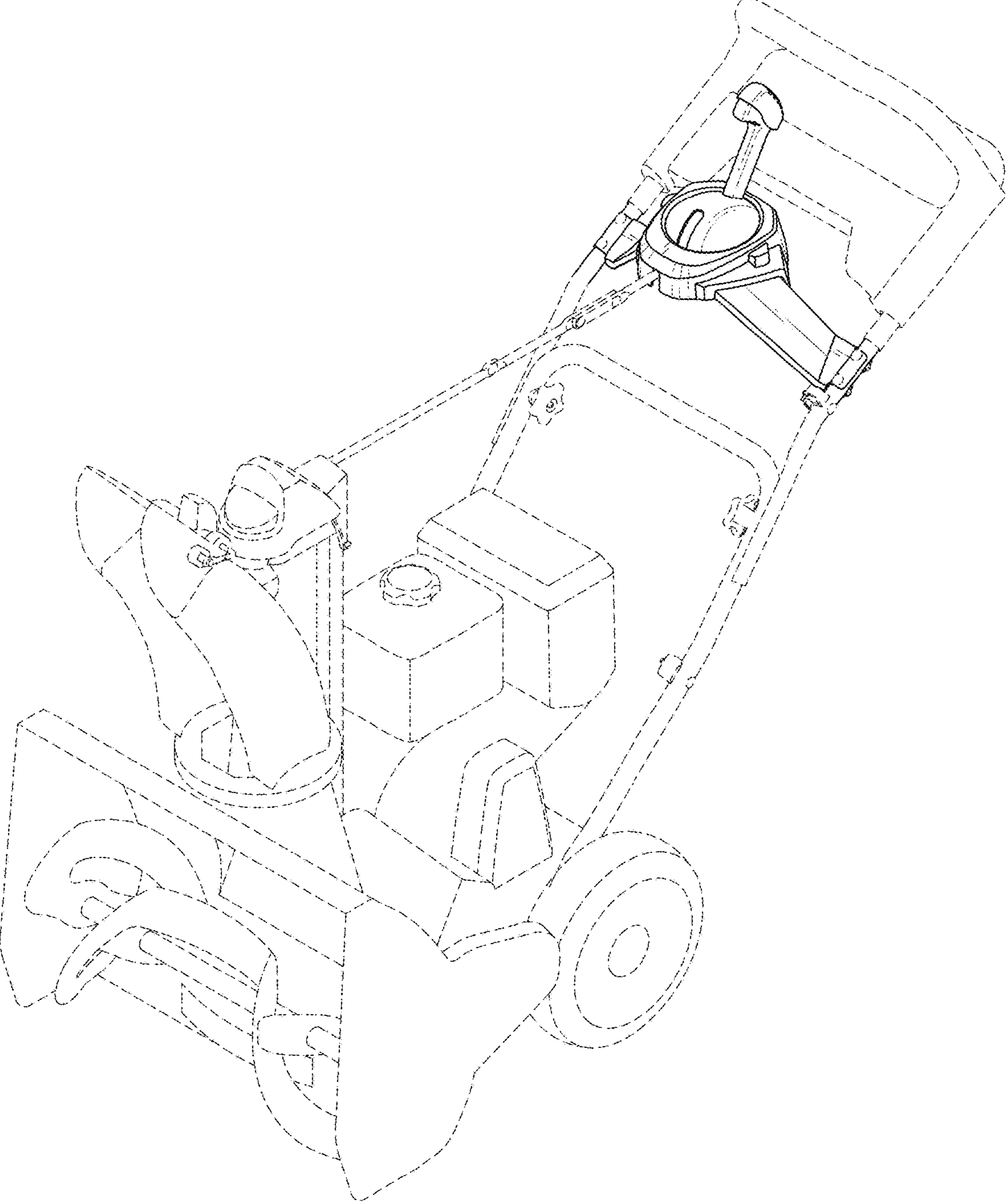

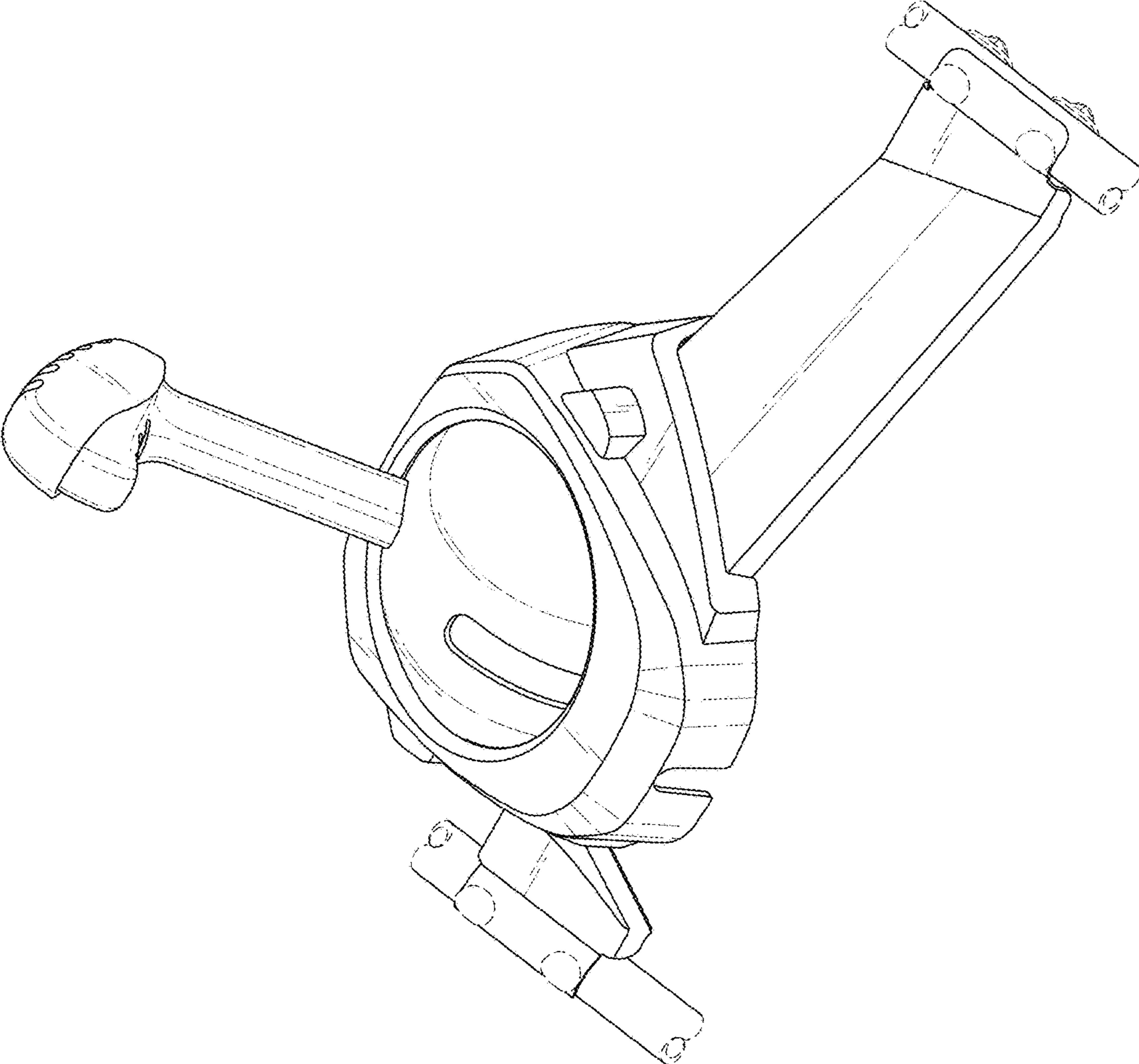

*Fig. 2*

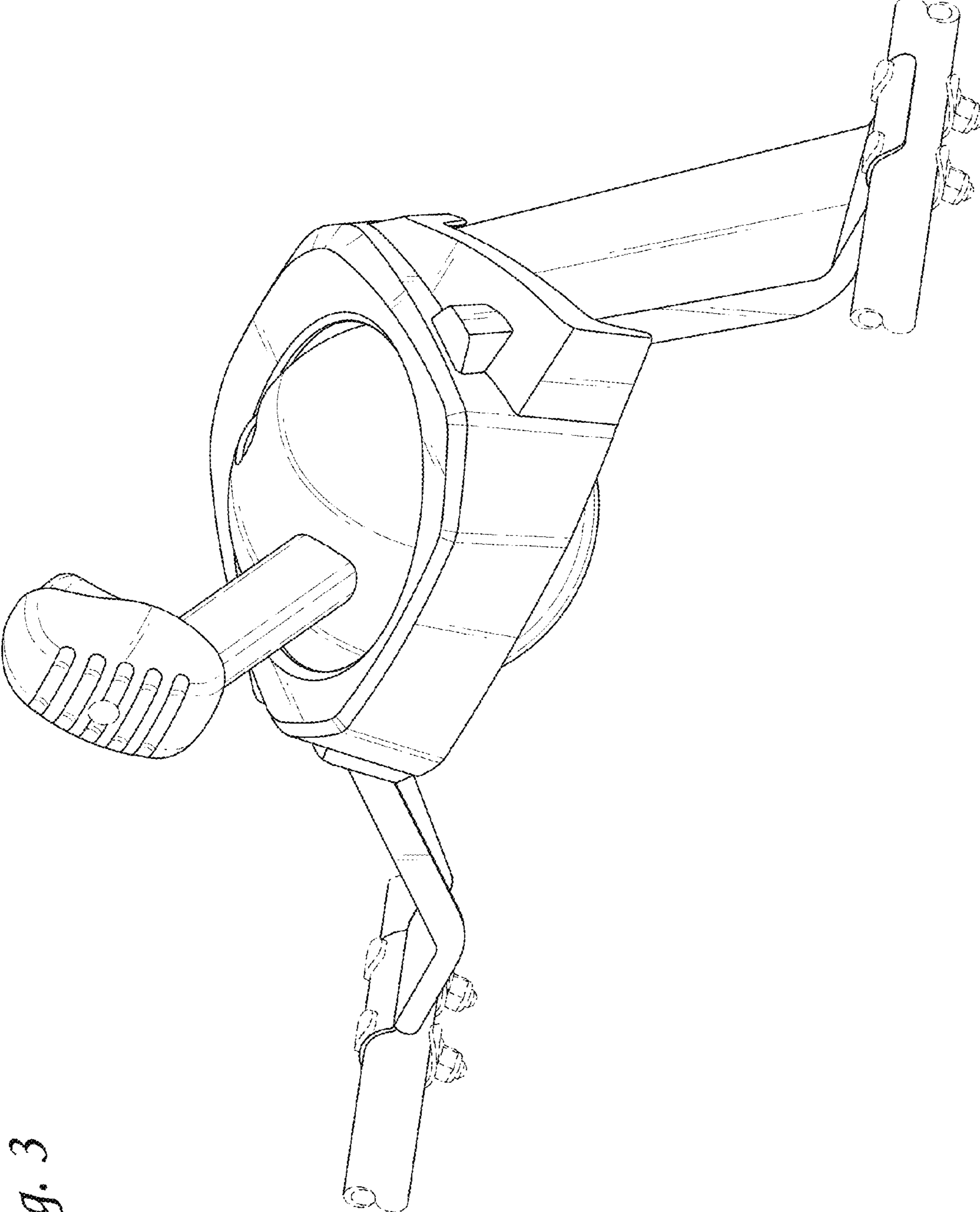

*Fig. 3*

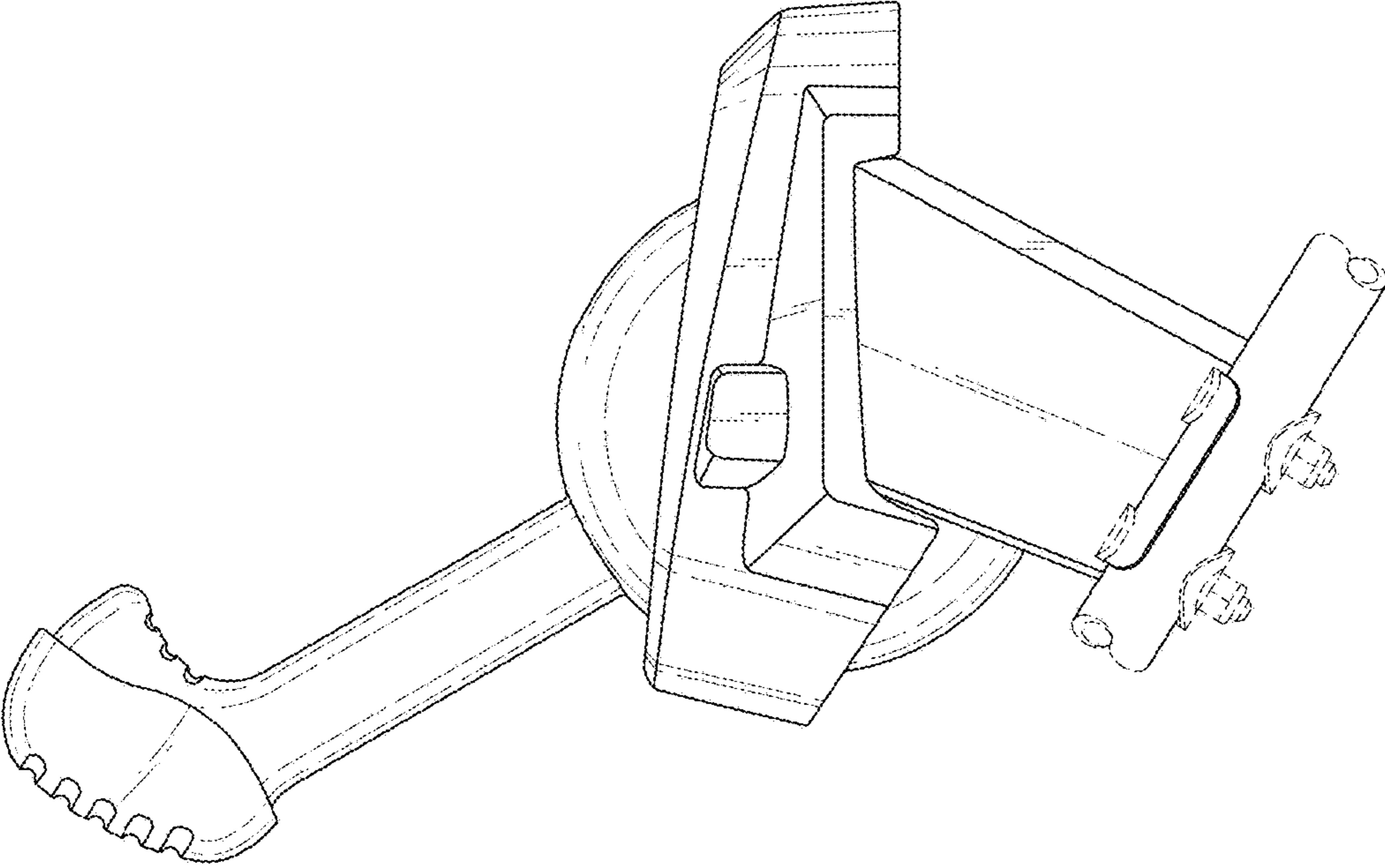
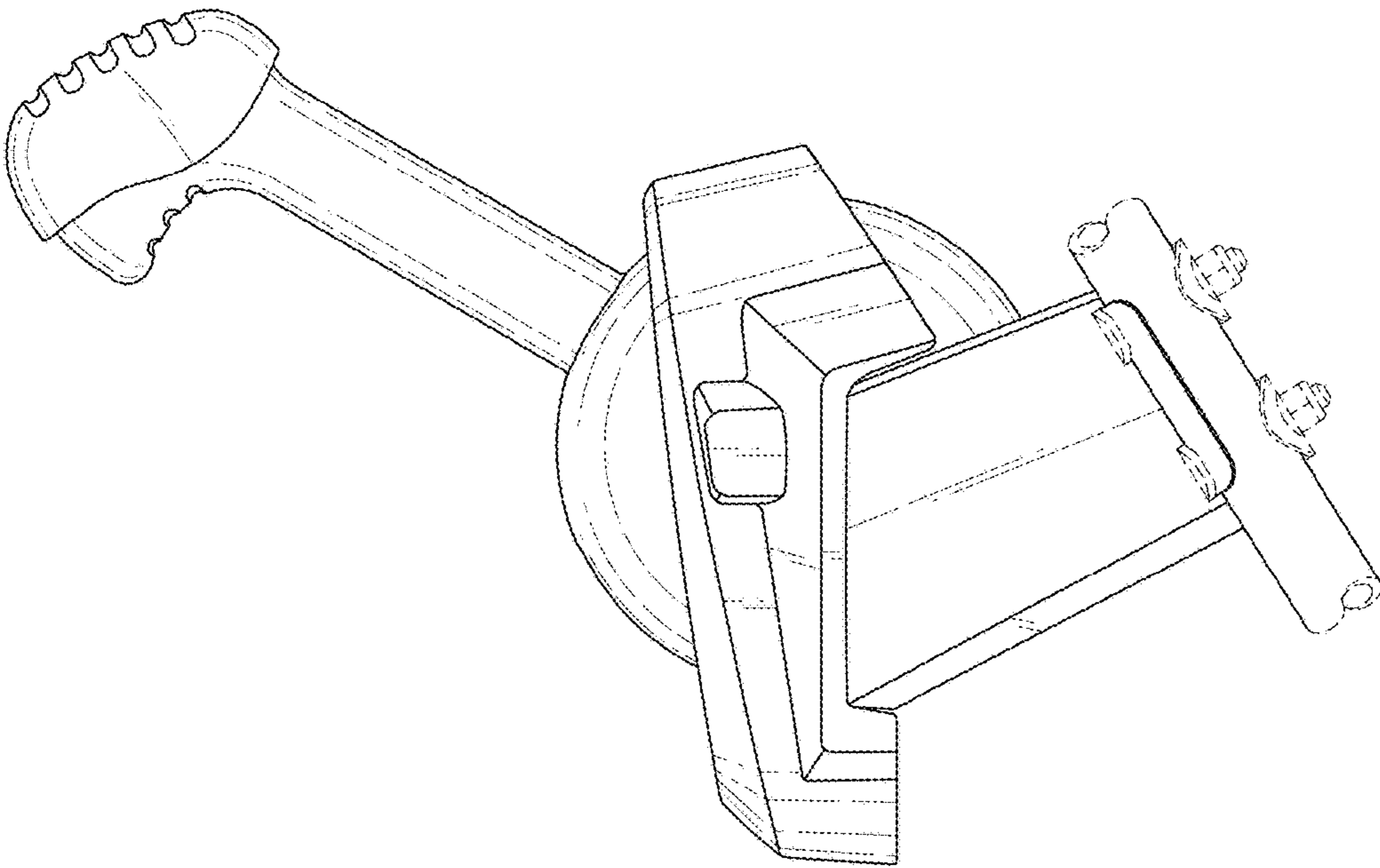
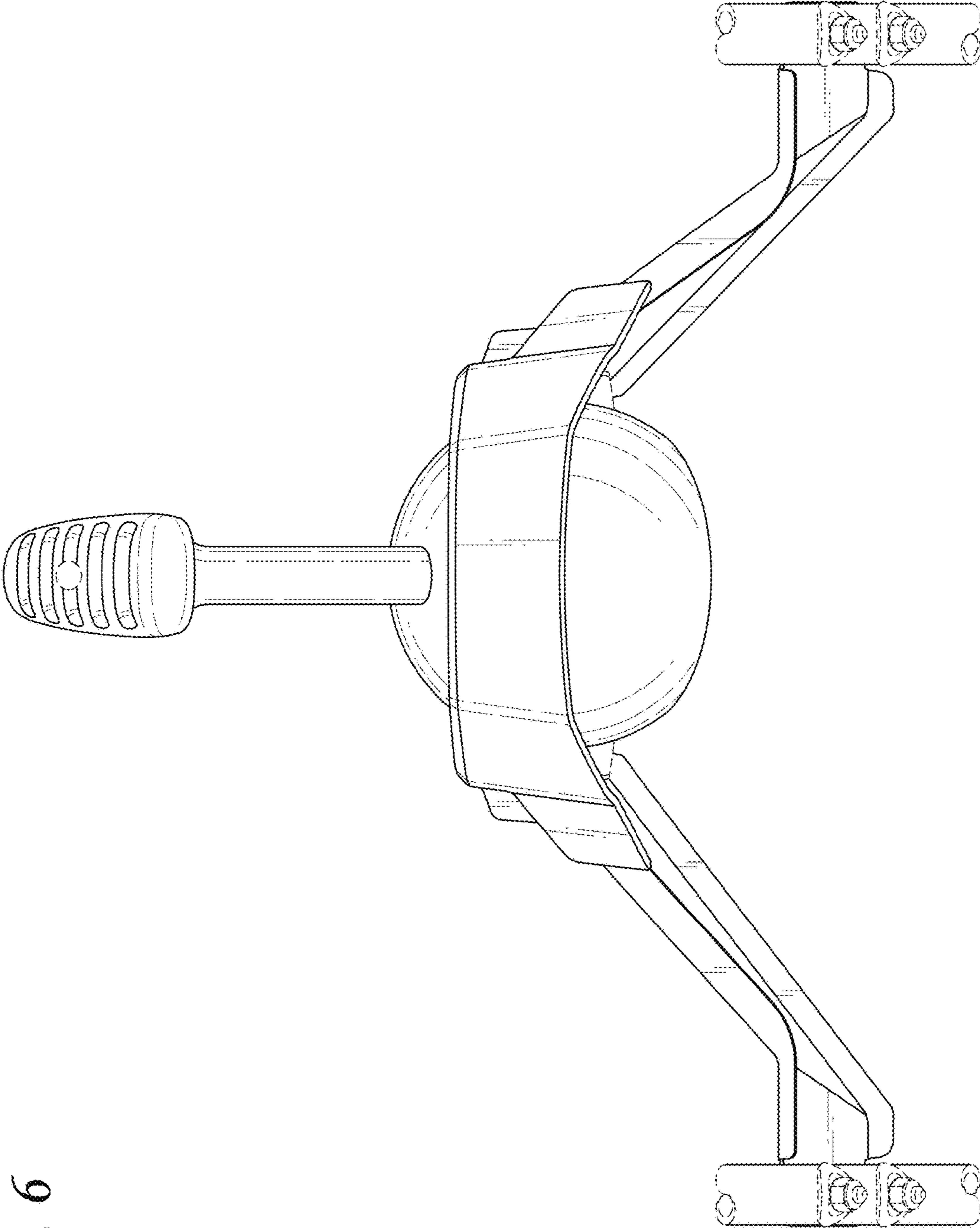

Fig. 4

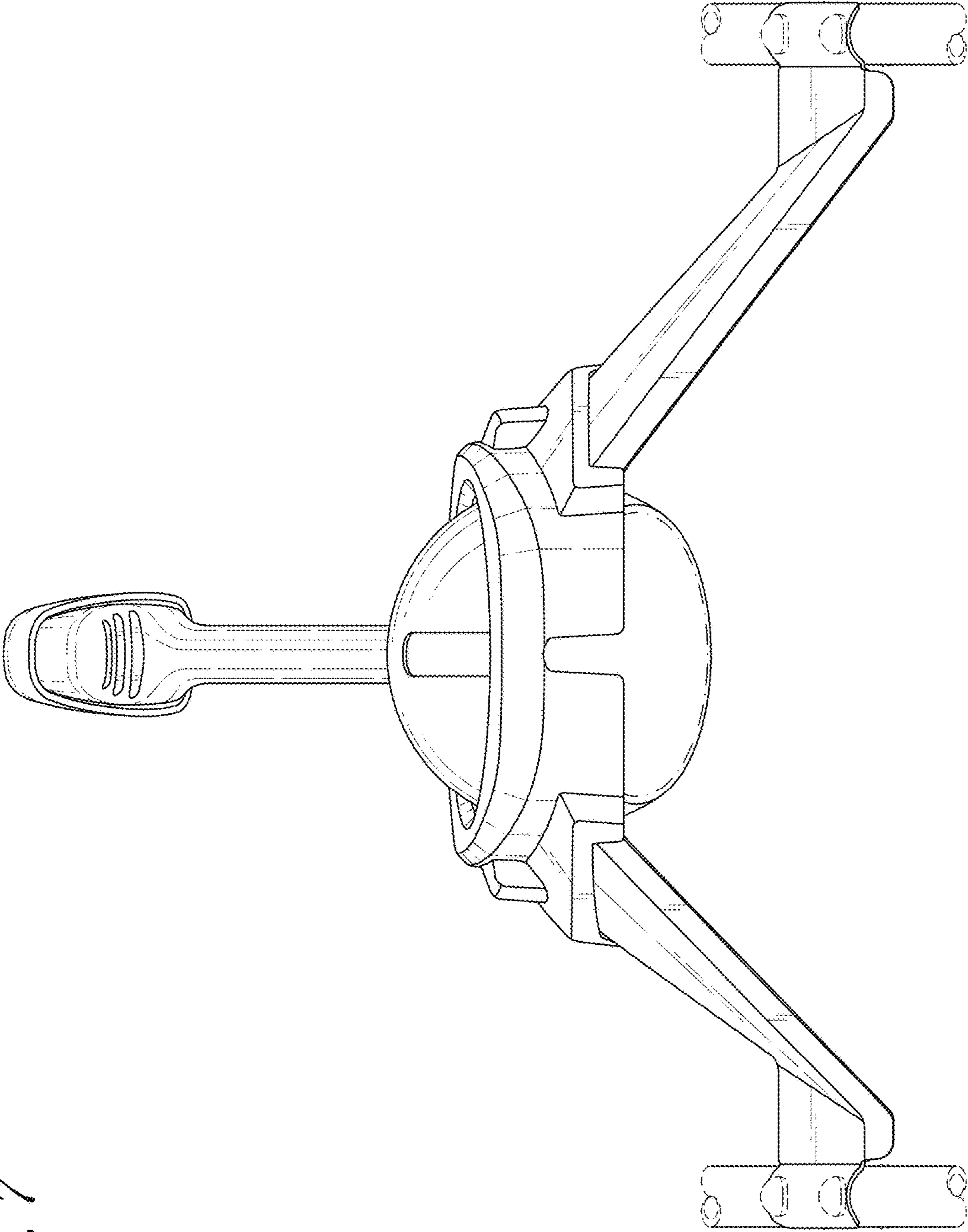

*Fig. 5*

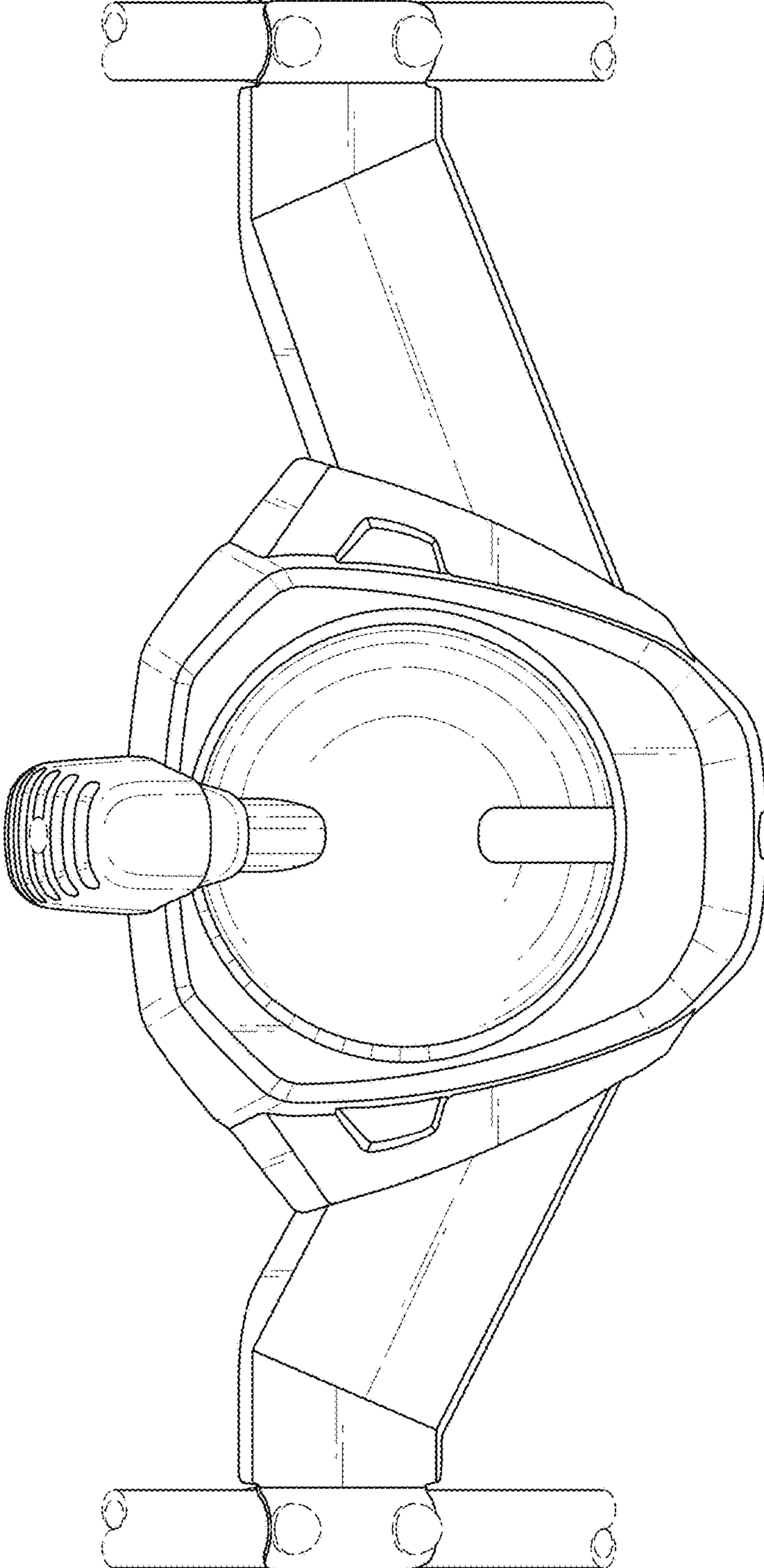

*Fig. 6*

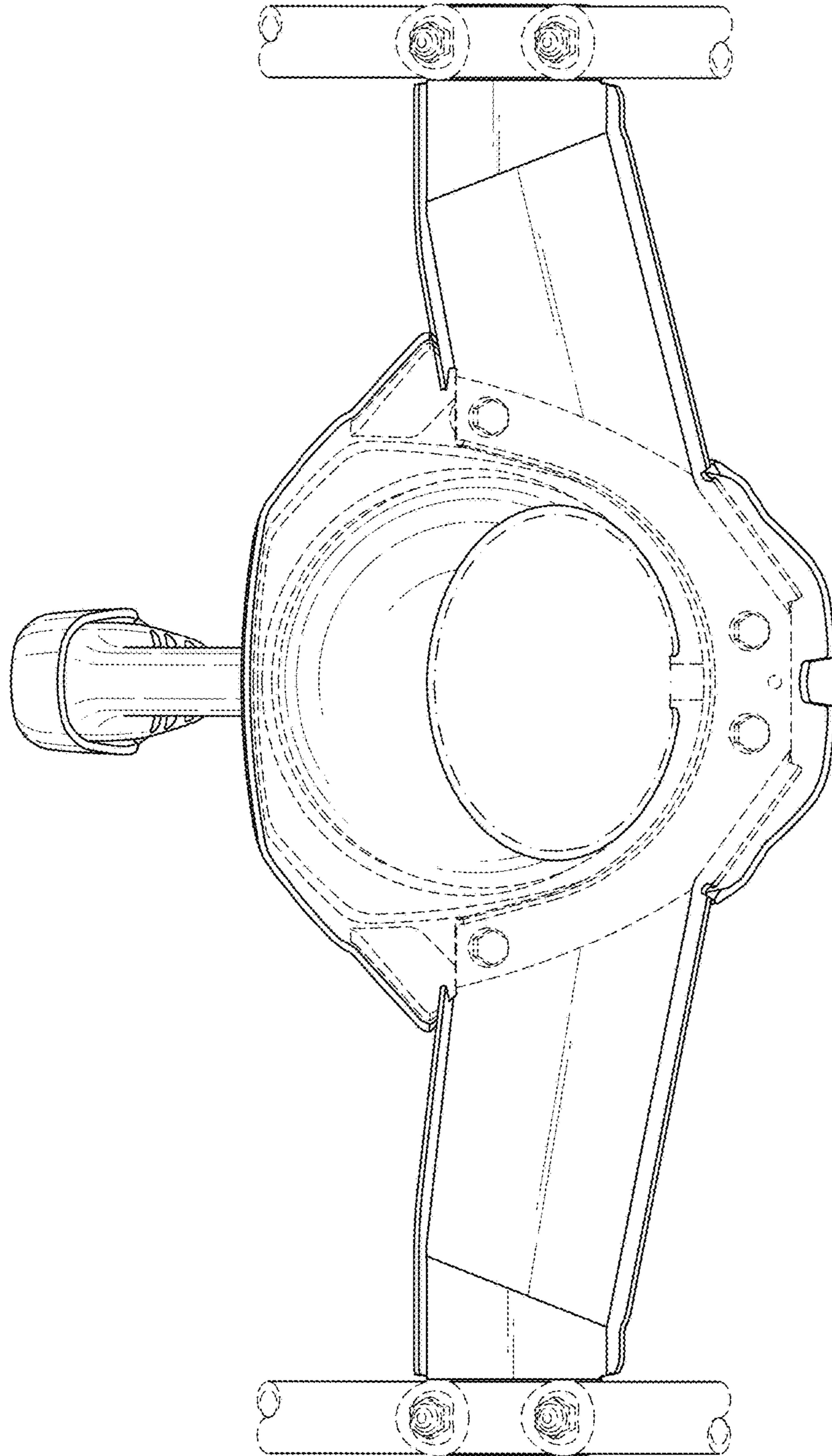



*Fig. 7*



*Fig. 8*



*Fig. 9*