



US00D775749S

(12) **United States Design Patent** (10) **Patent No.:** **US D775,749 S**
Daniels et al. (45) **Date of Patent:** **** Jan. 3, 2017**

- (54) **REAR LIGHT FOR A VEHICLE**
- (71) Applicant: **iCradle GmbH**, Frankfurt (DE)
- (72) Inventors: **Micha Daniels**, Darmstadt (DE);
Alexander Erdwins, Darmstadt (DE)
- (73) Assignee: **COBI GmbH**, Frankfurt (DE)
- (**) Term: **15 Years**
- (21) Appl. No.: **29/528,190**
- (22) Filed: **May 27, 2015**
- (30) **Foreign Application Priority Data**

Nov. 27, 2014 (EM) 002 586 776-0001
 Nov. 27, 2014 (EM) 002 586 776-0002

- (51) **LOC (10) Cl.** **26-06**
- (52) **U.S. Cl.**
USPC **D26/28**
- (58) **Field of Classification Search**
USPC D26/28-36; 362/459-468, 475-478,
362/485-487
CPC F21S 48/00; F21S 48/10; F21S 48/115;
F21S 48/225; F21S 48/1233; F21S
48/1266; F21S 48/1388; F21S 48/2268;
F21V 21/04
See application file for complete search history.

(56) **References Cited**
U.S. PATENT DOCUMENTS

D515,227 S *	2/2006	Idei	D26/28
D520,656 S *	5/2006	Shiu	D26/28
D556,927 S *	12/2007	Shiu	D26/39
D560,008 S *	1/2008	Poon	D26/39
D579,133 S *	10/2008	Shiu	D26/39
D707,868 S *	6/2014	Lee	D26/39
D724,248 S *	3/2015	Brands	D26/39
D742,042 S *	10/2015	Li	D26/28

D744,133 S *	11/2015	Deyaf	D26/28
D745,718 S *	12/2015	Deyaf	D26/28
D745,728 S *	12/2015	Ruthling	D26/28

(Continued)

FOREIGN PATENT DOCUMENTS

EM	002586776-0001	12/2014
EM	002586776-0002	12/2014

Primary Examiner — Angela J Lee

(74) *Attorney, Agent, or Firm* — SoCal IP Law Group
LLP; M. Kala Sarvaiya; Steven C. Sereboff

(57) **CLAIM**

The ornamental design for a rear light for a vehicle, as shown and described.

DESCRIPTION

A portion of the disclosure of this patent document contains material to which a claim for copyright is made. The copyright owner has no objection to the facsimile reproduction by anyone of the patent document or the patent disclosure, as it appears in the Patent and Trademark Office patent file or records, but reserves all other copyright rights whatsoever.

FIG. 1 is a front, top and right side perspective view of a rear light for a vehicle.

FIG. 2 is a rear, bottom and left side perspective view thereof;

FIG. 3 is a front elevation view thereof;

FIG. 4 is a rear elevation view thereof;

FIG. 5 is a top plan view thereof;

FIG. 6 is a bottom plan view thereof;

FIG. 7 is a right side elevation view thereof;

FIG. 8 is left side elevation view thereof.

FIG. 9 is a top elevation view thereof; and,

FIG. 10 is a bottom elevation view thereof.

The broken lines shown in the drawings are for illustrative purposes only and form no part of the claimed design.

1 Claim, 5 Drawing Sheets

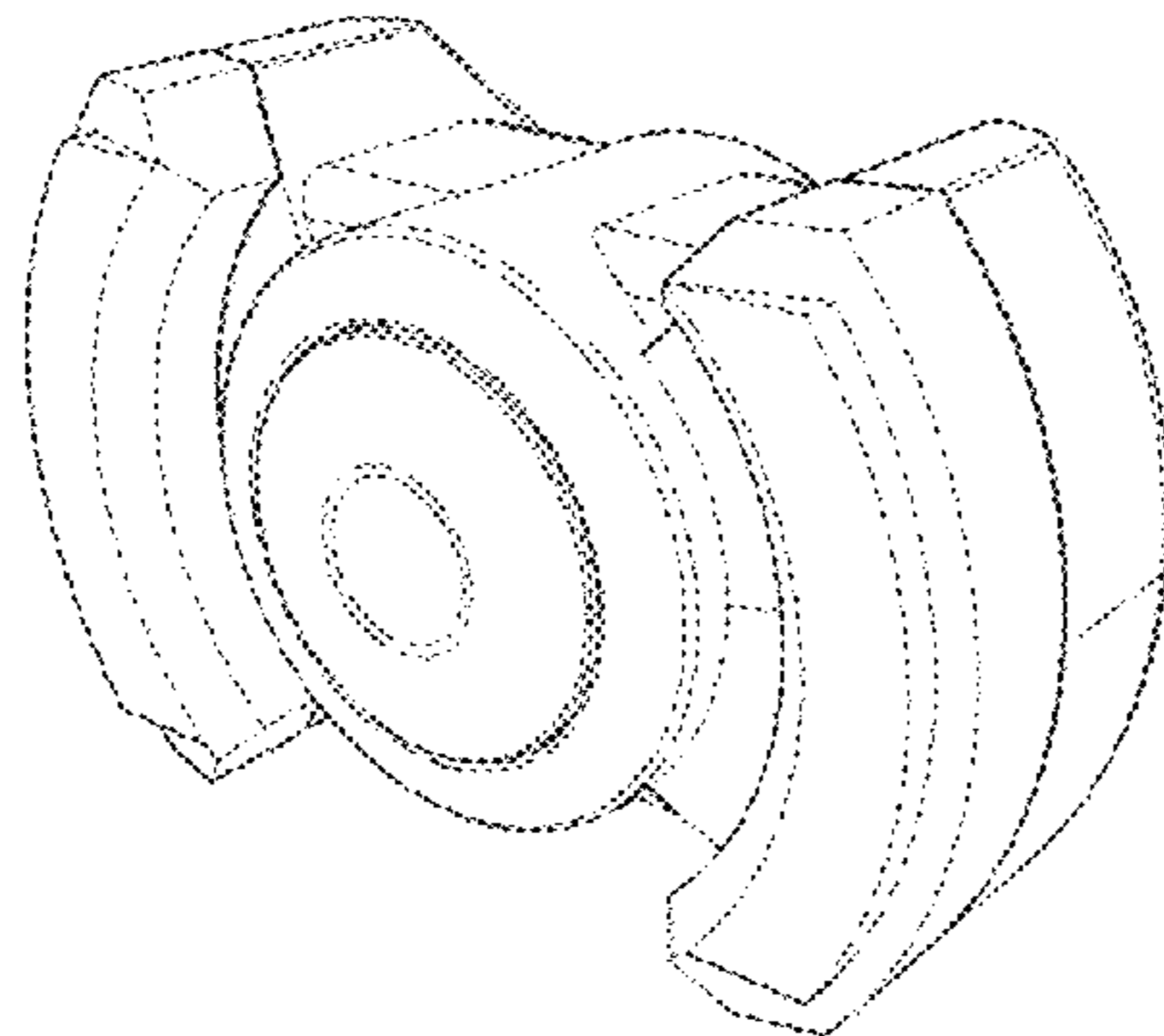

(56)

References Cited

U.S. PATENT DOCUMENTS

D746,501 S * 12/2015 Chen D26/28
D747,014 S * 1/2016 Chen D26/28

* cited by examiner

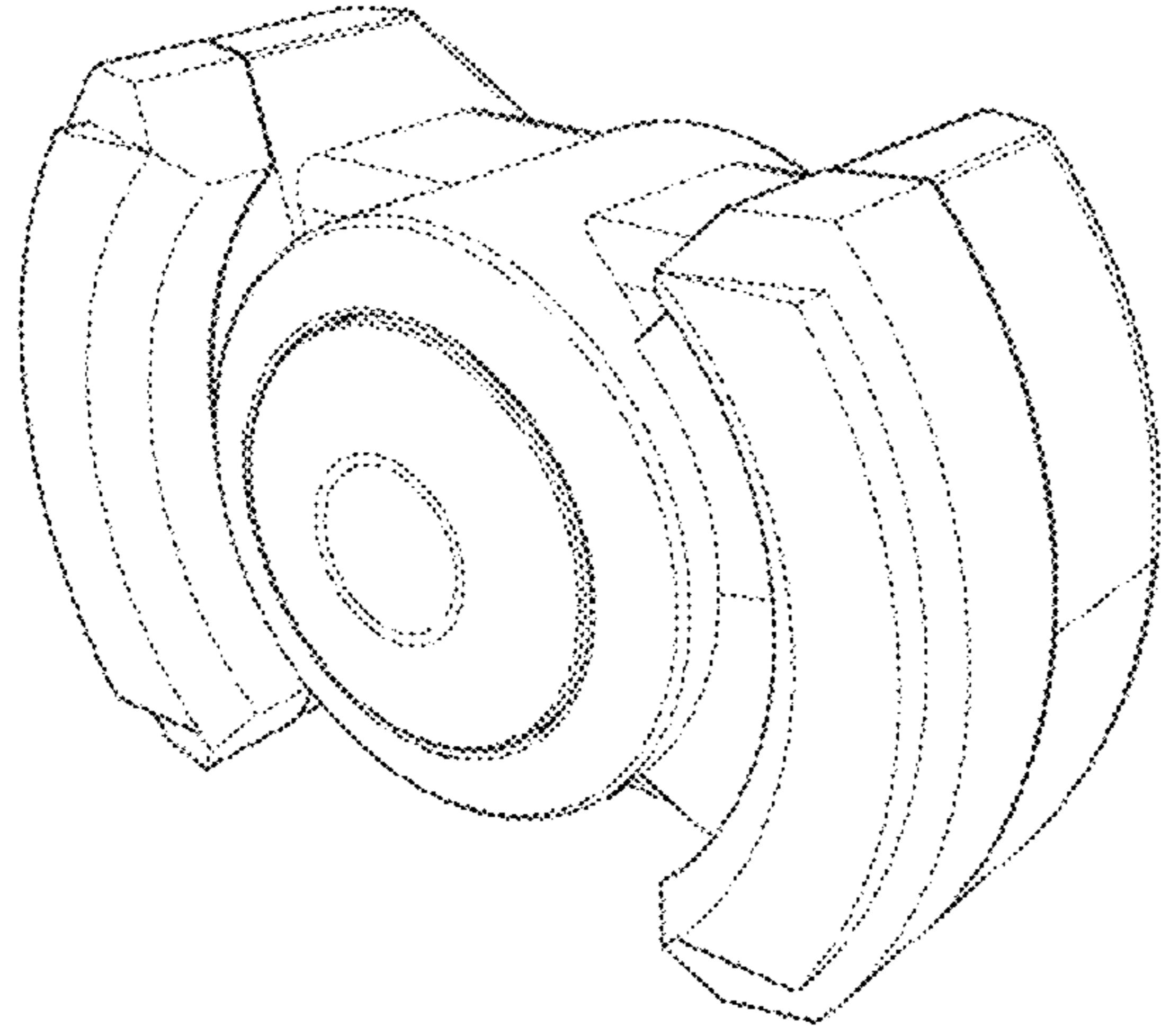

FIG. 1

©2015 iCradle GmbH

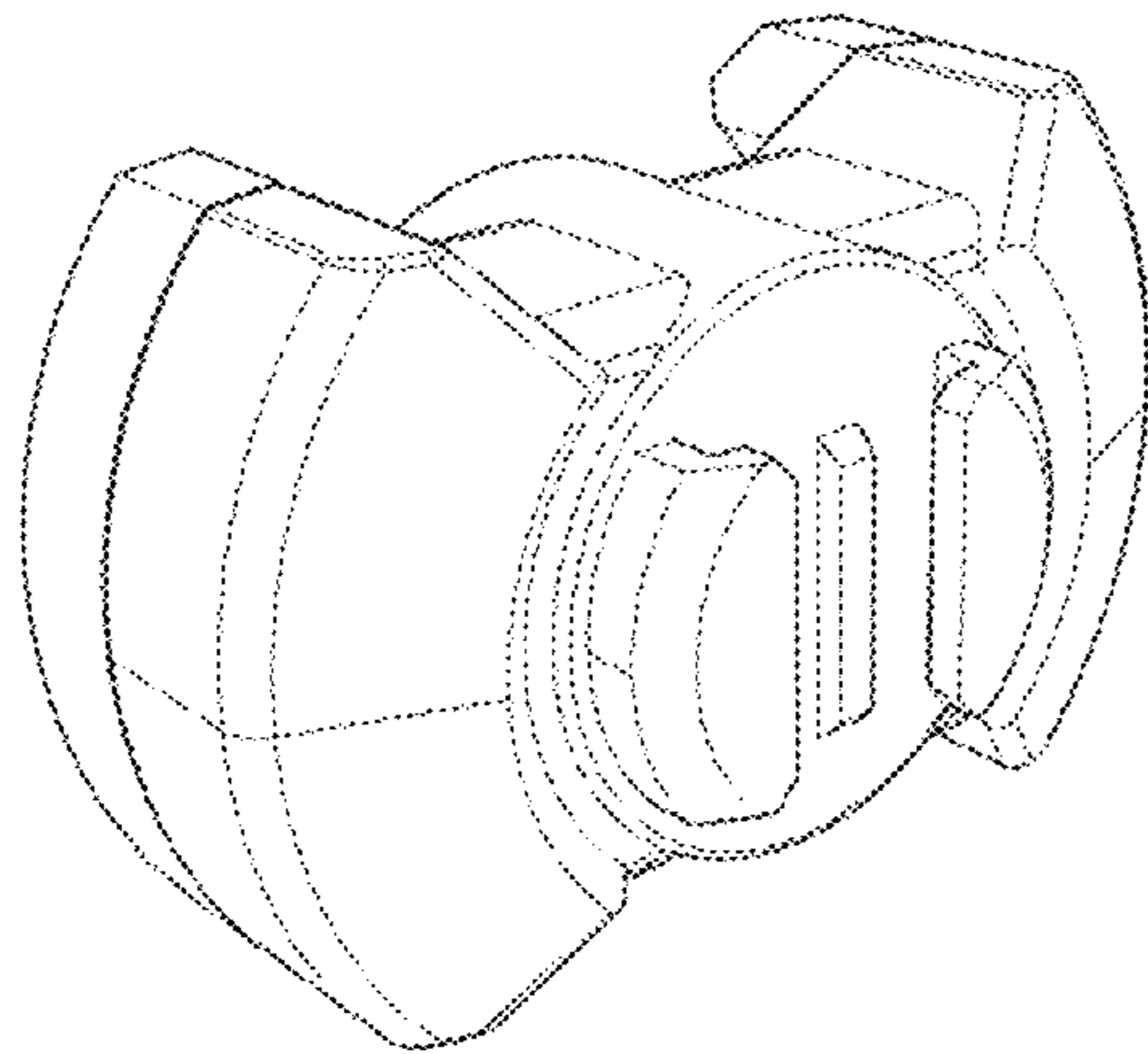

FIG. 2

©2015 iCradle GmbH

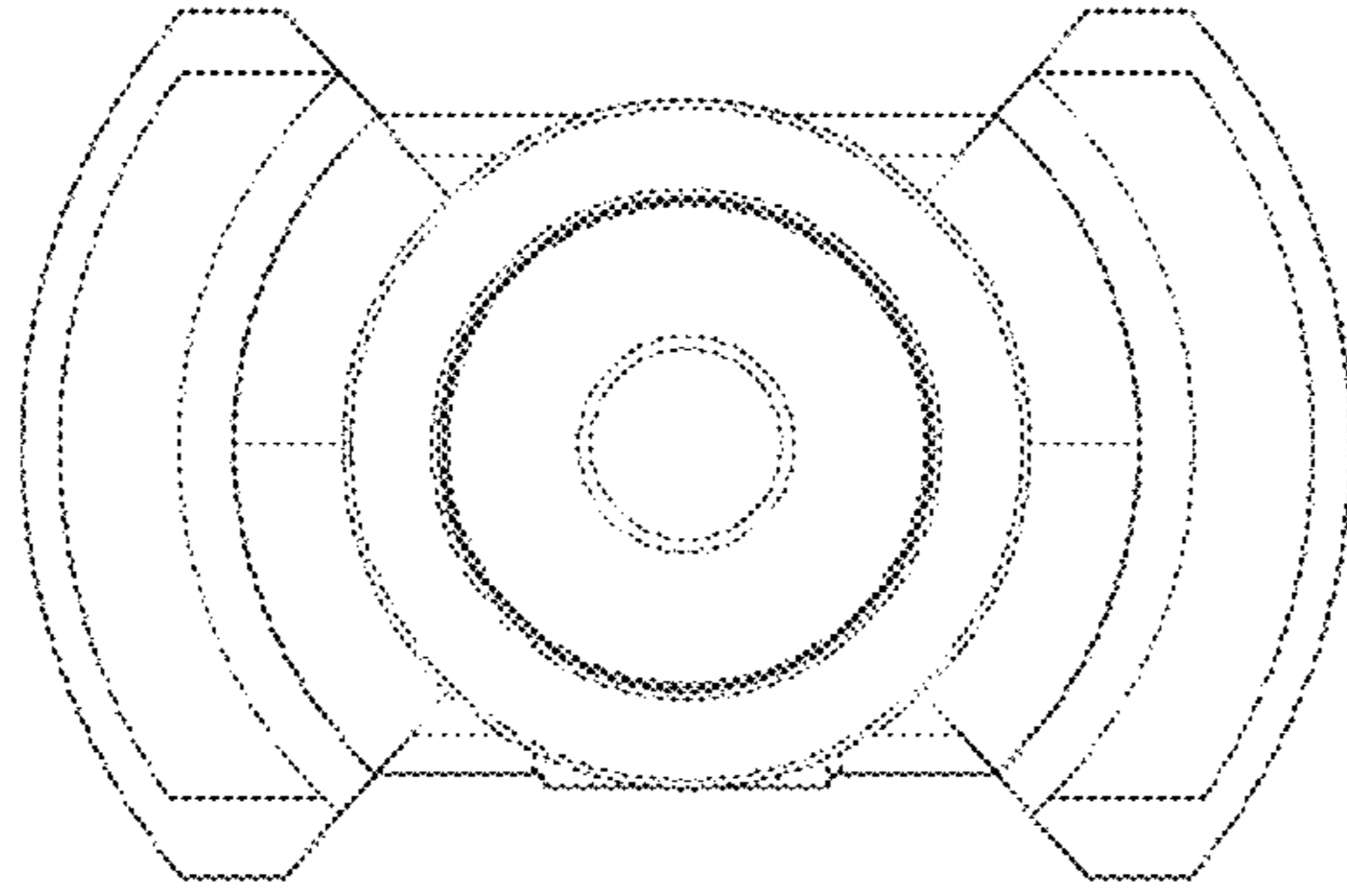

FIG. 3

©2015 iCradle GmbH

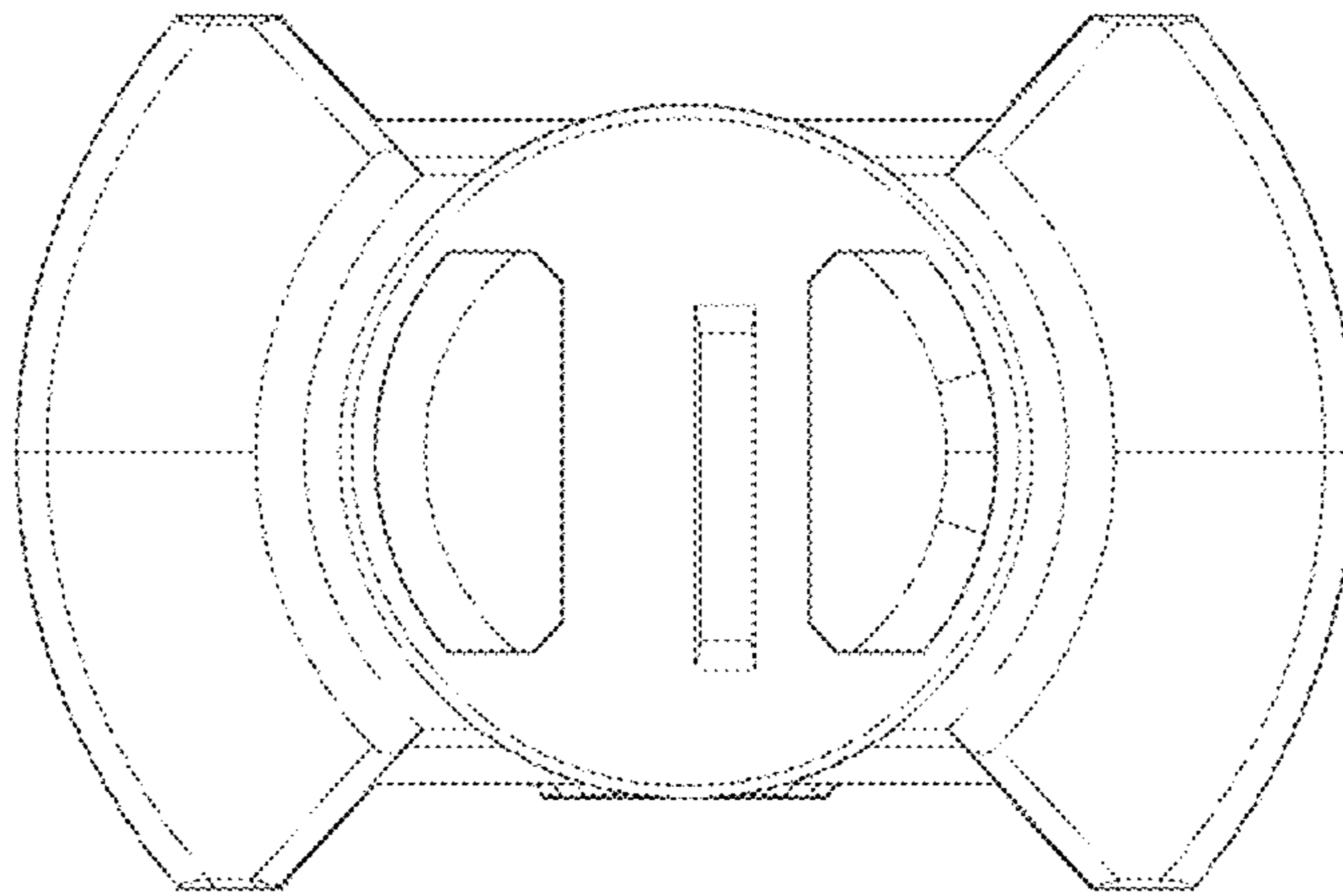

FIG. 4

©2015 iCradle GmbH

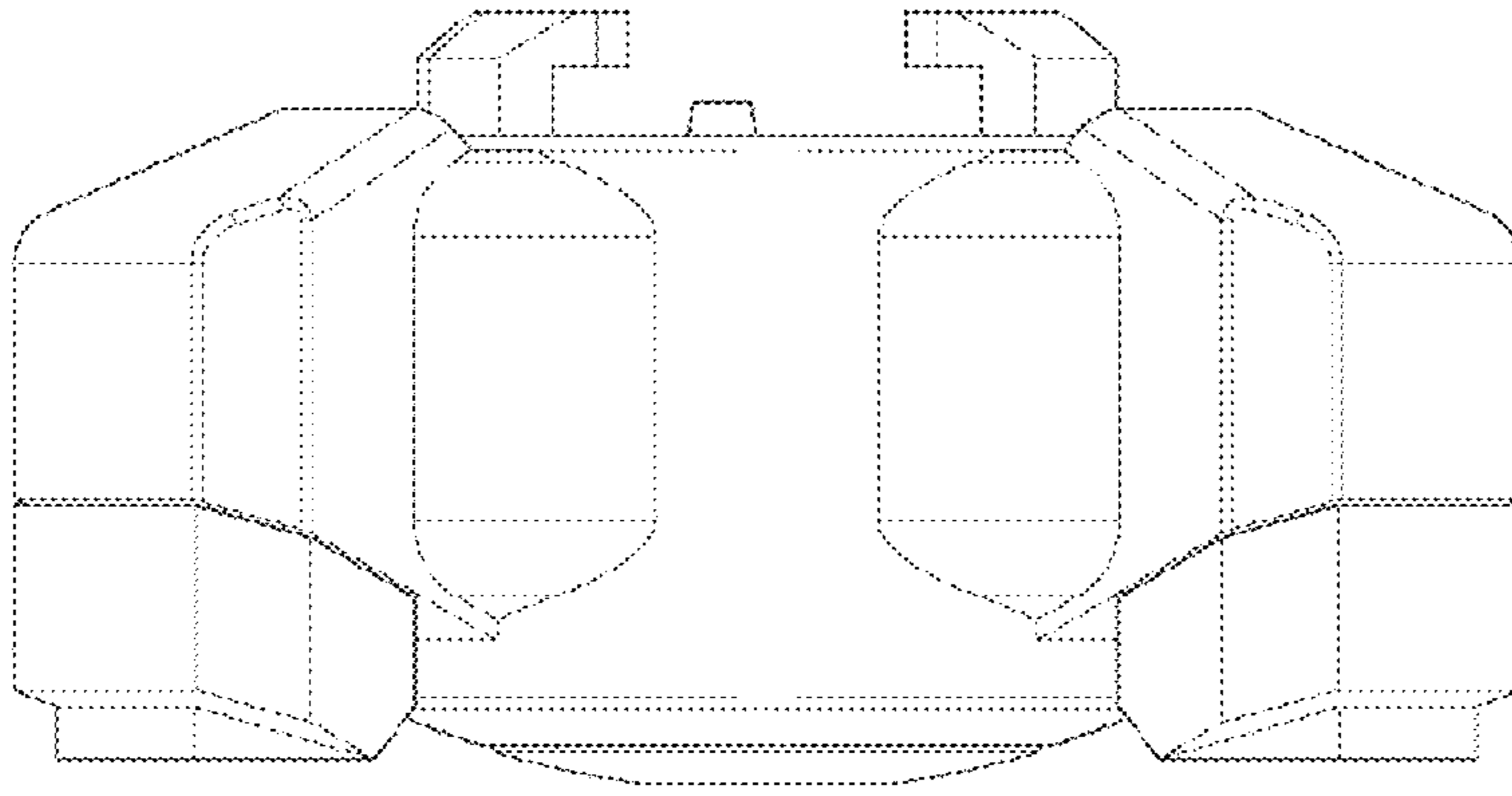

FIG. 5

©2015 iCradle GmbH

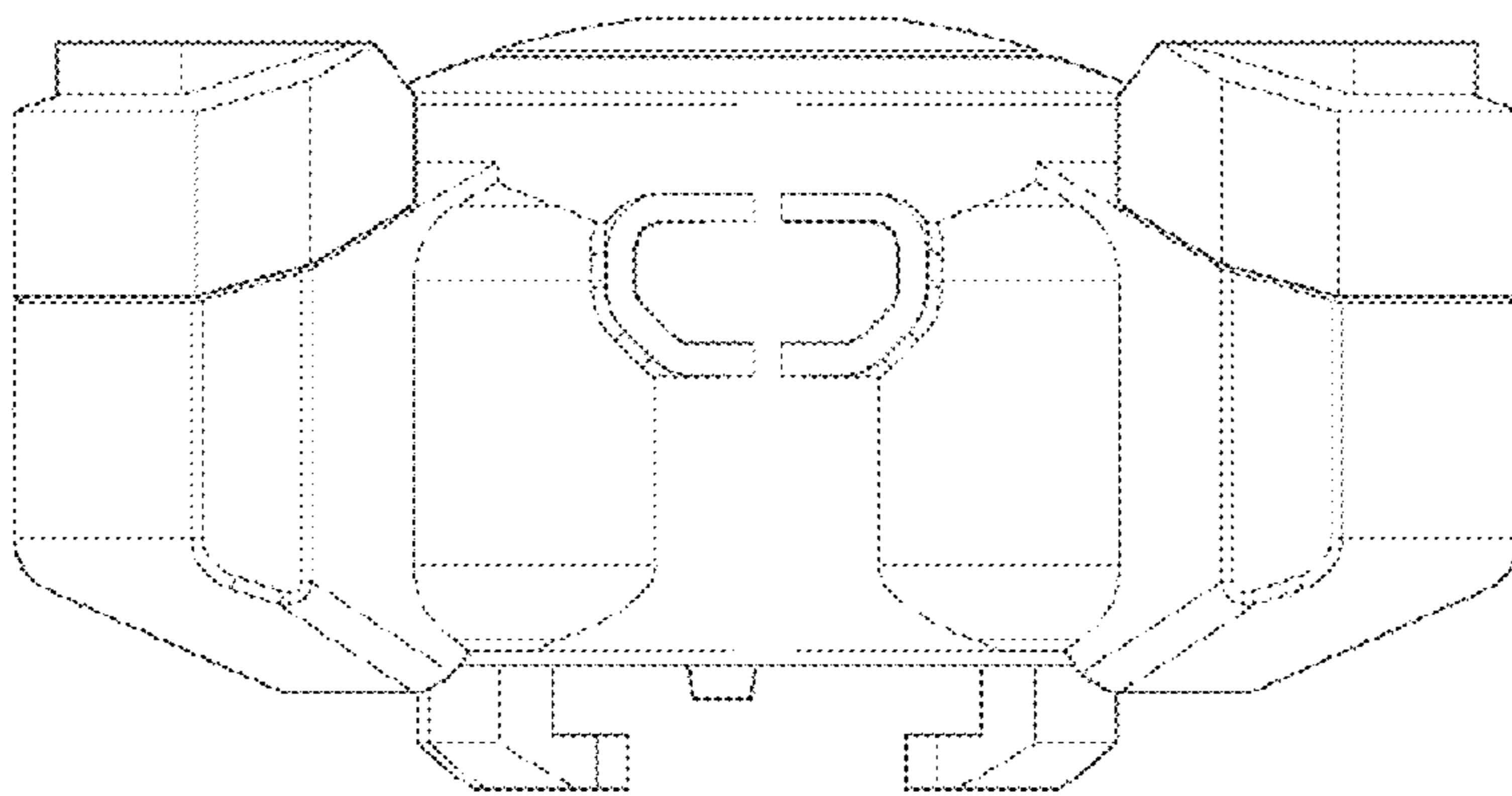

FIG. 6

©2015 iCradle GmbH

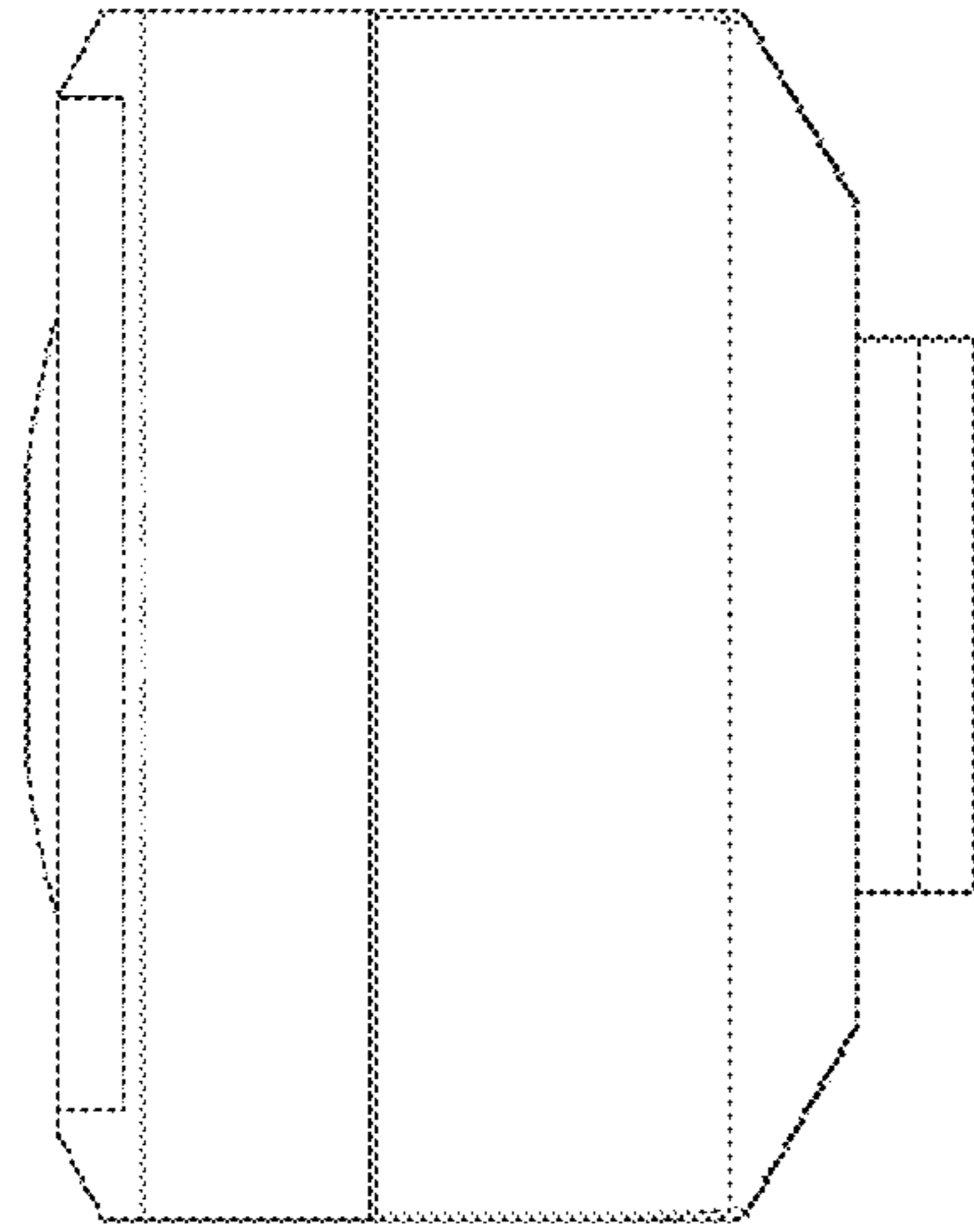

FIG. 7

©2015 iCradle GmbH

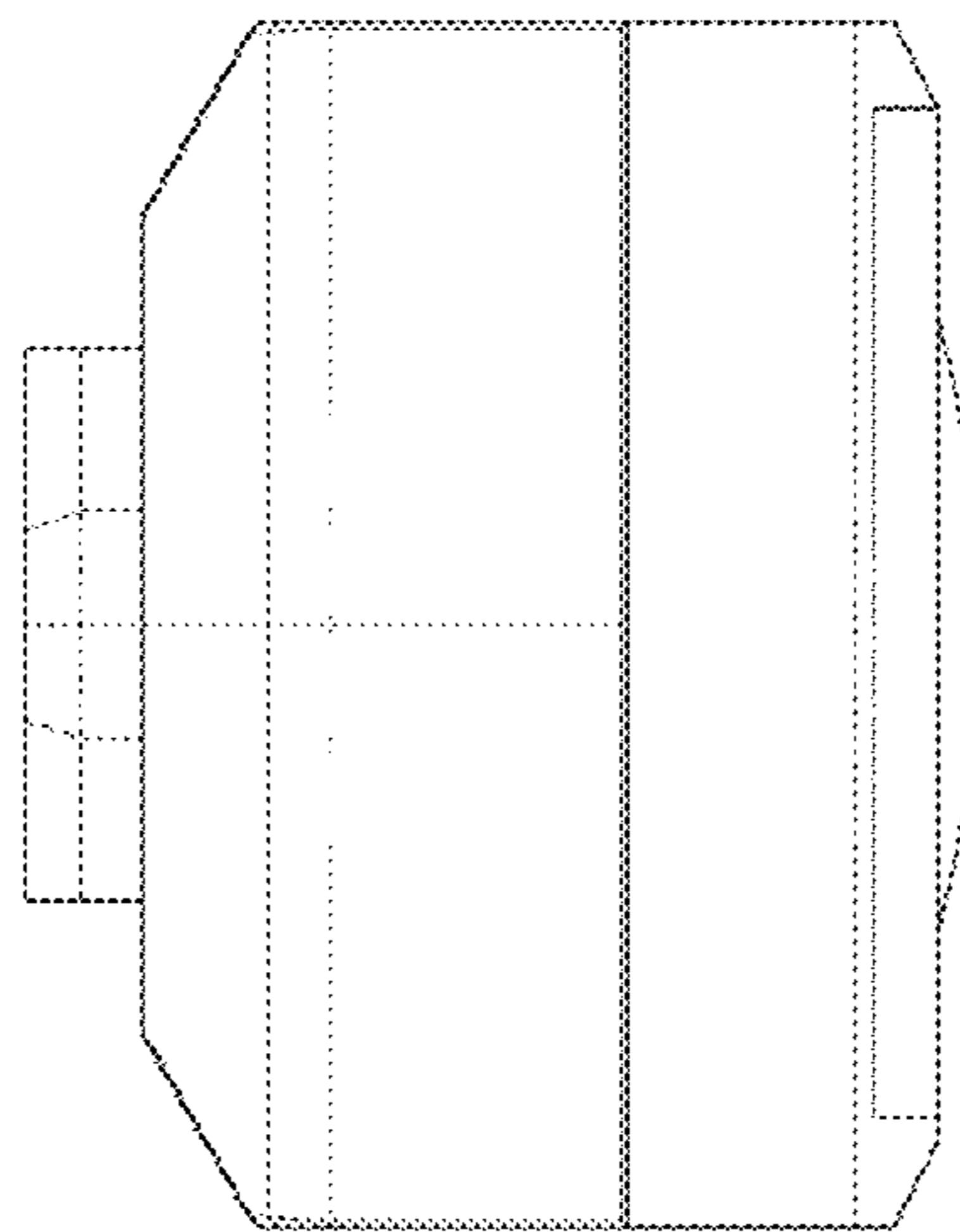

FIG. 8

©2015 iCradle GmbH

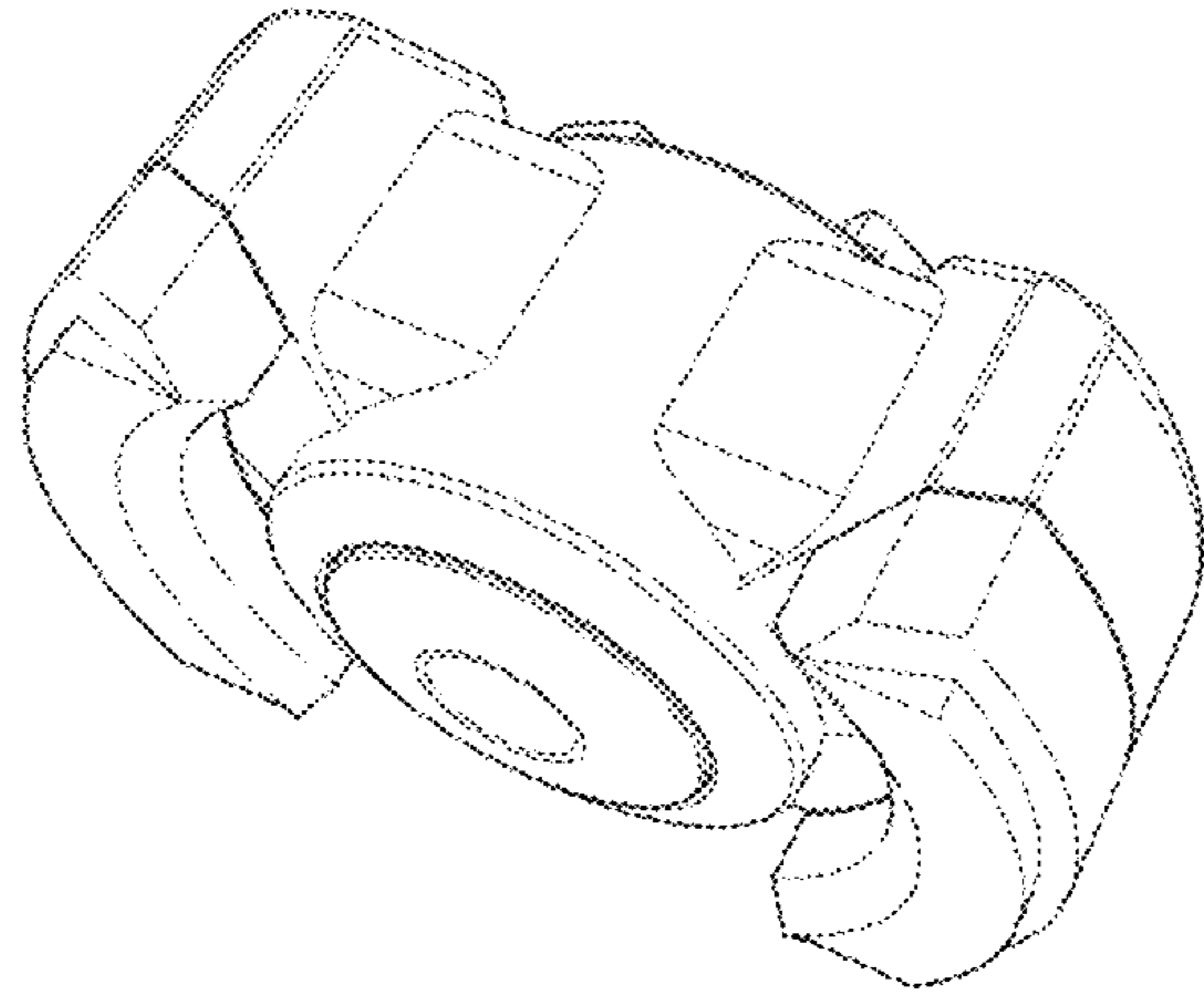

FIG. 9

©2015 iCradle GmbH

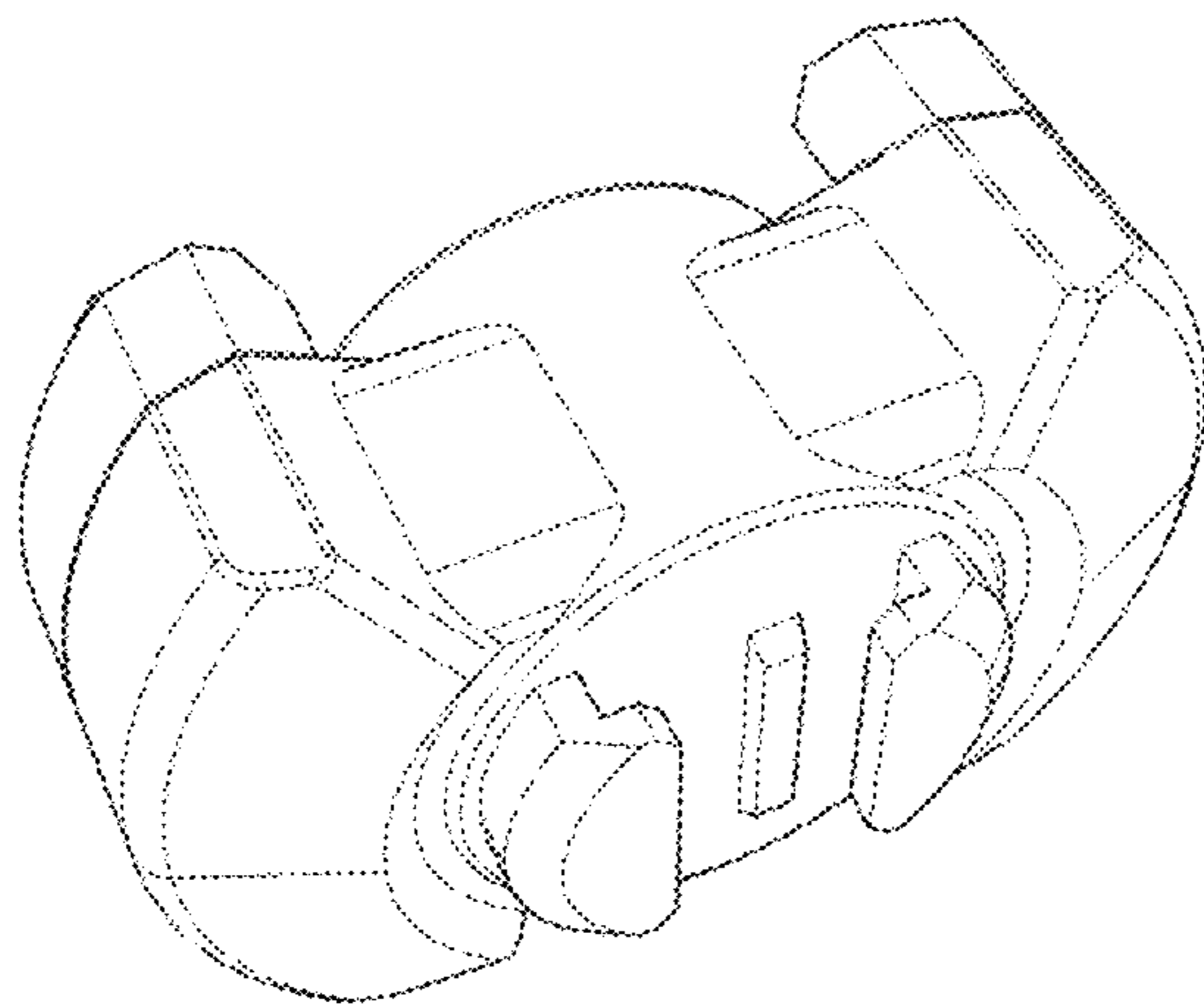

FIG. 10

©2015 iCradle GmbH

UNITED STATES PATENT AND TRADEMARK OFFICE
CERTIFICATE OF CORRECTION

PATENT NO. : D775,749 S
APPLICATION NO. : 29/528190
DATED : January 3, 2017
INVENTOR(S) : Micha Daniels and Alexander Erdwiens

Page 1 of 1

It is certified that error appears in the above-identified patent and that said Letters Patent is hereby corrected as shown below:

On the Title Page

Item (72) Inventors: "Erdwins" replace with --Erdwiens--

Signed and Sealed this
Twenty-seventh Day of June, 2017



Joseph Matal
*Performing the Functions and Duties of the
Under Secretary of Commerce for Intellectual Property and
Director of the United States Patent and Trademark Office*