



US00D775338S

(12) **United States Design Patent** (10) **Patent No.:** **US D775,338 S**
Gitman (45) **Date of Patent:** **** Dec. 27, 2016**

(54) **HANDLE FOR MEDICAL AND DENTAL SCALPEL**

(71) Applicant: **Eliyahu Gitman**, Jerusalem (IL)

(72) Inventor: **Eliyahu Gitman**, Jerusalem (IL)

(73) Assignee: **ScalPal LLC**, Jerusalem (IL)

(**) Term: **14 Years**

(21) Appl. No.: **29/500,887**

(22) Filed: **Aug. 29, 2014**

Related U.S. Application Data

(62) Division of application No. 29/435,465, filed on Oct. 24, 2012, now Pat. No. Des. 731,057.

(30) **Foreign Application Priority Data**

Apr. 24, 2012 (IL) 52538
Apr. 29, 2012 (IL) 52578

(51) **LOC (10) Cl.** **24-02**

(52) **U.S. Cl.**
USPC **D24/147**

(58) **Field of Classification Search**
USPC D24/146, 147, 133; D19/35, 55, 59, 117,
D19/180, 920, 913; 15/433; 401/6; D8/98,
D8/99
CPC ... A46B 5/02; A61B 17/3211; A61B 17/3213;
A61F 9/007; A61F 9/013; A61F 9/0133;
B25G 1/10; B25G 1/102; B25G
3/00; B43K 5/005; B21K 5/18
See application file for complete search history.

(56) **References Cited**

U.S. PATENT DOCUMENTS

D35,577 S * 1/1902 Jacobson 15/443
D241,343 S * 9/1976 Harmon D19/117

D269,357 S * 6/1983 Jagger D19/180
D453,531 S * 2/2002 Simon D19/163
D533,944 S * 12/2006 Sullivan D24/147
D561,828 S * 2/2008 Wesselmann D19/174
D632,391 S * 2/2011 Gitman D24/147
D635,260 S * 3/2011 Gitman D24/147
D645,718 S * 9/2011 Crystal D8/98
D700,700 S * 3/2014 Efinger D24/147
D729,385 S * 5/2015 Gitman D24/147
D731,057 S * 6/2015 Gitman D24/147
D746,460 S * 12/2015 Gitman D24/147

* cited by examiner

Primary Examiner — Robert M Spear
Assistant Examiner — Marissa J Cash
(74) *Attorney, Agent, or Firm* — Pearl Cohen Zedek
Latzer Baratz LLP

(57) **CLAIM**

I claim the ornamental design for handle for medical and dental scalpel, as shown and described.

DESCRIPTION

FIG. 1 is a perspective of a handle for medical and dental scalpel in accordance with the invention.
FIG. 2 is a left side view of the handle for medical and dental scalpel of FIG. 1.
FIG. 3 is a right side view of the handle for medical and dental scalpel of FIG. 1.
FIG. 4 is a front view of the handle for medical and dental scalpel of FIG. 1.
FIG. 5 is a back view of the handle for medical and dental scalpel of FIG. 1.
FIG. 6 is a top view of the handle for medical and dental scalpel of FIG. 1; and,
FIG. 7 is a bottom view of the handle for medical and dental scalpel of FIG. 1.

1 Claim, 4 Drawing Sheets

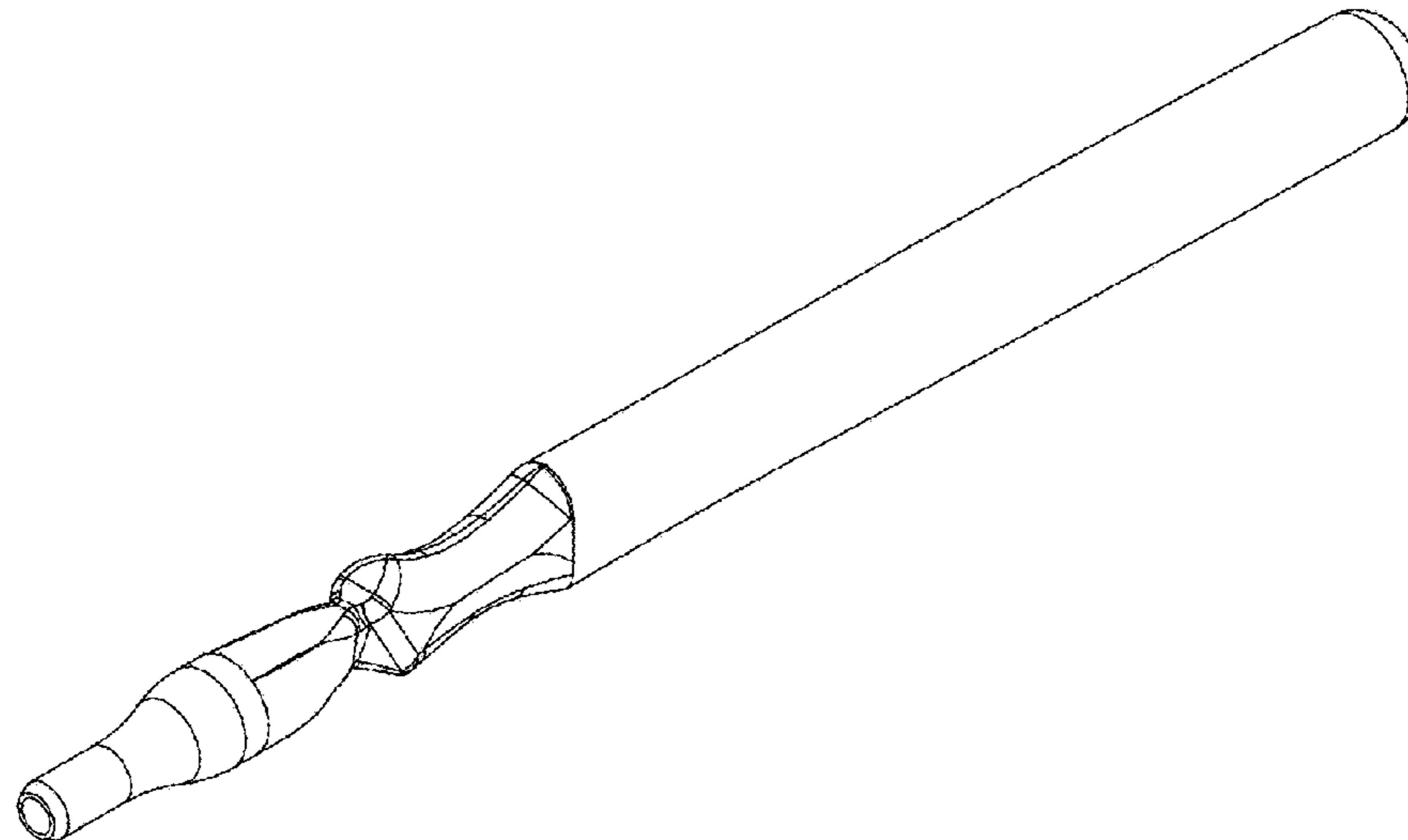

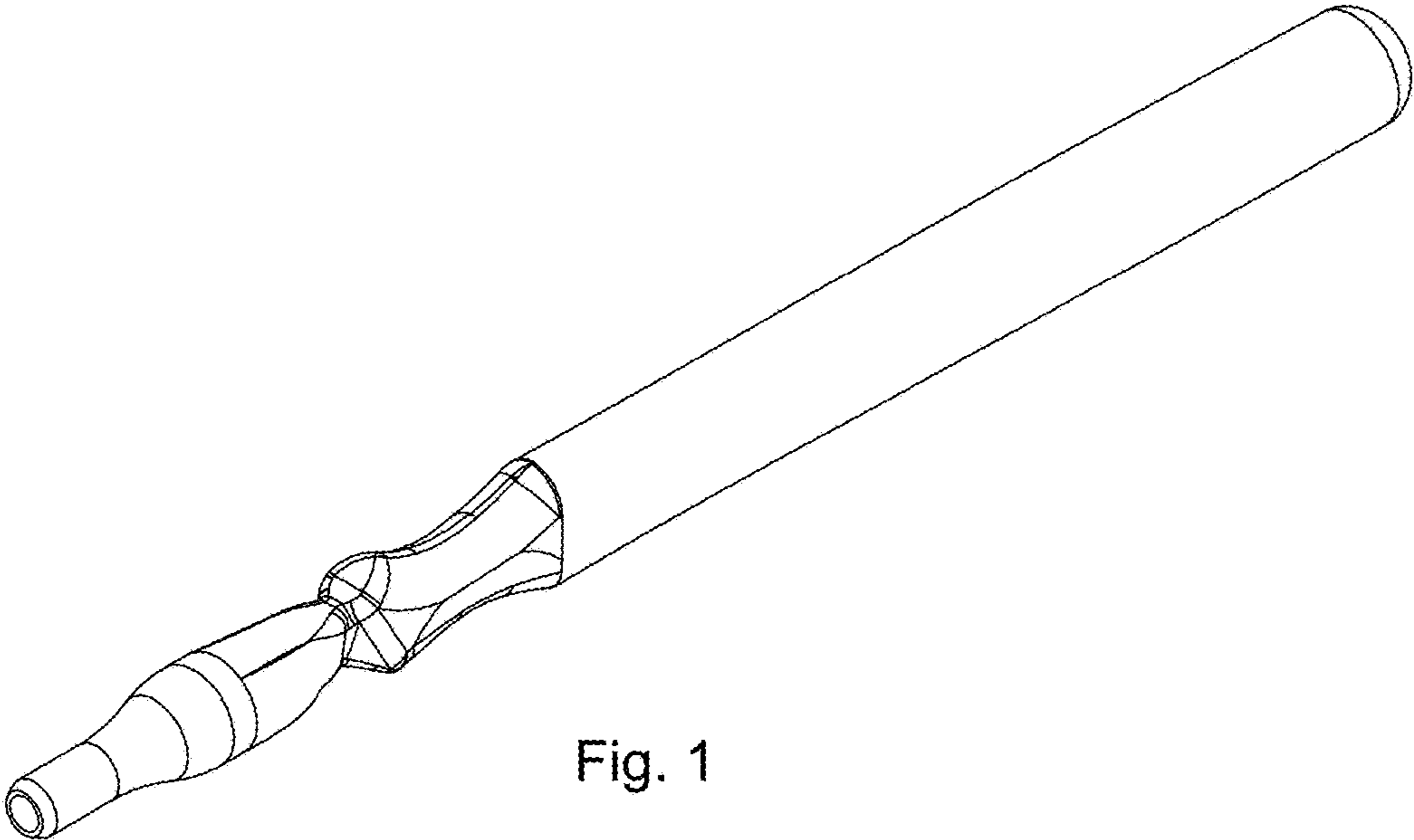

Fig. 1



Fig. 2



Fig. 3

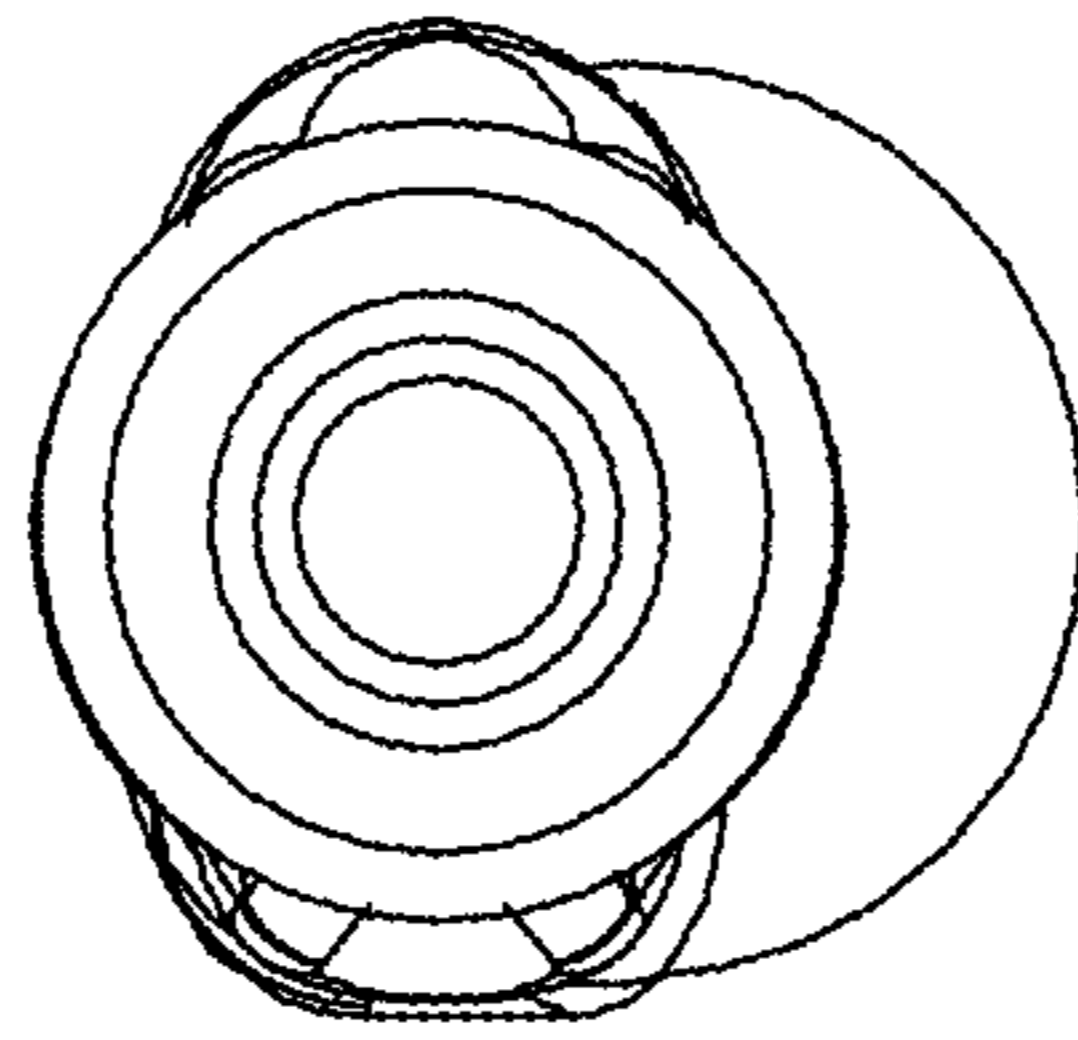

Fig. 4

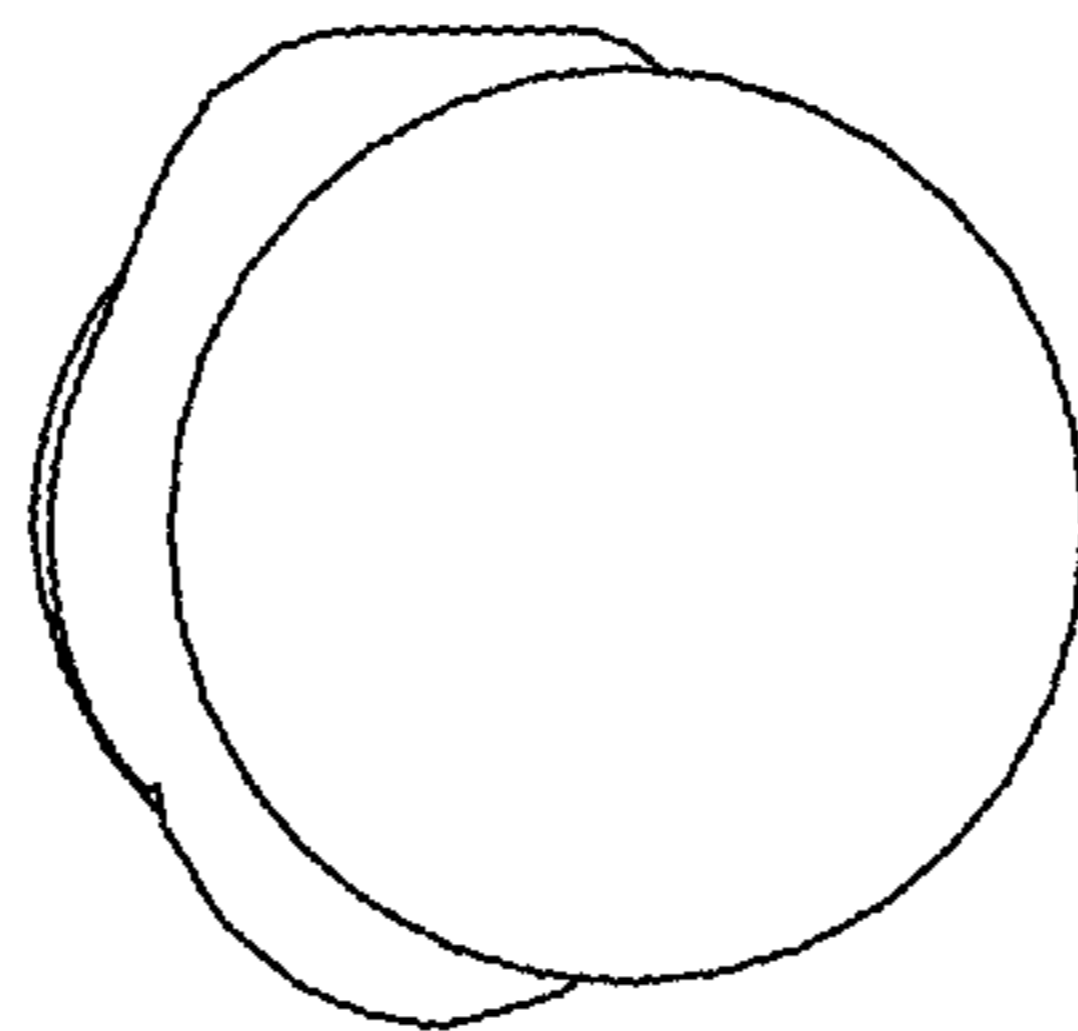

Fig. 5

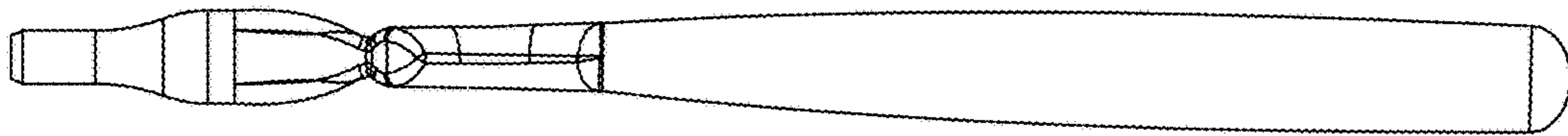

Fig. 6

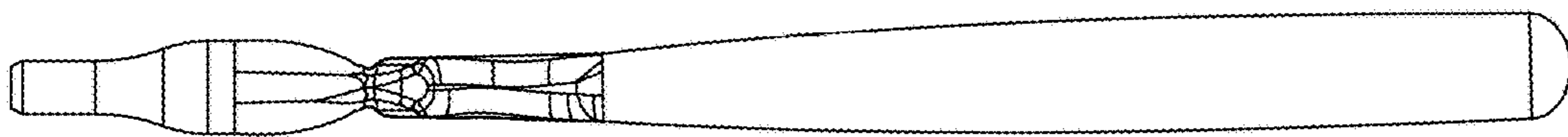

Fig. 7