



US00D775163S

(12) **United States Design Patent** (10) **Patent No.:** **US D775,163 S**  
**Strayle** (45) **Date of Patent:** **\*\* Dec. 27, 2016**

(54) **BUILT-IN HOME APPLIANCE DISPLAY SCREEN WITH TRANSITIONAL GRAPHICAL USER INTERFACE**

(71) Applicant: **BSH Bosch und Siemens Hausgeräte GmbH, Munich (DE)**

(72) Inventor: **Sören Strayle, München (DE)**

(73) Assignee: **BSH Hausgeräte GmbH, Munich (DE)**

(\*\*) Term: **14 Years**

(21) Appl. No.: **29/507,560**

(22) Filed: **Oct. 29, 2014**

**Related U.S. Application Data**

(62) Division of application No. 29/445,199, filed on Feb. 8, 2013, now Pat. No. Des. 722,322.

(30) **Foreign Application Priority Data**

Aug. 16, 2012 (EM) ..... 001341432

(51) **LOC (10) Cl.** ..... **14-04**

(52) **U.S. Cl.**  
USPC ..... **D14/486**

(58) **Field of Classification Search**  
USPC . D14/485-495; D18/26, 31, 32, 33; D20/11, D20/12, 23, 24, 25, 29, 30, 31, 32, 36, D20/37, 38; 715/702, 764, 838  
CPC ..... G06T 13/80; G06T 15/02; G06F 3/04817  
See application file for complete search history.

(56) **References Cited**

**U.S. PATENT DOCUMENTS**

D498,240 S \* 11/2004 Amaitis ..... D14/486  
D575,792 S \* 8/2008 Benson ..... D14/486

D602,944 S \* 10/2009 Barkhouse ..... D14/488  
D667,018 S \* 9/2012 Clanton ..... D14/485  
D678,302 S \* 3/2013 Trumble ..... D14/486  
D682,855 S \* 5/2013 Iden ..... D14/486  
D696,270 S \* 12/2013 Hyunjung ..... D14/486  
D699,255 S \* 2/2014 Kim ..... D14/486  
D700,618 S \* 3/2014 Hwang ..... D14/486  
D700,913 S \* 3/2014 Kim ..... D14/486  
D711,899 S \* 8/2014 Hwang ..... D14/486

(Continued)

*Primary Examiner* — Darlington Ly

(74) *Attorney, Agent, or Firm* — Michael E. Tschupp; Andre Pallapies

(57) **CLAIM**

The ornamental design for a built-in home appliance display screen with transitional graphical user interface, as shown and described.

**DESCRIPTION**

FIG. 1 is a front perspective view of a built-in home appliance having a display screen with transitional graphical user interface in accordance to my new design;

FIG. 2 is an enlarged front view of a first image of the display screen with transitional graphical user interface; and, FIG. 3 is an enlarged front view of a second image thereof.

In FIG. 1, the broken lines showing the built-in home appliance are provided for the purpose of illustrating environmental structure and forms no part of the claimed design. The broken line perimeter in showing the display screen and the broken lines showing elements of the graphical user interface are provided to illustrate portions of the article that forms no part of the claimed design.

The appearance of the design sequentially transitions between the enlarged images shown in FIGS. 2 and 3. The process or period in which one image transitions to another image forms no part of the claimed design.

**1 Claim, 3 Drawing Sheets**

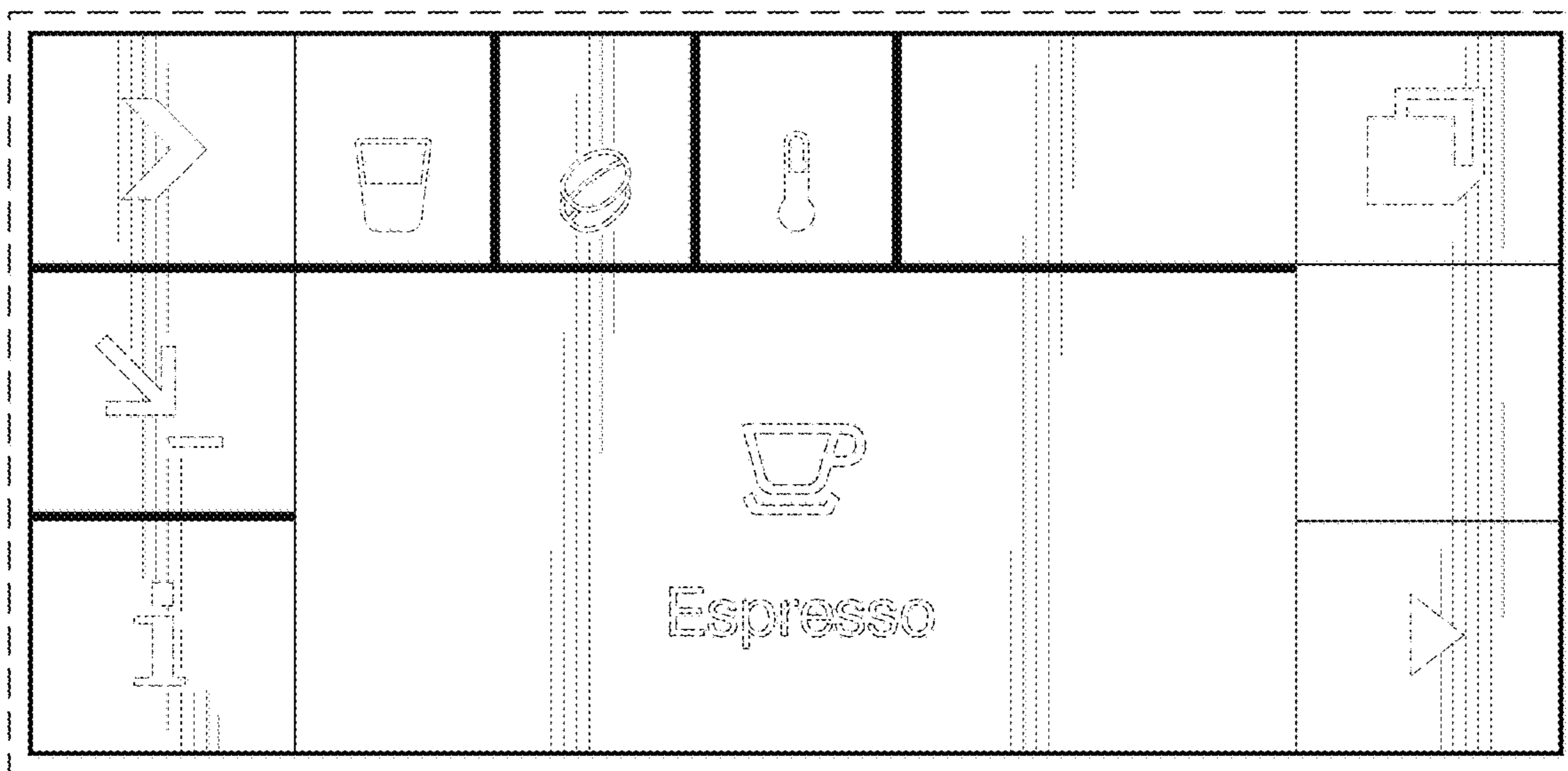

(56)

**References Cited**

U.S. PATENT DOCUMENTS

D728,592 S \* 5/2015 Kim ..... D14/486  
D729,267 S \* 5/2015 Yoo ..... D14/486  
D730,366 S \* 5/2015 Brush ..... D14/485  
D734,775 S \* 7/2015 Nagasawa ..... D14/488  
2009/0126714 A1\* 5/2009 Barkhouse ..... F23N 1/002  
126/39 G  
2010/0107103 A1\* 4/2010 Wallaert ..... F24F 11/0086  
715/771  
2011/0029865 A1\* 2/2011 Gilland ..... G06F 19/3406  
715/702  
2011/0071420 A1\* 3/2011 St. Pierre ..... A61B 5/02055  
600/549  
2011/0138323 A1\* 6/2011 Skidmore ..... A61M 16/0051  
715/800  
2011/0197165 A1\* 8/2011 Filippov ..... G06F 3/0482  
715/841  
2013/0277353 A1\* 10/2013 Joseph ..... H05B 1/0263  
219/209

\* cited by examiner

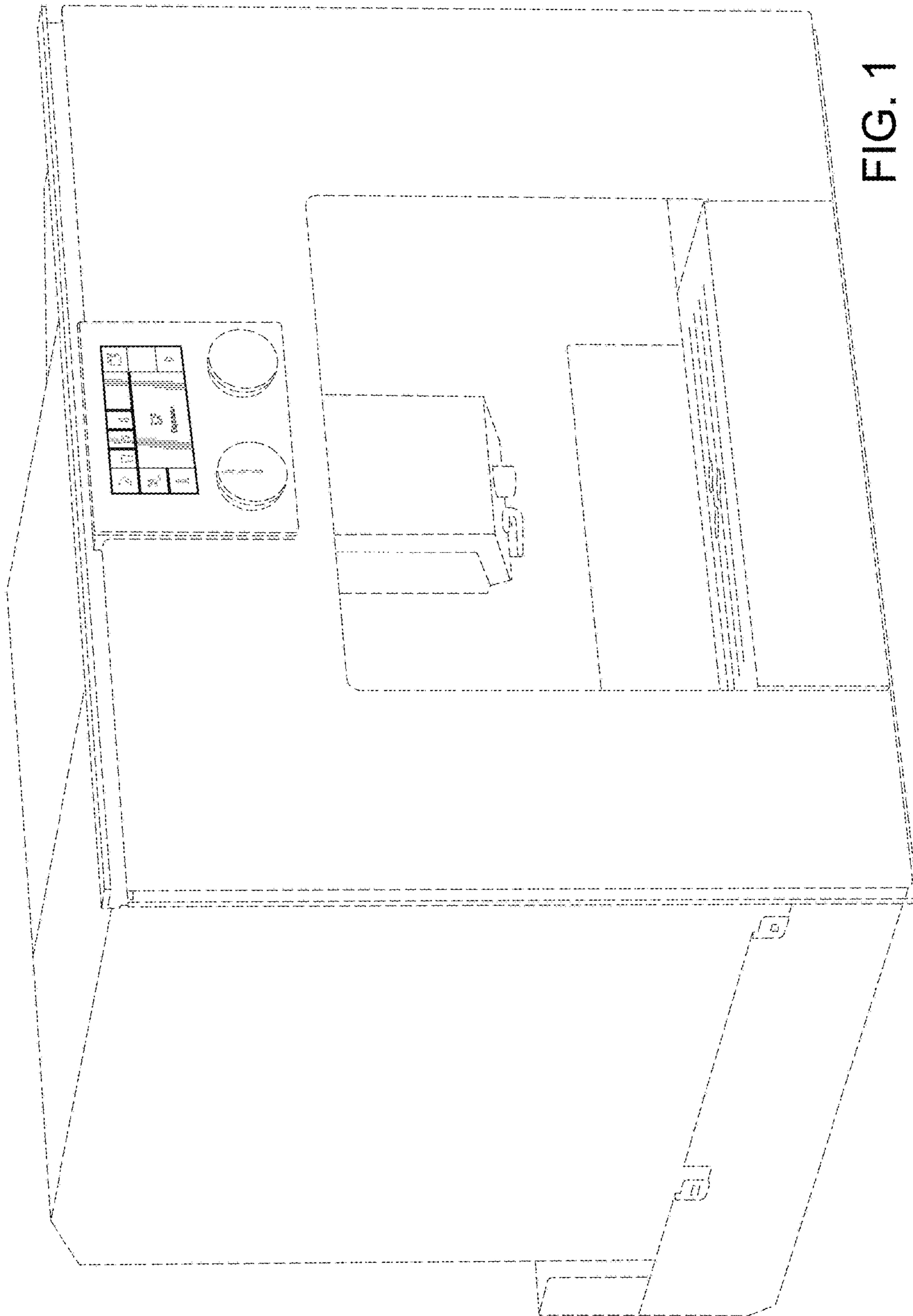

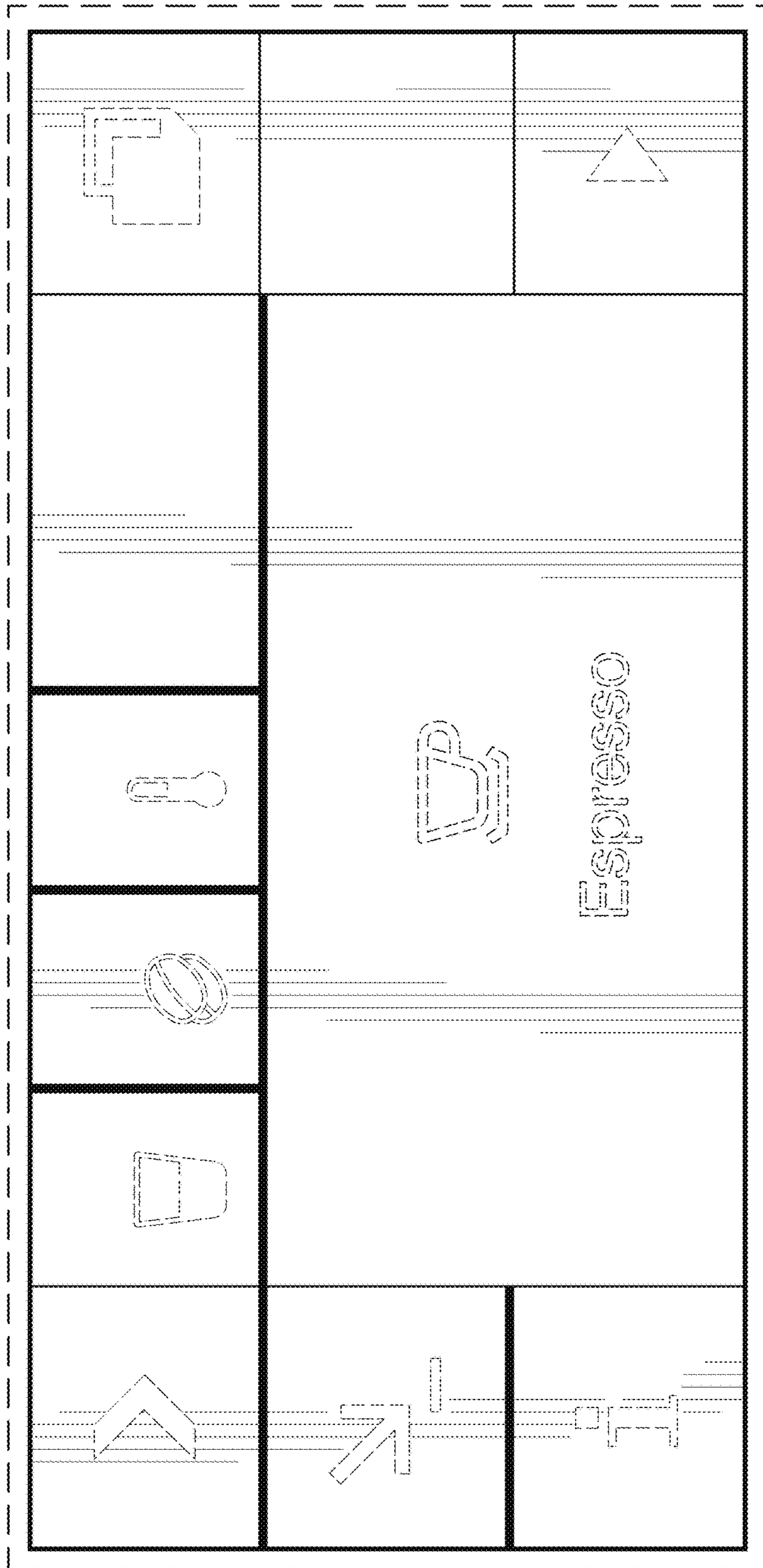

FIG. 2

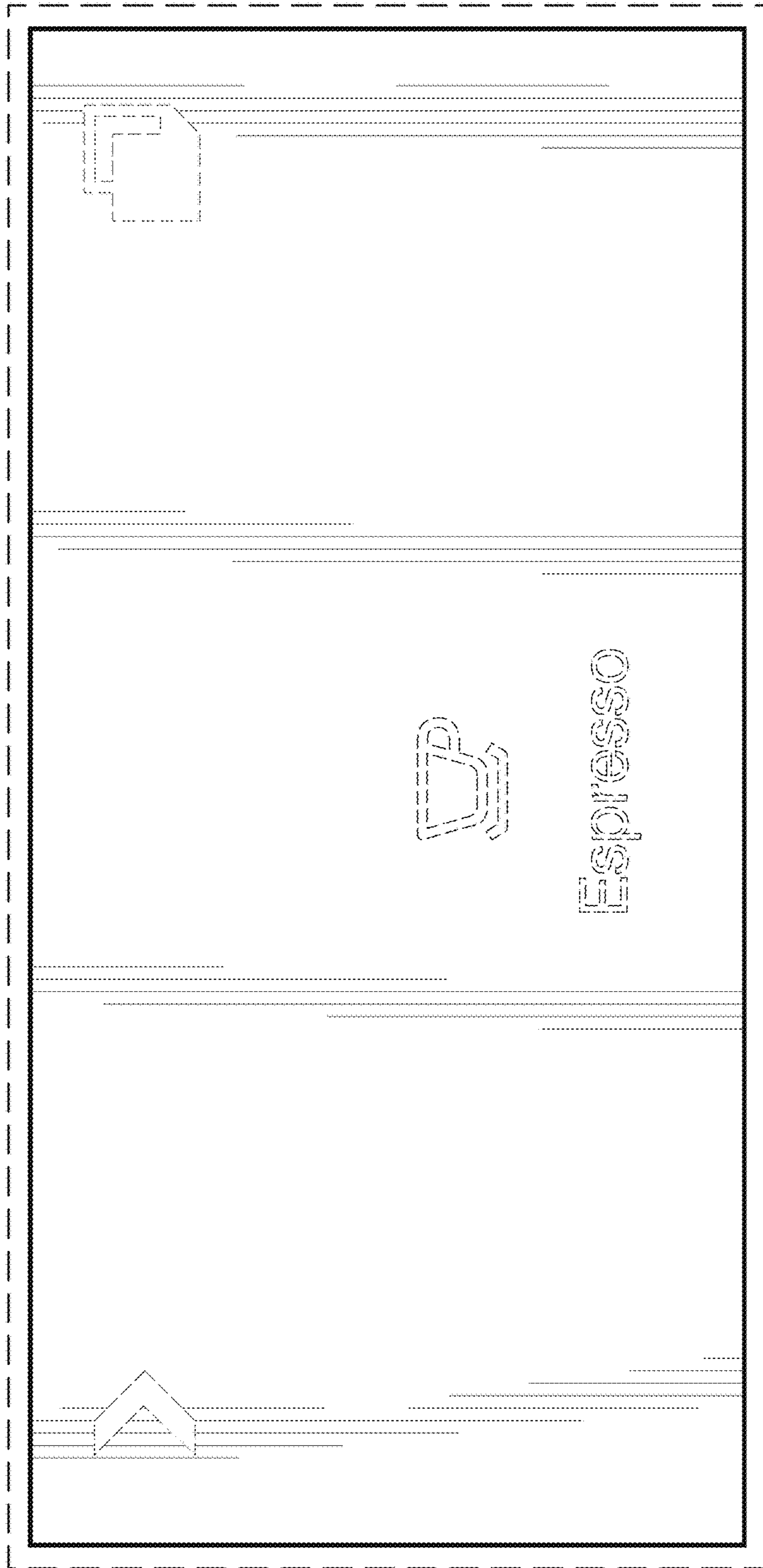

FIG. 3