



US00D773879S

(12) **United States Design Patent**
Magee et al.

(10) **Patent No.:** **US D773,879 S**

(45) **Date of Patent:** **** Dec. 13, 2016**

(54) **GRILL**

(71) Applicants: **Travis M. Magee**, Rowlett, TX (US);
Danica Magee-Jennings, Sunnyvale,
TX (US)

(72) Inventors: **Travis M. Magee**, Rowlett, TX (US);
Danica Magee-Jennings, Sunnyvale,
TX (US)

(**) Term: **14 Years**

(21) Appl. No.: **29/524,838**

(22) Filed: **Apr. 23, 2015**

(51) **LOC (10) Cl.** **07-02**

(52) **U.S. Cl.**
USPC **D7/334**

(58) **Field of Classification Search**
USPC D7/332-337, 402, 323, 327, 339-341;
D34/12, 17, 19, 20
CPC A47J 37/0704; A47J 37/0786; A47J 37/0763;
A47J 37/0713; A47J 37/0781; A47J
2037/0777; A47J 33/00; F24C 3/14; F24C
7/10; F24C 15/18; F24C 15/12; F24B
1/207
See application file for complete search history.

(56) **References Cited**

U.S. PATENT DOCUMENTS

D279,536 S * 7/1985 Braswell D7/335
D380,933 S * 7/1997 Schlosser D7/332

D388,277 S * 12/1997 Scroggins D7/332
D623,001 S * 9/2010 Lovay D7/334
D625,544 S * 10/2010 Radicke D7/334
D677,105 S * 3/2013 DeGeyter D7/332

* cited by examiner

Primary Examiner — Susan Bennett Hattan

Assistant Examiner — Brett Miller

(74) *Attorney, Agent, or Firm* — Mitchell Law PLLC;
Matthew W. Mitchell

(57) **CLAIM**

The ornamental design for a grill, as shown and described.

DESCRIPTION

FIG. 1 is a perspective view of a grill of the present invention;
FIG. 2 is another perspective view of the invention of FIG. 1;
FIG. 3 is a front view of the invention of FIG. 1;
FIG. 4 is a back view of the invention of FIG. 1;
FIG. 5 is a side view of the invention of FIG. 1, as seen from the left side of FIG. 3;
FIG. 6 is a side view of the invention of FIG. 1, as seen from the right side of FIG. 3; and,
FIG. 7 is a top view of the invention of FIG. 1.
The broken lines showing a wheeled-base are included for contextual purposes and form no part of the claimed design.

1 Claim, 4 Drawing Sheets

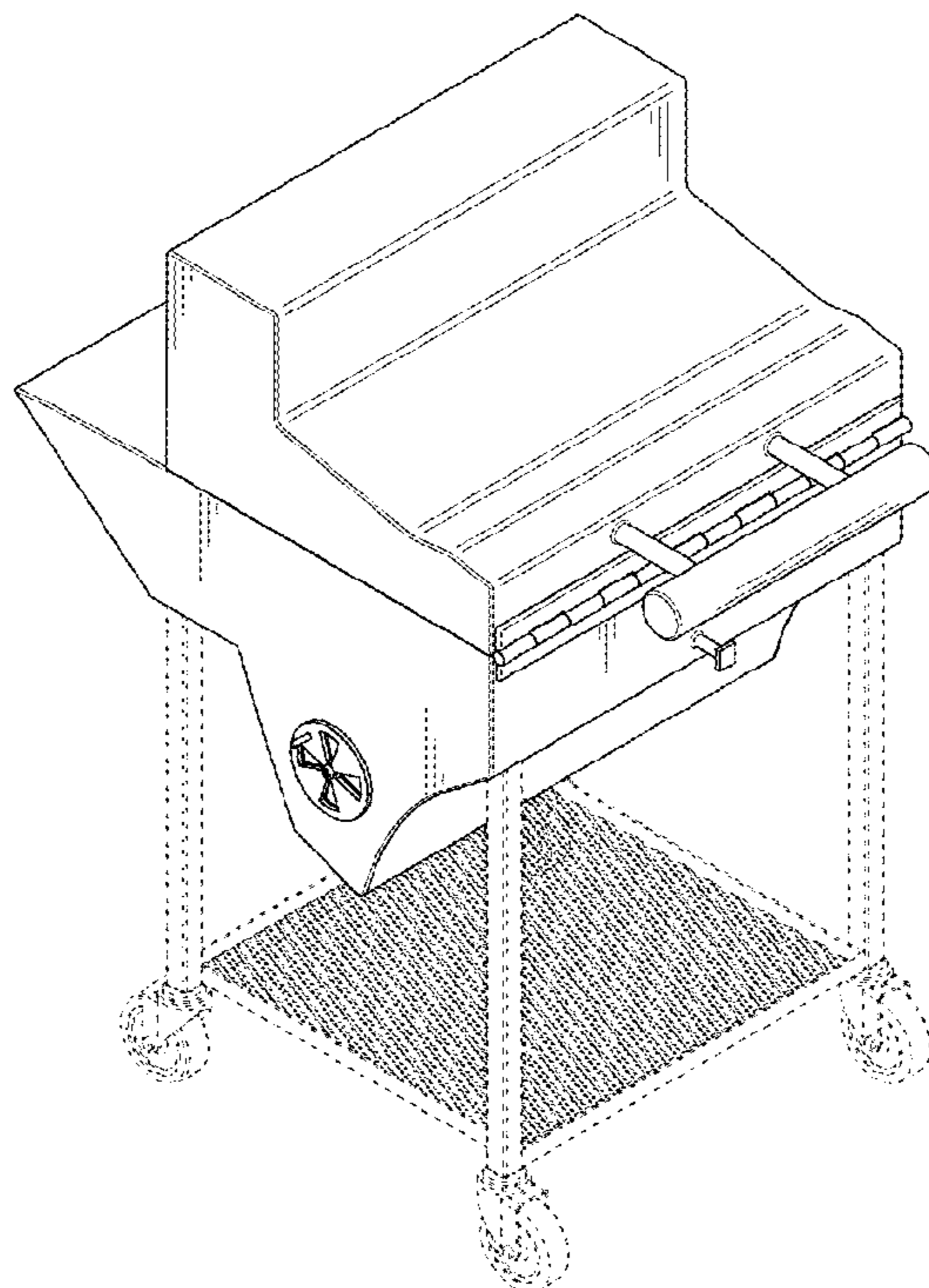

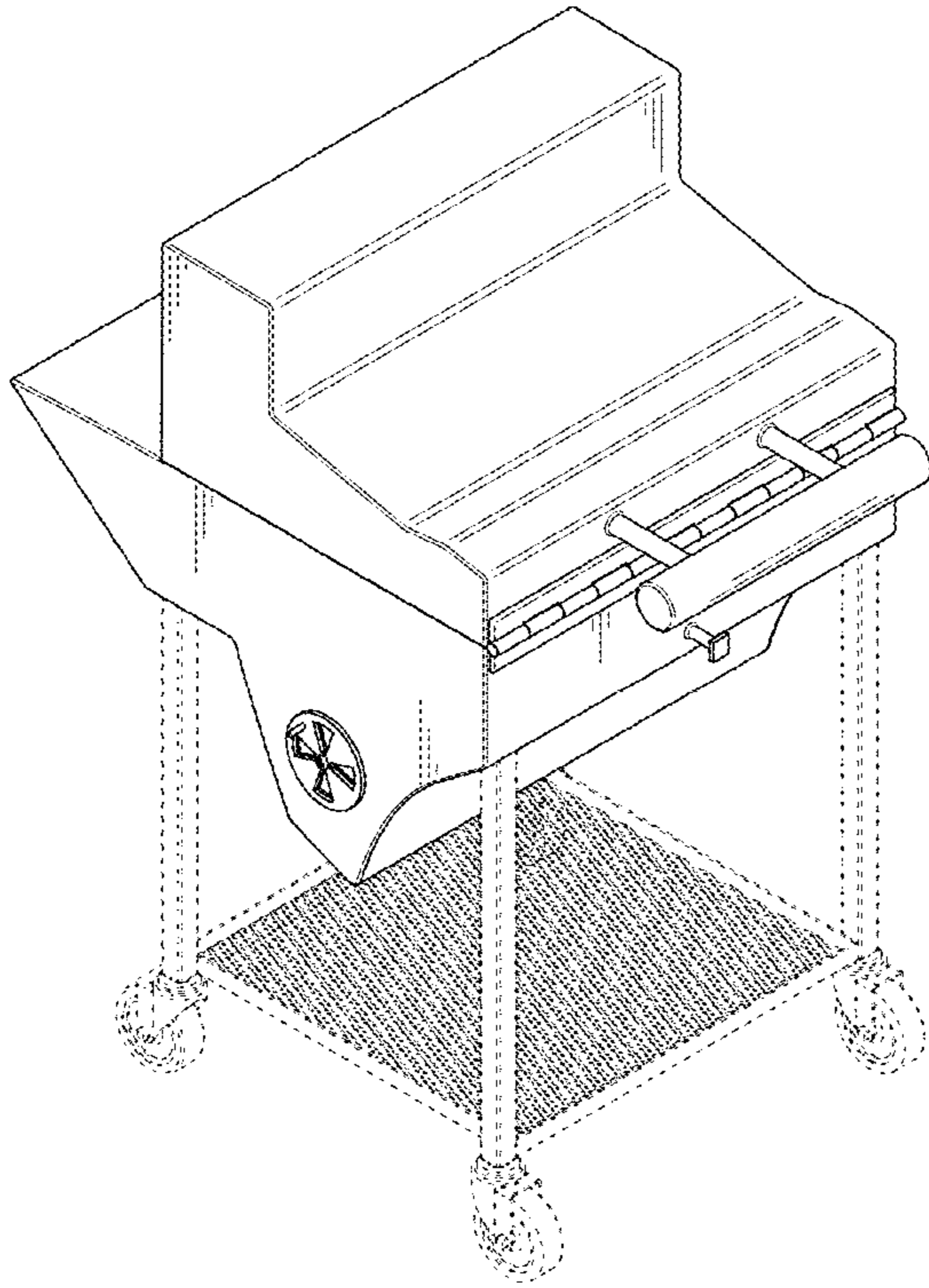

FIG. 1

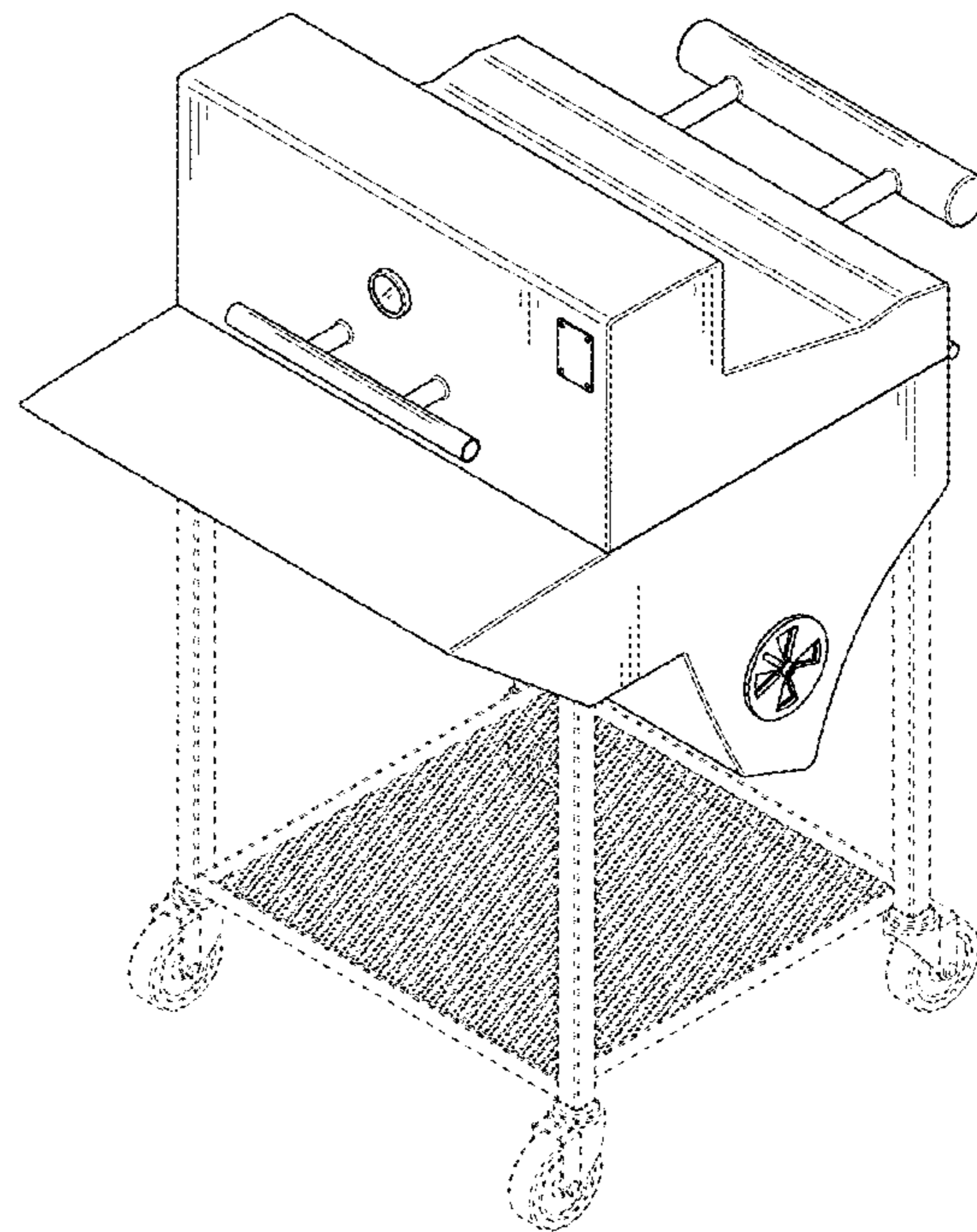

FIG. 2

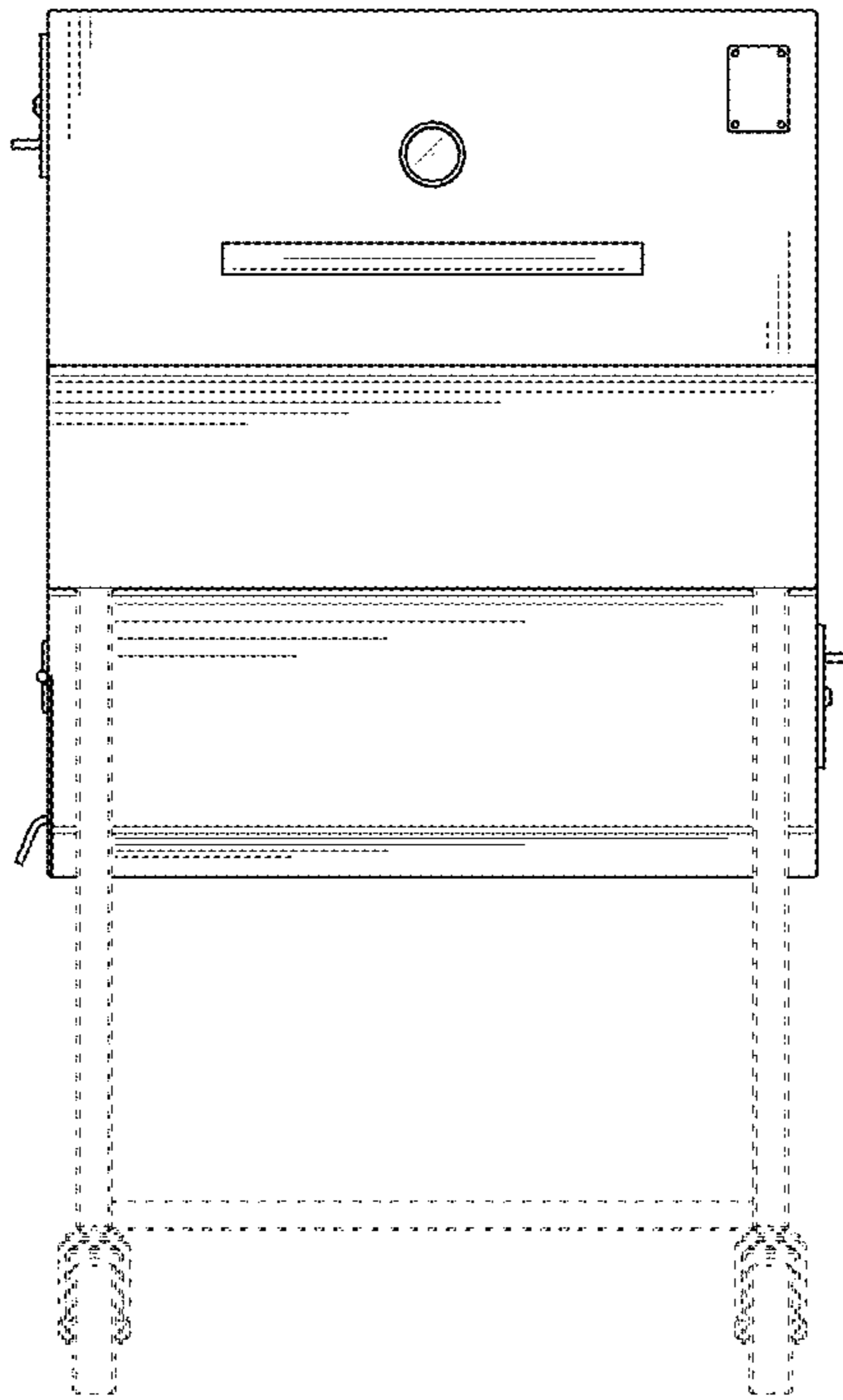

FIG. 3

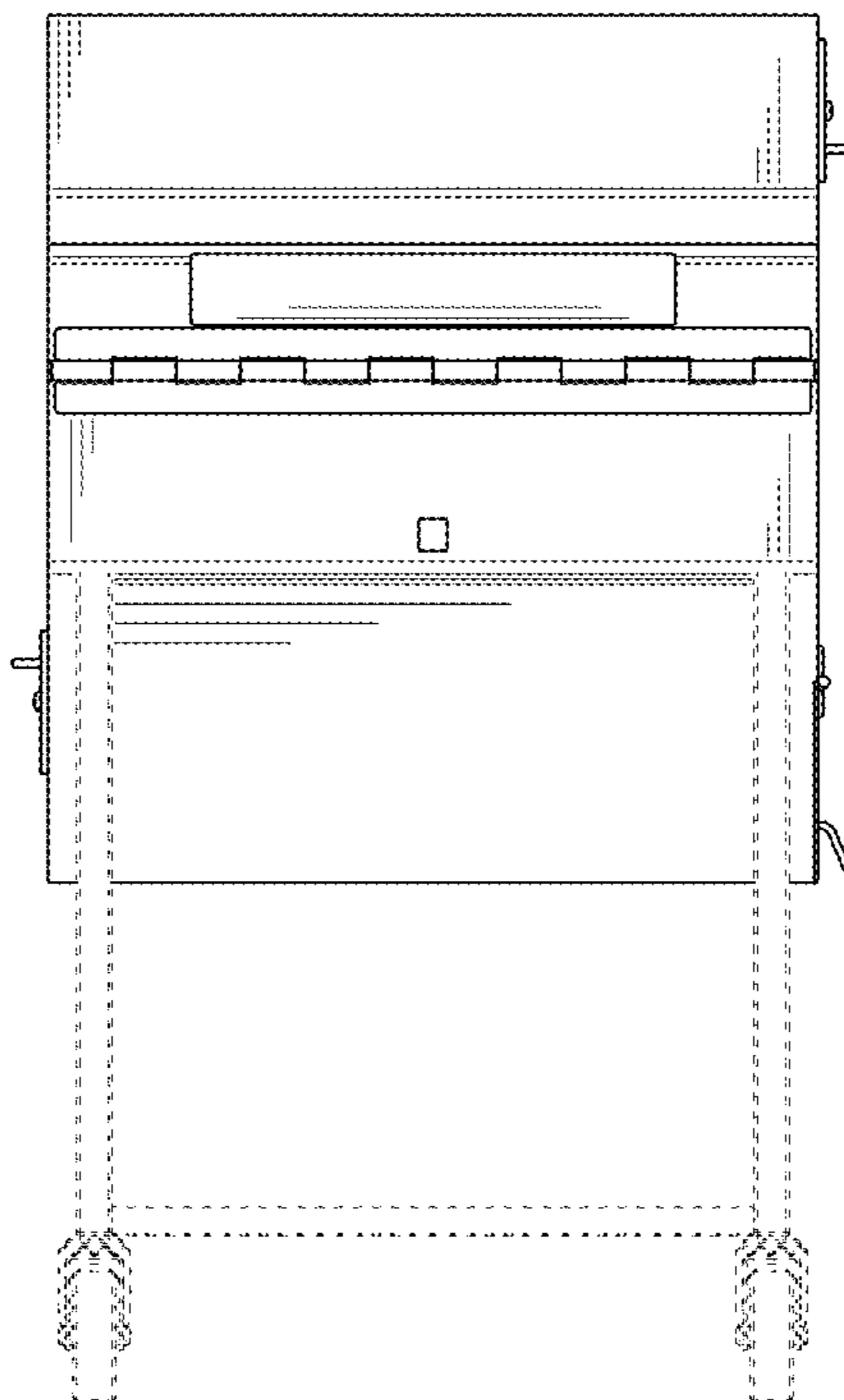

FIG. 4

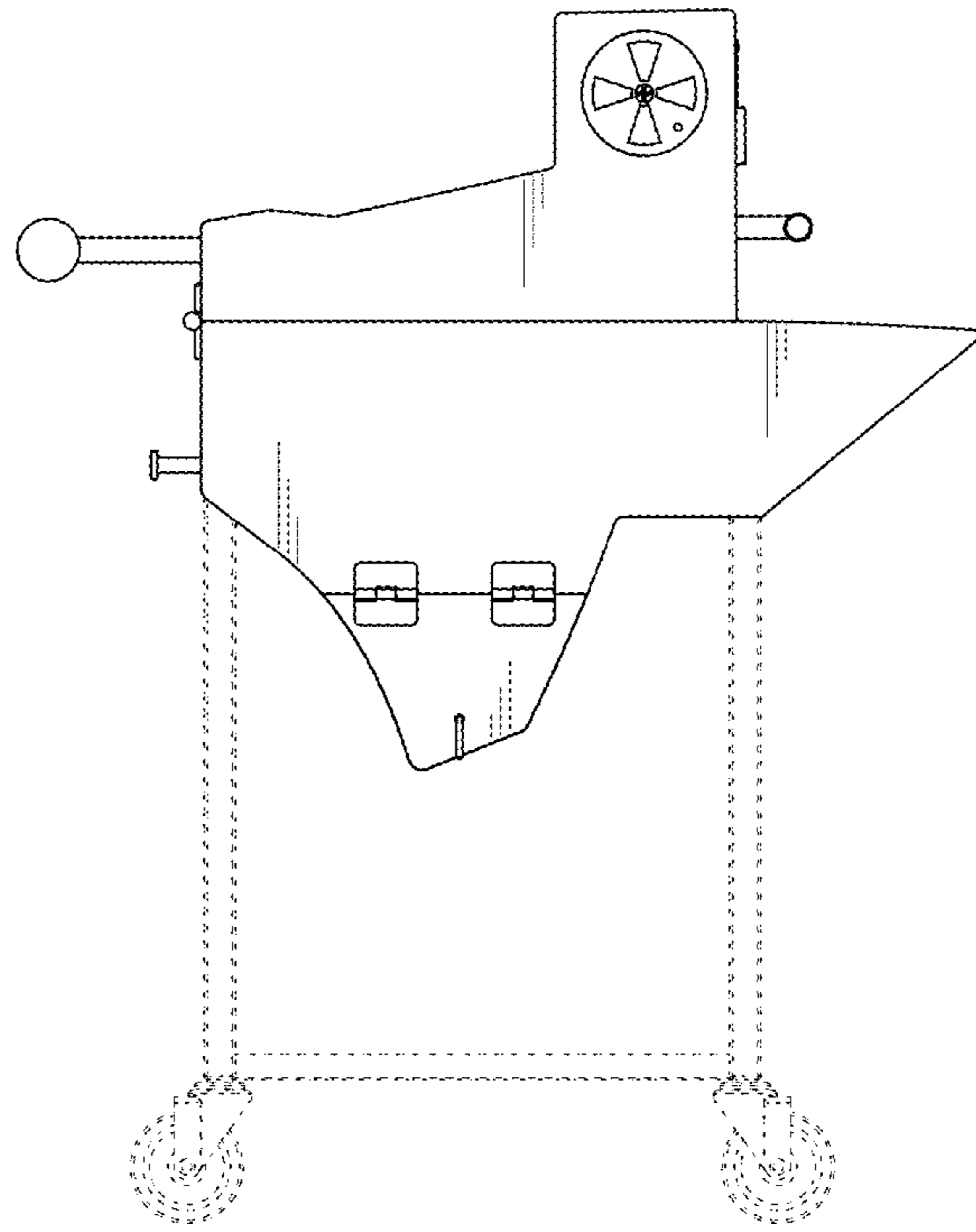

FIG. 5

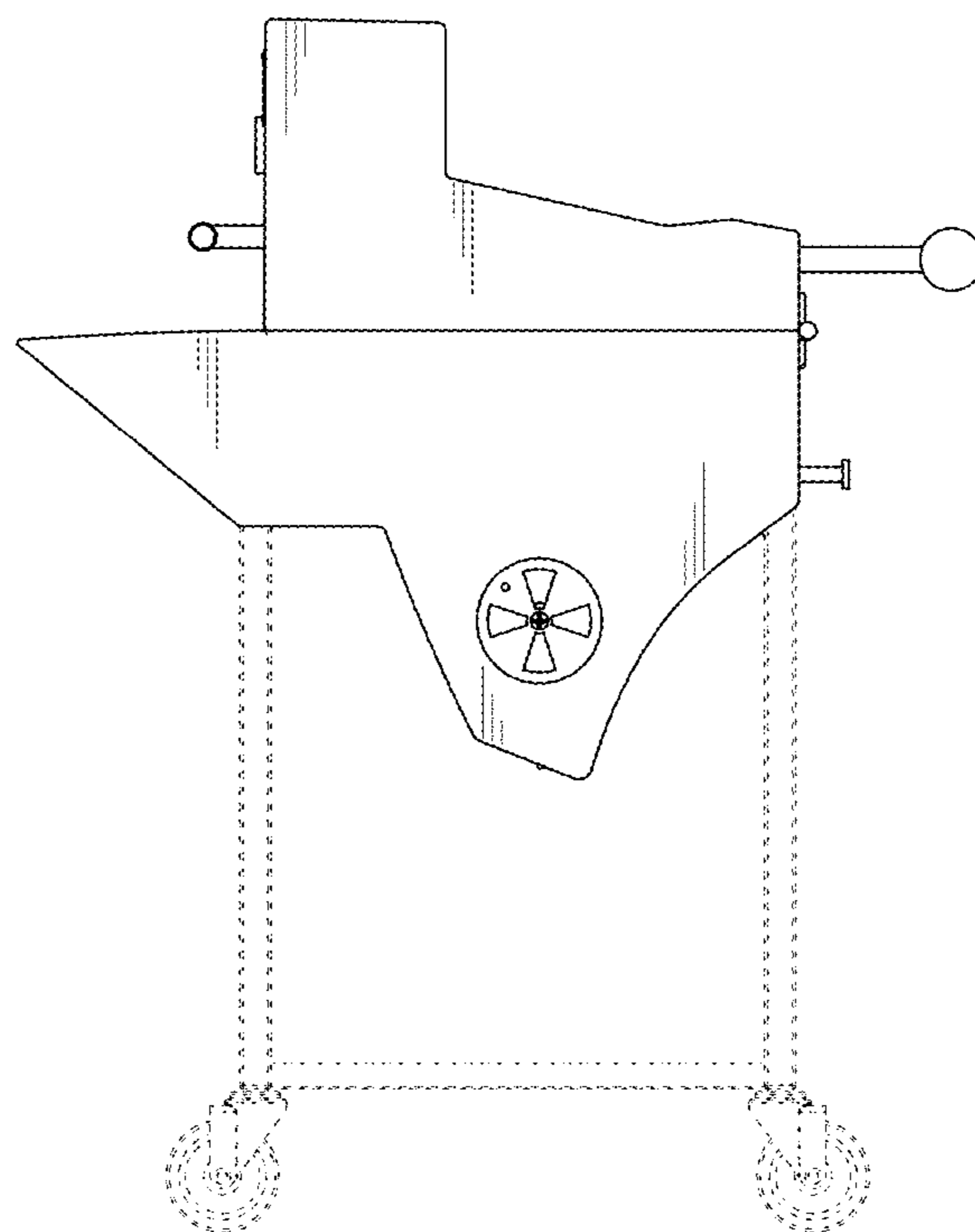

FIG. 6

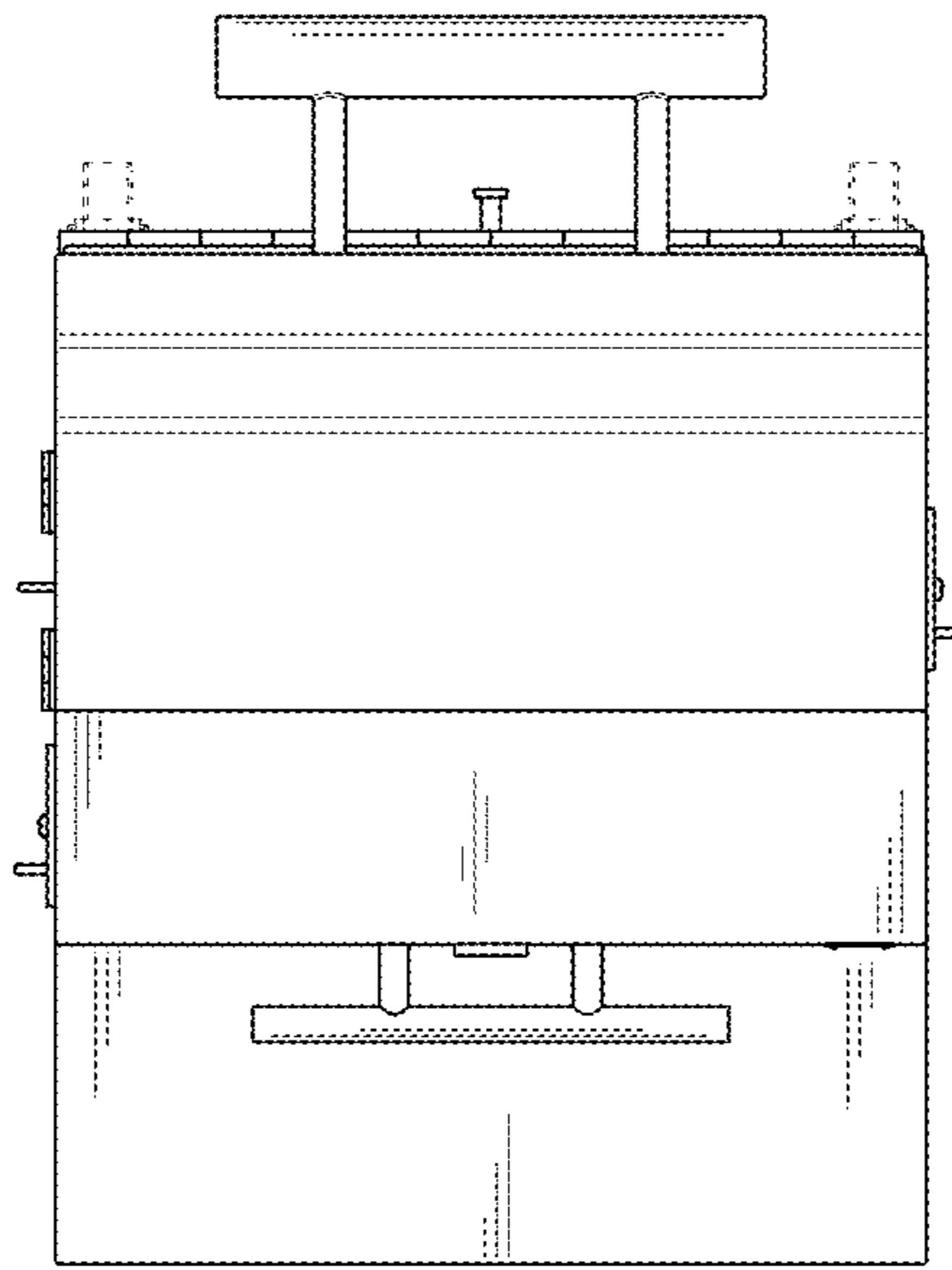

FIG. 7