



US00D773358S

(12) **United States Design Patent**
Rodriguez

(10) **Patent No.:** **US D773,358 S**

(45) **Date of Patent:** **** Dec. 6, 2016**

- (54) **HOOD FOR AN AUTOMOBILE**
- (71) Applicant: **Nissan Motor Co., Ltd.**, Yokohama, Kanagawa (JP)
- (72) Inventor: **Randy Rodriguez**, San Diego, CA (US)
- (73) Assignee: **Nissan Motor Co., Ltd.**, Yokohama (JP)

D722,928 S * 2/2015 George D12/173
 D756,864 S * 5/2016 Ino D12/173
 D762,534 S * 8/2016 Faghihzadeh D12/173

FOREIGN PATENT DOCUMENTS

JP D1066728 S 4/2000
 JP D1110939 S 6/2001
 JP D1190405 S 11/2003

(Continued)

Primary Examiner — Melody N Brown

(74) *Attorney, Agent, or Firm* — Global IP Counselors, LLP

- (**) Term: **14 Years**
- (21) Appl. No.: **29/525,544**
- (22) Filed: **Apr. 30, 2015**

(57) **CLAIM**

The ornamental design for a hood for an automobile, as shown and described.

(30) **Foreign Application Priority Data**

Nov. 12, 2014 (JP) 2014-025241

(51) **LOC (10) Cl.** **12-16**

(52) **U.S. Cl.**
USPC **D12/173**

(58) **Field of Classification Search**
 USPC .. D12/173, 196, 86, 90-92, 181; 180/69.21, 69.2, 69.22; 296/190.1-190.5, 296/190.8, 193.11, 37.6
 CPC B62D 25/10; B62D 25/06; B62D 65/02; B62D 25/12; B60Q 1/00
 See application file for complete search history.

DESCRIPTION

FIG. 1 is a front elevational view of a hood for an automobile in accordance with our new design;
 FIG. 2 is a top plan view thereof;
 FIG. 3 is a cross sectional view thereof, taken in the direction of line 3-3' of FIG. 2;
 FIG. 4 is a cross sectional view thereof, taken in the direction of line 4-4' of FIG. 2;
 FIG. 5 is a cross sectional view thereof, taken in the direction of line 5-5' of FIG. 2;
 FIG. 6 is a cross sectional view thereof, taken in the direction of line 6-6' of FIG. 2;
 FIG. 7 is a bottom plan view thereof;
 FIG. 8 is a right side elevational view thereof;
 FIG. 9 is a left side elevational view thereof;
 FIG. 10 is a top, front and right side perspective view thereof; and,
 FIG. 11 is a rear elevational view thereof.
 The bottom view and bottom surfaces of the hood form no part of the claimed design since the bottom view and bottom surfaces are hidden when the hood is mounted to an automobile.

(56) **References Cited**

U.S. PATENT DOCUMENTS

D678,148 S 3/2013 Terada et al.
 D683,286 S * 5/2013 Fuchigami D12/173
 D683,287 S * 5/2013 Yoshida D12/173
 D685,303 S * 7/2013 Tani D12/173
 D685,700 S * 7/2013 Tase D12/173
 D688,995 S * 9/2013 Hildebrand D12/173
 D695,169 S 12/2013 Endo
 D695,645 S * 12/2013 Tase D12/91
 D709,005 S * 7/2014 Koizumi D12/173

1 Claim, 11 Drawing Sheets

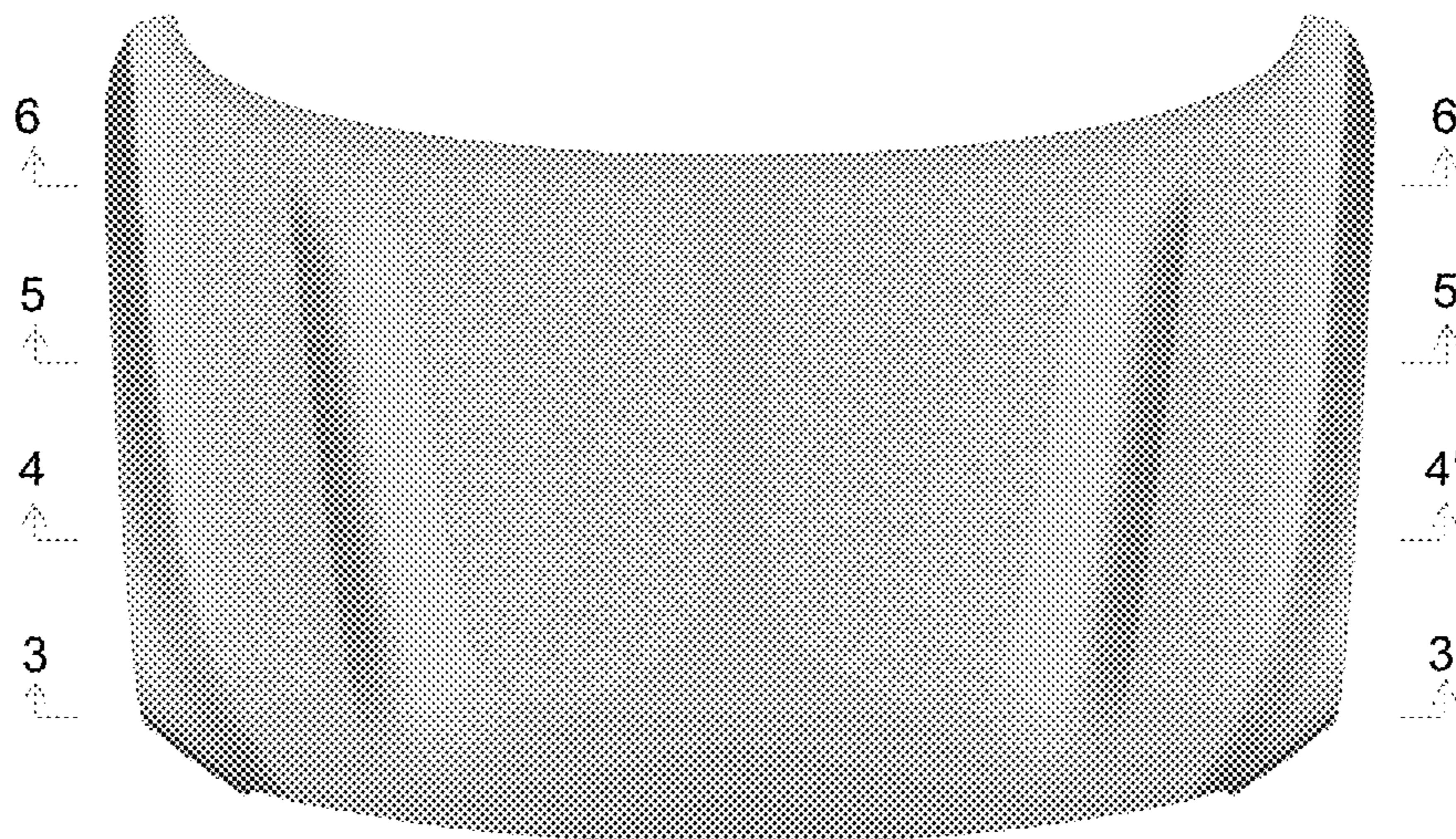

(56)

References Cited

FOREIGN PATENT DOCUMENTS

JP	D1214497 S	8/2004
JP	D1334926 S	7/2008
JP	D1377812 S	1/2010
JP	D1380443 S	2/2010
JP	D1400019 S	11/2010
JP	D1445035 S	6/2013
JP	D1472973 S	6/2013
JP	D1486864 S	12/2013
JP	D1489461 S	2/2015

* cited by examiner

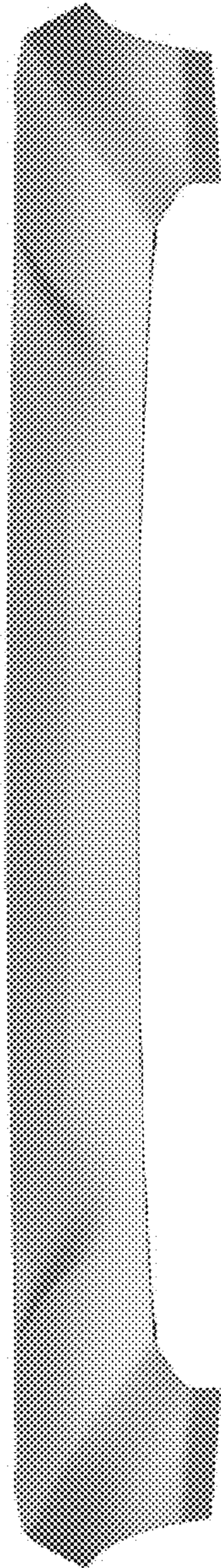

FIG. 1



FIG. 2

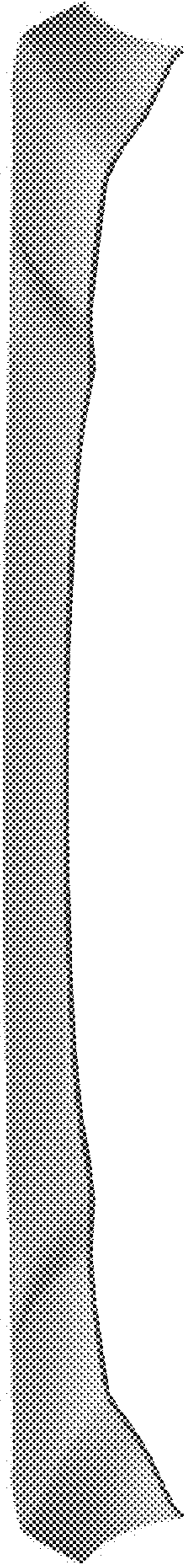

FIG. 3

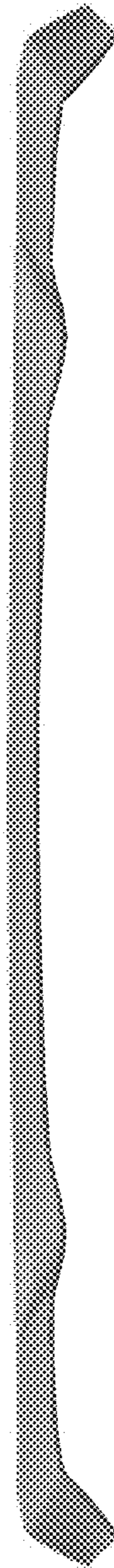

FIG. 4



FIG. 5



FIG. 6

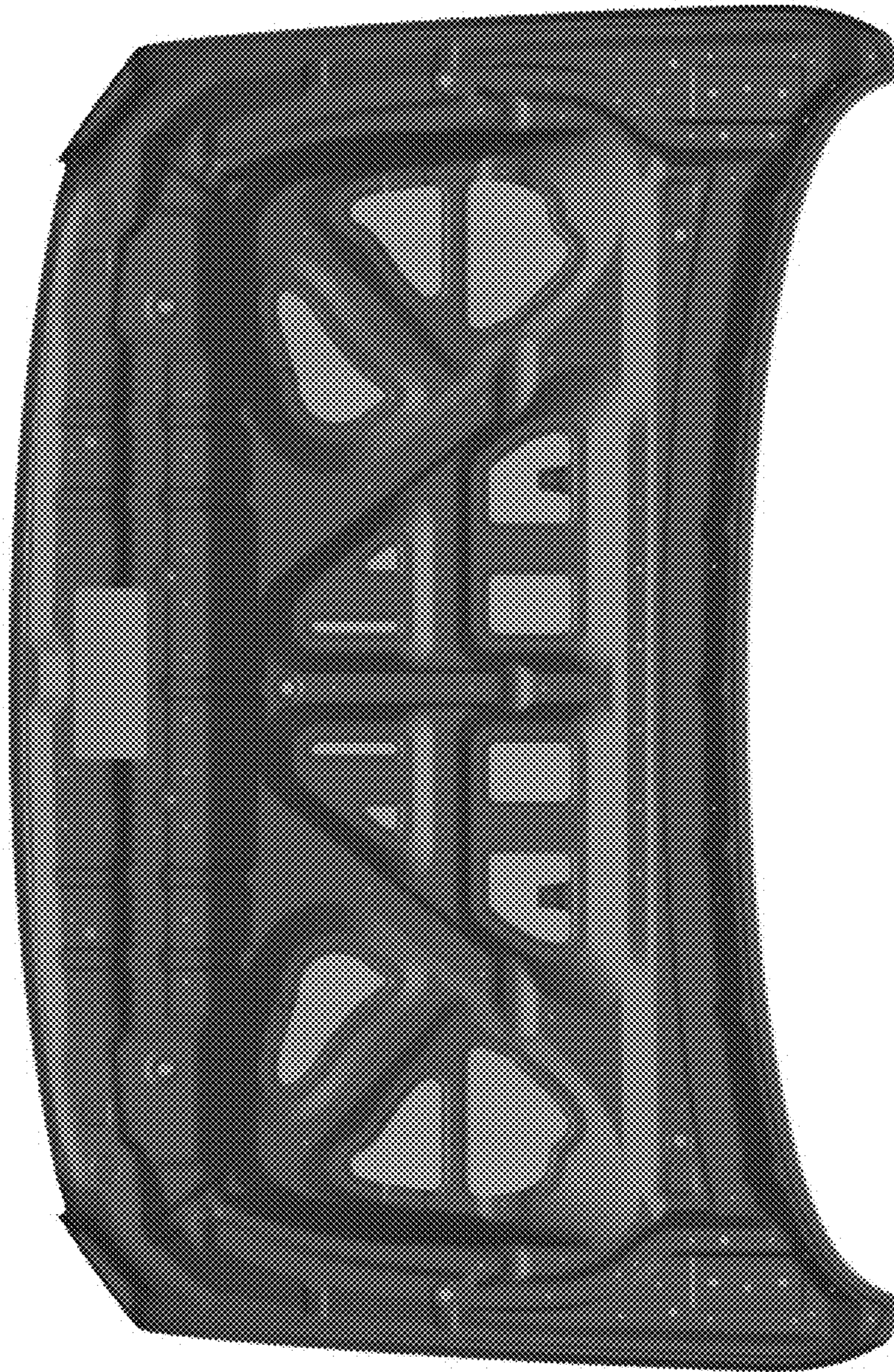

FIG. 7

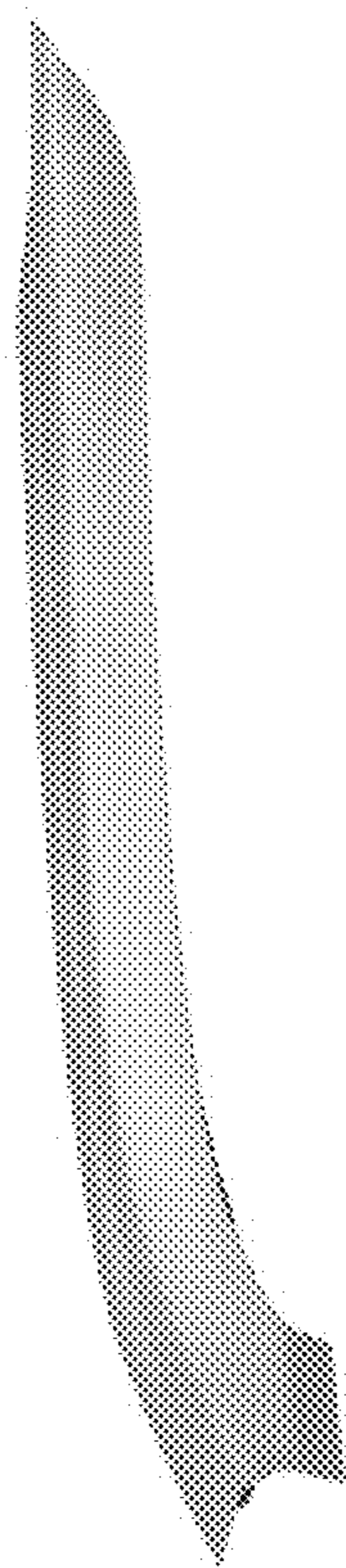

FIG. 8

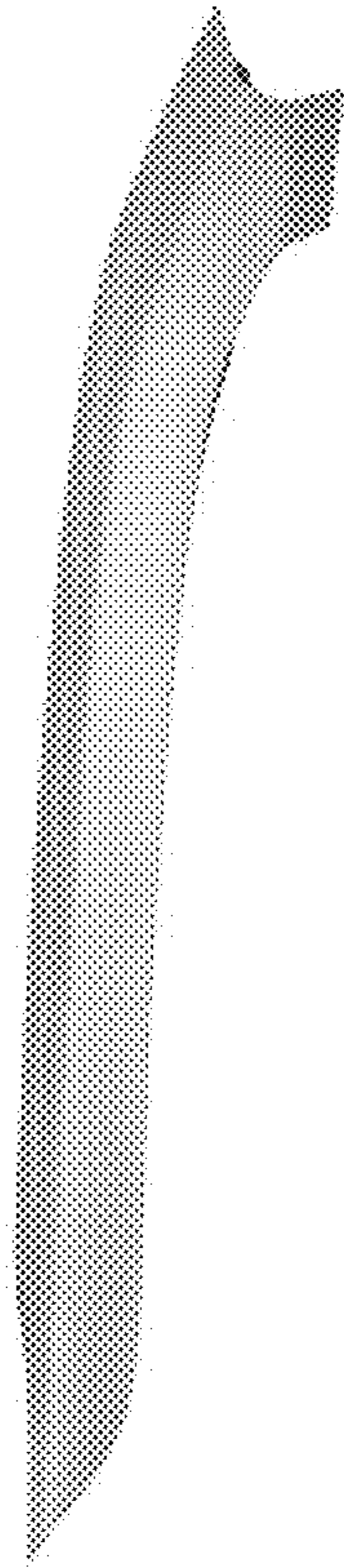

FIG. 9

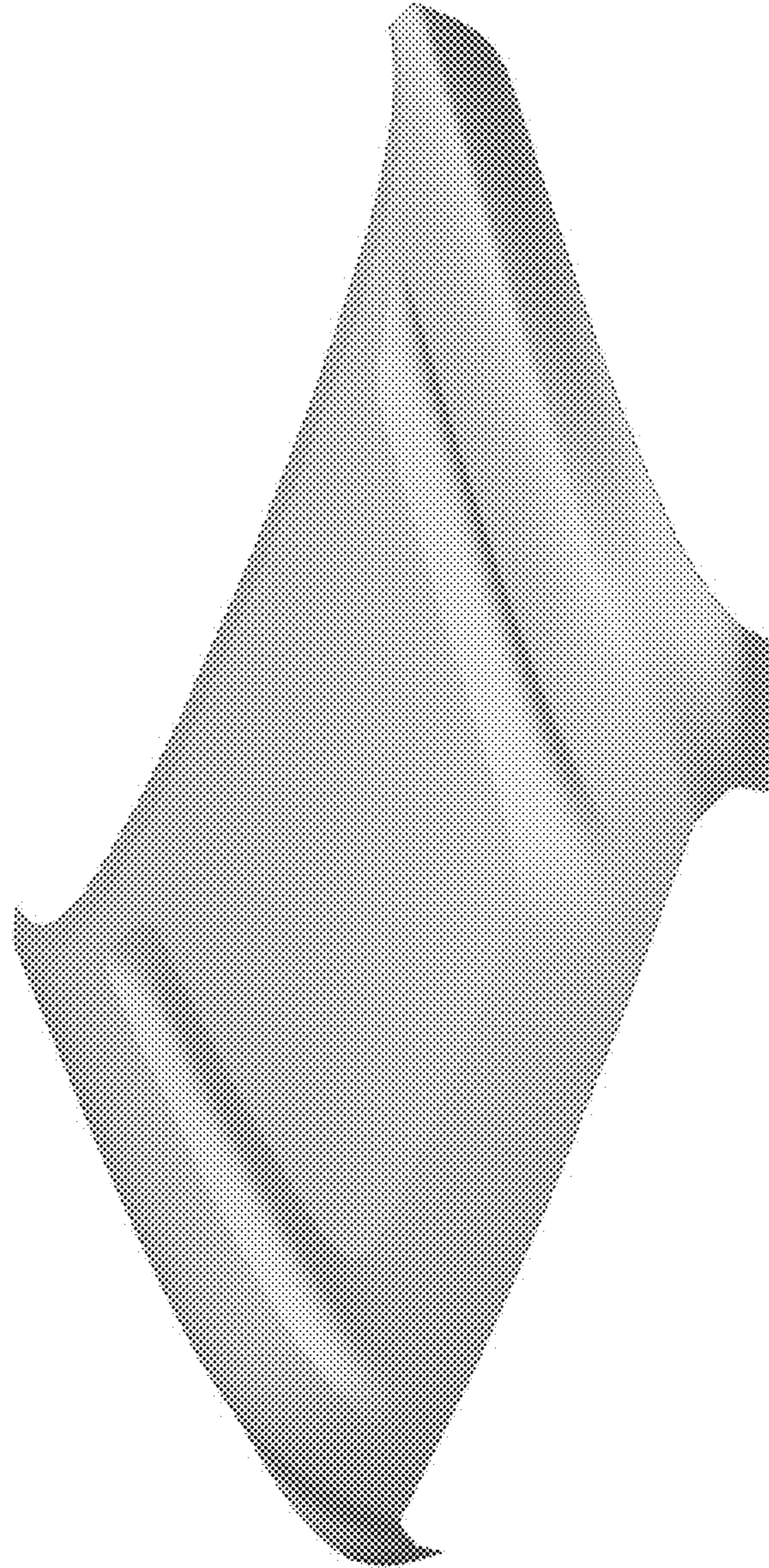

FIG. 10



FIG. 11