



US00D773083S

(12) **United States Design Patent** (10) **Patent No.:** **US D773,083 S**
Iwai et al. (45) **Date of Patent:** **** Nov. 29, 2016**

(54) **REAR COMBINATION LAMP FOR A MOTOR VEHICLE**

D635,698 S * 4/2011 Jeong D26/28
D652,550 S * 1/2012 Cho D26/28
D714,985 S * 10/2014 Moon D26/28

(71) Applicants: **Tatsuya Iwai**, Nisshin (JP); **Koichi Suga**, Toyota (JP)

OTHER PUBLICATIONS

(72) Inventors: **Tatsuya Iwai**, Nisshin (JP); **Koichi Suga**, Toyota (JP)

Netcarshow.com; URL: <http://www.netcarshow.com/lexus/2015-rc/>; Model: Lexus RC (2015); Mfg.: Lexus; available on at least Apr. 8, 2014.

(73) Assignee: **Toyota Jidosha Kabushiki Kaisha**, Toyota-shi, Aichi-ken (JP)

Netcarshow.com; URL: <http://www.netcarshow.com/bmw/2014-x5/>; Model: BMW X5 (2014); Mfg.: BMW; available on at least Apr. 8, 2014.

(**) Term: **15 Years**

Netcarshow.com; URL: http://www.netcarshow.com/bmw/2014-m235i_coupe/; Model: BMW M235I coupe (2014); available on at least Apr. 8, 2014.

(21) Appl. No.: **29/536,834**

* cited by examiner

(22) Filed: **Aug. 19, 2015**

Primary Examiner — Marcus Jackson

(30) **Foreign Application Priority Data**

(74) *Attorney, Agent, or Firm* — Finnegan, Henderson, Farabow, Garrett & Dunner, LLP

Feb. 20, 2015 (JP) 2015-003450

(51) **LOC (10) Cl.** **26-06**

(52) **U.S. Cl.**

USPC **D26/28**

(58) **Field of Classification Search**

USPC D26/28-36; 362/459-468, 475-478, 362/485-487

CPC F21S 48/00; F21S 48/10; F21S 48/115; F21S 48/225; F21S 48/1233; F21S 48/1266; F21S 48/1388; F21S 48/2268; F21V 21/04

See application file for complete search history.

(56) **References Cited**

U.S. PATENT DOCUMENTS

D526,427 S * 8/2006 Morioka D26/28
D595,880 S * 7/2009 Lamm D26/28

(57) **CLAIM**

The ornamental design for a rear combination lamp for a motor vehicle, as shown and described.

DESCRIPTION

FIG. 1 is a front perspective view of a rear combination lamp for a motor vehicle showing our new design; FIG. 2 is a front view thereof; FIG. 3 is a rear perspective view thereof; FIG. 4 is a right side elevation view thereof; FIG. 5 is a left side elevation view thereof; FIG. 6 is a top plan view thereof; and, FIG. 7 is a bottom view thereof. Our design includes a mirror image of the embodiment depicted.

1 Claim, 7 Drawing Sheets

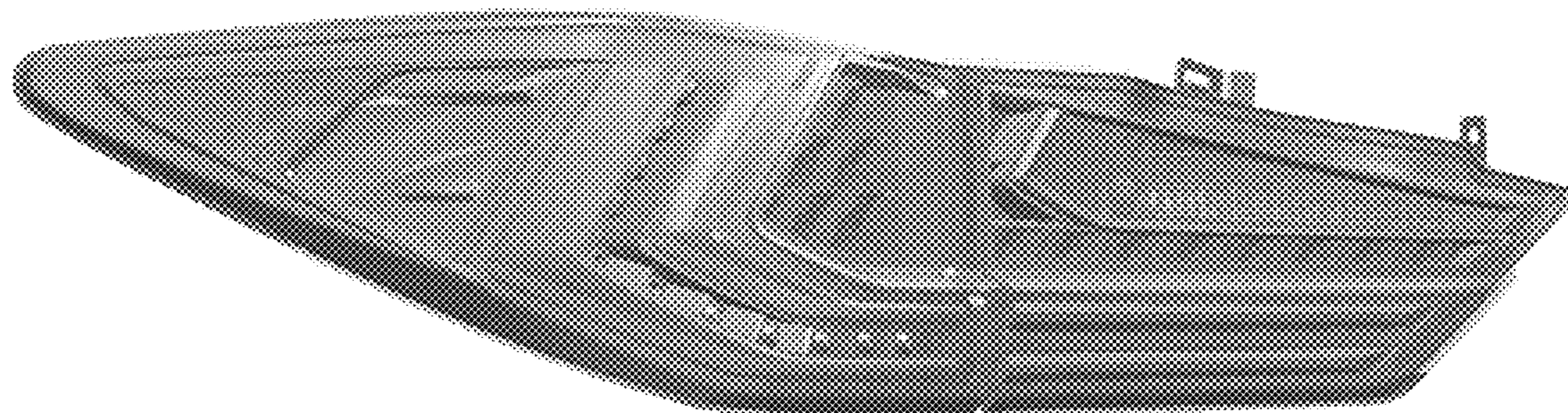

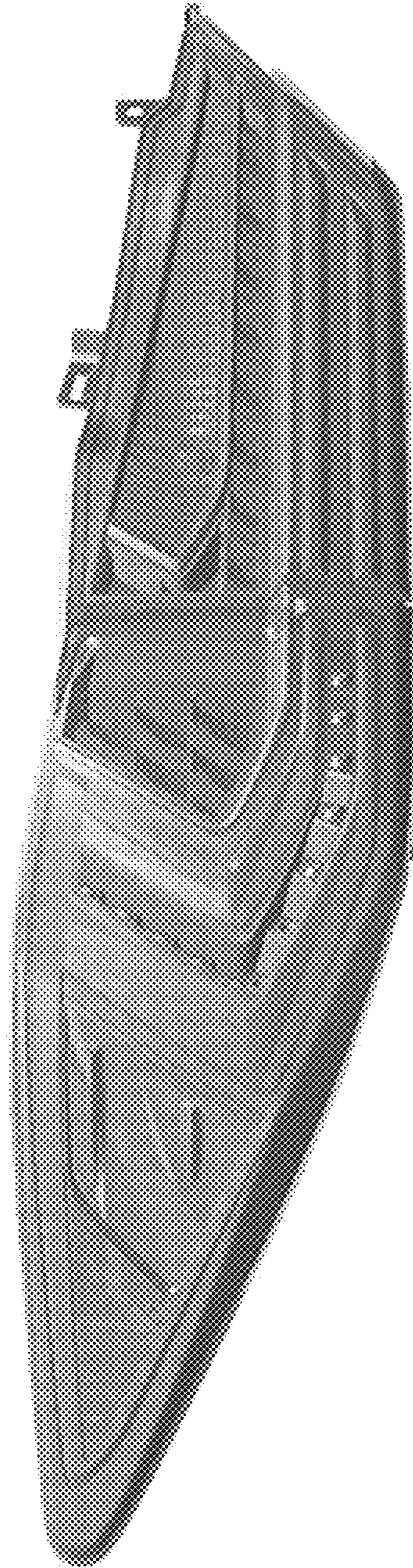

FIG. 1

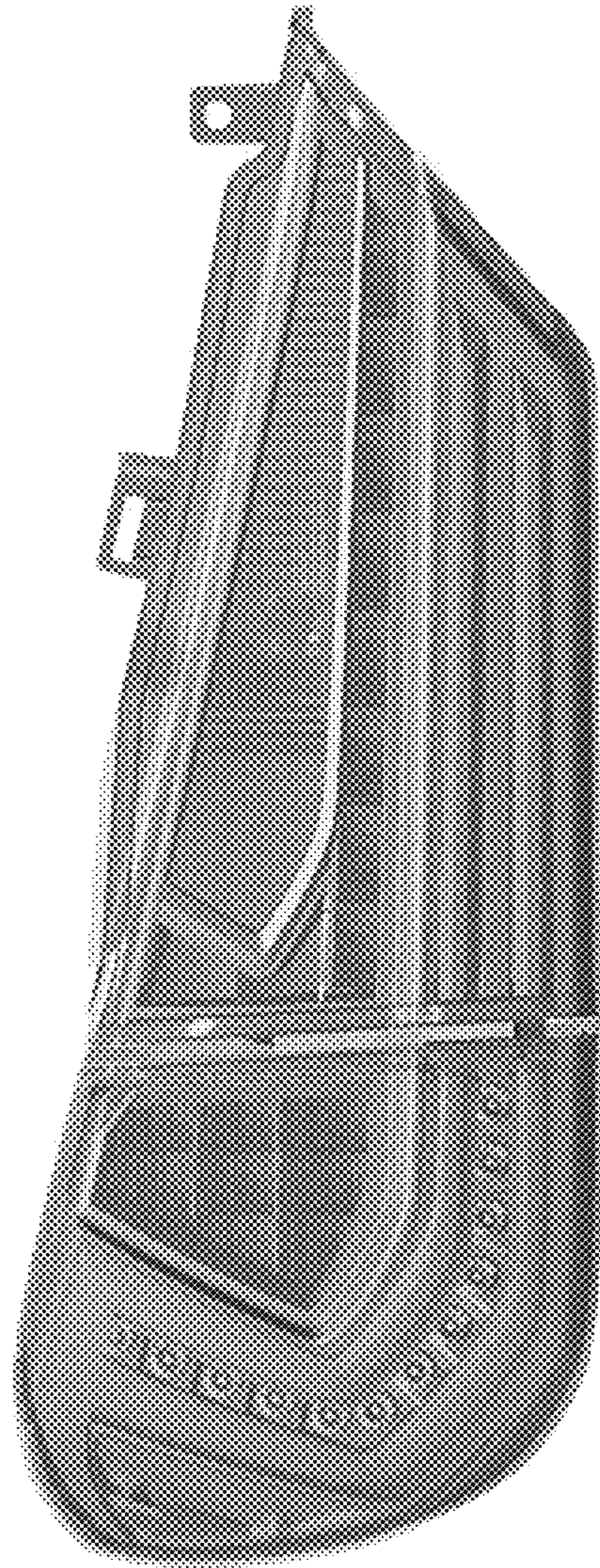

FIG. 2

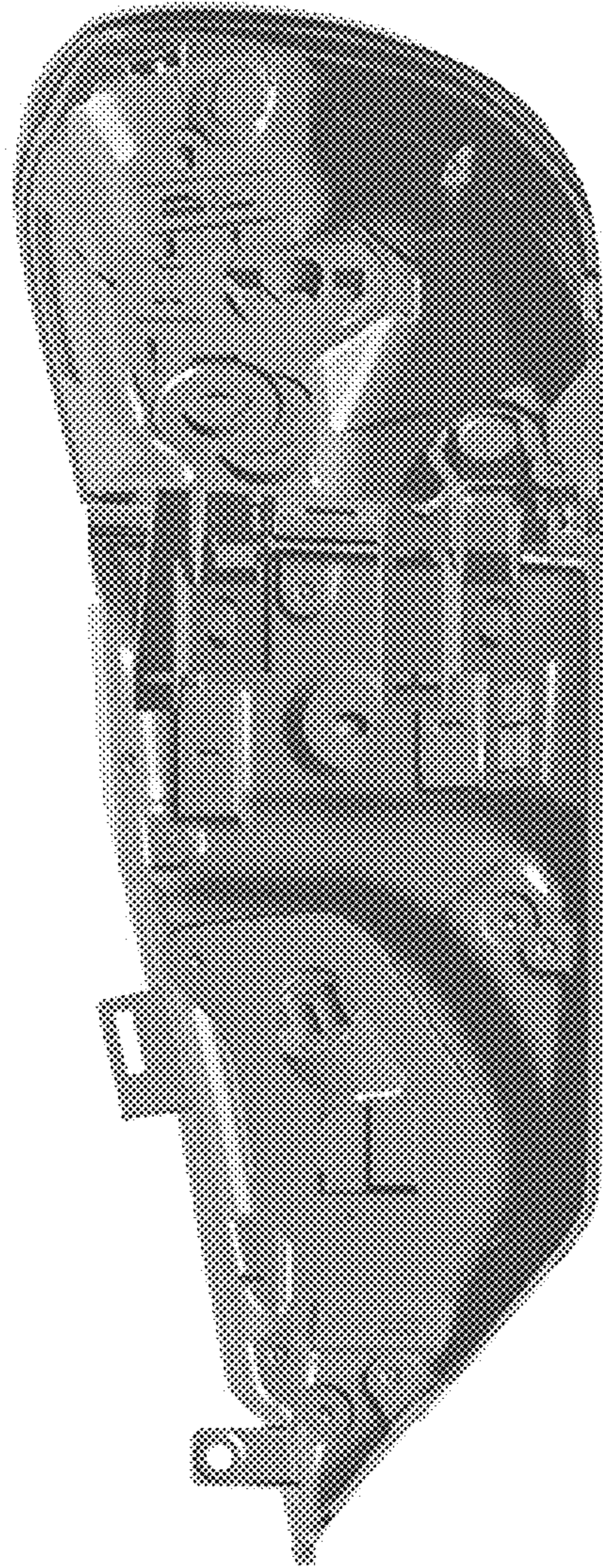

FIG. 3

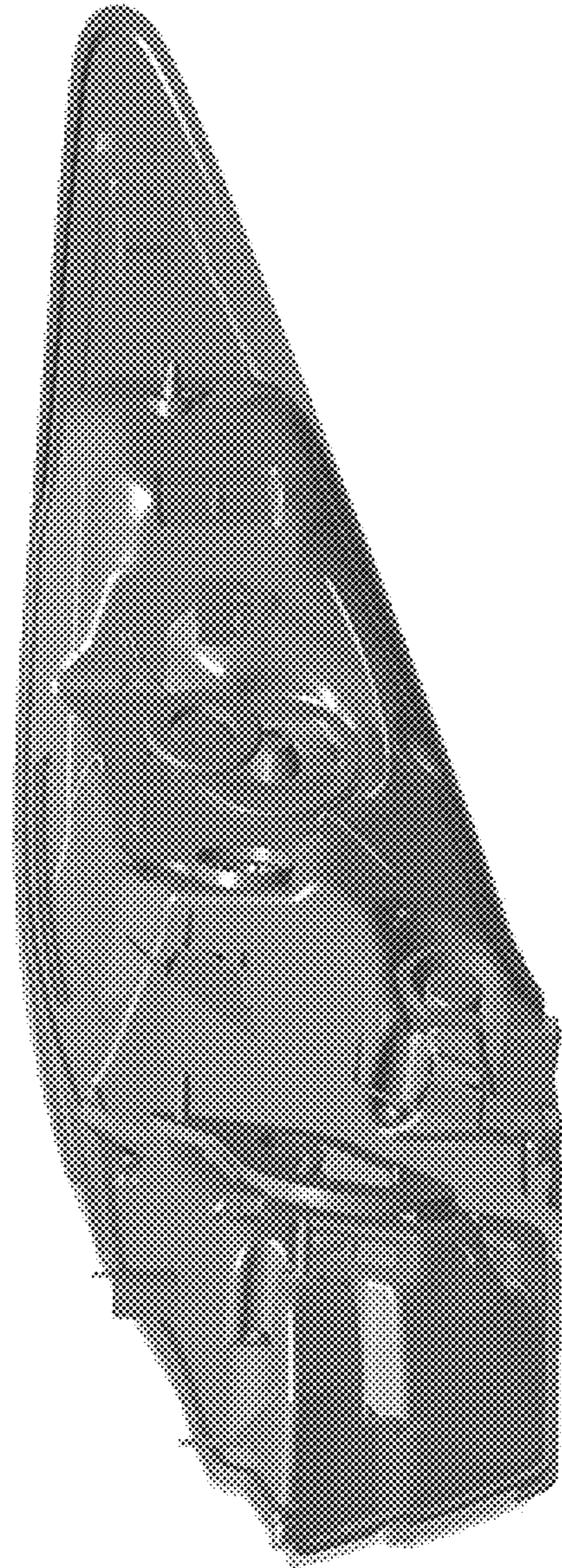

FIG. 4

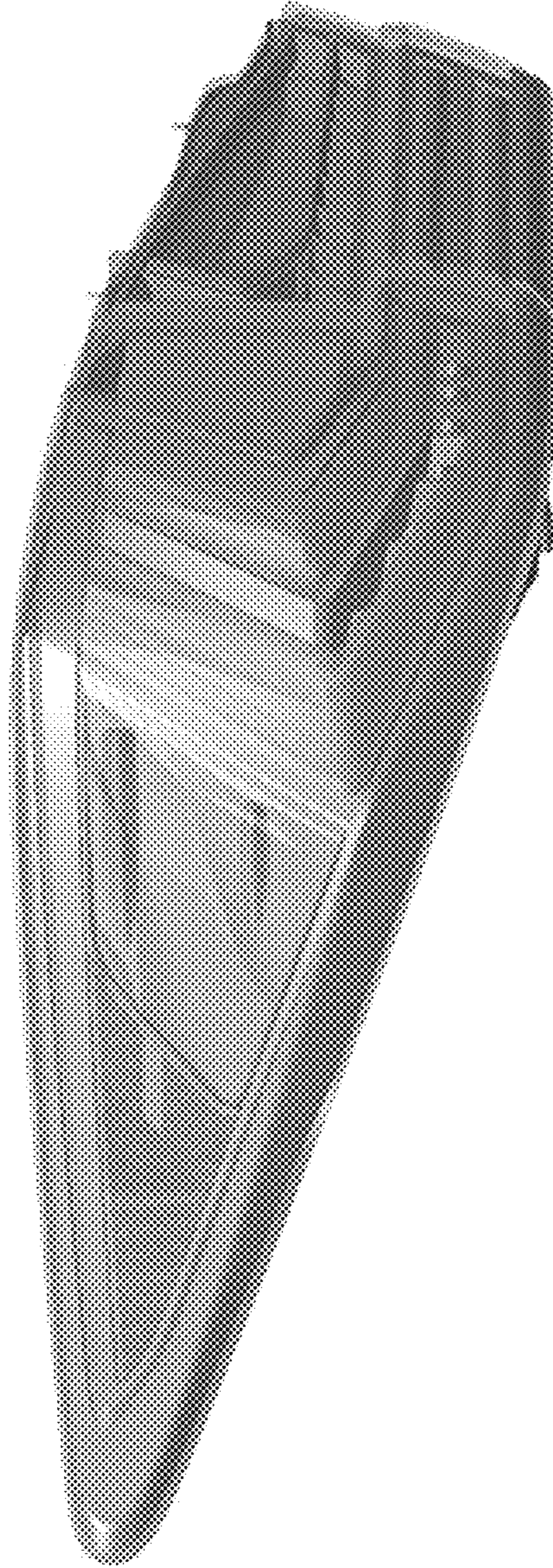

FIG. 5

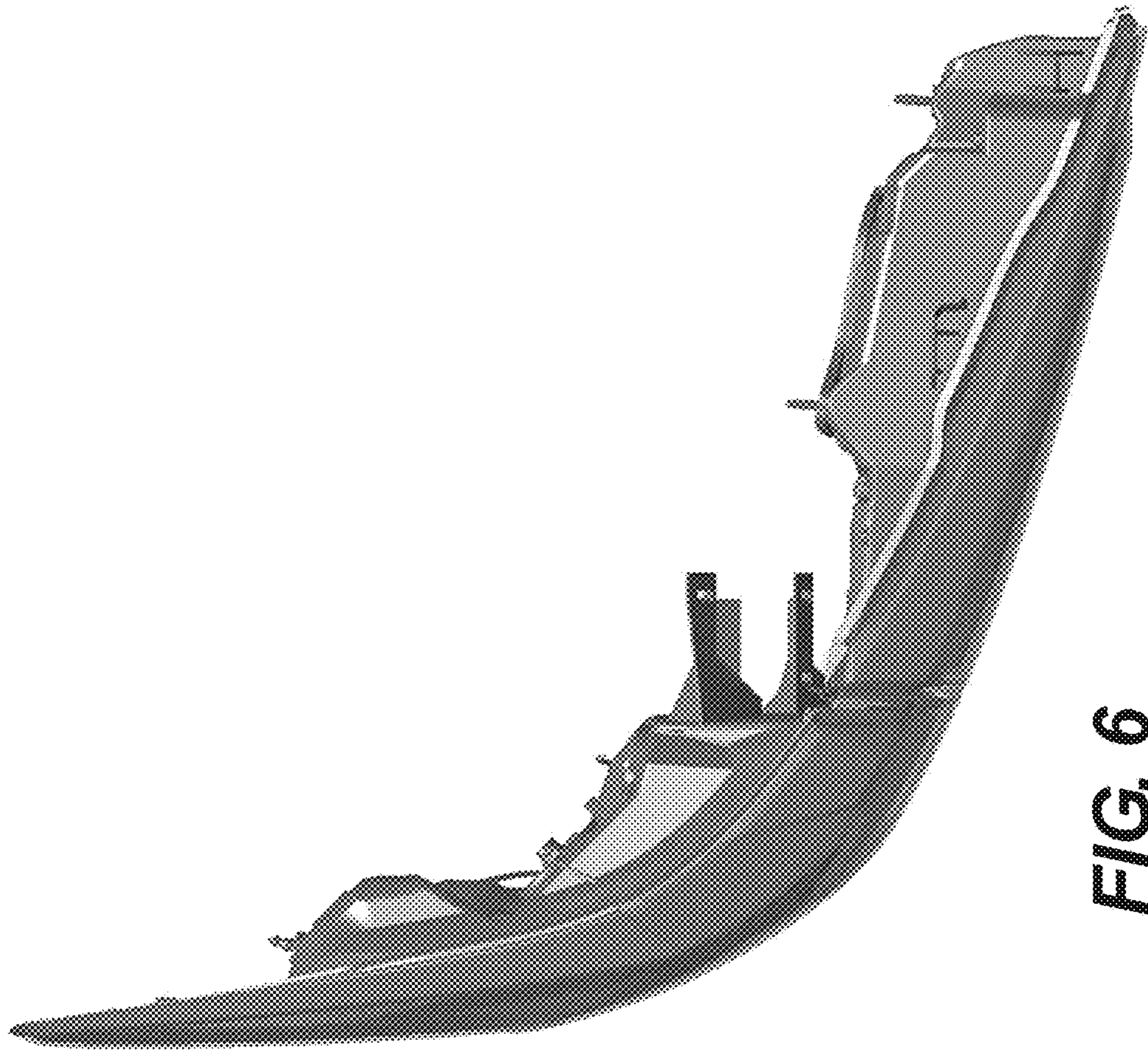

FIG. 6

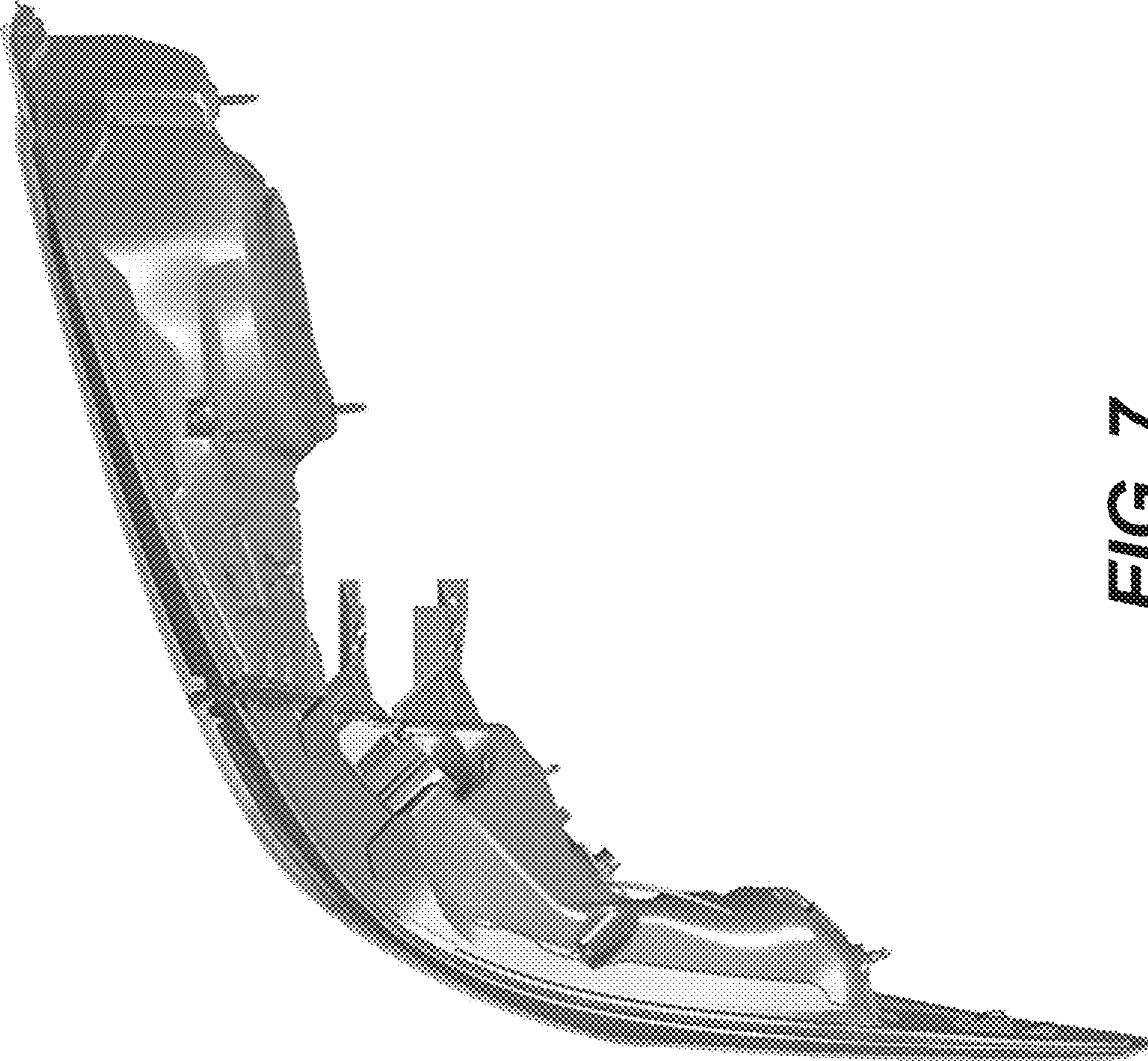

FIG. 7