



US00D771457S

(12) **United States Design Patent**
Guardia

(10) **Patent No.:** **US D771,457 S**

(45) **Date of Patent:** **** Nov. 15, 2016**

- (54) **CERAMIC FLOOR CUTTER**
- (71) Applicant: **Cortag Industria e Comercio Ltda,**
Mogi Mirim (BR)
- (72) Inventor: **Carlos Manoel Guardia,** Mogi Mirim
(BR)
- (73) Assignee: **Cortag Industria e Comercio Ltda,**
Morgi Mirim (BR)
- (**) Term: **15 Years**
- (21) Appl. No.: **29/537,310**
- (22) Filed: **Aug. 25, 2015**
- (30) **Foreign Application Priority Data**
Feb. 27, 2015 (BR) 3020150008989
- (51) **LOC (10) Cl.** **08-05**
- (52) **U.S. Cl.**
USPC **D8/51; D15/127**
- (58) **Field of Classification Search**
USPC D8/51, 98; D15/127
CPC B23D 1/225; Y10T 225/325; Y10T
83/0385; Y10T 83/3648; C03B 33/10
See application file for complete search history.

(56) **References Cited**

U.S. PATENT DOCUMENTS			
D291,578	S *	8/1987	Hepworth D15/127
D331,762	S *	12/1992	Matt D15/127
5,169,045	A *	12/1992	Liu B28D 1/225 125/23.02
D359,435	S *	6/1995	Joecker, Jr. D8/98
6,047,871	A *	4/2000	Chen B28D 1/225 125/23.02
6,053,159	A *	4/2000	Liu B28D 1/225 125/23.02
D424,585	S *	5/2000	Torrents Comas D15/127
6,148,810	A *	11/2000	Hepworth B28D 1/225 125/23.01
D434,782	S *	12/2000	Comas D15/127
6,164,272	A *	12/2000	Fouy B28D 1/225 125/12

6,223,736	B1 *	5/2001	Yasuga B28D 1/225 125/23.02
6,240,914	B1 *	6/2001	Yasuga B28D 1/225 125/23.02
6,269,994	B1 *	8/2001	Harrington B28D 1/225 125/23.02
D476,213	S *	6/2003	Hepworth D15/127
D533,426	S *	12/2006	Torrents Comas D15/127
D536,945	S *	2/2007	Yang D15/127
D541,127	S *	4/2007	Yang D8/51
7,434,576	B2 *	10/2008	Hwang B28D 1/225 125/23.02
D597,568	S *	8/2009	I Comas D15/127
D618,714	S *	6/2010	Comas D15/127
D638,864	S *	5/2011	Comas D15/127
8,578,923	B2 *	11/2013	Ghelfi B28D 1/225 125/23.01
D733,197	S *	6/2015	Ambrogiani D15/127
D737,350	S *	8/2015	Gargallo D15/127
D737,351	S *	8/2015	Gargallo D15/127
D755,598	S *	5/2016	Gargallo D15/127
D756,186	S *	5/2016	Sarmiento D15/127
D756,736	S *	5/2016	Gargallo D15/127
2003/0029433	A1 *	2/2003	Hepworth B28D 1/225 125/23.02

(Continued)

Primary Examiner — Deanna L Pratt

(74) *Attorney, Agent, or Firm* — Walker & Jocke; Ralph Jocke

(57)

CLAIM

The ornamental design for a ceramic floor cutter, as shown and described.

DESCRIPTION

FIG. 1 is a back end view showing my new design for a ceramic floor cutter.

FIG. 2 is a front end view thereof.

FIG. 3 is a right side view thereof.

FIG. 4 is a left side view thereof.

FIG. 5 is a top plan view thereof.

FIG. 6 is a top right perspective view thereof.

FIG. 7 is a left front perspective view thereof.

FIG. 8 is a left top perspective view thereof.

FIG. 9 is a back right perspective view thereof; and,

FIG. 10 is a back left perspective view thereof.

The broken lines in the drawings illustrate portions of the ceramic floor cutter that form no part of the claimed design.

1 Claim, 5 Drawing Sheets

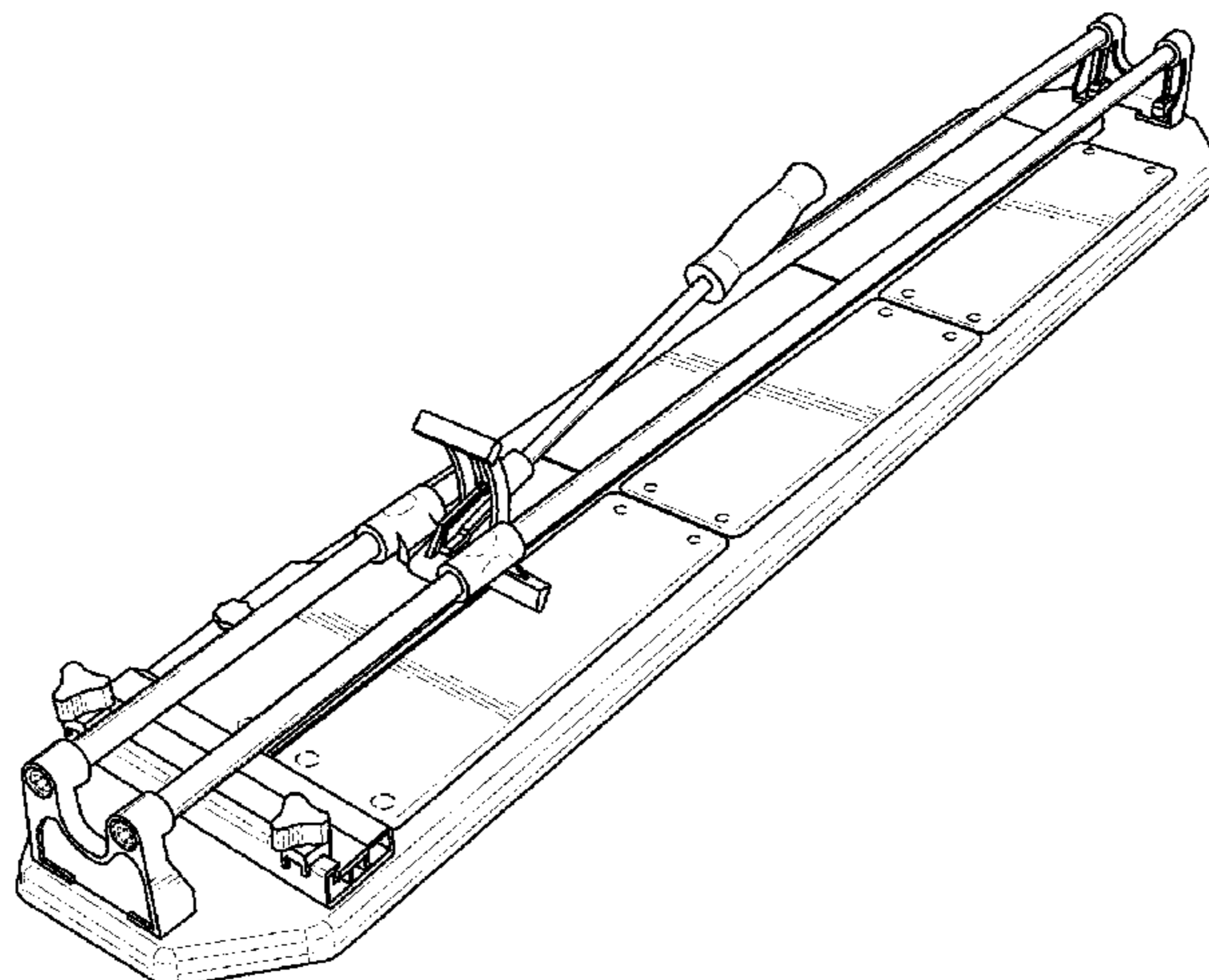

US D771,457 S

Page 2

(56)

References Cited

U.S. PATENT DOCUMENTS

2003/0047056	A1 *	3/2003	Torrents I Comas ..	B28D 1/225 83/886	2005/0016518	A1 *	1/2005	Ishii	B28D 1/225 125/23.02
2004/0025662	A1 *	2/2004	Torrents I Comas ..	B28D 1/225 83/886	2009/0044681	A1 *	2/2009	Torrents I Comas ..	B28D 1/225 83/886
					2009/0145416	A1 *	6/2009	Harding	B28D 1/225 125/23.02

* cited by examiner

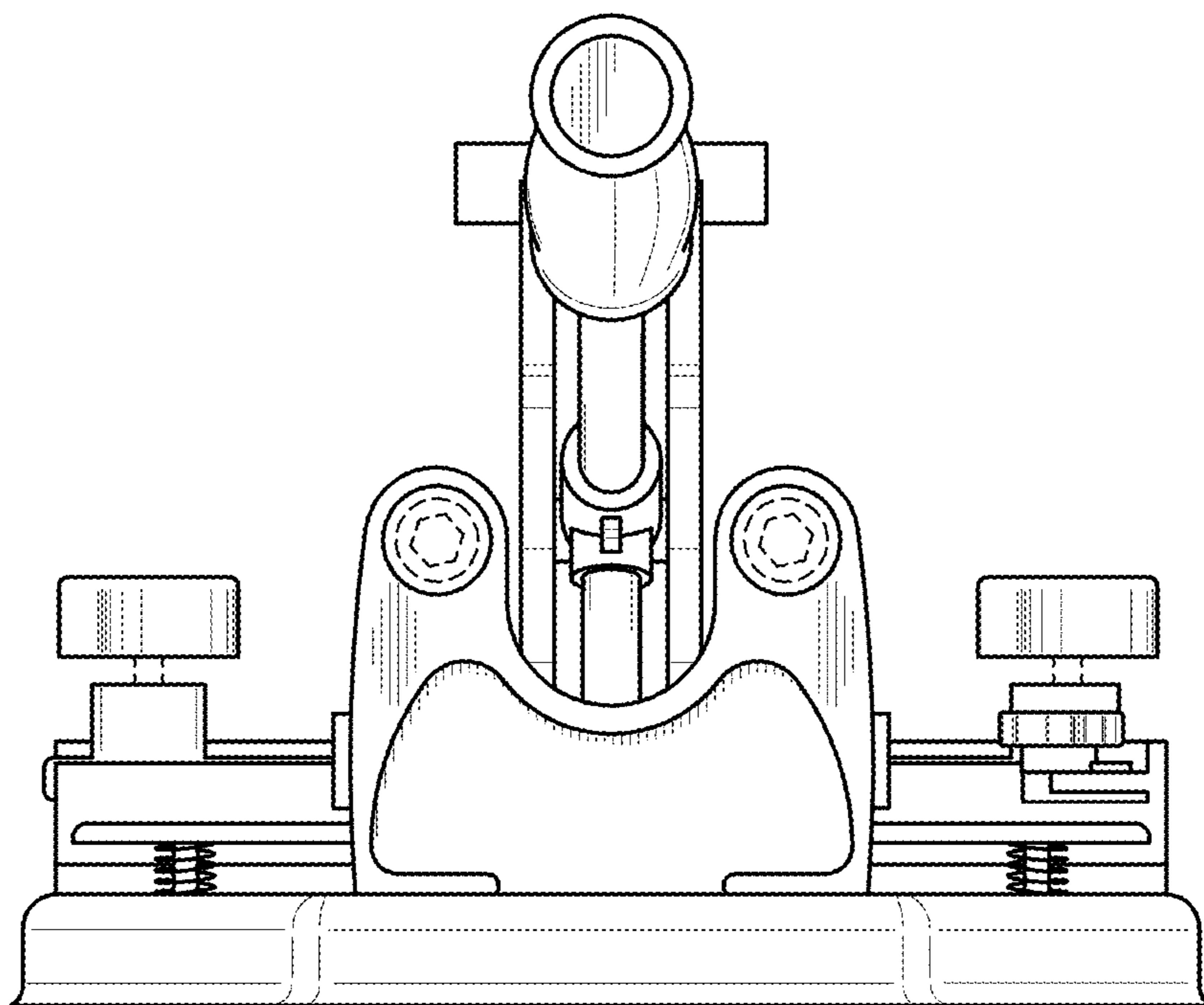

FIG. 1

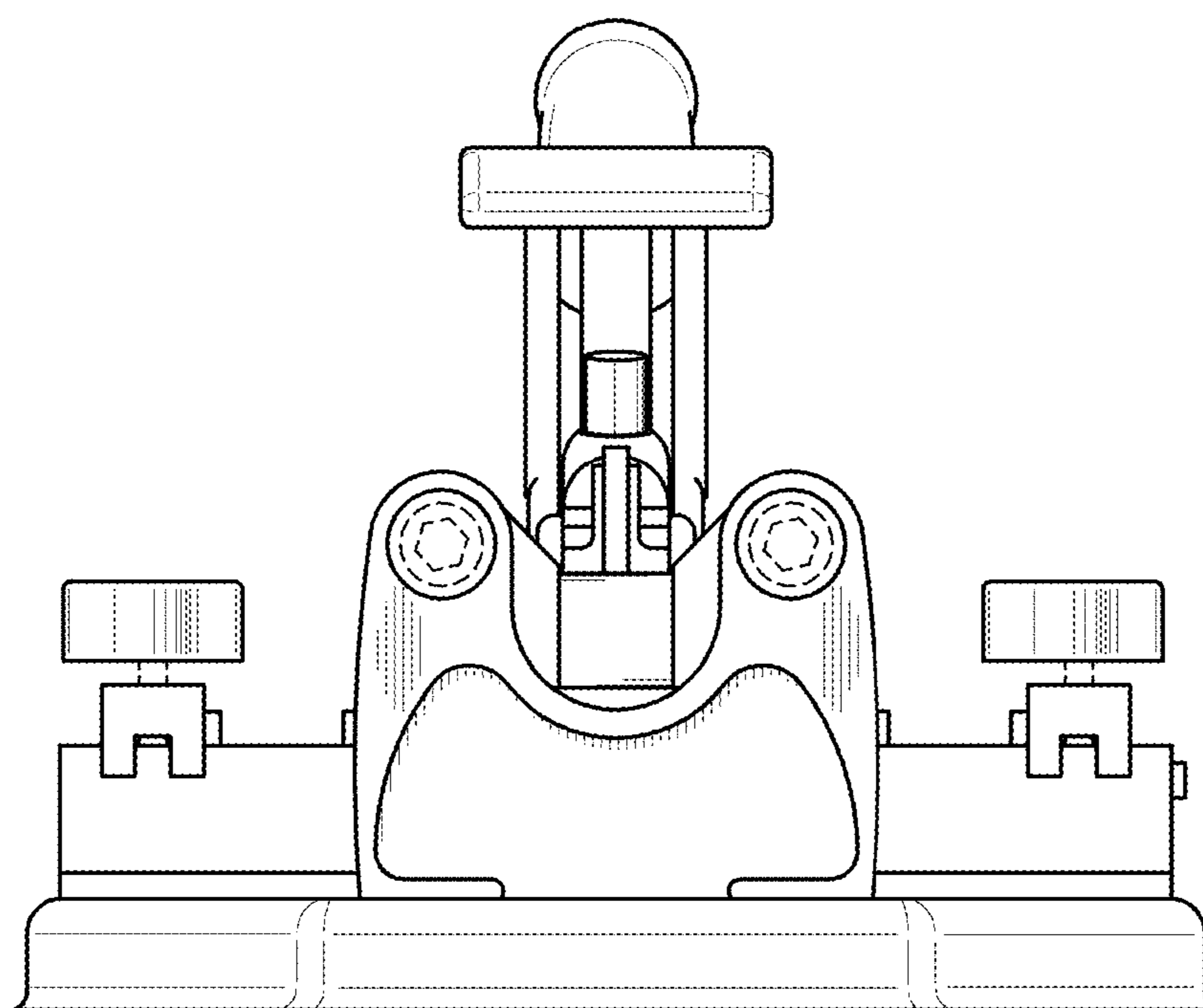

FIG. 2

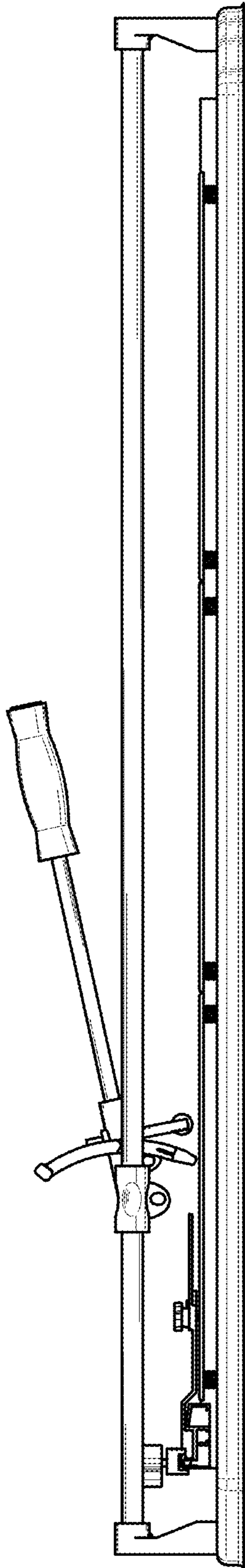

FIG. 3

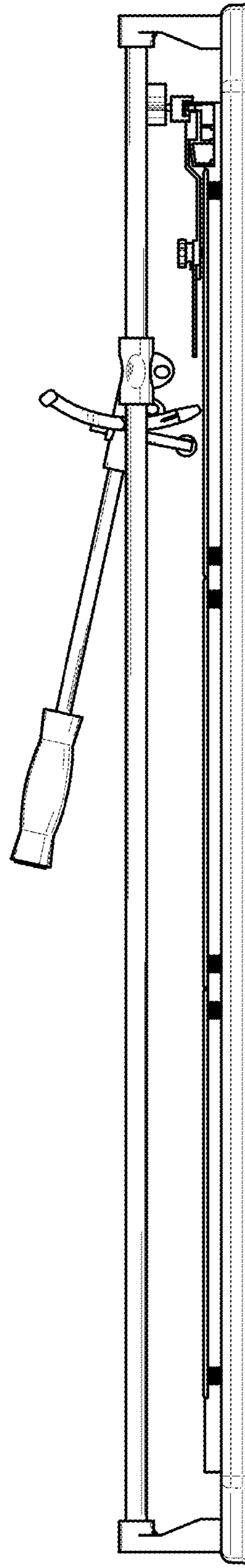

FIG. 4

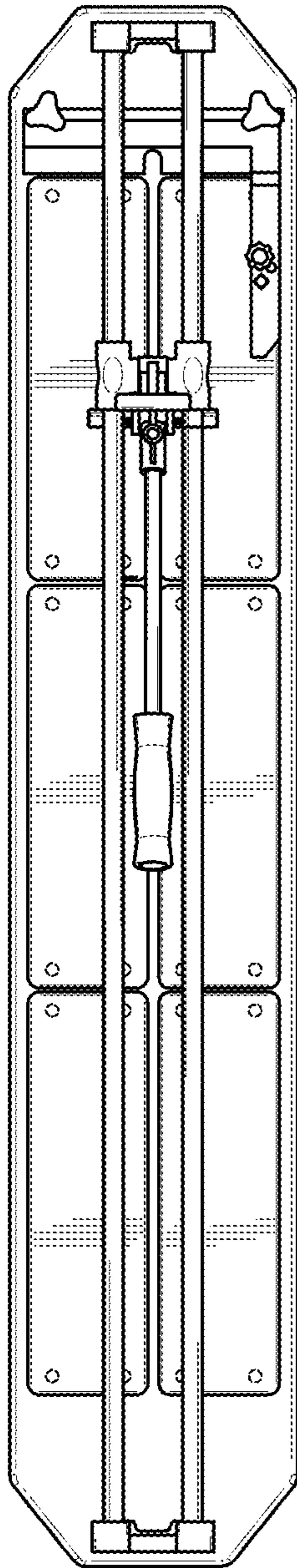

FIG. 5

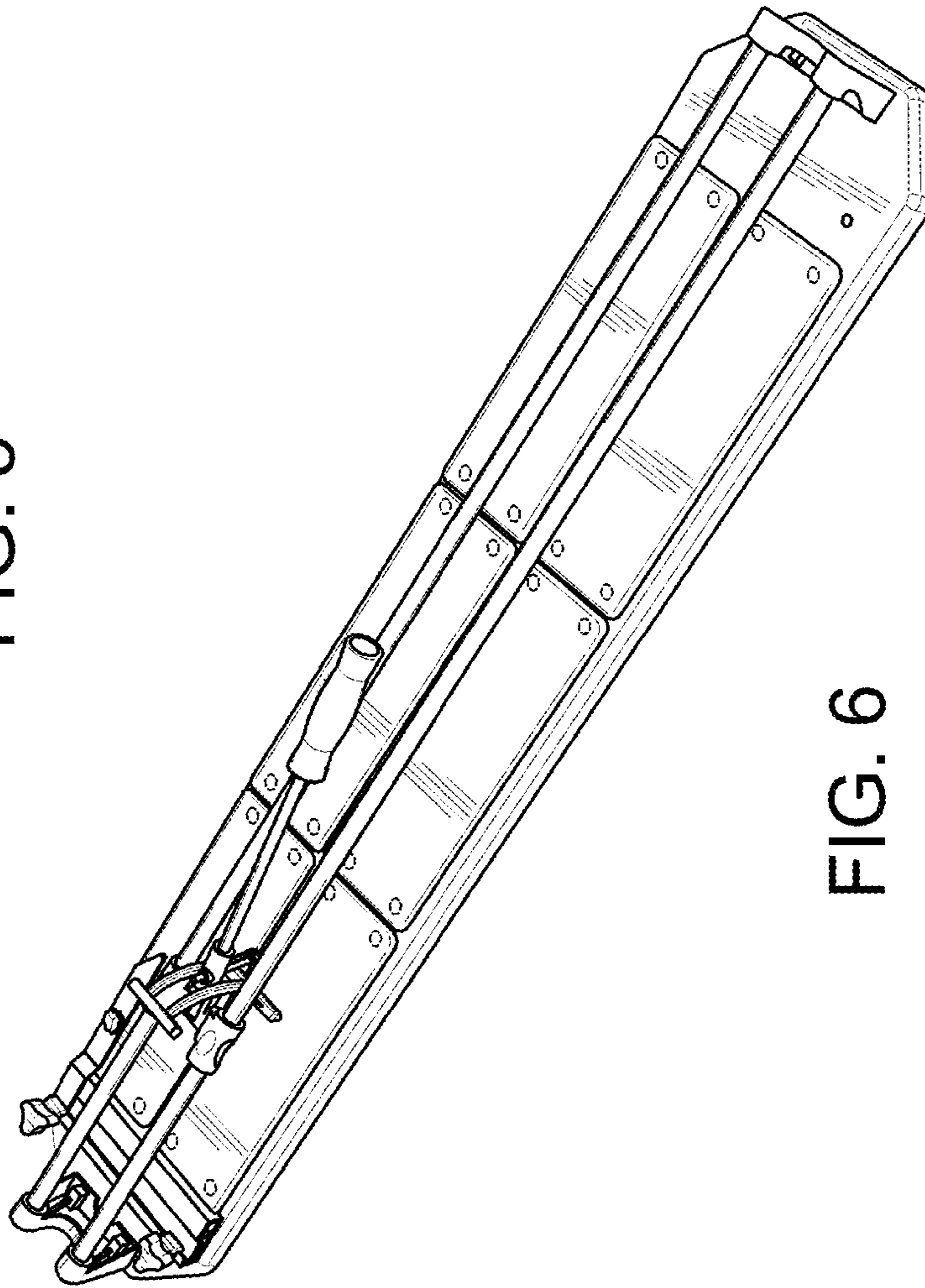
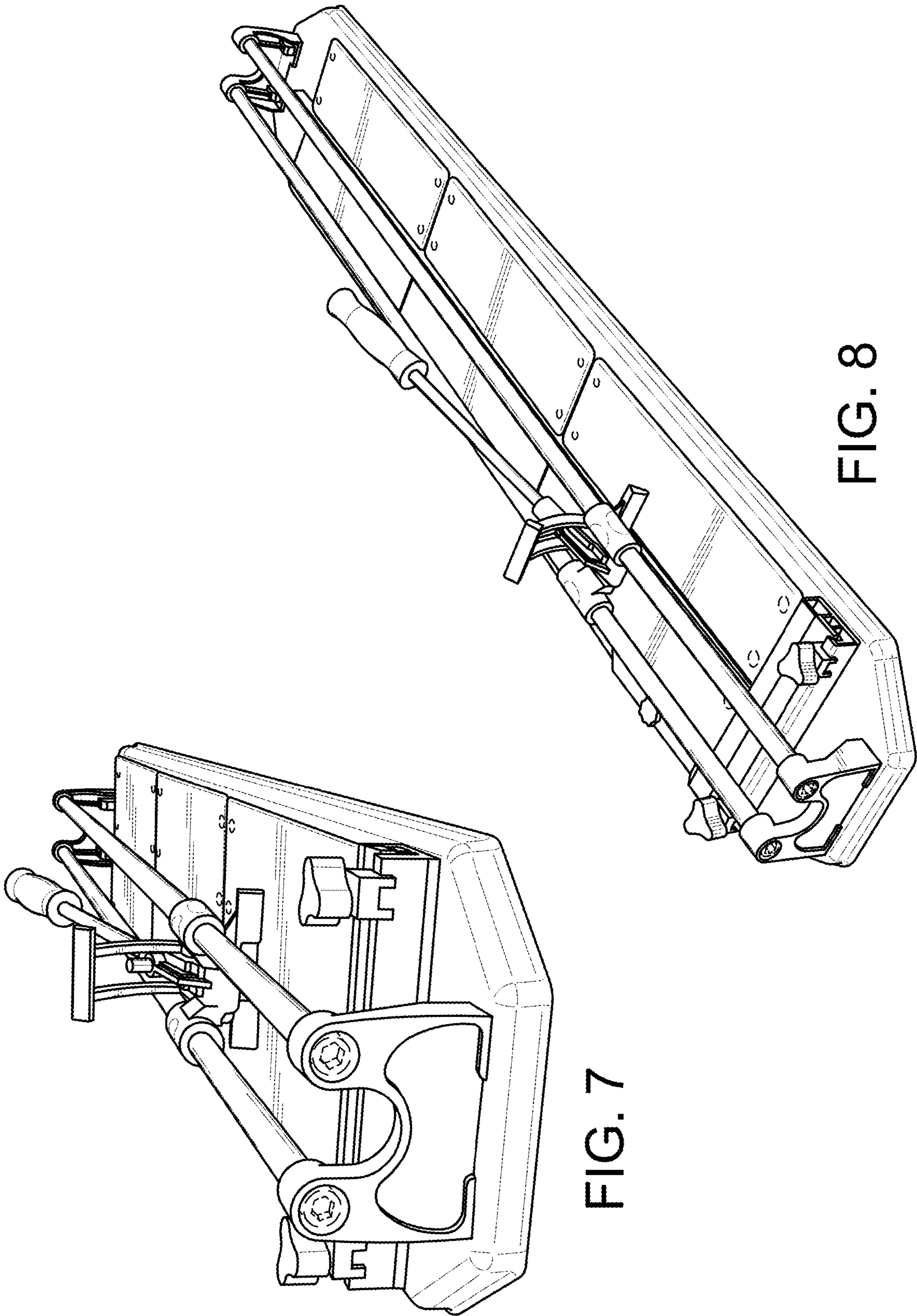

FIG. 6



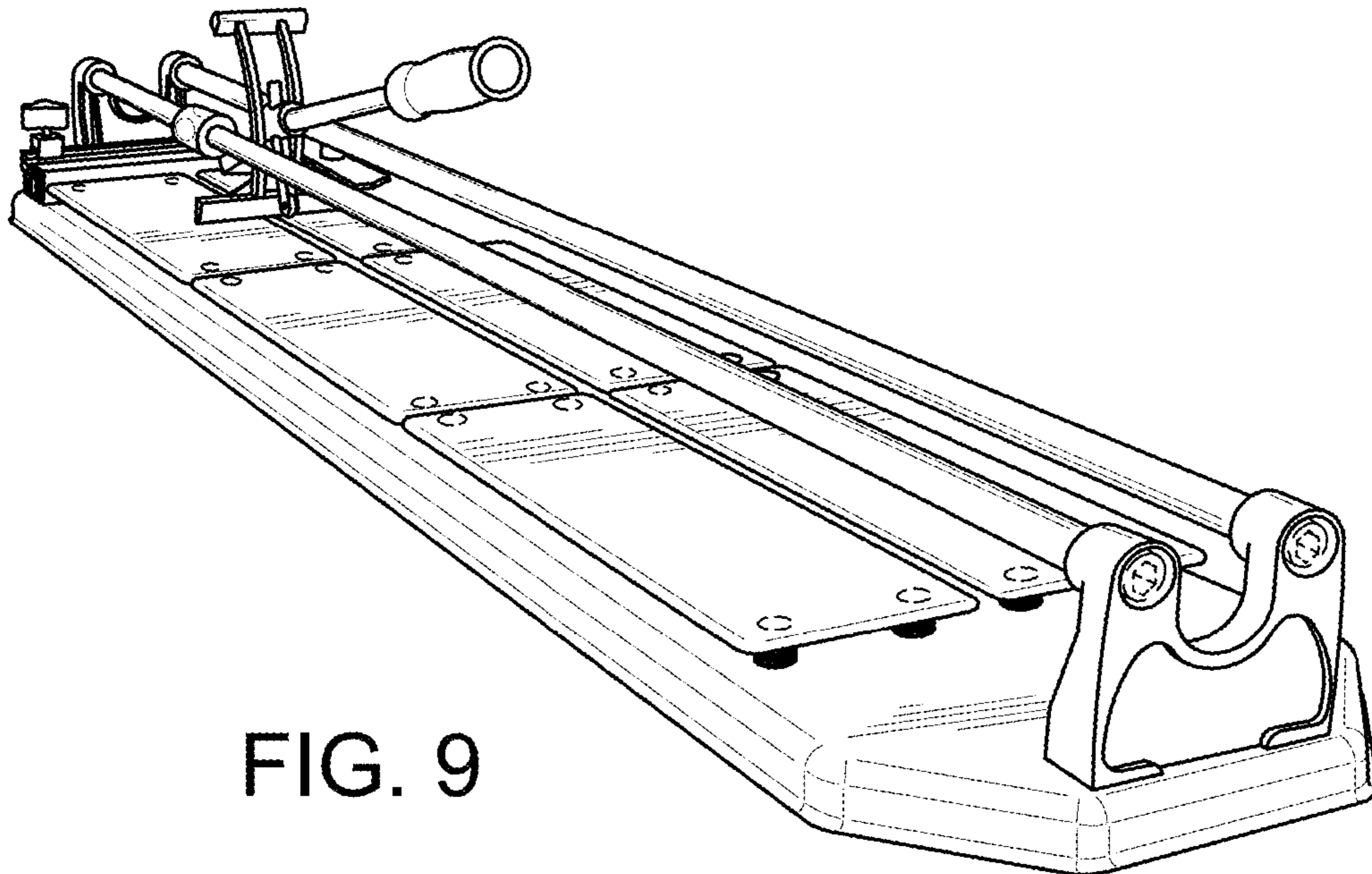

FIG. 9

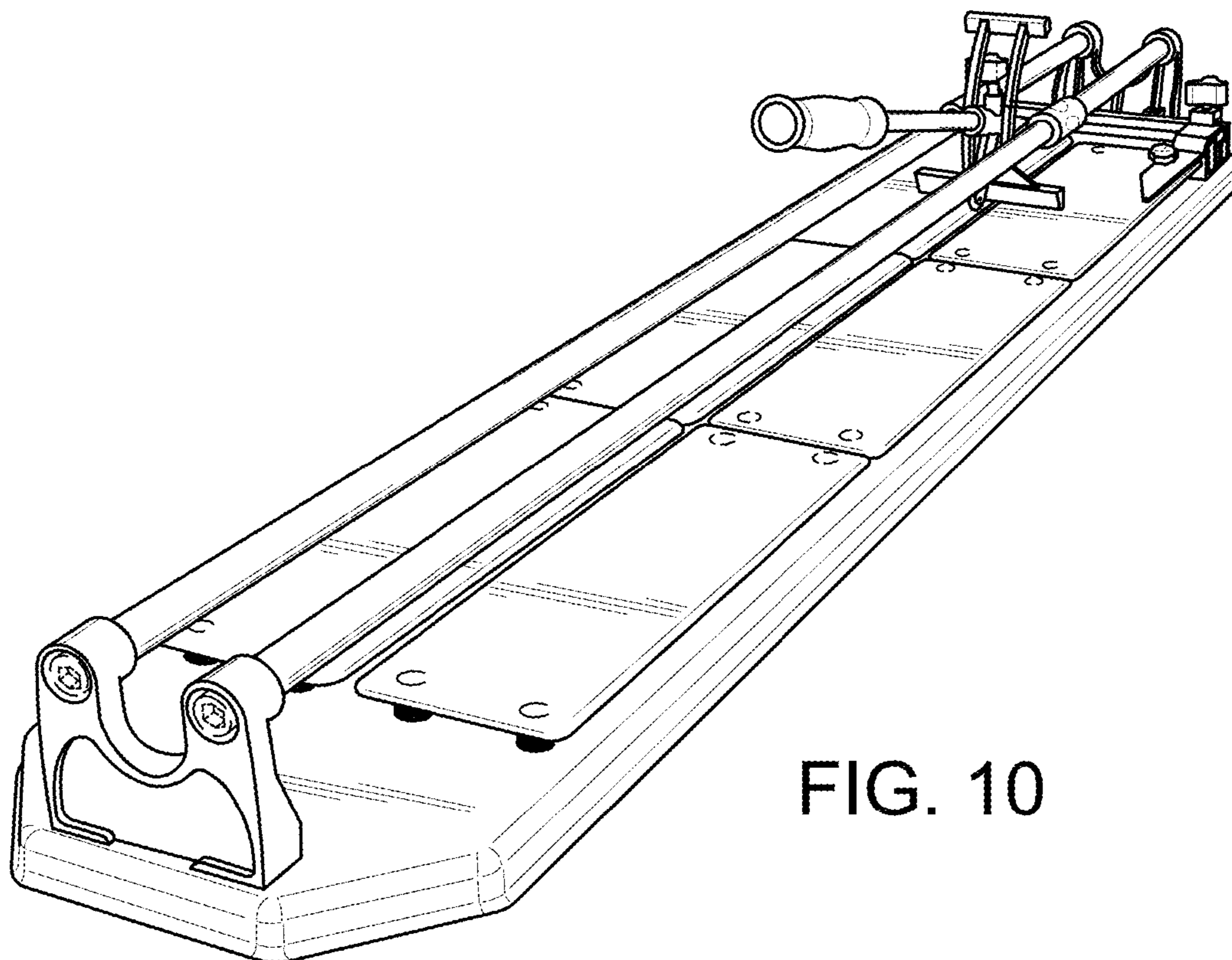

FIG. 10