



US00D770982S

(12) **United States Design Patent** (10) **Patent No.:** **US D770,982 S**
Wieser et al. (45) **Date of Patent:** **** *Nov. 8, 2016**

(54) **VEHICLE INTERFACE CONNECTOR DEVICE**

(71) Applicant: **Robert Bosch GmbH**, Stuttgart (DE)

(72) Inventors: **Matthias Wieser**, Stuttgart (DE); **Thomas Frank**, Berlin (DE); **Bankoley Florian**, Berlin (DE)

(73) Assignee: **Robert Bosch GmbH**, Stuttgart (DE)

(*) Notice: This patent is subject to a terminal disclaimer.

(**) Term: **14 Years**

(21) Appl. No.: **29/523,556**

(22) Filed: **Apr. 10, 2015**

(30) **Foreign Application Priority Data**

Oct. 10, 2014 (EM) 002555235

(51) **LOC (10) Cl.** **13-03**

(52) **U.S. Cl.**
USPC **D13/147; D13/148**

(58) **Field of Classification Search**

USPC D13/133, 134, 146, 147, 148, 153, 154, D13/184, 199

See application file for complete search history.

(56) **References Cited**

U.S. PATENT DOCUMENTS

D204,136 S *	3/1966	Schaefer	D13/133
D233,438 S *	10/1974	Bruner	D13/148
D361,745 S *	8/1995	Geroux	D13/120
D411,983 S *	7/1999	Awbrey	D13/148
8,872,402 B2 *	10/2014	Tanaka	H02K 11/0068 310/43

* cited by examiner

Primary Examiner — Daniel Bui

(74) *Attorney, Agent, or Firm* — Maginot, Moore & Beck LLP

(57) **CLAIM**

The ornamental design for a vehicle interface connector device, as shown and described.

DESCRIPTION

The patent or application file contains at least one drawing executed in color. Copies of this patent or patent application publication with color drawing(s) will be provided by the Office upon request and payment of the necessary fee.

Cross reference is made to copending U.S. design patent application Ser. No. 29/523,544 entitled "Vehicle Interface Connector Device" by Wieser et al., which was filed on Apr. 10, 2015; U.S. design patent application Ser. No. 29/523,546 entitled "Vehicle Interface Connector Device" by Wieser et al., which was filed on Apr. 10, 2015; U.S. design patent application Ser. No. 29/523,548 entitled "Vehicle Interface Connector Device" by Wieser et al., which was filed on Apr. 10, 2015; U.S. design patent application Ser. No. 29/523,550 entitled "Vehicle Interface Connector Device" by Wieser et al., which was filed on Apr. 10, 2015; U.S. design patent application Ser. No. 29/523,553 entitled "Vehicle Interface Connector Device" by Wieser et al., which was filed on Apr. 10, 2015; and U.S. design patent application Ser. No. 29/523,559 entitled "Vehicle Interface Connector Device" by Wieser et al., which was filed on Apr. 10, 2015.

FIG. 1 is a perspective view of a first embodiment of a vehicle interface connector device showing our new design; FIG. 2 is a left side elevational view thereof; FIG. 3 is a right side elevational view thereof; FIG. 4 is a top plan view thereof; FIG. 5 is a bottom plan view thereof; FIG. 6 is a front elevational view thereof; and FIG. 7 is a rear elevational view thereof.

FIG. 8 is a perspective view of a second embodiment of a vehicle interface connector device showing our new design; FIG. 9 is a left side elevational view thereof; FIG. 10 is a right side elevational view thereof; FIG. 11 is a top plan view thereof; FIG. 12 is a bottom plan view thereof; FIG. 13 is a front elevational view thereof; and

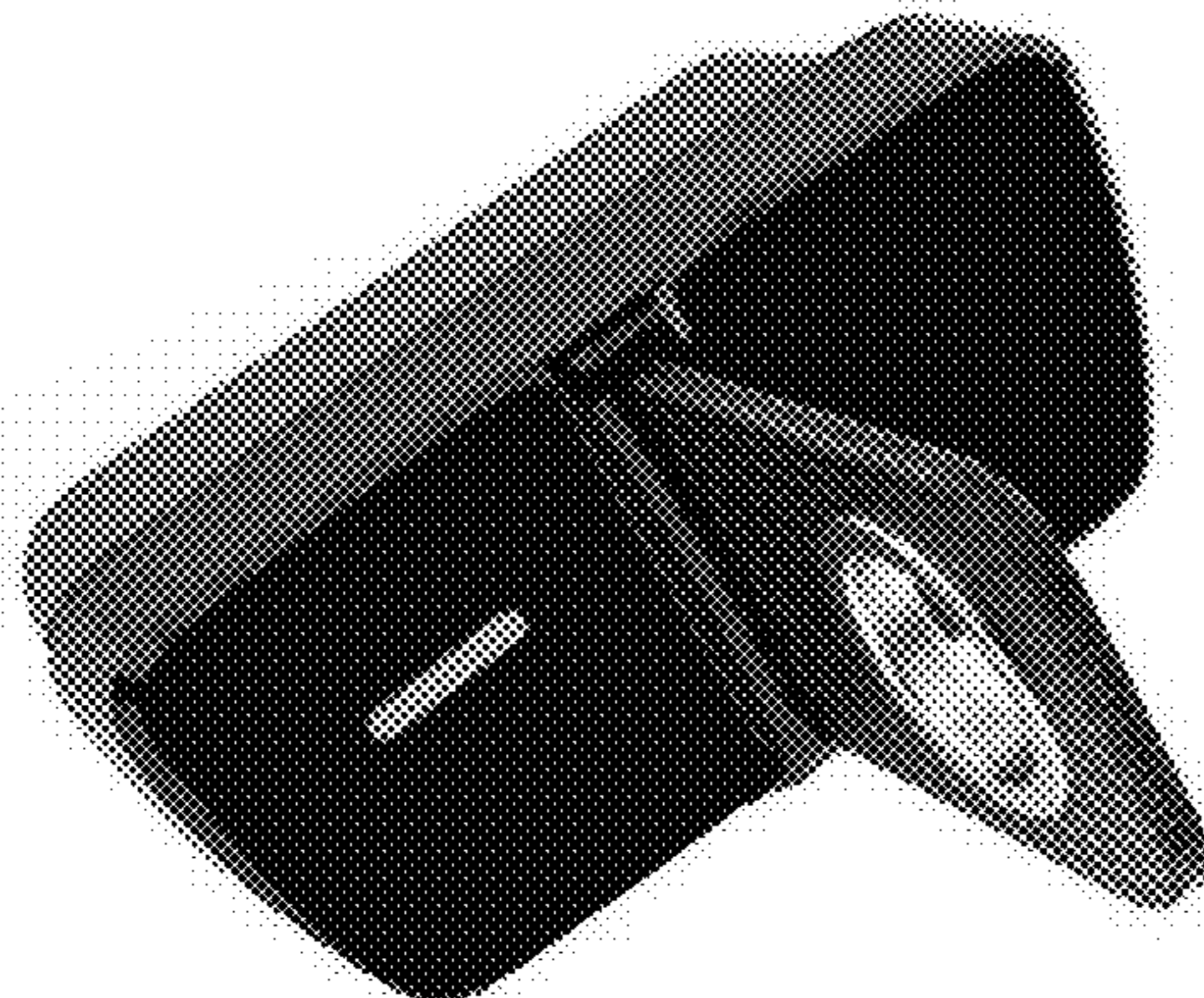

FIG. 14 is a rear elevational view thereof.
FIG. 15 is a perspective view of a third embodiment of a vehicle interface connector device showing our new design;
FIG. 16 is a left side elevational view thereof;
FIG. 17 is a right side elevational view thereof;
FIG. 18 is a top plan view thereof;
FIG. 19 is a bottom plan view thereof;
FIG. 20 is a front elevational view thereof; and,
FIG. 21 is a rear elevational view thereof.
The portions of the vehicle interface connector device located within the broken-line boxes of FIGS. 7, 14, and 21

represent unclaimed environment only and form no part of the claimed design. The broken-line boxes form no part of the claimed design.

The drivelog trademark shown in FIGS. 8, 13, 15, 18, and 20 forms part of the claimed design and is a registered trademark of Robert Bosch GmbH. The drivelog trademark is the property of Robert Bosch GmbH.

**1 Claim, 21 Drawing Sheets
(21 of 21 Drawing Sheet(s) Filed in Color)**



FIG. 1

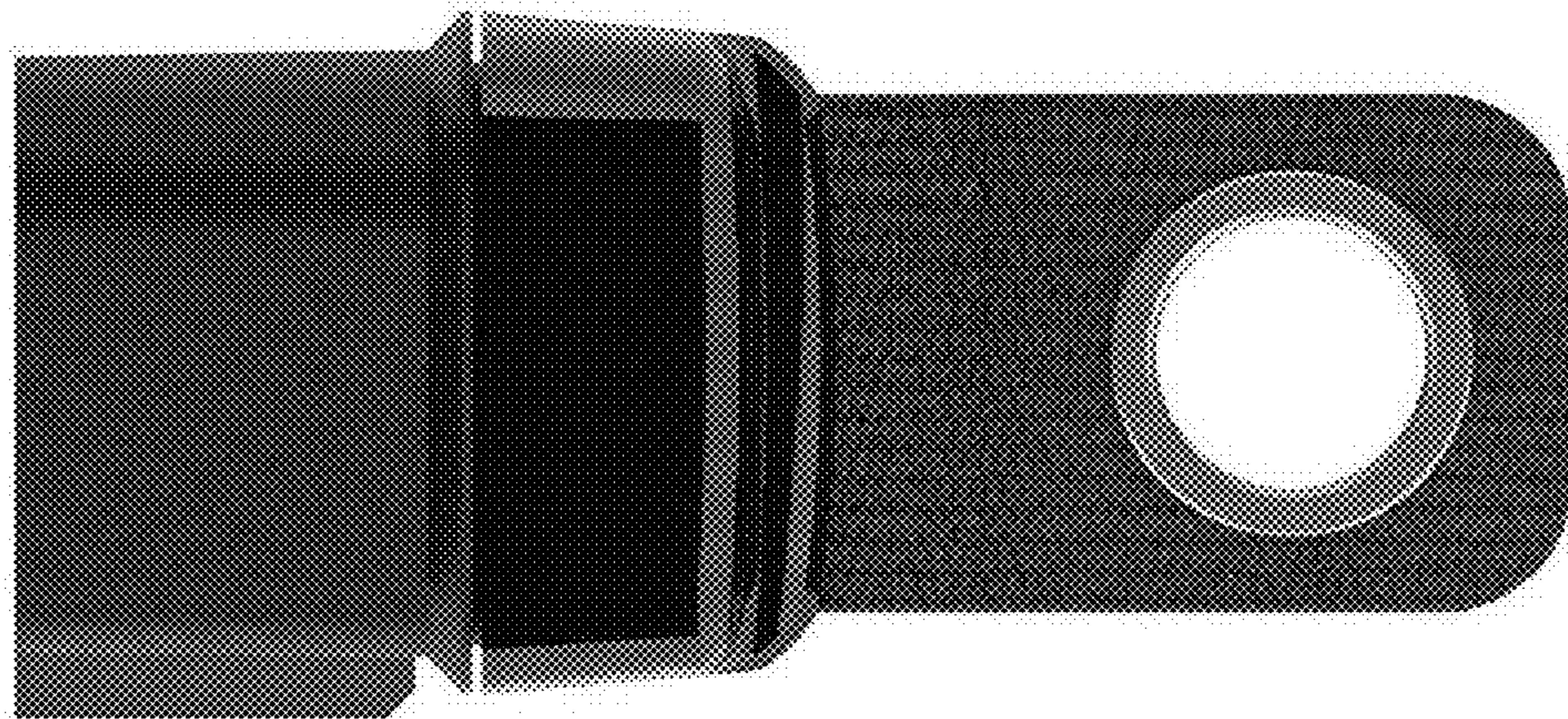

FIG. 2

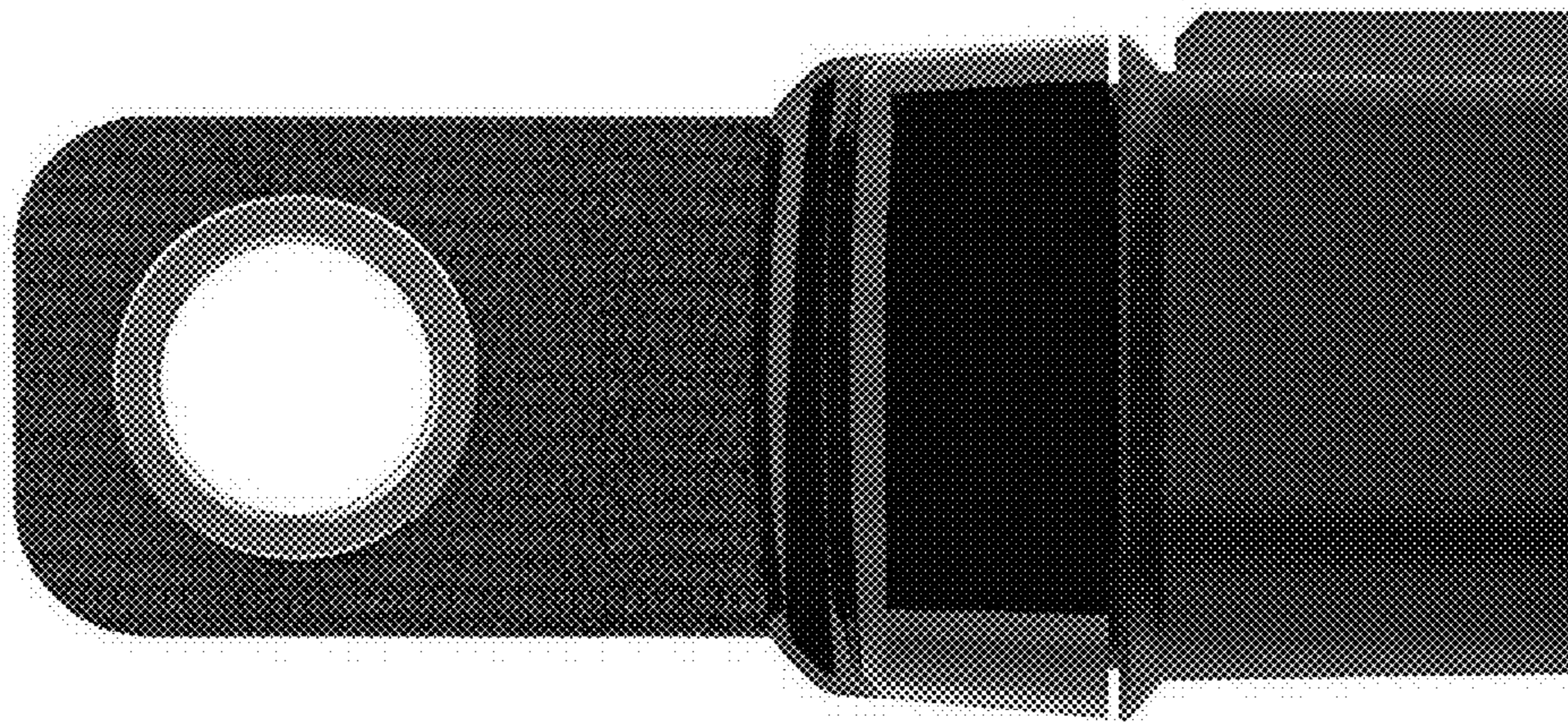

FIG. 3

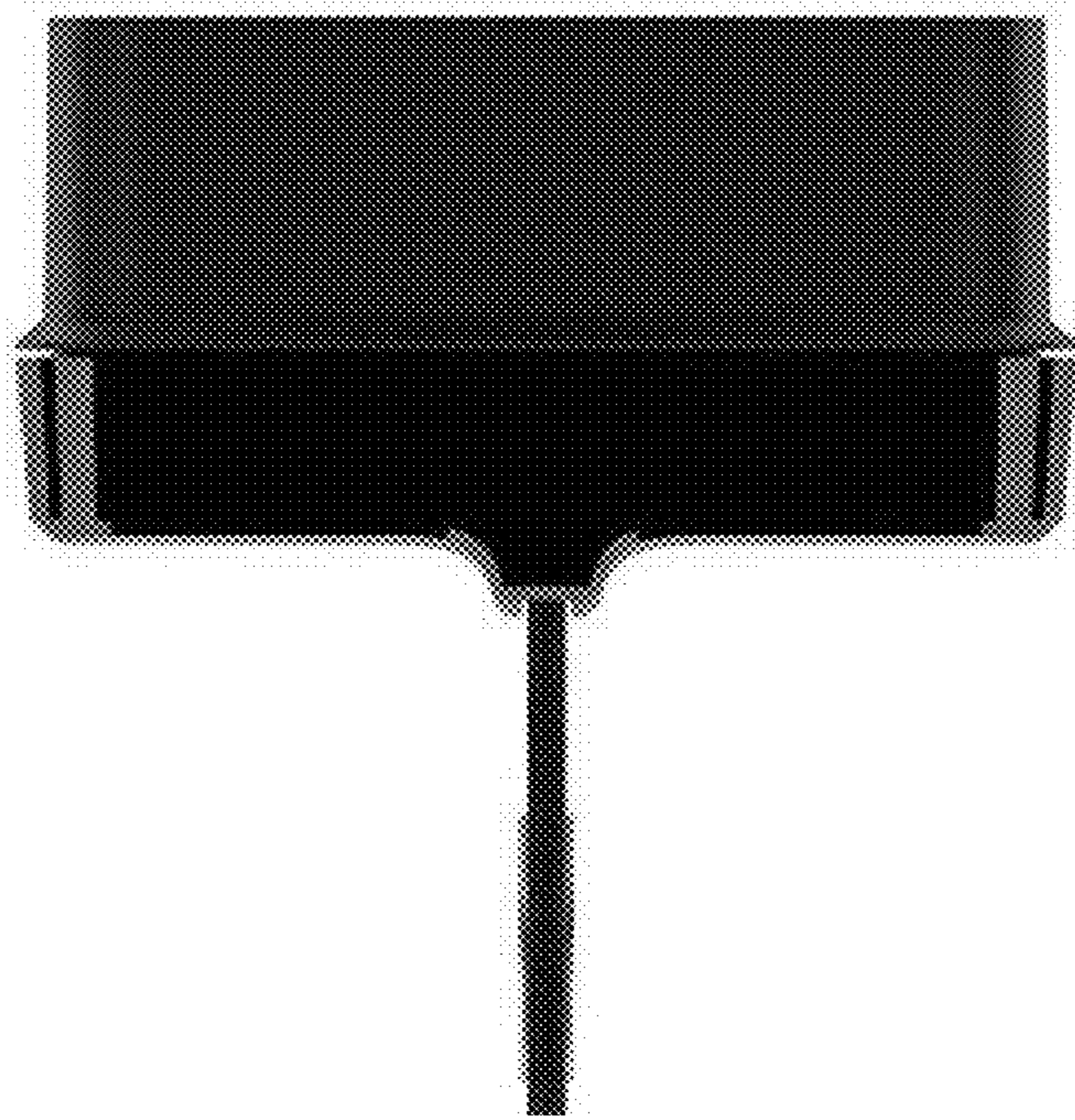

FIG. 4

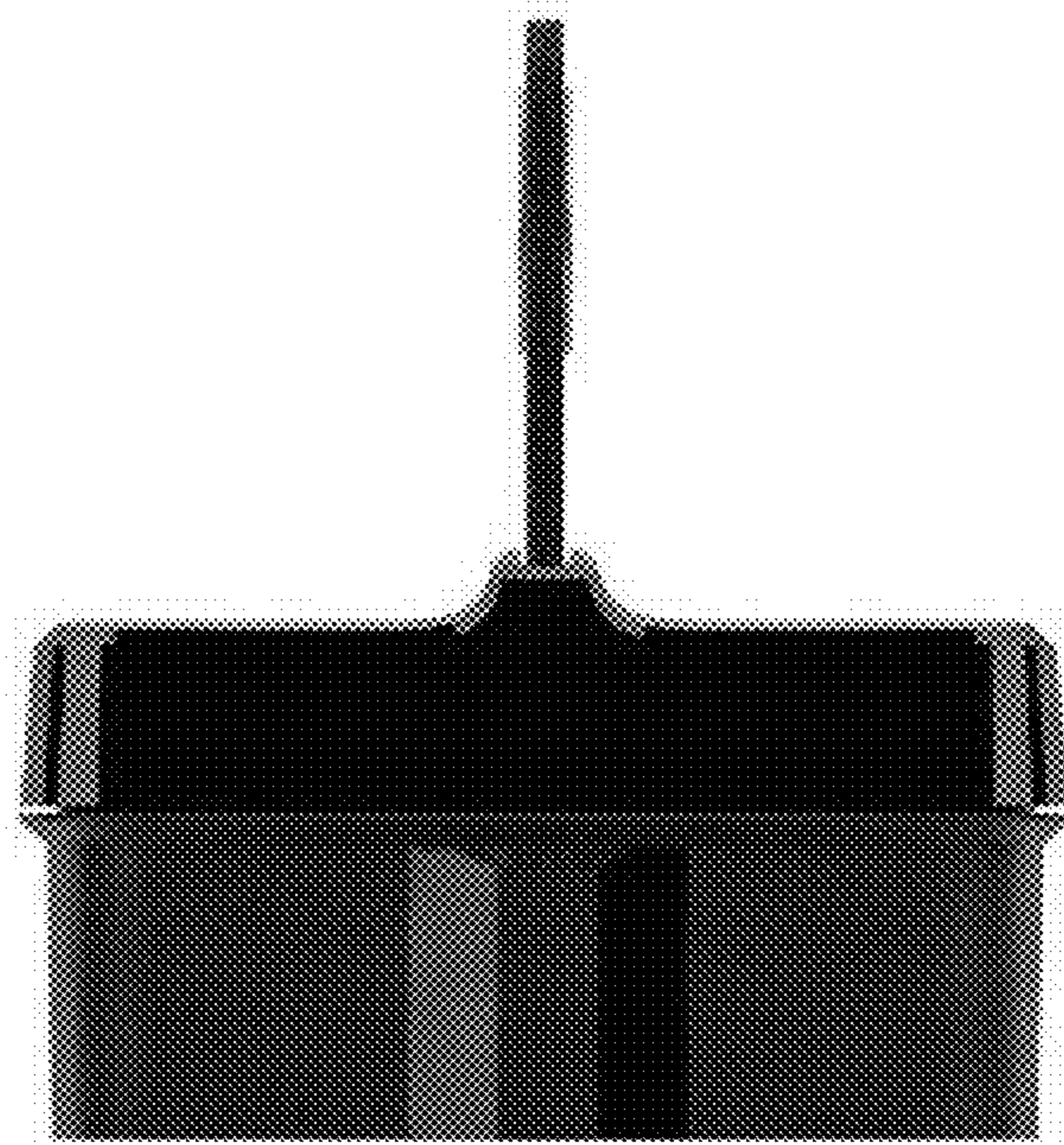

FIG. 5

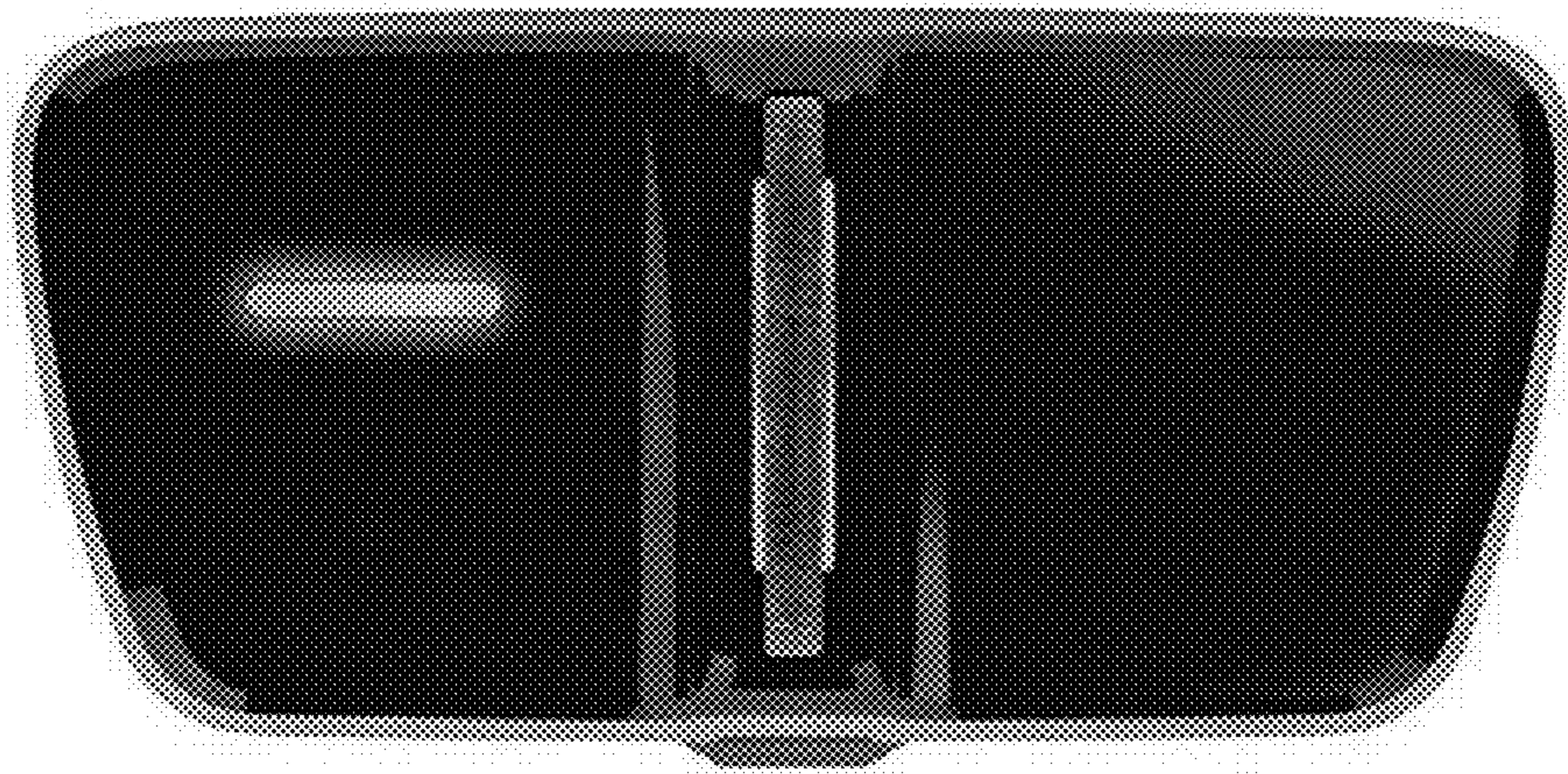

FIG. 6

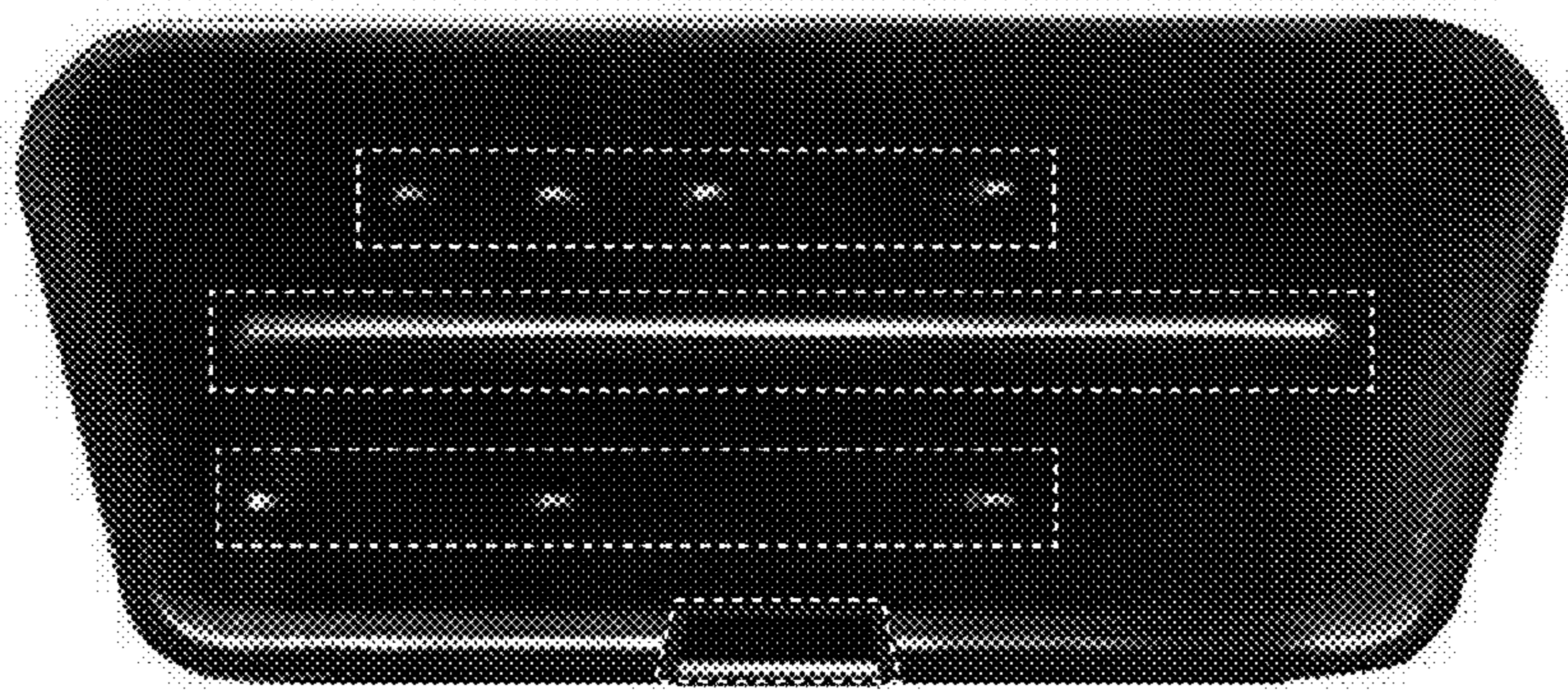

FIG. 7



FIG. 8

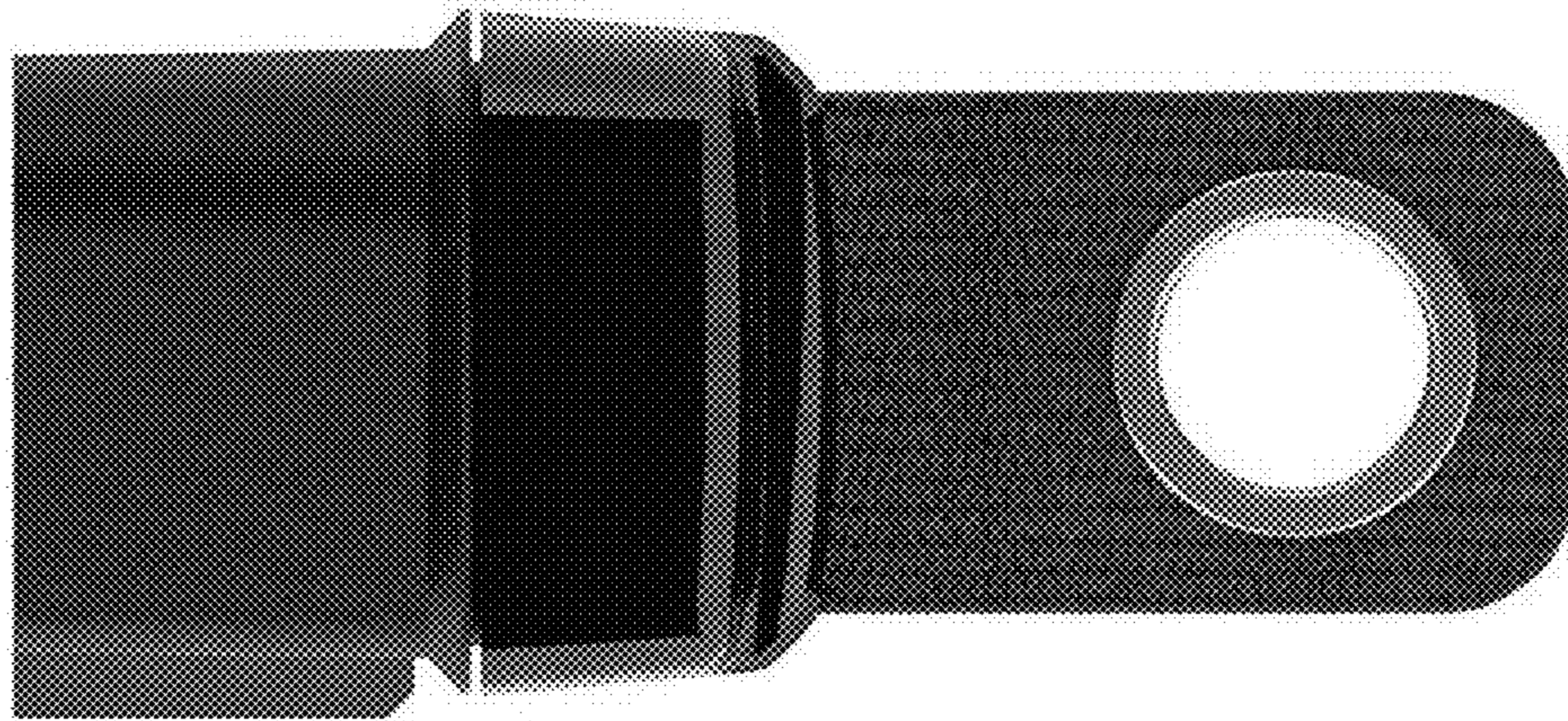

FIG. 9



FIG. 10



FIG. 11

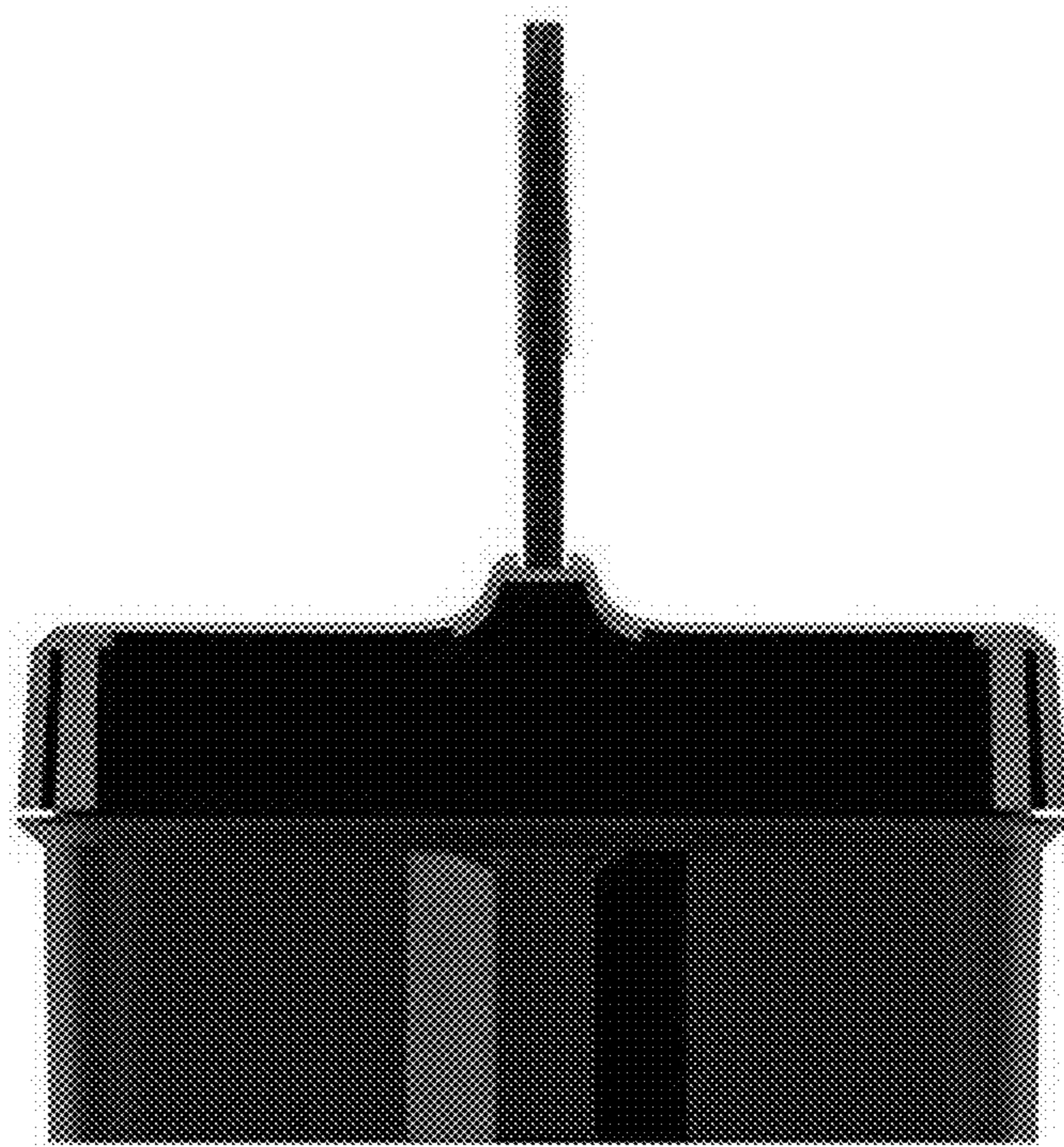

FIG. 12



FIG. 13

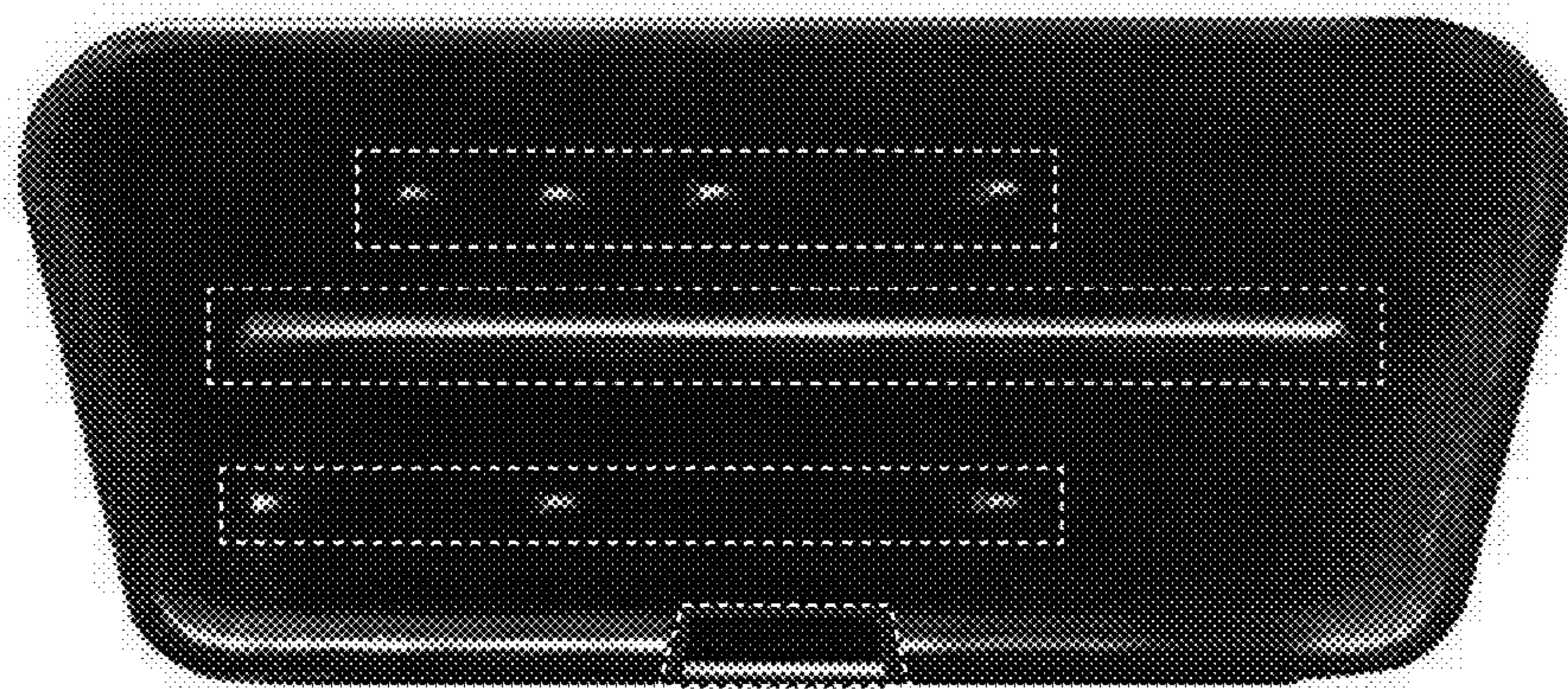

FIG. 14



FIG. 15

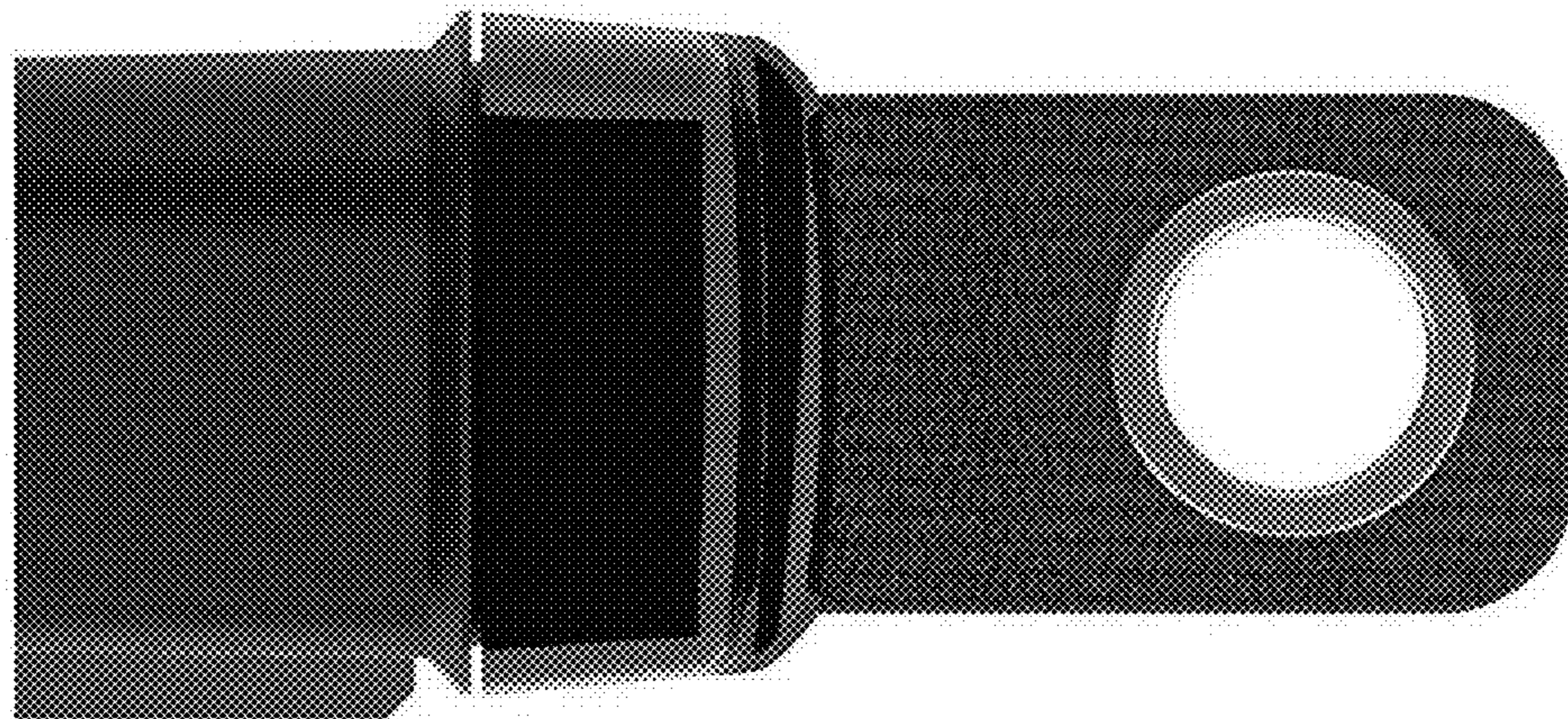

FIG. 16

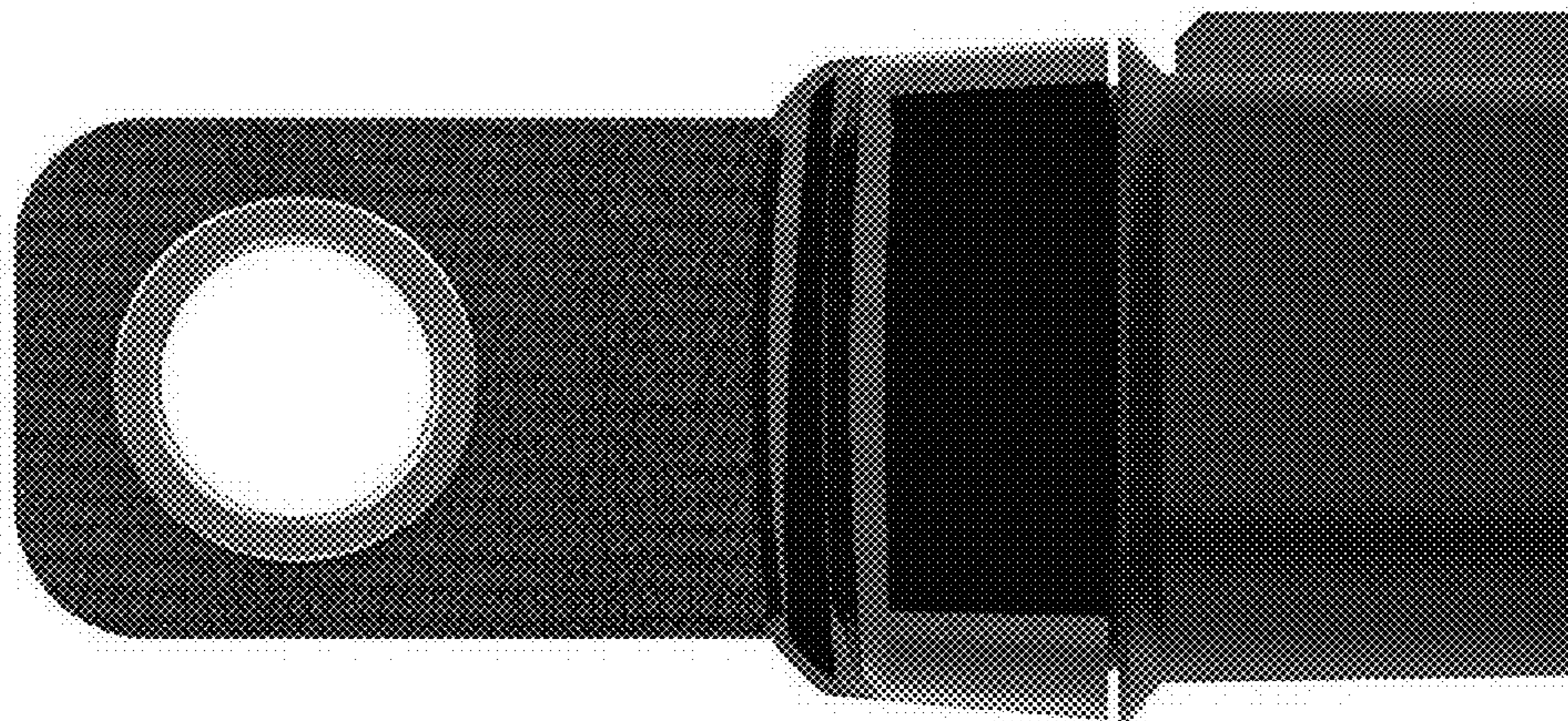

FIG. 17



FIG. 18



FIG. 19

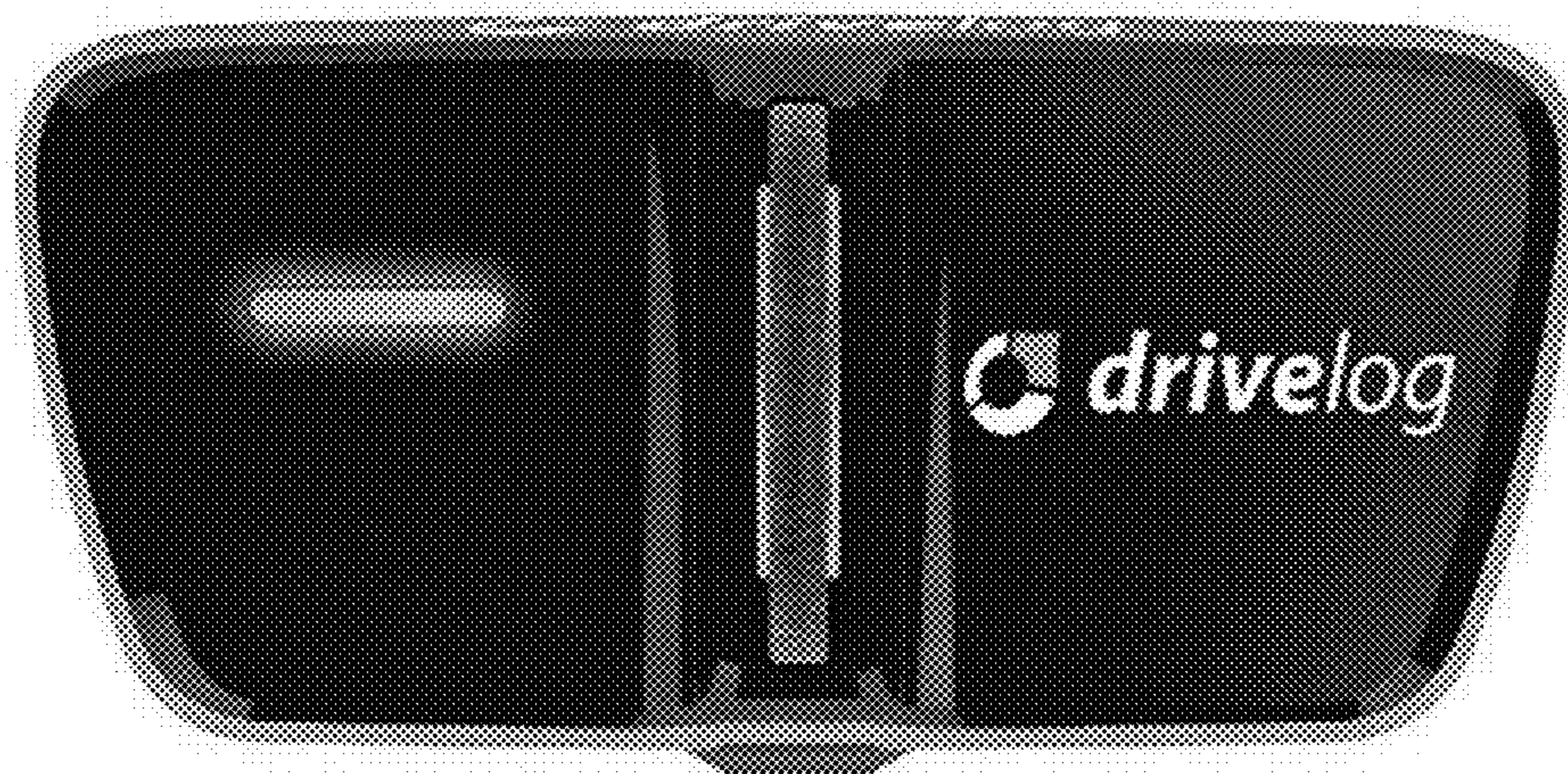

FIG. 20

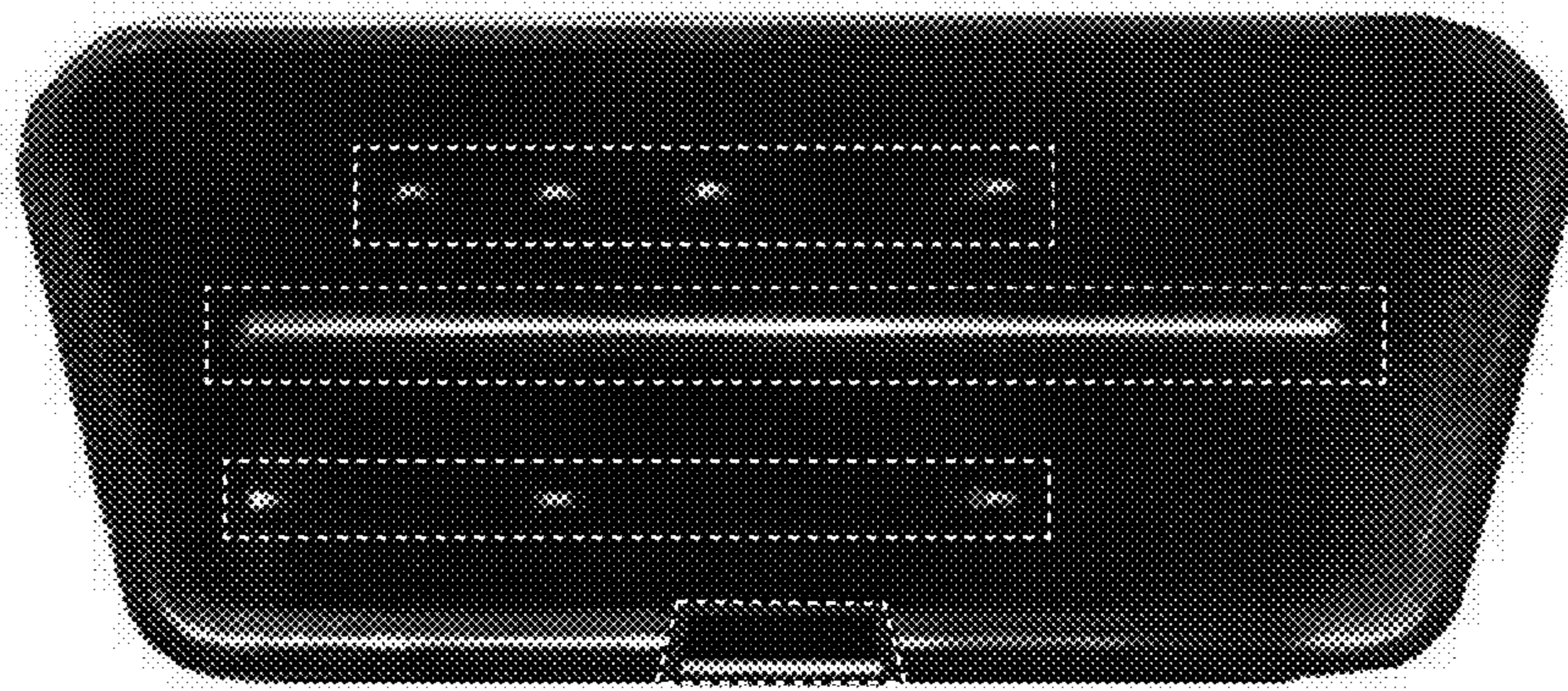

FIG. 21