

US00D769309S

(12) **United States Design Patent**
Knapp et al.

(10) **Patent No.:** **US D769,309 S**

(45) **Date of Patent:** **** Oct. 18, 2016**

(54) **DISPLAY SCREEN WITH ANIMATED GRAPHICAL USER INTERFACE**

(71) Applicant: **Microsoft Corporation**, Redmond, WA (US)

(72) Inventors: **Jaclyn Carley Knapp**, Redmond, WA (US); **Jose Alberto Rodriguez**, Seattle, WA (US)

(73) Assignee: **Microsoft Corporation**, Redmond, WA (US)

(**) Term: **14 Years**

(21) Appl. No.: **29/515,169**

(22) Filed: **Jan. 20, 2015**

(51) **LOC (10) Cl.** **14-04**

(52) **U.S. Cl.**
USPC **D14/488**

(58) **Field of Classification Search**
USPC D14/485-495
CPC .. G06F 3/0481; G06F 3/0482; G06F 3/0488;
G06F 3/0486; G06F 3/04883; G06F 3/04817;
G06F 17/30115; H04N 1/004
See application file for complete search history.

(56) **References Cited**

U.S. PATENT DOCUMENTS

D604,315 S	*	11/2009	Hoefnagels	D14/485
D692,448 S	*	10/2013	Jung	D14/486
D692,906 S	*	11/2013	Coudron	D14/486
D694,260 S	*	11/2013	Yang	D14/488
D698,815 S	*	2/2014	Scott	D14/488
D707,237 S	*	6/2014	Edwards	D14/486

D710,864 S	*	8/2014	Morse	D14/486
D714,338 S	*	9/2014	McCormack	D14/486
D714,820 S	*	10/2014	McCormack	D14/486
D739,418 S	*	9/2015	Coudron	D14/485
D751,597 S	*	3/2016	Pasceri	D14/486

* cited by examiner

Primary Examiner — Karen E Kearney

Assistant Examiner — Andrew Nemeth

(74) *Attorney, Agent, or Firm* — Banner & Witcoff, Ltd.

(57) **CLAIM**

The ornamental design for a display screen with animated graphical user interface, as shown and described.

DESCRIPTION

FIG. 1 is the first image in a sequence for a display screen with animated graphical user interface showing our new design;

FIG. 2 is the second image thereof;

FIG. 3 is the third image thereof; and,

FIG. 4 is the fourth image thereof.

The appearance of the animated graphical user interface sequentially transitions between the images shown in FIGS. 1-4. The process or period in which one image transitions to another forms no part of the claimed design. The even-length broken line showing of the text, the icons, the remainder of the animated graphical user interface and the remainder of the display screen, illustrates portions of the display screen with animated graphical user interface, and forms no part of the claimed design. The even-length broken line showing of an electronic device illustrates environmental structure and forms no part of the claimed design. The uneven-length broken line illustrates a portion of the display screen and forms no part of the claimed design.

1 Claim, 4 Drawing Sheets

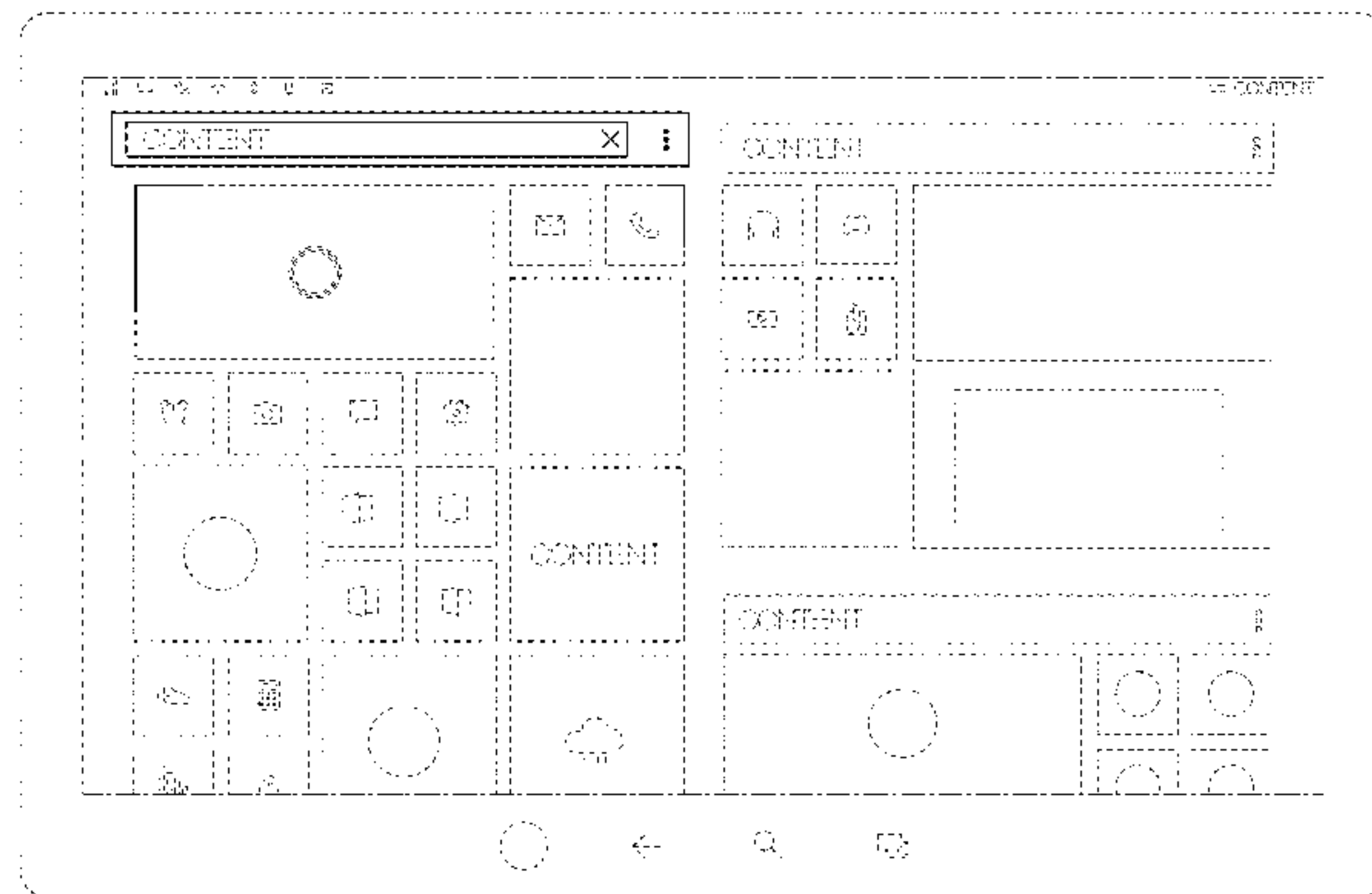
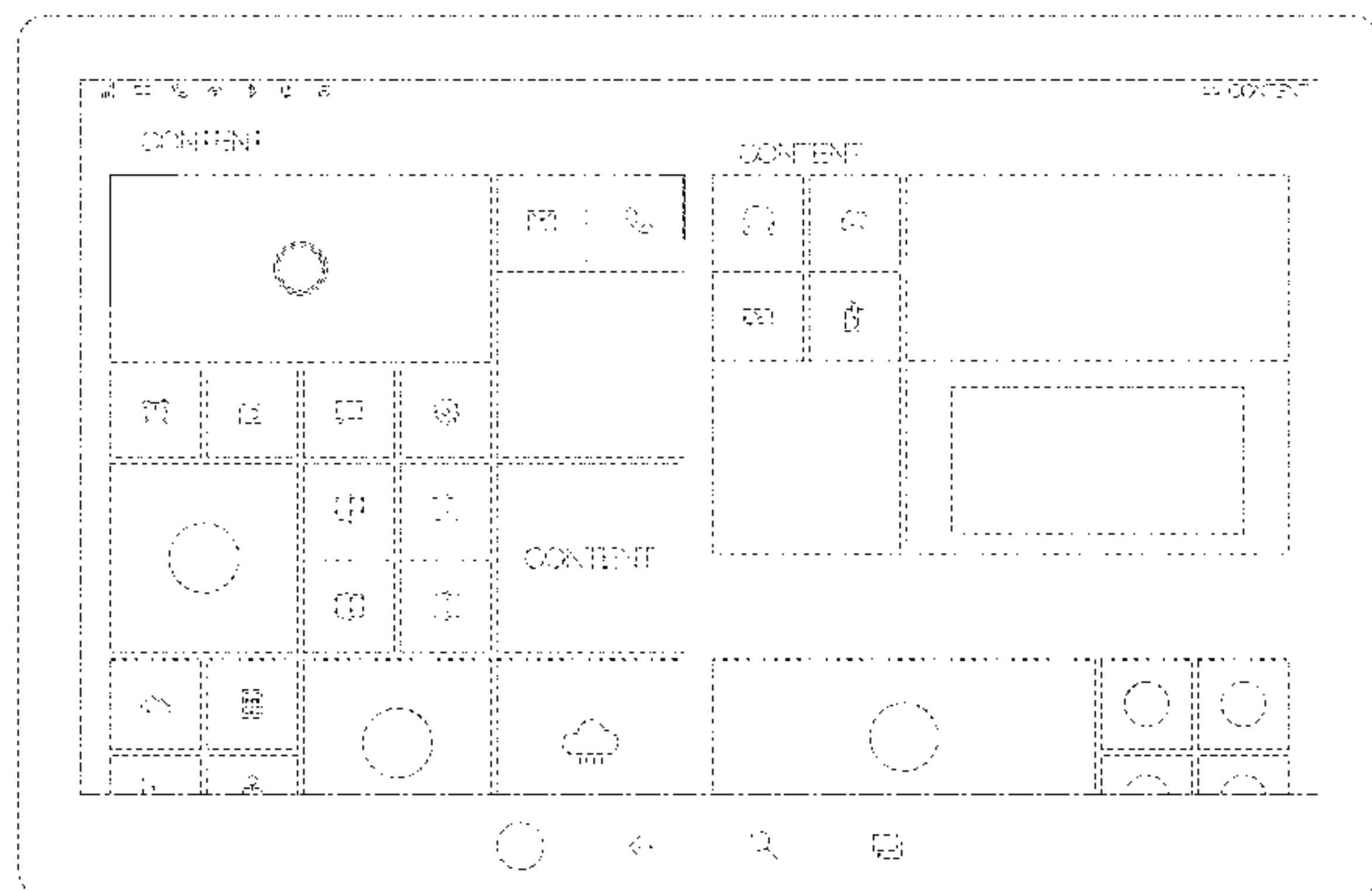

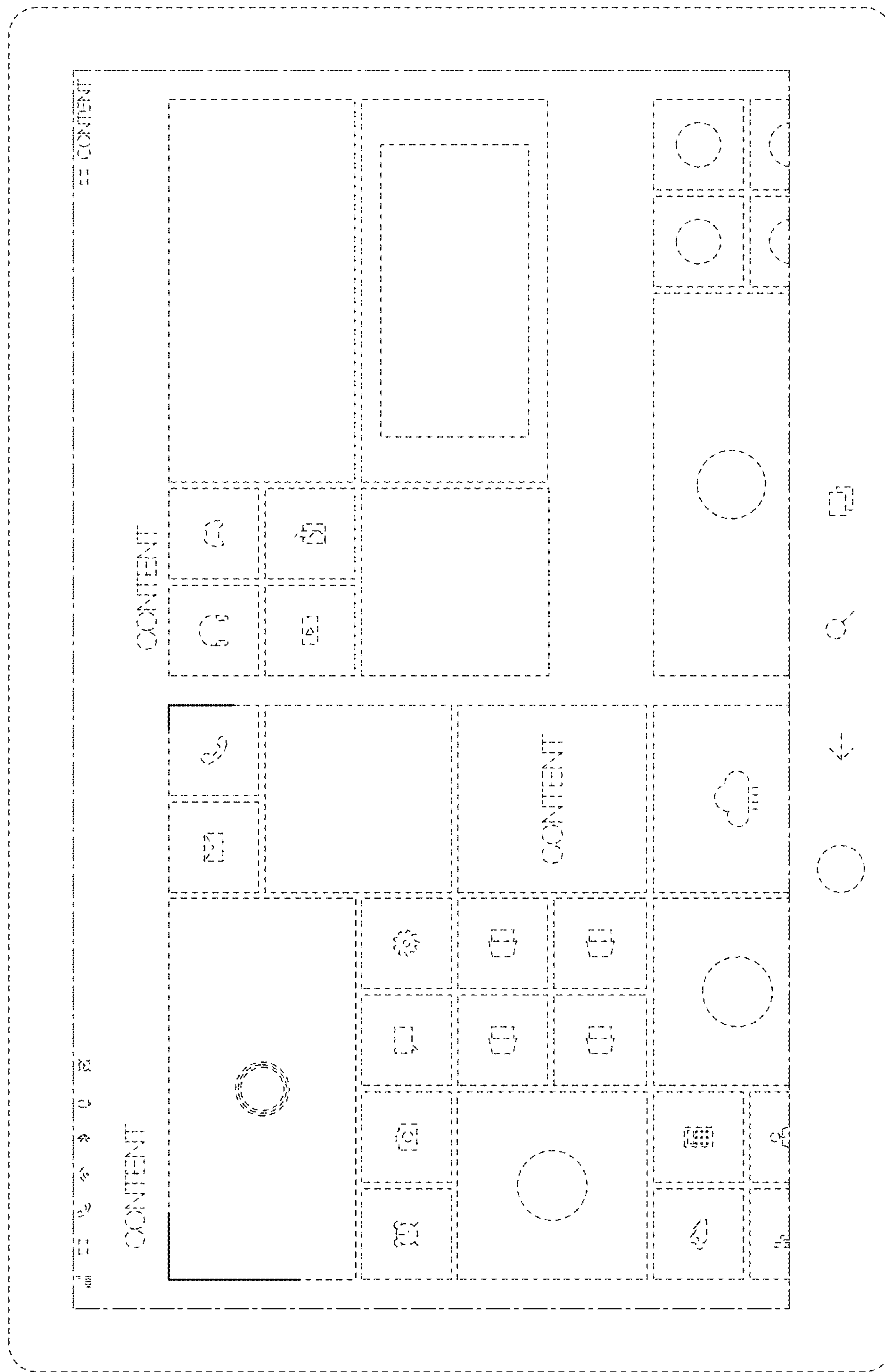
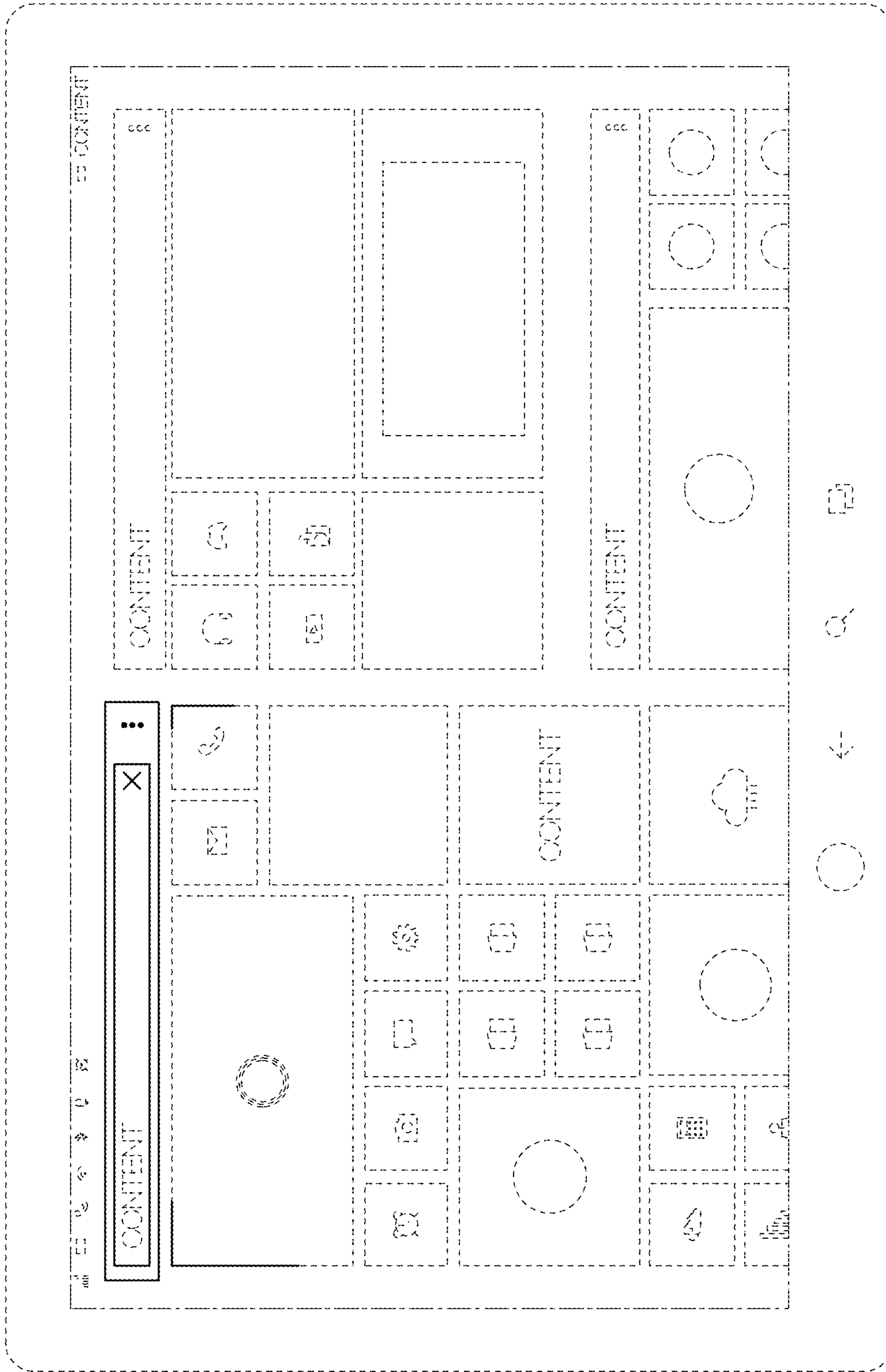

FIG. 1



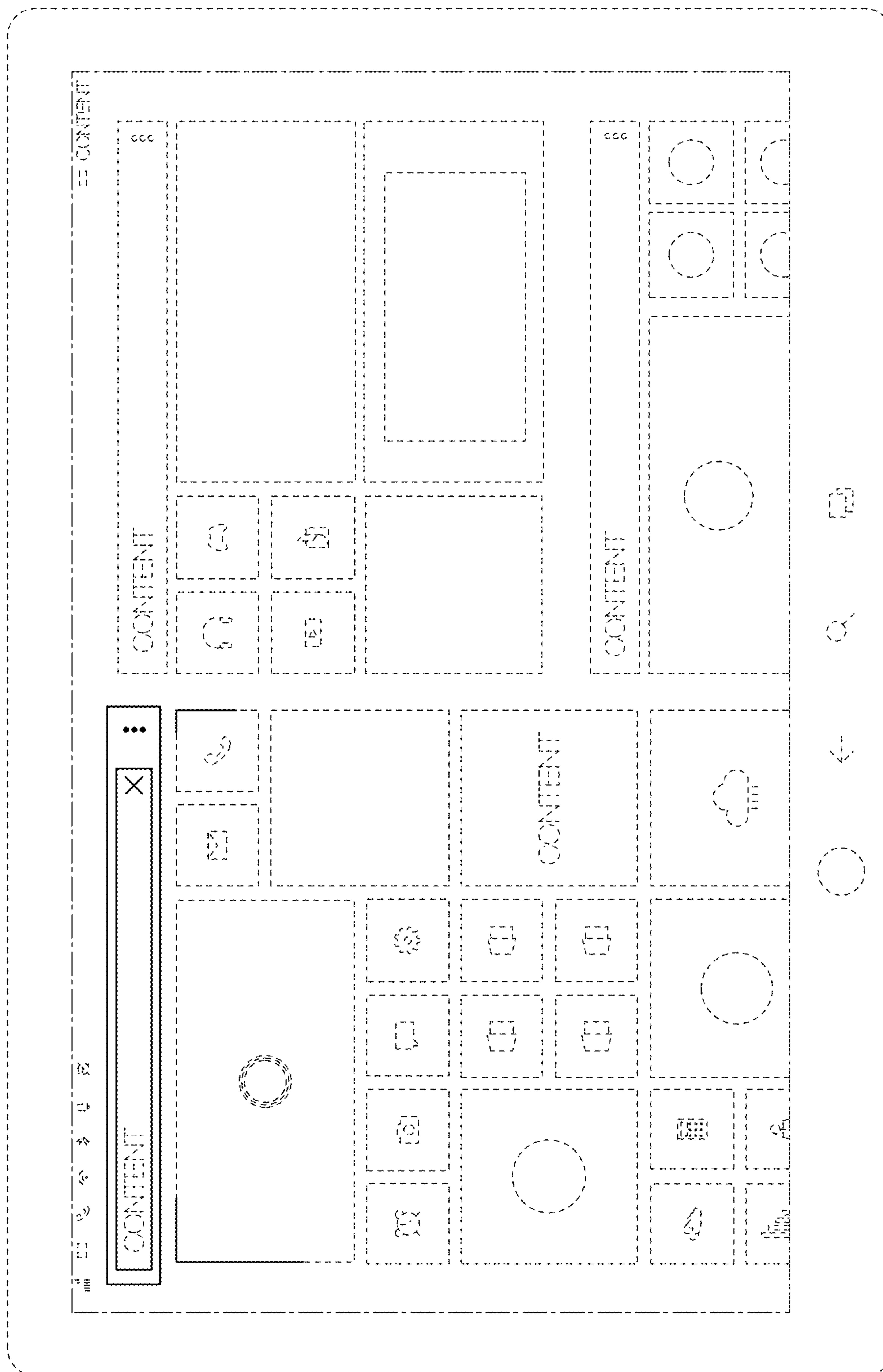

FIG. 3

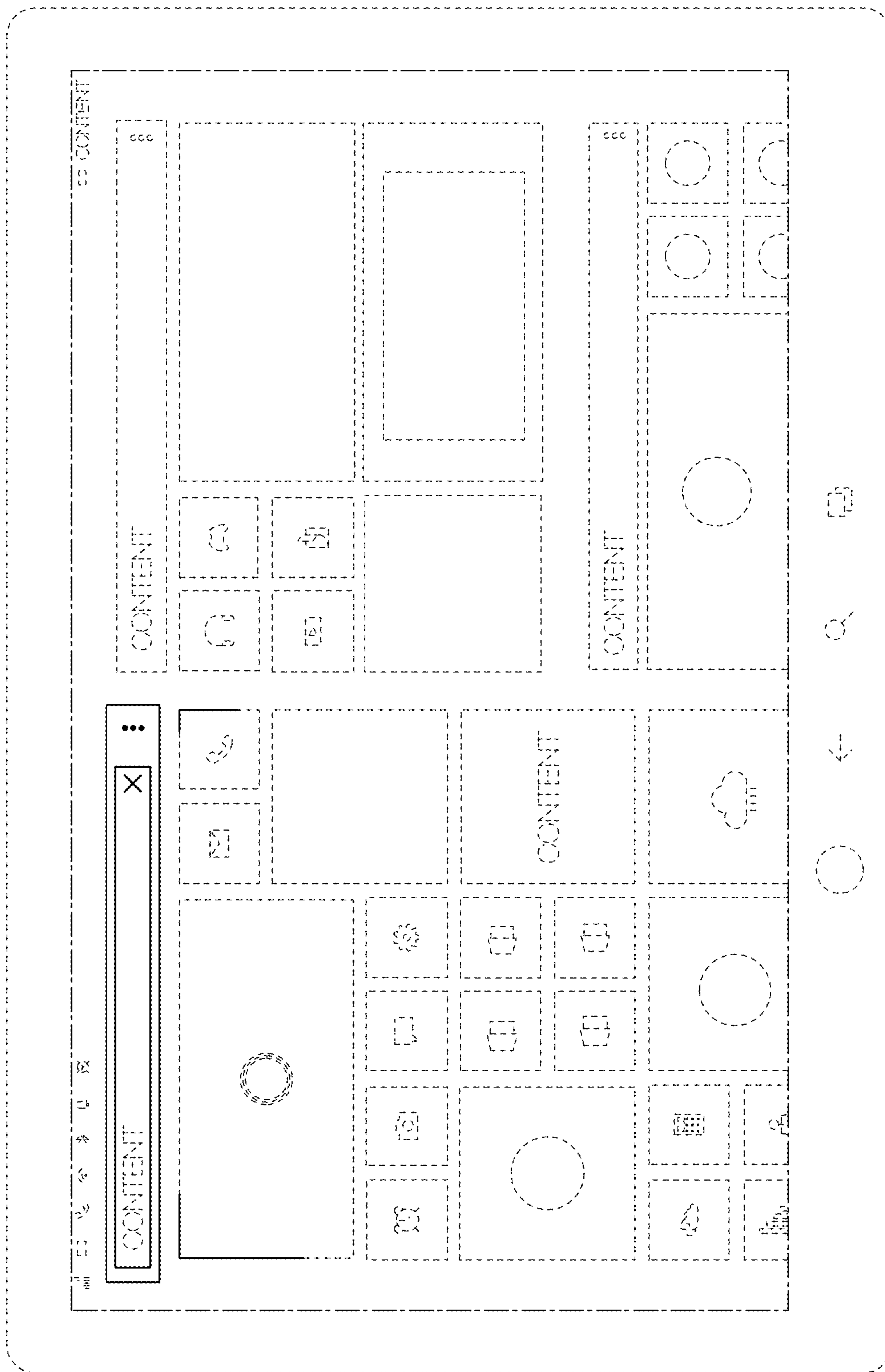

FIG. 4