



US00D769305S

(12) **United States Design Patent**
Williamson

(10) **Patent No.:** **US D769,305 S**
(45) **Date of Patent:** **** Oct. 18, 2016**

(54) **DISPLAY SCREEN WITH ANIMATED GRAPHICAL USER INTERFACE**

(71) Applicant: **Microsoft Corporation**, Redmond, WA (US)

(72) Inventor: **Conroy Williamson**, Redmond, WA (US)

(73) Assignee: **Microsoft Corporation**, Redmond, WA (US)

(**) Term: **14 Years**

(21) Appl. No.: **29/515,150**

(22) Filed: **Jan. 20, 2015**

(51) **LOC (10) Cl.** **14-04**

(52) **U.S. Cl.**
USPC **D14/488**

(58) **Field of Classification Search**
USPC D14/485-495
CPC .. G06F 3/0481; G06F 3/0482; G06F 3/0488;
G06F 3/0486; G06F 3/04883; G06F 3/04817;
G06F 17/30115; H04N 1/004
See application file for complete search history.

(56) **References Cited**

U.S. PATENT DOCUMENTS

5,818,455	A *	10/1998	Stone	G06T 3/0018	345/619
D599,363	S	9/2009	Mays			
D606,080	S *	12/2009	Murchie	D14/485	
D677,679	S *	3/2013	Edwards	D14/485	
D677,680	S *	3/2013	Edwards	D14/485	
D678,893	S *	3/2013	Ho Kushner	D14/485	
D682,849	S *	5/2013	Aoshima	D14/485	
D692,448	S *	10/2013	Jung	D14/486	
D692,906	S *	11/2013	Coudron	D14/486	
D701,228	S *	3/2014	Lee	D14/486	
D719,971	S *	12/2014	Tabata	D14/486	
D741,872	S *	10/2015	Hall	D14/485	

D746,305	S *	12/2015	Gray	D14/485	
D749,124	S *	2/2016	Danton	D14/488	
2013/0182138	A1 *	7/2013	Cho	G06F 9/4445	348/211.3
2015/0009391	A1 *	1/2015	Kim	H04N 5/23216	348/333.05
2015/0286343	A1 *	10/2015	Welicki	G06F 3/0481	715/763

* cited by examiner

Primary Examiner — Karen E Kearney

Assistant Examiner — Andrew Nemeth

(74) *Attorney, Agent, or Firm* — Banner & Witcoff, Ltd.

(57) **CLAIM**

The ornamental design for a display screen with animated graphical user interface, as shown and described.

DESCRIPTION

FIG. 1 is the first image in a sequence for a display screen with animated graphical user interface showing my new design;

FIG. 2 is the second image thereof;

FIG. 3 is the third image thereof;

FIG. 4 is the fourth image thereof;

FIG. 5 is the fifth image thereof;

FIG. 6 is the sixth image thereof; and,

FIG. 7 is the seventh image thereof.

The appearance of the animated graphical user interface sequentially transitions between the images shown in FIGS. 1-7. The process or period in which one image transitions to another forms no part of the claimed design.

The broken line showing of the text, the icons, the remainder of the animated graphical user interface and the remainder of the display screen, illustrates portions of the display screen with animated graphical user interface, and forms no part of the claimed design. The broken line showing of an electronic device is for the purpose of illustrating environmental structure, and forms no part of the claimed design.

1 Claim, 7 Drawing Sheets

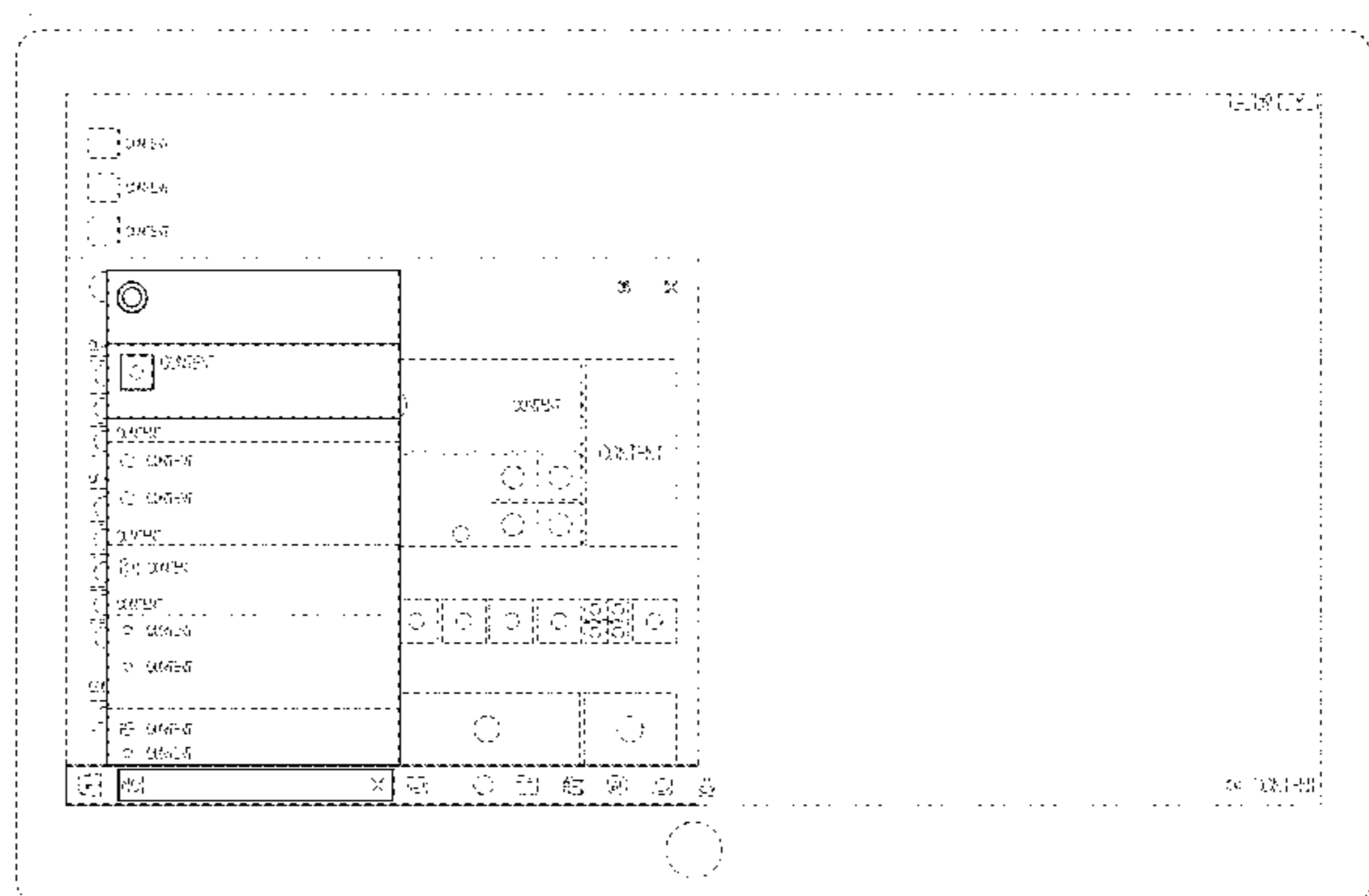
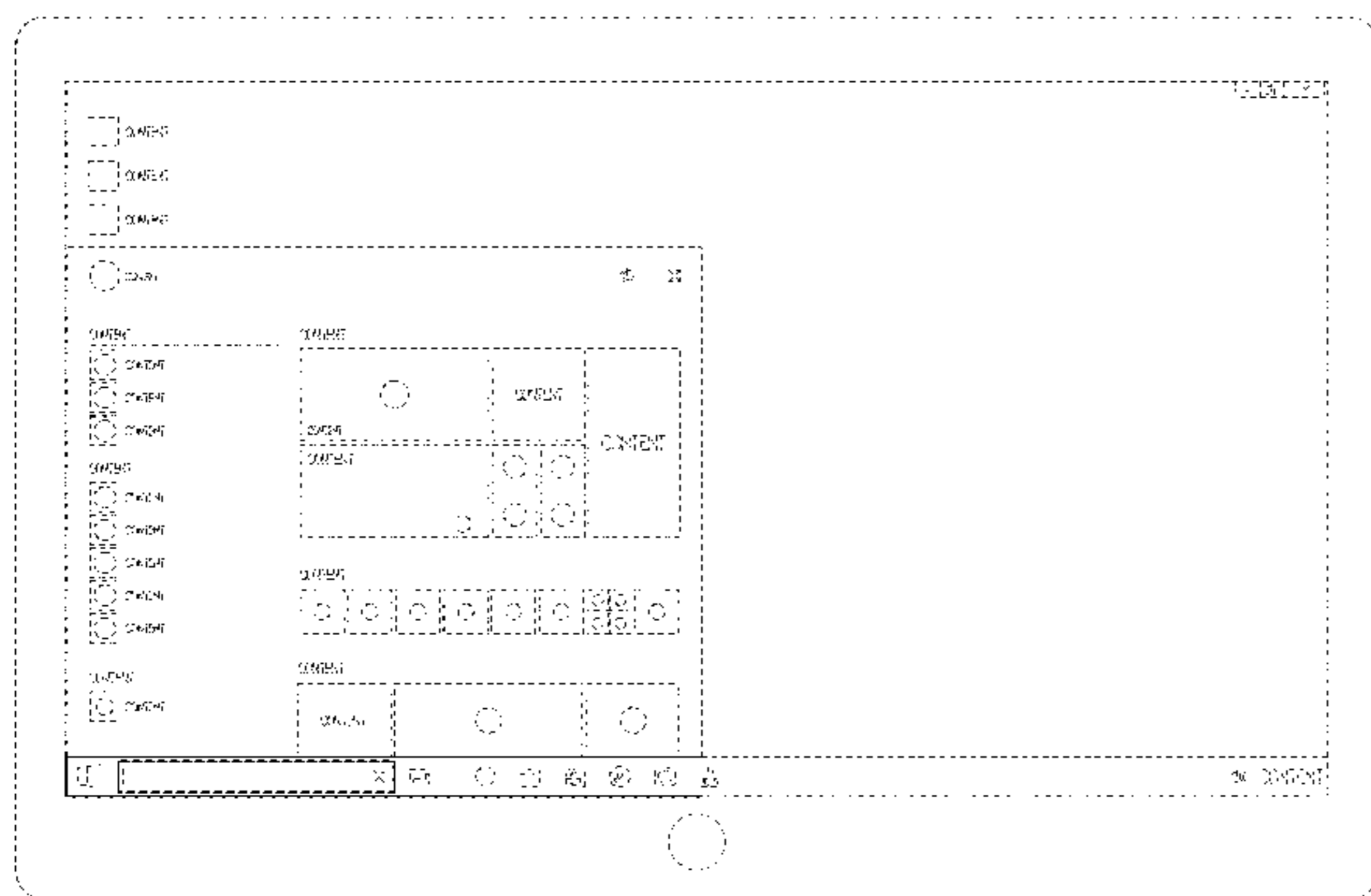

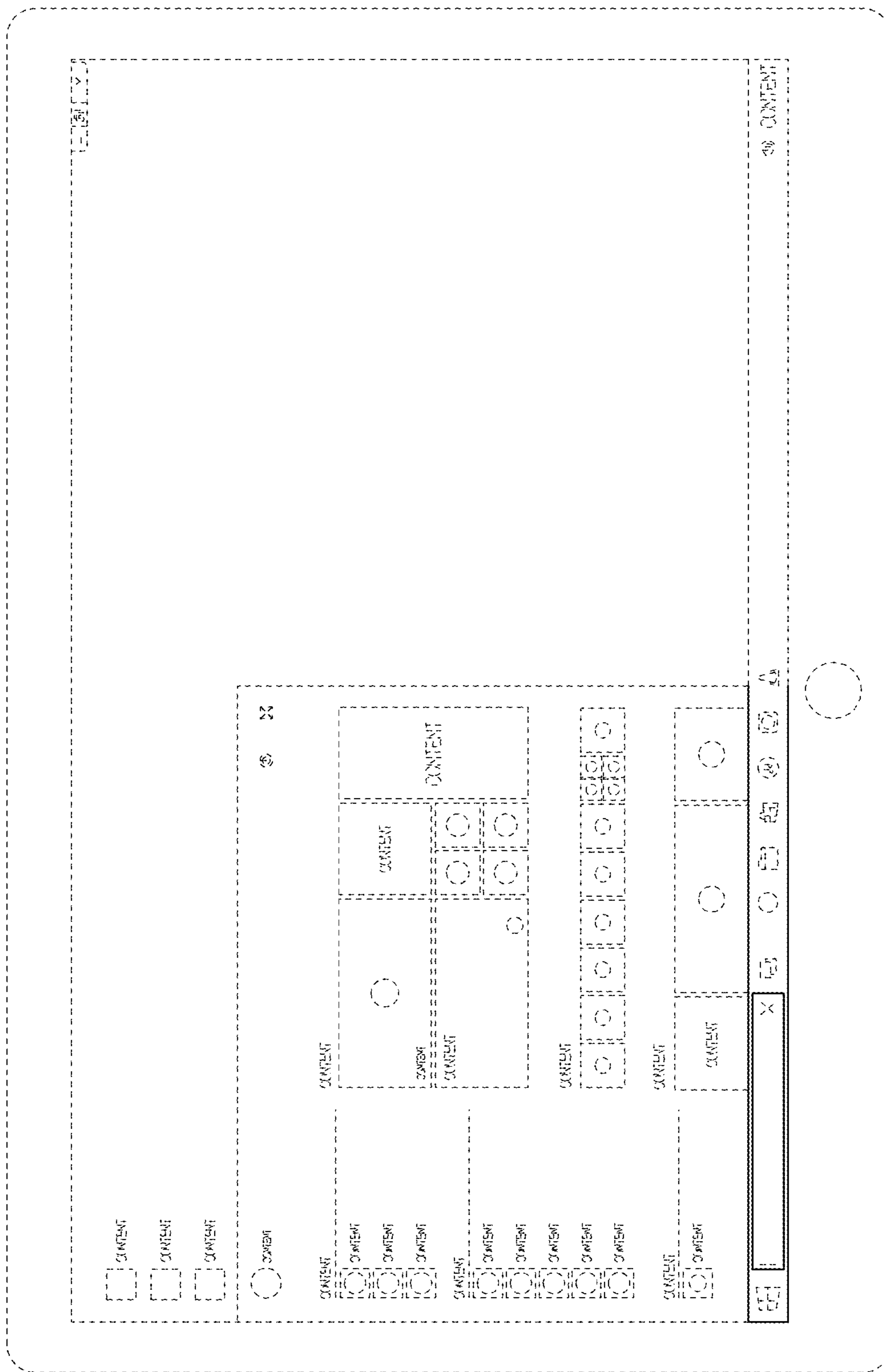

FIG. 1

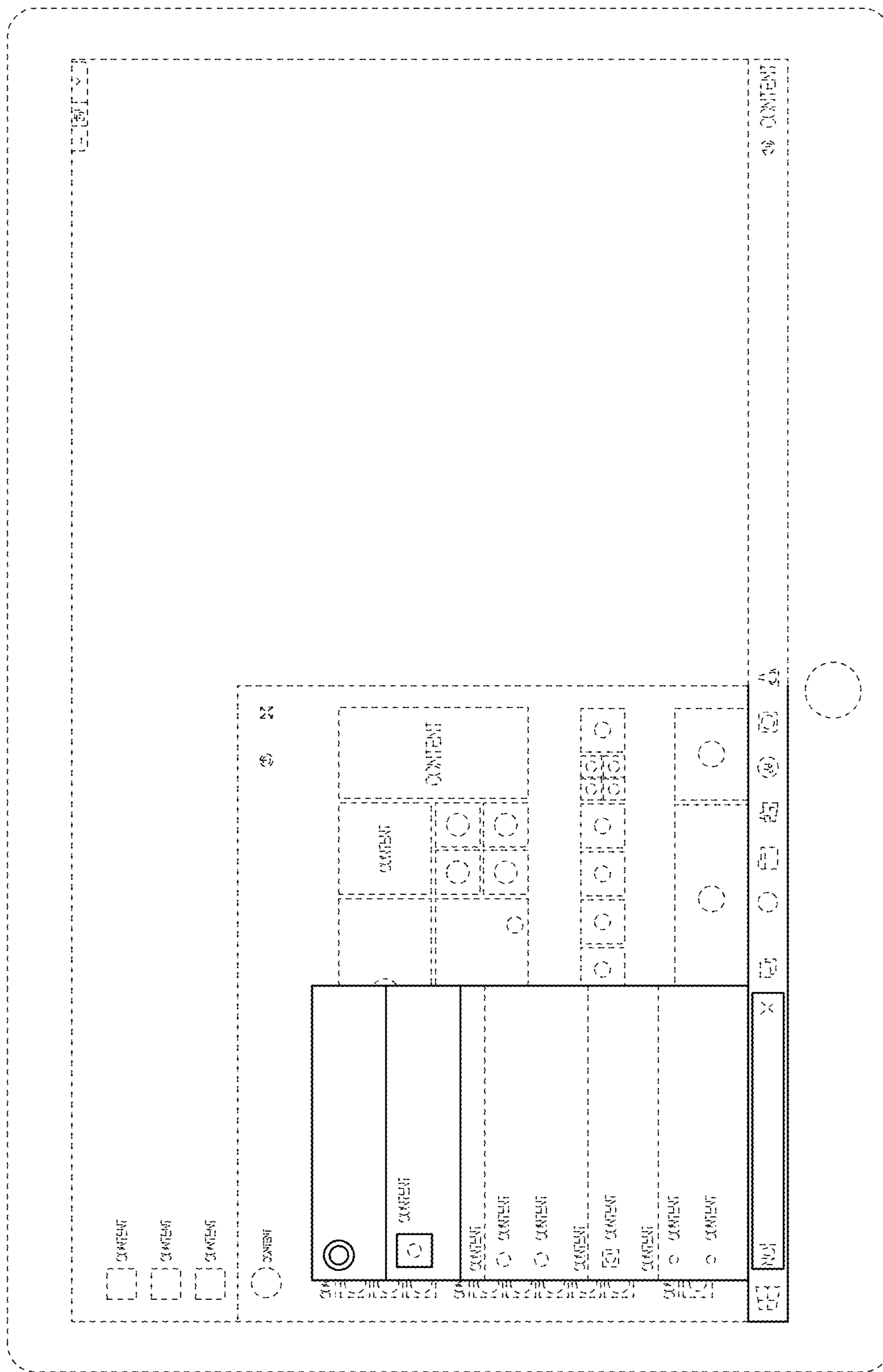

FIG. 2

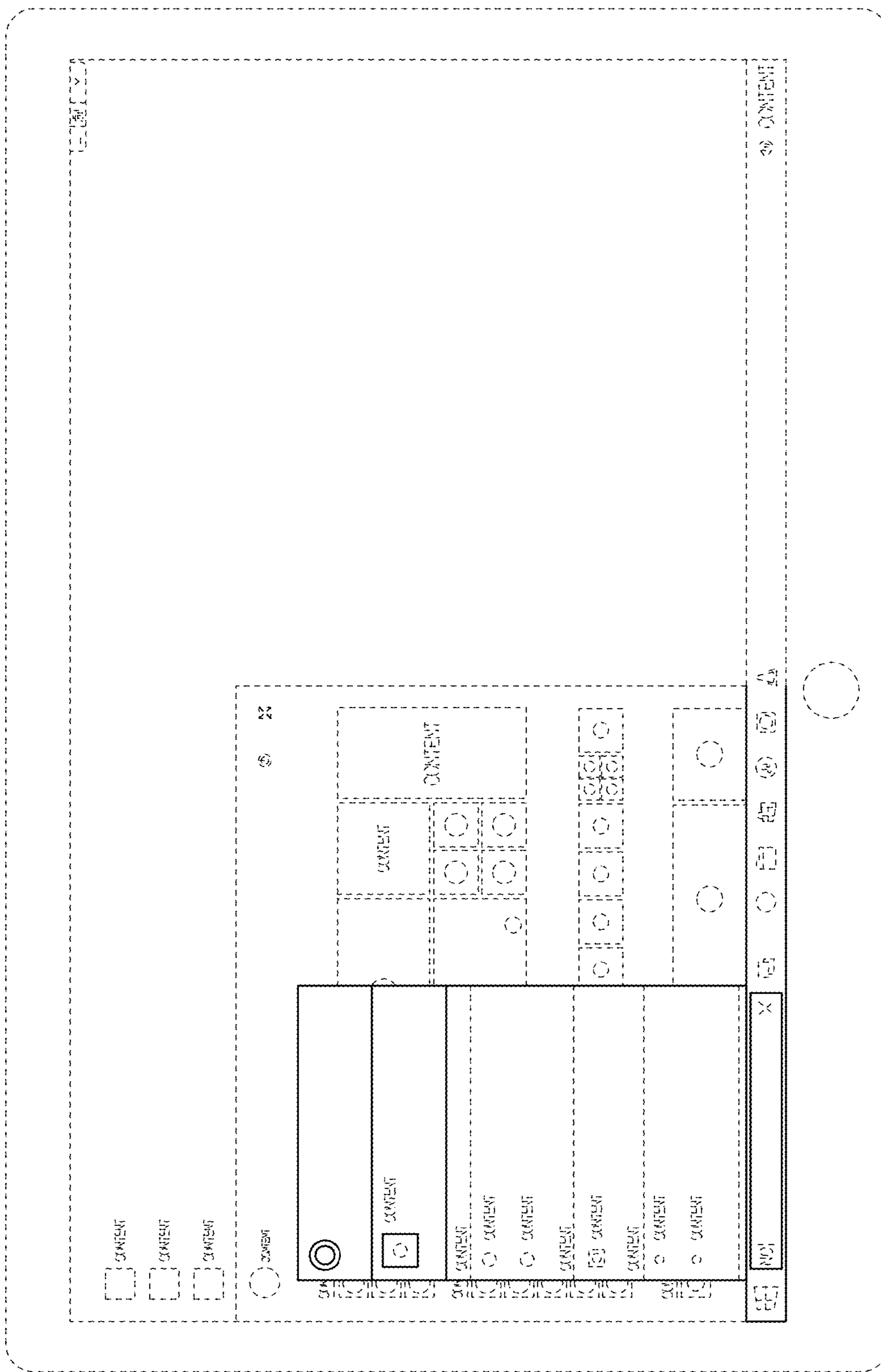

FIG. 3

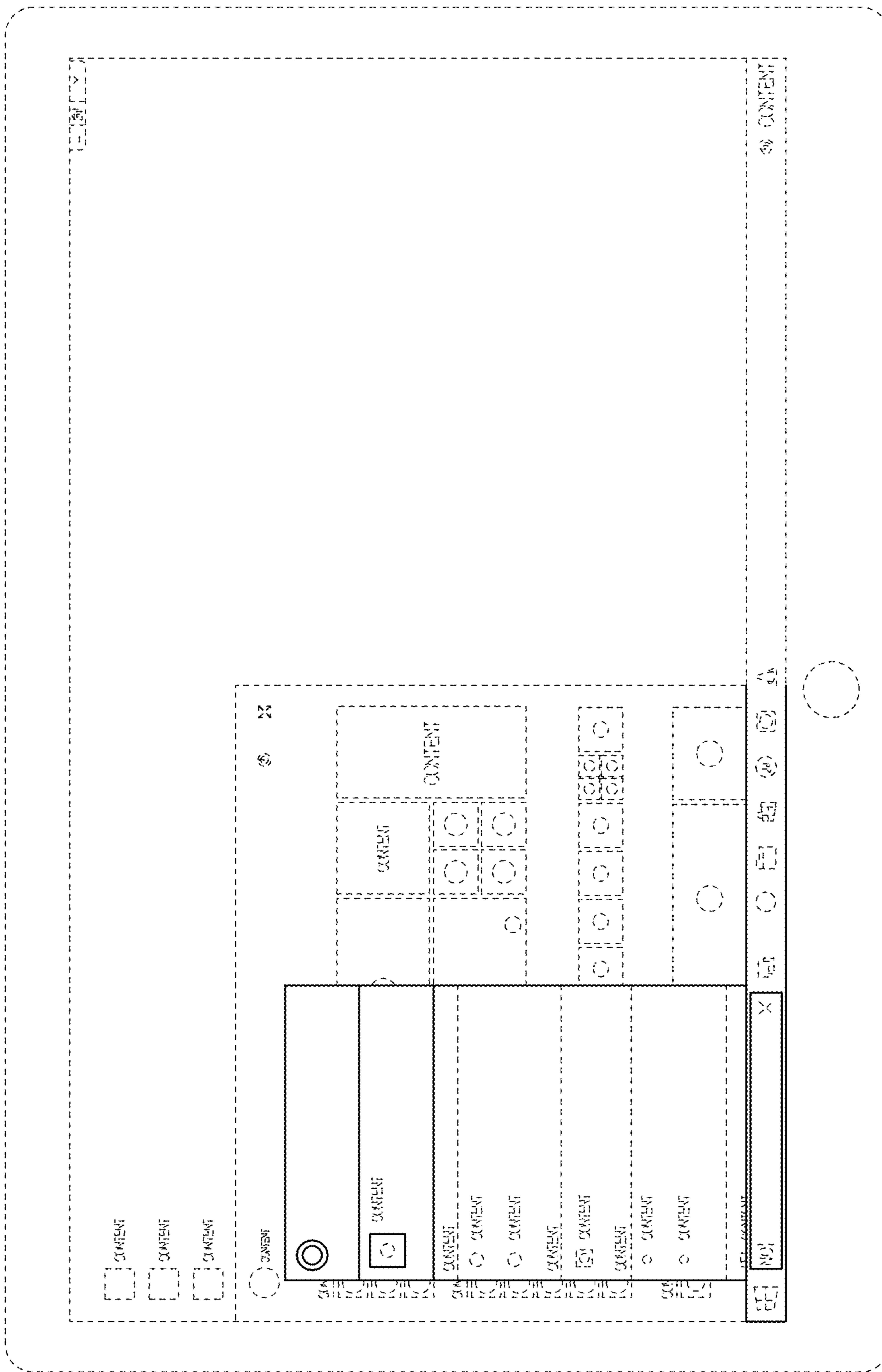

FIG. 4

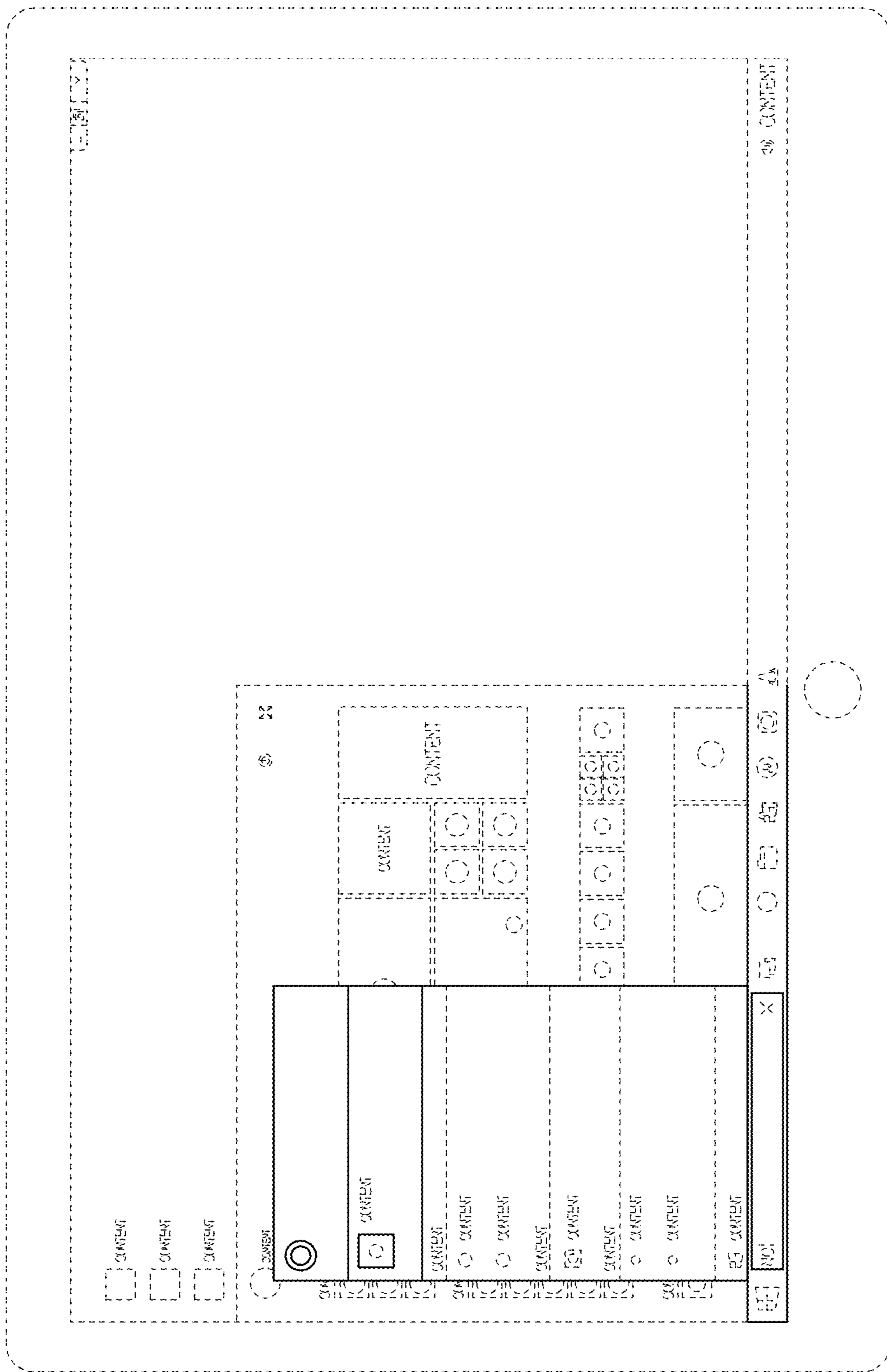

FIG. 5

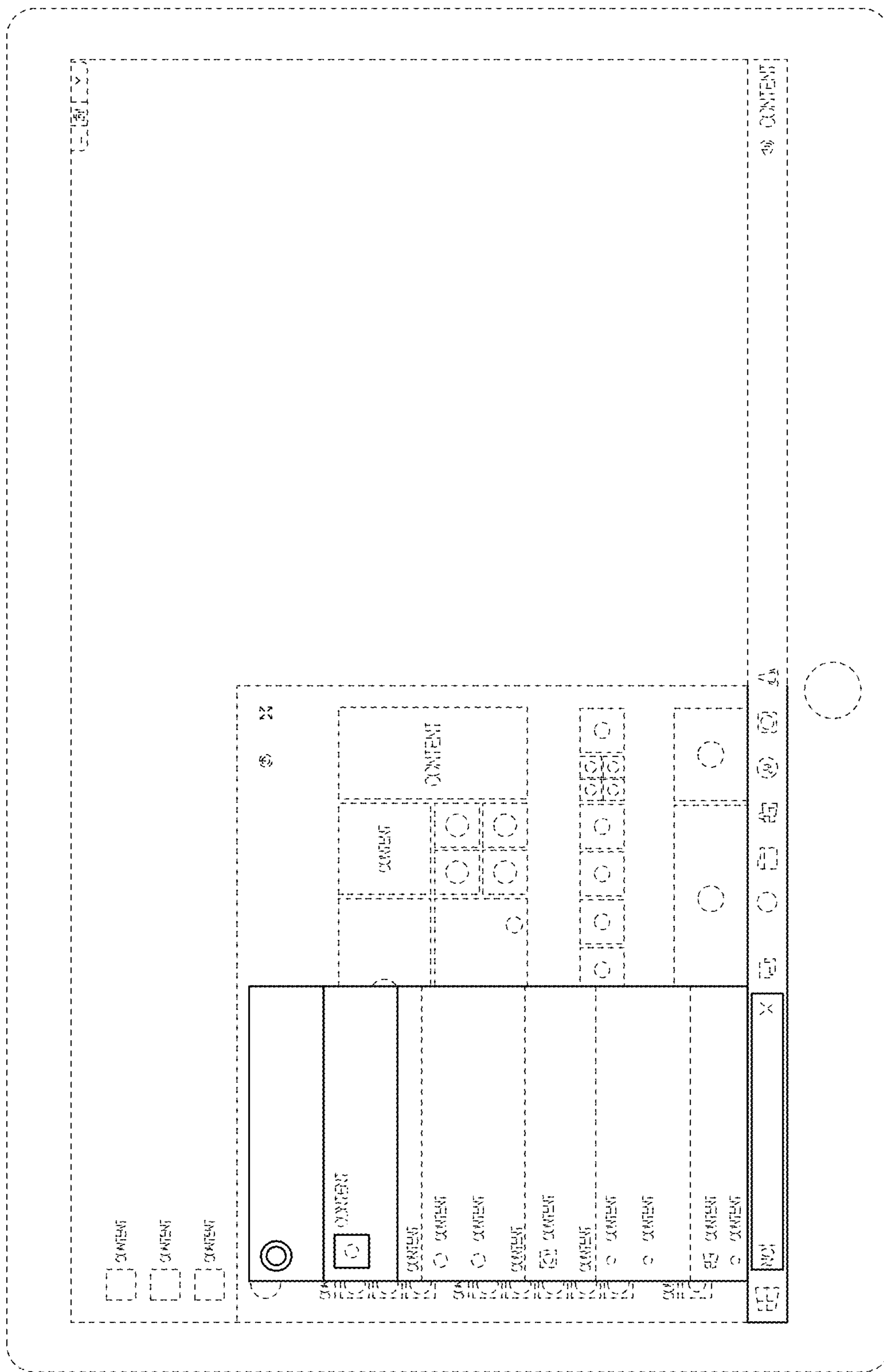

FIG. 7