



US00D769302S

(12) **United States Design Patent**
Rodriguez

(10) **Patent No.:** **US D769,302 S**

(45) **Date of Patent:** **** Oct. 18, 2016**

(54) **DISPLAY SCREEN WITH ANIMATED GRAPHICAL USER INTERFACE**

(71) Applicant: **Microsoft Corporation**, Redmond, WA (US)

(72) Inventor: **Jose Alberto Rodriguez**, Seattle, WA (US)

(73) Assignee: **Microsoft Corporation**, Redmond, WA (US)

(**) Term: **14 Years**

(21) Appl. No.: **29/515,075**

(22) Filed: **Jan. 20, 2015**

(51) **LOC (10) Cl.** **14-04**

(52) **U.S. Cl.**
USPC **D14/488**

(58) **Field of Classification Search**
USPC D14/485-495
CPC .. G06F 3/0481; G06F 3/0482; G06F 3/0486;
G06F 3/0488; G06F 17/30155; H04N 1/004
See application file for complete search history.

(56) **References Cited**

U.S. PATENT DOCUMENTS

D604,322	S	*	11/2009	Hoefnagels	D14/488
D664,972	S	*	8/2012	Gleasant	D14/486
D673,172	S	*	12/2012	Peters	D14/487
D677,678	S	*	3/2013	Esterly	D14/485
D684,996	S	*	6/2013	Wenz	D14/495
D690,309	S	*	9/2013	Wenz	D14/485
D700,196	S	*	2/2014	Bae	D14/486
D703,220	S	*	4/2014	Ku	D14/485
D705,241	S	*	5/2014	Chen	D14/485
D707,235	S		6/2014	Arnold et al.		
D707,691	S		6/2014	Roberts et al.		
D708,623	S	*	7/2014	Roberts	D14/485
D708,624	S		7/2014	Arnold et al.		

8,766,928	B2	*	7/2014	Weeldreyer	G06F 3/0481 345/173
D728,613	S	*	5/2015	Chen	D14/485
D750,664	S	*	3/2016	Chen	D14/485
D751,596	S	*	3/2016	Ng	D14/486

* cited by examiner

Primary Examiner — Cathron Brooks

Assistant Examiner — Andrew Nemeth

(74) *Attorney, Agent, or Firm* — Banner & Witcoff, Ltd.

(57) **CLAIM**

The ornamental design for a display screen with animated graphical user interface, as shown and described.

DESCRIPTION

FIG. 1 is the first image in a sequence for a display screen with animated graphical user interface showing my new design;

FIG. 2 is the second image thereof;

FIG. 3 is the third image thereof;

FIG. 4 is the fourth image thereof; and,

FIG. 5 is the fifth image thereof.

The appearance of the animated graphical user interface sequentially transitions between the images shown in FIGS. 1-5. The process or period in which one image transitions to another forms no part of the claimed design.

The claim is directed toward the rectangle and three lines shown in FIGS. 1-2, and the rectangle with two circles and three lines shown in FIGS. 3-5. The even-length broken line showing of an electronic device illustrates environmental structure and forms no part of the claimed design. The remainder of the even-length broken lines, including all of the text and all of the icons, illustrate portions of the graphical user interface and form no part of the claimed design. The uneven-length broken line illustrates a portion of the display screen and forms no part of the claimed design.

1 Claim, 5 Drawing Sheets

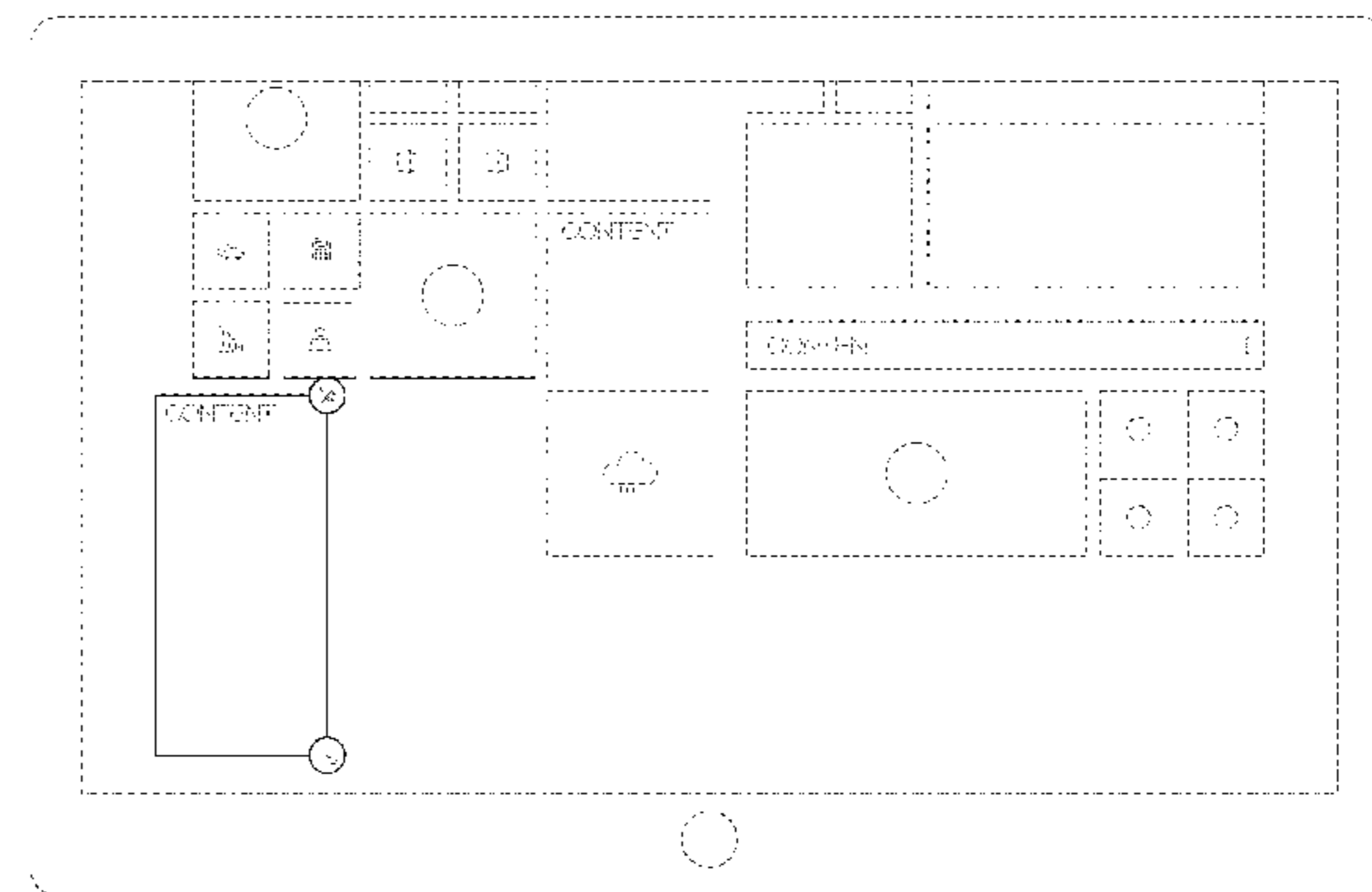
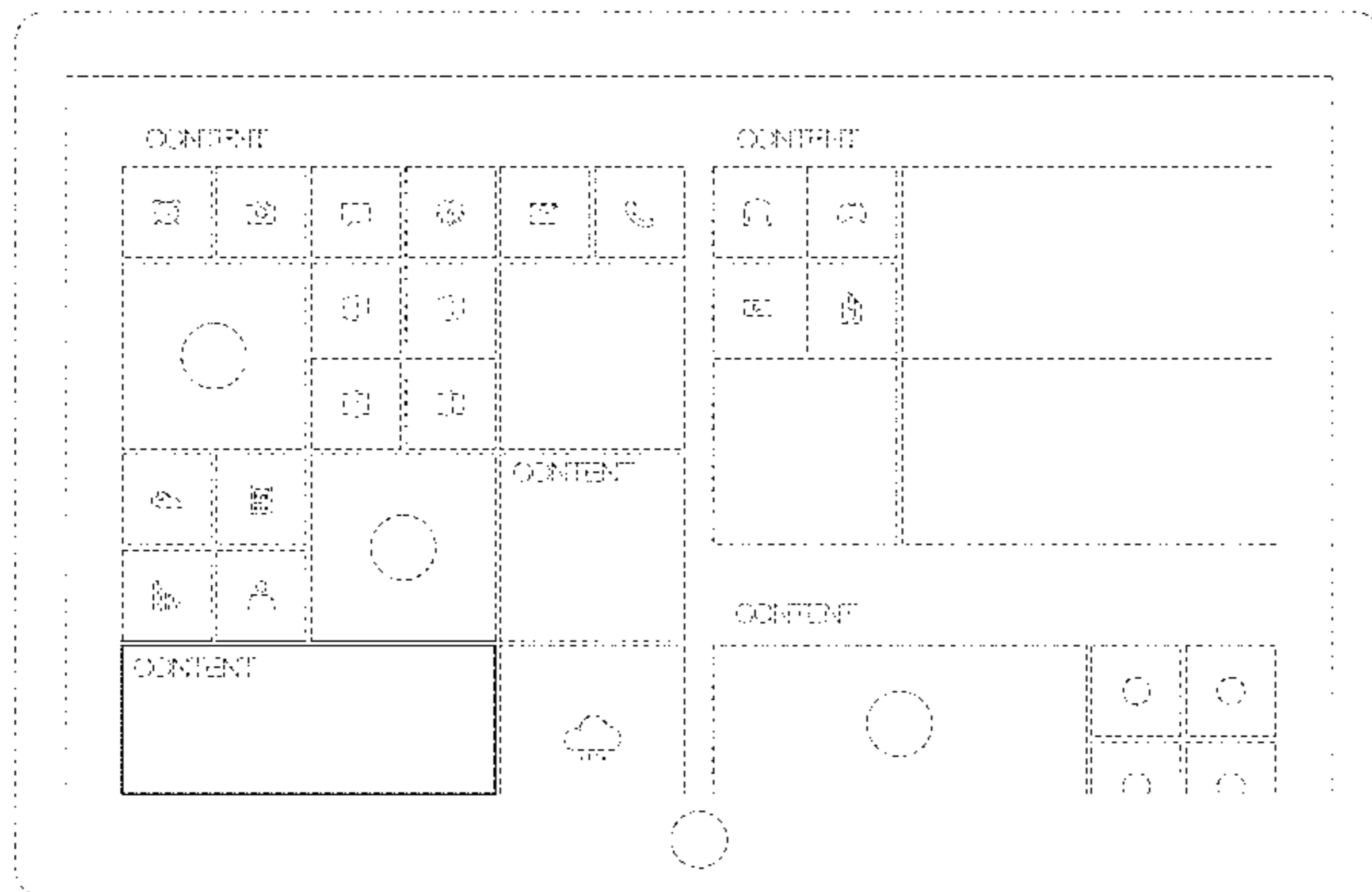

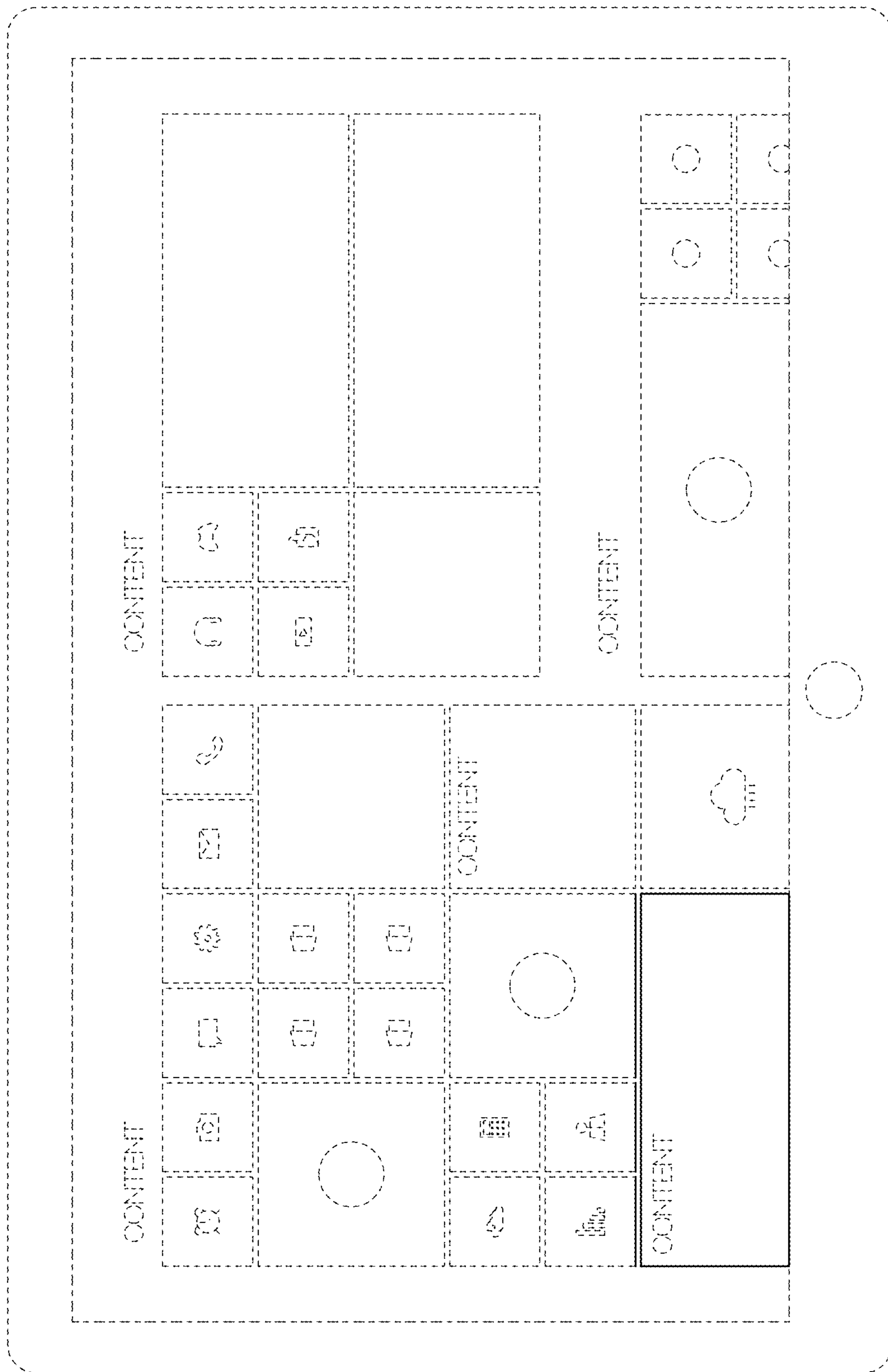

FIG. 1

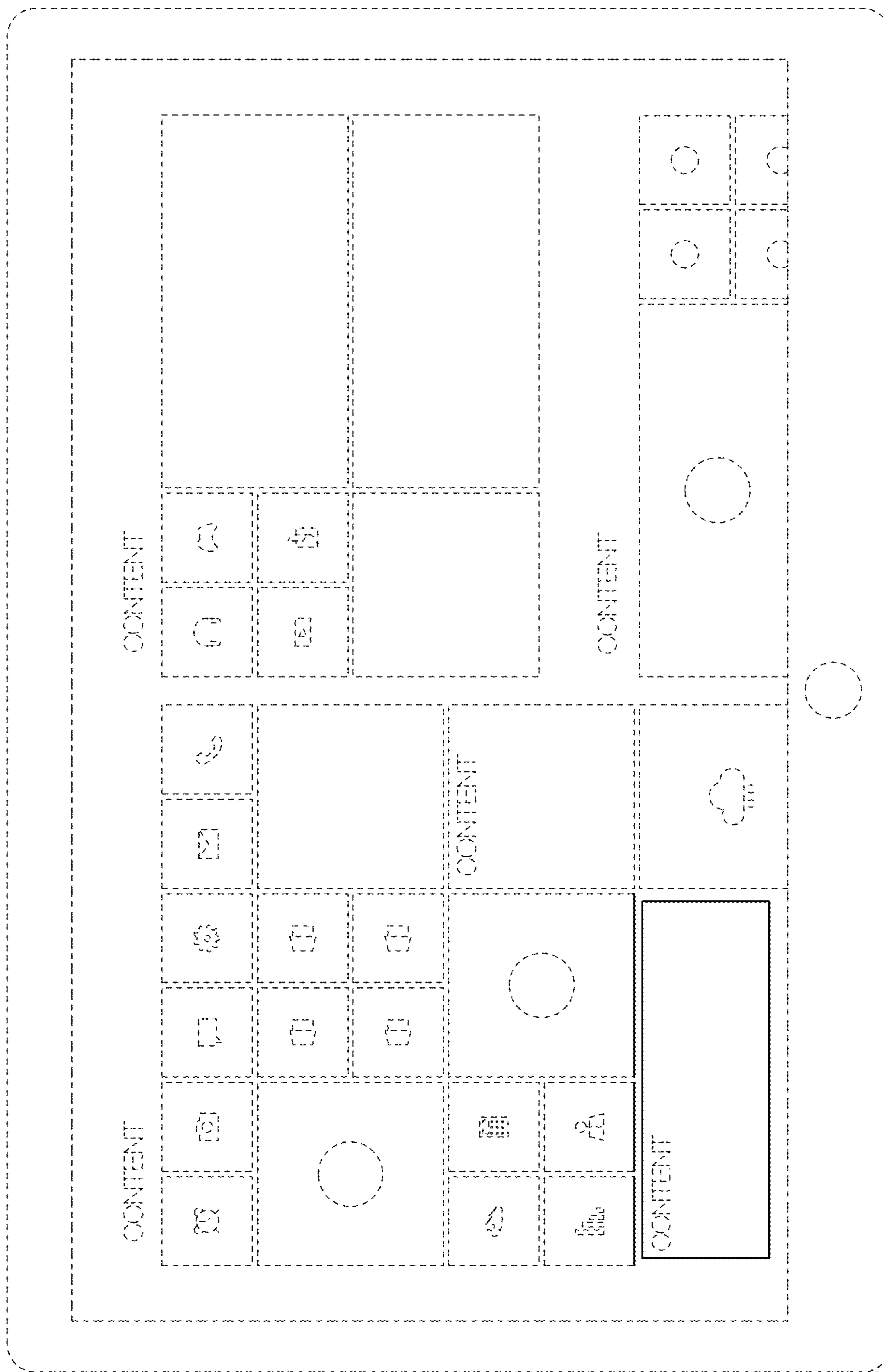

FIG. 2

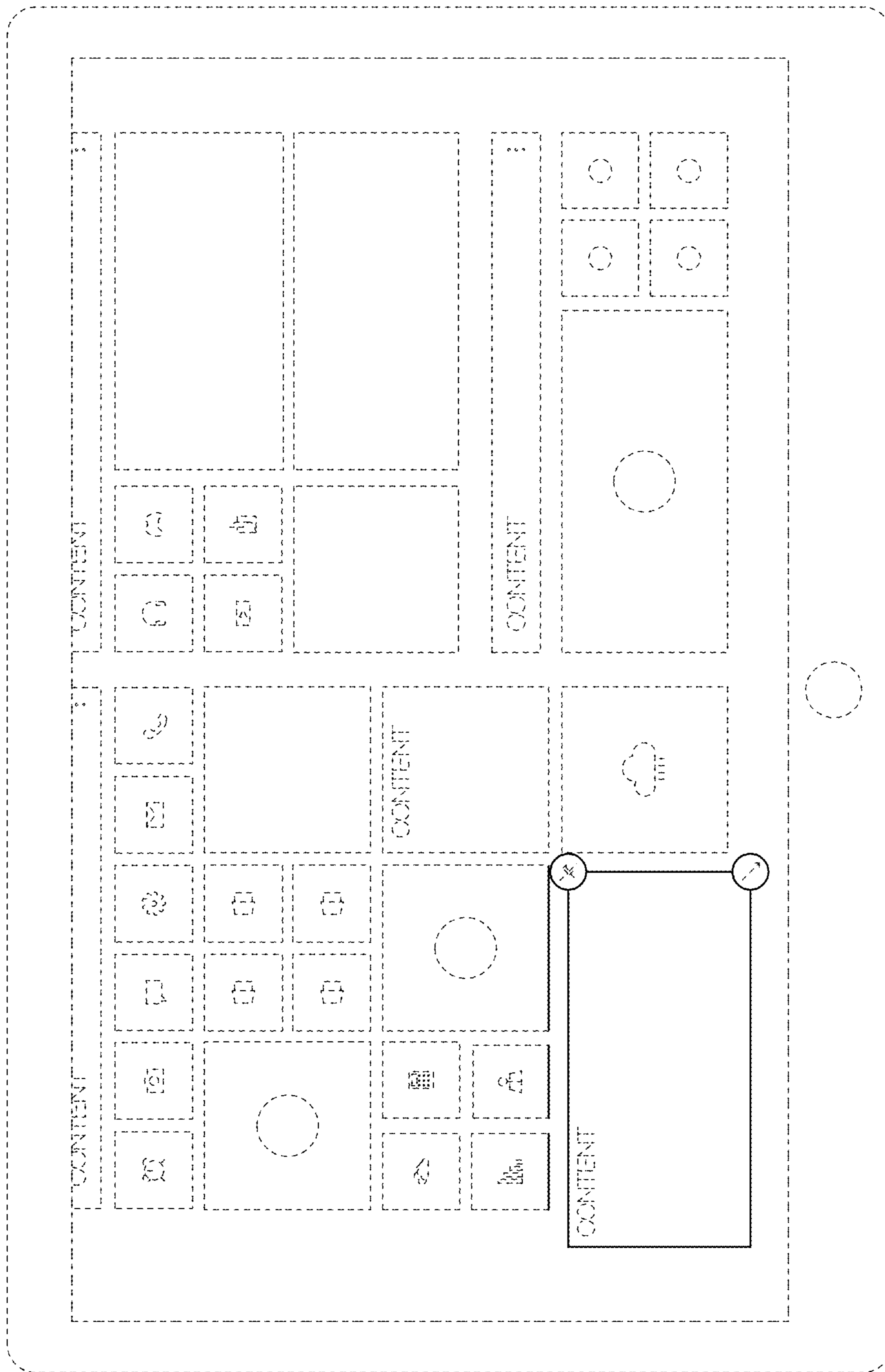

FIG. 3

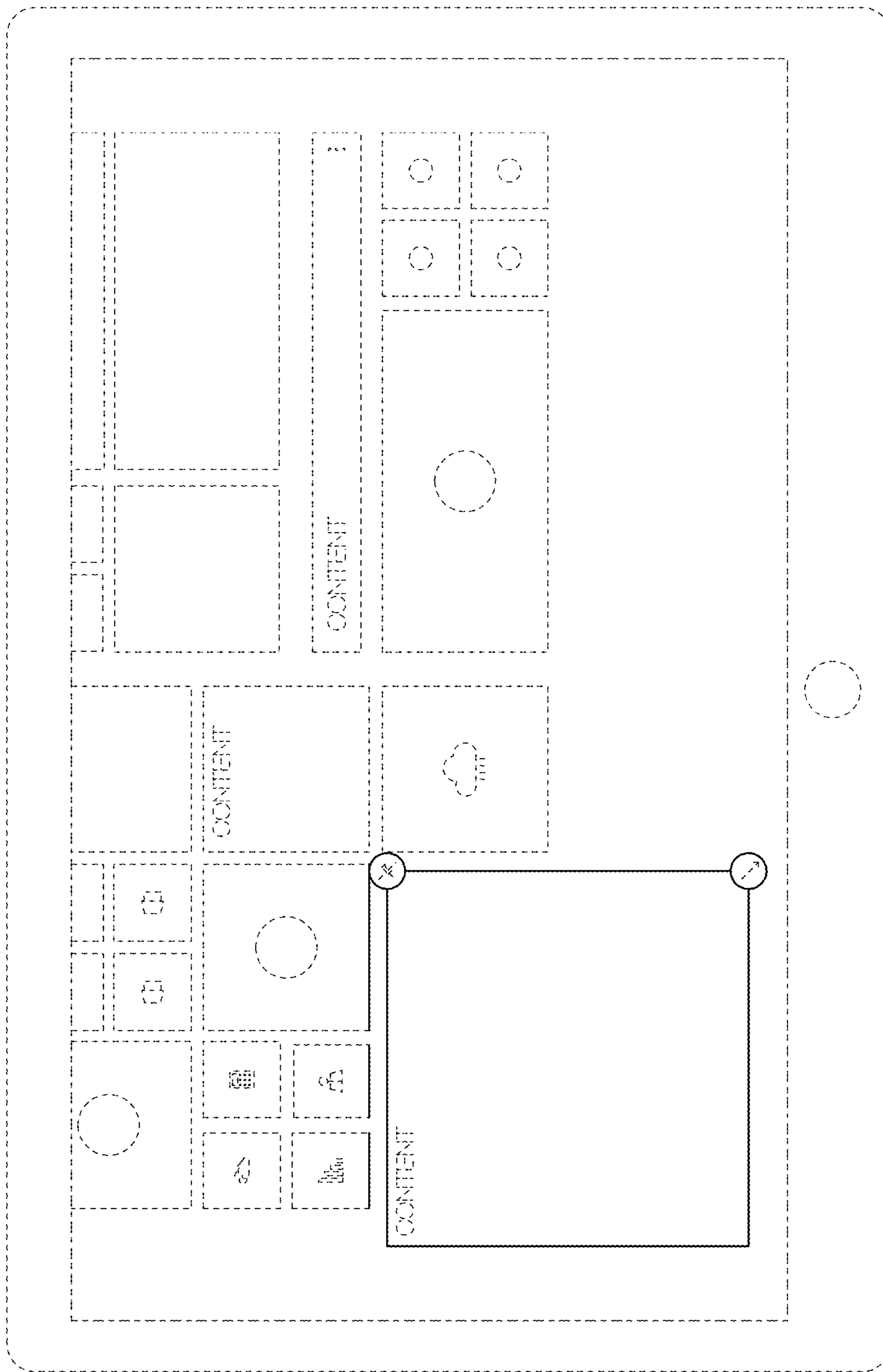

FIG. 4

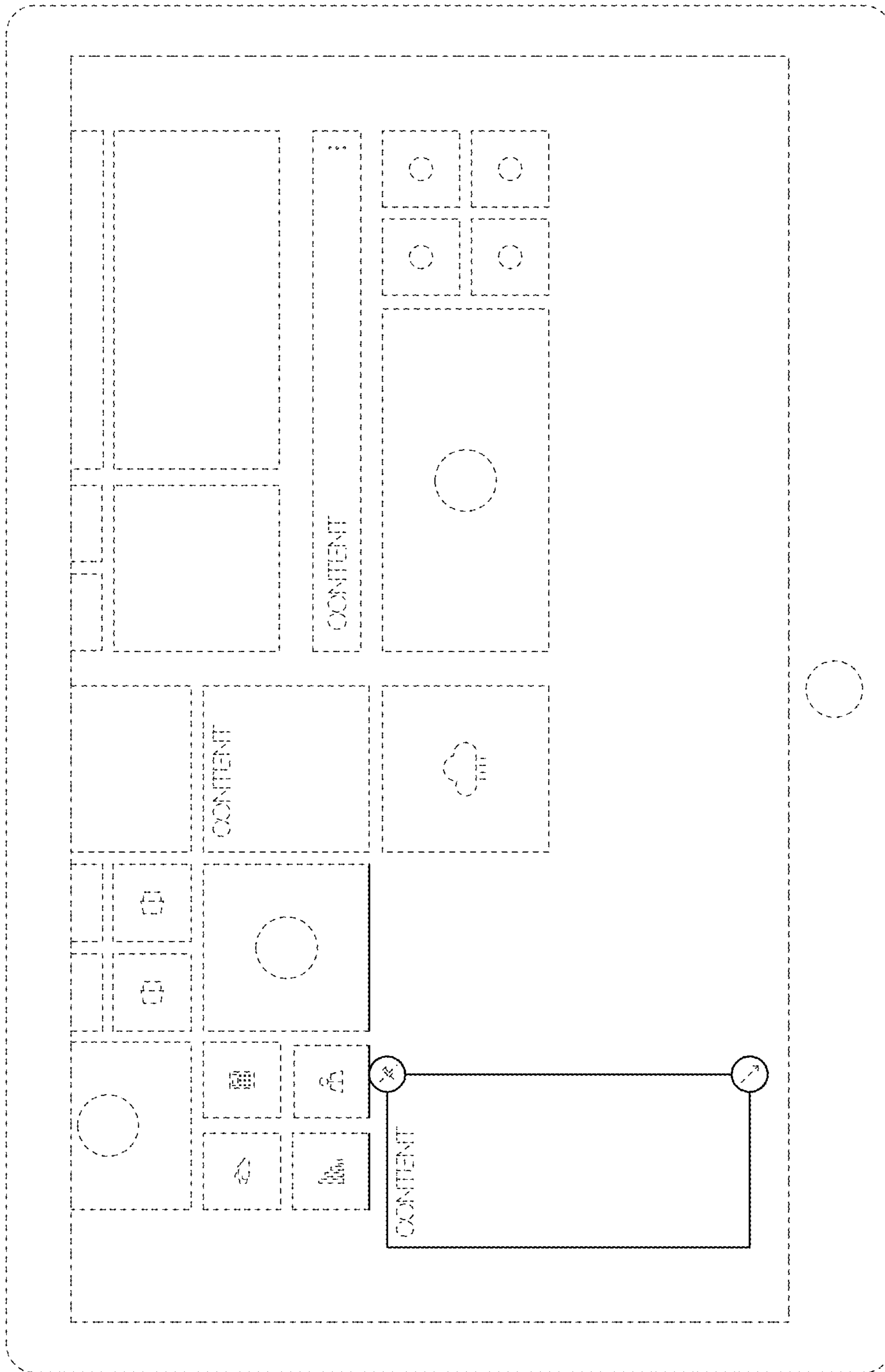

FIG. 5