



US00D769089S

(12) **United States Design Patent**
Chen

(10) **Patent No.:** **US D769,089 S**
(45) **Date of Patent:** **** Oct. 18, 2016**

(54) **ADJUSTING MEMBER FOR A BRAKE
CYLINDER ADJUSTER**

(71) Applicant: **JOINWIN CO., LTD.**, Tainan (TW)

(72) Inventor: **Shiao Hsiang Chen**, Taichung (TW)

(73) Assignee: **JOINWIN CO., LTD.**, Dali, Taichung
(TW)

(**) Term: **14 Years**

(21) Appl. No.: **29/504,378**

(22) Filed: **Oct. 6, 2014**

(51) **LOC (10) Cl.** **08-05**

(52) **U.S. Cl.**
USPC **D8/14; D8/51**

(58) **Field of Classification Search**
USPC D8/14, 51-59
CPC B25B 13/48; B25B 27/0035; F16D 65/0043
See application file for complete search history.

(56) **References Cited**

U.S. PATENT DOCUMENTS

1,705,582	A *	3/1929	May	A61G 15/10 248/316.2
6,095,017	A *	8/2000	Long	B25B 27/0035 81/176.15
6,339,981	B1 *	1/2002	Koochin	B25B 13/48 81/124.4
6,755,099	B2 *	6/2004	Huang	B25B 13/48 81/176.1
8,661,638	B2 *	3/2014	Chen	B25B 27/0035 29/239

9,174,330	B2 *	11/2015	Chen	B25B 27/0035
2015/0233437	A1 *	8/2015	Zdeb	F16D 65/0043 188/18 A
2016/0075544	A1 *	3/2016	Yang	F16D 65/18 254/134

* cited by examiner

Primary Examiner — Deanna L Pratt

(57) **CLAIM**

The ornamental design for an adjusting member for a brake cylinder adjuster, is as shown and described.

DESCRIPTION

FIG. 1 is a perspective view of an adjusting member for a brake cylinder adjuster showing my design; FIG. 2 is a front elevational view thereof; FIG. 3 is a rear elevational view thereof; FIG. 4 is a left side elevational view thereof; FIG. 5 is a right side elevational view thereof; FIG. 6 is a top plan view thereof; FIG. 7 is a bottom plan view thereof; and FIG. 8 is a schematic view thereof, in a condition that the adjusting member for a brake cylinder adjuster is in use with a brake cylinder adjuster; and, FIG. 9 is a schematic view thereof, in a condition that the adjusting member for a brake cylinder adjuster is in use with a brake cylinder adjuster. The broken line showing of the brake cylinder adjuster in FIGS. 8 and 9 illustrates the environment of the claimed design and forms no part thereof.

1 Claim, 6 Drawing Sheets

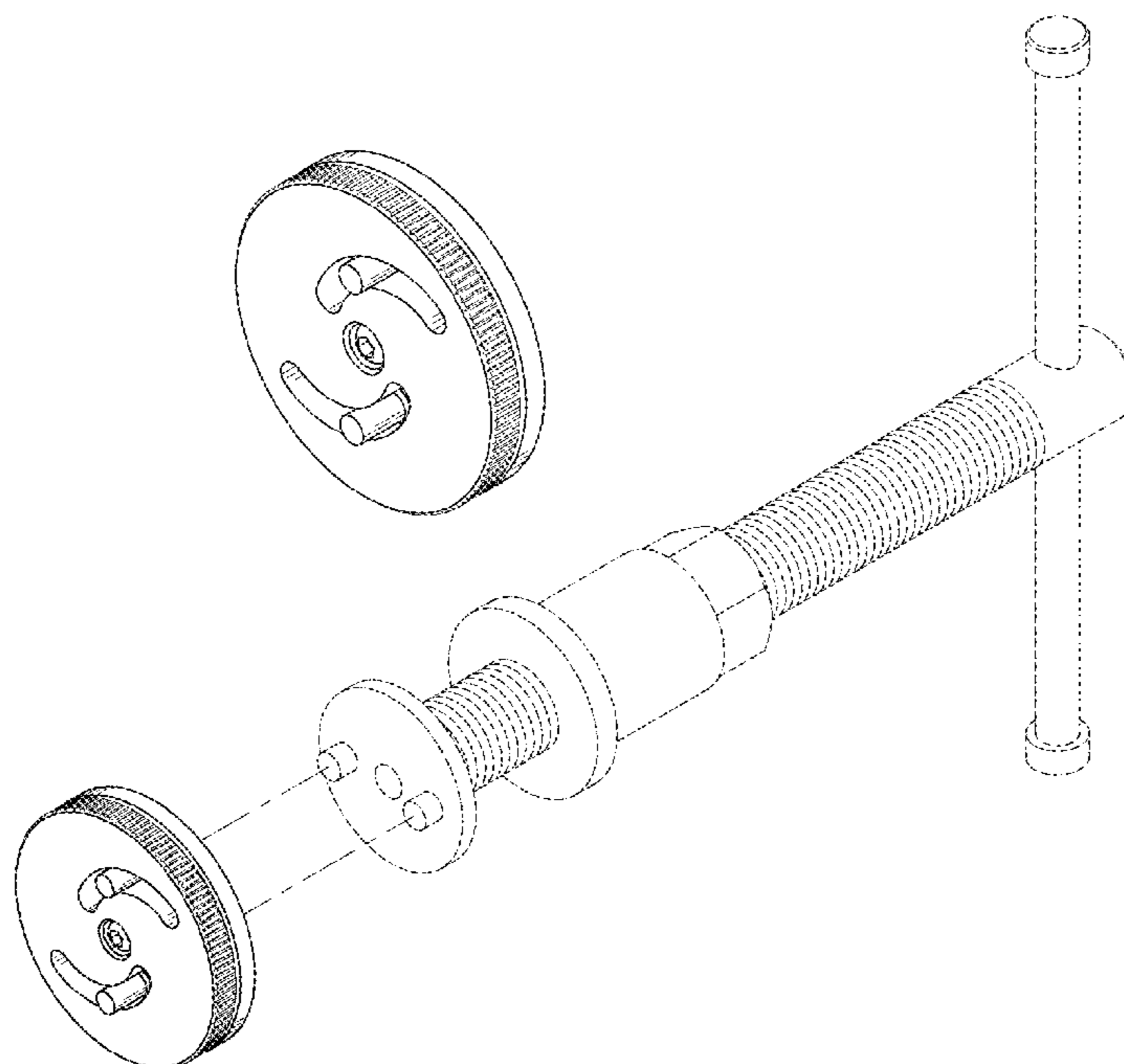

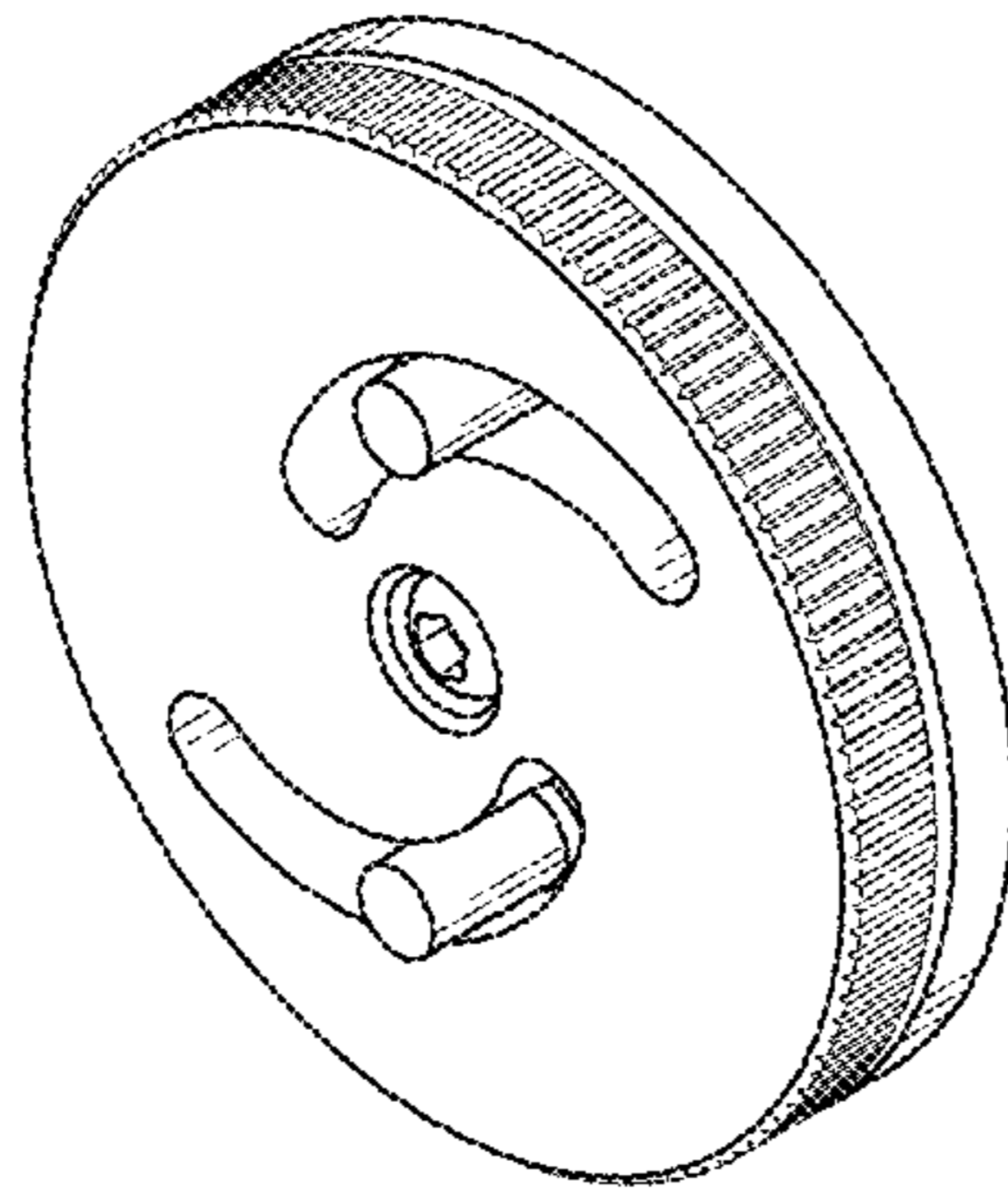

FIG.1

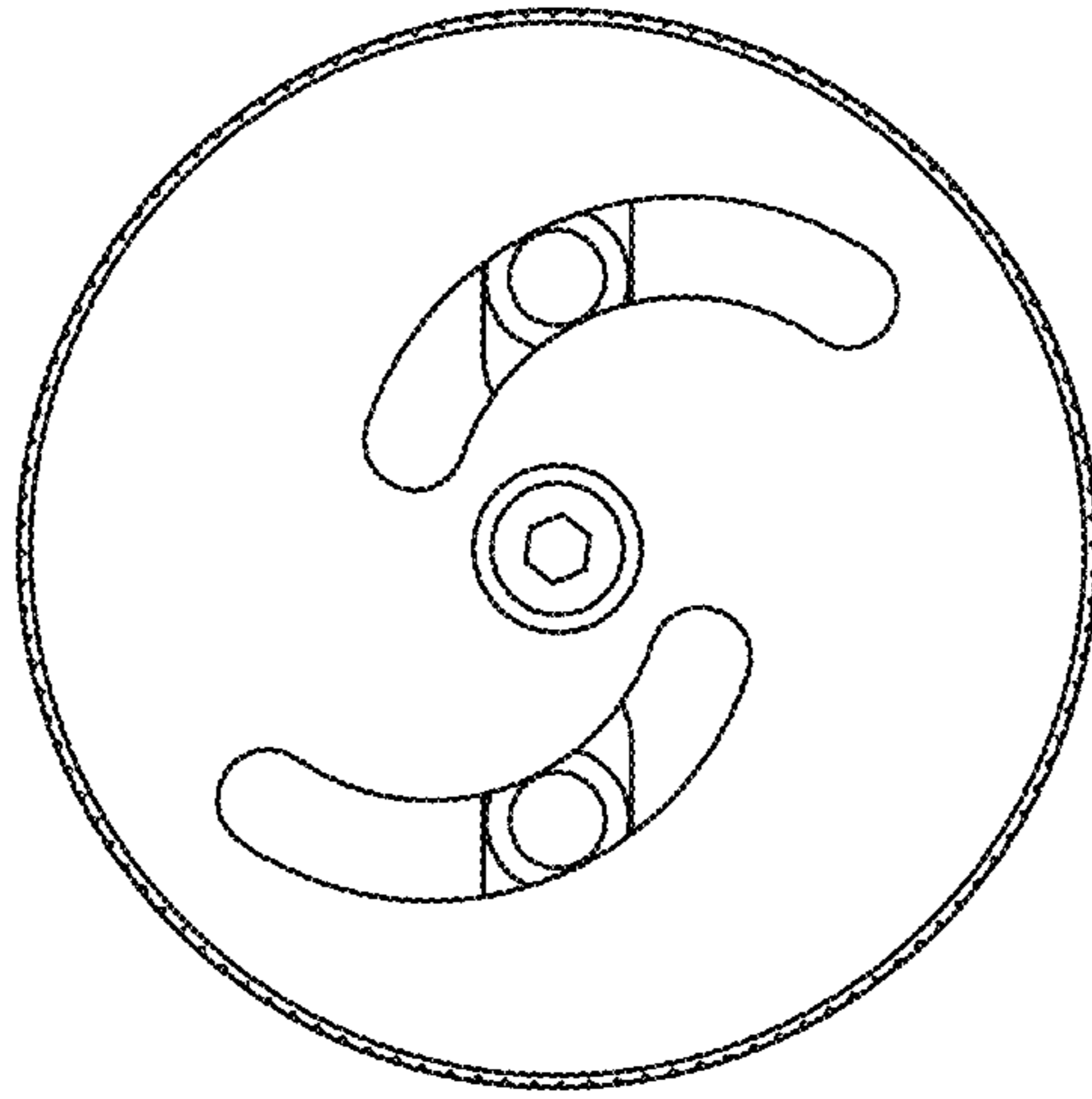

FIG. 2

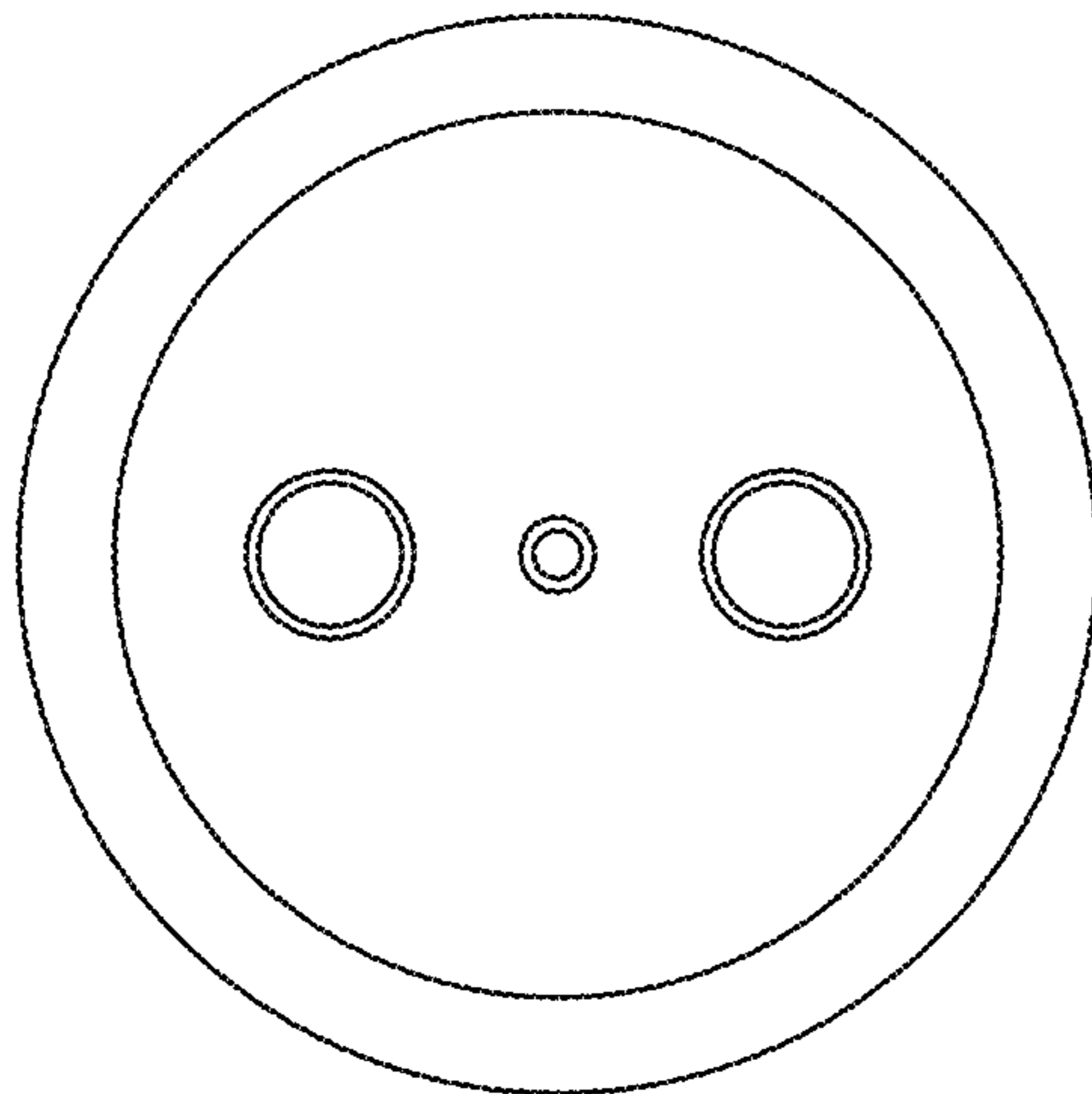

FIG. 3

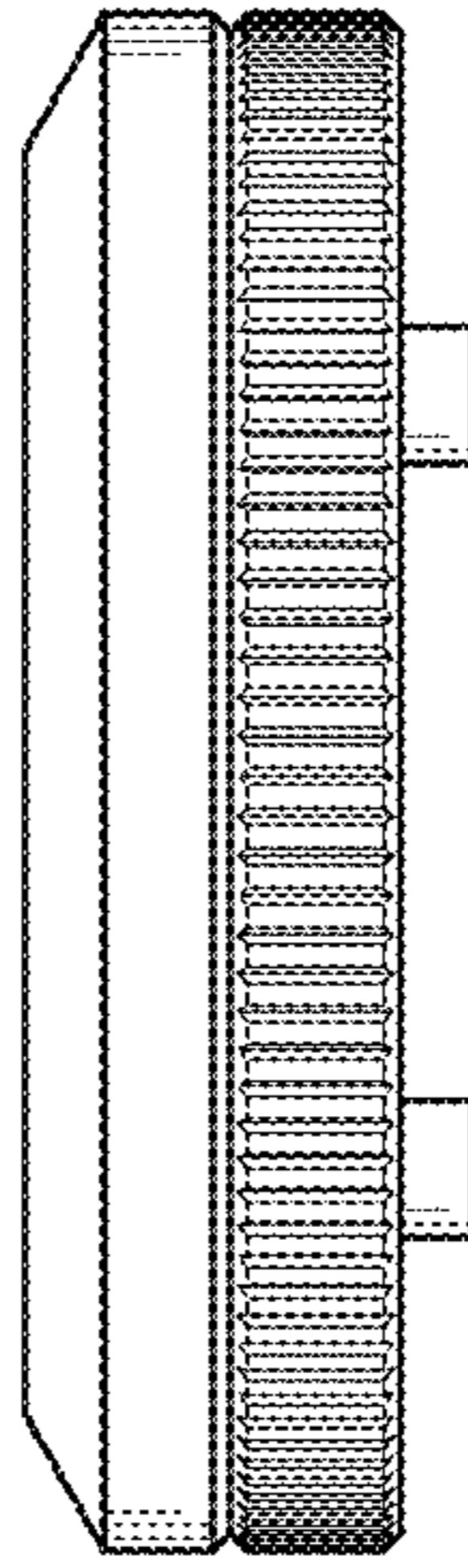

FIG. 4

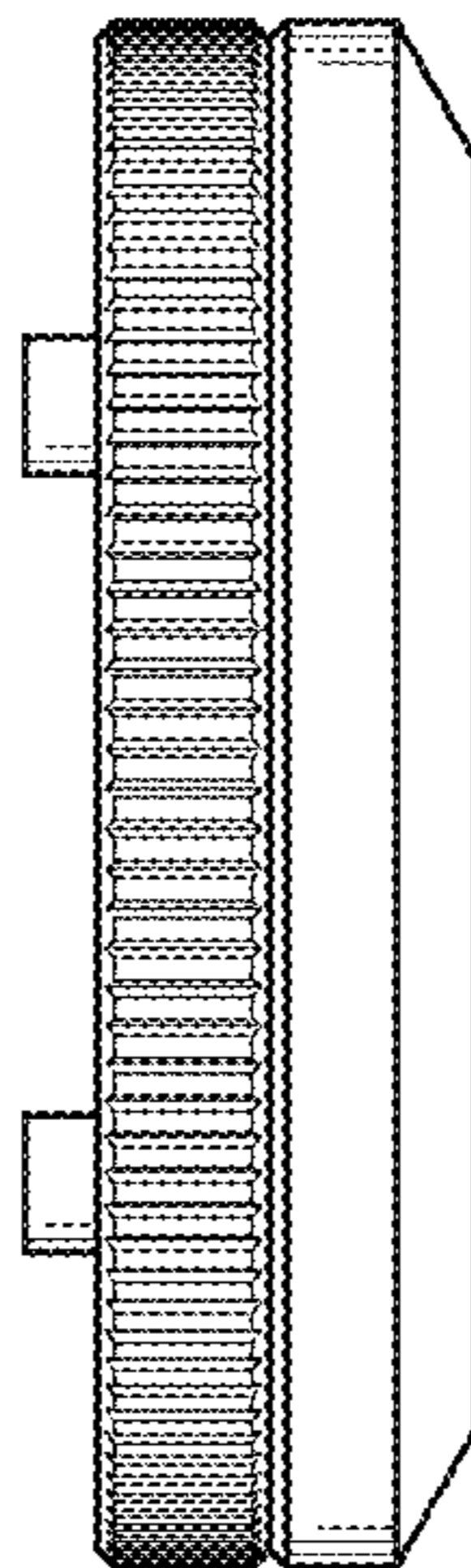

FIG. 5

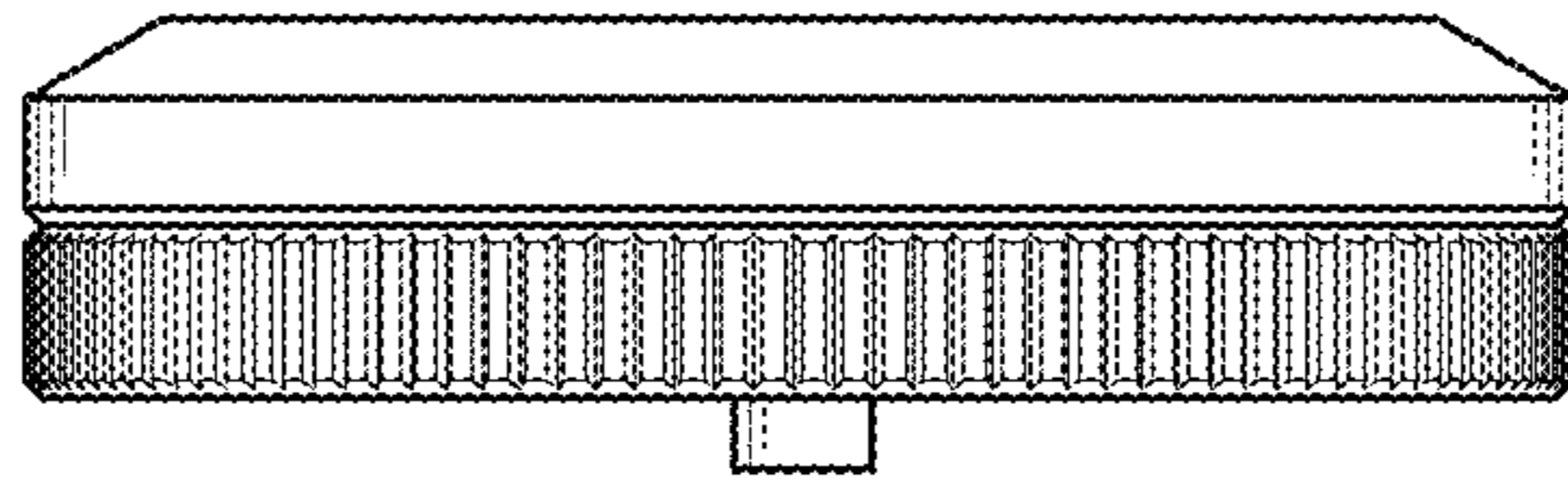

FIG. 6

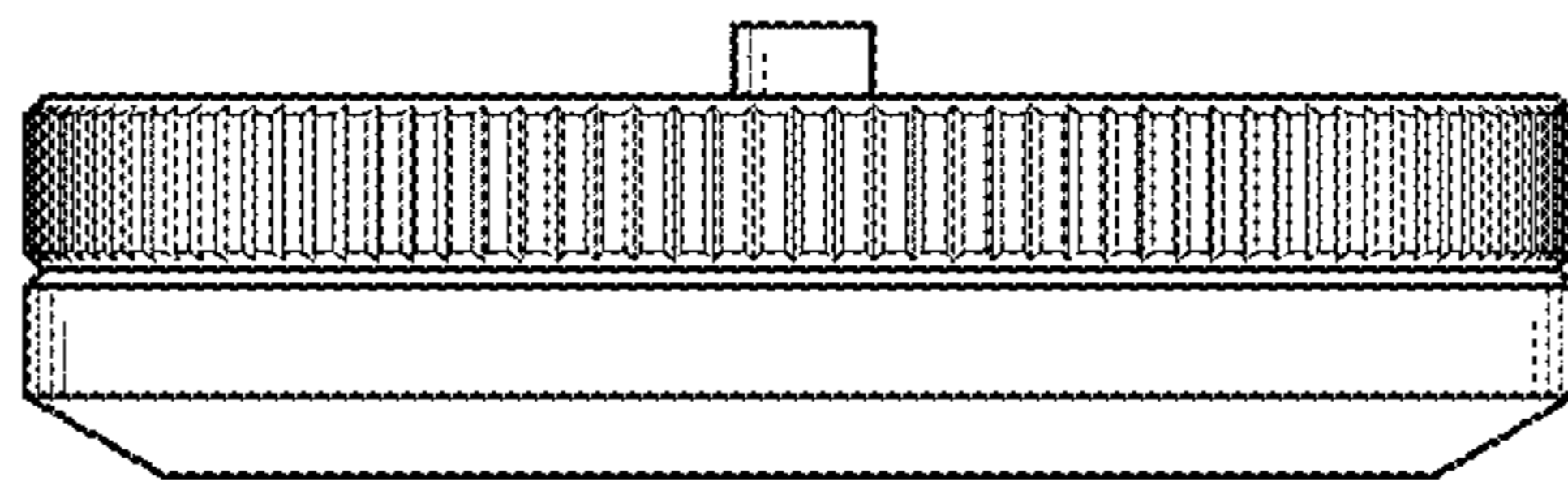

FIG. 7

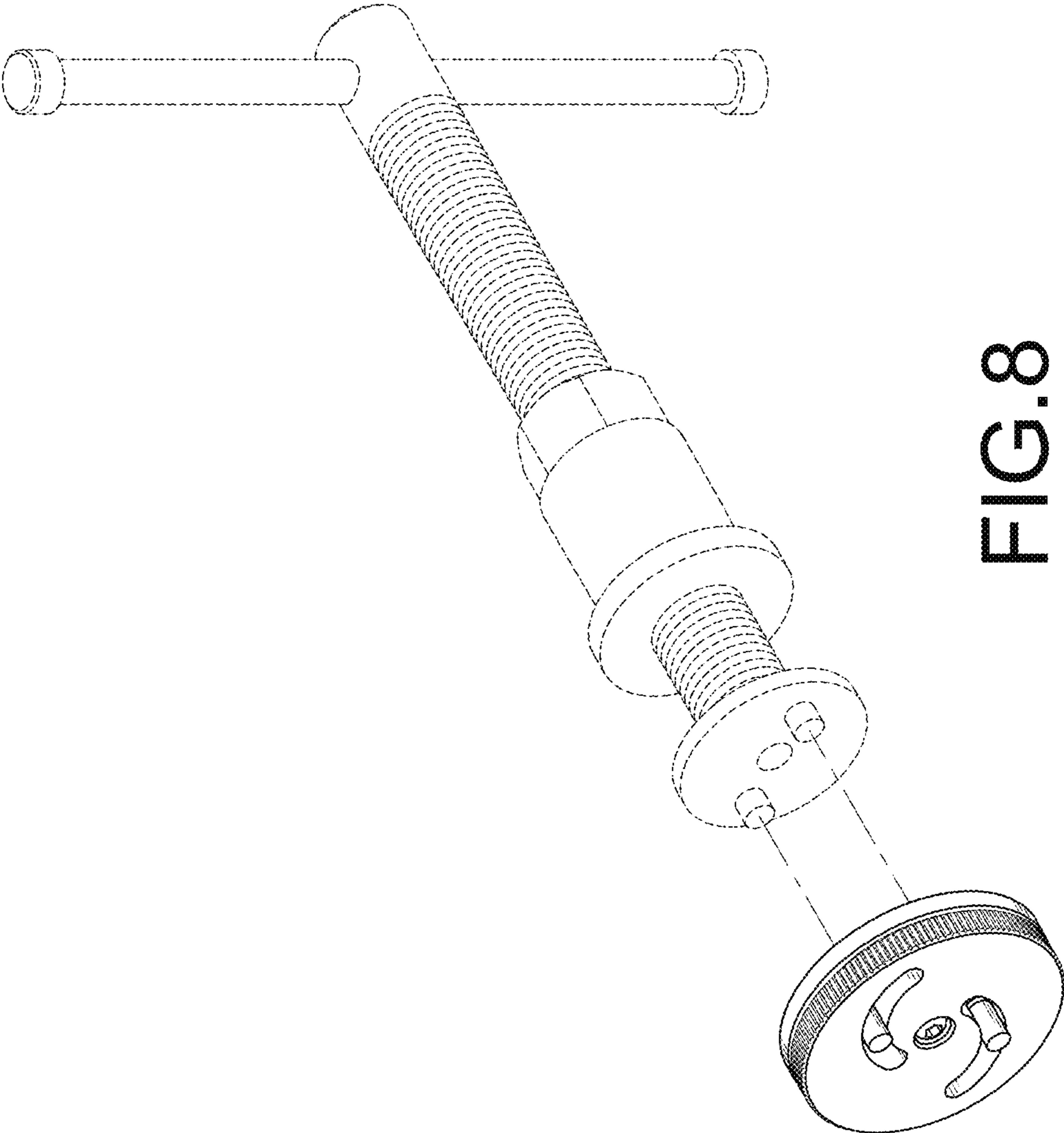

FIG. 8

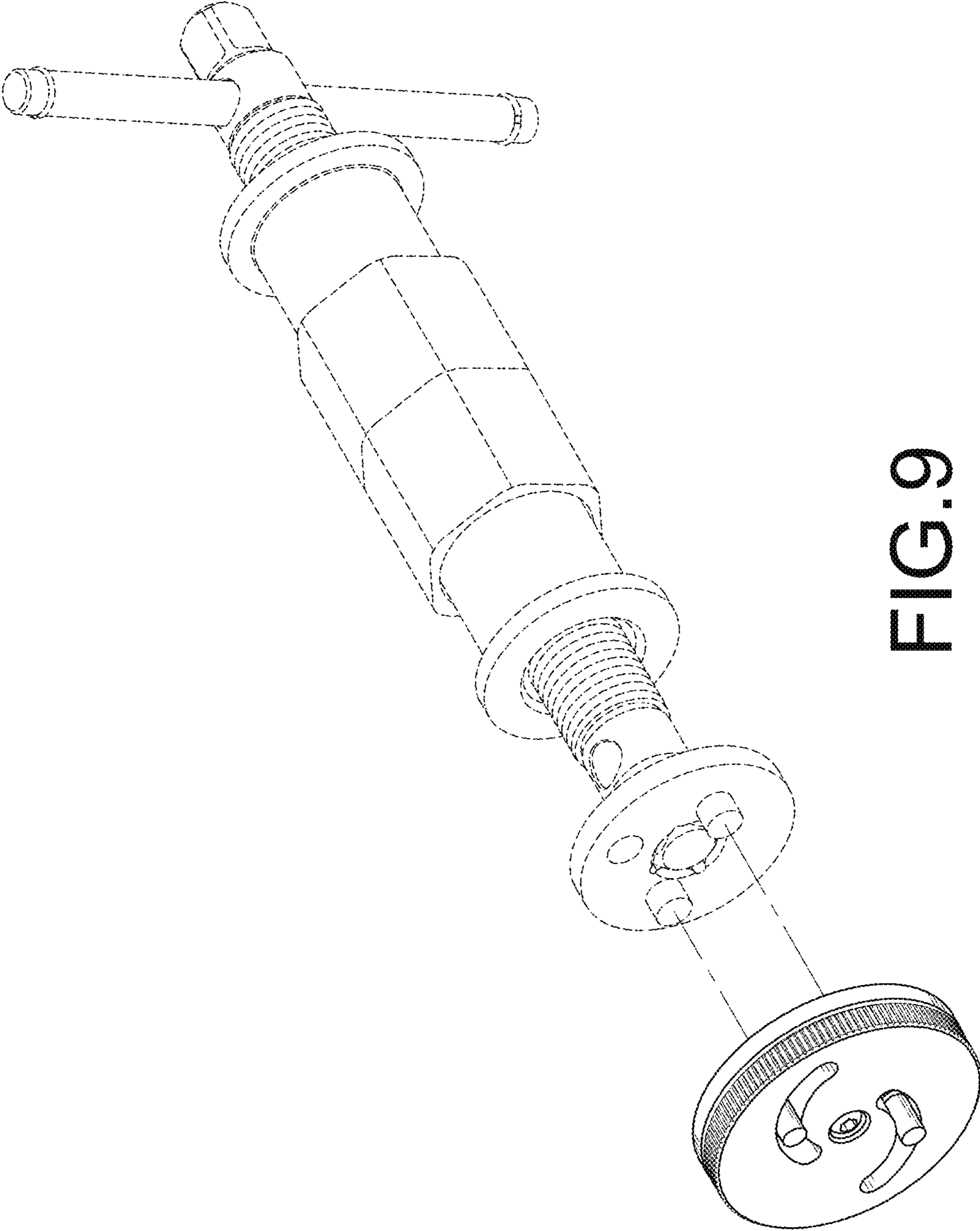

FIG. 9