

US00D768231S

(12) **United States Design Patent** (10) **Patent No.:** **US D768,231 S**
Kirsh (45) **Date of Patent:** **** Oct. 4, 2016**

(54) **MUSICAL TABLET**

(71) Applicant: **Moses Kirsh**, Flushing, NY (US)

(72) Inventor: **Moses Kirsh**, Flushing, NY (US)

(**) Term: **14 Years**

(21) Appl. No.: **29/512,562**

(22) Filed: **Dec. 19, 2014**

(51) **LOC (10) Cl.** **17-01**

(52) **U.S. Cl.**
USPC **D17/2**

(58) **Field of Classification Search**
USPC D14/217, 341, 345, 346; D17/1, 2, 4, 6,
D17/24, 99; D21/353, 405, 409
CPC A63H 5/00; G10C 1/00; G10C 1/02;
G10C 1/04; G10C 3/00; G10C 3/12; G10F
1/02; G10F 3/00; G10H 1/00
See application file for complete search history.

(56) **References Cited**

U.S. PATENT DOCUMENTS

D473,585 S *	4/2003	Carlson	D17/1
D490,808 S *	6/2004	Khachikian	D14/345
D569,415 S *	5/2008	Shigeru	D17/1
D599,841 S *	9/2009	Kawada	D17/2
D612,848 S *	3/2010	Morabito	D14/346
D617,791 S *	6/2010	Matsumoto	D14/341
D630,607 S *	1/2011	Li	D14/138 AB
D636,013 S *	4/2011	Shin	D17/1

D639,806 S *	6/2011	Lee	D14/345
D681,633 S *	5/2013	Reeves	D14/345
2003/0056634 A1 *	3/2003	Asahi	G10H 1/34 84/17
2005/0160903 A1 *	7/2005	Nagaoka	G10H 1/344 84/745
2011/0244438 A1 *	10/2011	Legrand	A63H 5/00 434/317

* cited by examiner

Primary Examiner — Manpreet Matharu
Assistant Examiner — Lisa A Grabenstetter
(74) *Attorney, Agent, or Firm* — Cowan, Liebowitz & Latman, P.C.; Mark Montague

(57) **CLAIM**
The ornamental design for a musical tablet, as shown and described.

DESCRIPTION

FIG. 1 is a front perspective view of the musical tablet showing my new design;
FIG. 2 is a front view thereof;
FIG. 3 is a right side view thereof;
FIG. 4 is a left side view thereof;
FIG. 5 is a rear view thereof;
FIG. 6 is a top plan view thereof; and,
FIG. 7 is a bottom plan view thereof.
The broken lines show unclaimed subject matter only and form no part of the claimed design.

1 Claim, 3 Drawing Sheets

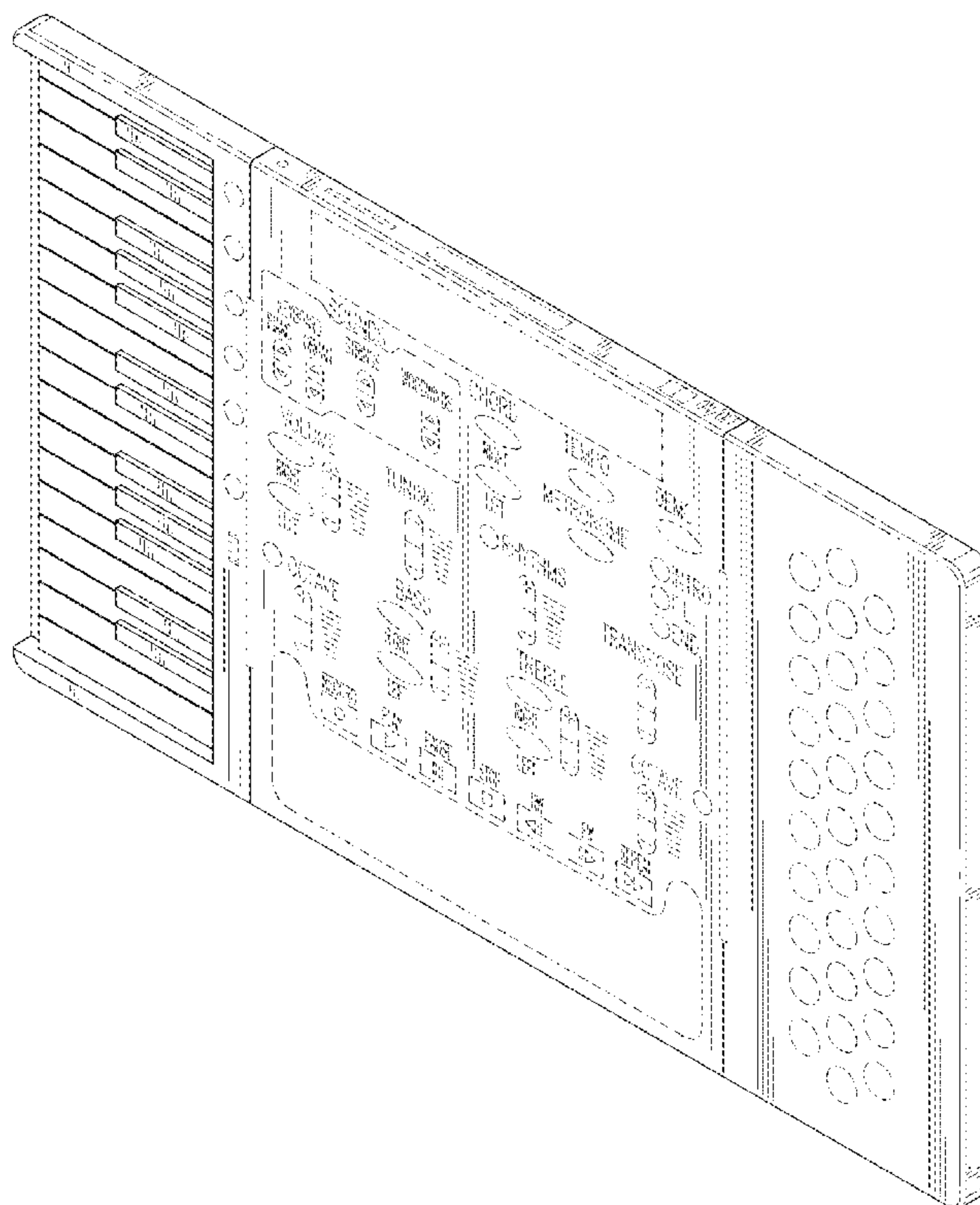

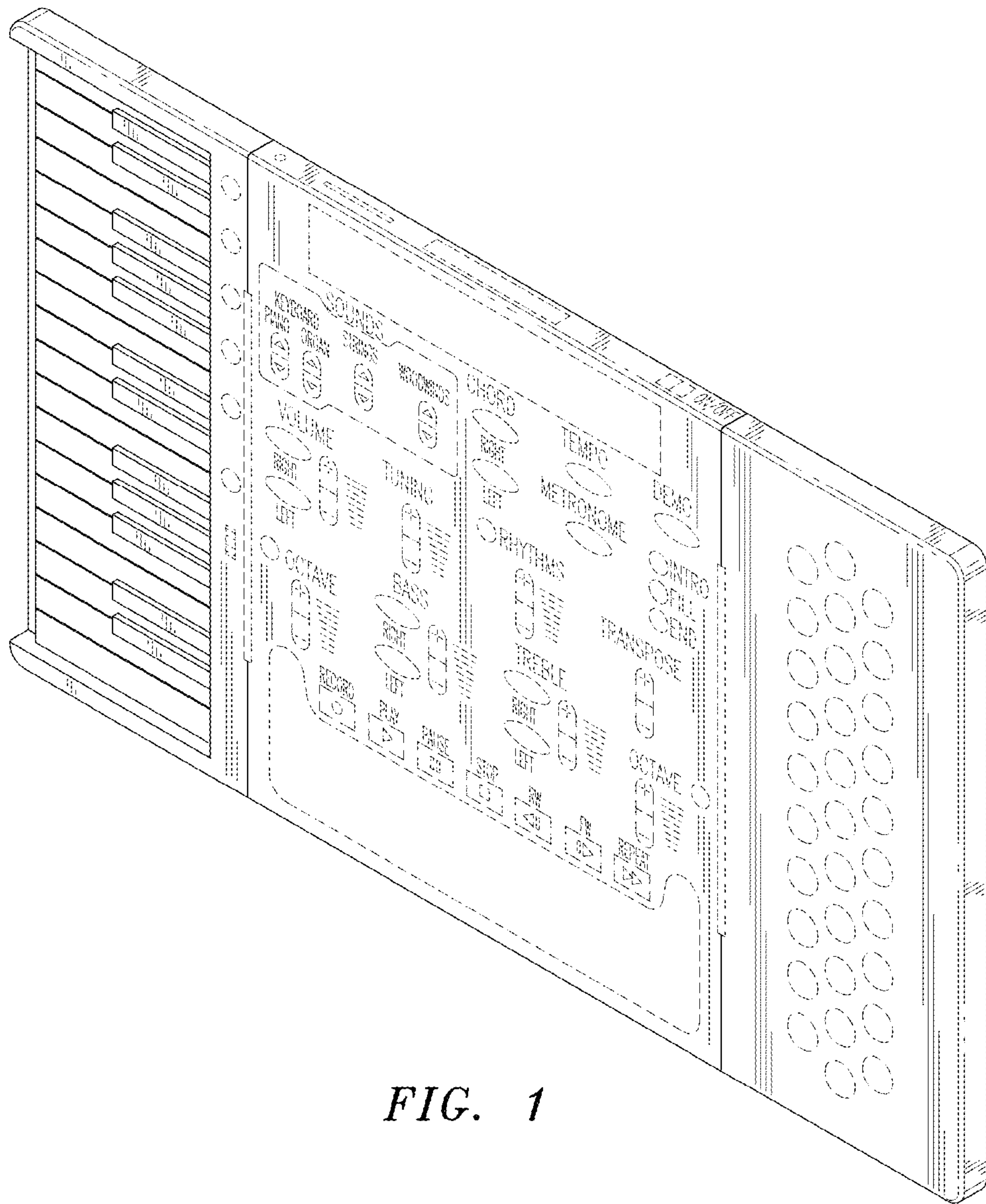

FIG. 1

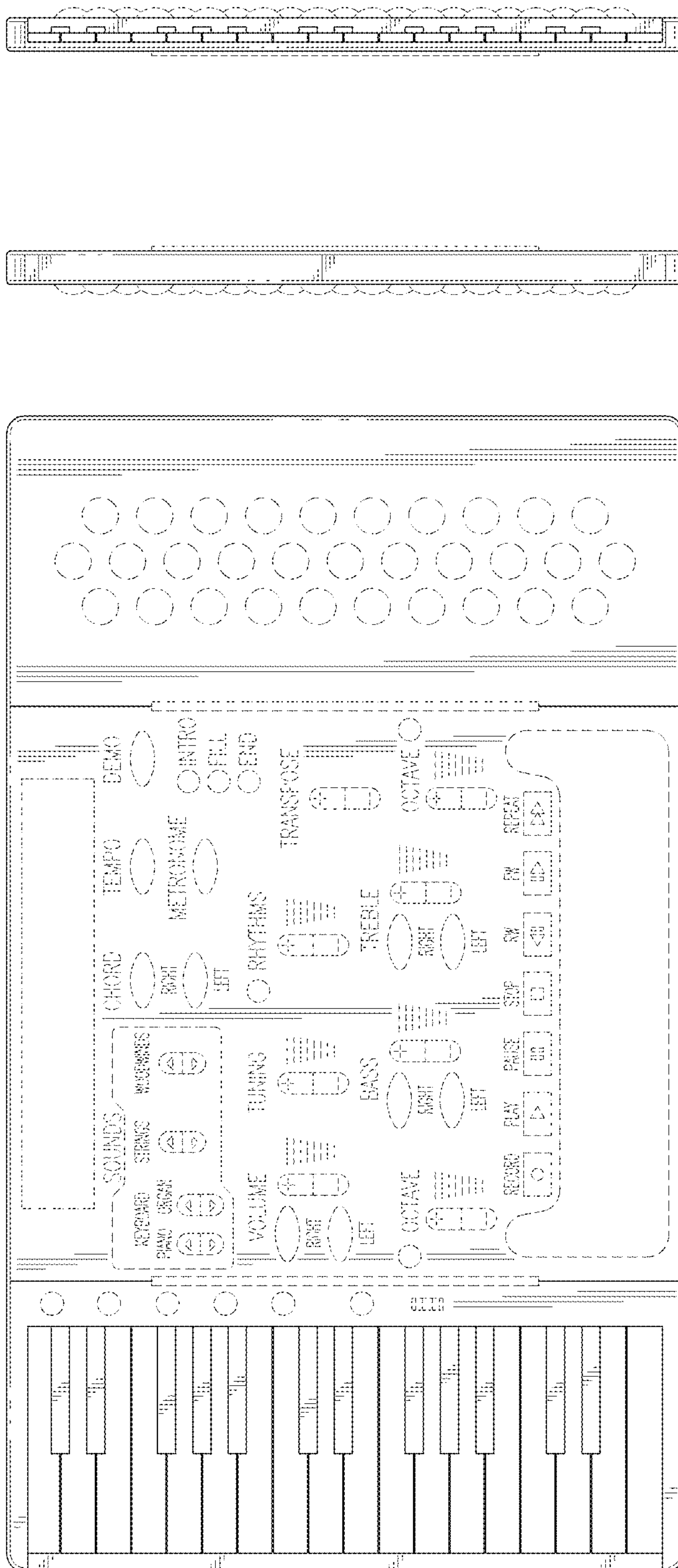

FIG. 2

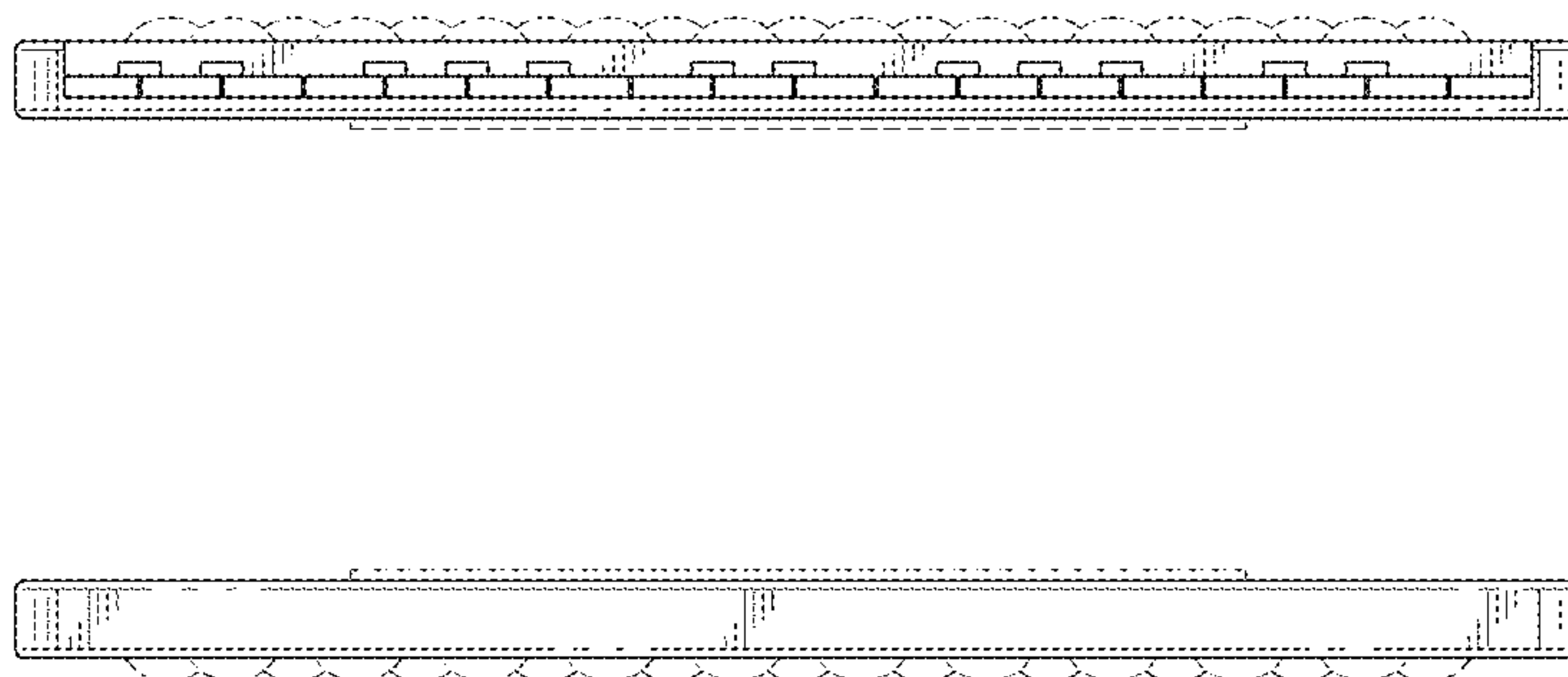

FIG. 3

FIG. 4

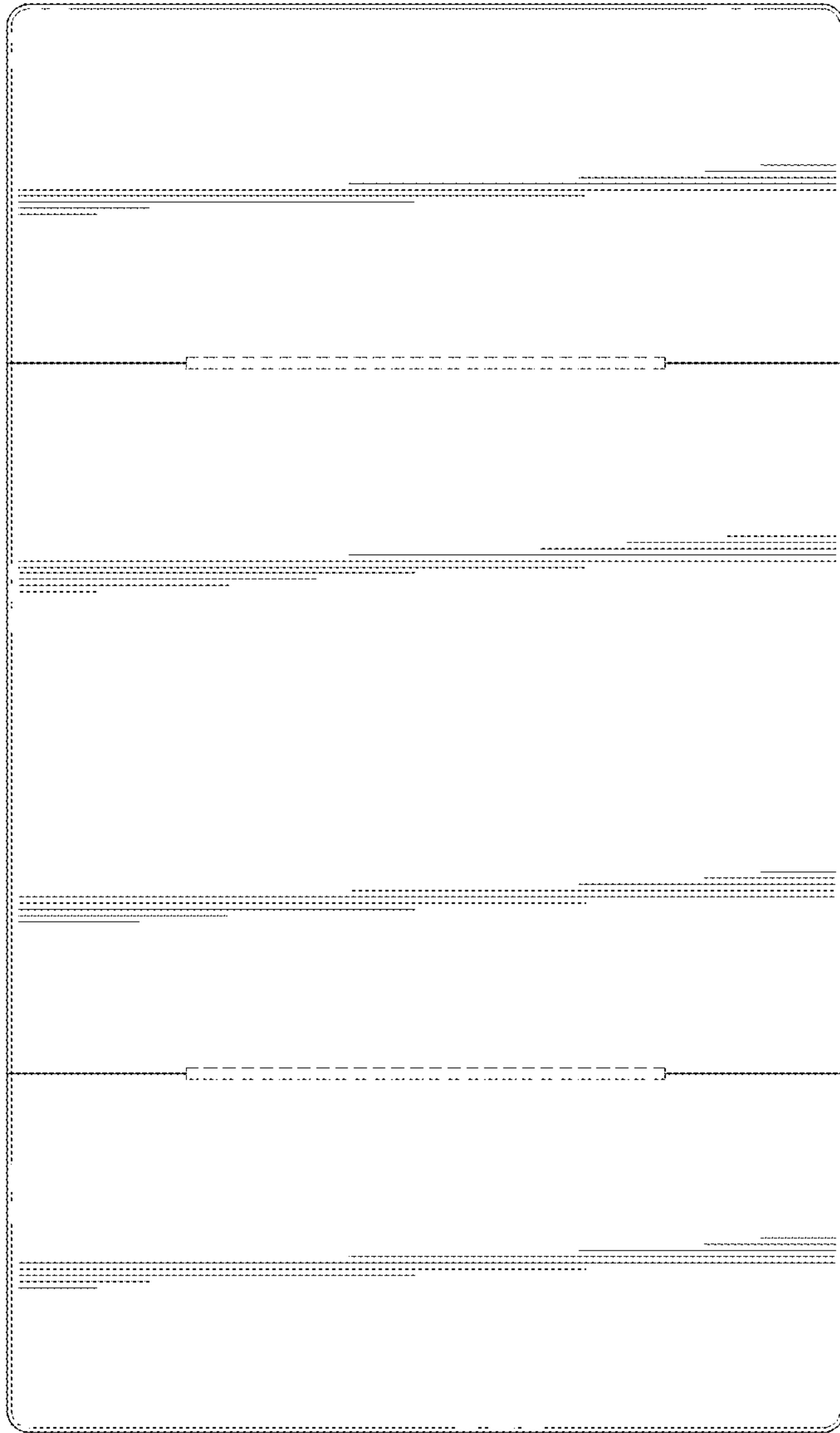

FIG. 5

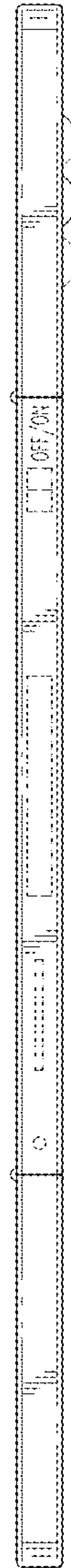

FIG. 6



FIG. 7