



US00D768168S

(12) **United States Design Patent**
Matoba et al.

(10) **Patent No.:** **US D768,168 S**

(45) **Date of Patent:** **** Oct. 4, 2016**

(54) **DISPLAY SCREEN OR PORTION THEREOF WITH A GRAPHICAL USER INTERFACE FOR AN INK JET PRINTER**

D420,995 S * 2/2000 Imamura D14/486

(Continued)

(71) Applicant: **Hitachi Industrial Equipment Systems Co., Ltd.**, Chiyoda-ku, Tokyo (JP)

OTHER PUBLICATIONS

(72) Inventors: **Kosuke Matoba**, Tokyo (JP); **Shinji Shibuya**, Tokyo (JP); **Tadahiro Yamaguchi**, Tokyo (JP); **Takashi Kawano**, Tokyo (JP); **Hiroko Kurihara**, Tokyo (JP)

Hitachi Coding & Marking Solutions, posting date not available, [retrieved Jun. 10, 2016]. Retrieved from Internet, <URL: https://www.codingsolutions.hitachi-industrial.eu/index/products/cijp/ux/ux-b160w.html >.*

(73) Assignee: **Hitachi Industrial Equipment Systems Co., Ltd.**, Tokyo (JP)

Primary Examiner — Barbara Fox
Assistant Examiner — Kristin E Reed

(**) Term: **14 Years**

(74) *Attorney, Agent, or Firm* — Crowell & Moring LLP

(21) Appl. No.: **29/524,952**

(22) Filed: **Apr. 24, 2015**

(30) **Foreign Application Priority Data**

Nov. 5, 2014 (JP) 2014-024639

(51) **LOC (10) Cl.** **14-04**

(52) **U.S. Cl.**
USPC **D14/486**

(58) **Field of Classification Search**

USPC D14/485-495
CPC . G01W 1/08; G01W 2001/006; G01W 1/06; G01W 1/12; G01W 1/14; G01W 1/16; G01W 2001/003; G01S 13/931; G01S 17/89; G06F 3/04817; G06F 3/04845; G06F 2200/1614; G06F 3/0482; G06F 3/04886; G06F 3/0489; G06F 15/0225; G06F 2203/04807; G06F 17/211; G06F 17/212; G06F 17/246; G05B 2219/23258; H04N 1/00891; H04N 21/472; H04N 21/478; H04N 1/00424; G06Q 30/02; G06Q 30/0222; G06Q 30/0639; G06Q 30/06; G09B 21/006; G09B 21/007; H04M 1/2477

See application file for complete search history.

(56) **References Cited**

U.S. PATENT DOCUMENTS

D401,231 S * 11/1998 Schechtman D14/486

(57) **CLAIM**

The ornamental design for a display screen or portion thereof with a graphical user interface for an ink jet printer, as shown and described.

DESCRIPTION

FIG. 1 is a front view of a display screen or portion thereof with a graphical user interface for an ink jet printer according to the design, showing the graphical user interface enlarged and separate for clarity of illustration; FIG. 2 is another front view of the display screen or portion thereof with a graphical user interface illustrating an example of as applied to an ink jet printer; FIG. 3 is a rear elevational view of the ink jet printer; FIG. 4 is a left side elevational view thereof; FIG. 5 is a right side elevational view thereof; FIG. 6 is a top plan view thereof; and, FIG. 7 is a bottom plan view thereof.

The broken lines within the graphical user interface illustrate portions of the graphical user interface. The broken line showing of the ink jet printer in FIGS. 2-7 illustrates environmental structure. The broken lines form no part of the claimed design.

1 Claim, 7 Drawing Sheets

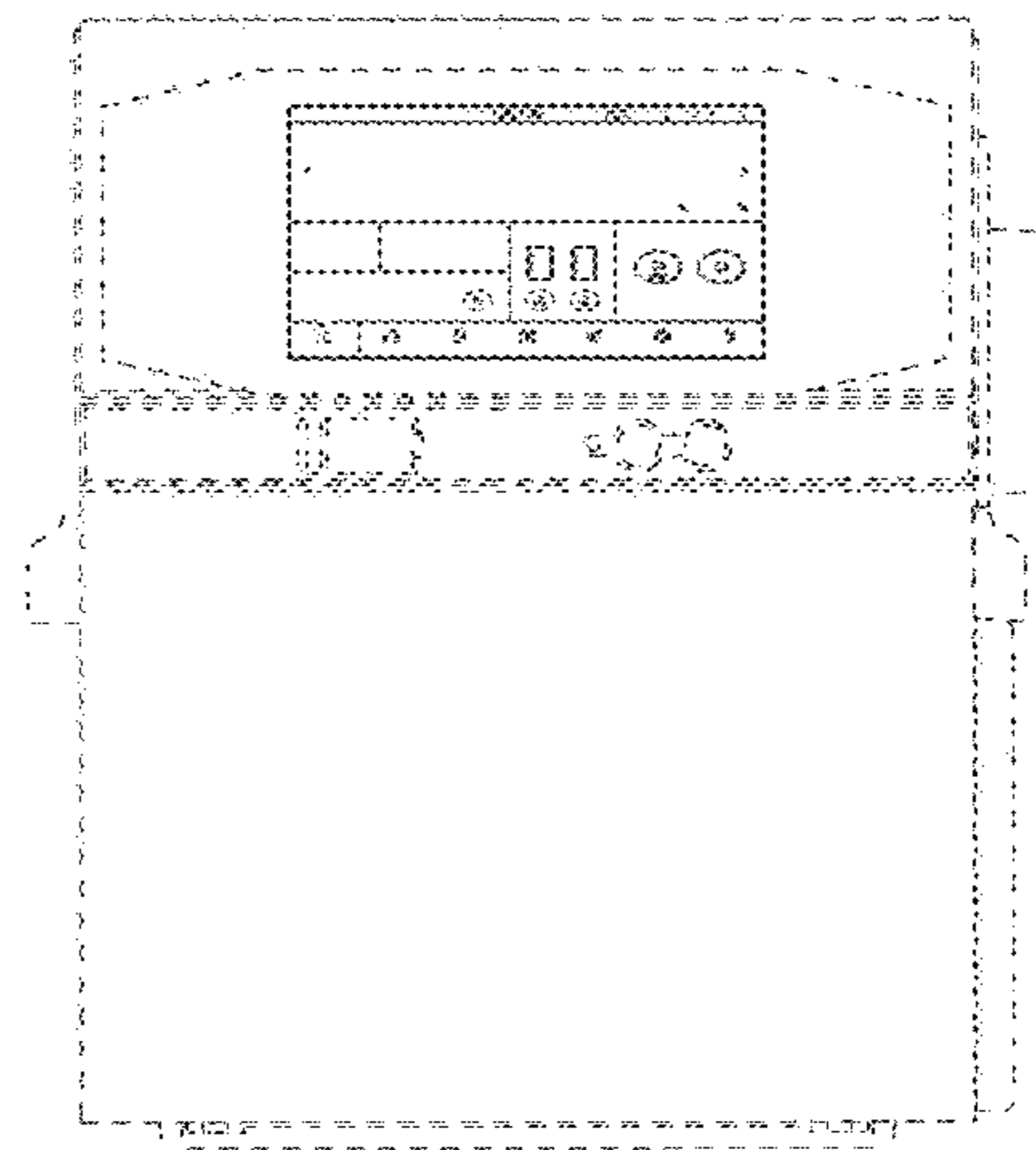
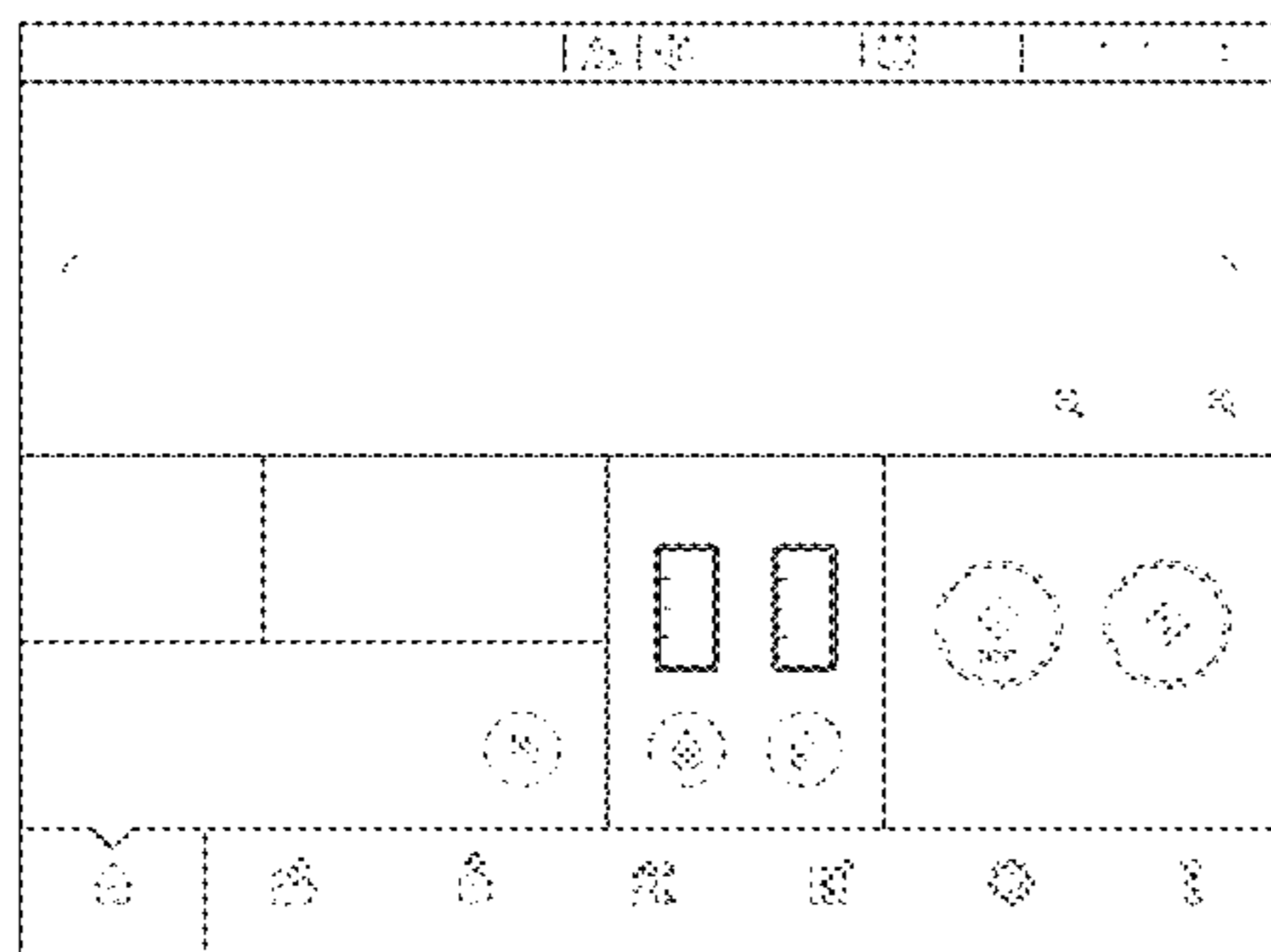

(56)

References Cited

U.S. PATENT DOCUMENTS

D450,323 S *	11/2001	Moore	D14/485	D735,737 S *	8/2015	Lee	D14/486
D474,778 S *	5/2003	Barnes	D14/486	D747,729 S *	1/2016	Smirin	D14/485
D545,829 S *	7/2007	Fletcher	D14/485	D755,242 S *	5/2016	Rajeswaran	D14/495
D595,309 S *	6/2009	Sasaki	D14/488	2001/0030661 A1 *	10/2001	Reichardt	H04N 5/44543
D614,634 S *	4/2010	Nilsen	D14/486					715/721
D667,833 S *	9/2012	DuPont	D14/486	2004/0068740 A1 *	4/2004	Fukuda	H04H 20/28
D691,616 S *	10/2013	Talbot	D14/485					725/45
D691,622 S *	10/2013	Shaffer	D14/486	2013/0198656 A1 *	8/2013	Jones	H04L 67/36
D707,237 S *	6/2014	Edwards	D14/486					715/758
D727,353 S *	4/2015	Yokota	D14/488	2014/0089979 A1 *	3/2014	Asam	H04N 21/42224
D729,264 S *	5/2015	Satalkar	D14/486					725/41
					2014/0195921 A1 *	7/2014	Grosz	G06F 3/1242
									715/738

* cited by examiner

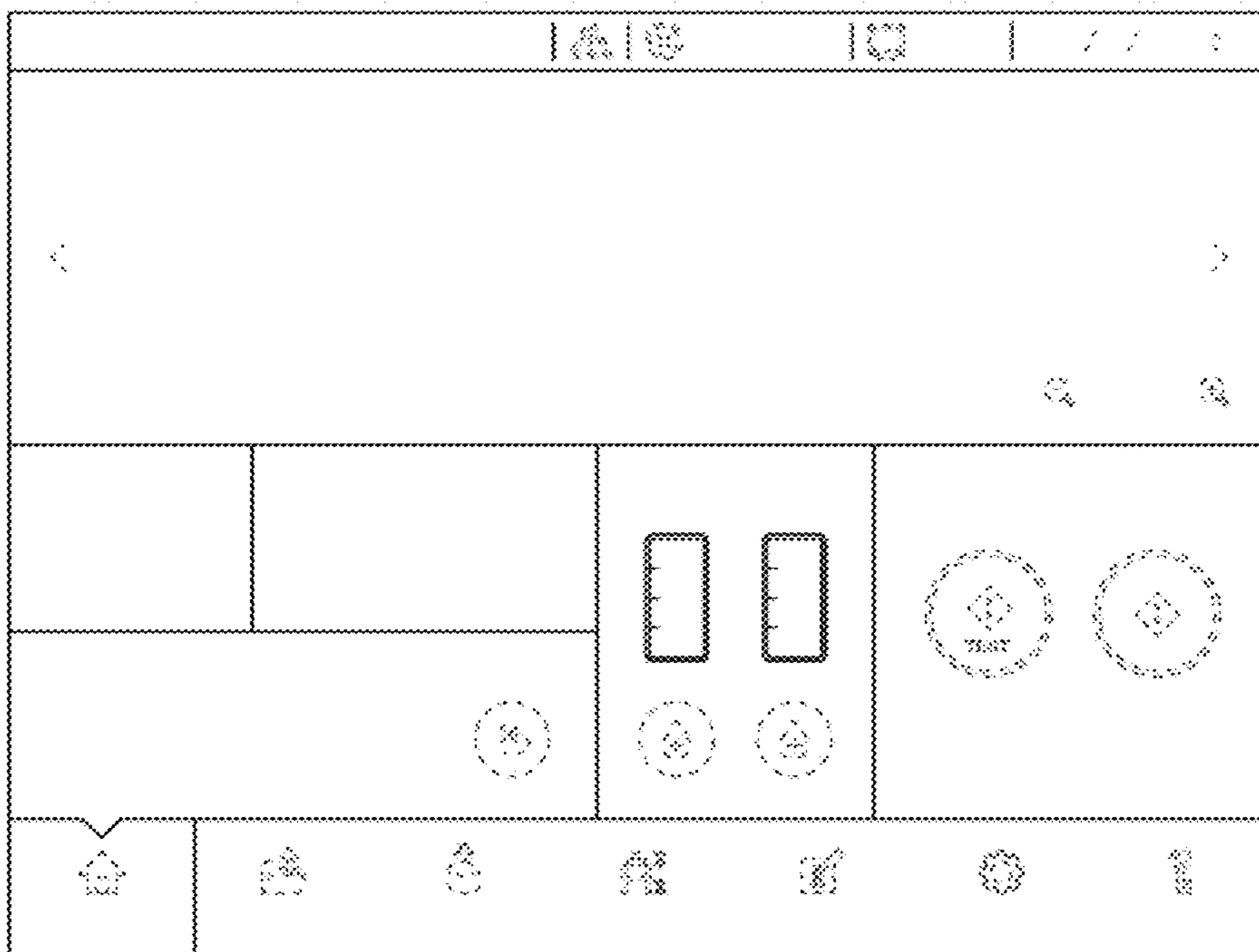

FIG. 1

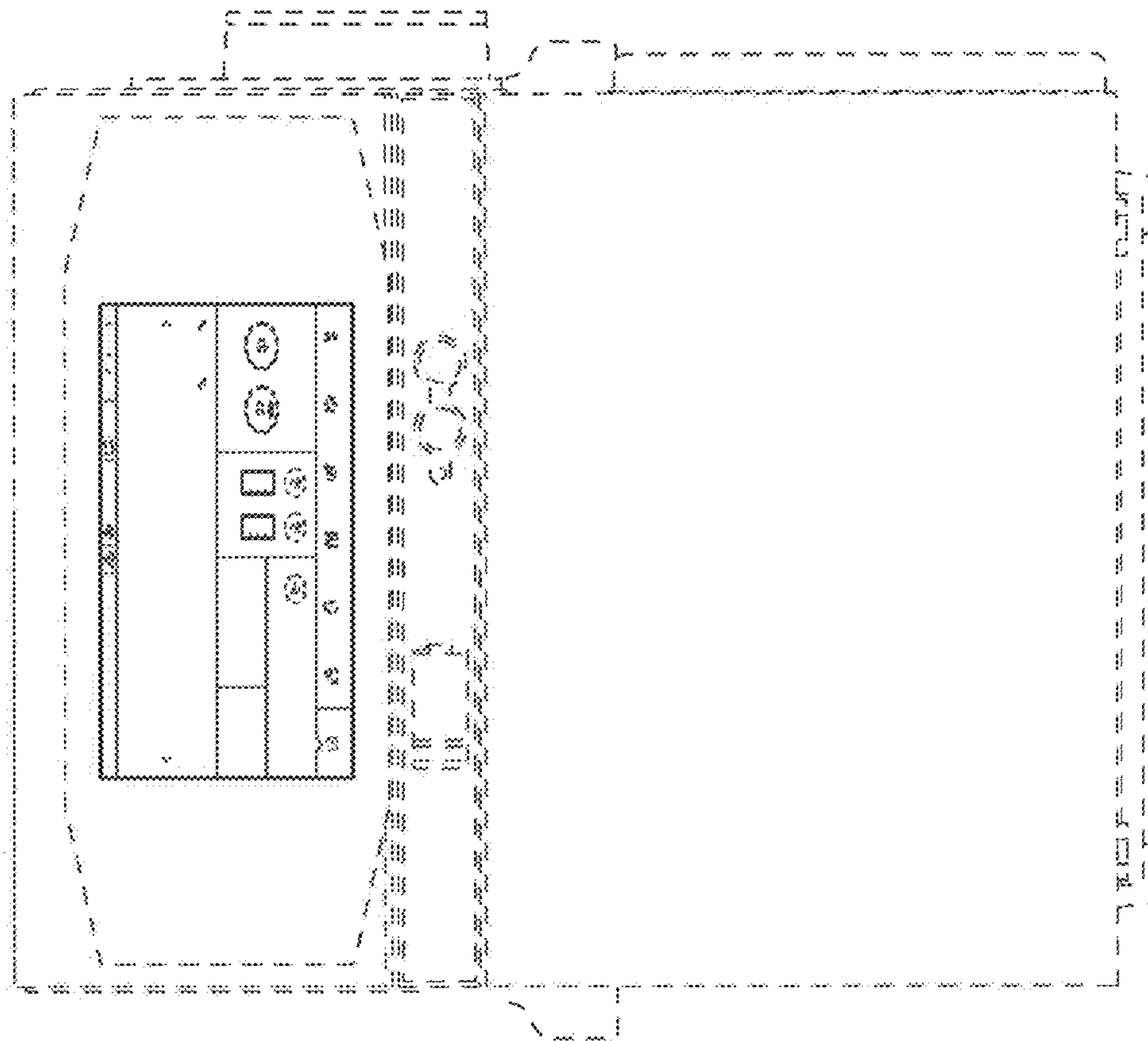

FIG. 2

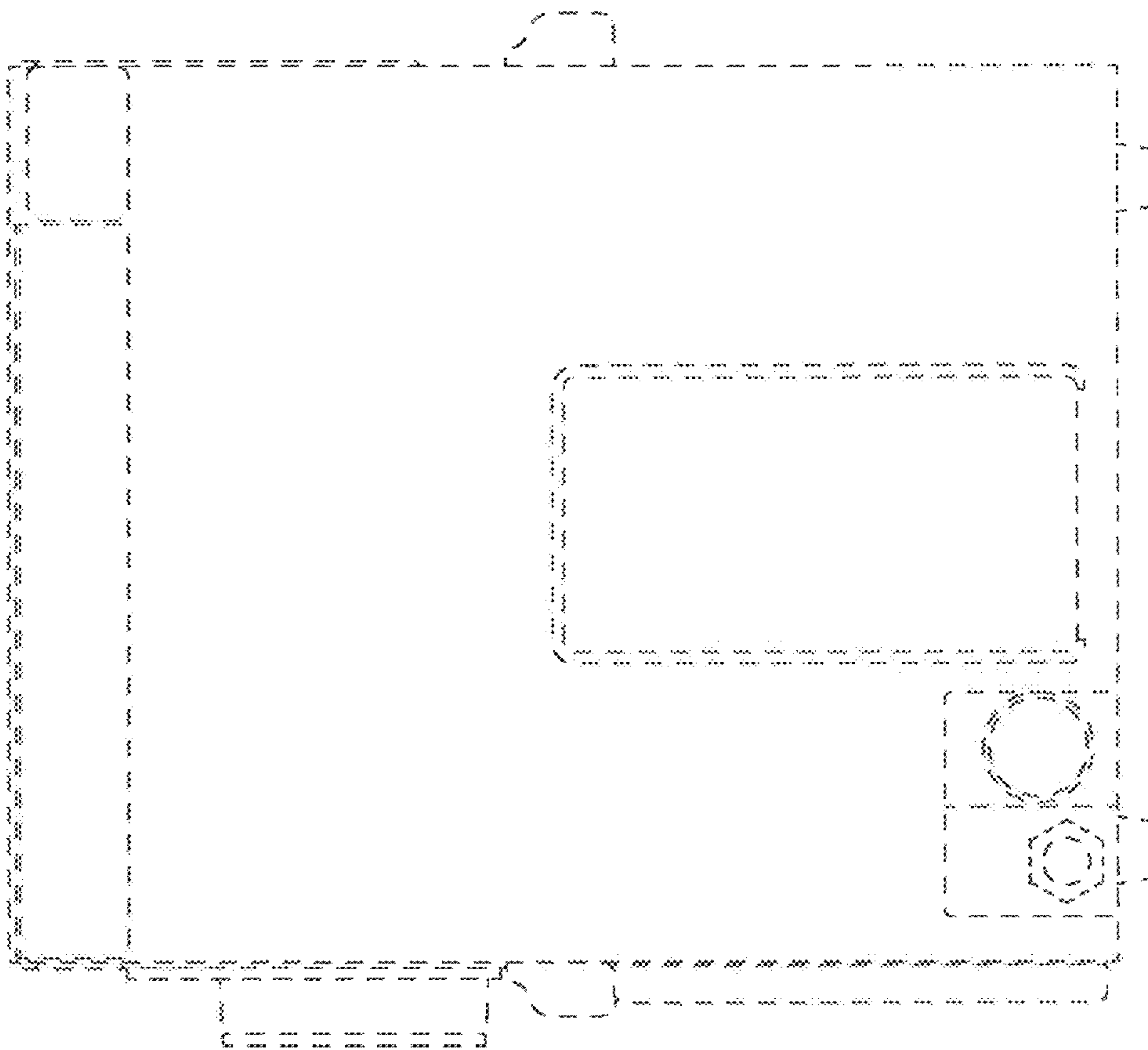

FIG. 3

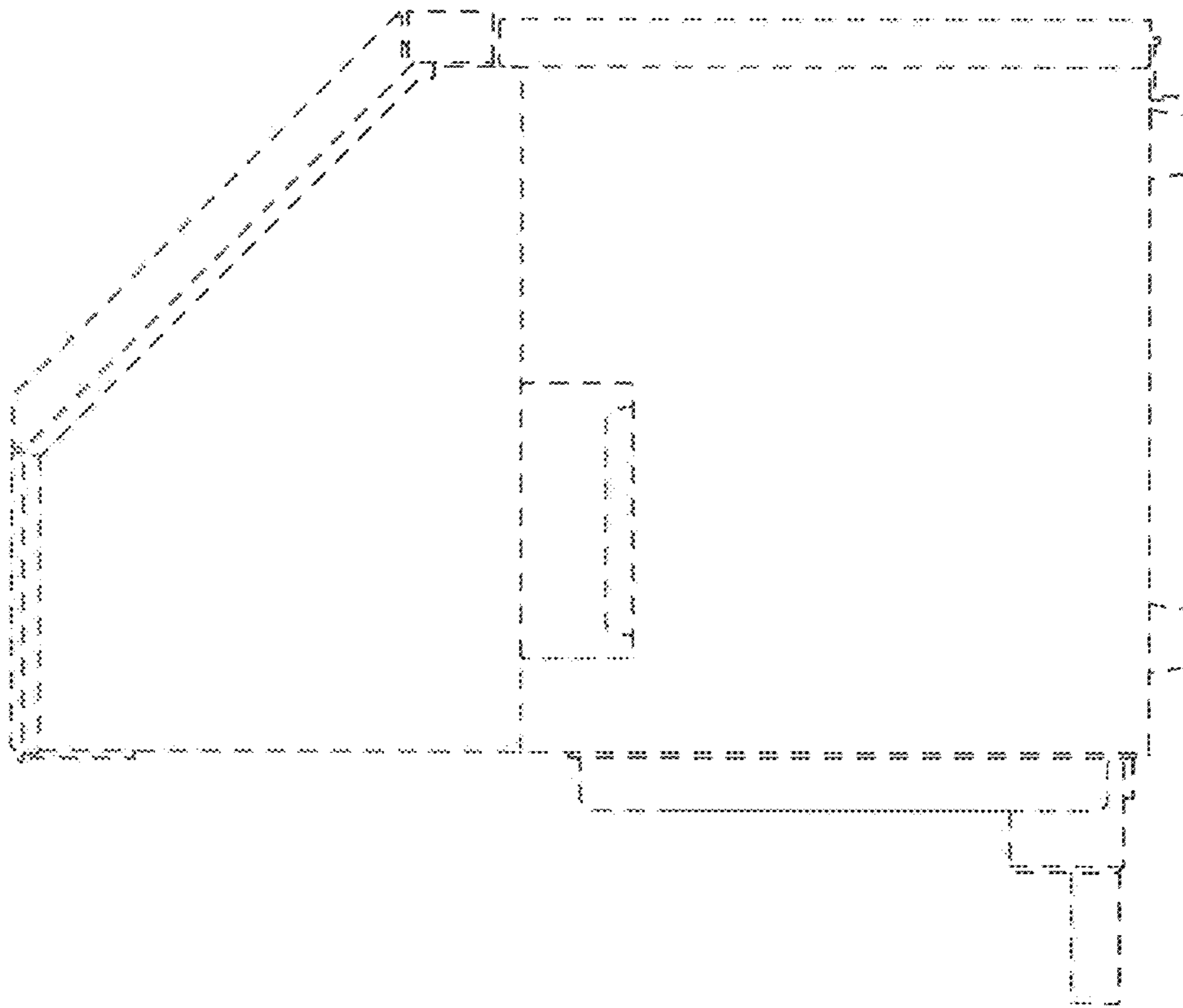

FIG. 4

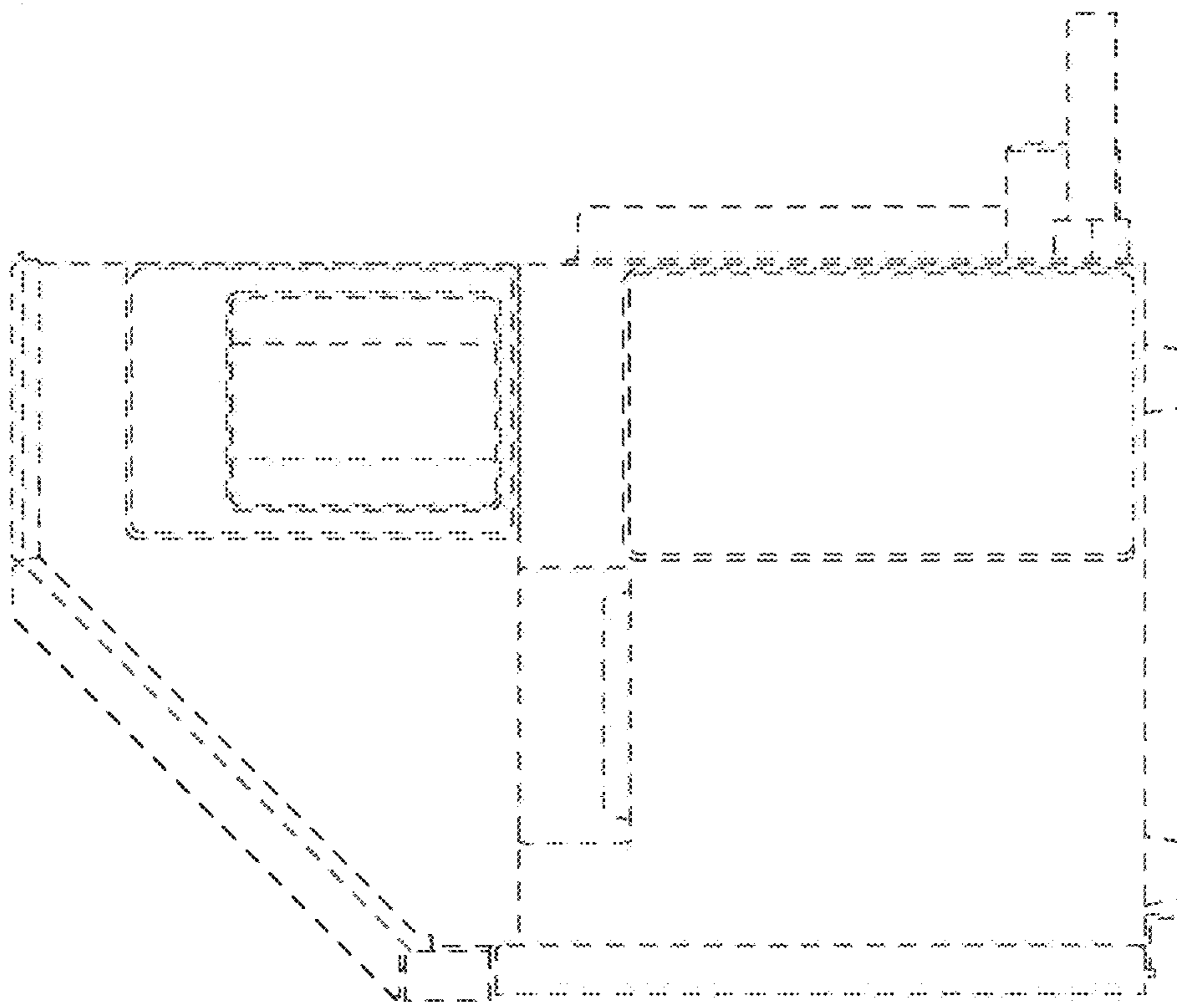

FIG. 5

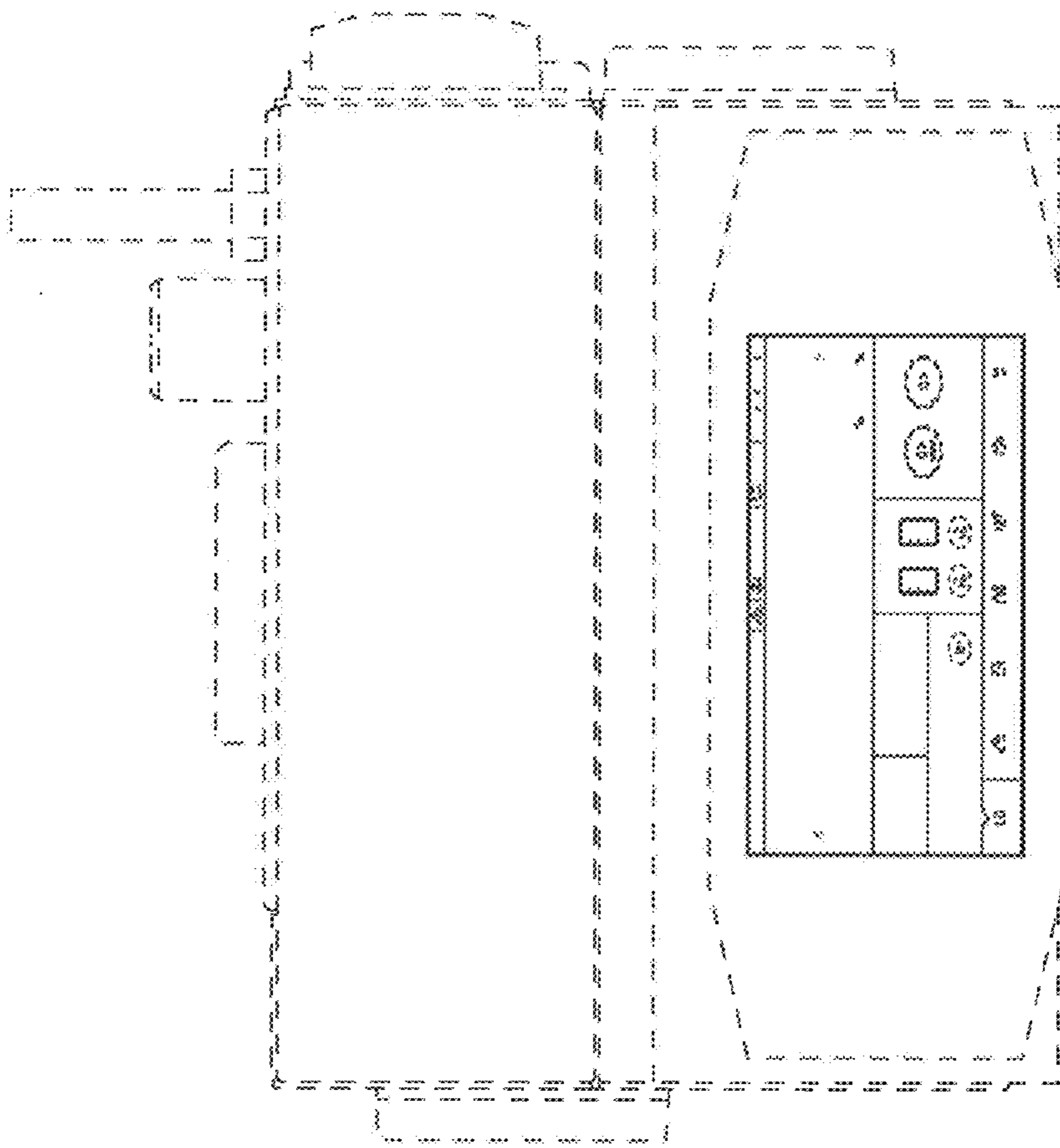

FIG. 6

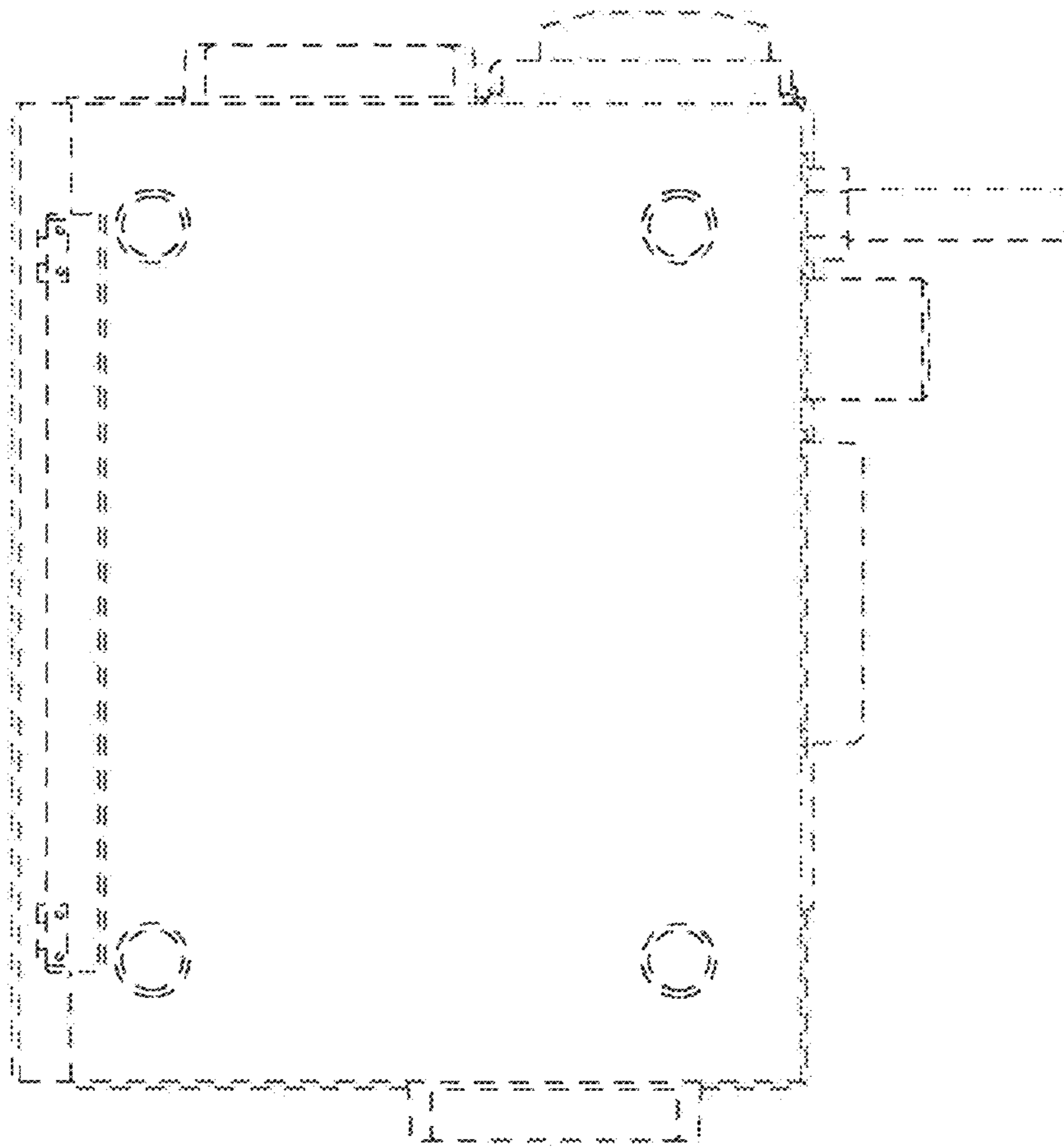

FIG. 7