

US00D767580S

(12) **United States Design Patent** (10) **Patent No.:** **US D767,580 S**
Billington (45) **Date of Patent:** **** Sep. 27, 2016**

(54) **USB MEMORY DEVICE**
(71) Applicant: **Charles Billington**, London (GB)
(72) Inventor: **Charles Billington**, London (GB)
(73) Assignee: **Groundhog S.A.**, Luxembourg (LU)
(**) Term: **15 Years**
(21) Appl. No.: **29/530,583**
(22) Filed: **Jun. 17, 2015**
(30) **Foreign Application Priority Data**

Mar. 16, 2015 (EM) 002655803-0001

(51) **LOC (10) Cl.** **14-03**
(52) **U.S. Cl.**
USPC **D14/480.5**
(58) **Field of Classification Search**
USPC D14/435.1, 480.1–480.7, 411, 433, 436,
D14/484.1, 137, 155, 203.1–203.8, 240,
D14/242; D13/133, 154
CPC H05K 5/0278; G06K 19/07732
See application file for complete search history.

(56) **References Cited**

U.S. PATENT DOCUMENTS

D542,787 S * 5/2007 Siu D14/480.5
D555,158 S * 11/2007 Lo D14/480.5
D556,752 S * 12/2007 Otsuka D14/480.5
D569,375 S * 5/2008 Yu D14/385

D583,816 S * 12/2008 Guccione D14/480.5
D610,156 S * 2/2010 Mudrick D14/480.5
D711,389 S * 8/2014 Sun D14/480.5
D741,865 S * 10/2015 Sundermeyer D14/433
D754,139 S * 4/2016 Billington D14/480.1
D759,021 S * 6/2016 Shim D14/435.1
D759,030 S * 6/2016 Kim D14/480.1

* cited by examiner

Primary Examiner — Angela J Lee

(74) *Attorney, Agent, or Firm* — Douglas L. Weller

(57) **CLAIM**

The ornamental design for a USB memory device, as shown and described.

DESCRIPTION

FIG. 1 is a top plan view of the USB memory device, the bottom being a mirror image of the top.
FIG. 2 is a rear elevational view of the USB memory device.
FIG. 3 is a front elevational view of the USB memory device.
FIG. 4 is a left side elevational view of the USB memory device, the right being a mirror image of the left.
FIG. 5 is a top front left perspective view of the USB memory device.
FIG. 6 is a top rear left perspective view of the USB memory device; and,
FIG. 7 is a top front left perspective view of the USB memory device with a protective cap removed from a USB connector to expose the USB connector.

1 Claim, 1 Drawing Sheet

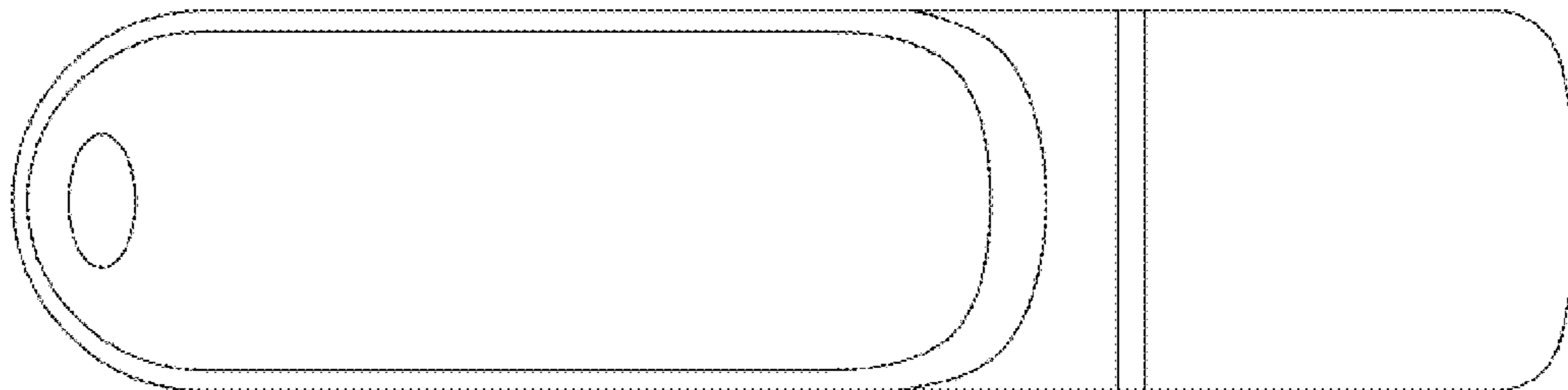

FIG.1

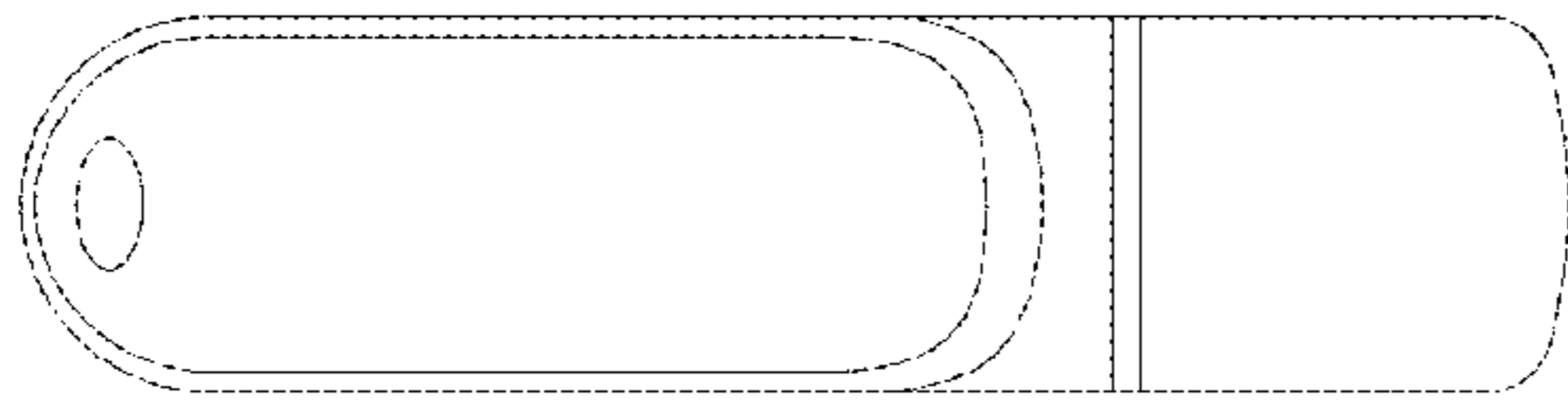

FIG.2

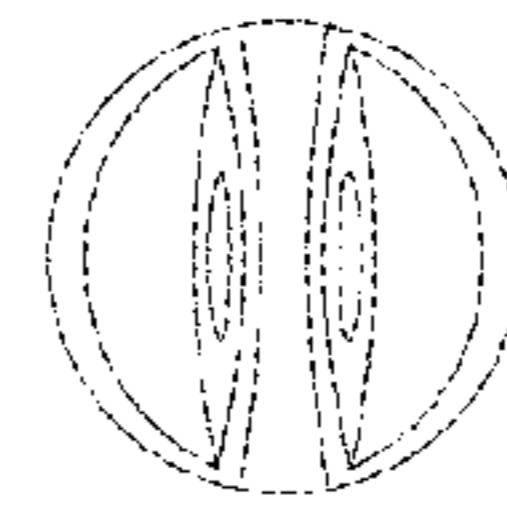

FIG.3

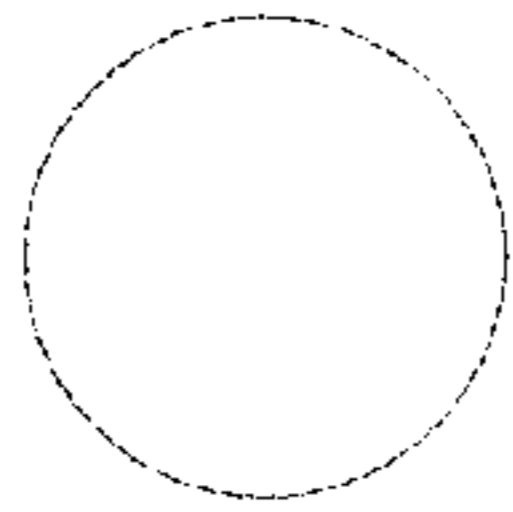

FIG.4

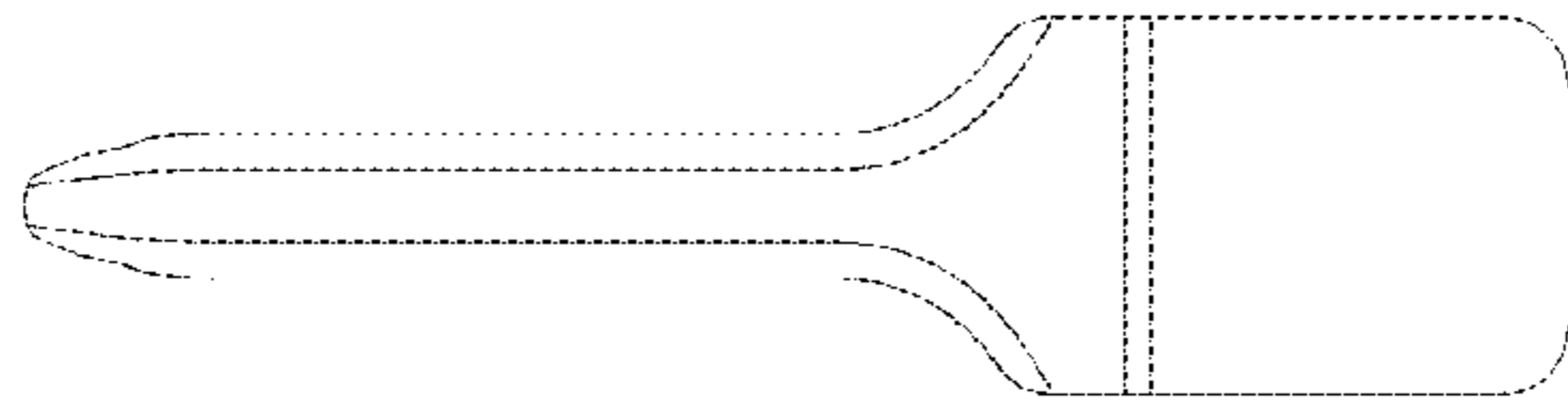

FIG.5

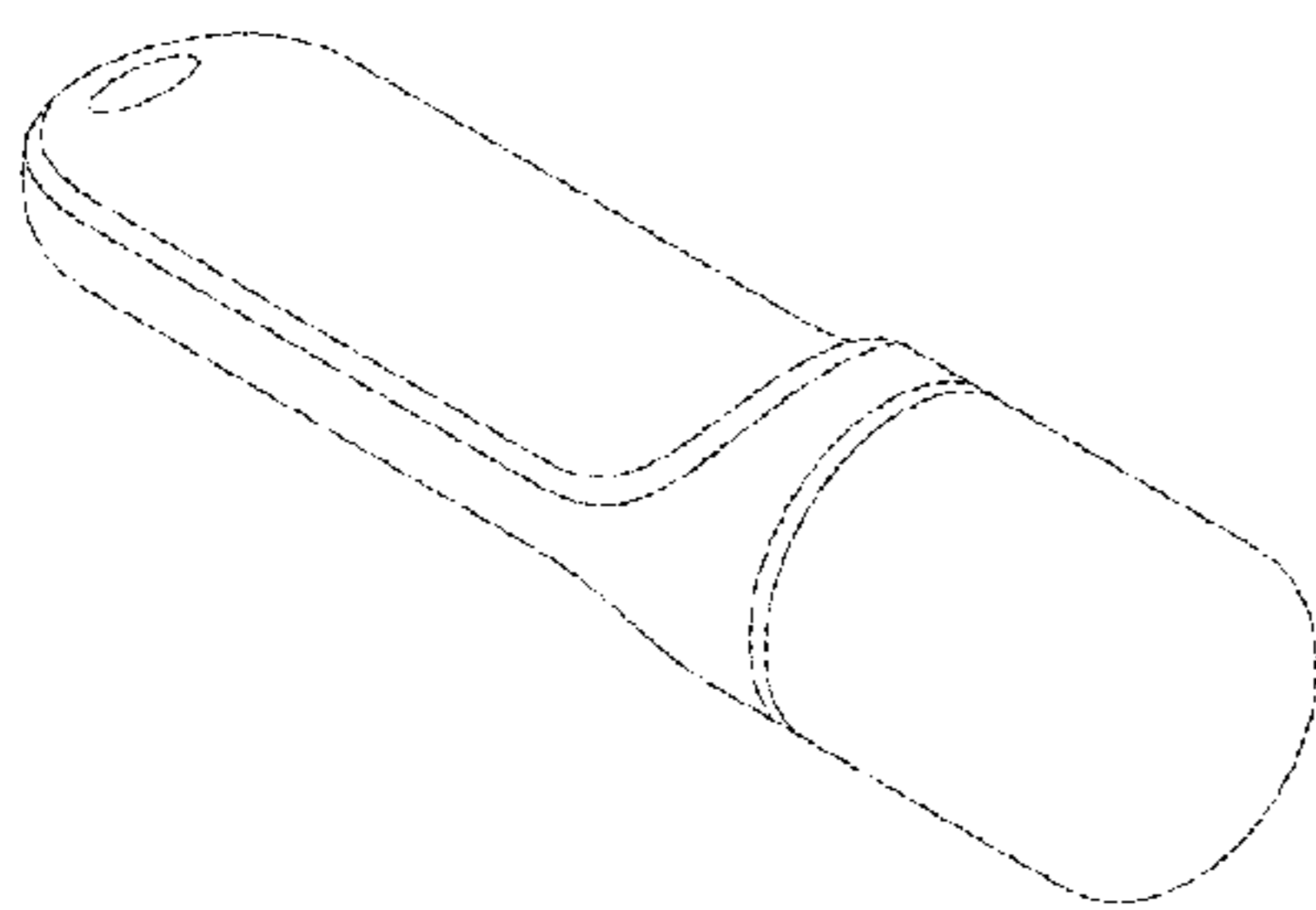

FIG.6

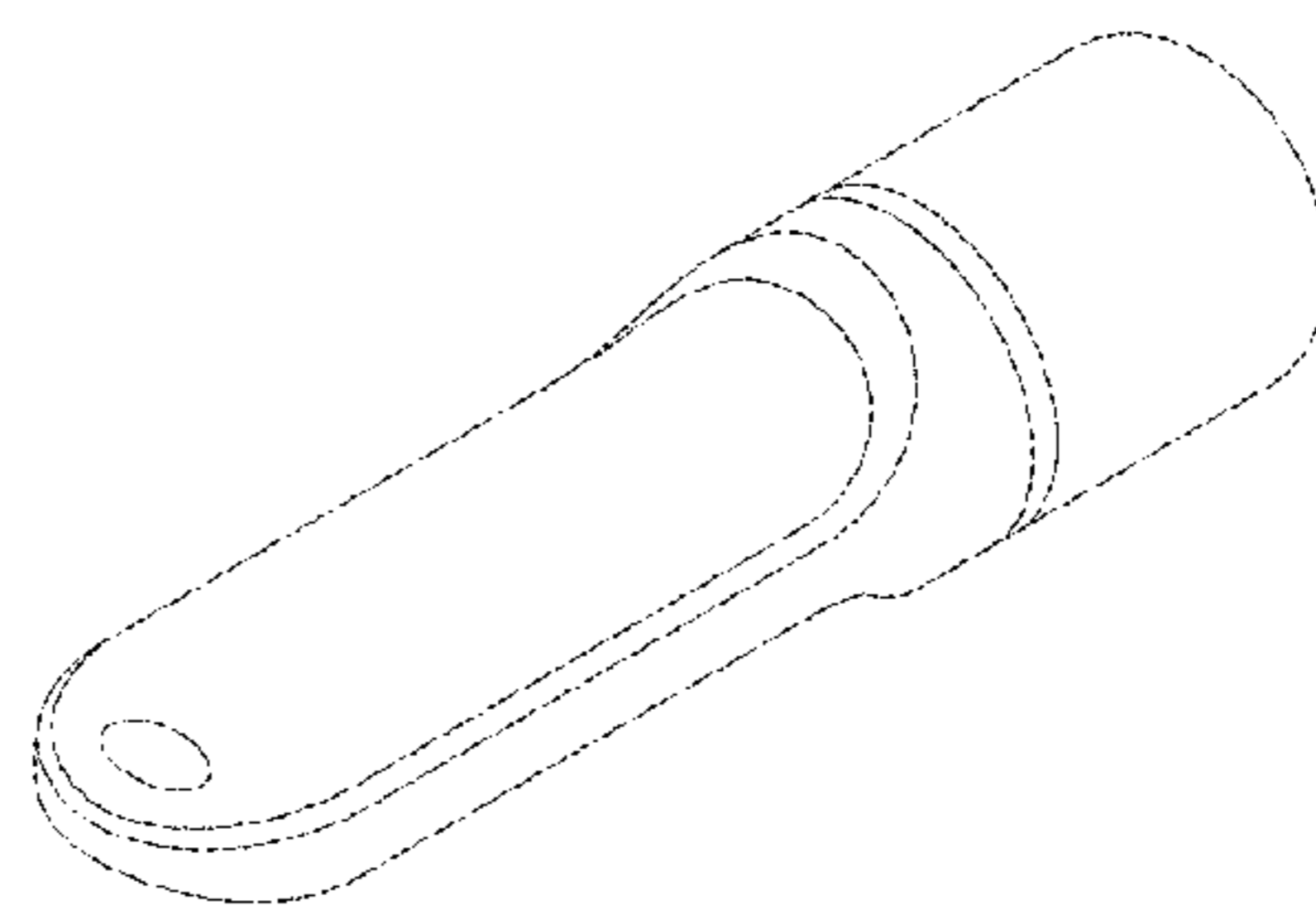

FIG.7

