



US00D766713S

(12) **United States Design Patent**
Kiss

(10) **Patent No.:** **US D766,713 S**

(45) **Date of Patent:** **** Sep. 20, 2016**

(54) **FOLDING CONTAINER**

(71) Applicant: **Tile, Inc.**, San Mateo, CA (US)

(72) Inventor: **Sándor Kiss**, Petaluma, CA (US)

(73) Assignee: **Tile, Inc.**, San Mateo, CA (US)

(**) Term: **15 Years**

(21) Appl. No.: **29/551,345**

(22) Filed: **Jan. 13, 2016**

Related U.S. Application Data

(62) Division of application No. 29/486,823, filed on Apr. 2, 2014, now Pat. No. Des. 750,478.

(51) **LOC (10) Cl.** **09-03**

(52) **U.S. Cl.**
USPC **D9/421**

(58) **Field of Classification Search**

USPC D9/414, 420-423, 432, 456; 229/103.2;
220/4.26; 206/321, 322, 449, 450, 472,
206/473; D6/634; D28/78, 83;
D3/272-274, 288; 40/126.06
CPC B65D 85/48; B65D 5/0245; B65D 77/0433;
B65D 85/46; G06F 5/04

See application file for complete search history.

(56) **References Cited**

U.S. PATENT DOCUMENTS

D190,253 S * 5/1961 Chlop D3/10
3,666,166 A * 5/1972 Freakes B65D 75/38
206/424
4,433,780 A * 2/1984 Ellis B42D 15/022
206/232
D372,670 S * 8/1996 Healey D9/422
5,807,110 A * 9/1998 Hytry G09F 5/04
434/72
6,186,327 B1 * 2/2001 Hadden G09F 5/04
190/16
6,253,922 B1 * 7/2001 Hadden G09F 5/04
206/472
D447,687 S * 9/2001 Roby D9/422

D455,958 S * 4/2002 Burrus D9/433
D476,116 S * 6/2003 Cohen D28/83
6,814,278 B2 * 11/2004 Gerrie B42D 15/08
229/305
D503,087 S * 3/2005 Dzwil D3/264
D517,911 S * 3/2006 Alexander D9/433
D519,367 S * 4/2006 Alexander D9/433
D536,246 S * 2/2007 Schneider D9/432
D553,494 S * 10/2007 Dehlin D9/432
7,686,165 B2 * 3/2010 Aldridge B65D 5/009
206/37
D622,503 S * 8/2010 Palmer D3/274

(Continued)

Primary Examiner — Ian Simmons

Assistant Examiner — Keith Frank

(74) *Attorney, Agent, or Firm* — Fenwick & West LLP

(57) **CLAIM**

I claim the ornamental design for a folding container, as shown and described.

DESCRIPTION

FIG. 1 is a perspective view of a folding container in a folded configuration showing my new design.

FIG. 2 is a top plan view thereof.

FIG. 3 is a front elevational view thereof, the rear being a mirror image.

FIG. 4 is a left side elevational view thereof.

FIG. 5 is a right side elevational view thereof.

FIG. 6 is a bottom plan view thereof.

FIG. 7 is a perspective view thereof in an open configuration.

FIG. 8 is a top plan view thereof.

FIG. 9 is a front elevational view thereof, the rear being a mirror image.

FIG. 10 is a left side elevational view thereof, the right side being a mirror image; and,

FIG. 11 is a bottom plan view thereof.

The stipple shading and the straight line shading in the drawings illustrate a contrasting appearance. The broken lines in the drawings illustrate the portions of the folding container that form no part of the claimed design.

1 Claim, 6 Drawing Sheets

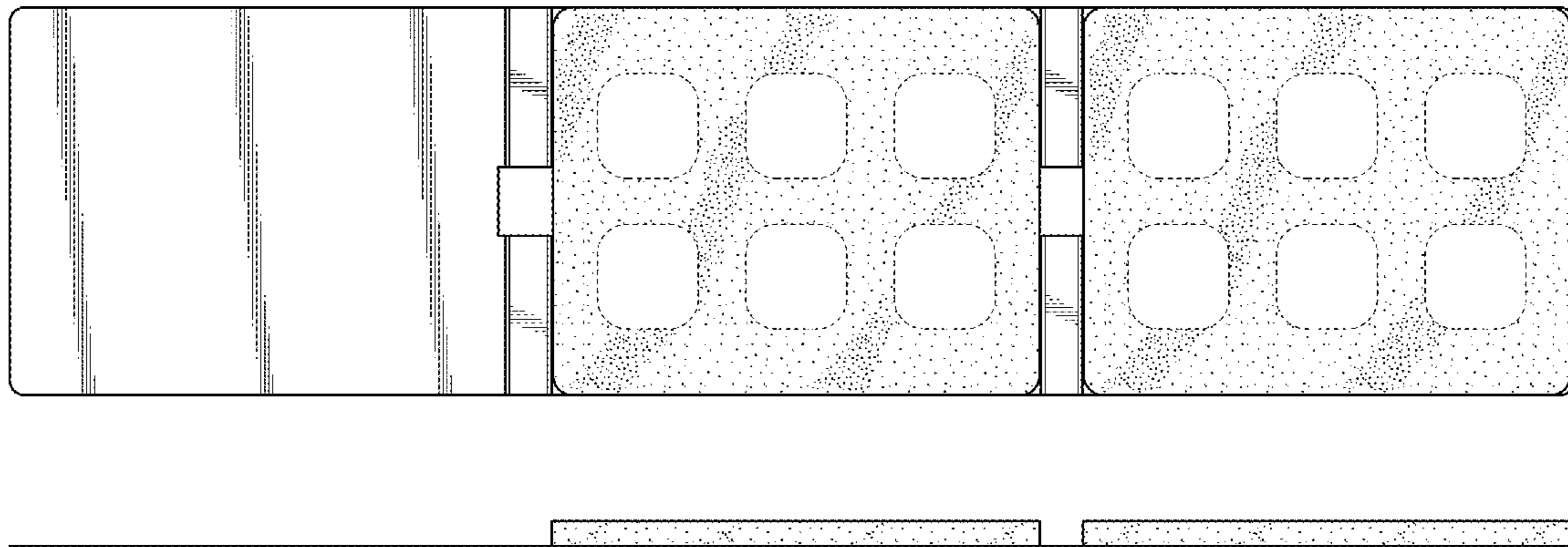

(56)

References Cited

U.S. PATENT DOCUMENTS

D639,014 S *	5/2011	Eustis	D34/39	D682,279 S *	5/2013	Fuchs	D14/440
D657,560 S *	4/2012	Schulz	D19/88	D715,634 S *	10/2014	Stevens	D9/414
D659,019 S *	5/2012	Specker	D9/421	8,915,358 B2 *	12/2014	Johnson	A47K 10/421 206/210
D674,709 S *	1/2013	Akana	D9/432	D741,200 S *	10/2015	Lee	D9/748
				D758,191 S *	6/2016	Tu	D9/414

* cited by examiner

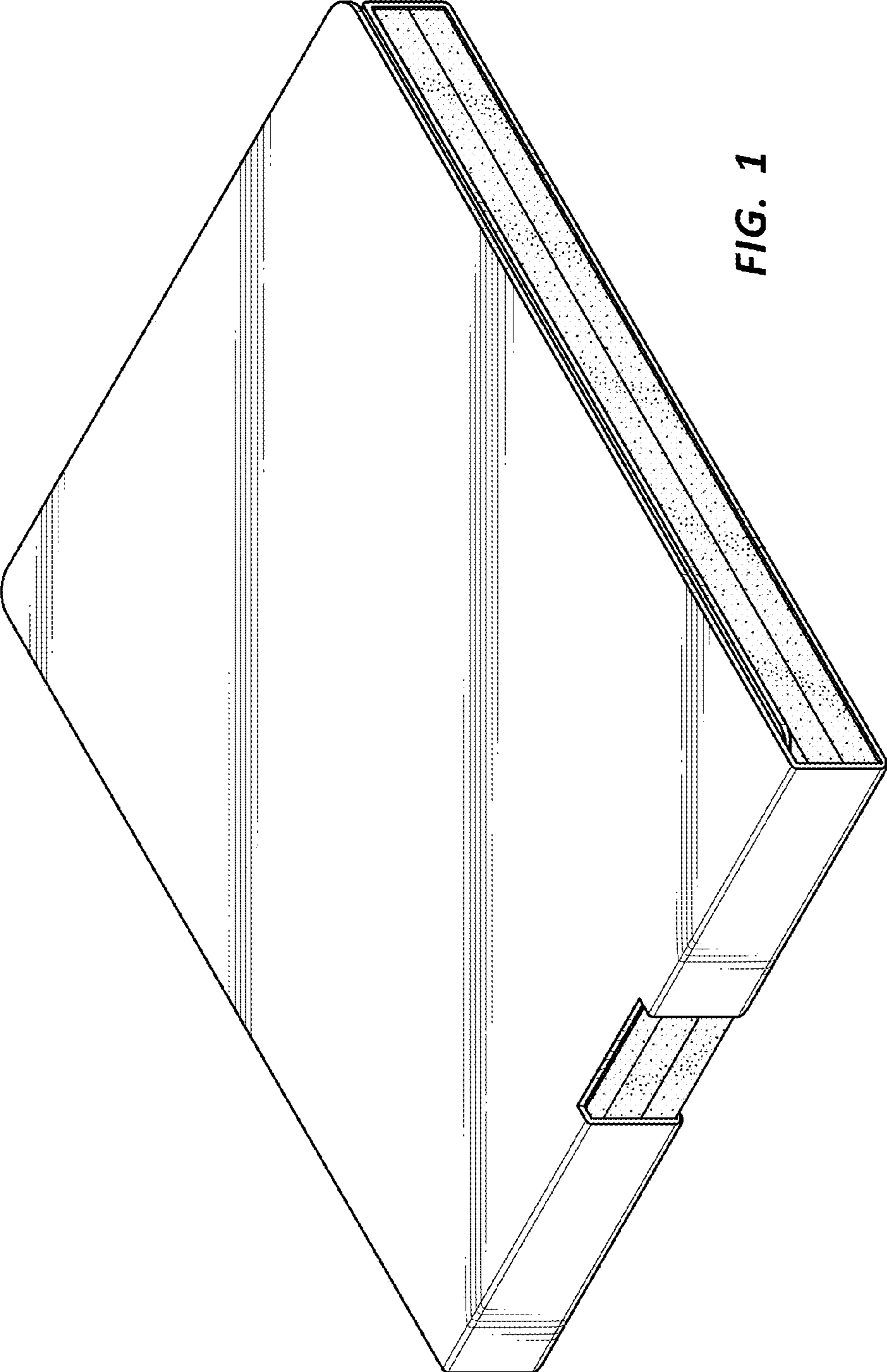

FIG. 1

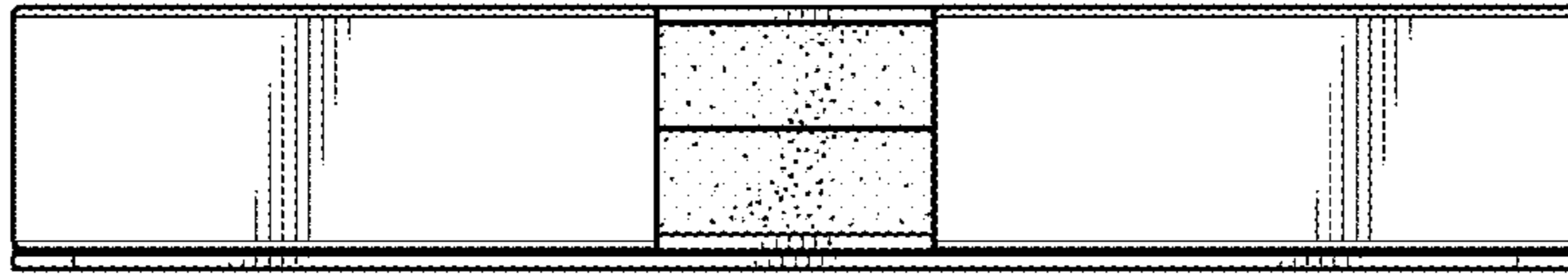

FIG. 5

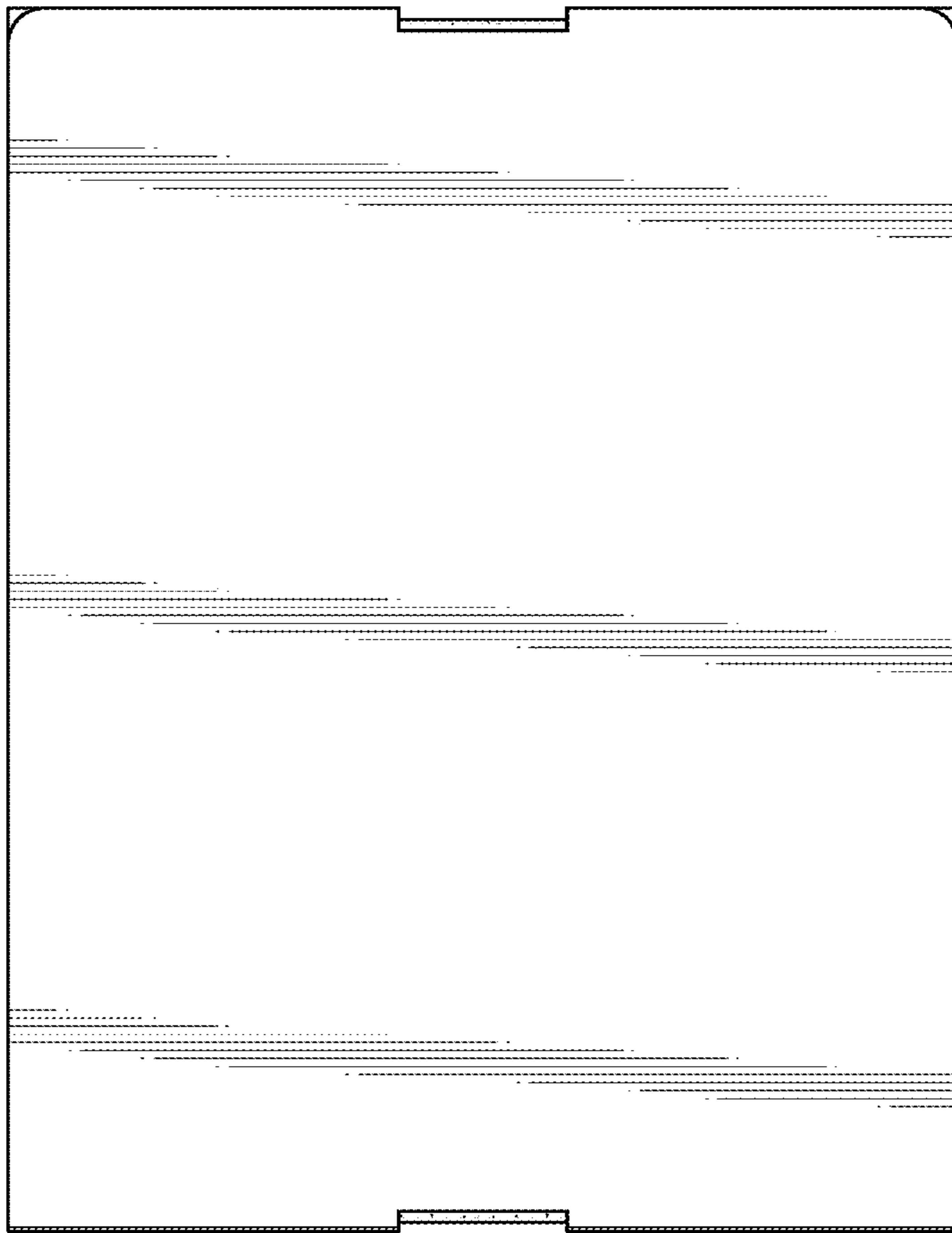

FIG. 2

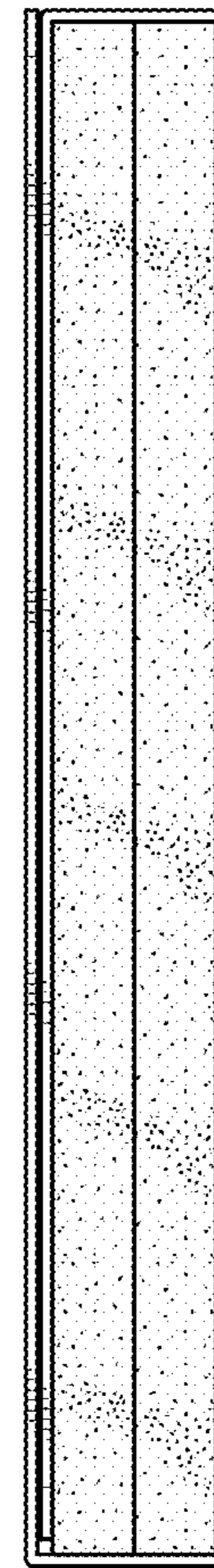

FIG. 3

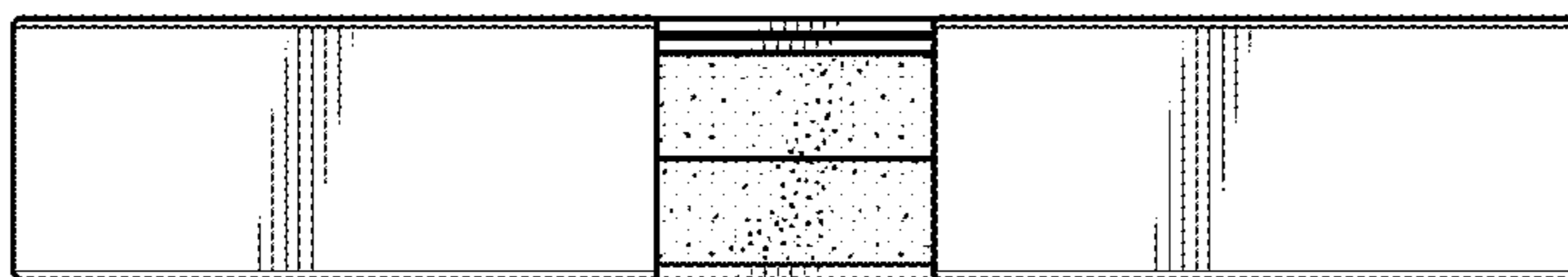

FIG. 4

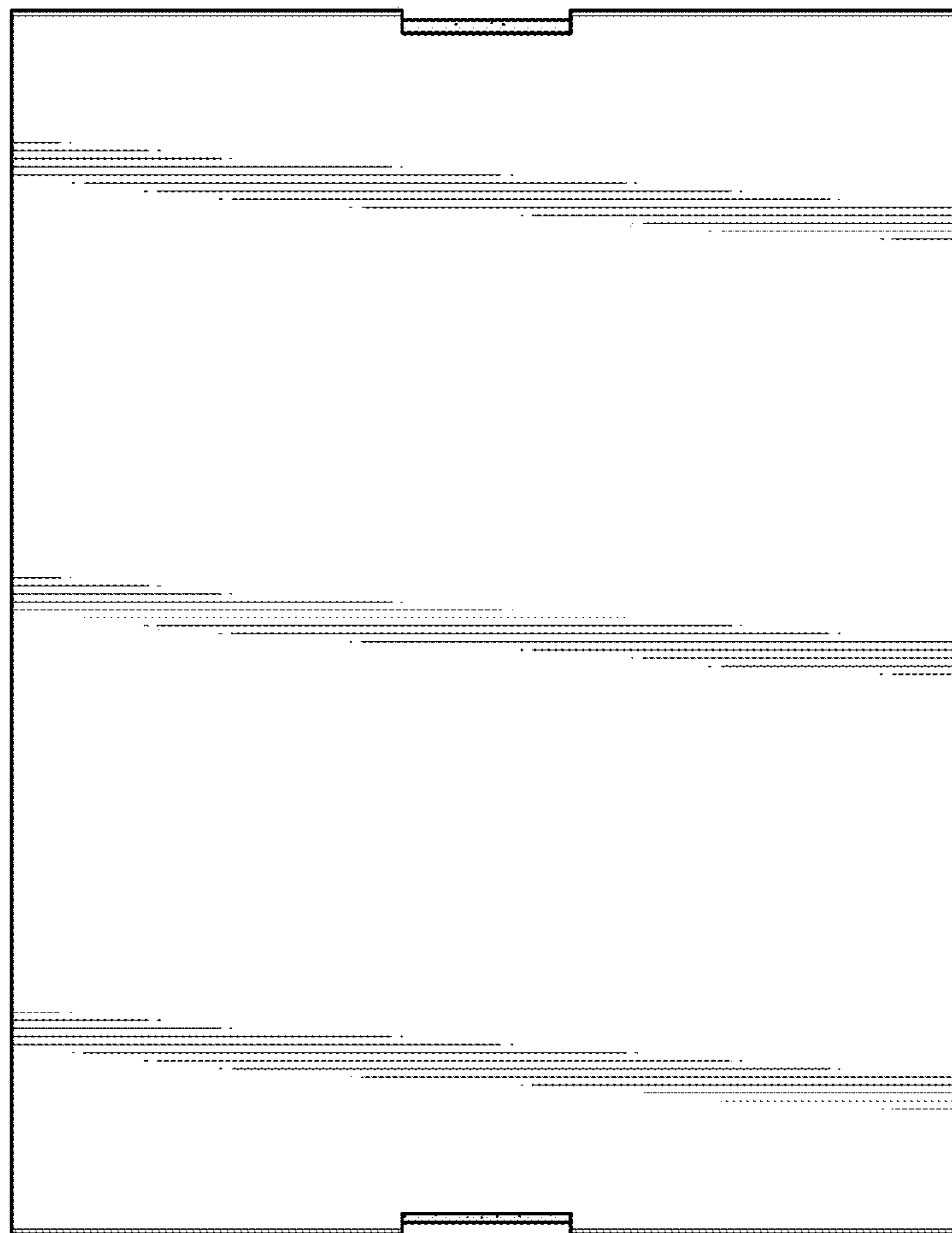

FIG. 6

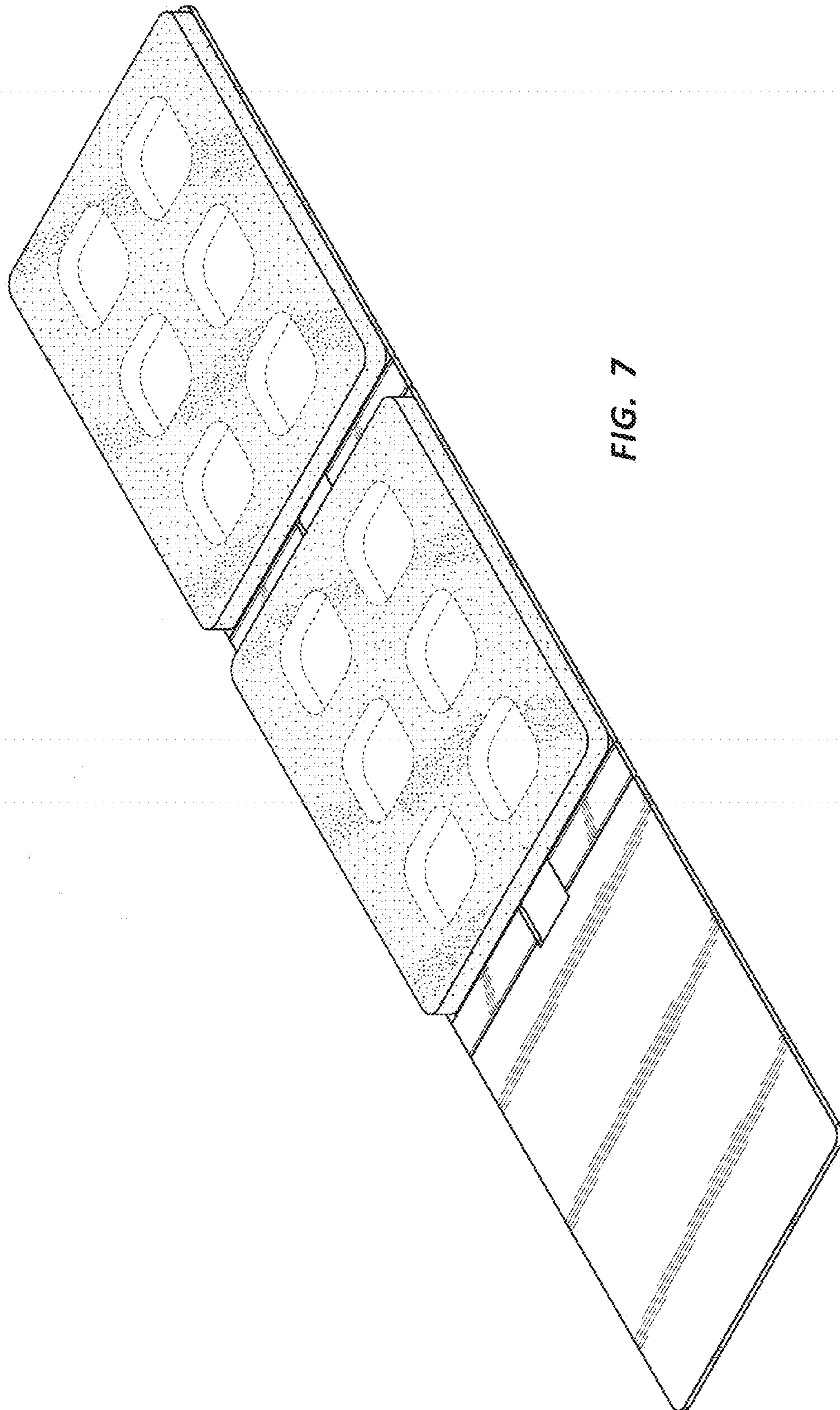

FIG. 7

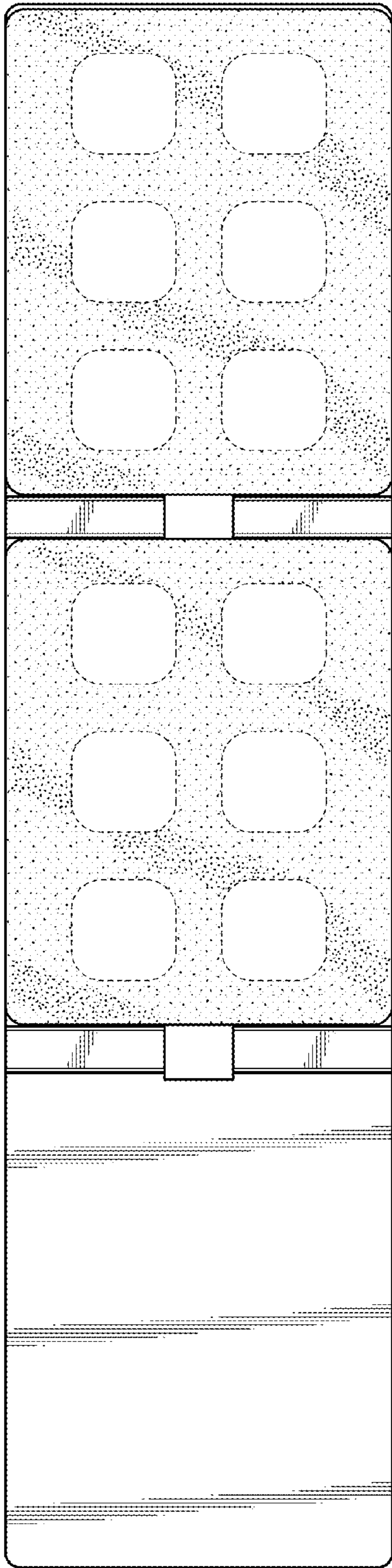

FIG. 8



FIG. 9



FIG. 10

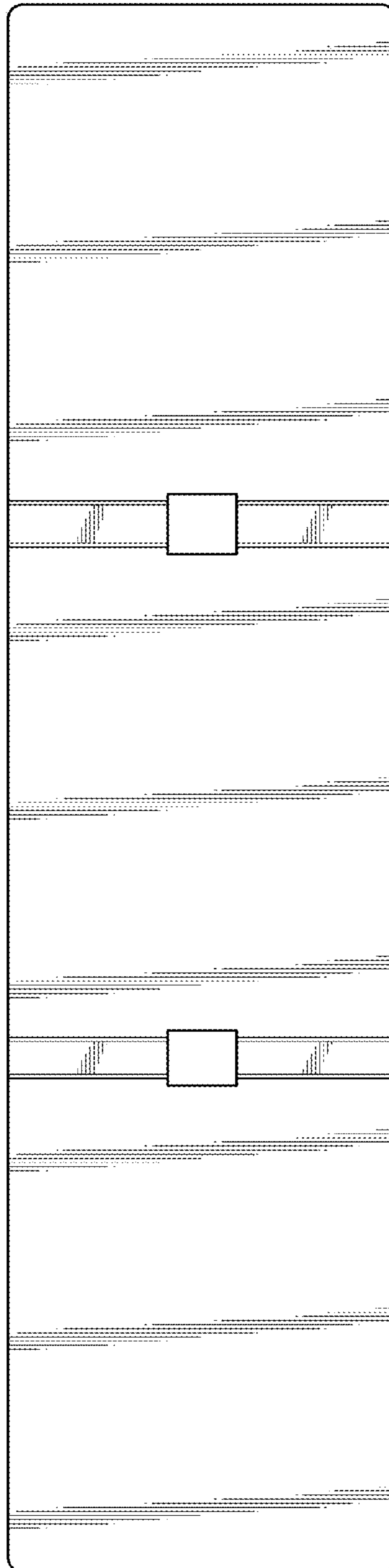

FIG. 11