

US00D766646S

(12) **United States Design Patent**  
**Navare**

(10) **Patent No.:** **US D766,646 S**

(45) **Date of Patent:** **\*\* Sep. 20, 2016**

(54) **GRILL**

6,389,961 B1 5/2002 Wu  
D458,798 S \* 6/2002 Kellermann ..... D7/360

(71) Applicant: **Ravi Navare**, Mabelton, GA (US)

(Continued)

(72) Inventor: **Ravi Navare**, Mabelton, GA (US)

*Primary Examiner* — Ricky Pham

(\*\*) Term: **14 Years**

(74) *Attorney, Agent, or Firm* — Bradley D. Crose; Crose Law LLC

(21) Appl. No.: **29/506,453**

(57) **CLAIM**

The ornamental design for a grill, as shown and described.

(22) Filed: **Oct. 15, 2014**

**DESCRIPTION**

(51) **LOC (10) Cl.** ..... **07-02**

(52) **U.S. Cl.**

USPC ..... **D7/359**; D7/354; D7/356

(58) **Field of Classification Search**

USPC ..... D7/323, 354–363, 367, 391, 393–396, D7/409

CPC ..... A47G 19/12; A47J 27/00; A47J 27/002; A47J 27/08; A47J 27/13; A47J 27/21; A47J 27/58; A47J 33/00; A47J 36/025; A47J 36/06; A47J 36/12; A47J 37/00; A47J 37/01; A47J 37/0623; A47J 37/067; A47J 37/10; A47J 37/101; A47J 37/103; A47J 37/12; A47J 37/1204; A47J 45/061; A47J 45/071; A47J 45/08; H05B 6/12

See application file for complete search history.

FIG. 1 is a perspective view of the grill pan, illustrating the new, original, and ornamental design, shown separately for ease of illustration;

FIG. 2 is a top view of the grill pan, illustrating the new, original, and ornamental design;

FIG. 3 is a side view of the grill pan, illustrating the new, original, and ornamental design;

FIG. 4 is a side cross-sectional view taken through line 4-4 of FIG. 1 of the grill pan, illustrating the new, original, and ornamental design;

FIG. 5 is a perspective view of the grate insert of the grill pan, generally from a bottom view, illustrating the new, original, and ornamental design, shown separately for ease of illustration;

FIG. 6 is a top view of the grate insert of the grill pan, illustrating the new, original, and ornamental design;

FIG. 7 is a side view of the grate insert of the grill pan, illustrating the new, original, and ornamental design.

FIG. 8 is a perspective, expanded view of the grill, illustrating the new, original, and ornamental design;

FIG. 9 is a perspective, expanded view of the grill, illustrating the new, original, and ornamental design;

FIG. 10 is a side view of the grill, illustrating the new, original, and ornamental design;

FIG. 11 is a top view of the grill, illustrating the new, original, and ornamental design; and,

FIG. 12 is an alternate side view of the grate insert of the grill pan, illustrating the new, original, and ornamental design.

The bottom views not shown are not part of the claiming design and form no part of the claimed design.

(56) **References Cited**

**U.S. PATENT DOCUMENTS**

|                |         |                |              |
|----------------|---------|----------------|--------------|
| 199,822 A      | 1/1878  | Geyser         |              |
| D29,714 S *    | 11/1898 | Hall           | D7/359       |
| D85,804 S      | 12/1931 | Axford         |              |
| D183,086 S *   | 6/1958  | Collins        | 126/9 B      |
| D251,176 S     | 2/1979  | Lewis          |              |
| D297,604 S     | 9/1988  | Hagberg et al. |              |
| D414,981 S *   | 10/1999 | Roskind        | D7/359       |
| 5,970,858 A *  | 10/1999 | Boehm          | A47J 37/0629 |
|                |         |                | 99/400       |
| 6,196,115 B1 * | 3/2001  | Tsao           | A47J 27/13   |
|                |         |                | 126/20       |
| 6,201,217 B1 * | 3/2001  | Moon           | A47J 37/0623 |
|                |         |                | 126/21 A     |
| D442,822 S *   | 5/2001  | Lin            | D7/337       |
| 6,334,386 B1   | 1/2002  | Iachetti       |              |

**1 Claim, 12 Drawing Sheets**

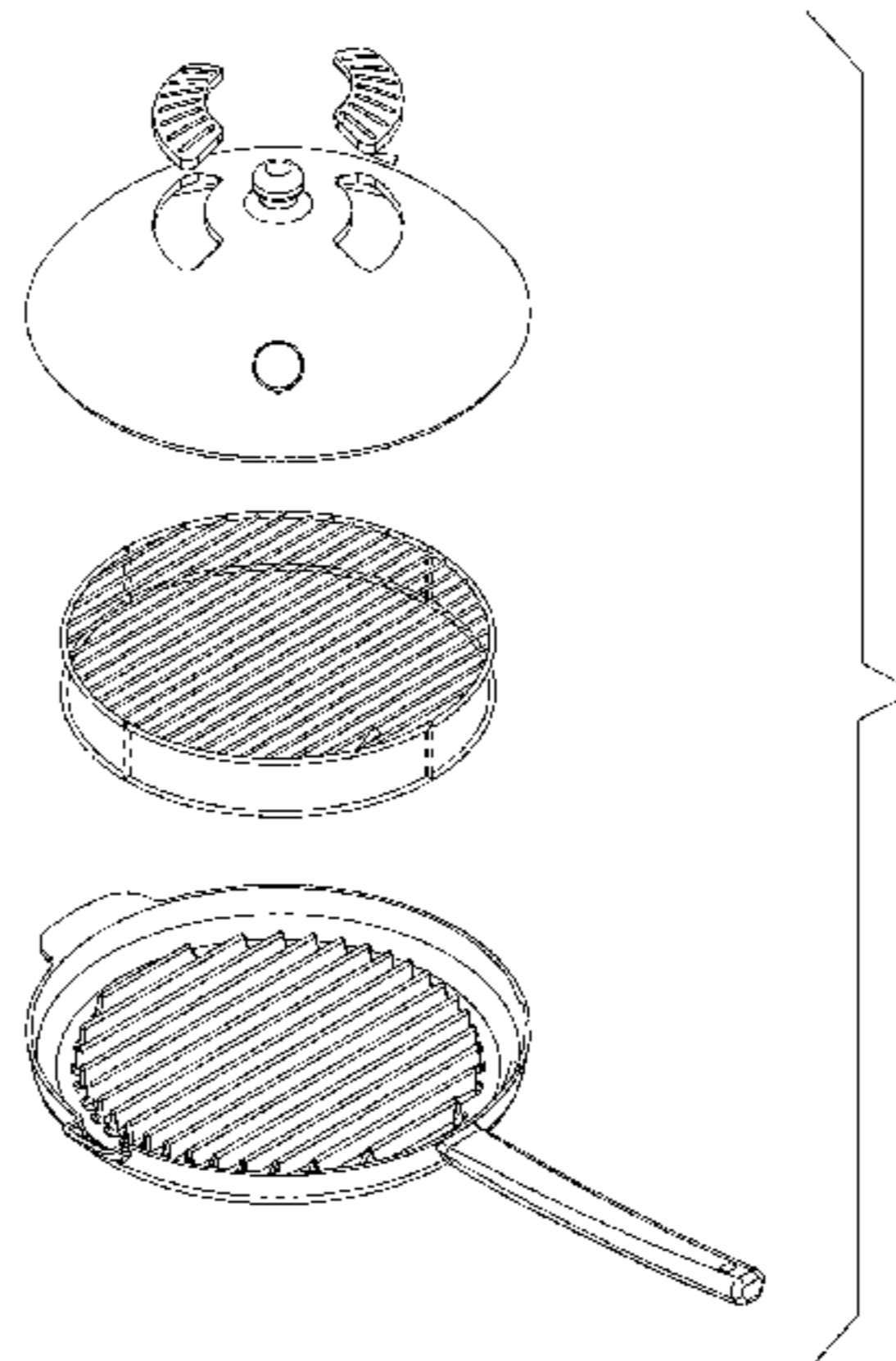

# US D766,646 S

Page 2

---

(56)

## References Cited

### U.S. PATENT DOCUMENTS

|                   |         |         |       |                        |  |  |  |                     |
|-------------------|---------|---------|-------|------------------------|--|--|--|---------------------|
| 6,782,801 B1 *    | 8/2004  | Correa  | ..... | A47J 37/067<br>99/340  |  |  |  |                     |
| D695,059 S *      | 12/2013 | Mehler  | ..... | D7/354                 |  |  |  | * cited by examiner |
| 9,016,191 B2 *    | 4/2015  | Krolick | ..... | A47J 37/01<br>99/447   |  |  |  |                     |
| D730,680 S *      | 6/2015  | Palermo | ..... | D7/367                 |  |  |  |                     |
| 2009/0020109 A1 * | 1/2009  | Rheault | ..... | A47J 33/00<br>126/25 R |  |  |  |                     |

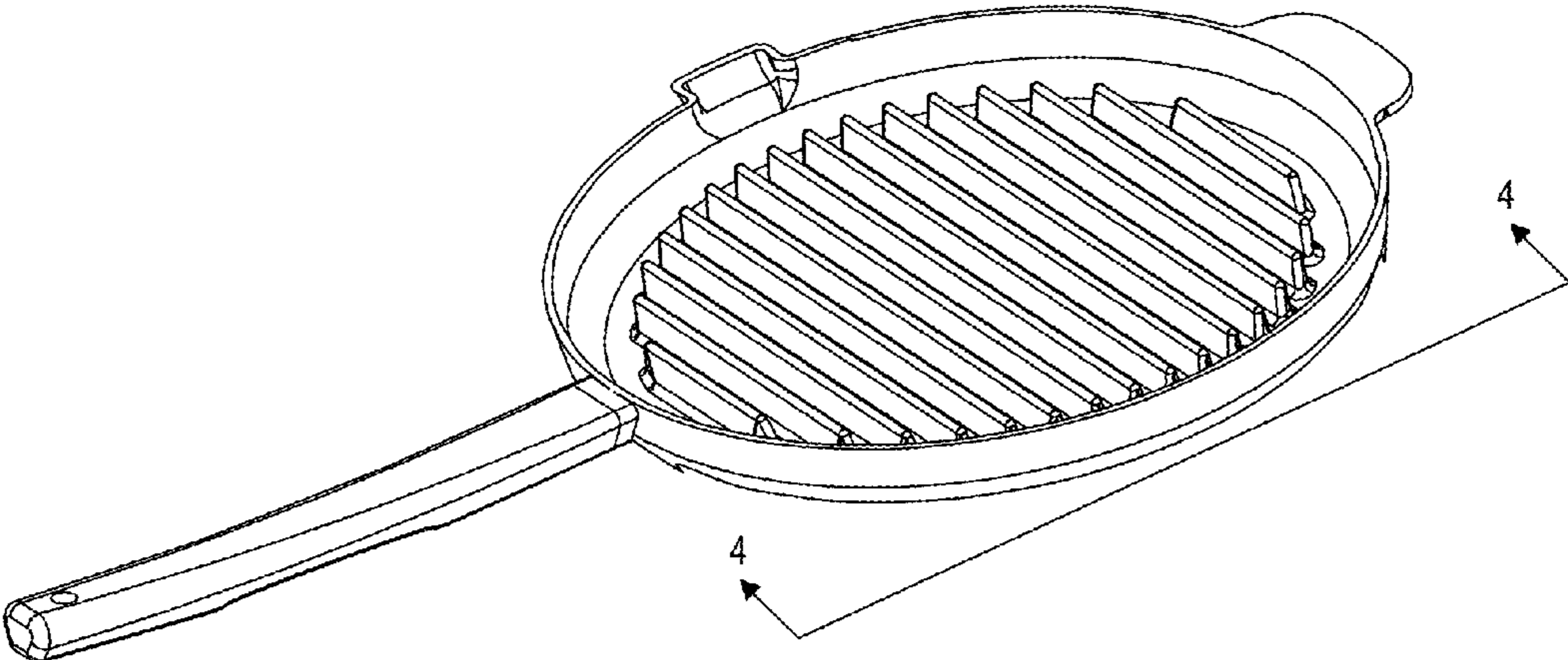

FIG. 1

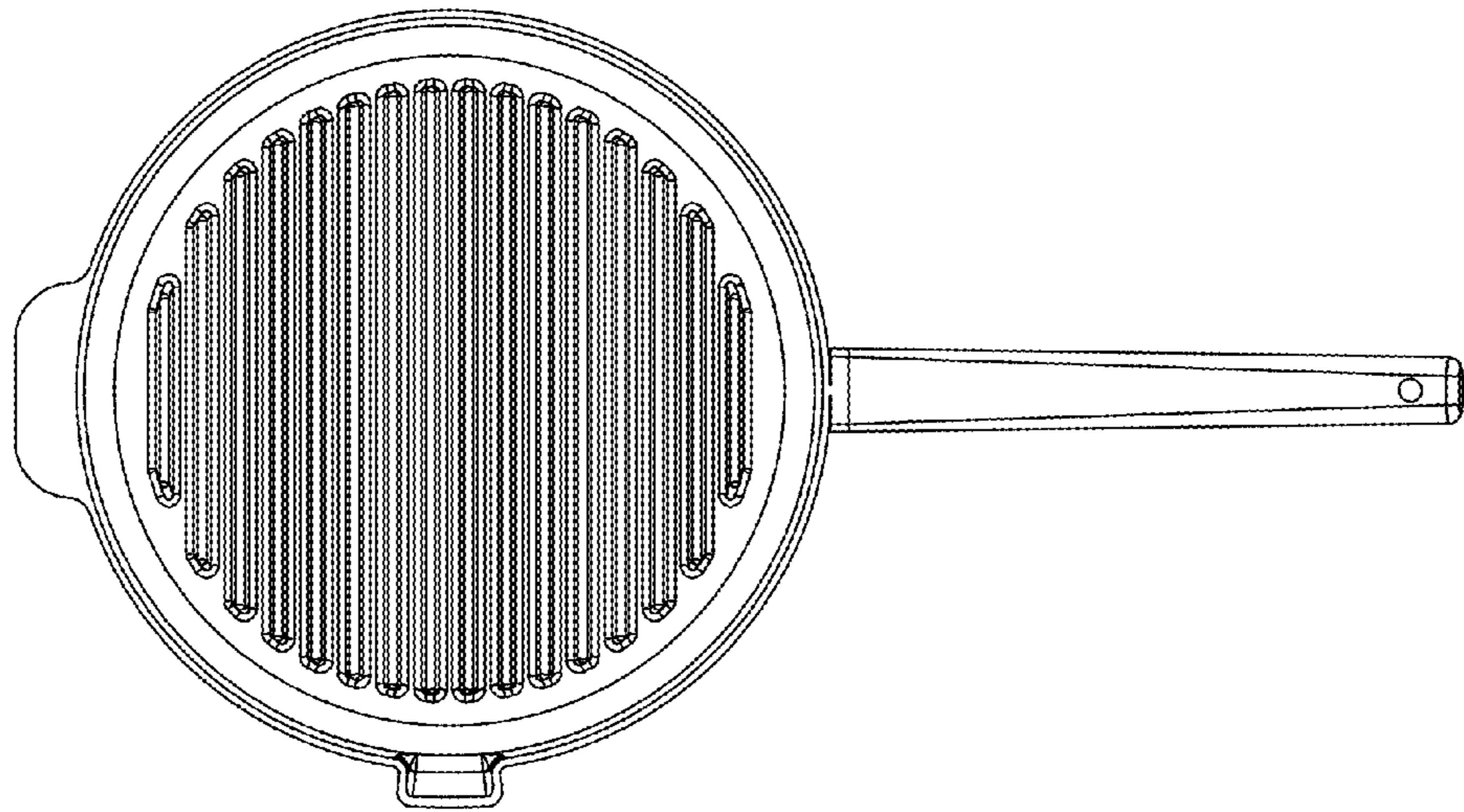

FIG. 2



FIG. 3



FIG. 4

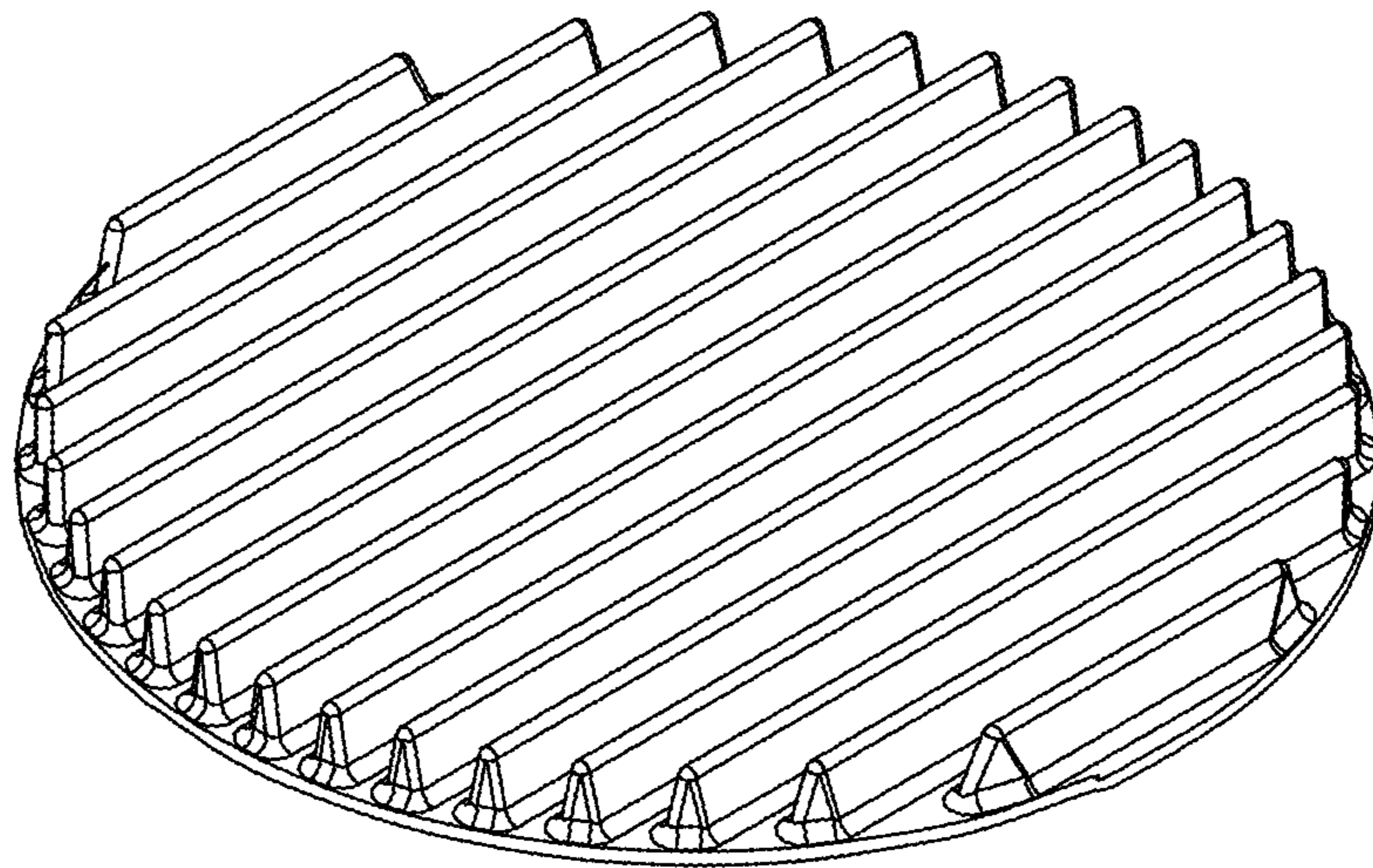

FIG. 5

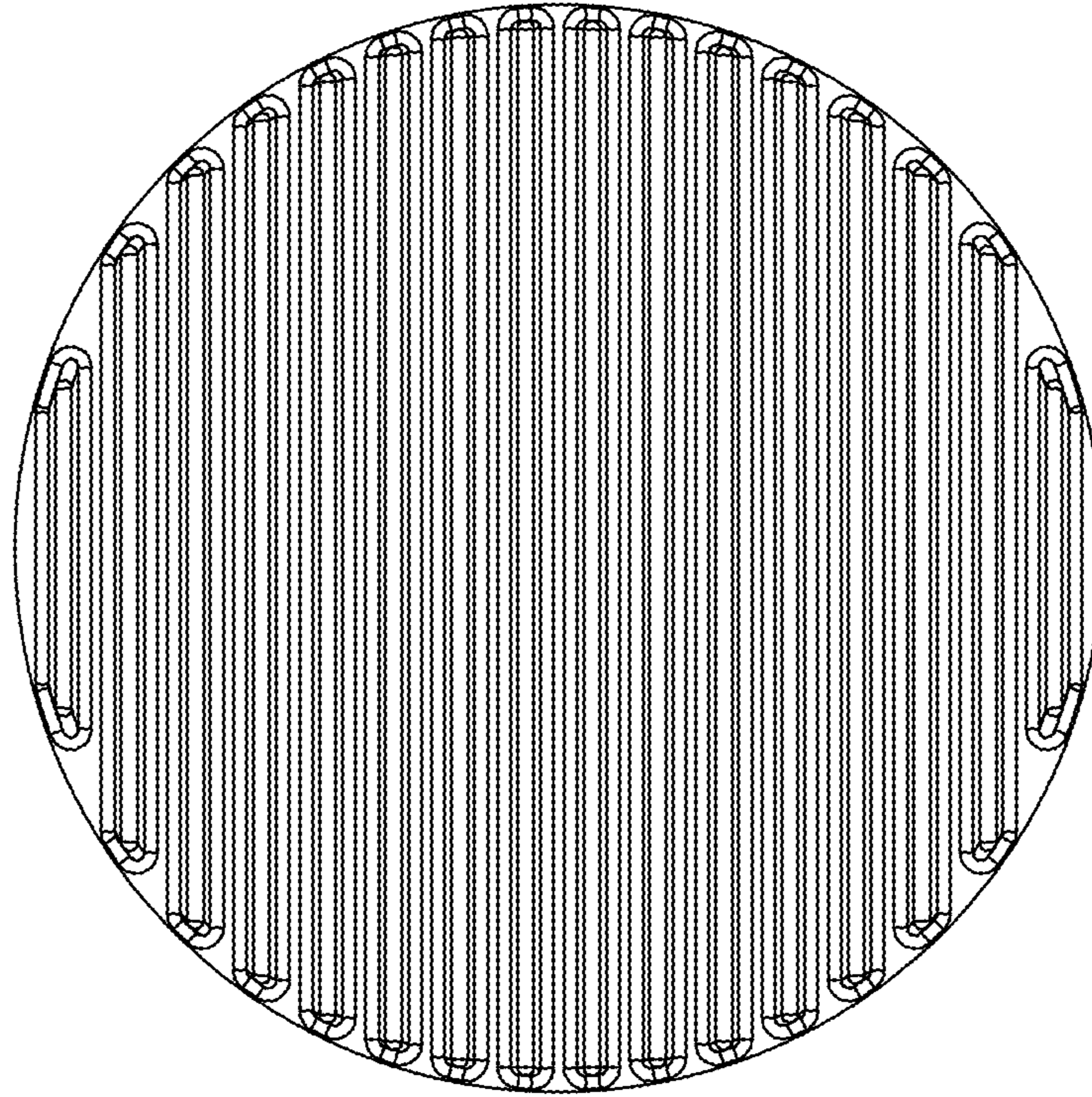

FIG. 6





FIG. 7

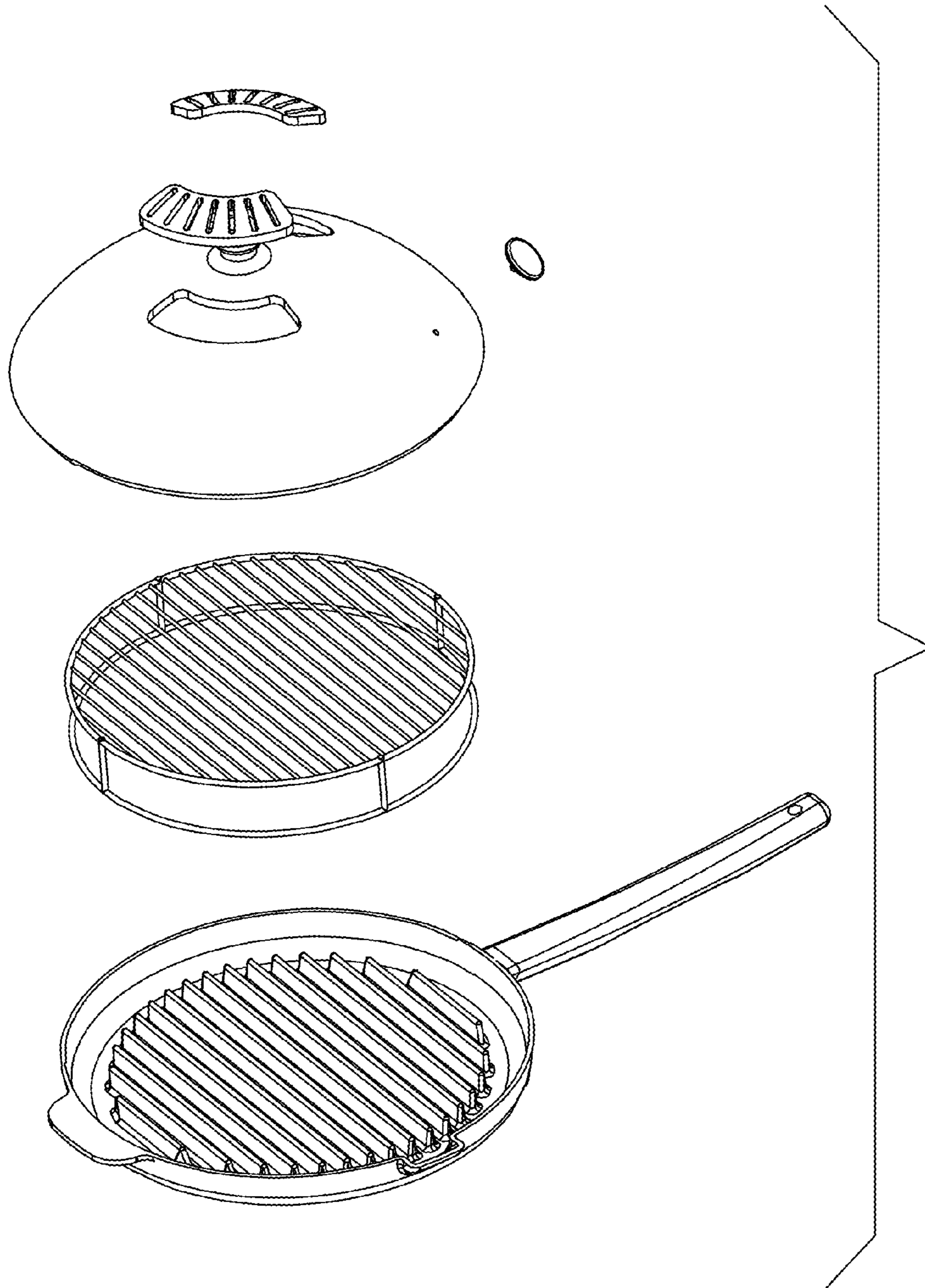

FIG. 8

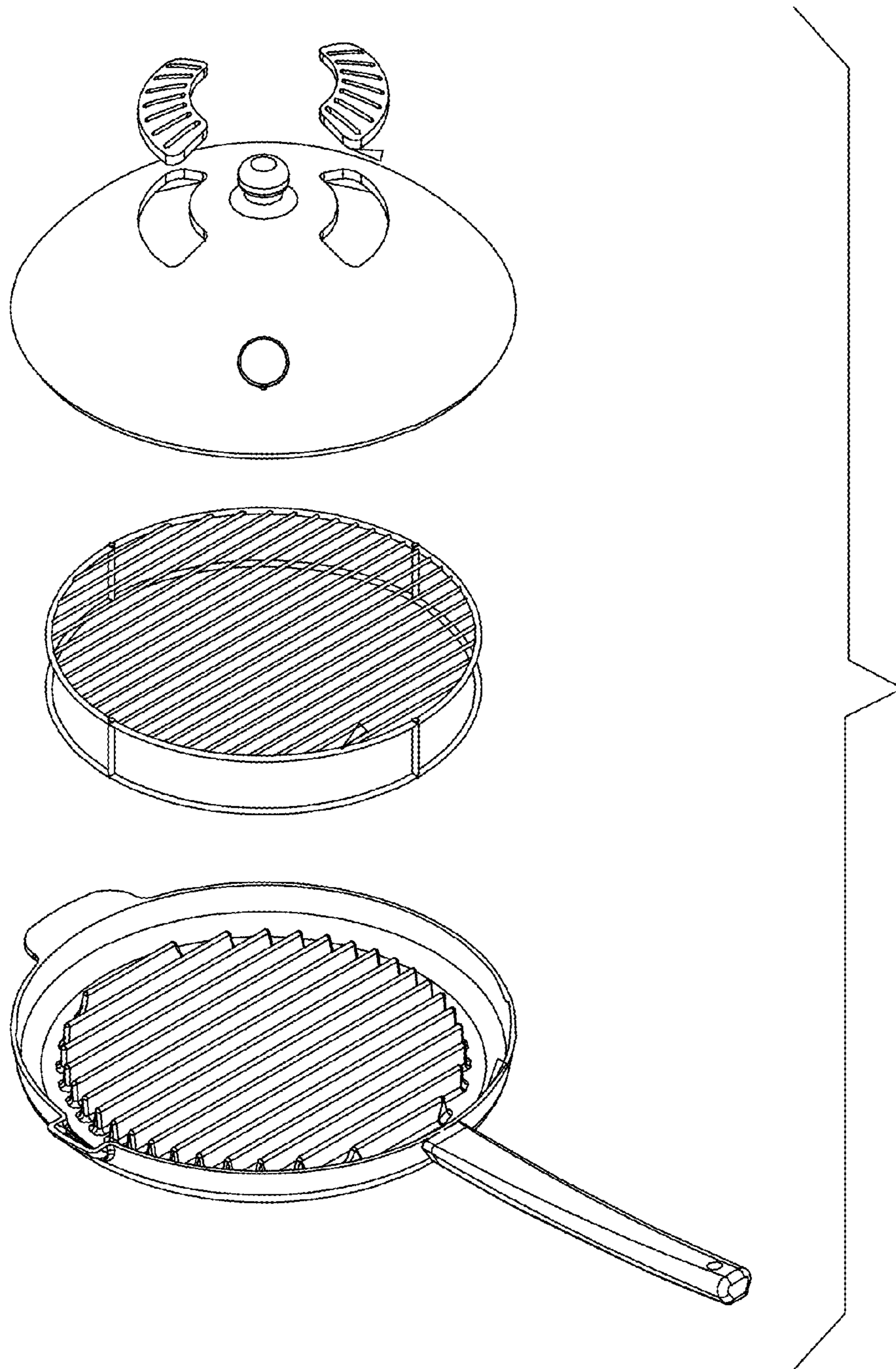

FIG. 9

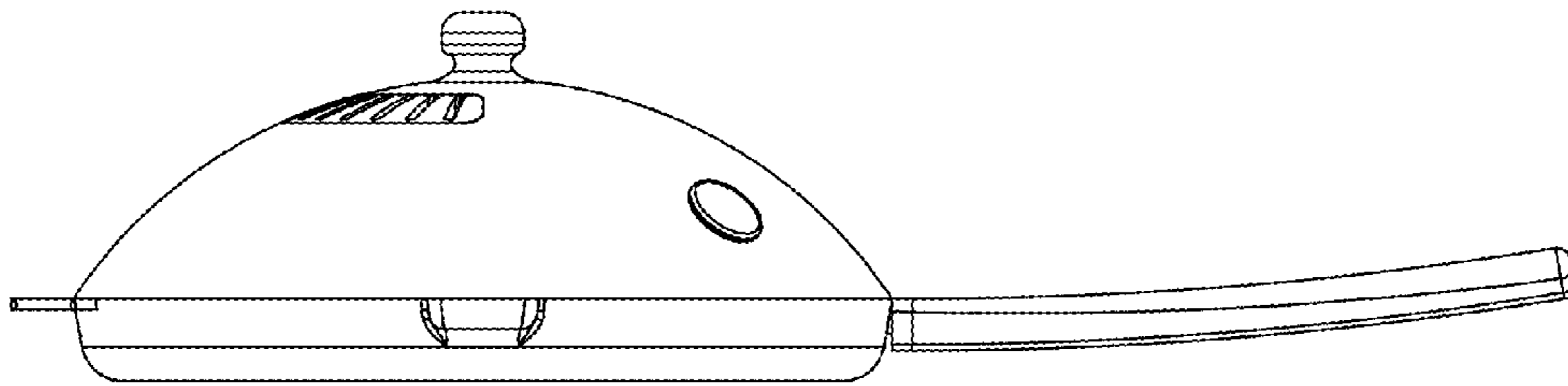

FIG. 10

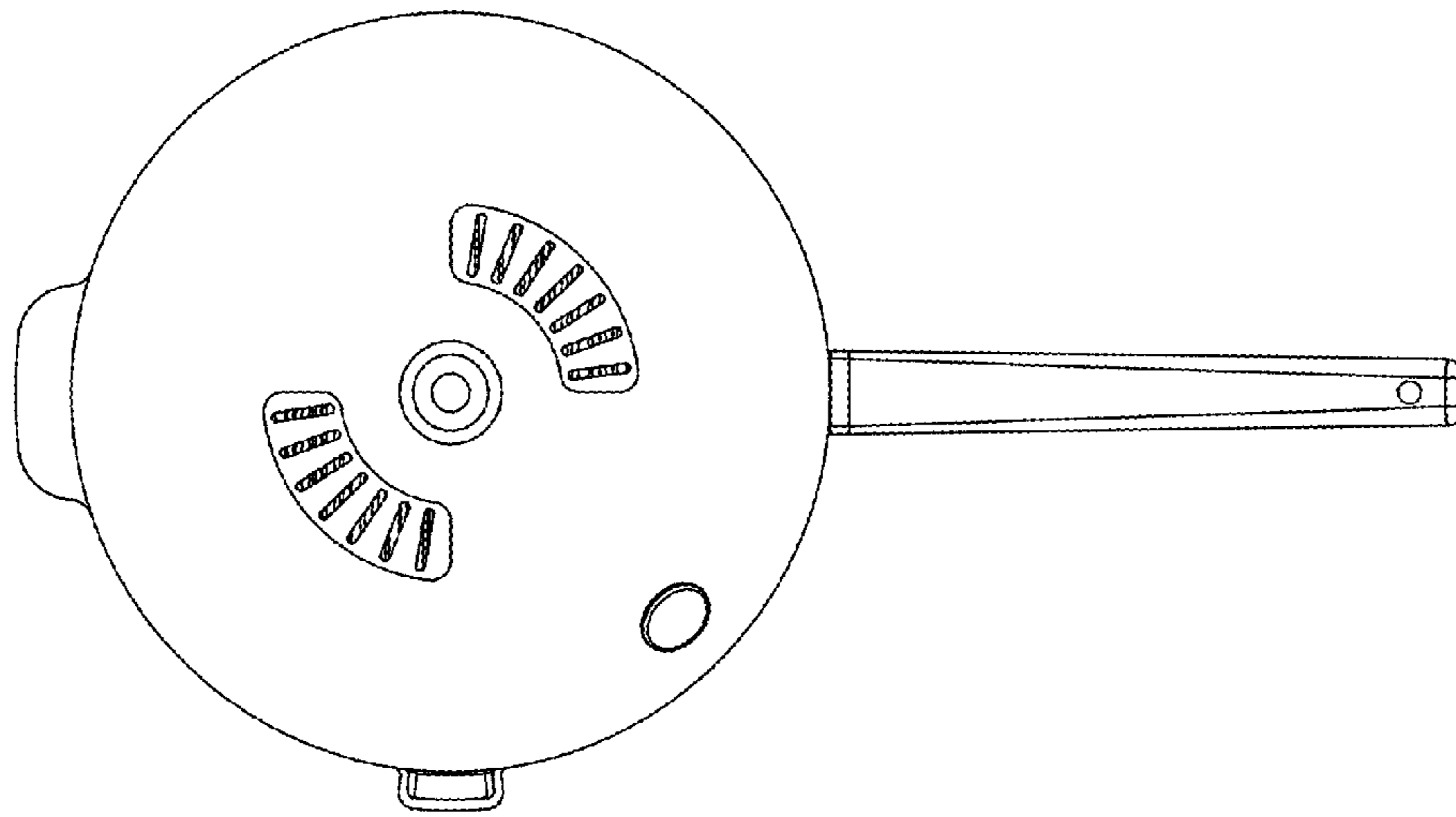

FIG. 11



FIG. 12