

US00D765792S

(12) **United States Design Patent** (10) **Patent No.:** **US D765,792 S**  
**Chatterjee et al.** (45) **Date of Patent:** **\*\* Sep. 6, 2016**

(54) **CONTROLLER**  
(71) Applicant: **Microsoft Corporation**, Redmond, WA (US)  
(72) Inventors: **Monique Chatterjee**, Seattle, WA (US); **Austin Rand Porter**, Seattle, WA (US); **William Bennett Mabry**, Seattle, WA (US); **Jordan Patrick Evans**, Seattle, WA (US); **Richard Thomas Hanks**, Seattle, WA (US); **Ryan Curtis Clark**, Maple Valley, WA (US)  
(73) Assignee: **Microsoft Corporation**, Redmond, WA (US)

D435,551 S 12/2000 Hayes  
6,231,444 B1 \* 5/2001 Goto ..... G05G 9/047  
273/148 B  
D449,042 S 10/2001 Chung  
D453,932 S 2/2002 Han et al.  
6,463,159 B1 10/2002 Ming-Cheng  
D467,922 S 12/2002 Lee  
6,743,100 B1 \* 6/2004 Neiser ..... A63F 13/06  
273/148 B  
6,968,070 B1 11/2005 Chiang  
D521,015 S 5/2006 Hayes et al.  
D522,011 S 5/2006 Hayes et al.  
D522,012 S 5/2006 Hayes et al.  
7,063,321 B2 \* 6/2006 Hussaini ..... A63F 13/06  
273/148 B  
7,105,754 B2 9/2006 Turner  
7,195,561 B2 3/2007 Hussaini et al.

(\*\*) Term: **15 Years**

(Continued)

(21) Appl. No.: **29/535,181**  
(22) Filed: **Aug. 4, 2015**  
(51) **LOC (10) Cl.** ..... **21-01**  
(52) **U.S. Cl.**  
USPC ..... **D21/333**; D14/401  
(58) **Field of Classification Search**  
USPC ..... D14/496, 401, 435, 474, 483, 217, 137,  
D14/138, 160, 168, 356, 203.1-203.8, 507;  
345/156, 169, 173-179, 905;  
715/727-729, 864; 710/1, 5, 8; 713/1,  
713/600; 455/1.1, 1.7, 73, 344-347, 93, 95,  
455/3.01-3.06, 550.1, 573.1; 370/342-344;  
369/1, 2, 6-12; 463/43-47, 29-35;  
273/148 B; D21/324-333  
CPC ..... A63F 13/02; A63F 13/12; A63F 9/24;  
A63F 9/02; A63F 11/00; A63F 71/00;  
G06F 3/02; G06G 3/033; G09G 5/00  
See application file for complete search history.

**OTHER PUBLICATIONS**

Side-by-side: Xbox One Gamepad vs Xbox 360 gamepad (Jun. 11, 2013), <http://www.techradar.com/us/news/gaming/consoles/side-by-side-xbox-one-gamepad-vs-xbox-360-gamepad-1158091>.

*Primary Examiner* — Prabhakar Deshmukh  
(74) *Attorney, Agent, or Firm* — Banner & Witcoff, Ltd.

(57) **CLAIM**  
The ornamental design for a controller, as shown and described.

**DESCRIPTION**

FIG. 1 is a perspective front view of a controller showing our new design;  
FIG. 2 is a front view thereof;  
FIG. 3 is a rear view thereof;  
FIG. 4 is a right side view thereof;  
FIG. 5 is a left side view thereof;  
FIG. 6 is a top view thereof; and,  
FIG. 7 is a bottom view thereof.  
The broken line showing of the remainder of the controller in FIGS. 1-7 is for environmental purposes only and forms no part of the claimed design.

(56) **References Cited**  
U.S. PATENT DOCUMENTS  
D398,214 S 9/1998 Yui  
D424,047 S 5/2000 Chan

**1 Claim, 6 Drawing Sheets**

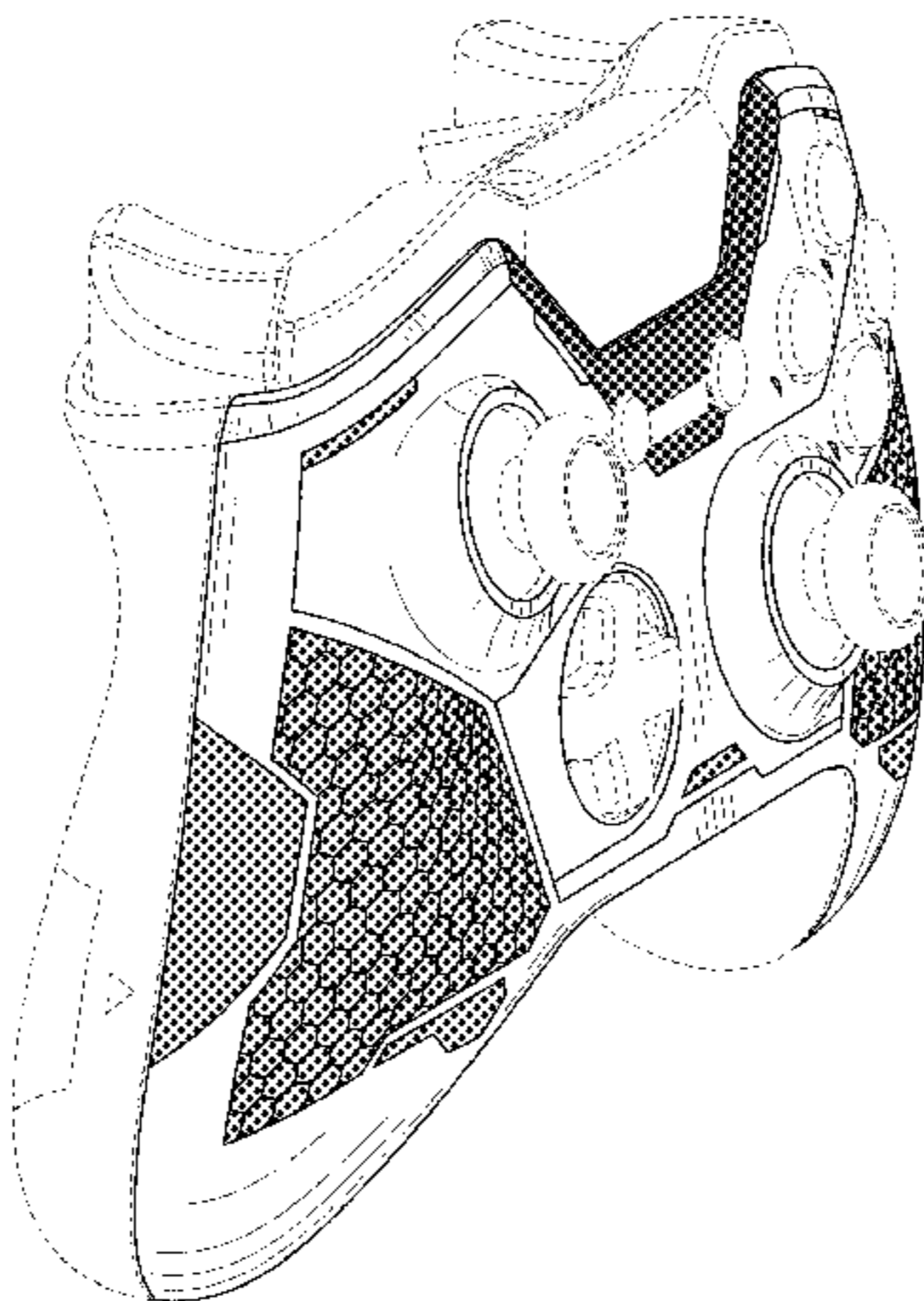

(56)

References Cited

U.S. PATENT DOCUMENTS

D545,317 S *	6/2007	Wang .....	D14/401	D646,275 S	10/2011	Ikeda et al.	
D547,763 S	7/2007	Hayes et al.		D650,795 S	12/2011	Koehn	
D556,201 S	11/2007	Ashida et al.		D655,350 S	3/2012	Taniguchi et al.	
D563,480 S	3/2008	Blaseflug et al.		D658,178 S	4/2012	Ikeda et al.	
D565,668 S	4/2008	Baseflug et al.		D658,179 S	4/2012	Ikeda et al.	
D568,335 S	5/2008	Armstrong et al.		D659,140 S	5/2012	Ikeda et al.	
D569,388 S	5/2008	Armstrong et al.		D685,434 S *	7/2013	Ali .....	D14/401
D581,422 S	11/2008	Hayes et al.		D692,001 S	10/2013	Ibuki et al.	
7,445,550 B2	11/2008	Barney et al.		D692,887 S	11/2013	Ibuki et al.	
D601,564 S	10/2009	Maeno		D694,830 S	12/2013	Crowley et al.	
D619,596 S	7/2010	Maitlen et al.		D700,182 S *	2/2014	Kidakarn .....	D14/401
7,762,553 B2 *	7/2010	Harris .....	A63F 13/98 273/148 B	D708,615 S *	7/2014	Delrue .....	D14/401
D637,153 S	5/2011	Ikeda et al.		D709,498 S	7/2014	Morris et al.	
D638,016 S	5/2011	Ikeda		D709,499 S *	7/2014	Morris .....	D14/401
				D709,882 S *	7/2014	Morris .....	D14/401
				D715,865 S	10/2014	Morris et al.	
				D745,607 S *	12/2015	Jones .....	D14/401
				D754,128 S *	4/2016	Bellinghausen .....	D14/401

\* cited by examiner

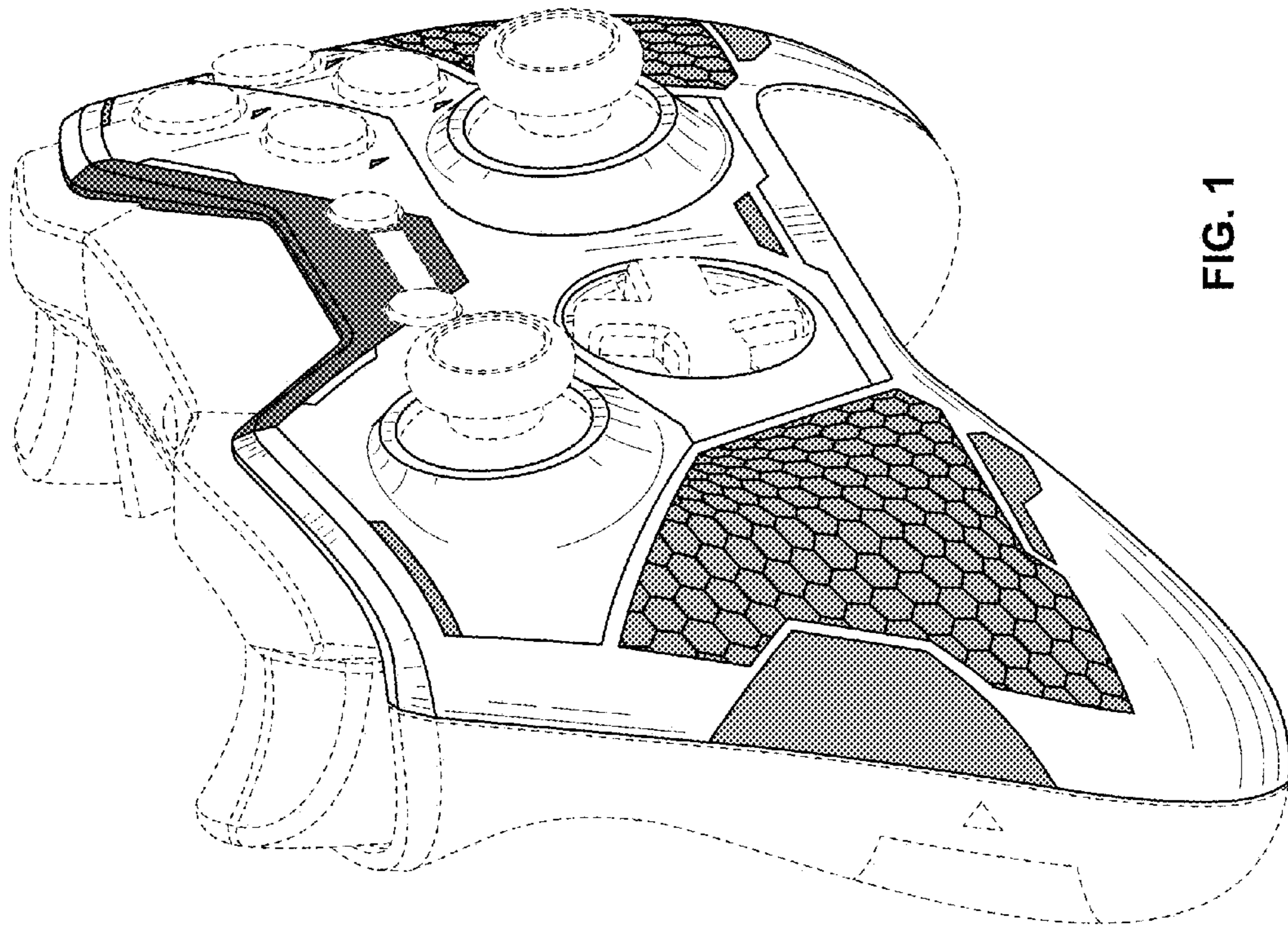

FIG. 1

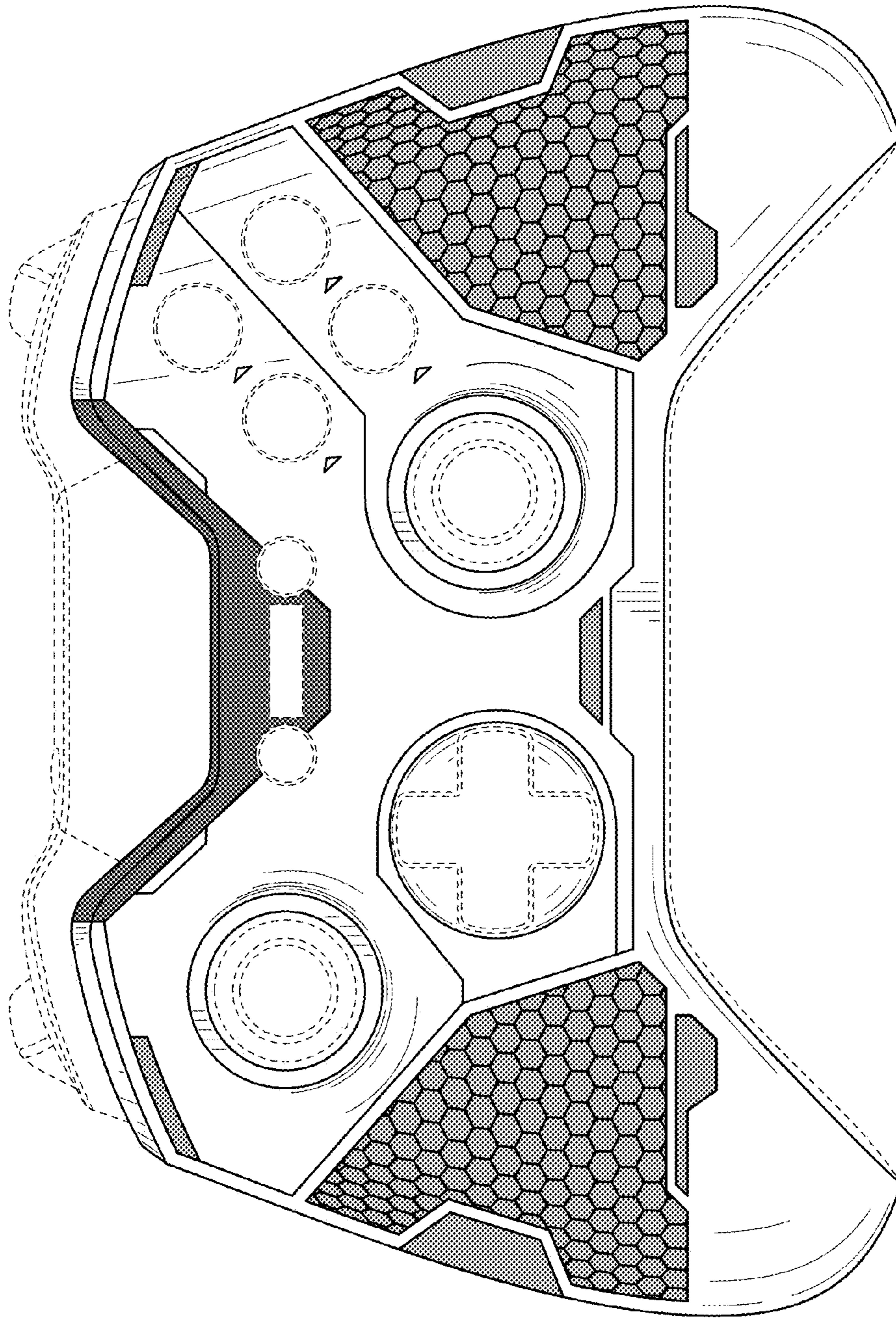

FIG. 2

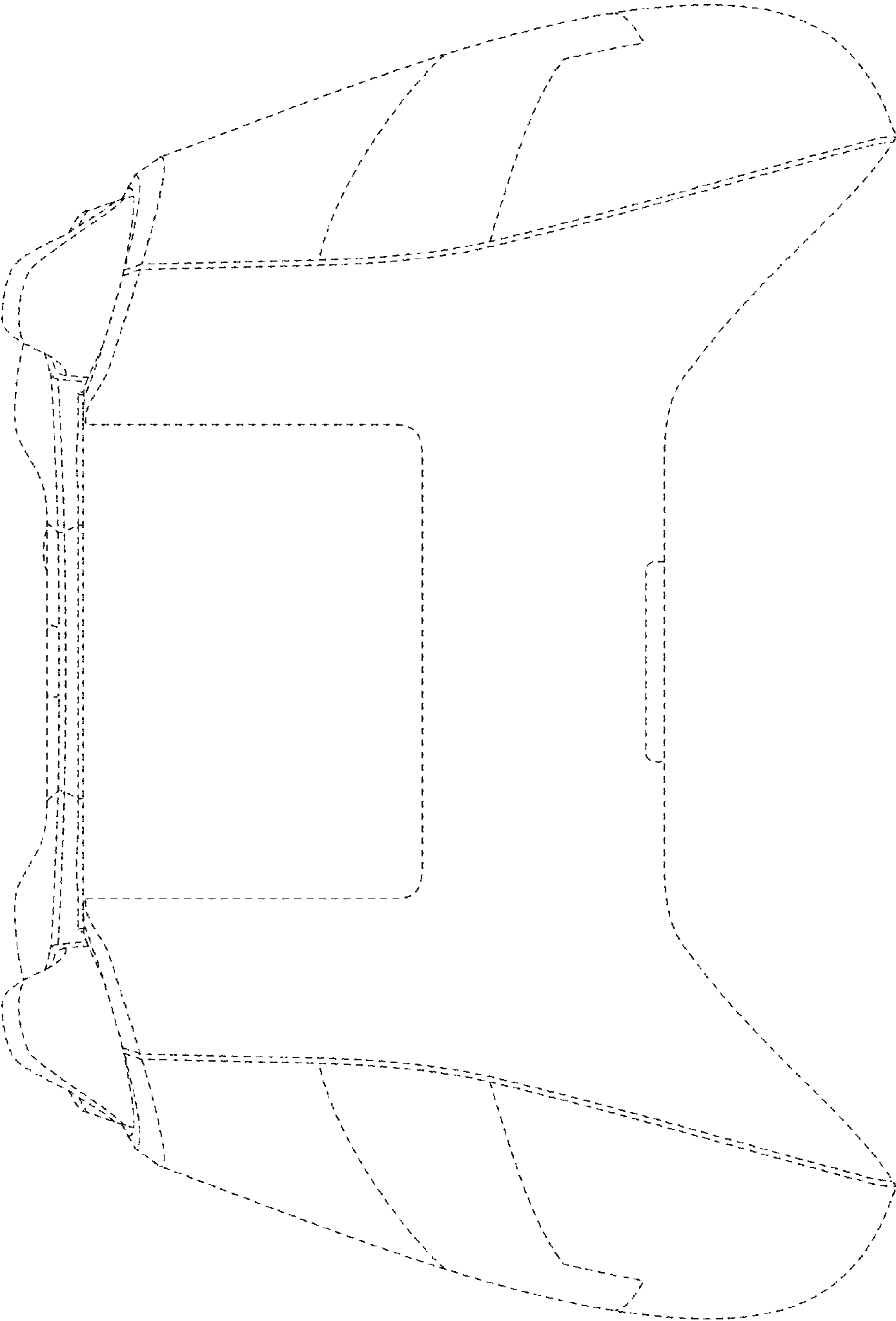

FIG. 3

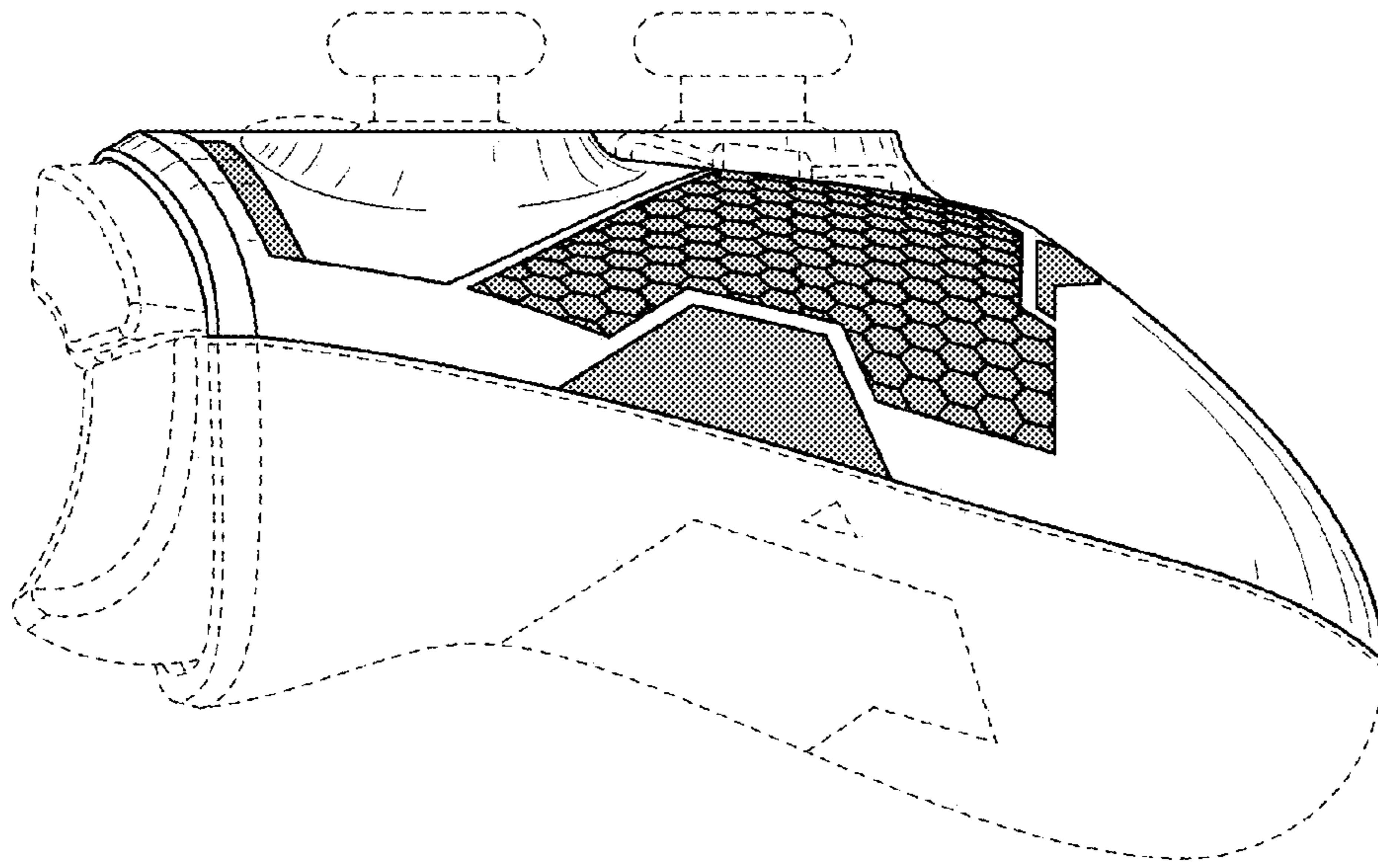

FIG. 5

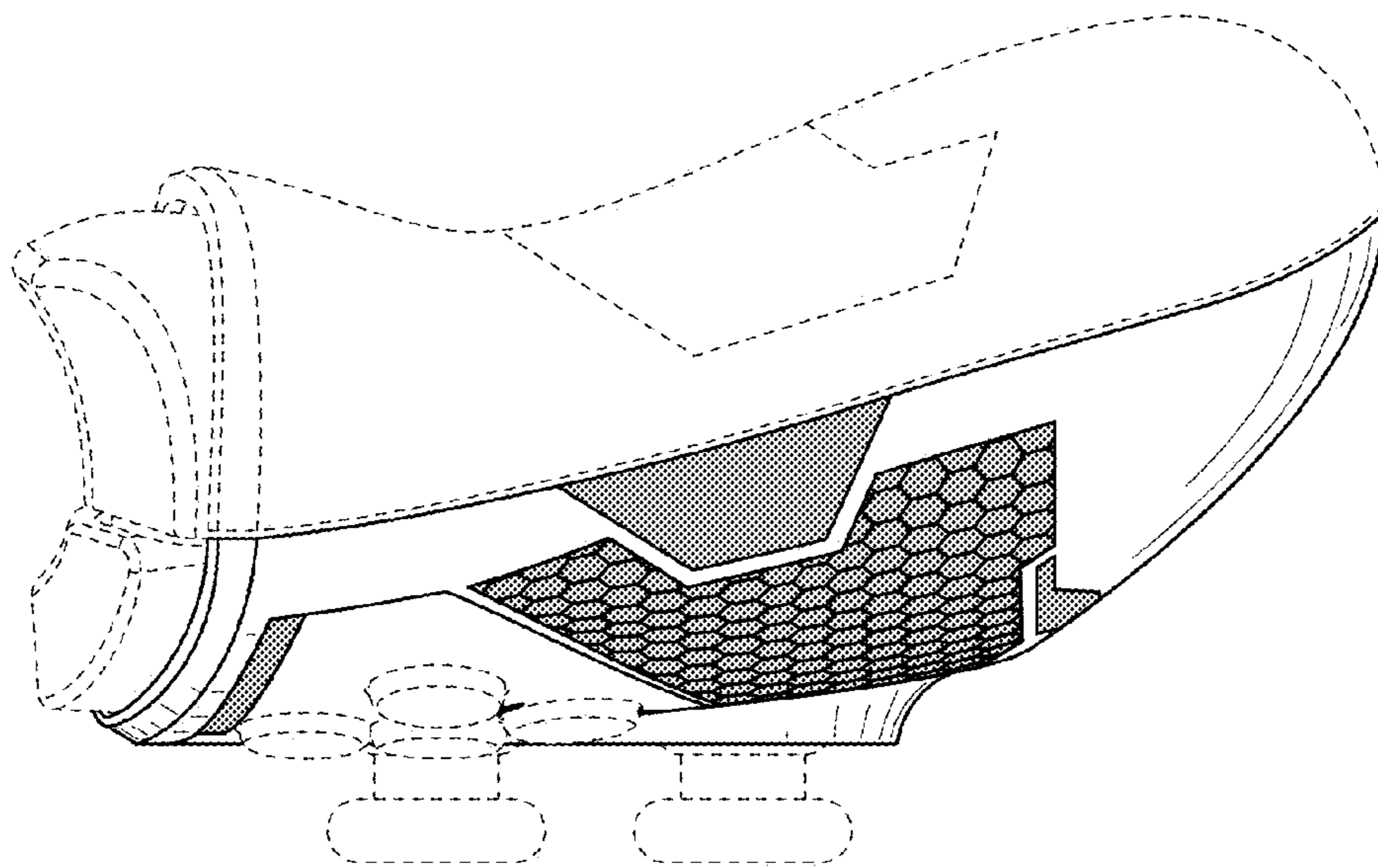

FIG. 4

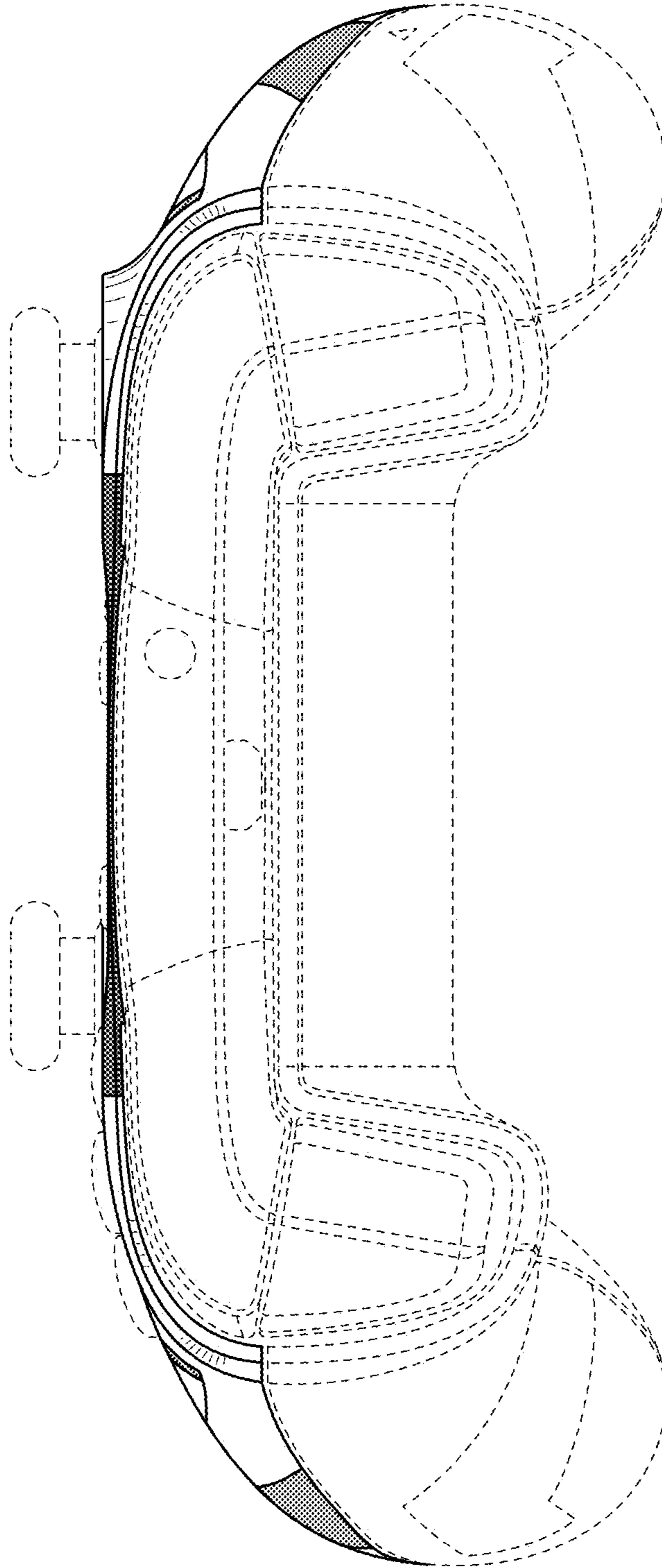

FIG. 6

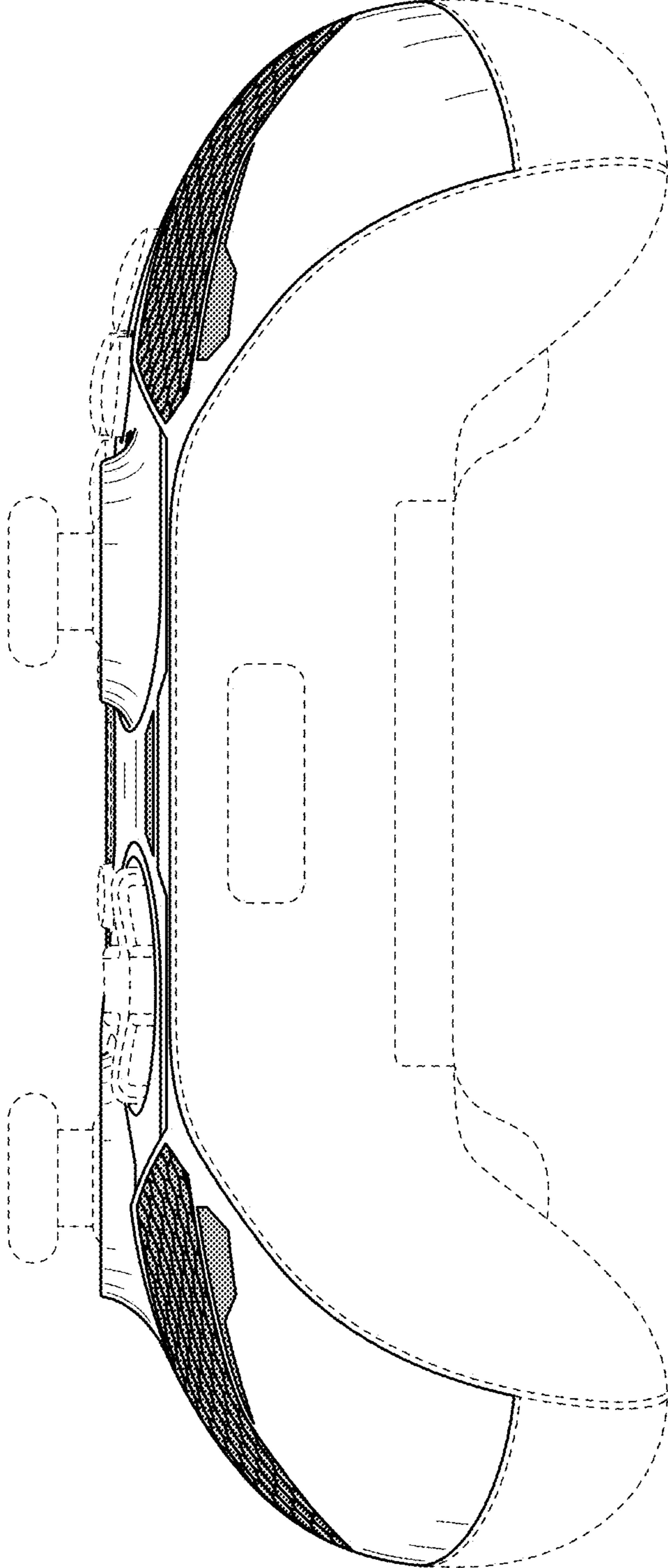

FIG. 7