



US00D765107S

(12) **United States Design Patent** (10) **Patent No.:** **US D765,107 S**
Heinrich et al. (45) **Date of Patent:** **** Aug. 30, 2016**

(54) **DISPLAY SCREEN WITH GRAPHICAL USER INTERFACE**

(71) Applicant: **Deere & Company**, Moline, IL (US)

(72) Inventors: **Nathan C. Heinrich**, Singapore (SG);
Sangeeta Mehta, Moline, IL (US);
Alison Wong, Menlo Park, CA (US)

(73) Assignee: **Deer & Company**, Moline, IL (US)

(**) Term: **14 Years**

(21) Appl. No.: **29/477,427**

(22) Filed: **Dec. 20, 2013**

(51) **LOC (10) Cl.** **14-04**

(52) **U.S. Cl.**
USPC **D14/486**

(58) **Field of Classification Search**
USPC D14/485-495
See application file for complete search history.

(56) **References Cited**

U.S. PATENT DOCUMENTS

- 6,934,615 B2 * 8/2005 Flann A01B 69/008
172/2
- 7,110,881 B2 * 9/2006 Gray G01C 21/00
340/995.19
- D555,661 S * 11/2007 Kim D14/486
- D595,304 S * 6/2009 Rasmussen D14/486
- D614,195 S * 4/2010 Guntaur D14/486
- D616,451 S * 5/2010 Cameron D14/486
- D625,322 S * 10/2010 Guntaur D14/486
- 8,127,240 B2 2/2012 Grotjohn et al.
- D656,945 S * 4/2012 Lee D14/486
- D658,667 S * 5/2012 Cho D14/486
- D664,977 S * 8/2012 Everingham D14/487
- D666,629 S * 9/2012 Lee D14/486
- 8,296,170 B2 10/2012 O'Brien et al.
- D671,953 S * 12/2012 Lee D14/486
- D671,954 S * 12/2012 Wojcik D14/486
- D682,844 S * 5/2013 Friedlander D14/485
- 8,515,456 B2 * 8/2013 Yoon H04M 1/72572

- 340/992
- D689,085 S * 9/2013 Pasceri D14/486
- D691,616 S * 10/2013 Talbot D14/485
- D696,678 S * 12/2013 Bae D14/486
- D696,680 S * 12/2013 Bae D14/486
- D696,681 S * 12/2013 Kim D14/486
- D696,682 S * 12/2013 Kim D14/486
- D708,197 S * 7/2014 Pasceri D14/486
- 8,984,099 B1 * 3/2015 Giencke H04L 67/10
705/14.49
- D735,213 S * 7/2015 Kim D14/485

(Continued)

OTHER PUBLICATIONS

iCropTrack iCT 4.1 Display Screen, <http://www.icroptrak.com/icroptrak4.1late.html>, Copyright 2014.

(Continued)

Primary Examiner — Sheryl Lane
Assistant Examiner — Nicole Shiflet

(74) *Attorney, Agent, or Firm* — Ingrassia, Fisher & Lorenz, PC

(57) **CLAIM**

The ornamental design for a display screen with graphical user interface, as shown and described.

DESCRIPTION

The patent file contains at least one drawing executed in color. Copies of the patent file with color drawing(s) will be provided by the Patent Office upon request and payment of the necessary fee.

FIG. 1 is a front view of a display screen with graphical user interface showing our new design;

FIG. 2 is another embodiment thereof;

FIG. 3 is another embodiment thereof; and,

FIG. 4 is another embodiment thereof.

The dot-dash line representations of the display screen in the figures, and the dash line representations in FIGS. 3 and 4, form no part of the claimed design.

1 Claim, 4 Drawing Sheets
(2 of 4 Drawing Sheet(s) Filed in Color)

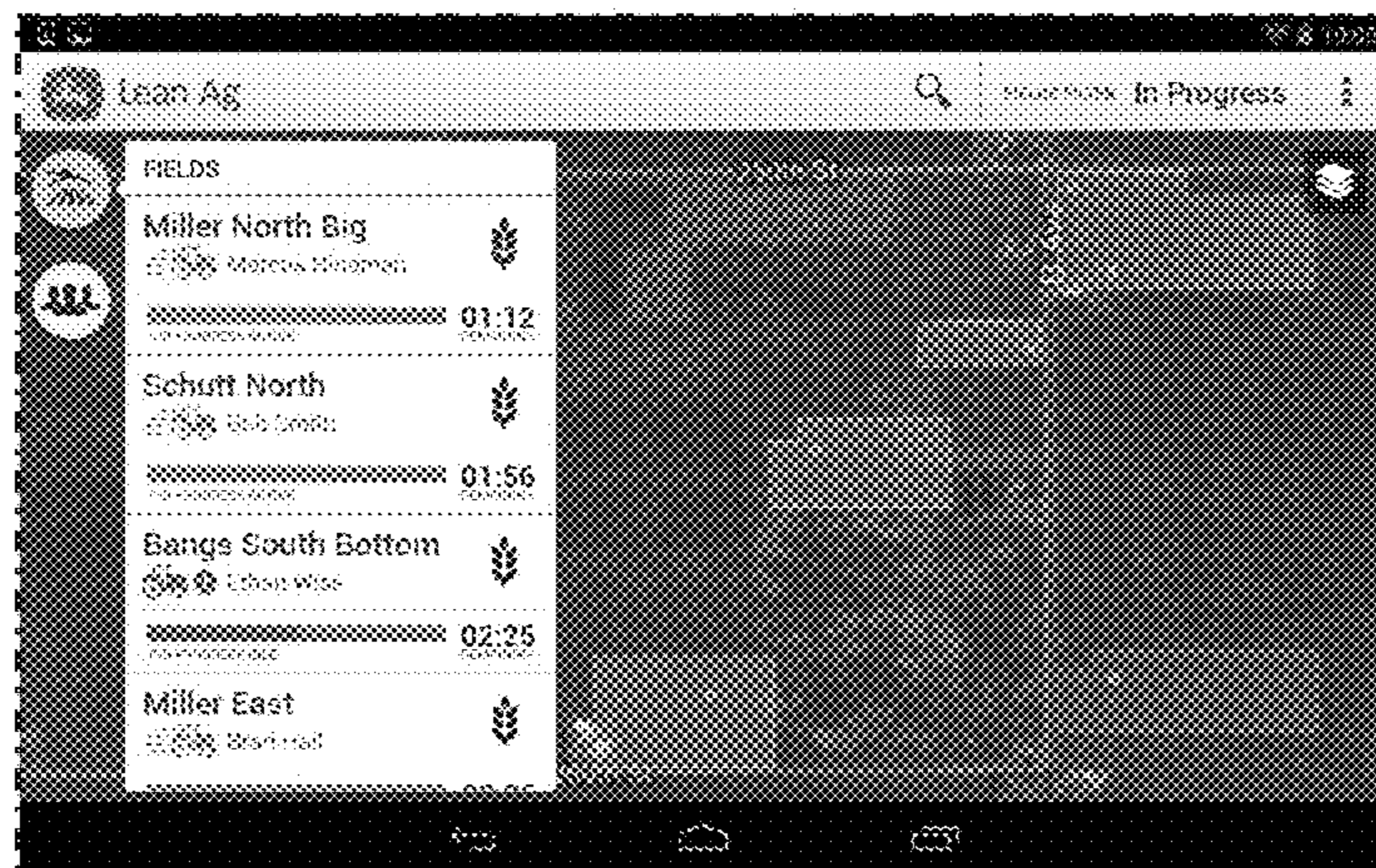

(56)

References Cited

U.S. PATENT DOCUMENTS

D737,831 S * 9/2015 Lee D14/485
D738,384 S * 9/2015 Kim D14/485
D738,386 S * 9/2015 Meegan D14/485
D738,396 S * 9/2015 Kenmochi D14/488
D738,398 S * 9/2015 Drozd D14/488
D741,343 S * 10/2015 Chung D14/485
D741,883 S * 10/2015 Kadosh D14/486
2006/0271287 A1* 11/2006 Gold G01C 21/26
701/426
2007/0281689 A1* 12/2007 Altman G06Q 30/0207
455/435.1
2008/0040684 A1* 2/2008 Crump G06F 3/0482
715/808

2012/0317108 A1* 12/2012 Okazaki G06F 3/0488
707/732
2012/0326997 A1* 12/2012 Kasahara G06F 3/0488
345/173
2013/0326407 A1* 12/2013 van Os G01C 21/00
715/810

OTHER PUBLICATIONS

Precision Planting 20/20 SeedSense® Display Screen, <http://www.precisionplanting.com/Products/20-20-seedsense/performance.aspx>, Copyright 2013.
Flexicode Solutions Farm Manager Display Screen, <http://farm-manager.co/index.html>.

* cited by examiner



FIG. 1

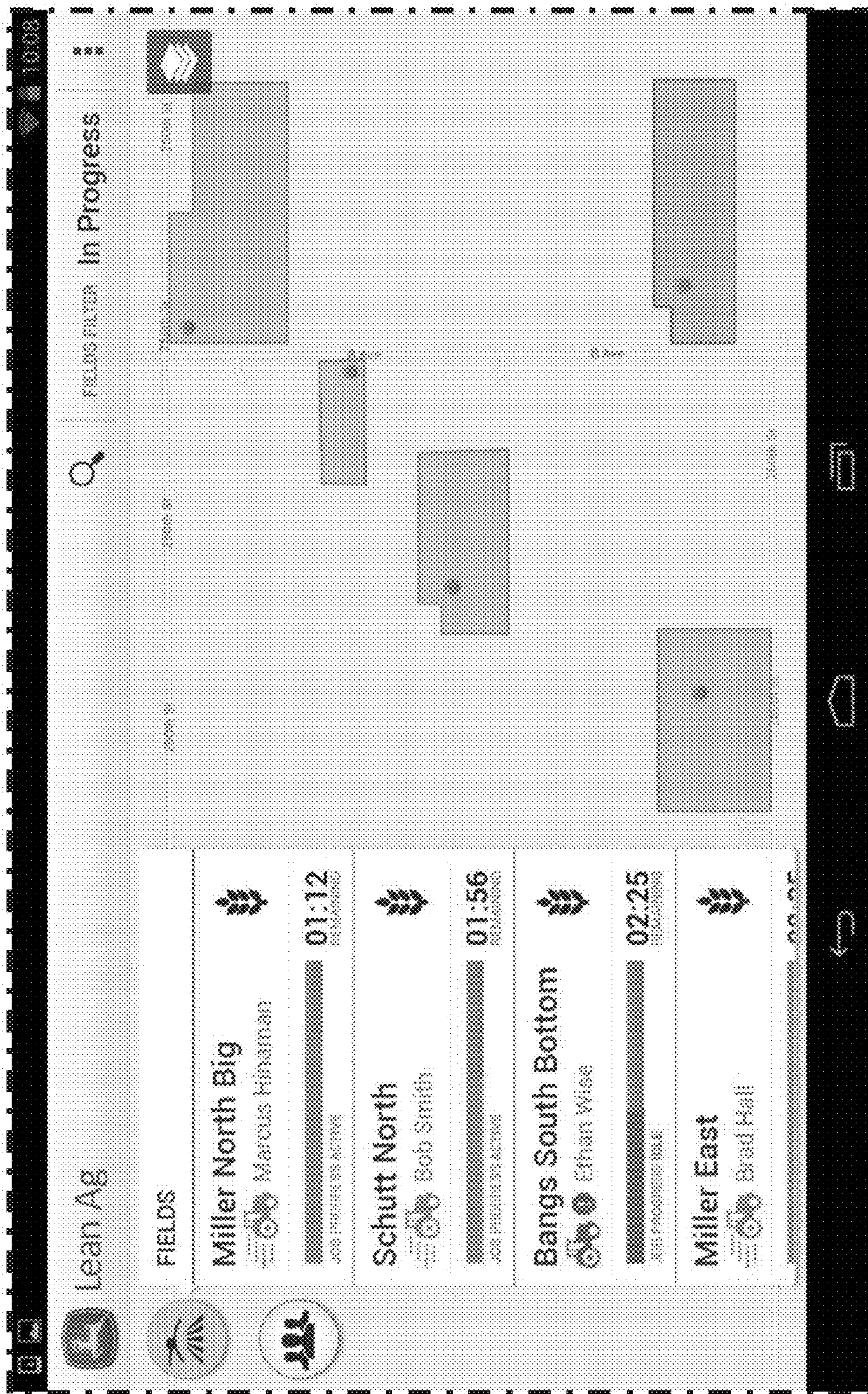

FIG. 2

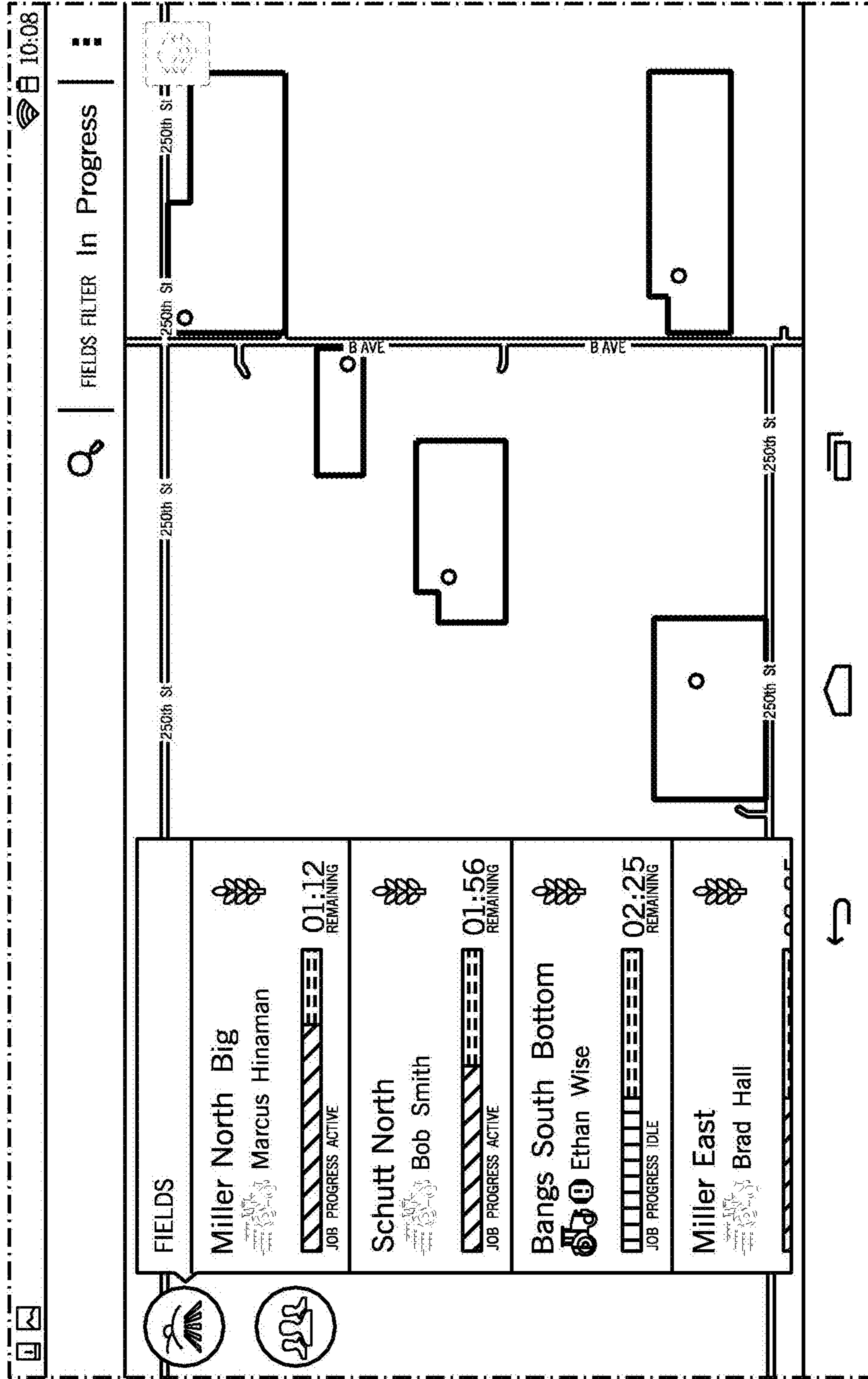

FIG. 3

