

US00D764359S

(12) **United States Design Patent** (10) **Patent No.:** **US D764,359 S**
Conner et al. (45) **Date of Patent:** **** Aug. 23, 2016**

- (54) **STEERING KNUCKLE FOR A DRIVING APPARATUS**
- (71) Applicants: **Hitachi Metals America, Ltd.**, Novi, MI (US); **Hitachi Metals, Ltd.**, Tokyo (JP)
- (72) Inventors: **Aaron Conner**, Novi, MI (US); **Rick Bowen**, Novi, MI (US); **Ronald Walker**, Novi, MI (US)
- (73) Assignees: **HITACHI METALS AMERICA, LTD.**, Novi, MI (US); **HITACHI METALS, LTD.**, Tokyo (JP)

8,297,632 B2	10/2012	Webster et al.	
D686,952 S	7/2013	Rau et al.	
8,794,647 B2	8/2014	Moessinger	
2006/0110213 A1 *	5/2006	Wolf	B60G 7/008 403/134
2013/0181421 A1	7/2013	Rohde et al.	
2015/0251695 A1 *	9/2015	Burgess	B62D 7/16 403/343

(**) Term: **14 Years**

(21) Appl. No.: **29/503,922**

FOREIGN PATENT DOCUMENTS

CN	302660191 S	11/2013	
IN	2012MU00844	3/2013	
JP	2001-114127 A	4/2001	
JP	2001-187583 A	7/2001	
JP	1358555 S	5/2009	
JP	1447400 S	7/2012	
JP	2014-91469 A	5/2014	
WO	WO 97/13674	4/1997	
WO	WO 9713674 A1 *	4/1997	B62D 7/18

- (22) Filed: **Sep. 30, 2014**
- (51) **LOC (10) Cl.** **12-16**
- (52) **U.S. Cl.**
USPC **D12/159**
- (58) **Field of Classification Search**
USPC D12/159
CPC F16C 11/0671; F16C 11/00; F16C 11/06;
F16C 2326/24; F16F 9/3242; F16F 9/0218;
F16F 9/0227; F16F 9/3221; F16F 9/3235;
Y10T 16/62; Y10T 16/281
See application file for complete search history.

OTHER PUBLICATIONS

United States Office Action dated Feb. 12, 2016 in co-pending U.S. Appl. No. 14/532,564.

United States Office Action dated Feb. 12, 2016 in co-pending U.S. Appl. No. 14/876,367.

United States Office Action dated Dec. 21, 2015 in co-pending U.S. Appl. No. 29/503,930.

International Search Report in PCT/US2015/059017 dated Jan. 13, 2016.

Written Opinion of the International Searching Authority in PCT/US2015/059017.

United States Notice of Allowance dated Dec. 28, 2015 in co-pending U.S. Appl. No. 29/503,927.

(56) **References Cited**

U.S. PATENT DOCUMENTS

3,749,415 A *	7/1973	Sampatacos	B06G 7/005 280/124.136
4,618,159 A *	10/1986	Kozyra	B60T 1/065 180/253
4,722,540 A *	2/1988	Kozyra	B60T 1/065 180/253
5,022,673 A	6/1991	Sekino et al.	
5,120,150 A	6/1992	Kozyra et al.	
5,366,233 A	11/1994	Kozyra et al.	
6,179,308 B1	1/2001	Mielauskas et al.	
6,739,422 B2	5/2004	Krude et al.	
D612,304 S	3/2010	Mahnig et al.	

* cited by examiner

Primary Examiner — Michael A Pratt
(74) *Attorney, Agent, or Firm* — McGinn IP Law Group PLLC

(57) **CLAIM**
The ornamental design for a steering knuckle for a driving apparatus, as shown and described.

DESCRIPTION

FIG. 1 is a front view of a steering knuckle comprising an opening hole (environment), a recess having an omega-like

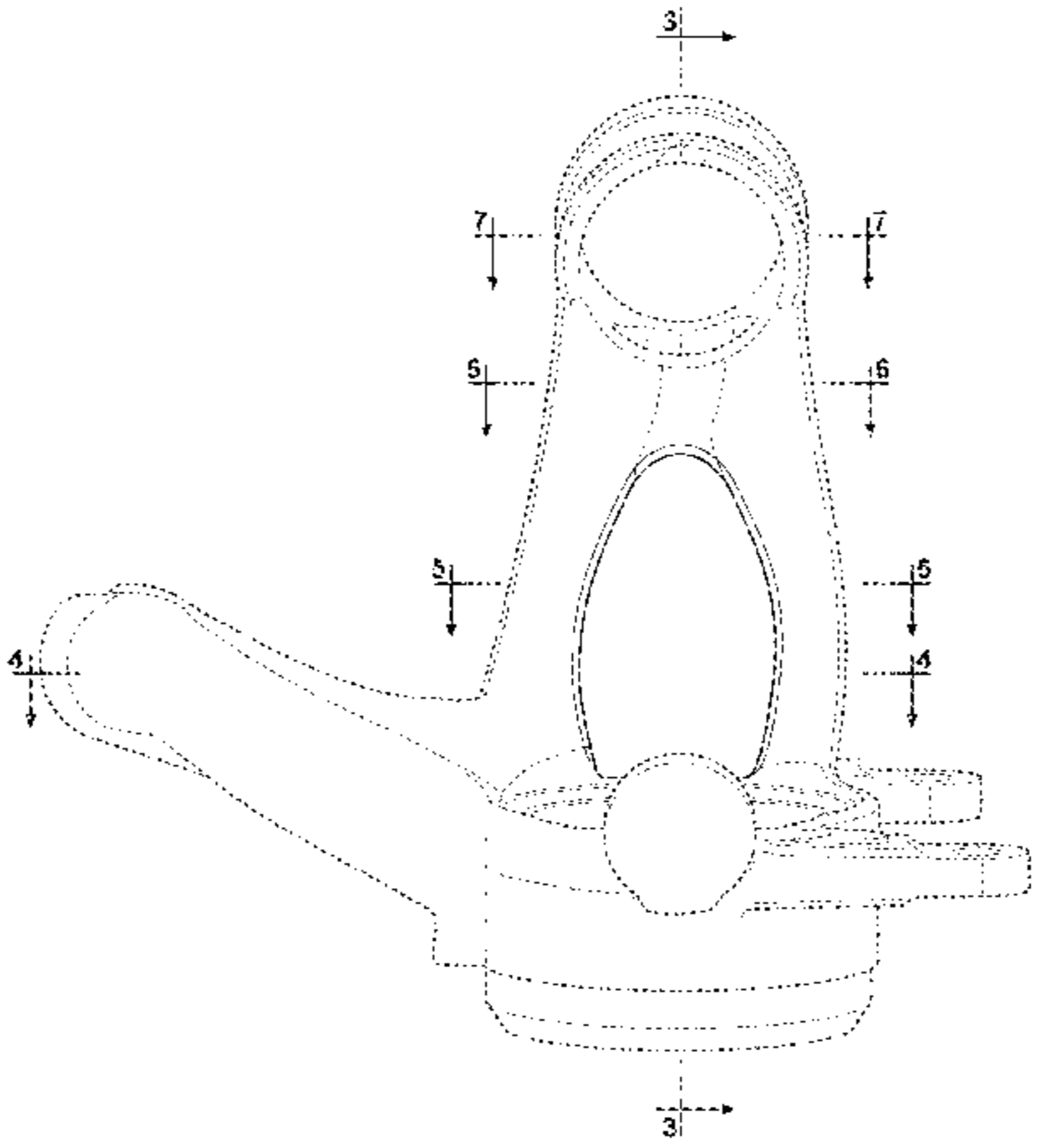

cross-section, and a beam connecting between the two (environment) as showing our new design;

FIG. 2 is a perspective view thereof;

FIG. 3 is an X-plane cross section view of a steering knuckle as showing our new design;

FIG. 4 is a first Y-plane cross section view of a steering knuckle as showing our new design;

FIG. 5 is a second Y-plane cross section view of a steering knuckle as showing our new design;

FIG. 6 is a third Y-plane cross section view of a steering knuckle as showing our new design;

FIG. 7 is an fourth Y-plane cross section view of a steering knuckle as showing our new design;

FIG. 8 is a first Z-plane cross section view of a steering knuckle as showing our new design;

FIG. 9 is a second Z-plane cross section view of a steering knuckle as showing our new design;

FIG. 10 is a third Z-plane cross section view of a steering knuckle as showing our new design;

FIG. 11 is a front view of a second embodiment of the steering knuckle;

FIG. 12 is a perspective view of the second embodiment of the steering knuckle;

FIG. 13 is a front view of a third embodiment of the steering knuckle;

FIG. 14 is a perspective view of the third embodiment of the steering knuckle;

FIG. 15 is a front view of a fourth embodiment of the steering knuckle;

FIG. 16 is a perspective view of the fourth embodiment of the steering knuckle;

FIG. 17 is a front view of a fifth embodiment of the steering knuckle; and,

FIG. 18 is a perspective view of the fifth embodiment of the steering knuckle.

The broken line showing of portions of the steering knuckle forms no part of the claimed design.

1 Claim, 18 Drawing Sheets

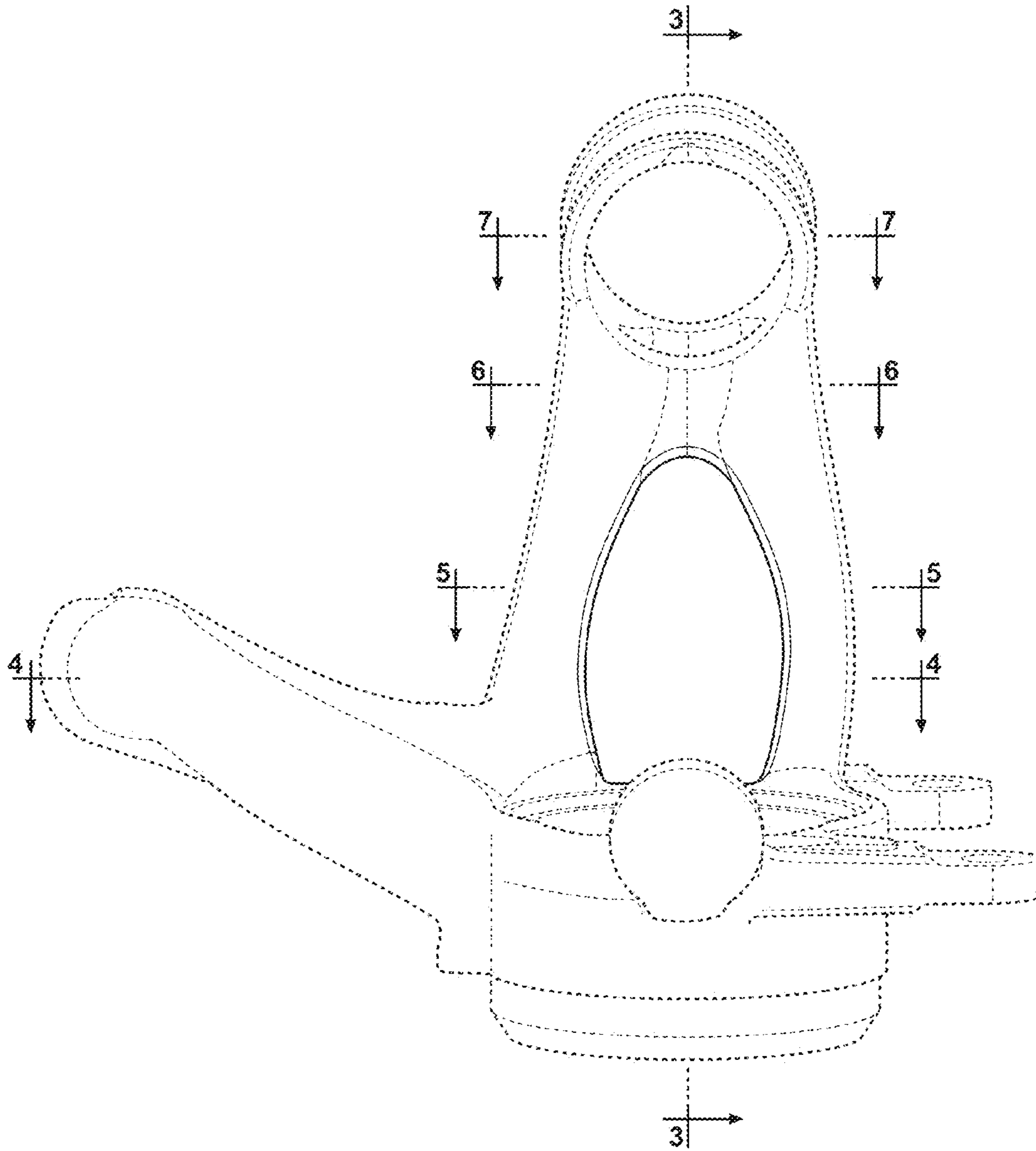

FIG. 1

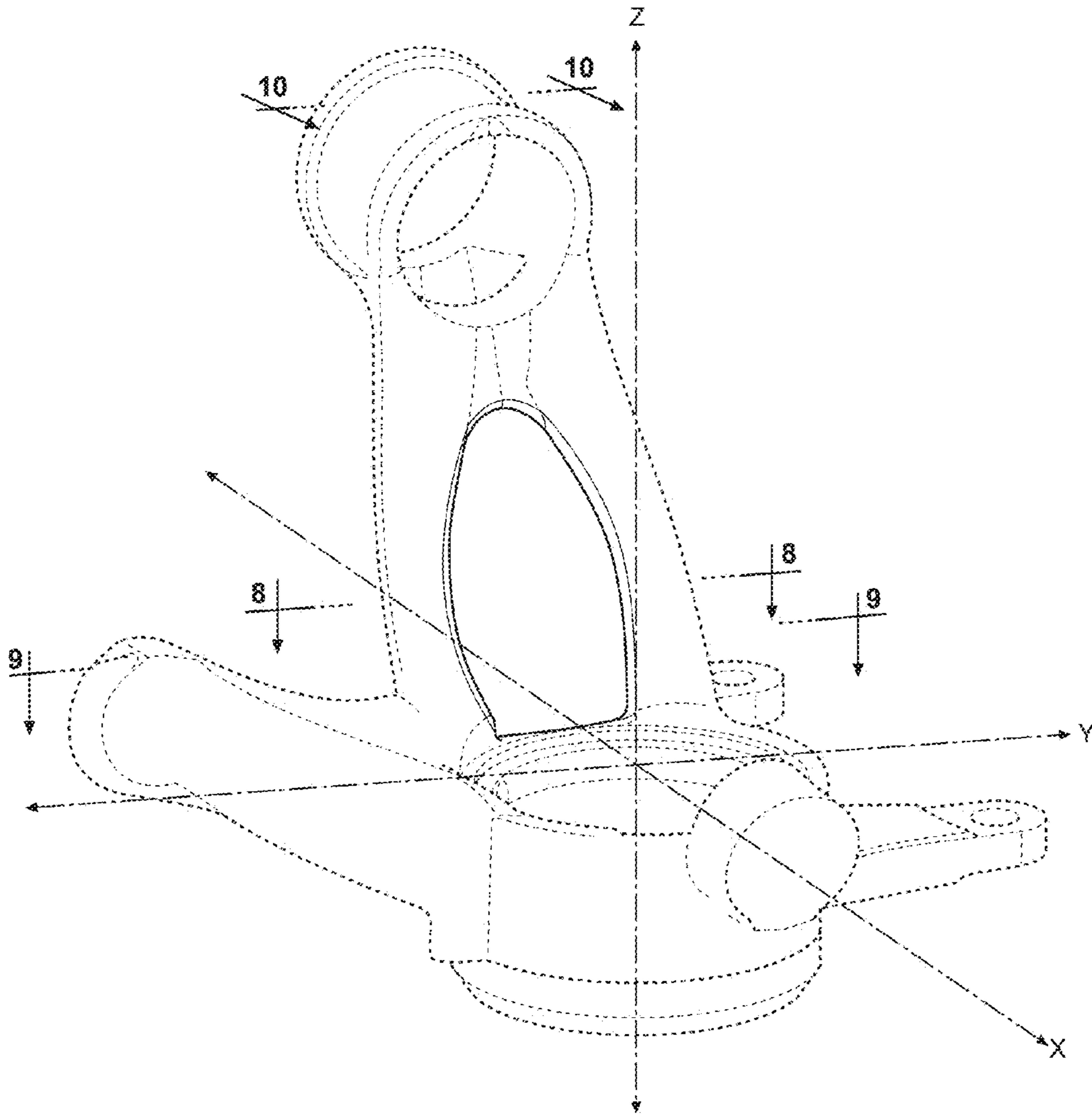

FIG. 2

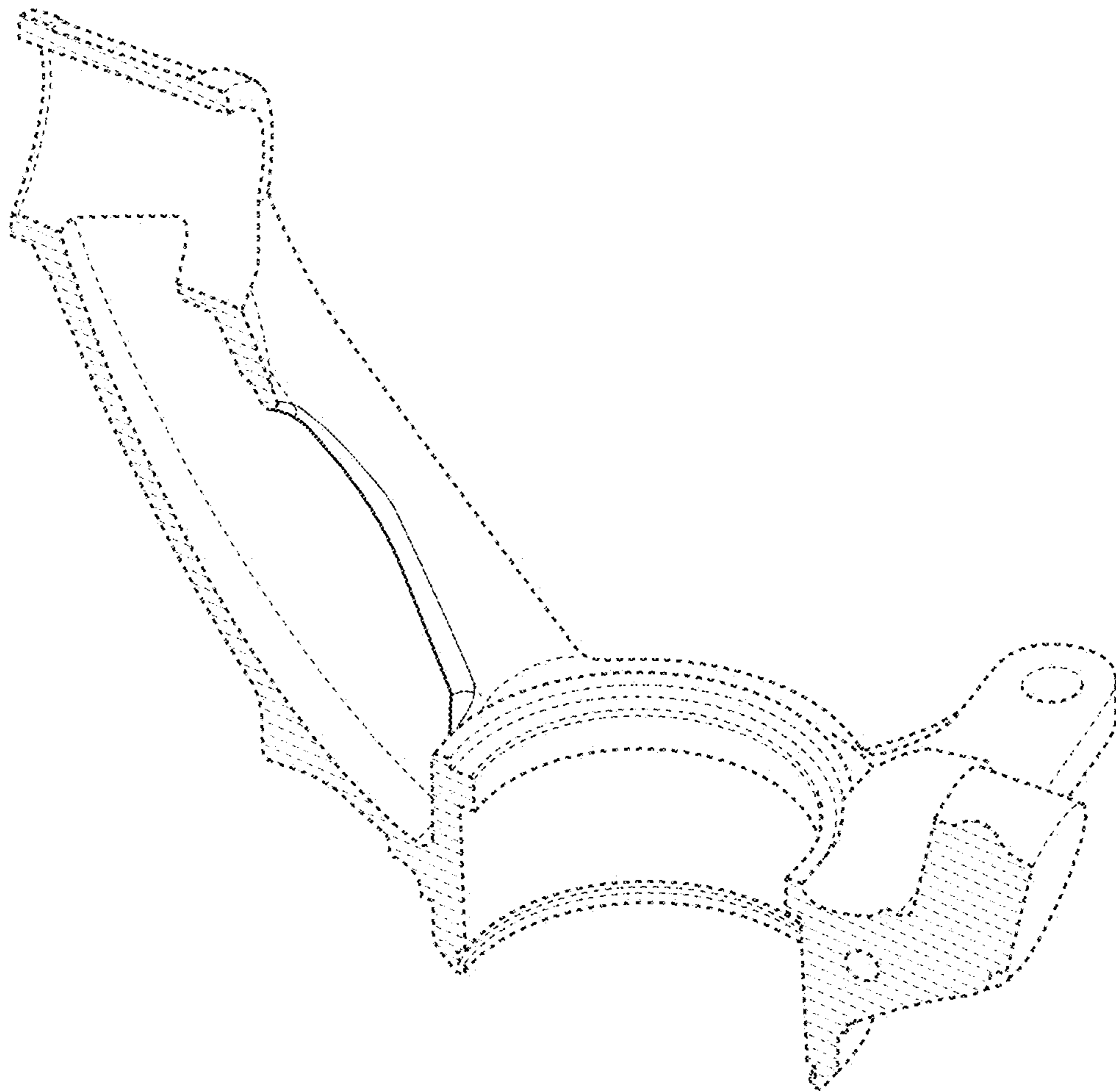

FIG. 3

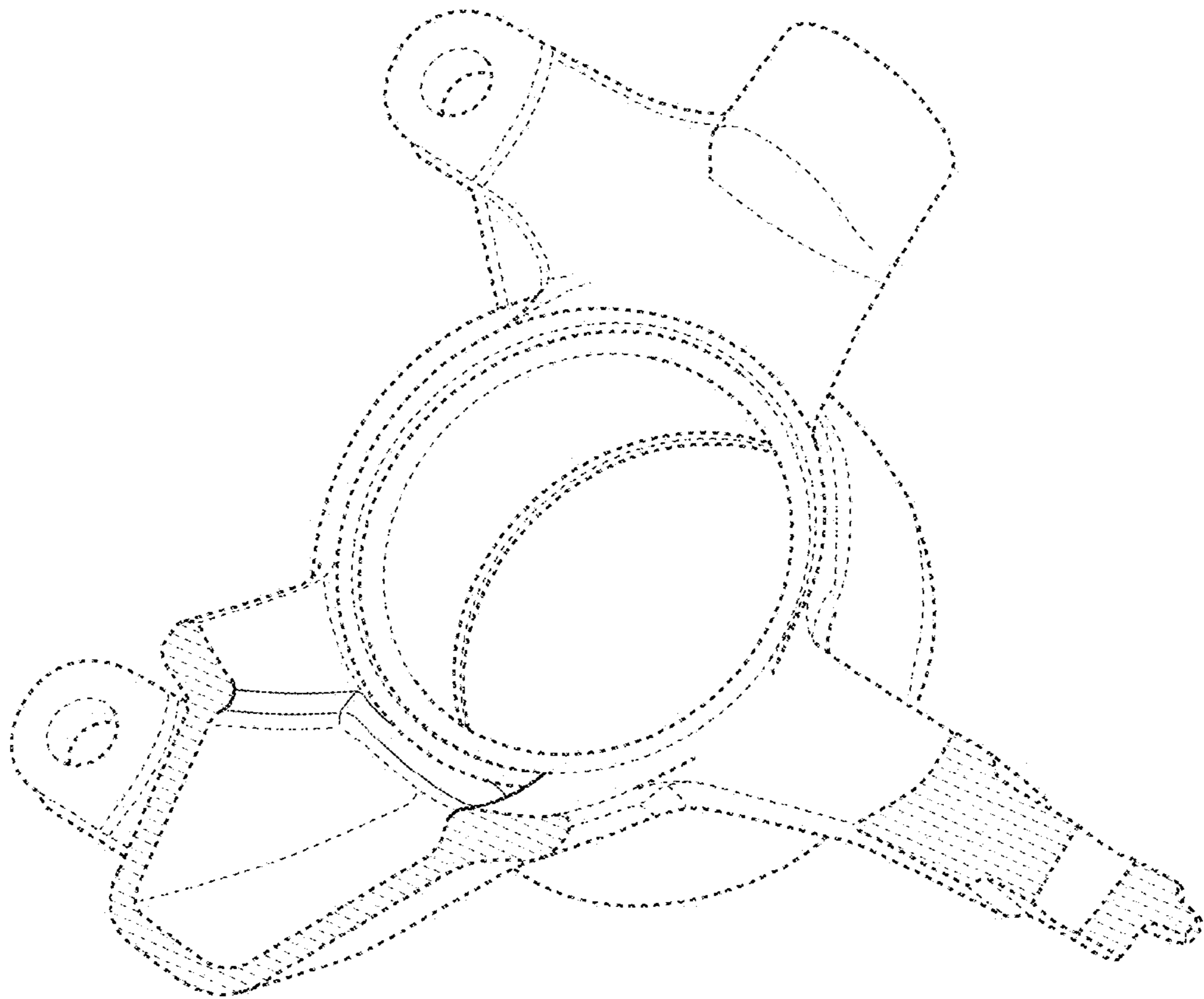

FIG. 4

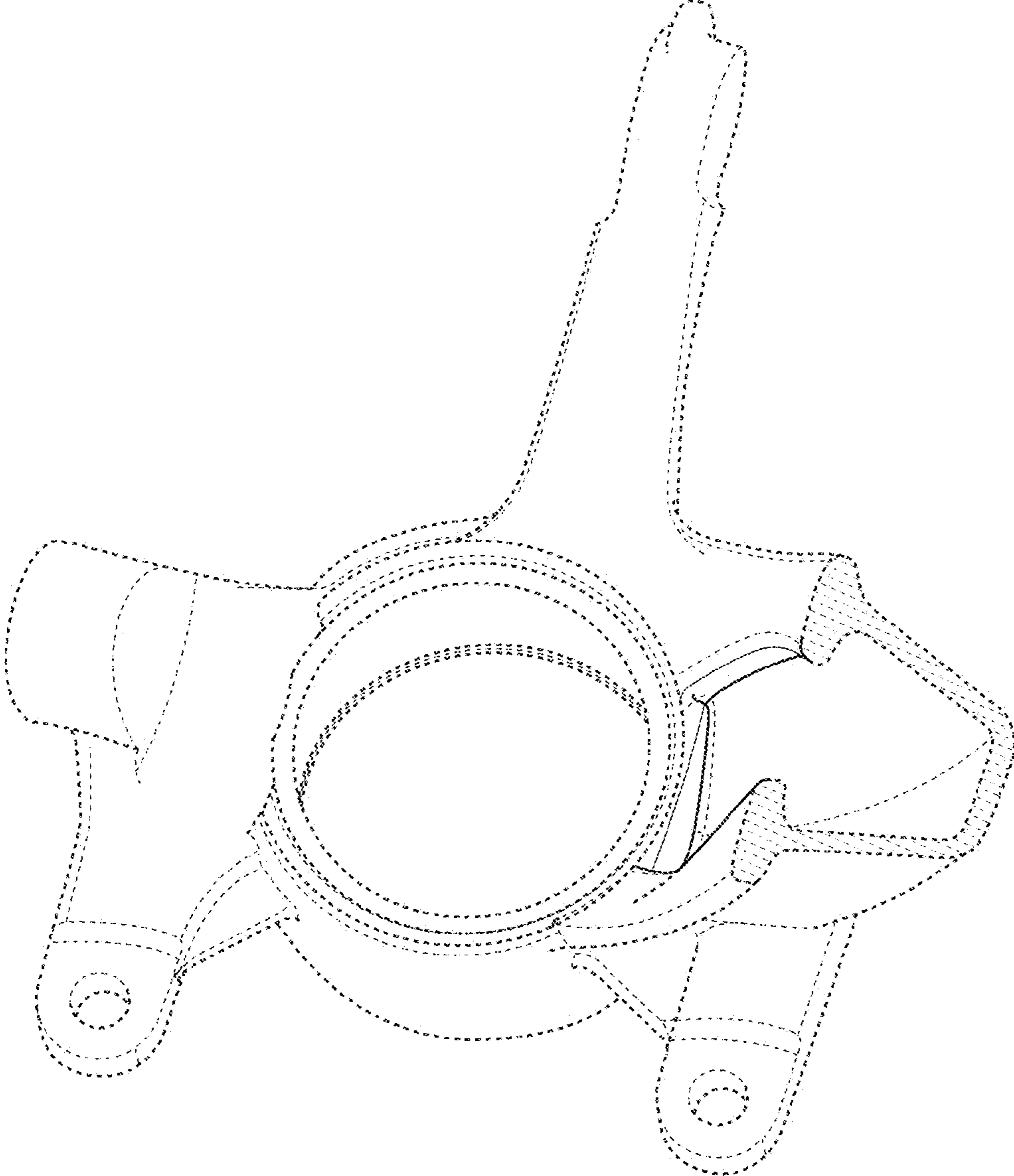

FIG. 5

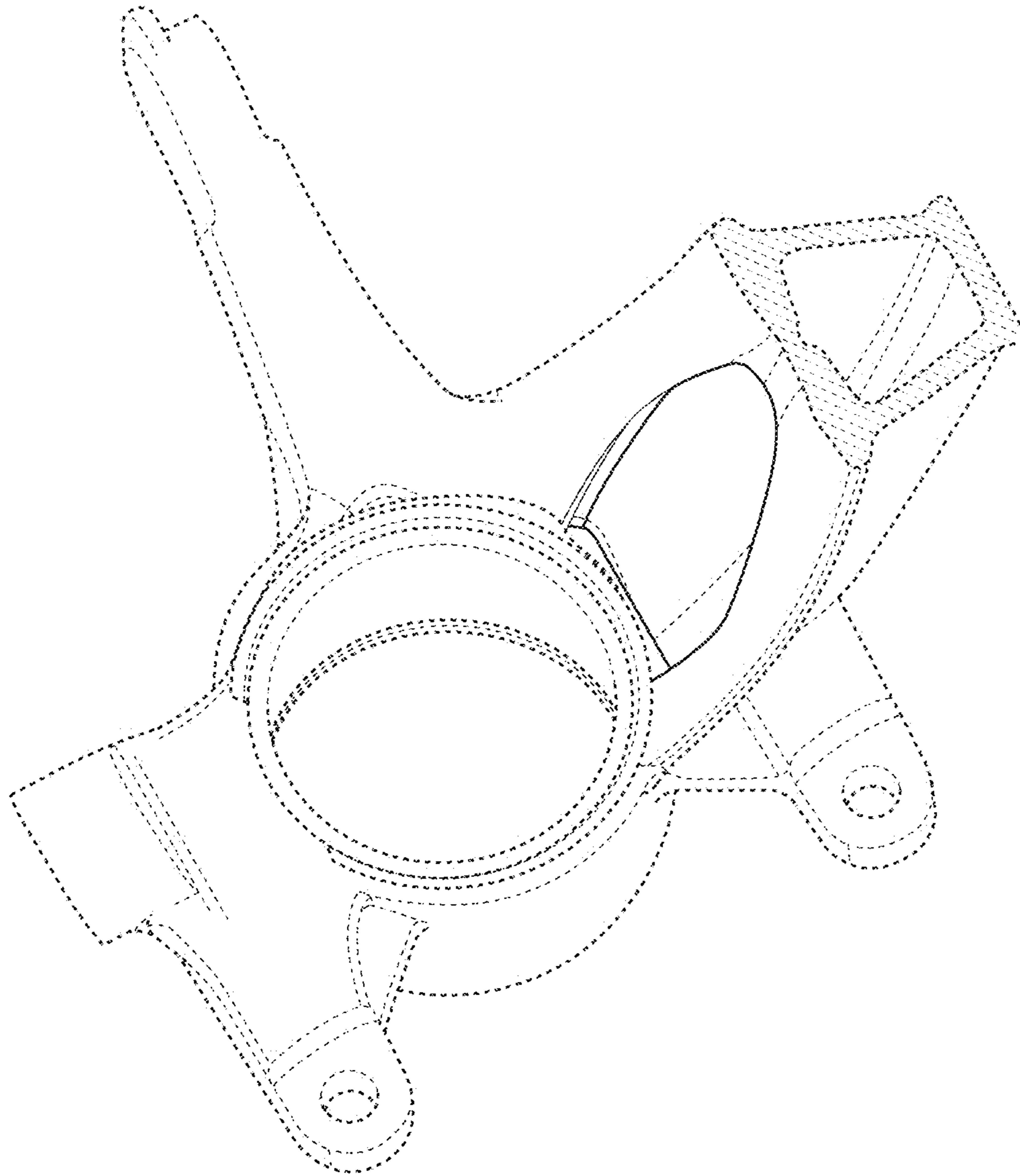

FIG. 6

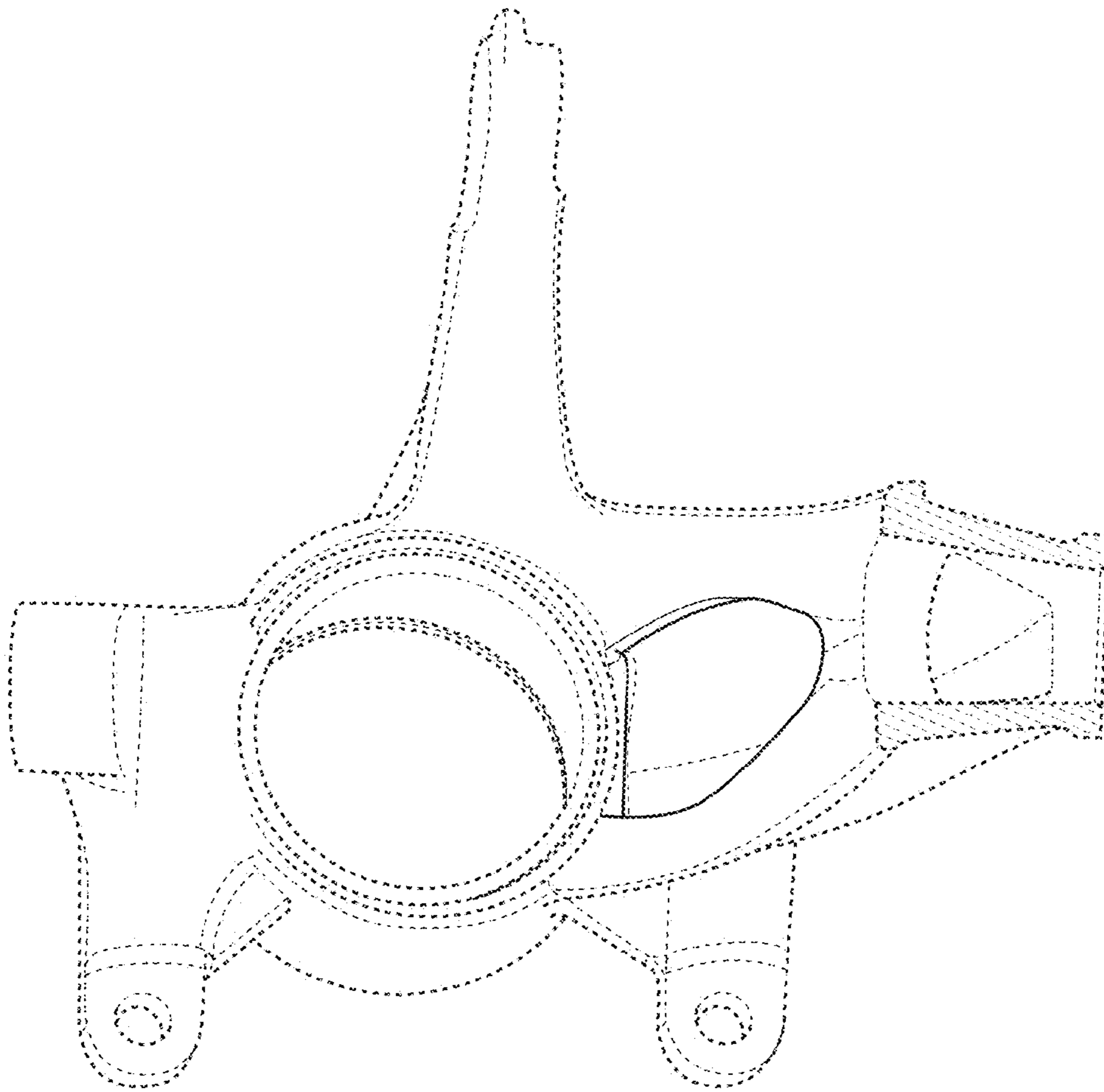

FIG. 7

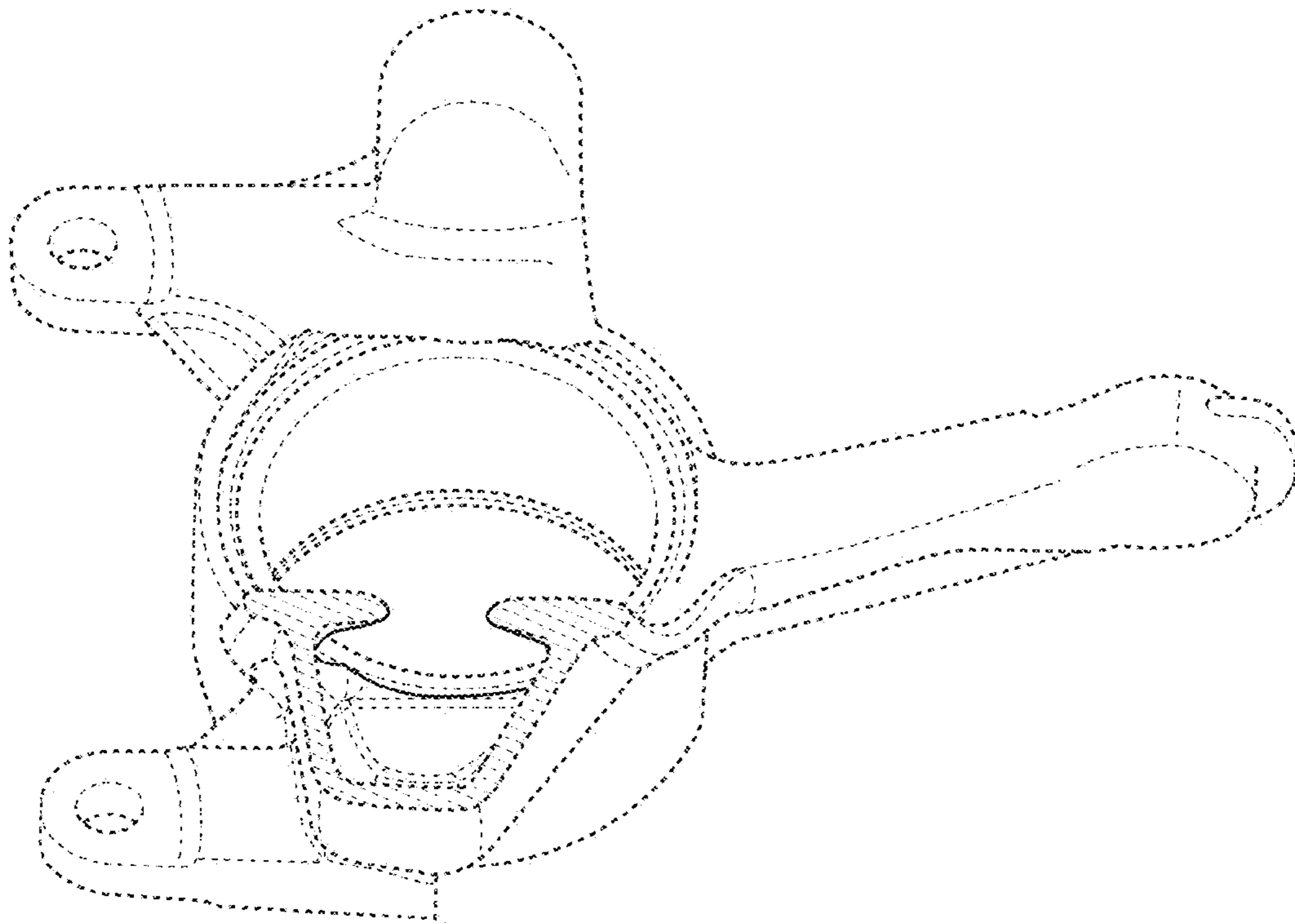

FIG. 8

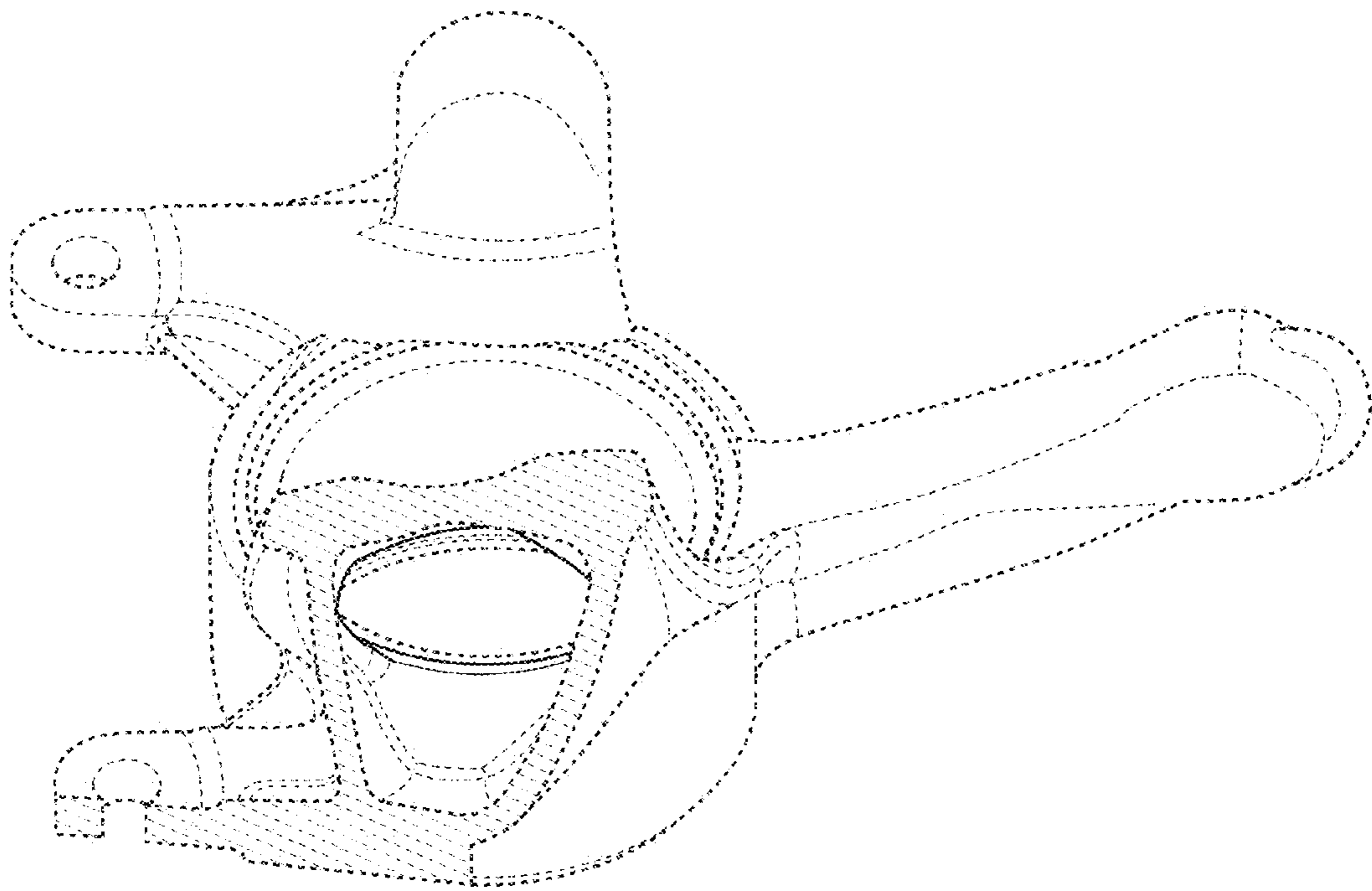

FIG. 9

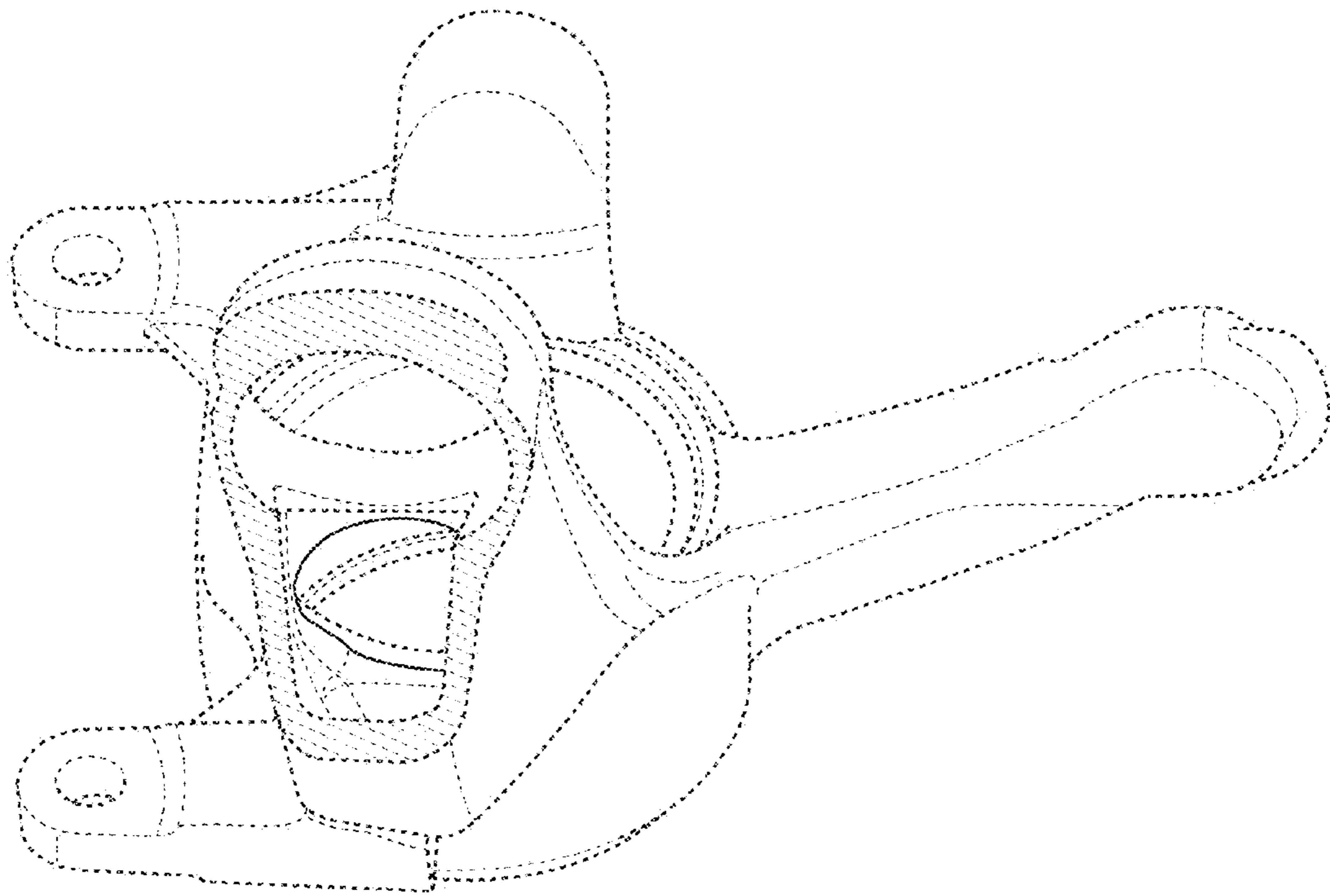

FIG. 10

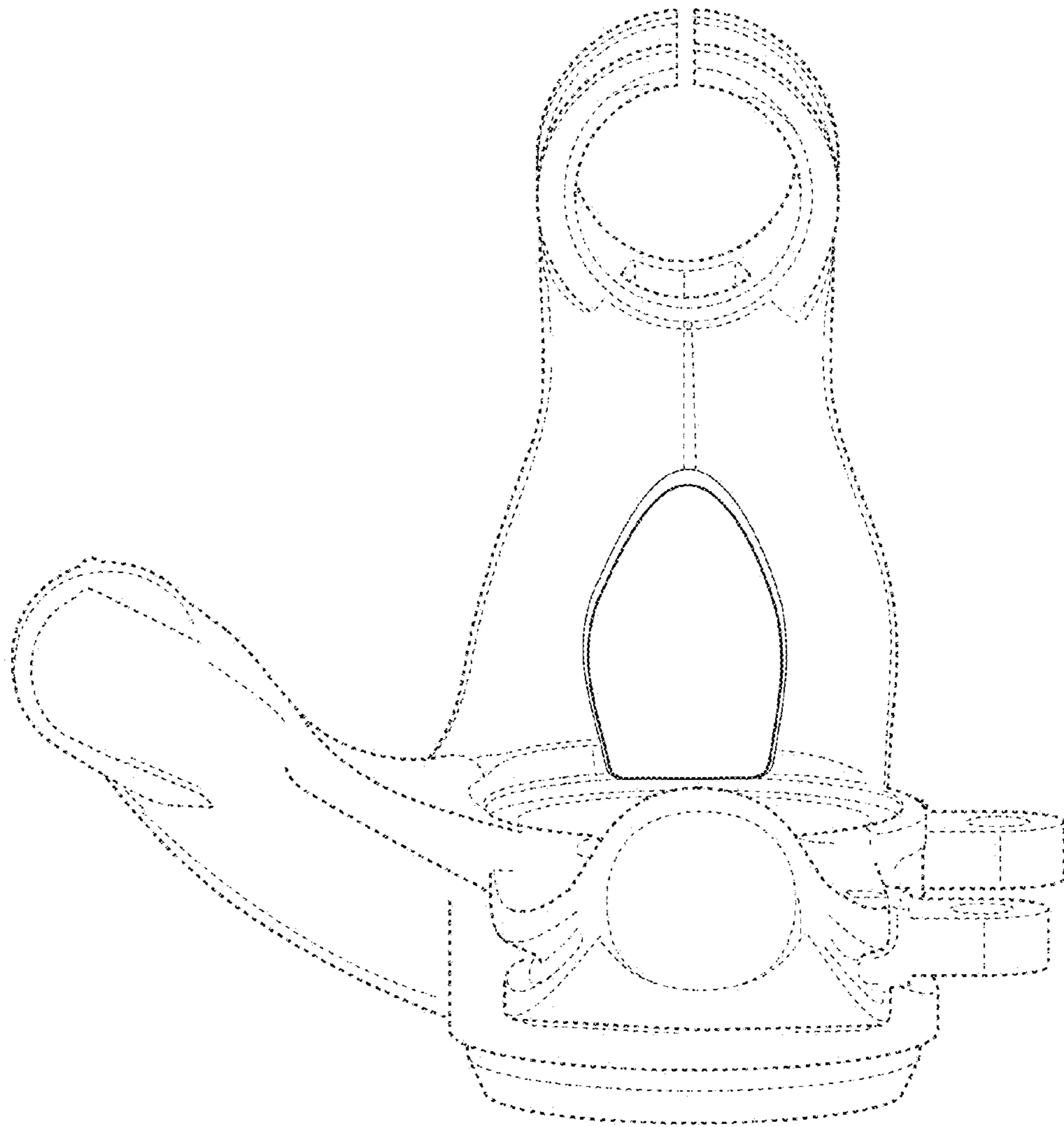

FIG. 11

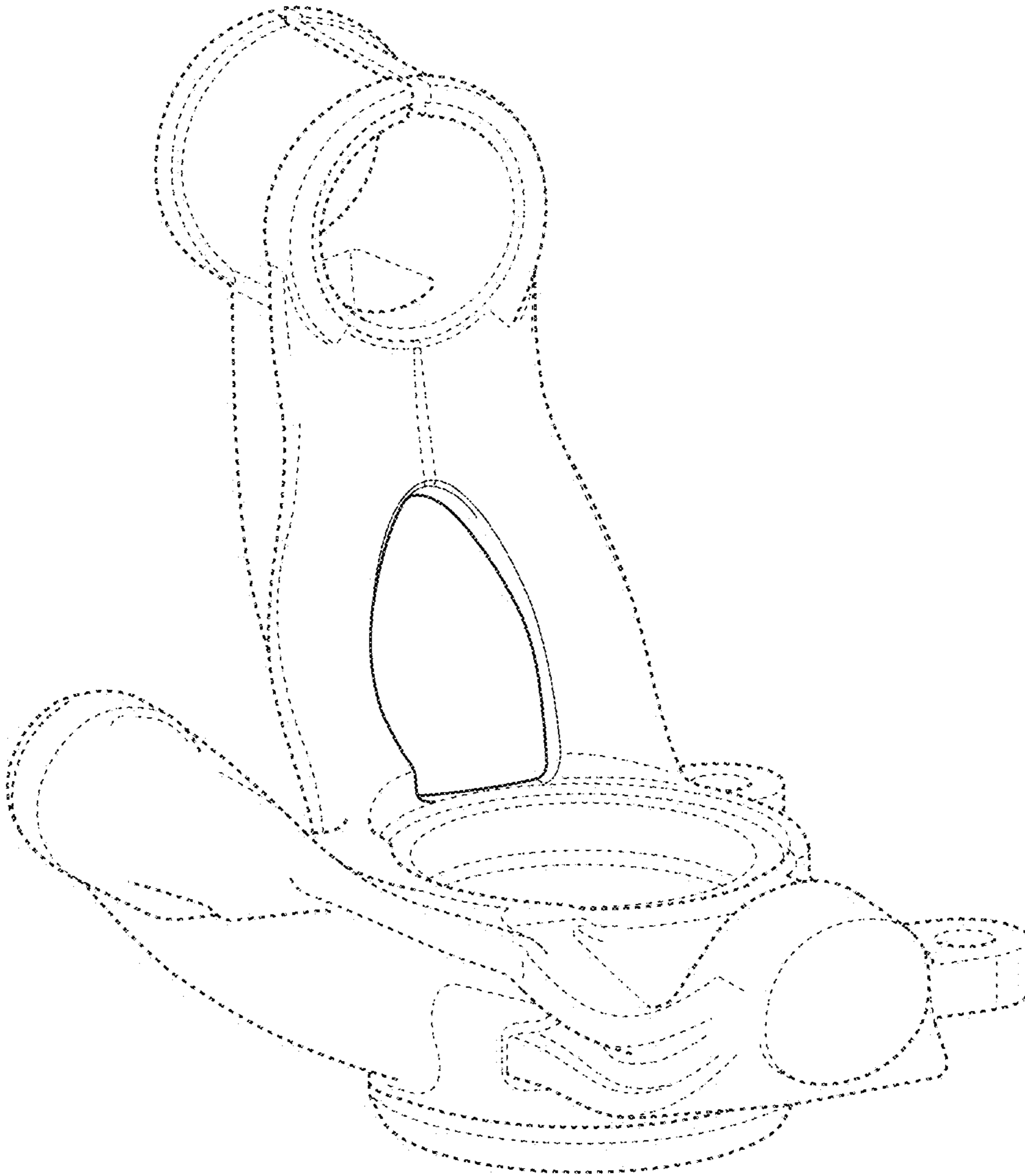

FIG. 12

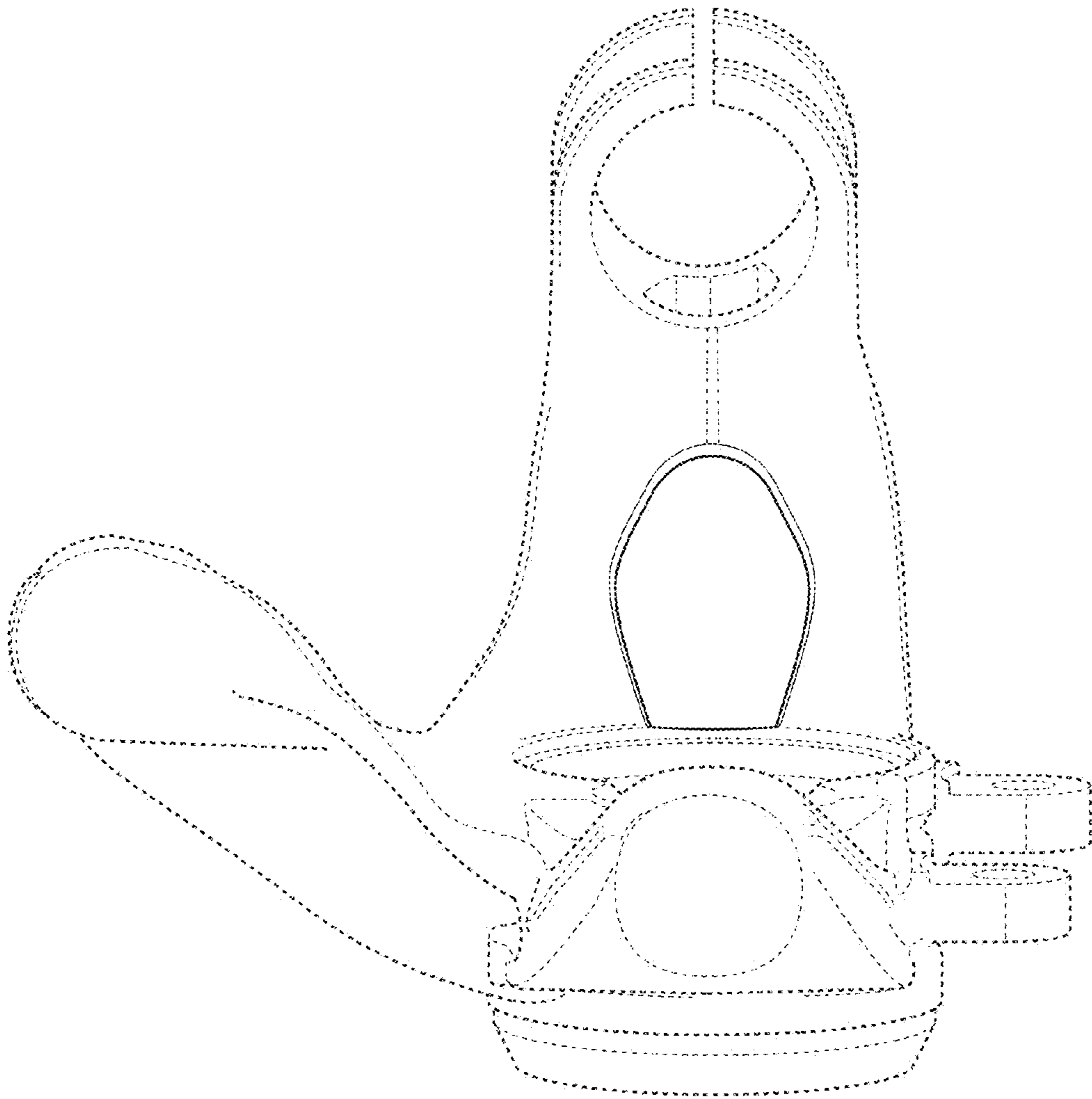

FIG. 13

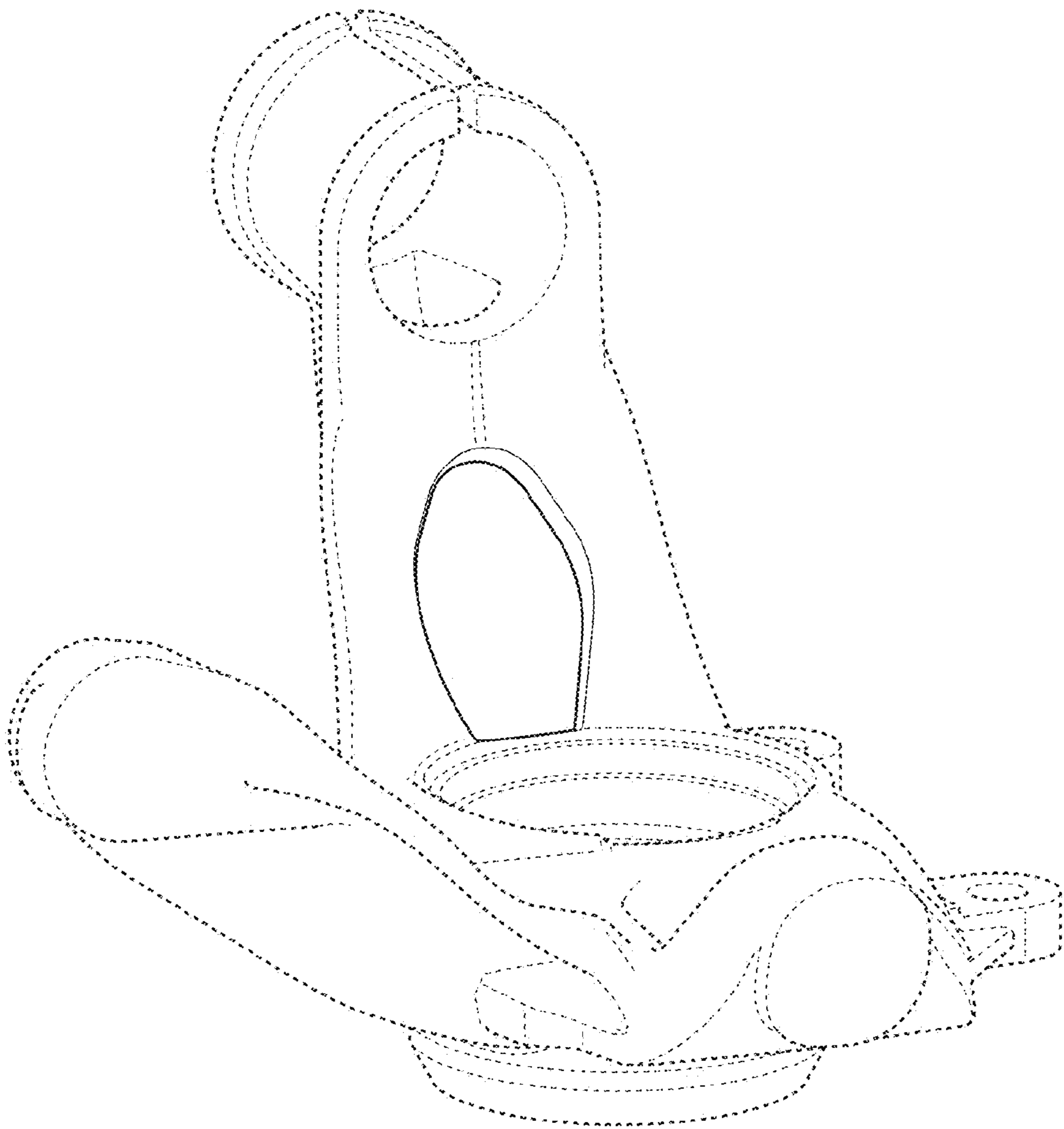

FIG. 14

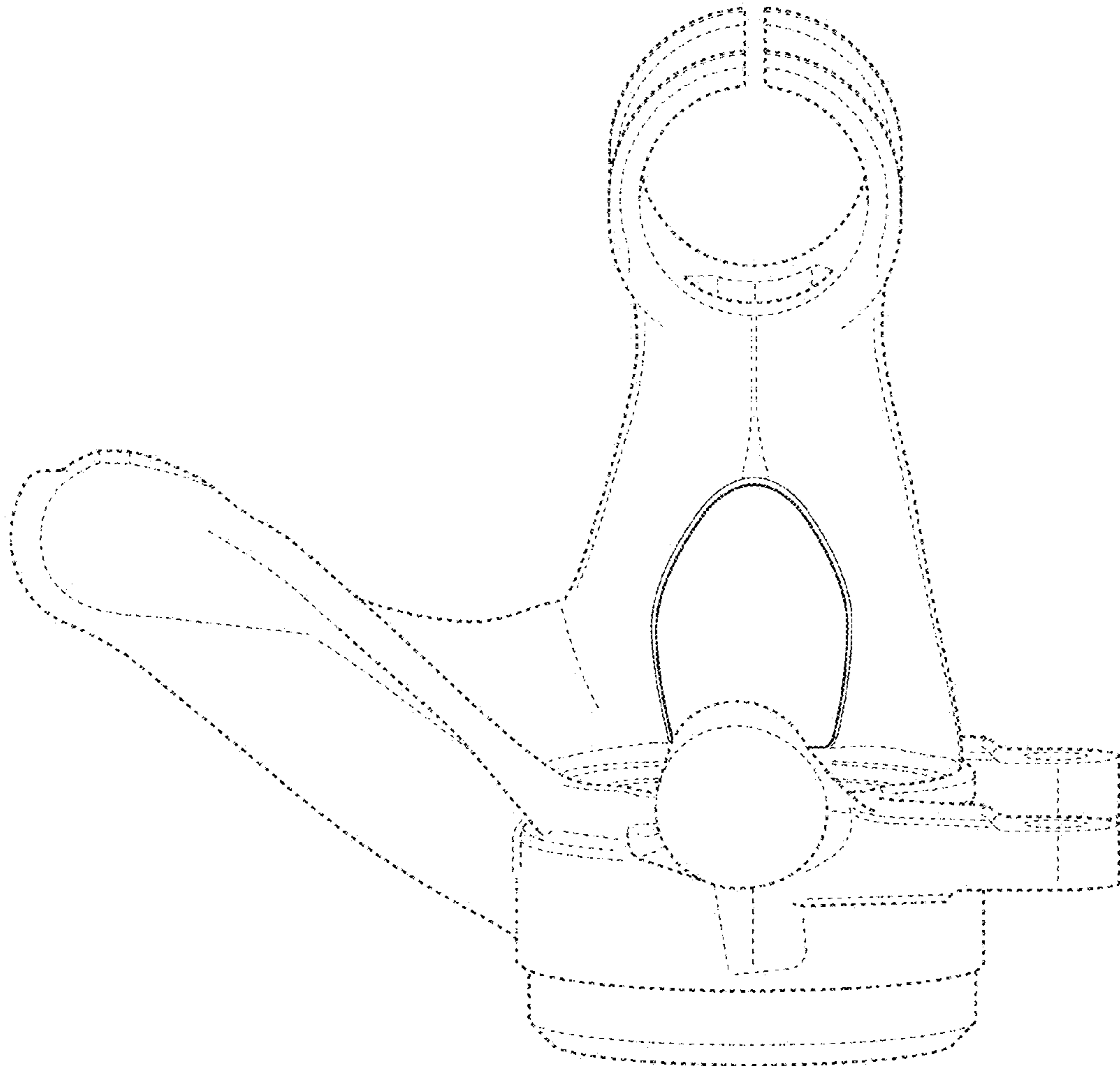

FIG. 15

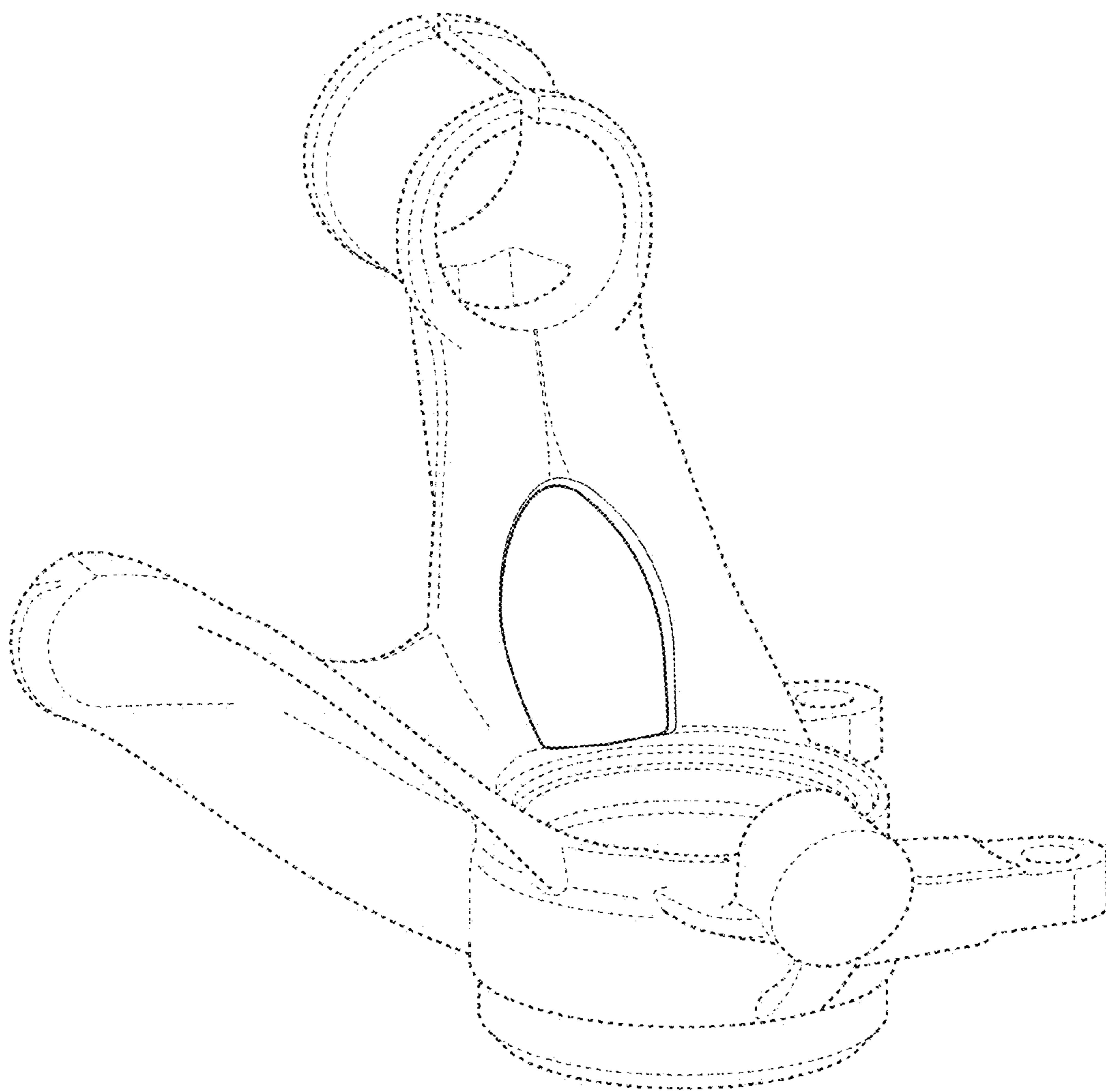

FIG. 16

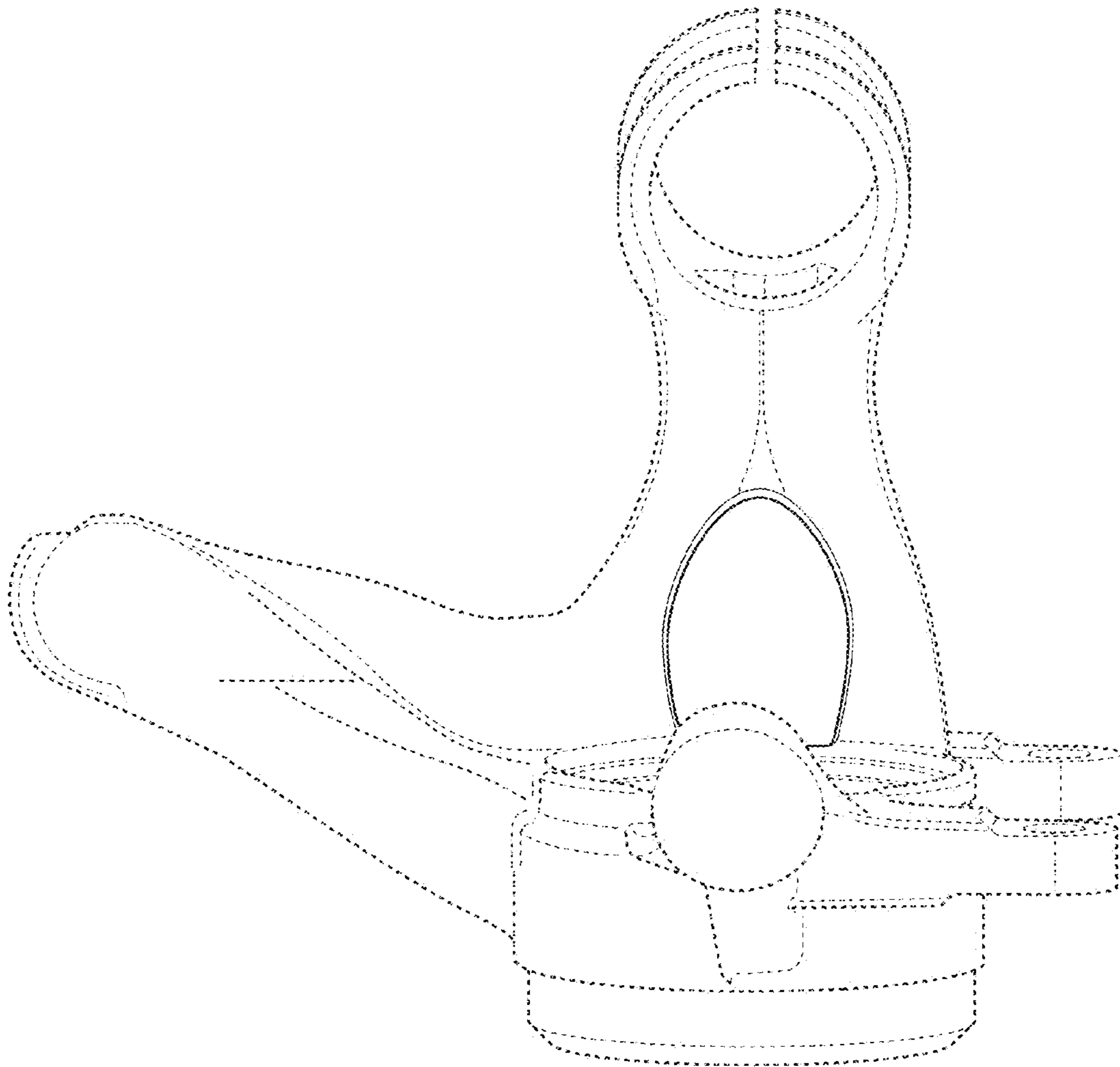

FIG. 17

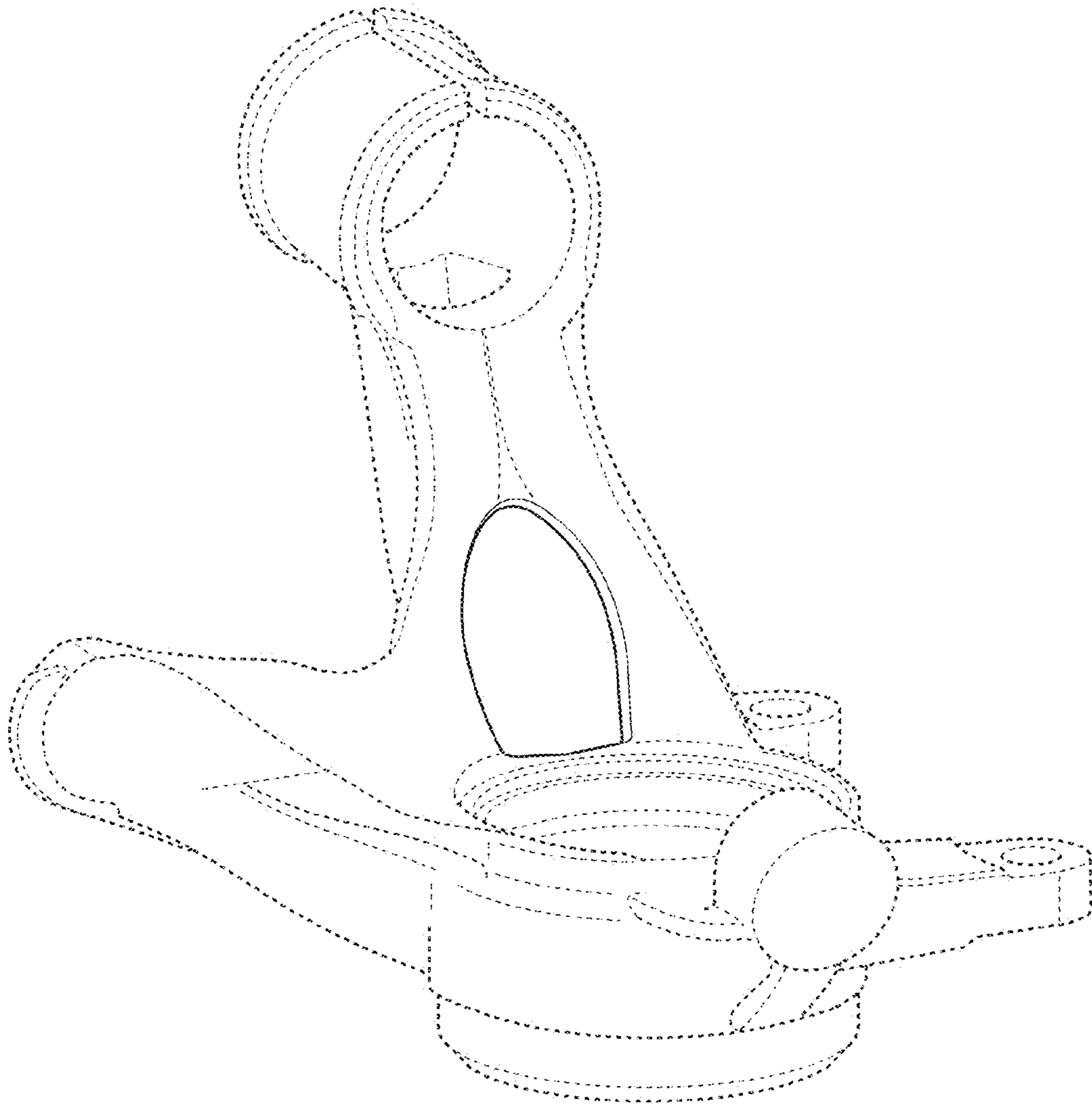

FIG. 18