



US00D758512S

(12) **United States Design Patent**
Su

(10) **Patent No.:** **US D758,512 S**
(45) **Date of Patent:** **** Jun. 7, 2016**

- (54) **TOY BAT**
- (71) Applicant: **TAIWAN JOCA CORP.**, Taipei (TW)
- (72) Inventor: **Tsang-Sheng Su**, Taipei (TW)
- (73) Assignee: **TAIWAN JOCA CORP.**, Taipei (TW)
- (**) Term: **14 Years**
- (21) Appl. No.: **29/525,872**
- (22) Filed: **May 4, 2015**
- (51) **LOC (10) Cl.** **21-02**
- (52) **U.S. Cl.**
USPC **D21/725; D21/398**
- (58) **Field of Classification Search**
USPC **D21/725, 398**
CPC **A63B 60/38; A63B 47/002; A63B 59/50;**
A63B 59/00
See application file for complete search history.

- D590,900 S * 4/2009 Sass D21/725
- D594,515 S * 6/2009 Giblin D21/725
- D668,307 S * 10/2012 Grimm D21/725
- 2006/0252586 A1 * 11/2006 Nguyen **A63B 59/50**
473/564

* cited by examiner

Primary Examiner — Mitchell Siegel

(74) *Attorney, Agent, or Firm* — Kirton McConkie; Evan R. Witt

(57) **CLAIM**

The ornamental design for a toy bat, as shown and described.

DESCRIPTION

FIG. 1 is a front perspective view of a toy bat showing my new design;

FIG. 2 is a front elevational view thereof;

FIG. 3 is a rear elevational view thereof;

FIG. 4 is a left side elevational view thereof;

FIG. 5 is a right side elevational view thereof;

FIG. 6 is a top plan view thereof; and,

FIG. 7 is a bottom plan view thereof.

The broken lines are for the purpose of illustrating holes in balls used with the toy bat and form no part of the claimed design.

The parallel diagonal lines shown in the head portion of the toy bat represent a transparent material.

1 Claim, 6 Drawing Sheets

(56) **References Cited**

U.S. PATENT DOCUMENTS

- 3,819,179 A * 6/1974 Ambler, Jr. A63B 60/38
124/26
- 4,521,015 A * 6/1985 Carafeno A63B 60/38
124/16
- 5,024,435 A * 6/1991 Robbins A63B 60/38
473/457
- 5,820,438 A * 10/1998 Horton, III A63B 59/00
446/213
- D448,056 S * 9/2001 Duffy D21/725

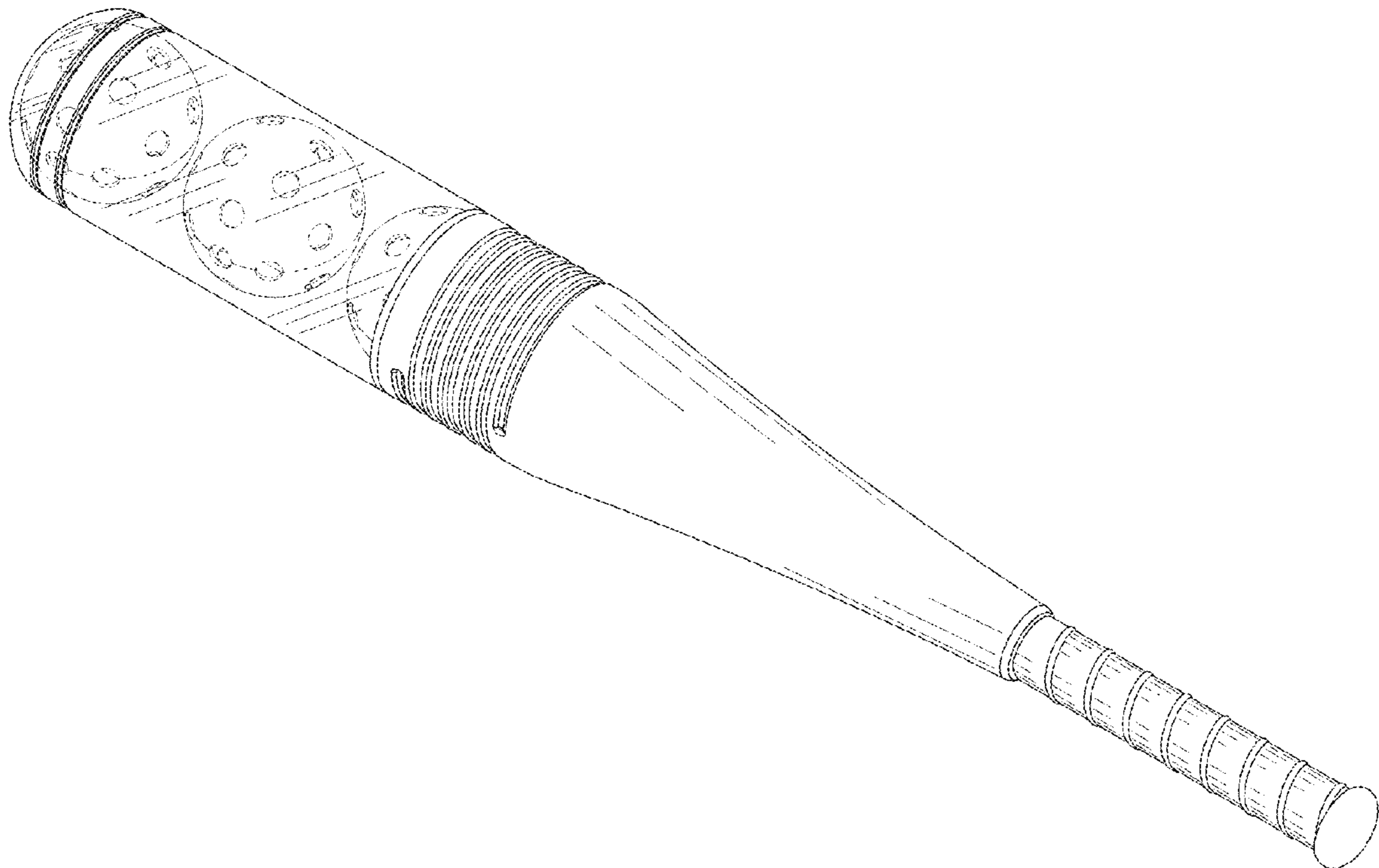

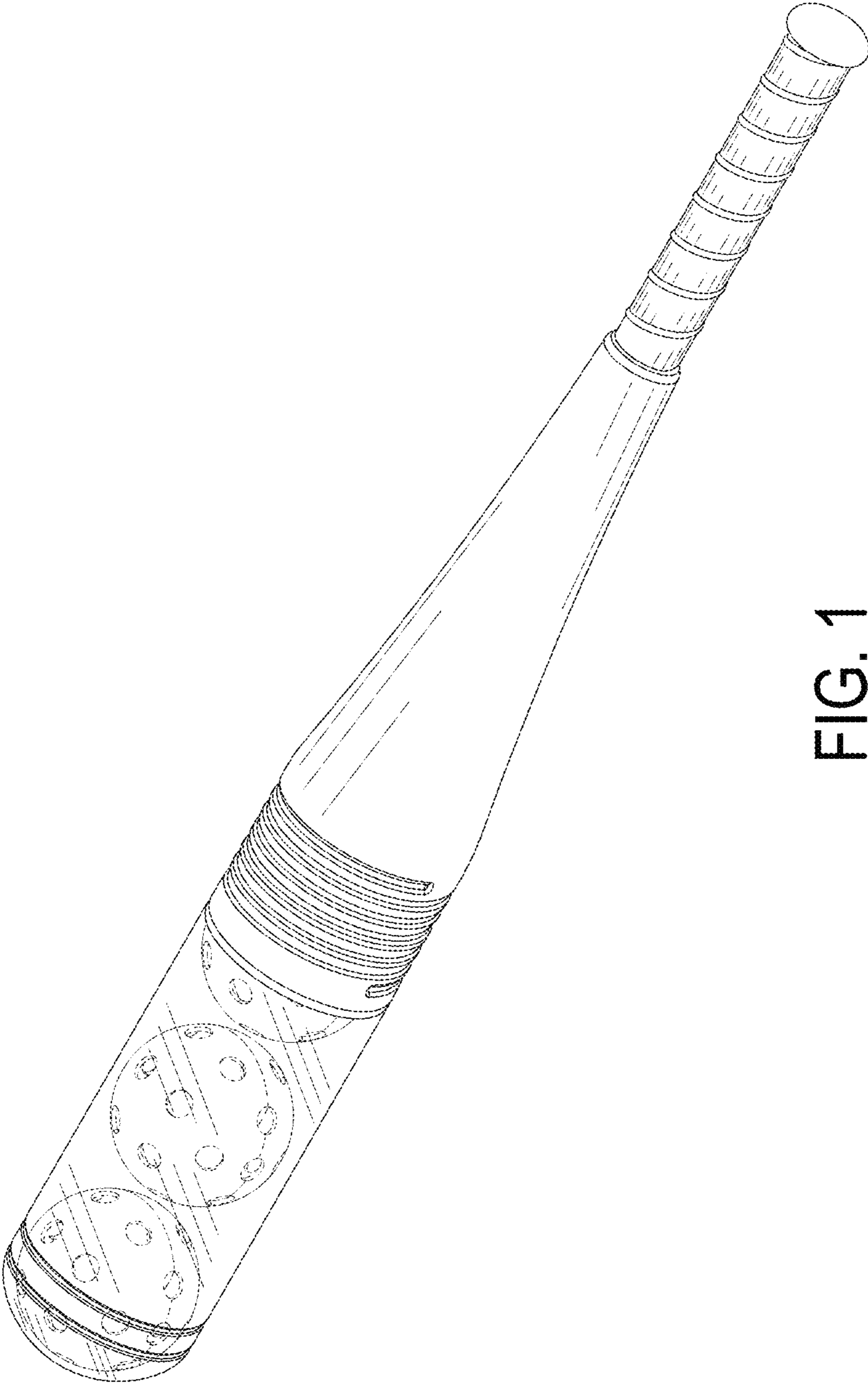

FIG. 1

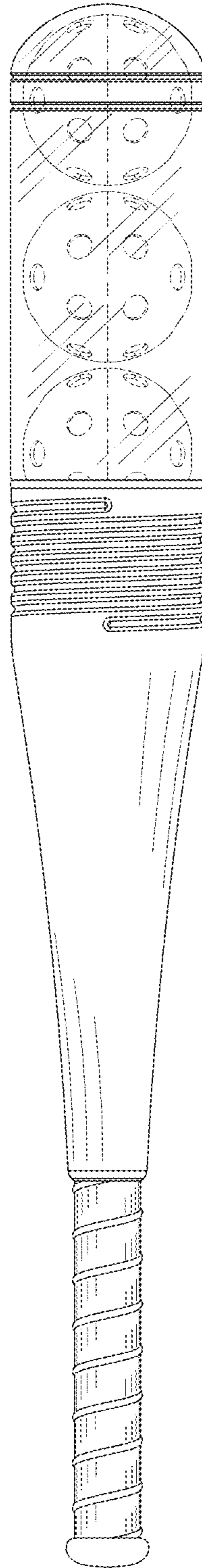

FIG. 2

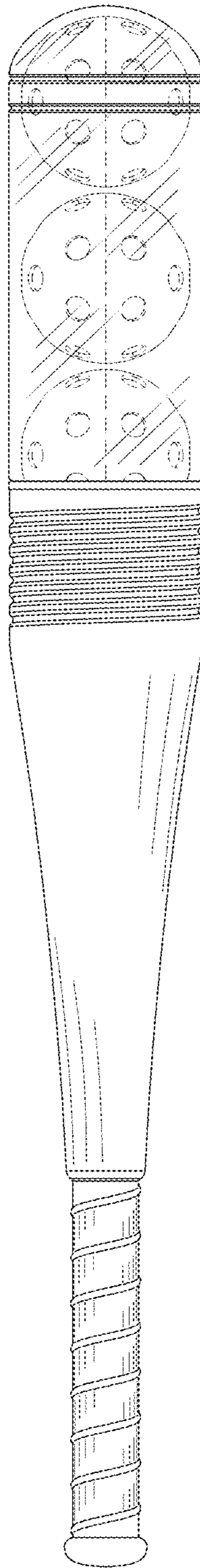

FIG. 3

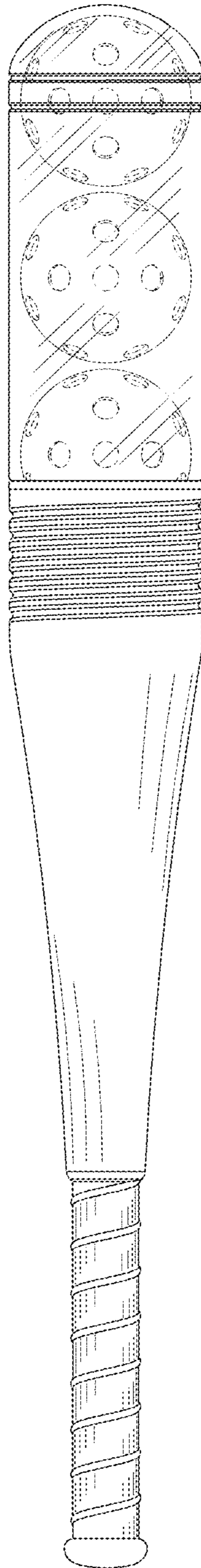

FIG. 4

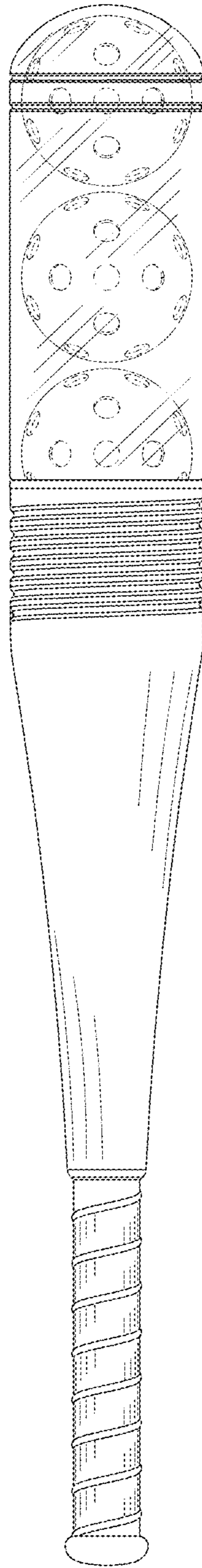

FIG. 5

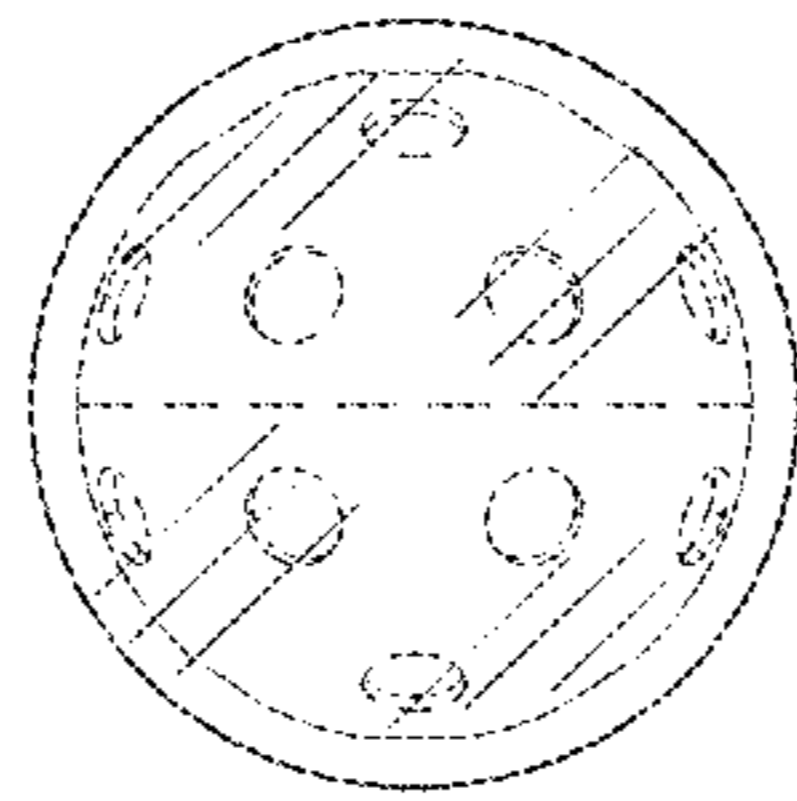

FIG. 6

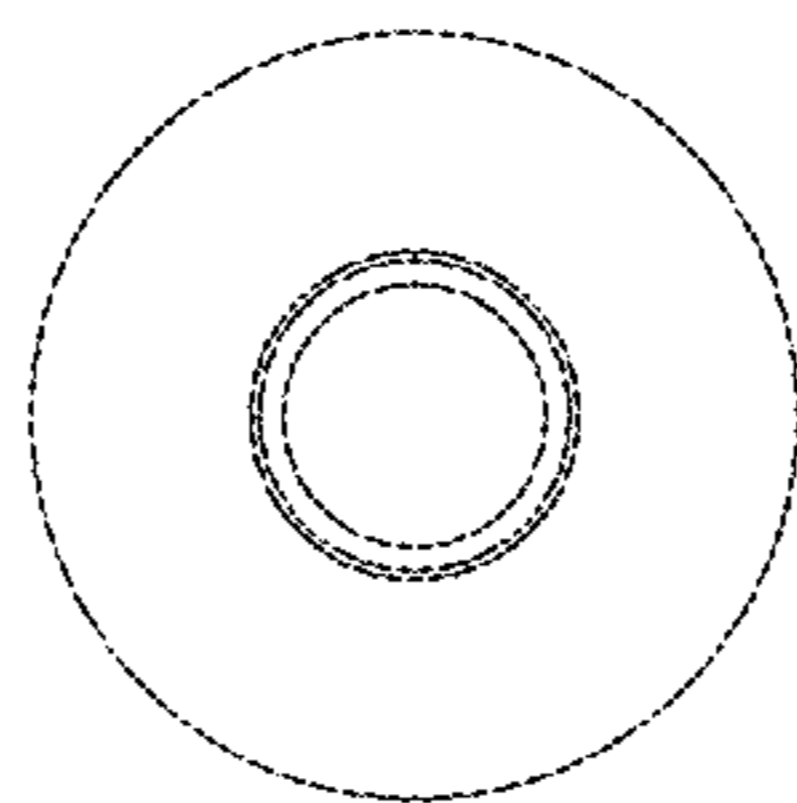

FIG. 7