



US00D758310S

(12) **United States Design Patent**
Veeh et al.

(10) **Patent No.:** **US D758,310 S**
(45) **Date of Patent:** **** Jun. 7, 2016**

(54) **ELECTRIC MOTOR**

(71) Applicant: **BAUMUELLER NUERNBERG GMBH**, Nuremberg (DE)

(72) Inventors: **Michael Veeh**, Kleinrinderfeld (DE);
Claus Oechsner, Schoenfeld (DE)

(73) Assignee: **Baum Mueller Nuernberg GmbH**,
Nuremberg (DE)

(**) Term: **14 Years**

(21) Appl. No.: **29/512,151**

(22) Filed: **Dec. 17, 2014**

(30) **Foreign Application Priority Data**

Jun. 17, 2014 (EP) EU1414437

(51) **LOC (10) Cl.** **13-01**

(52) **U.S. Cl.**
USPC **D13/112**

(58) **Field of Classification Search**
USPC D13/112, 101, 110, 113-118, 122, 123,
D13/154, 162, 164, 184, 199; D15/3, 5,
D15/199; 74/606 R, 609; 310/10, 40 MM,
310/40 R, 42, 51, 52, 58, 64, 71, 80, 83, 85,
310/88, 89, 91, 109, 236, 239, 254;
318/245, 255; 322/16, 39; 361/688,
361/704, 709; 29/596-598
CPC F02B 63/04; H02K 3/24; H02K 3/47
See application file for complete search history.

(56) **References Cited**

U.S. PATENT DOCUMENTS

D138,289 S * 7/1944 Lear D13/112
D244,204 S * 5/1977 Briggs et al. D13/112

4,807,354 A * 2/1989 Capuano et al. 29/596
D332,081 S * 12/1992 Sieber D13/112
D336,890 S * 6/1993 Hirose et al. D13/112
5,998,896 A * 12/1999 Early et al. 310/89
6,246,134 B1 * 6/2001 Berrong et al. 310/52
D568,811 S * 5/2008 Andersson et al. D13/114
D568,812 S * 5/2008 Andersson et al. D13/114
D573,091 S * 7/2008 Shih et al. D13/112
D578,063 S * 10/2008 Lannoch D13/112
D587,648 S * 3/2009 Lannoch D13/112
D601,958 S * 10/2009 Huan et al. D13/112
D678,194 S * 3/2013 Lannoch D13/112
D688,627 S * 8/2013 Veeh D13/112
D705,163 S * 5/2014 Lauper et al. D13/112
D712,354 S * 9/2014 Veeh et al. D13/112
D713,338 S * 9/2014 Lannoch et al. D13/112
9,091,322 B2 * 7/2015 Wang et al.

* cited by examiner

Primary Examiner — Derrick Holland

Assistant Examiner — Jennifer O King

(74) *Attorney, Agent, or Firm* — Laurence A. Greenberg;
Werner H. Stemer; Ralph E. Locher

(57) **CLAIM**

The ornamental design for an electric motor, as shown and described.

DESCRIPTION

FIG. 1 is a right side elevation view of an electric motor showing my new invention;
FIG. 2 is a top plan view thereof;
FIG. 3 is a bottom plan view thereof;
FIG. 4 is a rear elevation view thereof;
FIG. 5 is a left side elevation view thereof;
FIG. 6 is a front elevation view thereof; and,
FIG. 7 is a perspective view thereof.
The broken lines shown represent unclaimed subject matter and form no part of the claimed design.

1 Claim, 7 Drawing Sheets

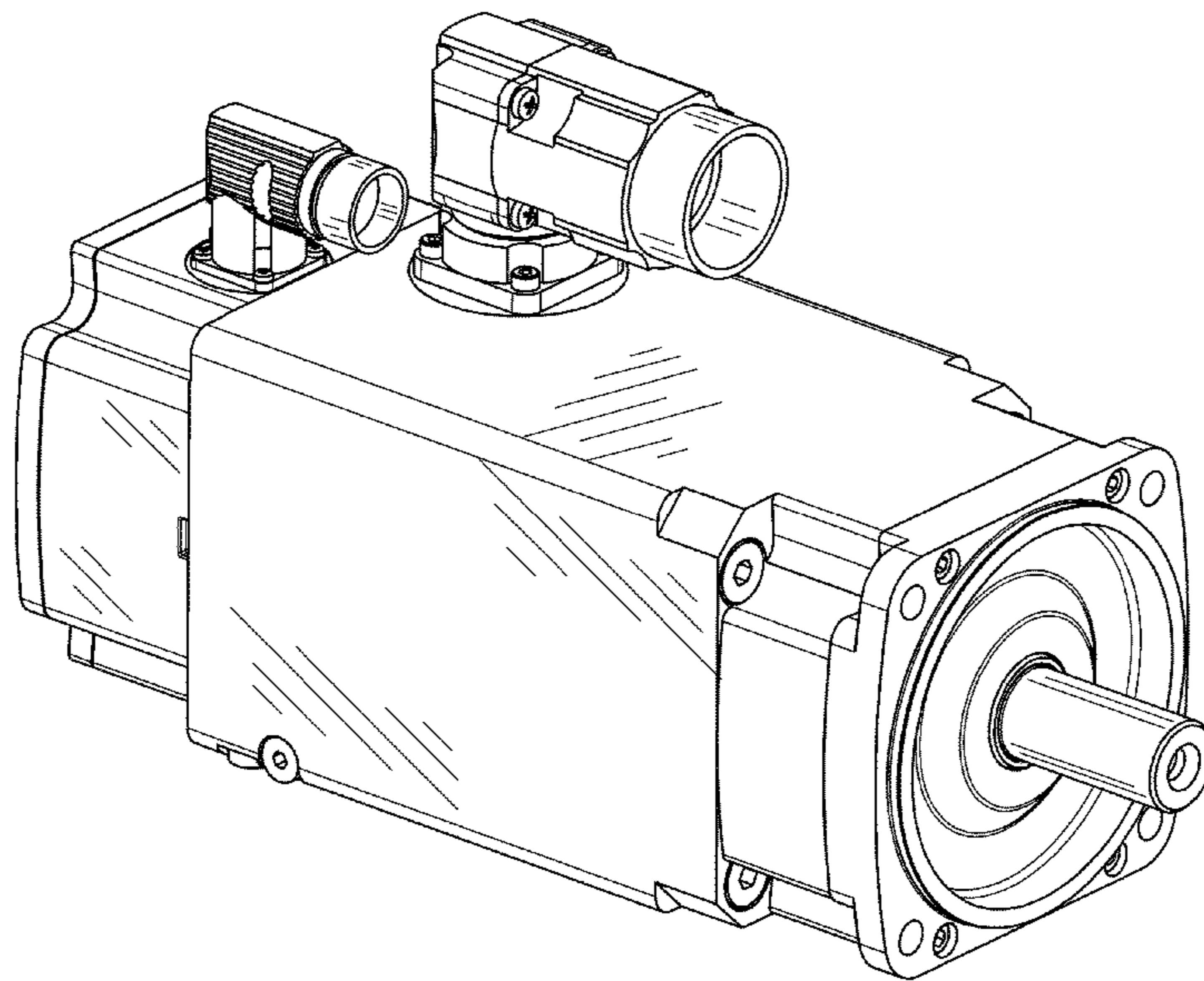

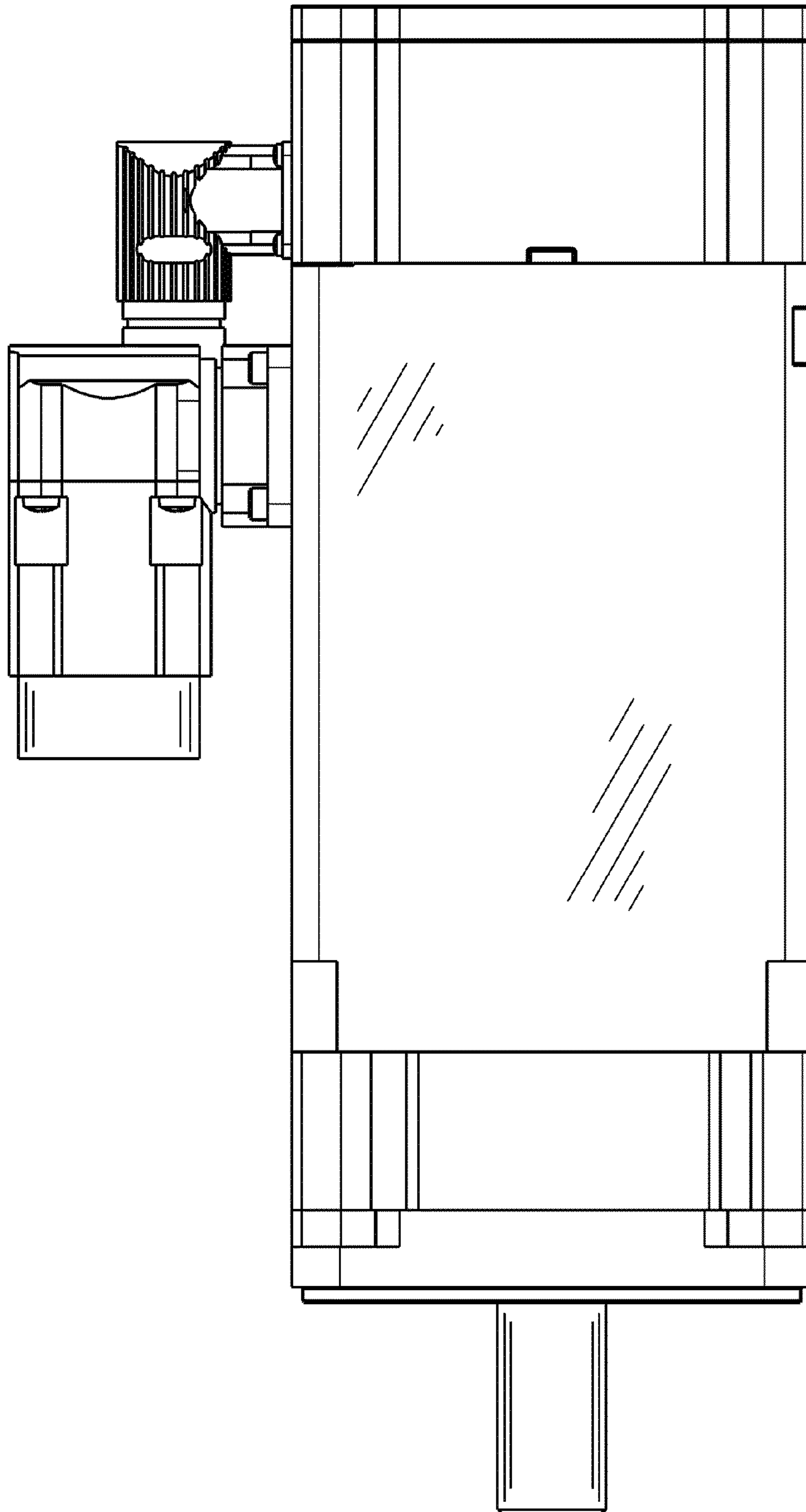

FIG. 1

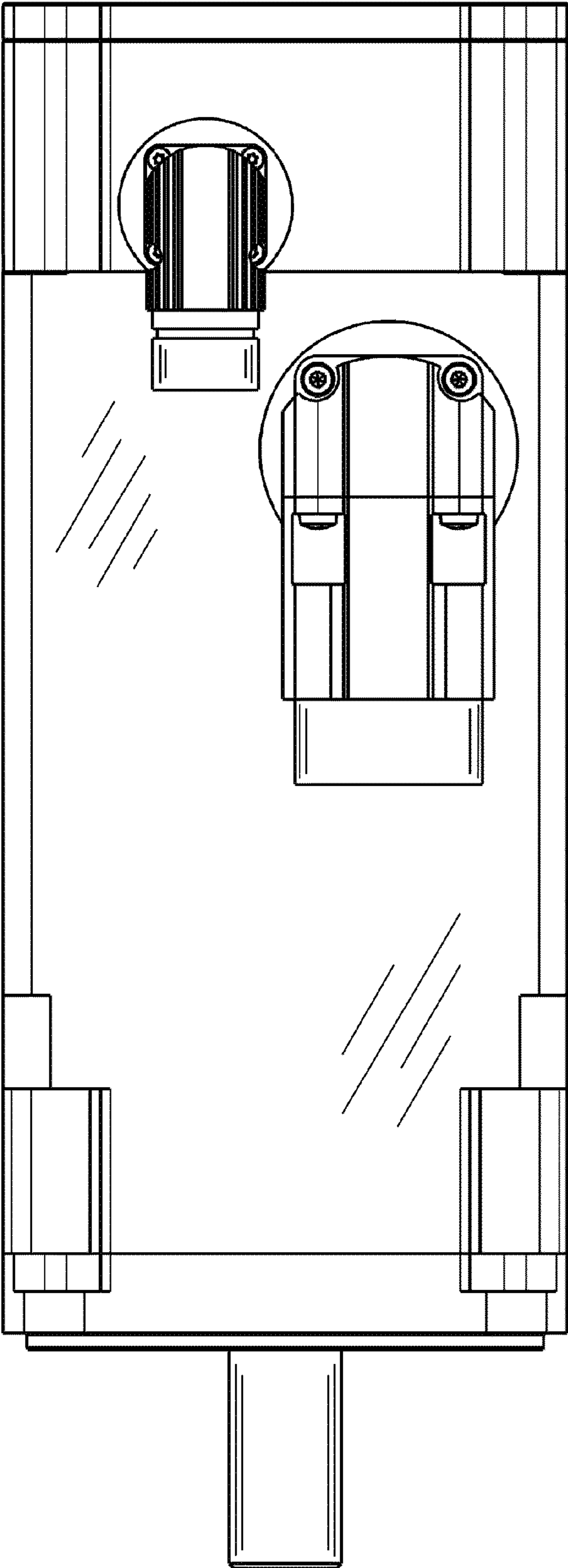

FIG. 2

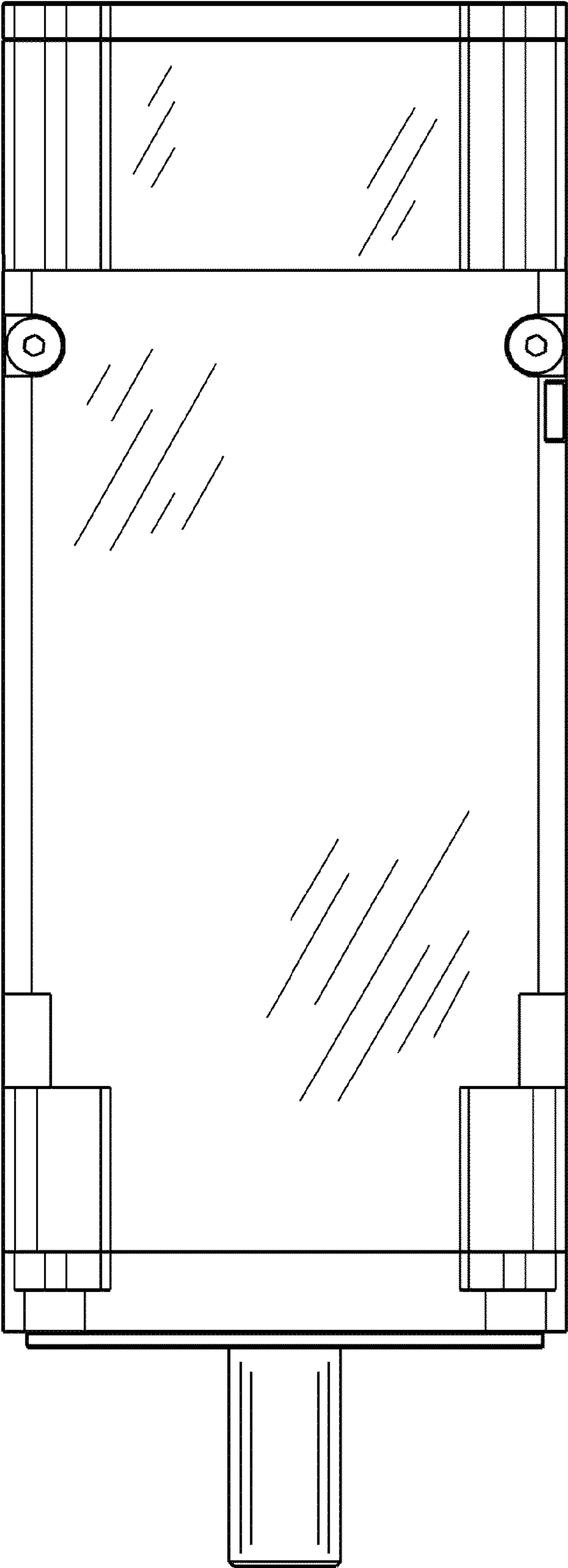

FIG. 3

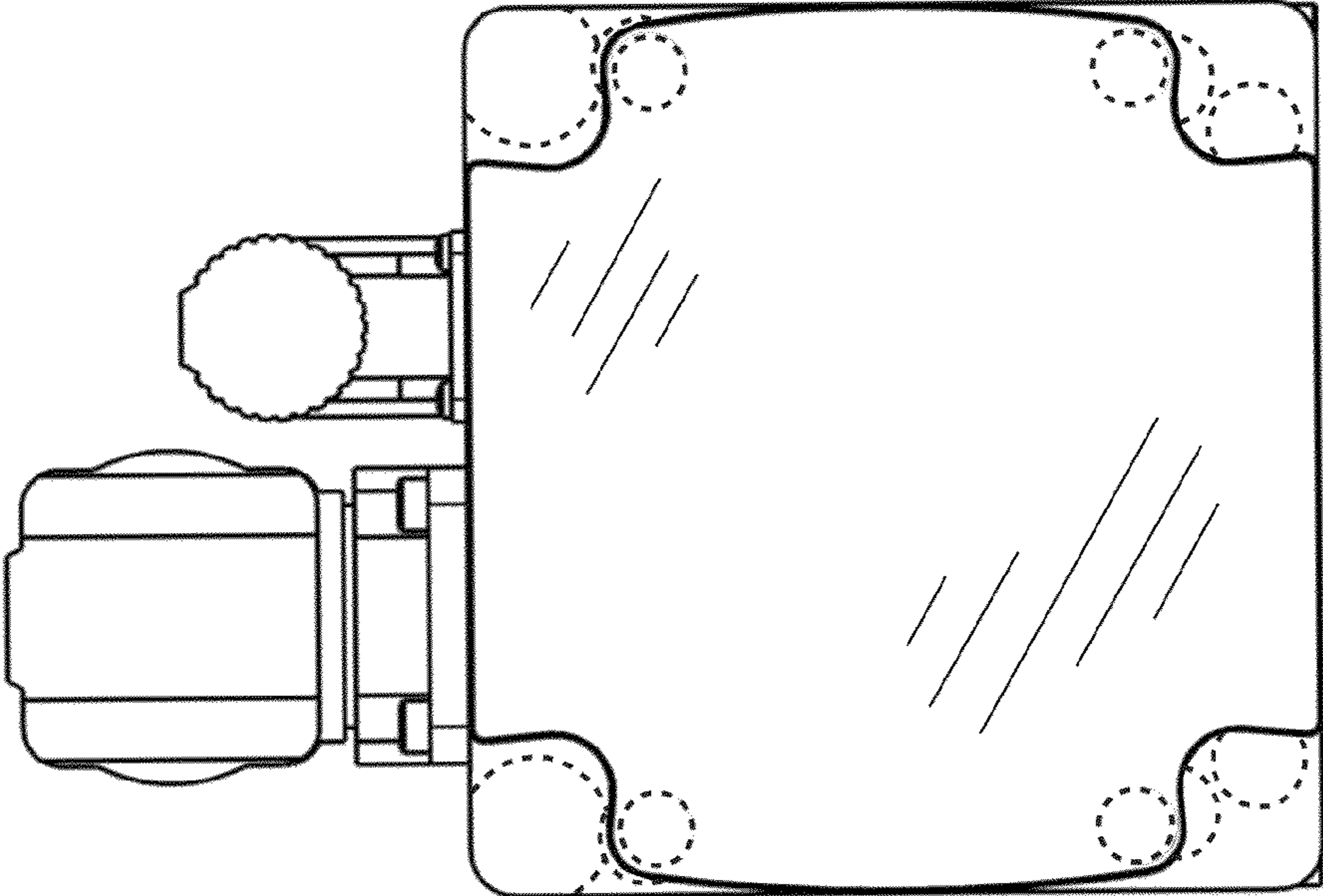

FIG. 4

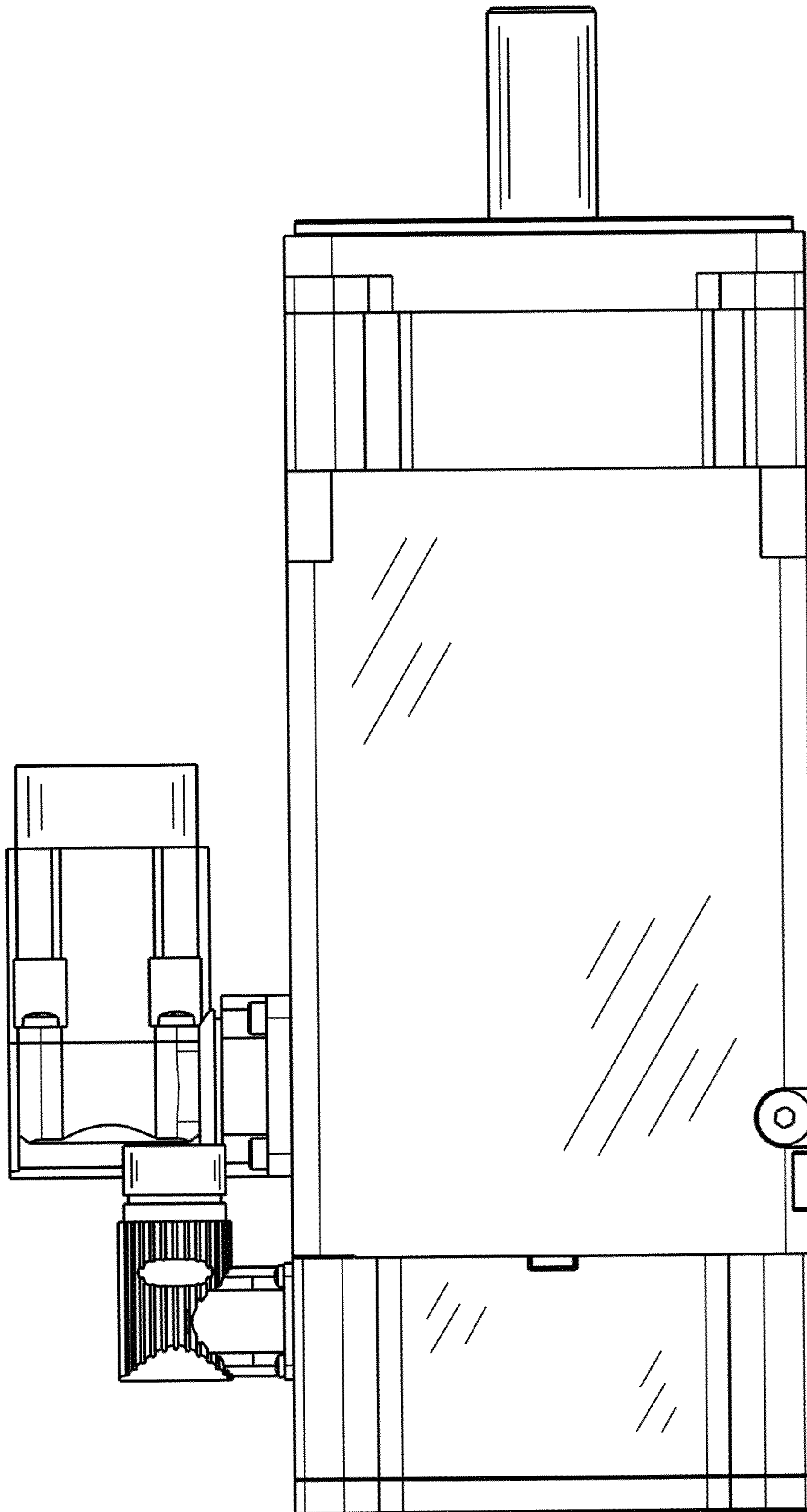

FIG. 5

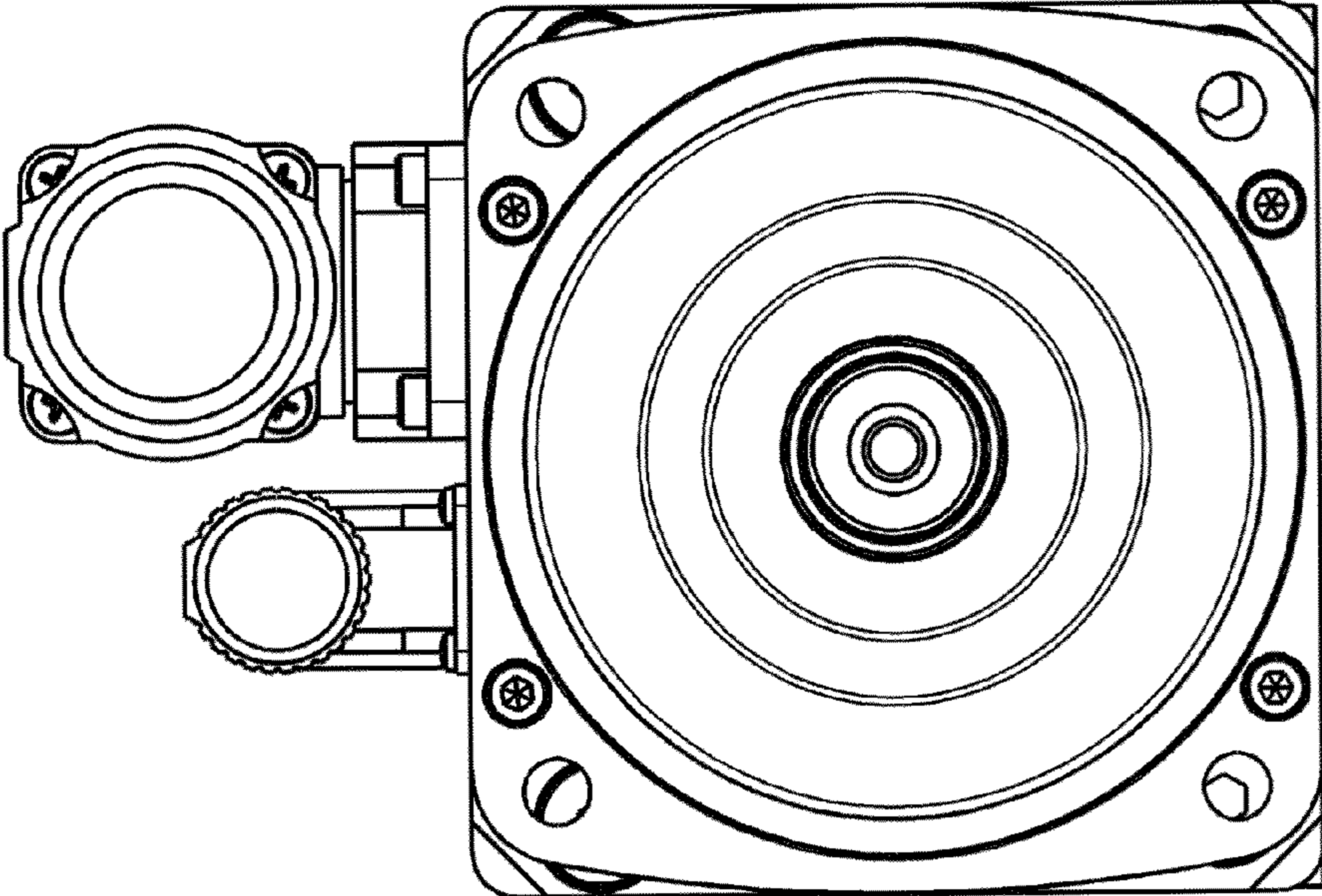

FIG. 6

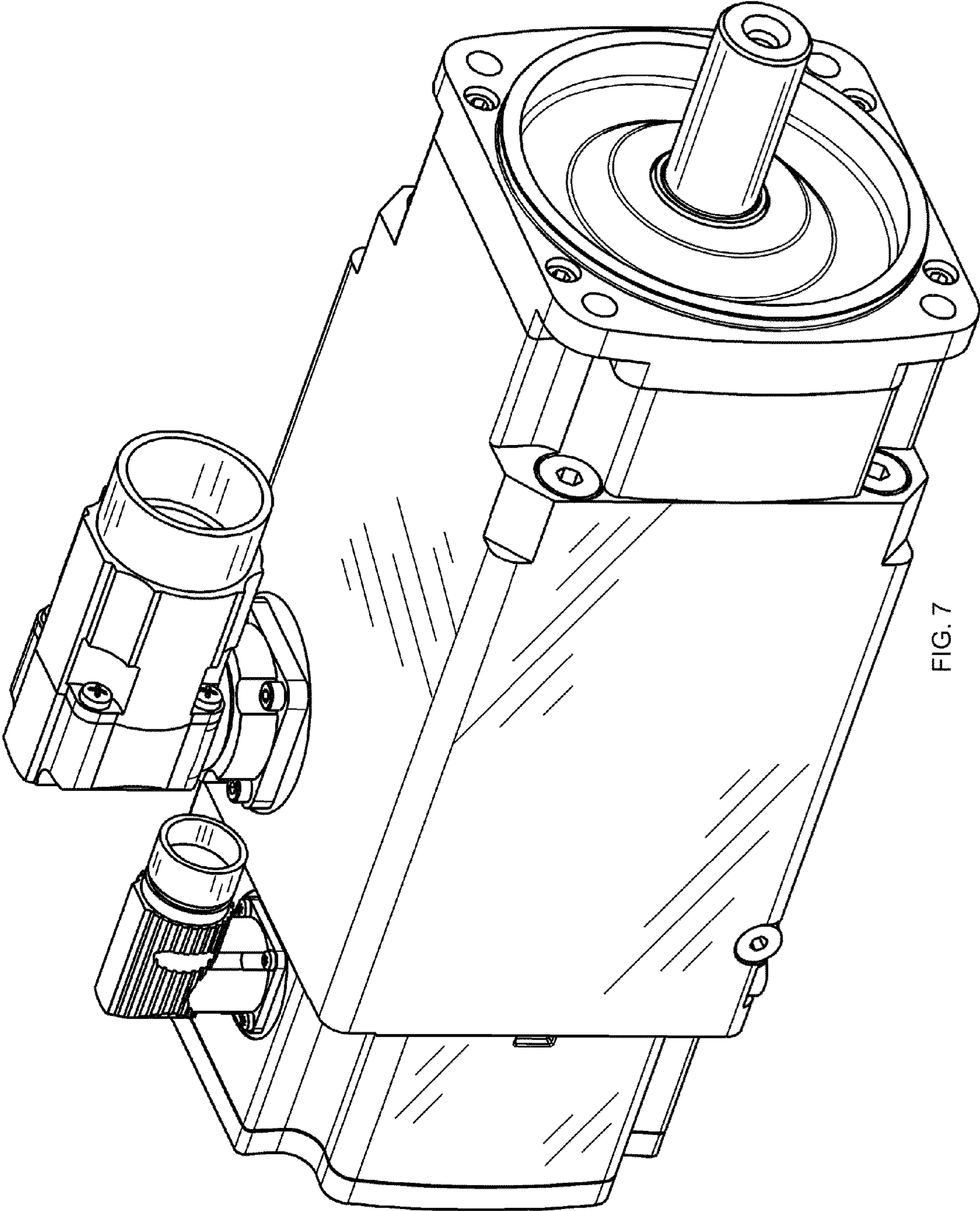

FIG. 7