



US00D758221S

(12) **United States Design Patent**
Fujiwara

(10) **Patent No.:** **US D758,221 S**

(45) **Date of Patent:** **** Jun. 7, 2016**

(54) **THERMOGRAVIMETRIC ANALYZER**

(56) **References Cited**

(71) Applicant: **Hitachi High-Tech Science Corporation**, Minato-ku, Tokyo (JP)

(72) Inventor: **Hirohito Fujiwara**, Tokyo (JP)

(73) Assignee: **Hitachi High-Tech Science Corporation**, Minato-ku, Tokyo (JP)

(**) Term: **14 Years**

(21) Appl. No.: **29/500,561**

(22) Filed: **Aug. 26, 2014**

(30) **Foreign Application Priority Data**

Feb. 28, 2014 (JP) 2014-004229

(51) **LOC (10) Cl.** **10-04**

(52) **U.S. Cl.**
USPC **D10/81**; D24/186; D24/232

(58) **Field of Classification Search**
USPC D10/46, 75, 81; D24/185, 186, 216,
D24/217, 219, 220, 232, 233, 234
CPC G01N 25/00; G01N 25/005; G01N 25/02;
G01N 25/04; G01N 25/06; G01N 25/08;
G01N 25/085; G01N 25/10; G01N 25/12;
G01N 25/14; G01N 25/142; G01N 25/145;
G01N 25/147; G01N 25/16; G01N 25/18;
G01N 25/20; G01N 25/22

See application file for complete search history.

U.S. PATENT DOCUMENTS

D283,107 S *	3/1986	Collister	D10/46
D292,979 S *	12/1987	Chow	D10/75
5,322,360 A *	6/1994	Willis et al.	374/38
D381,756 S *	7/1997	Ohnuma et al.	D24/232
6,760,679 B1 *	7/2004	Carney et al.	702/94
6,846,455 B1 *	1/2005	Carney et al.	422/64
D556,914 S *	12/2007	Okamoto et al.	D24/233
D638,545 S *	5/2011	Okawa et al.	D24/186
D689,387 S *	9/2013	Muraoka et al.	D10/81

* cited by examiner

Primary Examiner — Antoine D Davis

(74) *Attorney, Agent, or Firm* — Banner & Witcoff, Ltd.

(57) **CLAIM**

The ornamental design for a thermogravimetric analyzer, as shown and described.

DESCRIPTION

FIG. 1 is a front perspective view of a thermogravimetric analyzer showing my new design;
FIG. 2 is a front view thereof;
FIG. 3 is a rear view thereof;
FIG. 4 is a left side view thereof;
FIG. 5 is a right side view thereof;
FIG. 6 is a top plan view thereof;
FIG. 7 is a bottom view thereof; and,
FIG. 8 is an enlarged perspective view of a portion defined by lines 8 show in FIG. 1.

The broken lines represent the portions of the design that form no part of the claim. The mesh portion around the claimed portion forms no part of the claimed design.

1 Claim, 8 Drawing Sheets

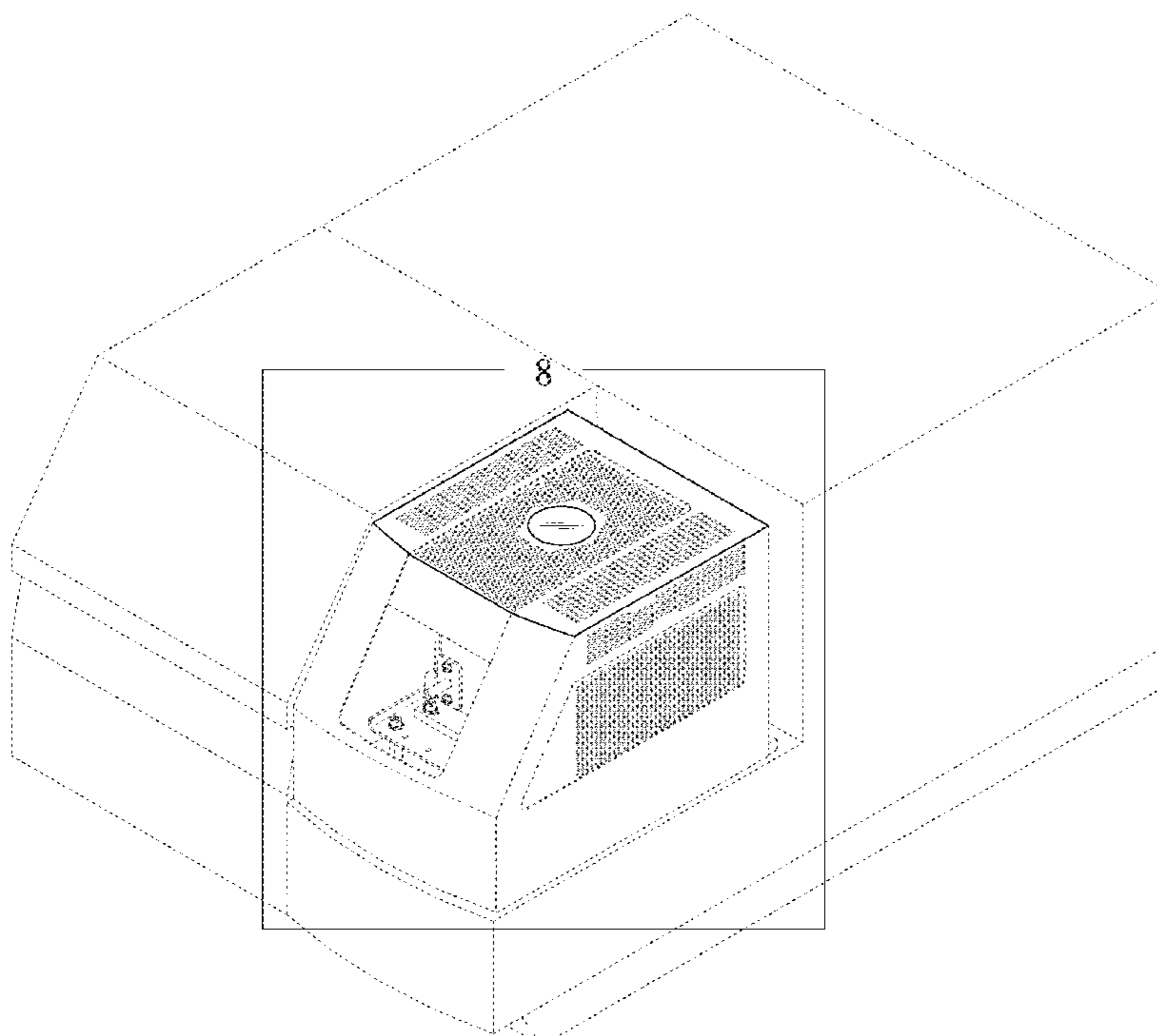

Fig. 1

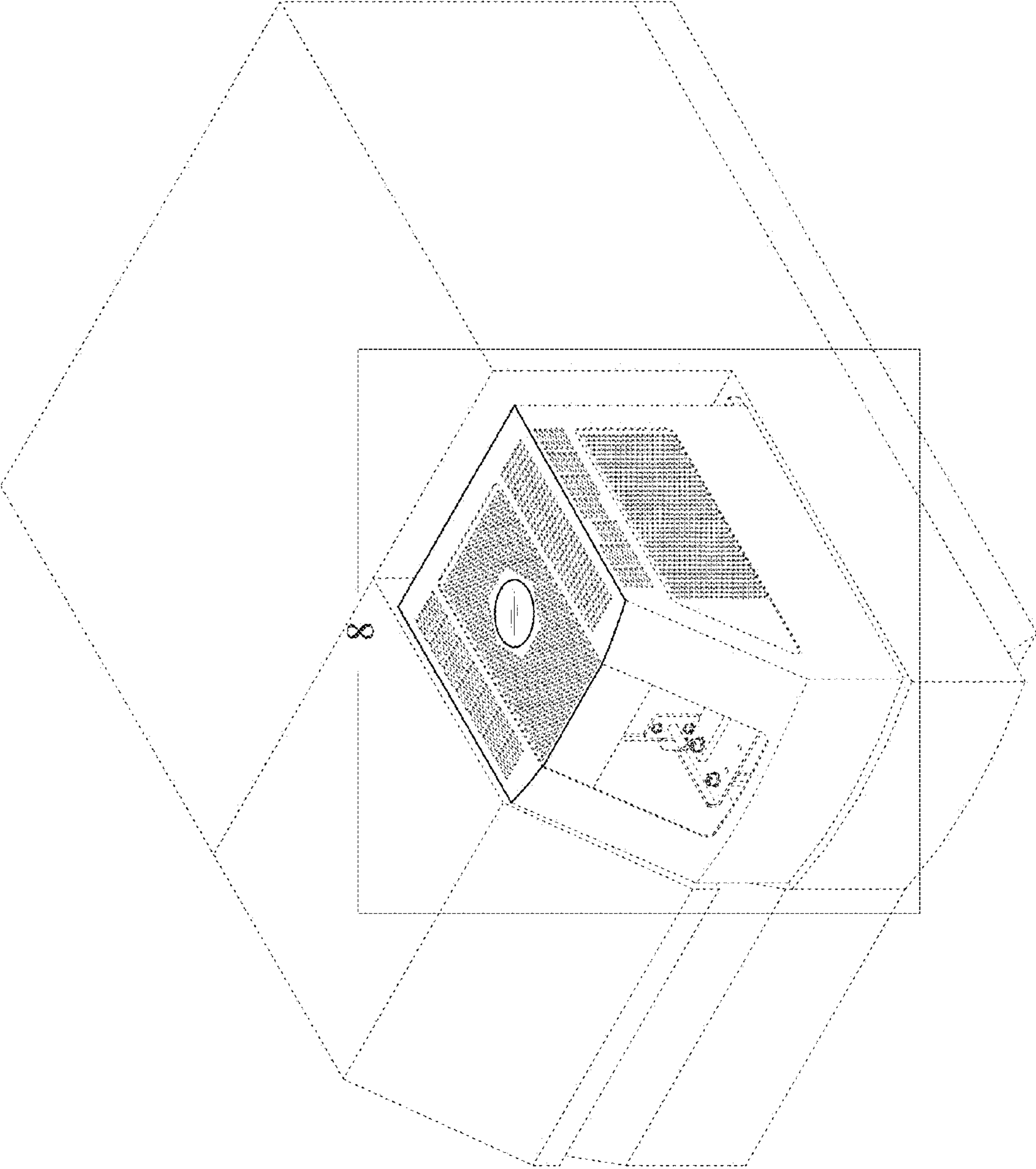

Fig. 2

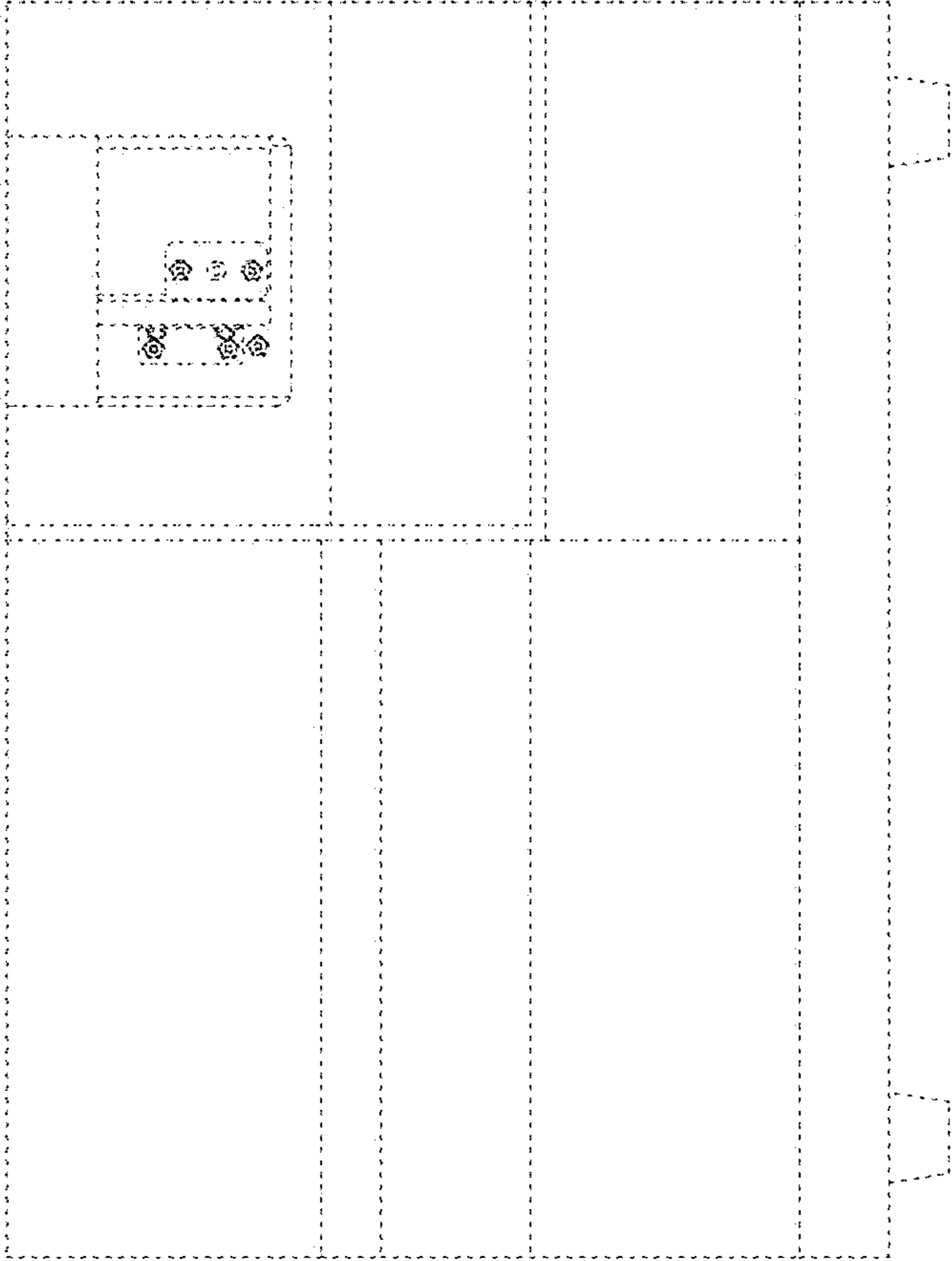

Fig. 3

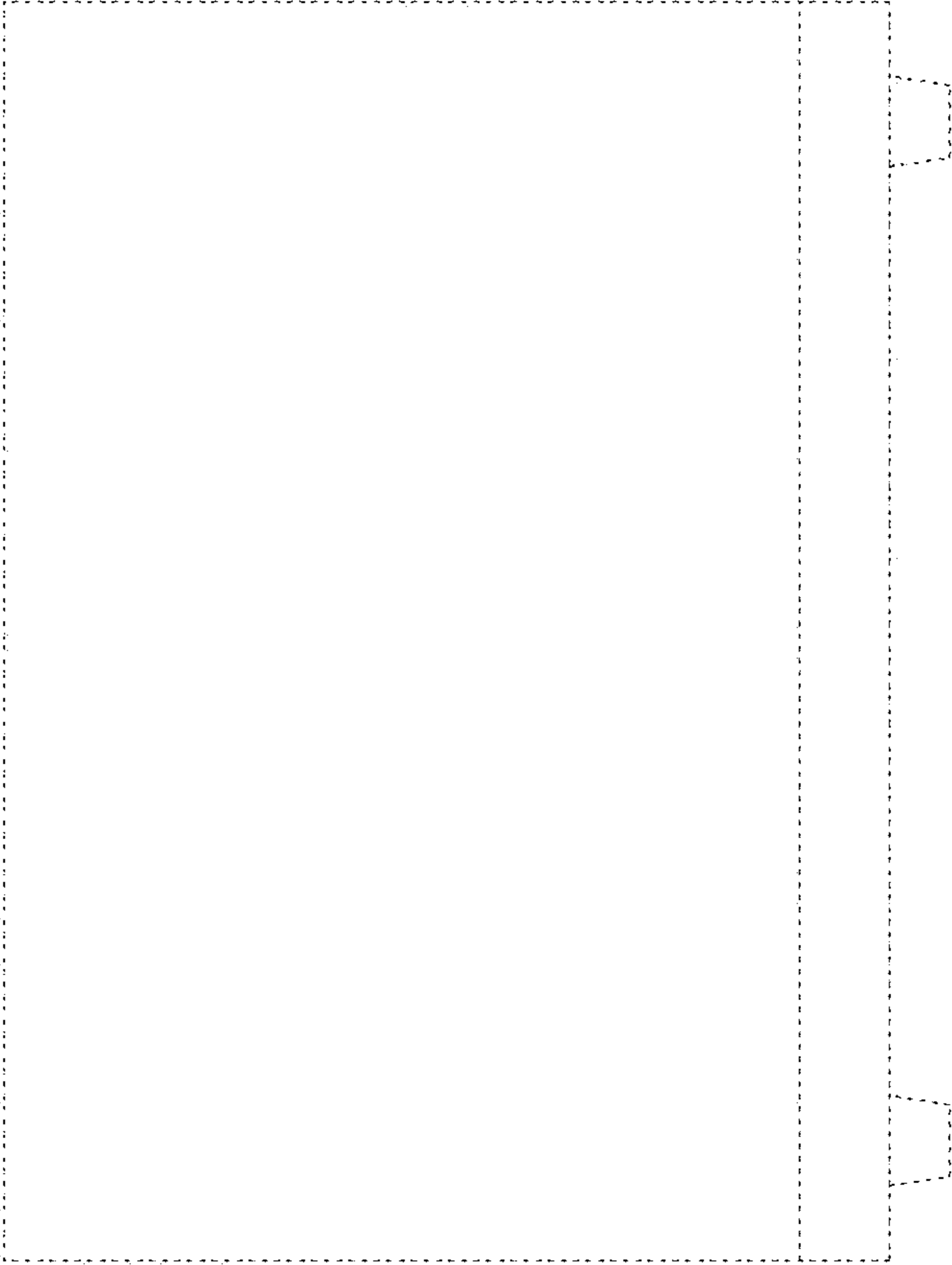

Fig. 4

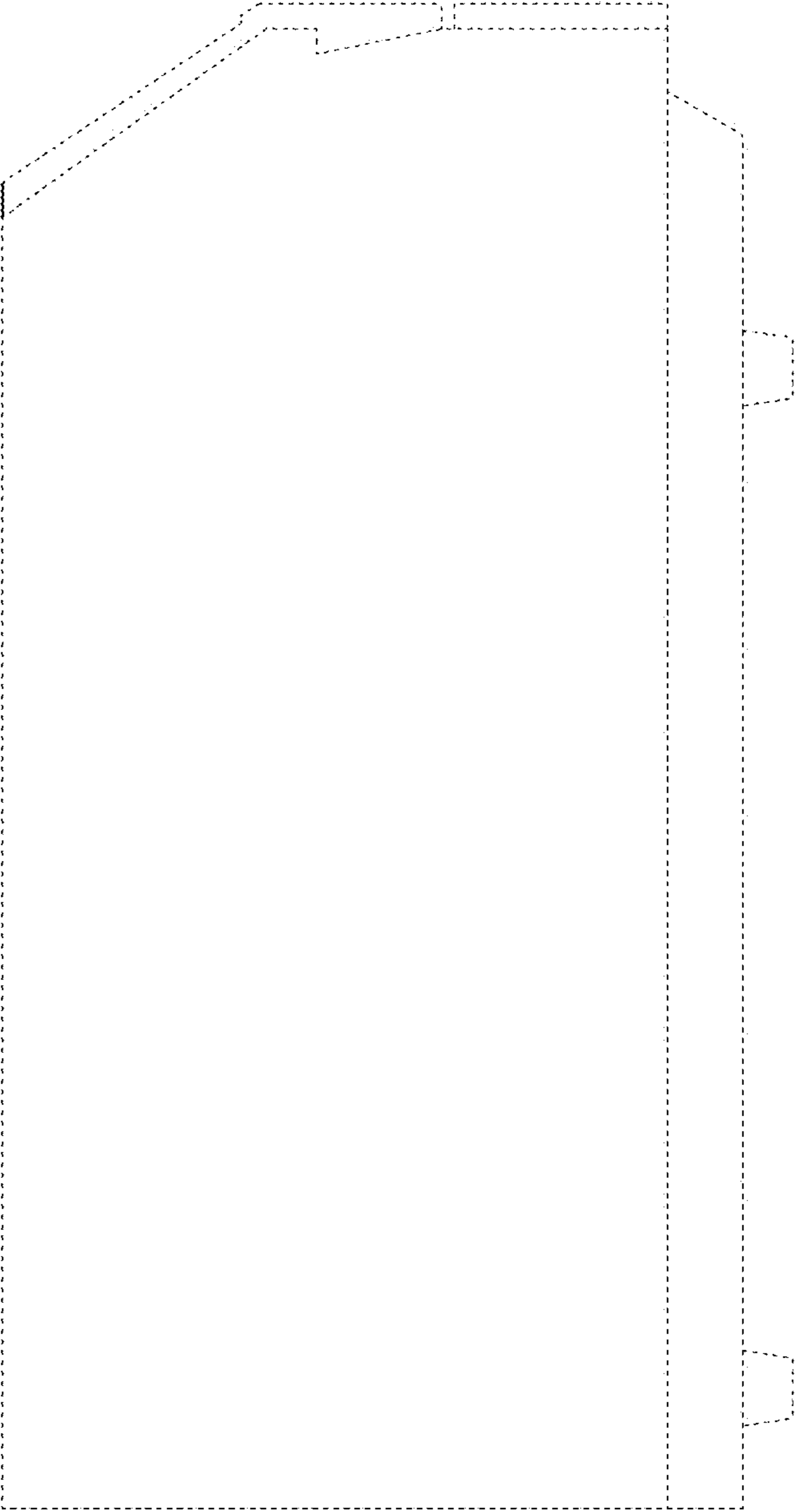

Fig. 5

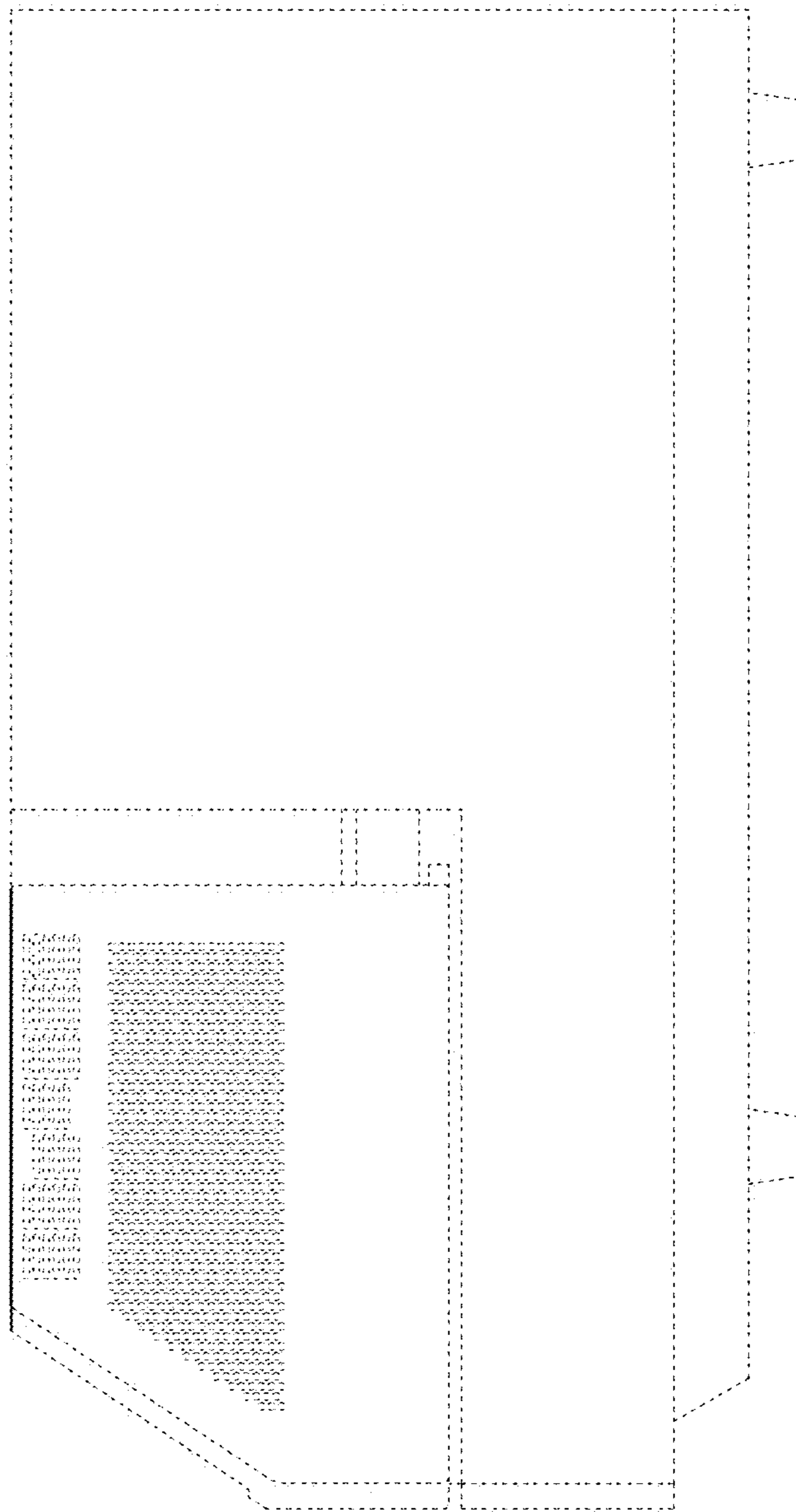

Fig. 6

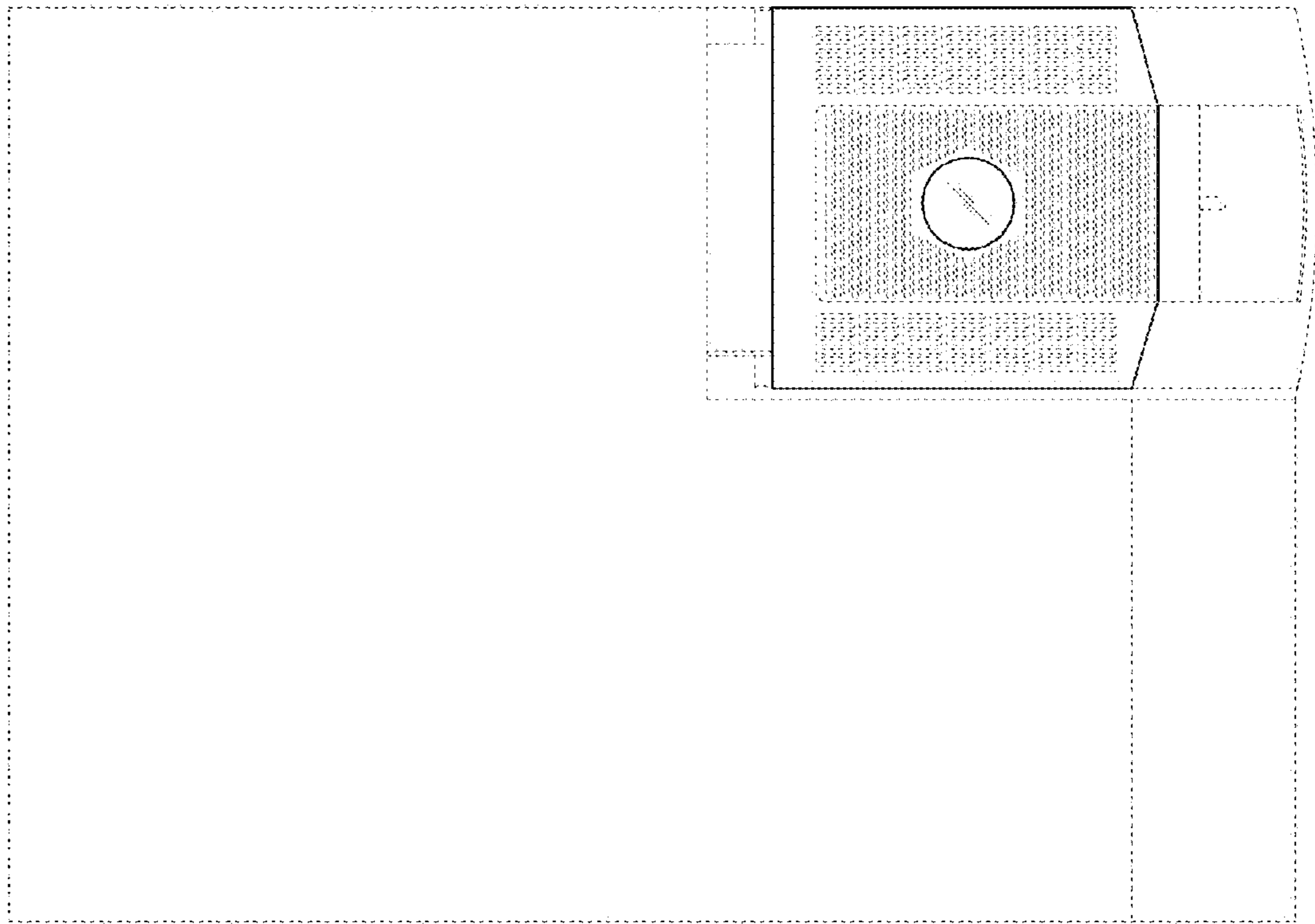

Fig. 7

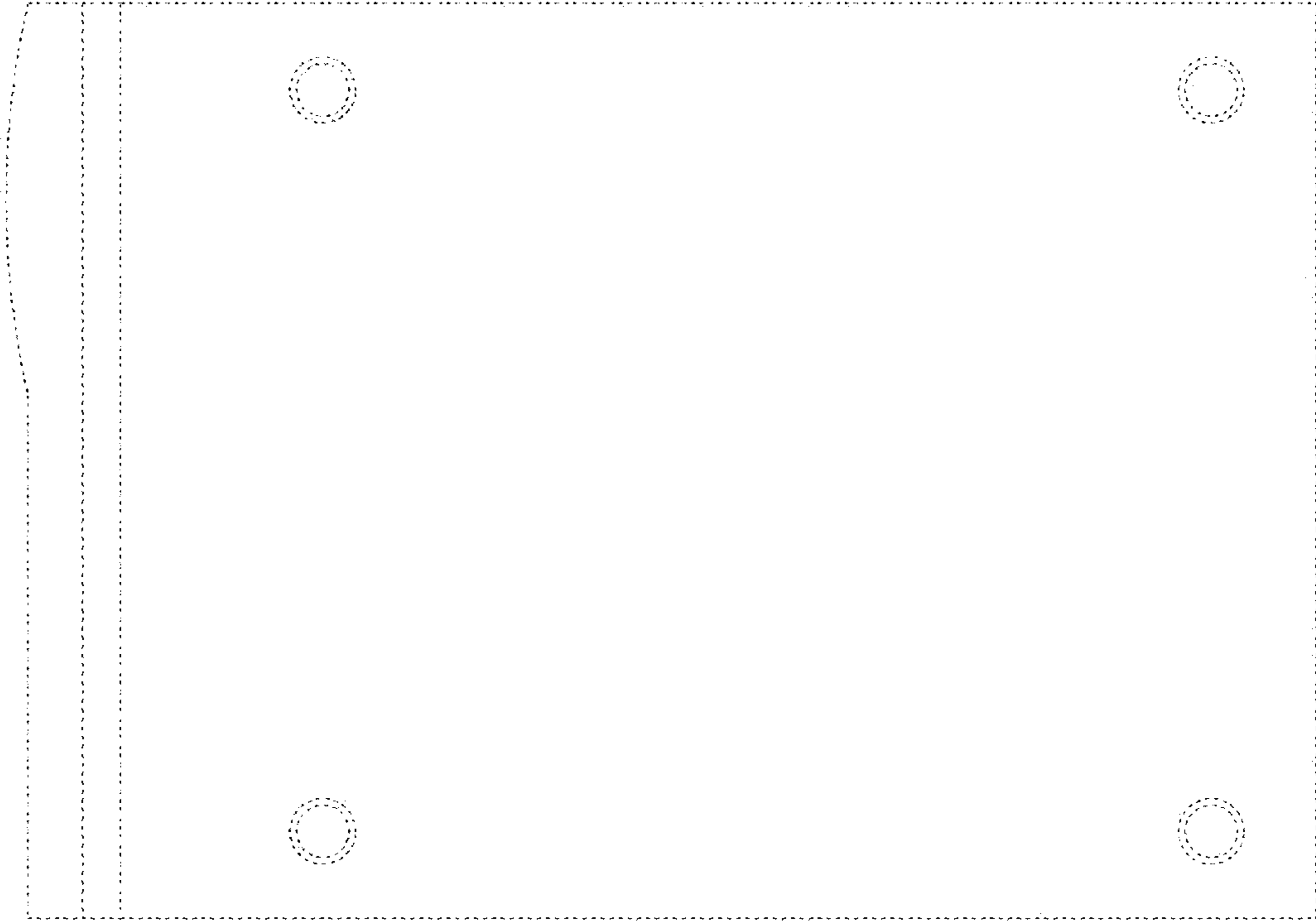

Fig. 8

