



US00D756747S

(12) **United States Design Patent**
Wu et al.

(10) **Patent No.:** **US D756,747 S**
(45) **Date of Patent:** **** May 24, 2016**

(54) **ESCUTCHEON**

(56) **References Cited**

(71) Applicant: **TAIWAN FU HSING INDUSTRIAL CO., LTD.**, Kaohsiung (TW)

U.S. PATENT DOCUMENTS

(72) Inventors: **Wen-Fa Wu**, Kaohsiung (TW);
Wen-Tung Chen, Pingtung County (TW)

D305,863	S	*	2/1990	Gresens	D8/352
5,026,012	A	*	6/1991	Wang	A47K 10/10 248/222.14
D328,210	S	*	7/1992	Callon	D6/707.2
D369,288	S	*	4/1996	Jensen	D8/310
D385,956	S	*	11/1997	Doughty	D23/259
D531,276	S	*	10/2006	Tsai	D23/254
D554,974	S	*	11/2007	Huang	D8/352
D635,443	S	*	4/2011	Roberts, III	D6/330
D635,444	S	*	4/2011	Roberts, III	D8/330
D640,078	S	*	6/2011	Gilbert	D6/524
D648,424	S	*	11/2011	Gilbert	137/359
D648,834	S	*	11/2011	Gilbert	137/359
D678,752	S	*	3/2013	Sedwick	D23/249
D679,171	S	*	4/2013	Sedwick	D23/249
D703,026	S	*	4/2014	Wu	D8/350
D703,791	S	*	4/2014	Gilbert	D23/249

(73) Assignee: **TAIWAN FU HSING INDUSTRIAL CO., LTD.**, Gangshan District, Kaohsiung (TW)

(**) Term: **14 Years**

(21) Appl. No.: **29/508,409**

(22) Filed: **Nov. 6, 2014**

FOREIGN PATENT DOCUMENTS

(30) **Foreign Application Priority Data**

TW	M287852	2/2006
TW	D124742	9/2008

Oct. 9, 2014 (TW) 103306017

* cited by examiner

(51) **LOC (10) Cl.** **08-07**

Primary Examiner — Mark Goodwin

(52) **U.S. Cl.**

(74) *Attorney, Agent, or Firm* — Winston Hsu; Scott Margo

USPC **D8/352**

(58) **Field of Classification Search**

(57) **CLAIM**

The ornamental design for an escutcheon, as shown and described.

USPC D8/330, 331, 334, 300, 301, 302,
D8/350–353; 70/14, 20–22, 57, 57.1,
70/284–286, 314, DIG. 44; 340/5.21, 5.54,
340/5.65, 5.73, 5.81, 5.85; D23/249, 254
CPC E05C 9/004; E05B 9/002; E05B 9/00;
E05B 9/02; E05B 37/00; E05B 1/00; E05B
3/00; E05B 47/00; E05B 47/06; E05B 49/00;
E05B 15/02; E05B 15/00; E05B 13/103;
Y10T 70/8324; Y10T 70/8459; Y10T
70/8514; Y10T 70/8568

DESCRIPTION

FIG. 1. is a front perspective view of an escutcheon showing our new design;
FIG. 2. is a front elevational view thereof;
FIG. 3. is a rear elevational view thereof;
FIG. 4. is a left side elevational view thereof;
FIG. 5. is a top plan view thereof;
FIG. 6. is a bottom plan view thereof; and,
FIG. 7. is a cross section taken along lines 4-4 of FIG. 2.

See application file for complete search history.

1 Claim, 7 Drawing Sheets

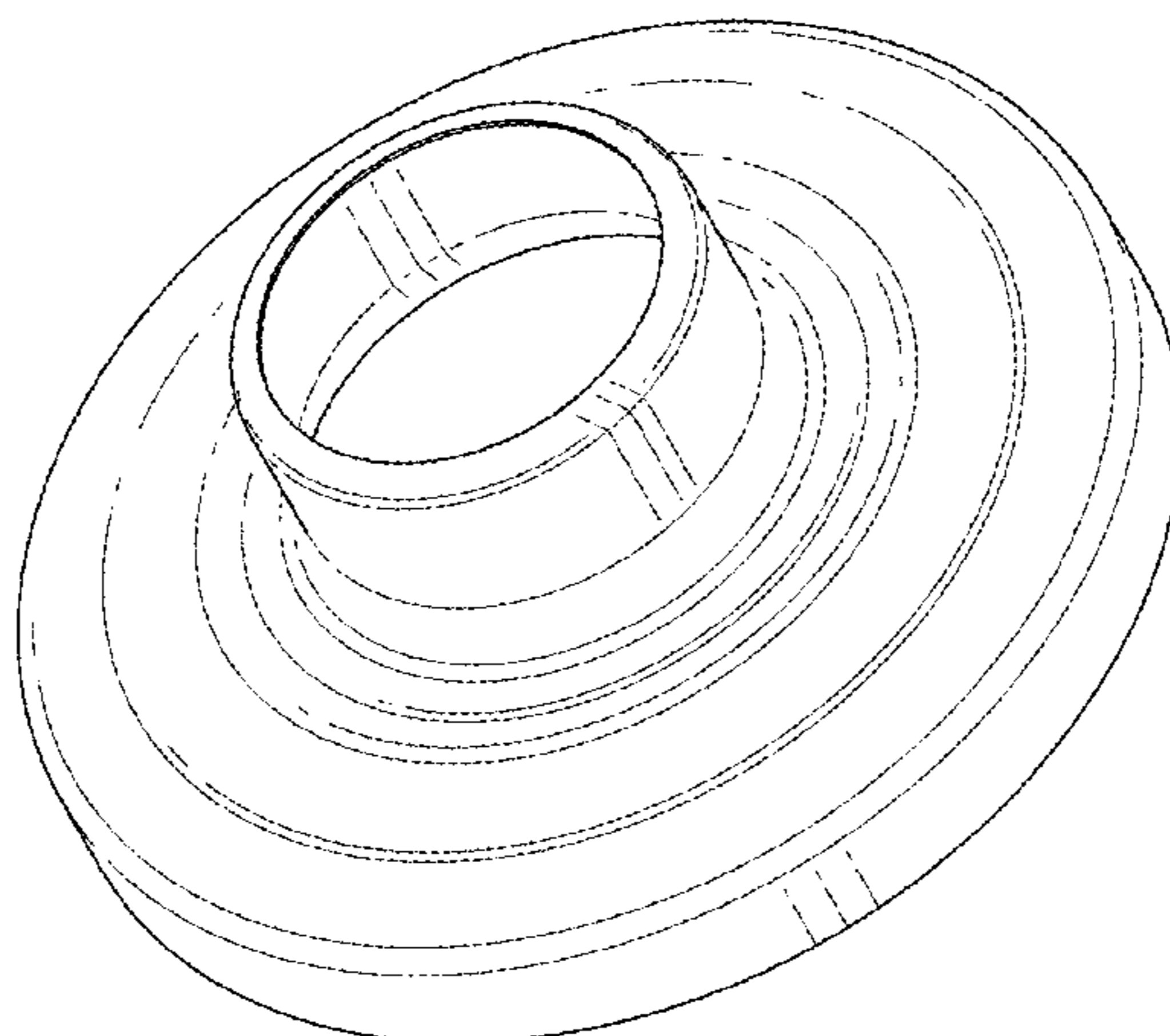

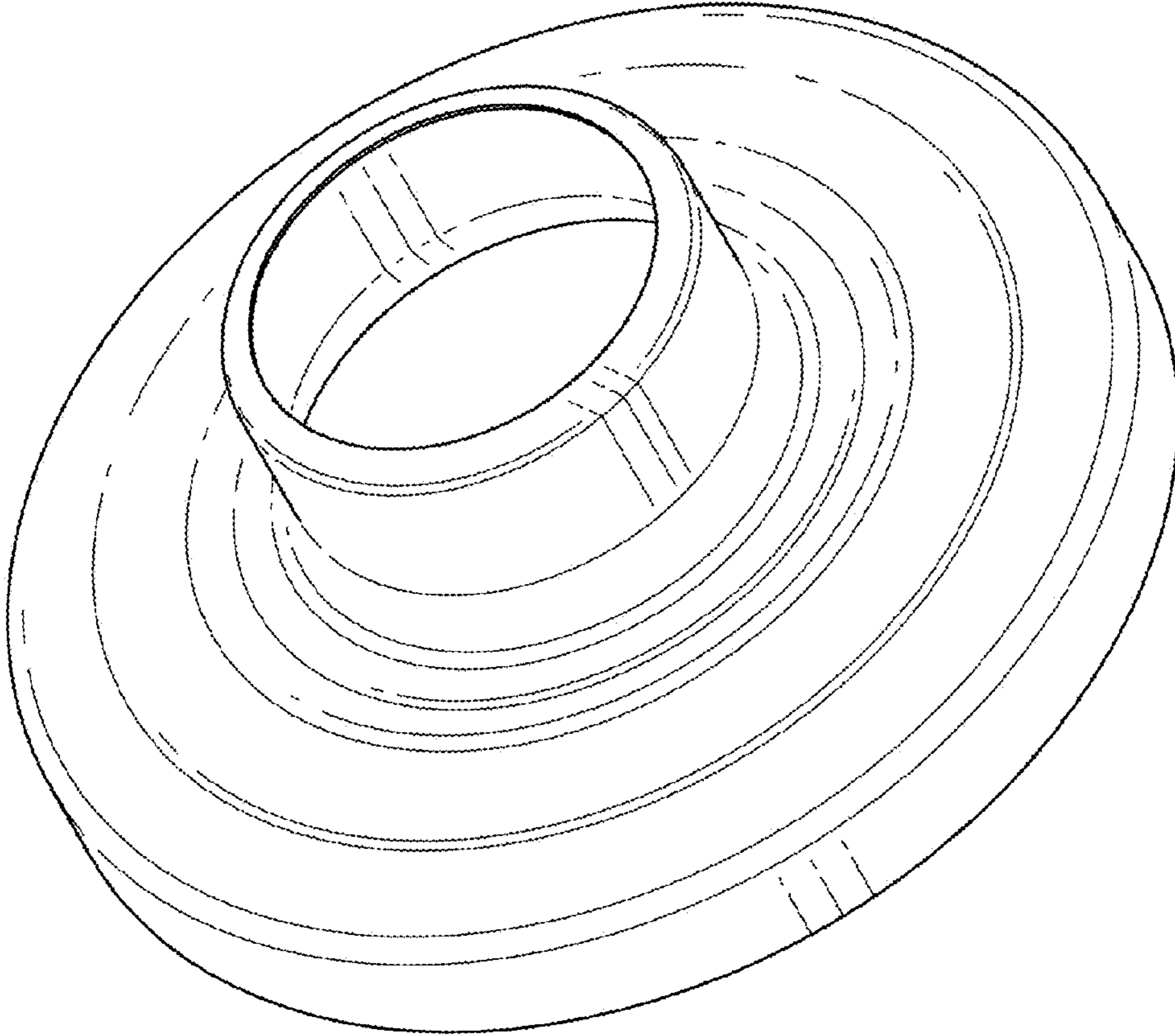

FIG. 1

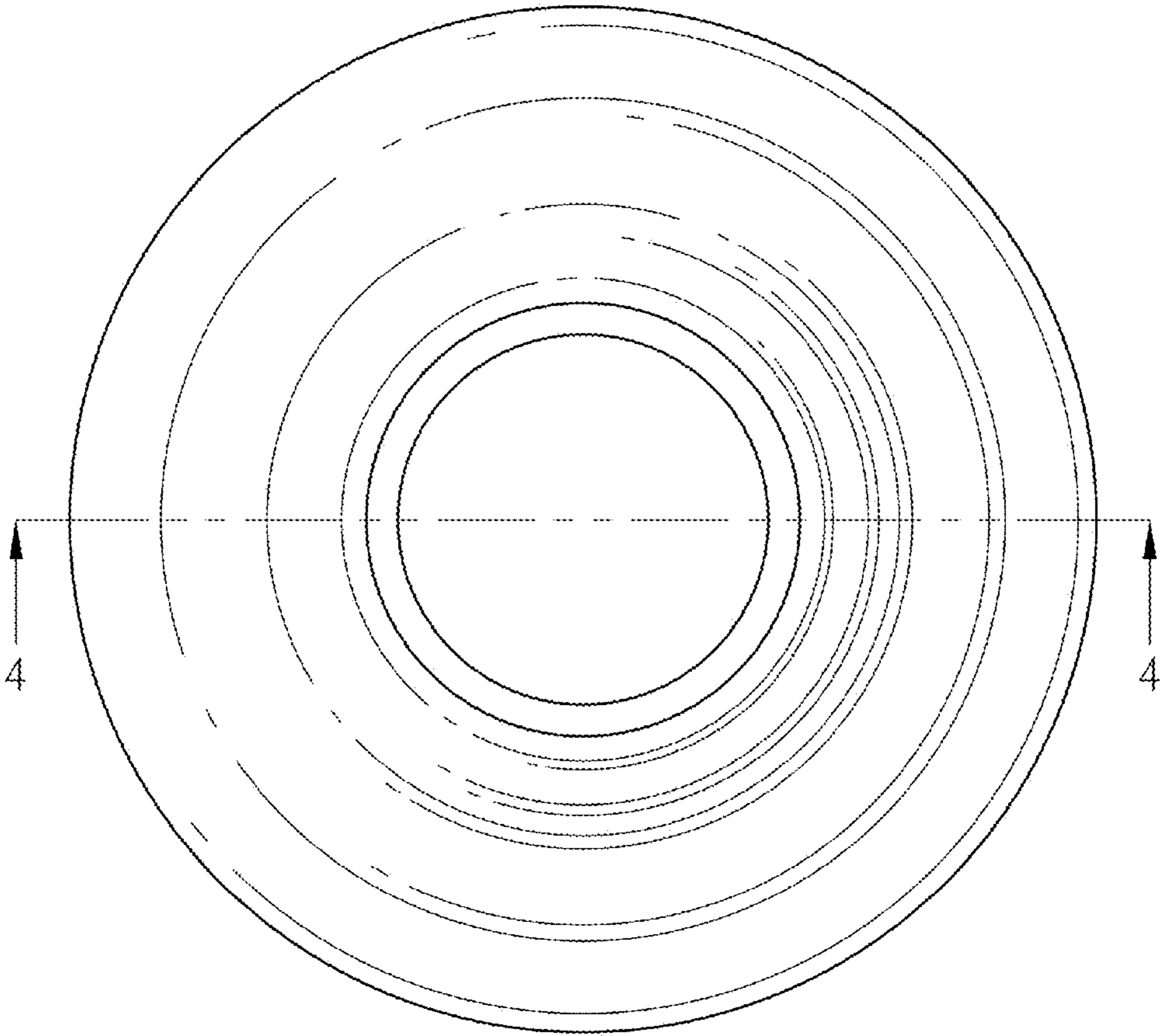

FIG. 2

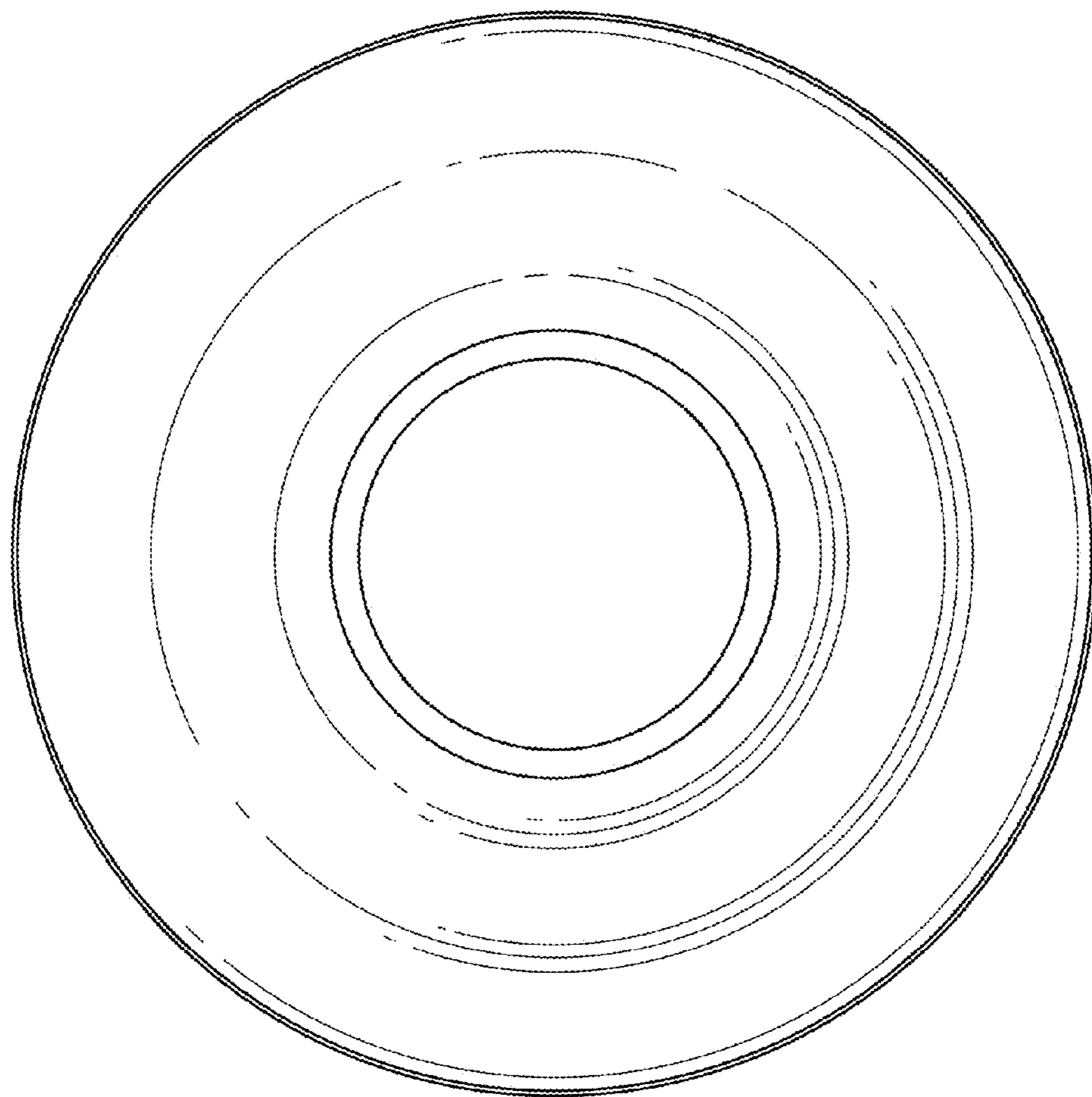

FIG. 3

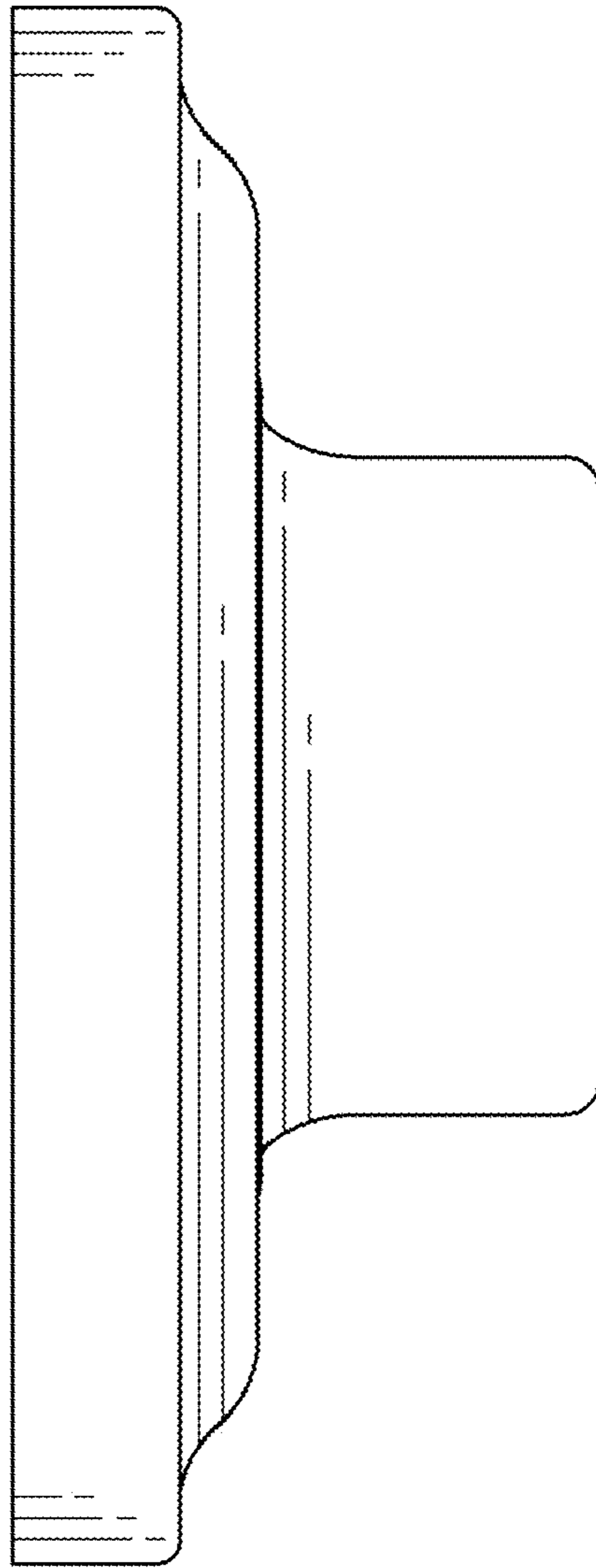

FIG. 4

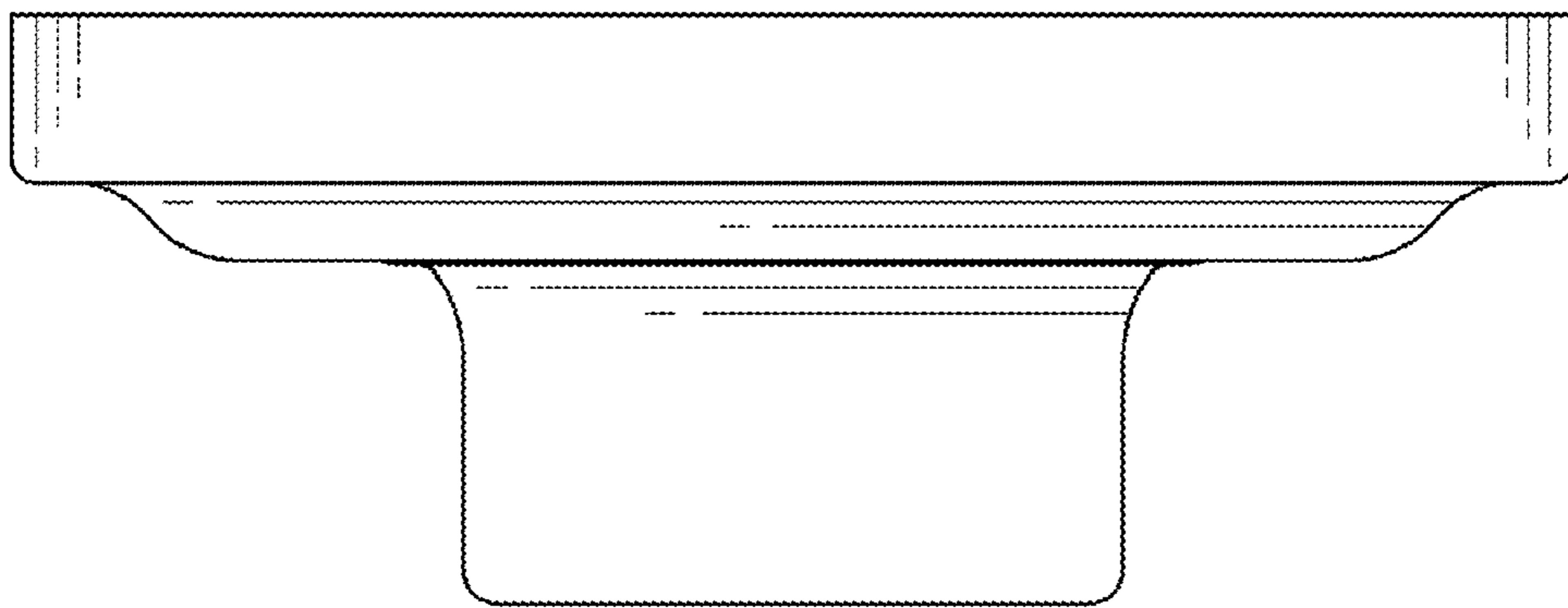

FIG. 5

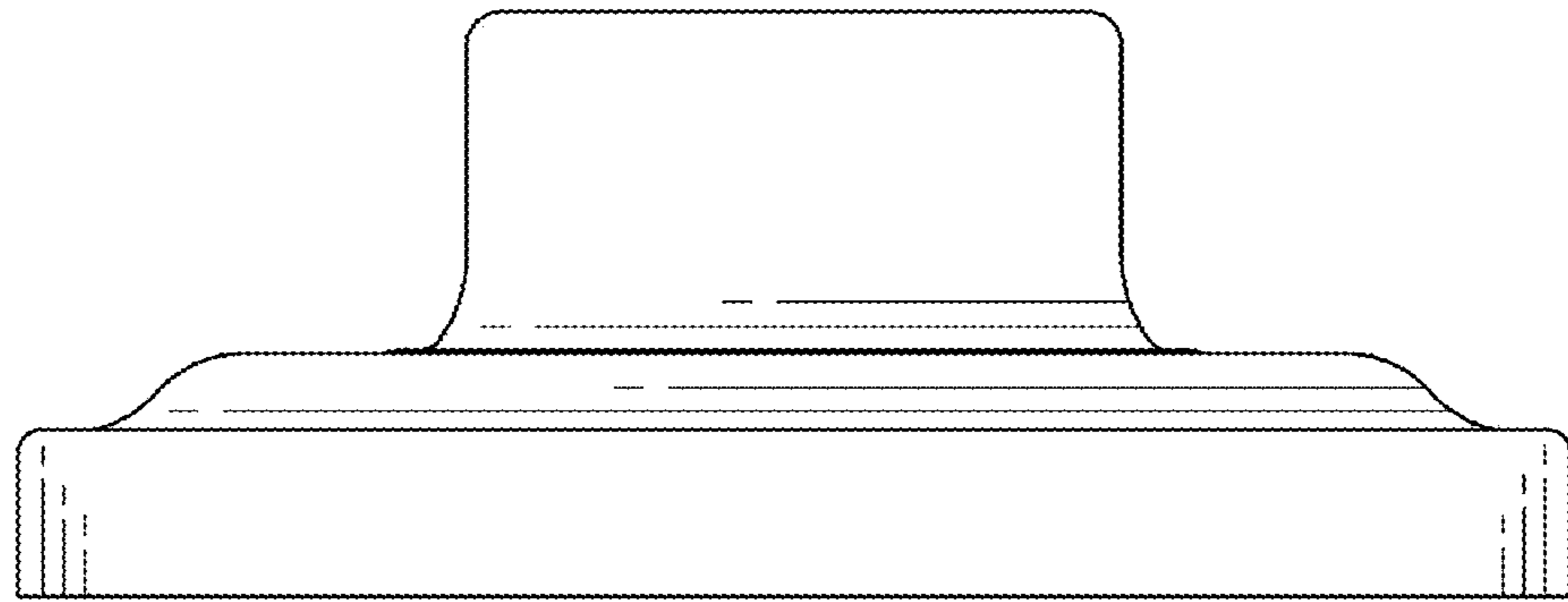

FIG. 6

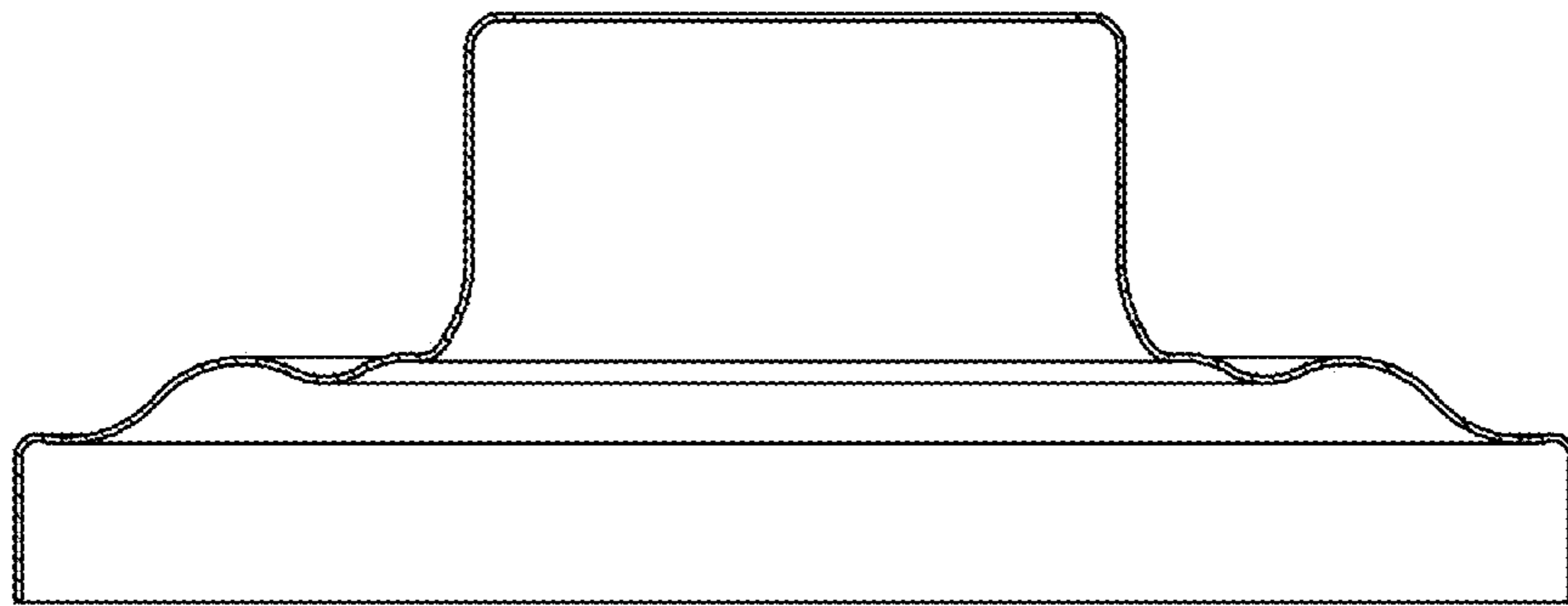

FIG. 7