



US00D756201S

(12) **United States Design Patent**  
**VanDeusen**

(10) **Patent No.:** **US D756,201 S**  
(45) **Date of Patent:** **\*\* May 17, 2016**

- (54) **REMOVABLE SHIM**
- (71) Applicant: **Eaton Corporation**, Cleveland, OH  
(US)
- (72) Inventor: **Brian Karl VanDeusen**, Augusta, MI  
(US)
- (73) Assignee: **Eaton Corporation**, Cleveland, OH  
(US)
- (\*\*) Term: **14 Years**
- (21) Appl. No.: **29/507,008**
- (22) Filed: **Oct. 23, 2014**
- (51) **LOC (10) Cl.** ..... **08-05**
- (52) **U.S. Cl.**  
USPC ..... **D8/354; D15/5**
- (58) **Field of Classification Search**  
USPC ..... D8/349, 354-355, 373, 380, 382-383,  
D8/394, 396; D15/5  
CPC ..... B60G 2204/4402; F16B 43/005;  
Y10T 403/7047; Y10T 74/2063  
See application file for complete search history.

- (56) **References Cited**  
U.S. PATENT DOCUMENTS  
4,683,923 A \* 8/1987 Harris ..... B67D 7/50  
141/392  
D298,212 S \* 10/1988 Gross ..... D15/9.1  
D313,739 S \* 1/1991 Preston ..... D8/354  
D325,564 S \* 4/1992 Lemke ..... D13/154  
D423,909 S \* 5/2000 Hartin ..... D8/349  
6,415,755 B1 7/2002 McCarthy  
D482,599 S \* 11/2003 May ..... D8/356  
6,830,086 B2 \* 12/2004 Smith ..... B67D 7/50  
141/392

- D508,841 S \* 8/2005 Jordan, Jr. .... D8/395
- 7,055,655 B2 \* 6/2006 Takizawa ..... F16B 43/005  
188/18 A
- 7,096,836 B2 8/2006 Curtis
- D563,770 S \* 3/2008 Payne, Jr. .... D8/354
- D569,241 S \* 5/2008 O'Neill ..... D8/395
- 7,685,984 B2 3/2010 Hendriksma
- 8,534,250 B2 9/2013 Meldolesi
- 2002/0185622 A1 \* 12/2002 Bruns ..... B67D 7/50  
251/90

\* cited by examiner

*Primary Examiner* — Rosemary K Tarcza  
*Assistant Examiner* — Nathaniel D Buckner  
(74) *Attorney, Agent, or Firm* — Remarck Law Group PLC

(57) **CLAIM**  
The ornamental design for a removable shim, as shown and described.

**DESCRIPTION**  
FIG. 1 is a front perspective view of a first example of the removable shim showing the new design.  
FIG. 2 is a top view of the first example the removable shim of FIG. 1.  
FIG. 3 is a bottom view of the first example of the removable shim of FIG. 1.  
FIG. 4 is a first side view of the first example of the removable shim of FIG. 1.  
FIG. 5 is a second side view of the first example of the removable shim of FIG. 1.  
FIG. 6 is a third side view of the first example of the removable shim of FIG. 1; and,  
FIG. 7 is a fourth side view of the first example of the removable shim of FIG. 1.

**1 Claim, 1 Drawing Sheet**

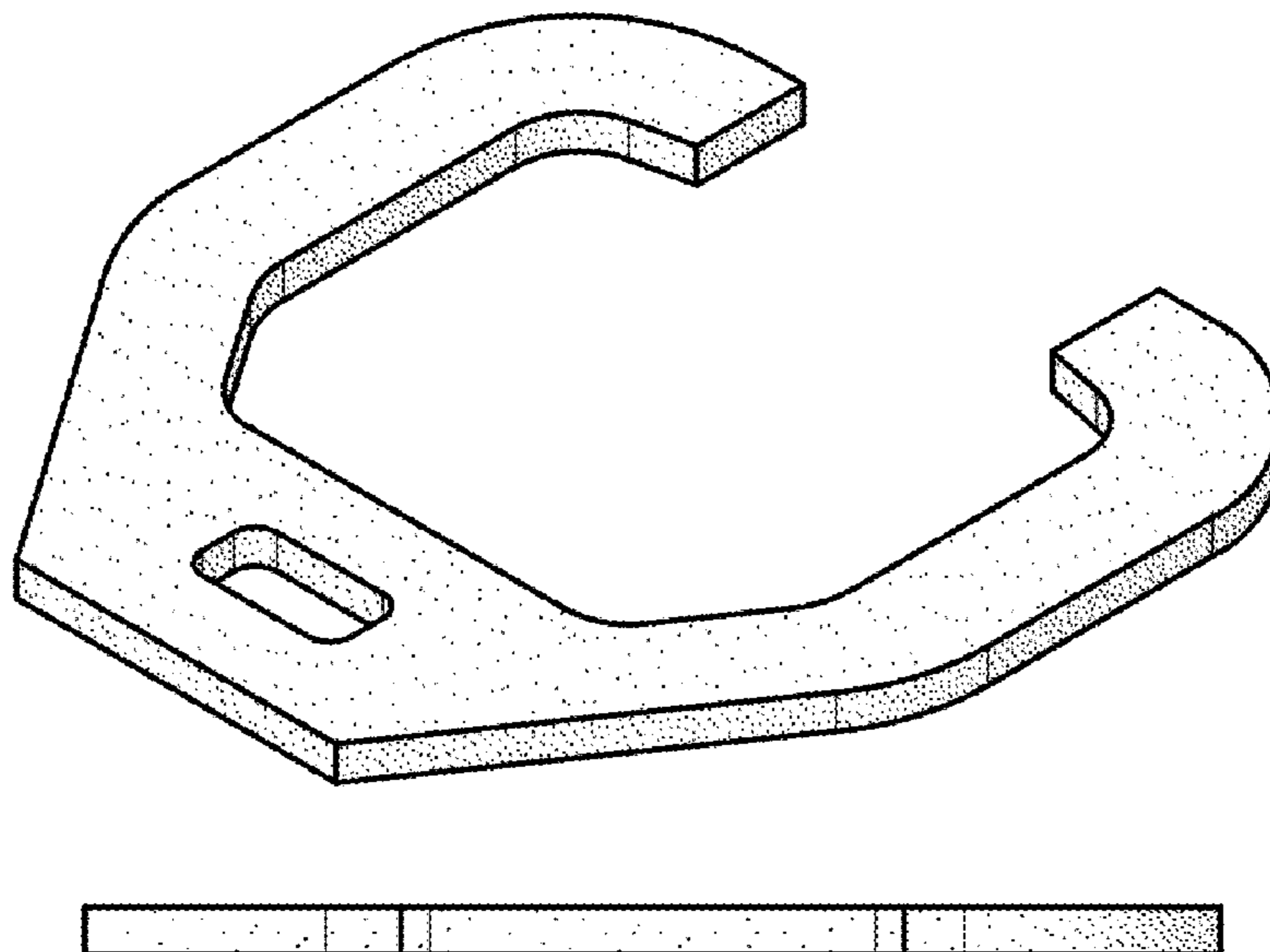

**FIG.1**

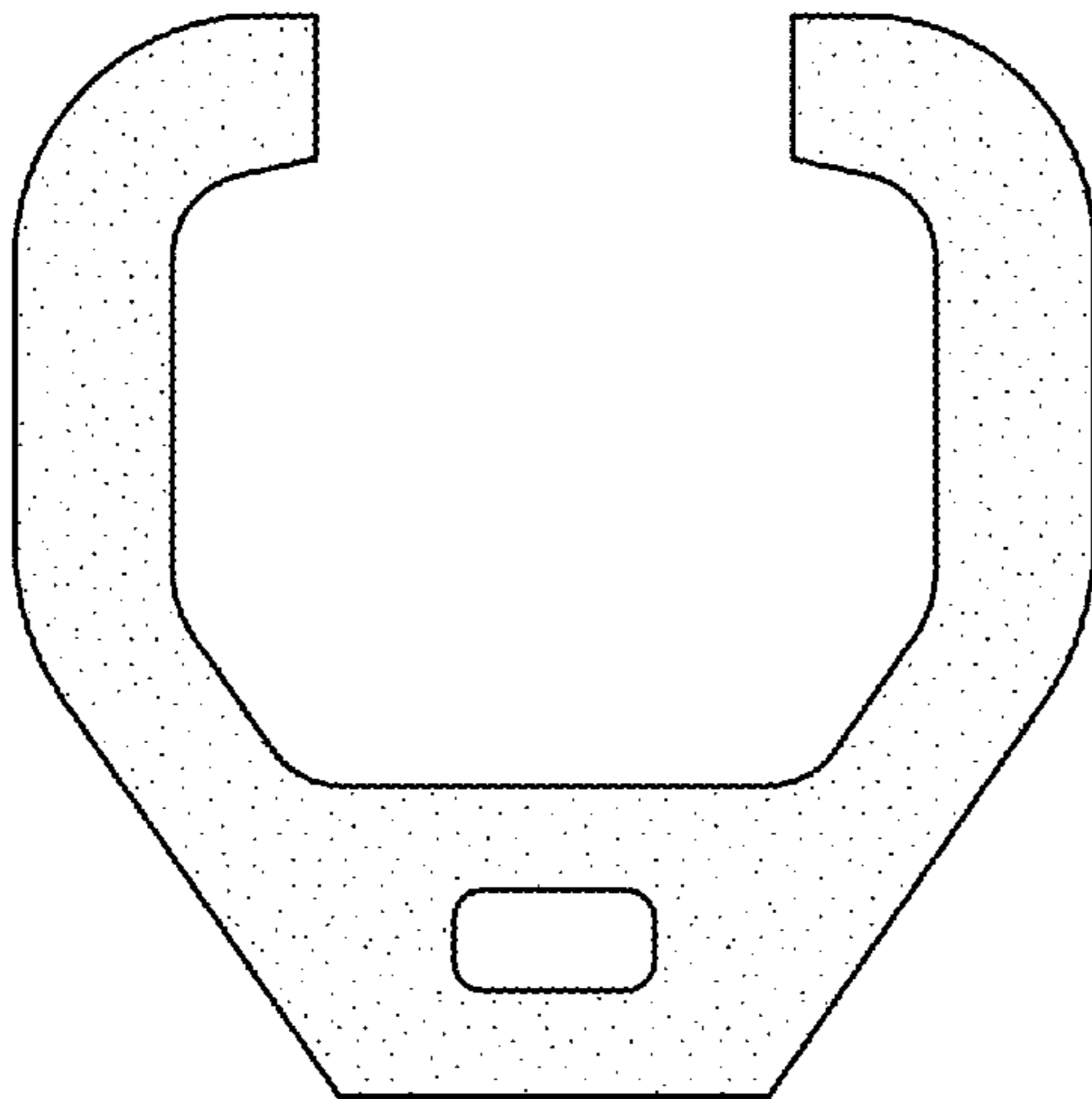
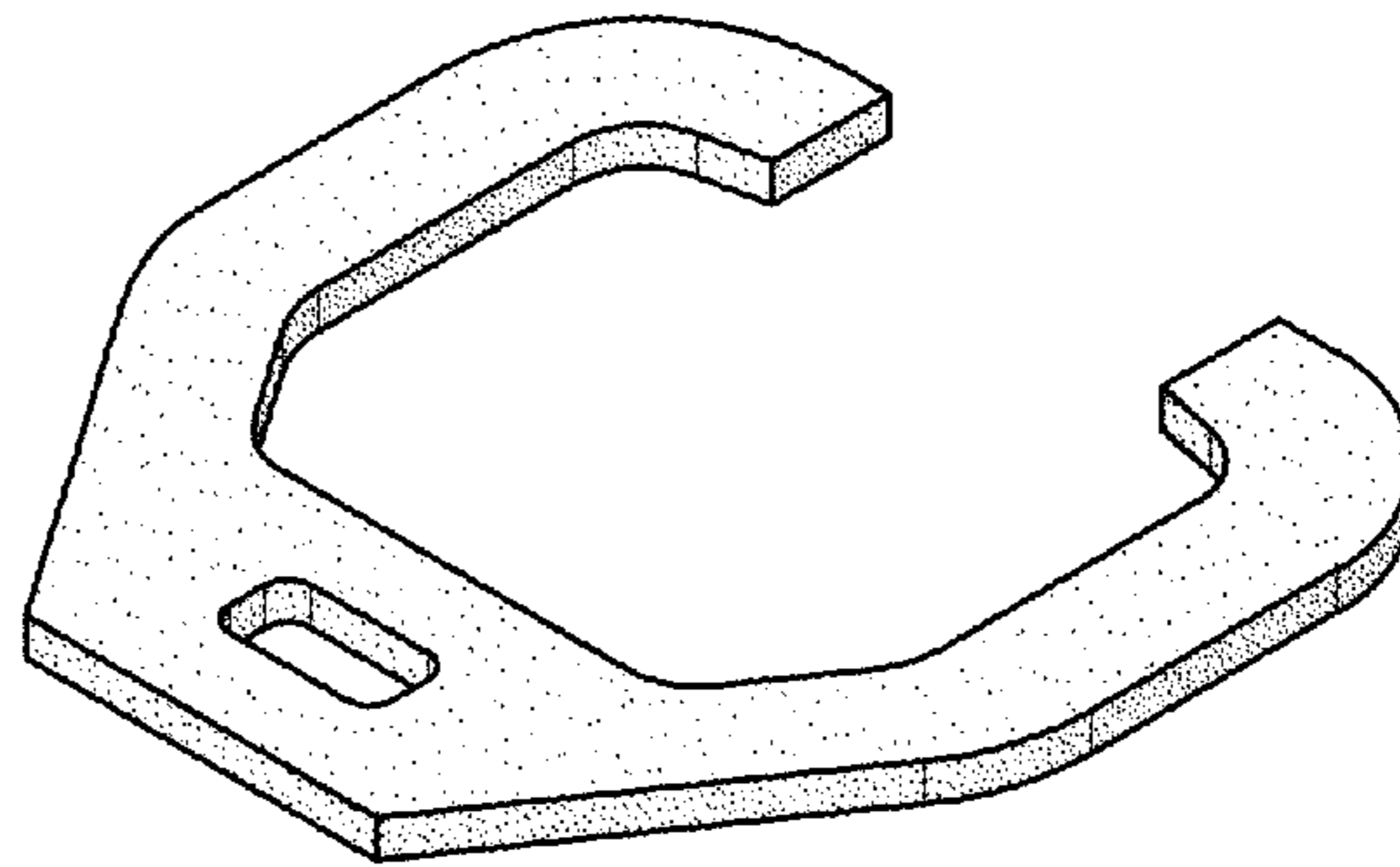

**FIG.2**

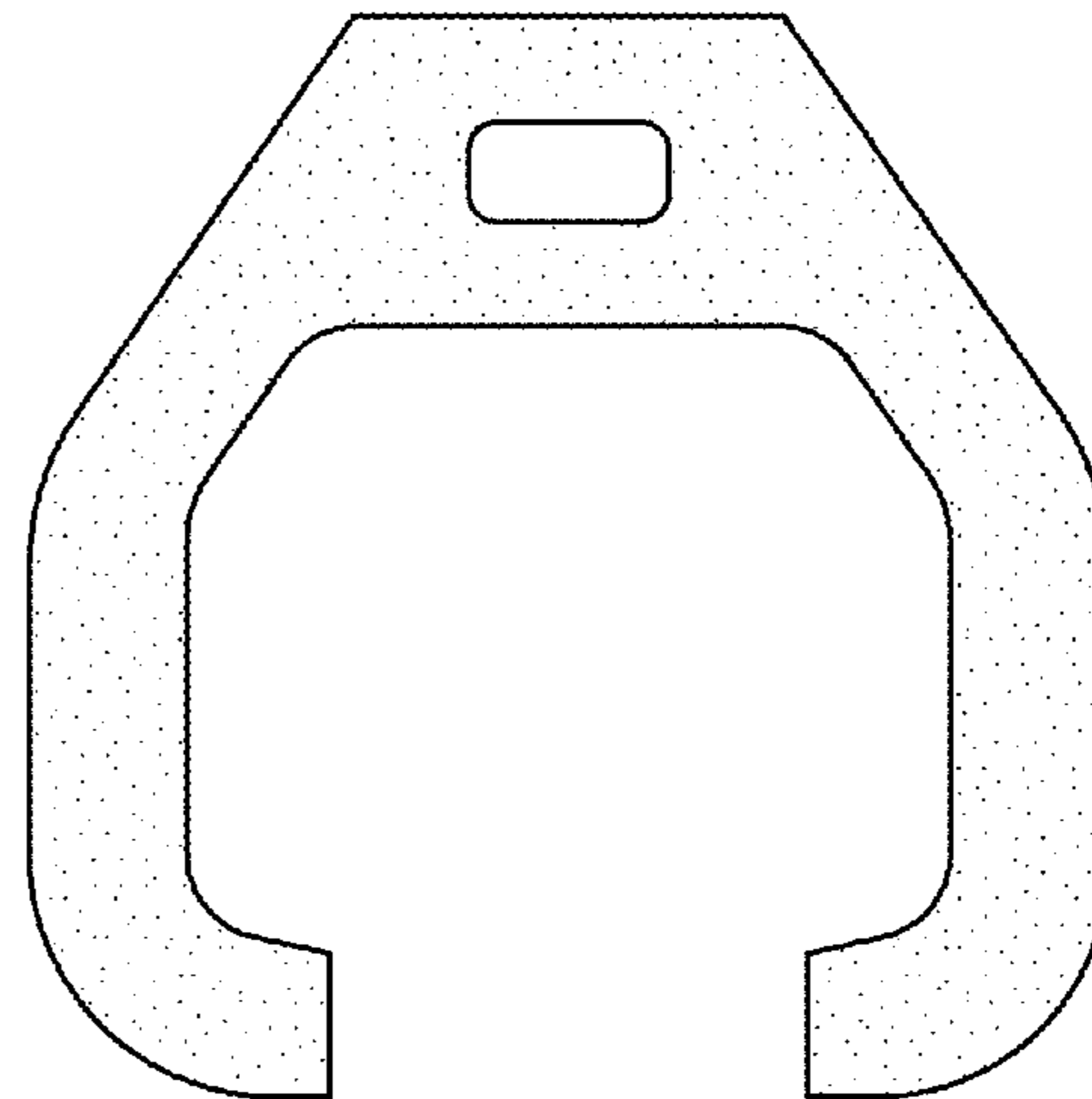

**FIG.3**

