



US00D755365S

(12) **United States Design Patent**
Stevens

(10) **Patent No.:** **US D755,365 S**

(45) **Date of Patent:** **** May 3, 2016**

(54) **HVAC RADIUS RETURN AIR BOX WITH A SQUARE THROAT**

(71) Applicant: **Craig Stevens**, Rochester, NY (US)

(72) Inventor: **Craig Stevens**, Rochester, NY (US)

(73) Assignee: **Craig Stevens**, Rochester, NY (US)

(**) Term: **14 Years**

(21) Appl. No.: **29/497,576**

(22) Filed: **Jul. 25, 2014**

(51) **LOC (10) Cl.** **23-04**

(52) **U.S. Cl.**
USPC **D23/393**

(58) **Field of Classification Search**
USPC D23/385-395, 397, 370-373, 365, 354,
D23/399-403, 421, 499; 285/229, 189, 183,
285/123.1, 15, 114, 110, 424, 197;
454/309, 275-277, 284, 287-291,
454/358-363; 52/302.1, 32.07
CPC F26B 3/04; F26B 21/004; E04B 5/48;
F24D 5/02

See application file for complete search history.

(56) **References Cited**

U.S. PATENT DOCUMENTS

D80,763 S * 3/1930 Betz D23/351
2,447,472 A * 8/1948 Donley F24F 7/02
454/366
2,741,972 A * 4/1956 Pryne F23L 17/03
454/27

D192,946 S * 5/1962 Parsons D23/351
3,919,927 A * 11/1975 Bernard, Jr. B60H 1/262
454/104
D295,216 S * 4/1988 Morris D23/355
D378,125 S * 2/1997 Vannier D23/364
D397,202 S * 8/1998 Saar D23/387
D448,468 S * 9/2001 Koessler D23/373
7,334,420 B1 * 2/2008 Garris F24F 13/32
454/365
D674,077 S * 1/2013 Miyake D23/372
2006/0025067 A1 * 2/2006 Koessler F24F 7/02
454/359
2015/0241122 A1 * 8/2015 Cross F26B 3/04
34/218

* cited by examiner

Primary Examiner — David Muller

Assistant Examiner — Nathan Johnston

(74) *Attorney, Agent, or Firm* — William N. Hulsey, III;
Jeffrey D. Hunt; Hulsey Hunt & Parks, P.C.

(57) **CLAIM**

The ornamental design for an HVAC radius return air box with a square throat, as shown and described.

DESCRIPTION

FIG. 1 depicts an isometric view of an HVAC radius return air box with a square throat showing my new design.

FIG. 2 depicts an alternative isometric view thereof.

FIG. 3 depicts a side elevation view thereof.

FIG. 4 depicts a side elevation view thereof.

FIG. 5 depicts a side elevation view thereof.

FIG. 6 depicts a top plan view thereof; and,

FIG. 7 depicts a bottom plan view thereof.

1 Claim, 7 Drawing Sheets

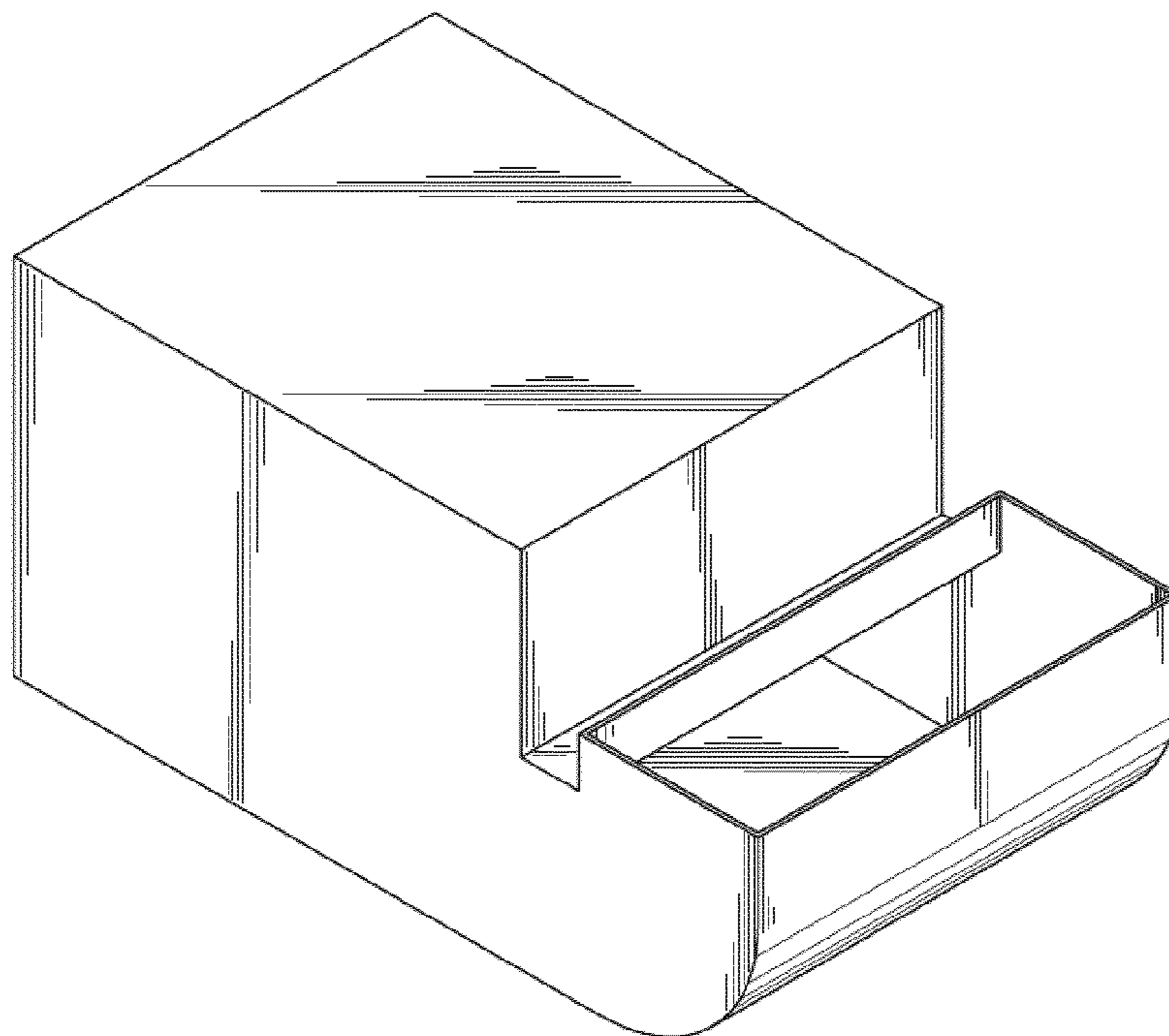

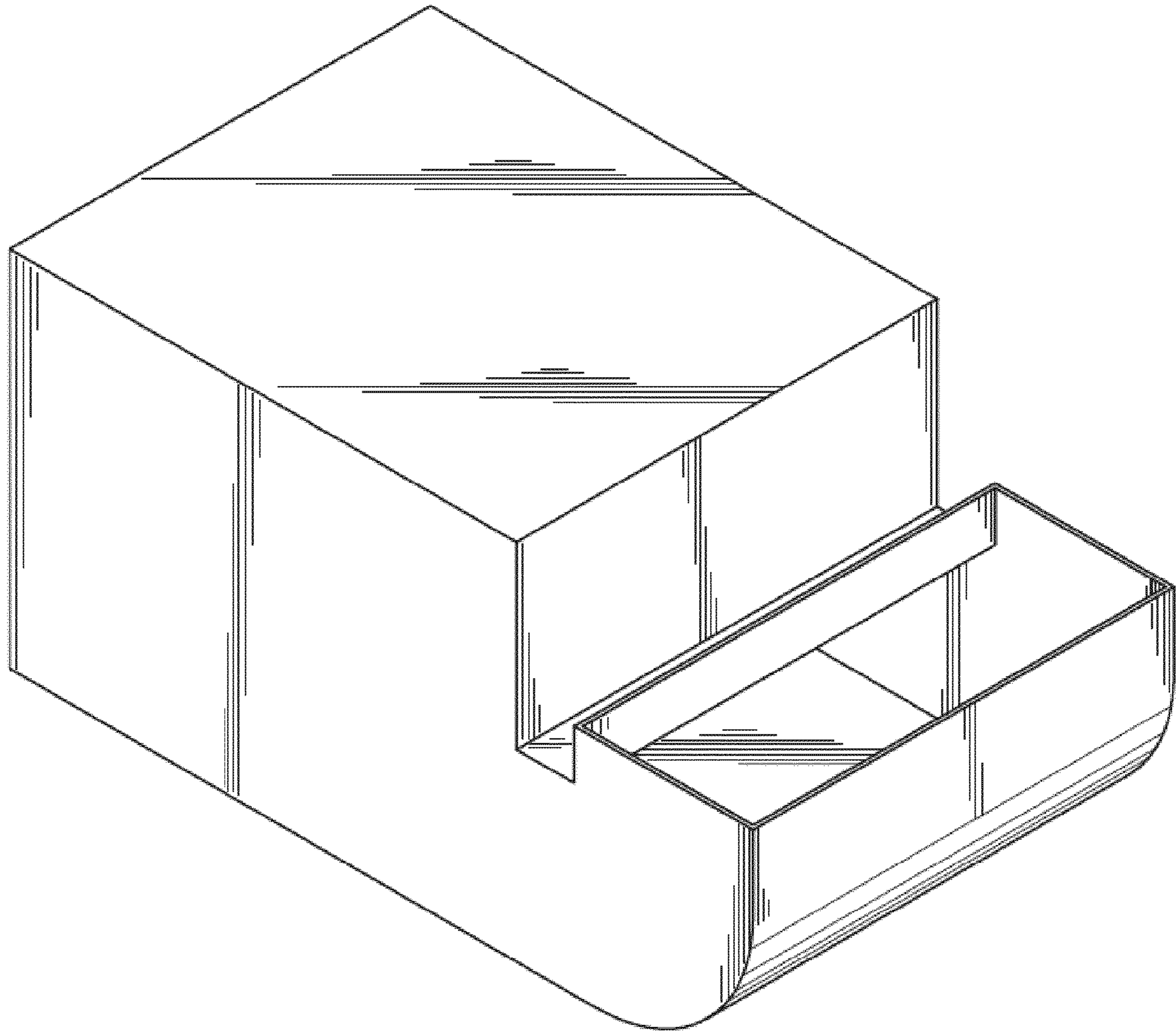

FIG. 1

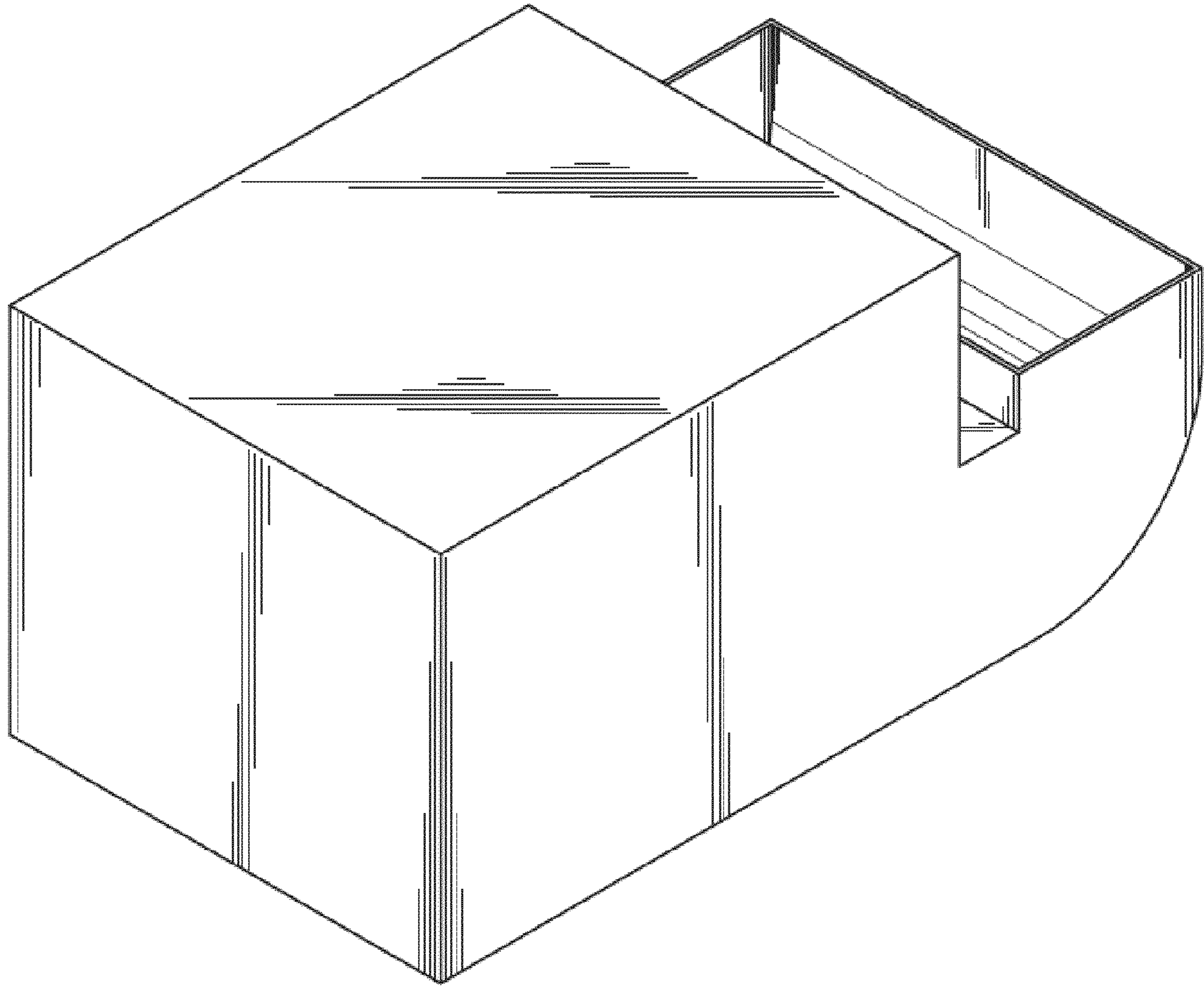

FIG. 2

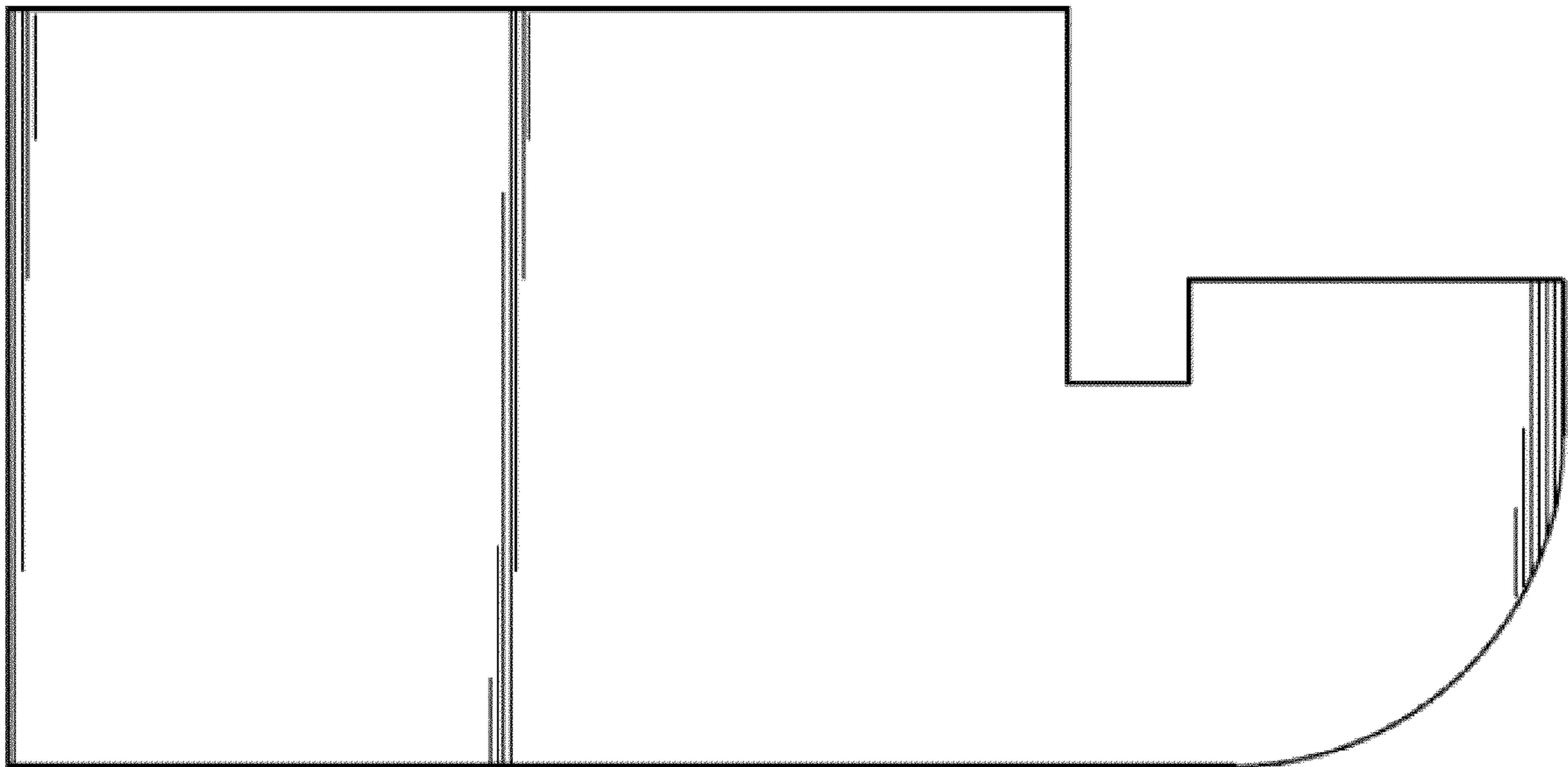

FIG. 3

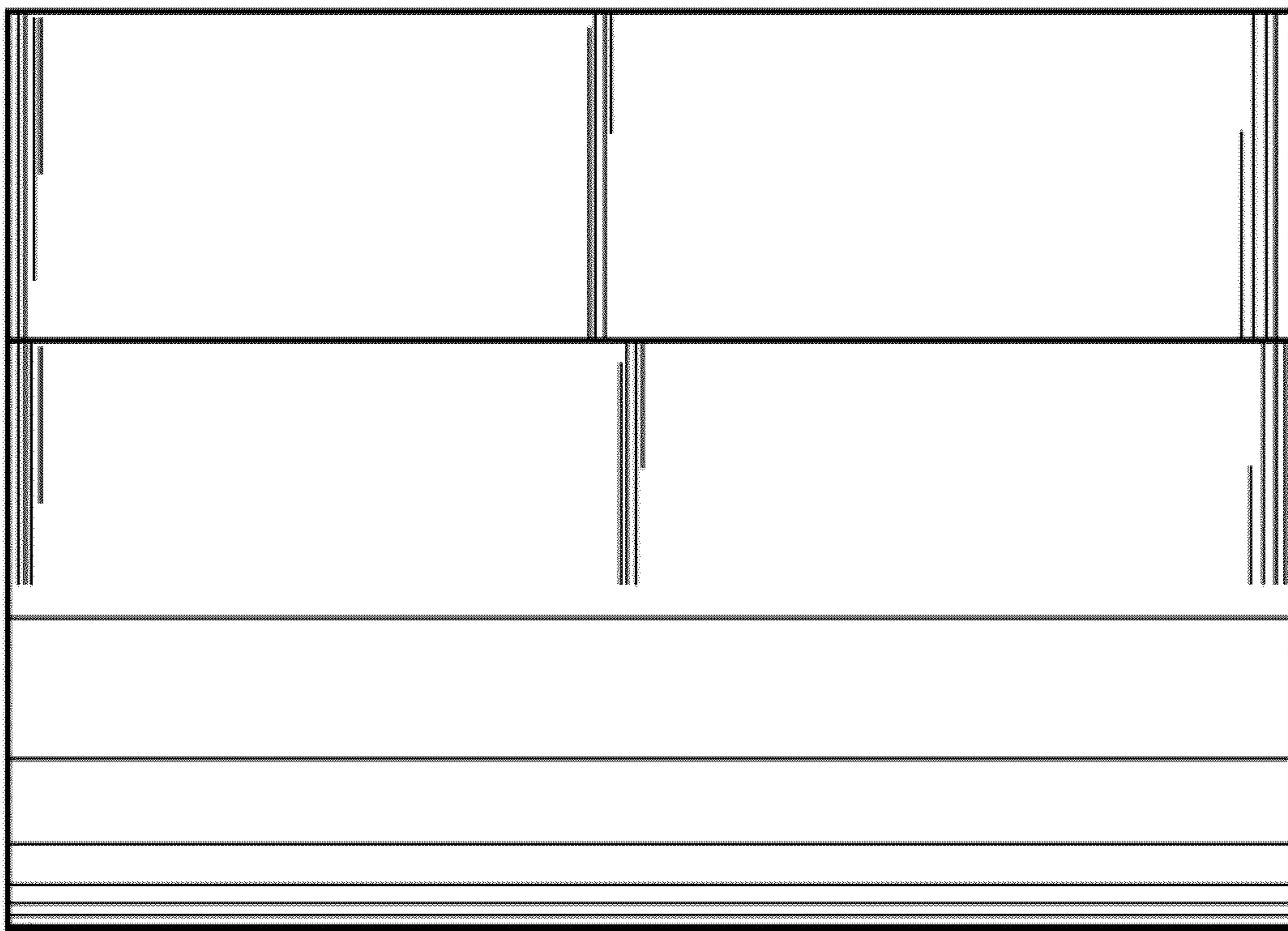

FIG. 4

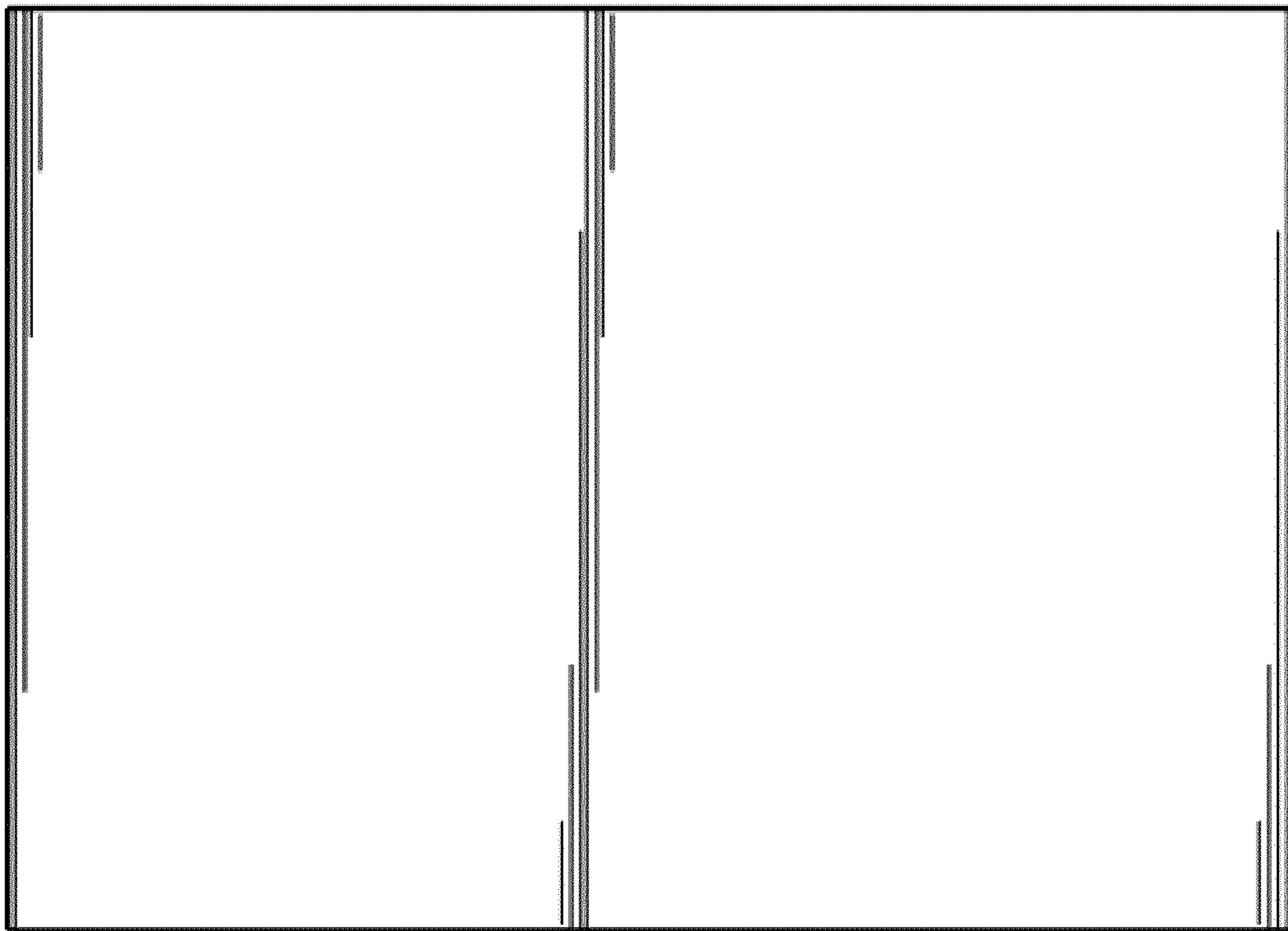

FIG. 5

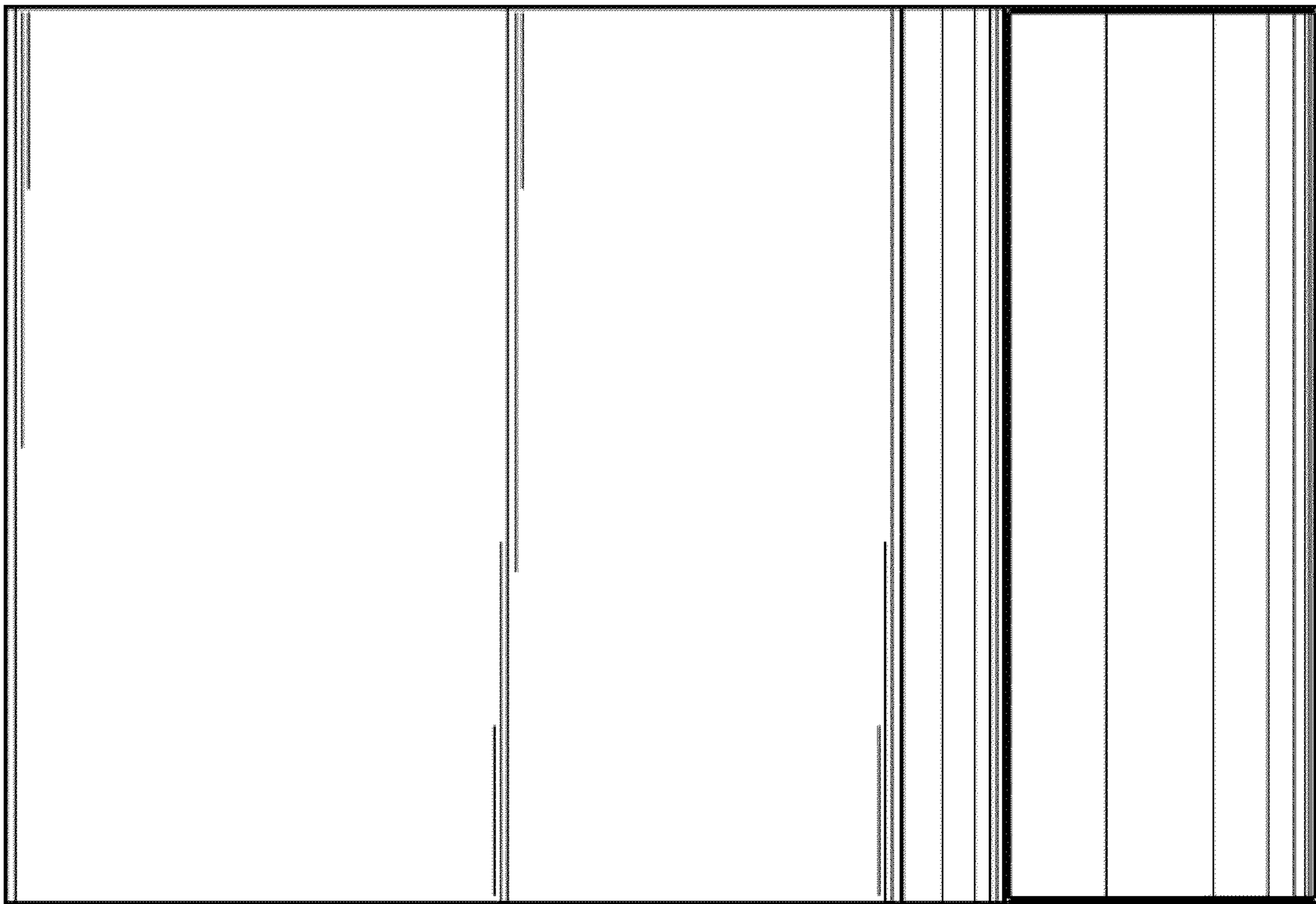

FIG. 6

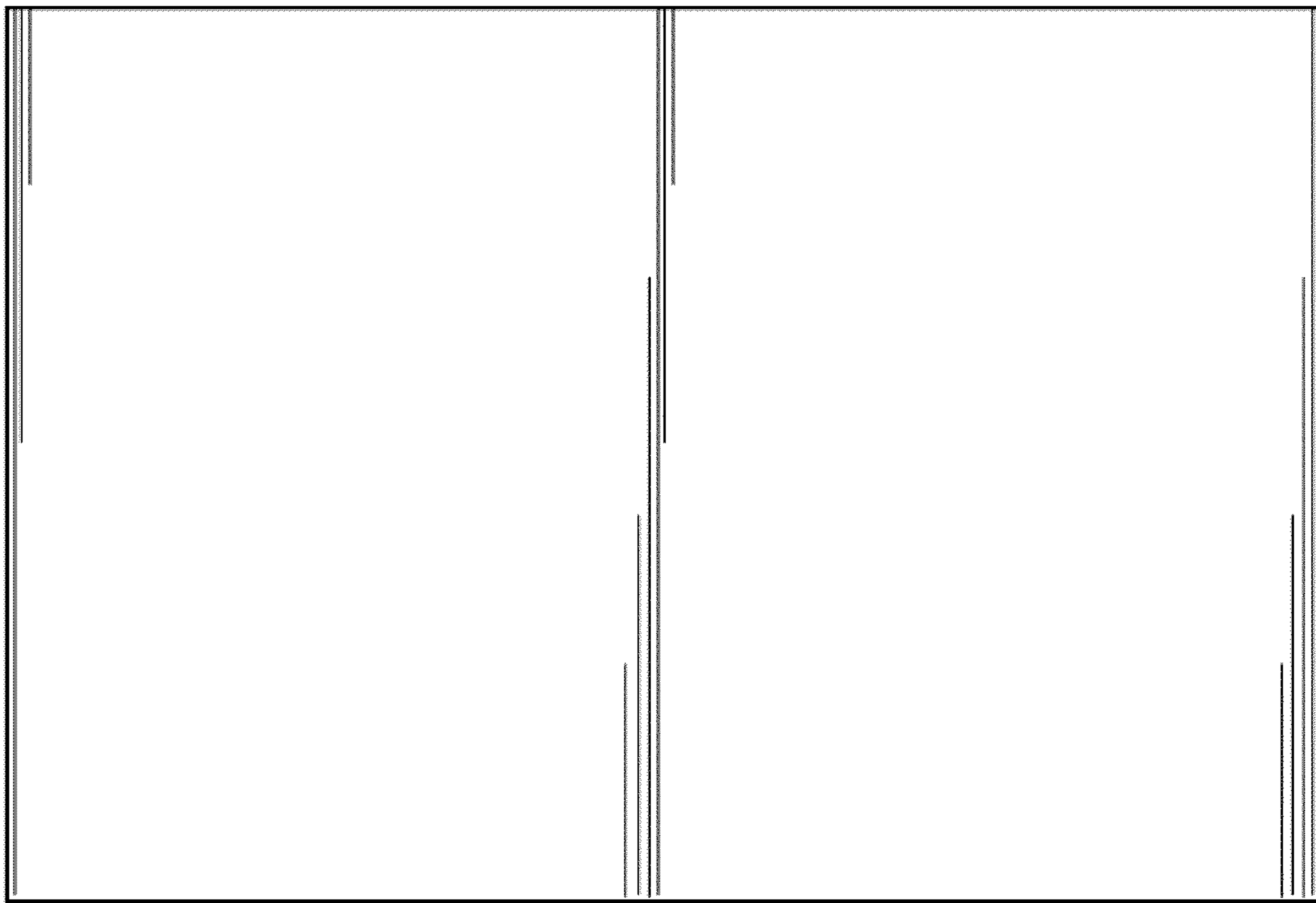

FIG. 7