



US00D754146S

(12) **United States Design Patent**
Giles et al.

(10) **Patent No.:** **US D754,146 S**
(45) **Date of Patent:** **** Apr. 19, 2016**

(54) **DISPLAY SCREEN WITH GRAPHICAL USER INTERFACE**

(71) Applicant: **Microsoft Corporation**, Redmond, WA (US)

(72) Inventors: **Jason Giles**, Seattle, WA (US); **Jeff Fleischmann**, Seattle, WA (US); **Joseph Wheeler**, Sammamish, WA (US)

(73) Assignee: **Microsoft Corporation**, Redmond, WA (US)

(**) Term: **14 Years**

(21) Appl. No.: **29/490,757**

(22) Filed: **May 13, 2014**

(51) **LOC (10) Cl.** **14-04**

(52) **U.S. Cl.**
USPC **D14/485**

(58) **Field of Classification Search**
USPC D14/485-496

CPC ... G06F 3/048; G06F 3/0481; G06F 3/04812; G06F 3/04815; G06F 3/04817; G06F 3/0482; G06F 3/0483; G06F 3/0484; G06F 3/04842; G06F 3/04845; G06F 3/04847; G06F 3/0485; G06F 3/04855; G06F 3/0486; G06F 3/0487; G06F 3/0488; G06F 3/04883; G06F 3/04886

See application file for complete search history.

(56) **References Cited**

U.S. PATENT DOCUMENTS

D594,020 S	6/2009	Ball et al.
D629,417 S	12/2010	Weir et al.
D645,469 S	9/2011	Gardner et al.
D655,301 S	3/2012	Ray et al.
D655,304 S	3/2012	Zaman et al.
D655,712 S	3/2012	Ray et al.
D655,713 S	3/2012	Ray et al.
D655,714 S	3/2012	Ray et al.

D655,715 S	3/2012	Ray et al.	
D655,716 S	3/2012	Ray et al.	
D655,717 S	3/2012	Ray et al.	
D655,718 S	3/2012	Ray et al.	
D656,511 S	3/2012	Hally et al.	
D658,670 S	5/2012	Ray et al.	
D658,672 S	* 5/2012	Ray	D14/486
D658,673 S	* 5/2012	Velasco	D14/488
D664,152 S	7/2012	Ray et al.	
D664,970 S	8/2012	Ray et al.	
D681,050 S	4/2013	Ray et al.	
D684,988 S	* 6/2013	Gardner	D14/486
D685,389 S	* 7/2013	Gardner	D14/486
D686,231 S	* 7/2013	Rodenhous	D14/486
D687,051 S	* 7/2013	Gardner	D14/486
D687,052 S	* 7/2013	Gardner	D14/486
D687,053 S	* 7/2013	Rodenhous	D14/486
D687,054 S	* 7/2013	Rodenhous	D14/486
D687,055 S	* 7/2013	Rodenhous	D14/486
D693,360 S	* 11/2013	Gardner	D14/486
D694,775 S	* 12/2013	Gardner	D14/486
D695,302 S	* 12/2013	Rodenhous	D14/486

(Continued)

Primary Examiner — Eric Goodman

Assistant Examiner — Christian P McLean

(74) *Attorney, Agent, or Firm* — Banner & Witcoff, Ltd.

(57) **CLAIM**

The ornamental design for a display screen with graphical user interface, as shown and described.

DESCRIPTION

FIG. 1 is a front view of a display screen with graphical user interface showing our new design; and, FIG. 2 is a front view of the display screen with graphical user interface shown in FIG. 1, with broken line elements omitted for clarity.

The broken line showing of the text, the numerals, the various icons, the various tile portions, the remainder of the user interface and the remainder of the display screen is for environmental purposes only and forms no part of the claimed design.

1 Claim, 2 Drawing Sheets

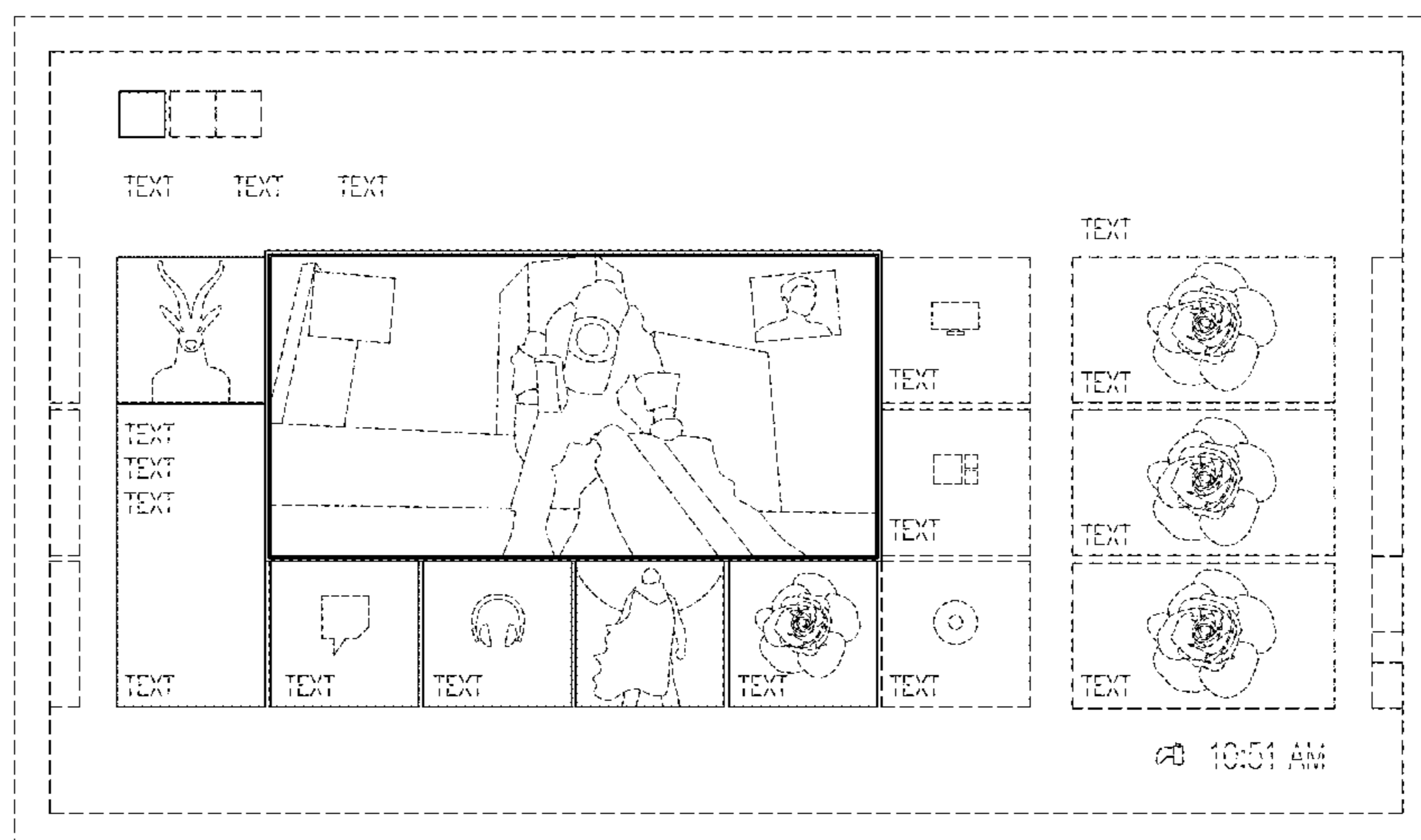

US D754,146 S

Page 2

(56)

References Cited

U.S. PATENT DOCUMENTS

D695,774 S	*	12/2013	Rodenhous	D14/486	
D697,077 S	*	1/2014	Rodenhous	D14/486	* cited by examiner
D698,812 S	*	2/2014	Gardner	D14/488	
D715,821 S	*	10/2014	Varon	D14/486	
D737,315 S	*	8/2015	Barling	D14/488	

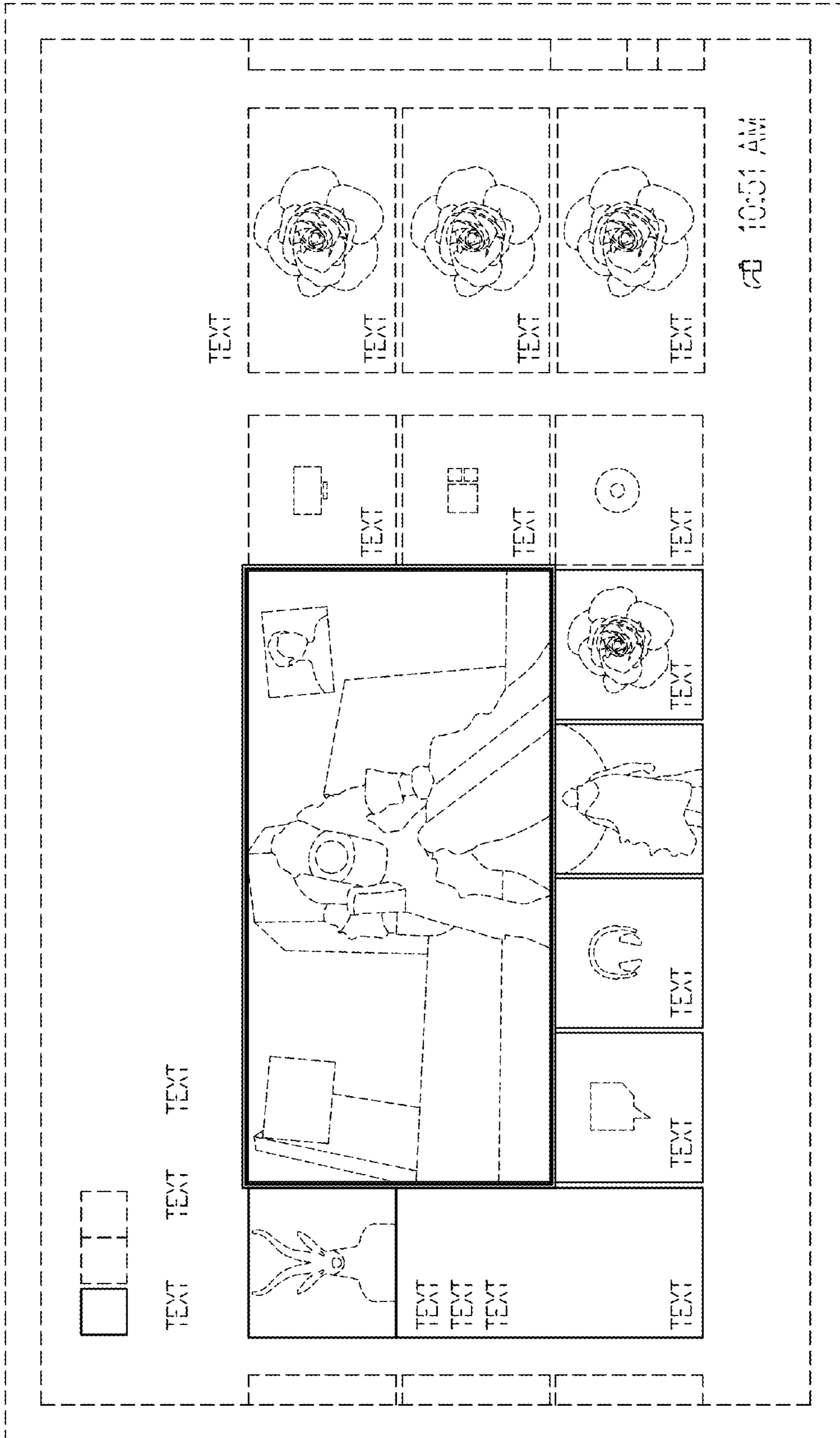

FIG. 1

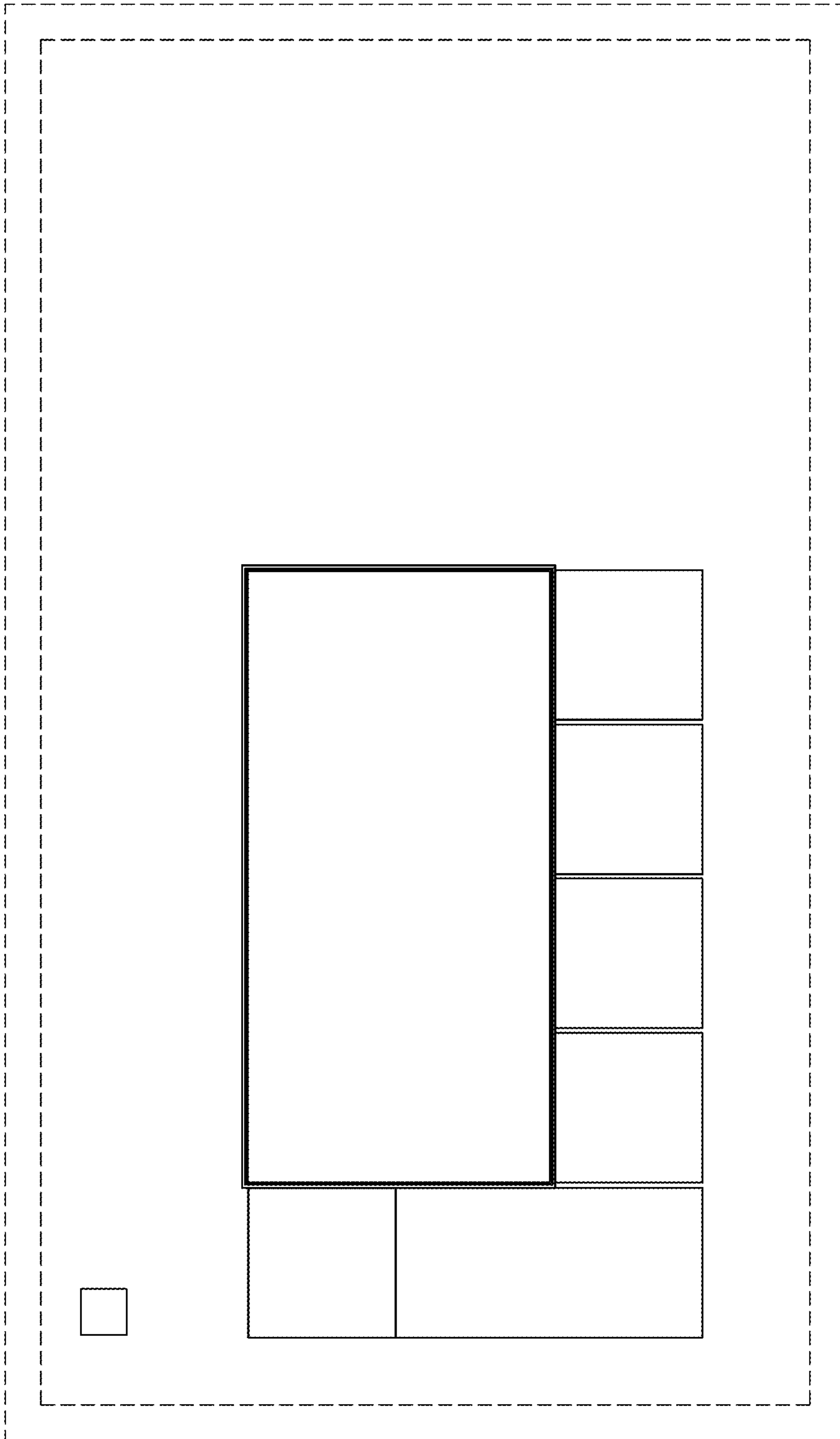

FIG. 2