



US00D753021S

(12) **United States Design Patent**  
**Allen**

(10) **Patent No.:** **US D753,021 S**  
(45) **Date of Patent:** **\*\* Apr. 5, 2016**

(54) **GOLF CART**

(71) Applicant: **Christian Allen**, San Rafael, CA (US)

(72) Inventor: **Christian Allen**, San Rafael, CA (US)

(\*\*) Term: **14 Years**

(21) Appl. No.: **29/450,236**

(22) Filed: **Mar. 15, 2013**

(51) **LOC (10) Cl.** ..... **12-02**

(52) **U.S. Cl.**  
USPC ..... **D12/16**

(58) **Field of Classification Search**  
USPC ..... D12/16, 14, 1, 86, 90, 91, 92, 107, 85,  
D12/88, 82, 87, 110, 114; D21/424, 433,  
D21/435, 550; 224/274; 280/DIG. 5, DIG. 6;  
180/233, 908, 89.1, 89.11, 6.5  
CPC ..... B60R 9/10; B62K 5/00; B62K 5/02;  
B62K 2005/002; B62K 15/006; B62B  
2202/404; B62M 1/10  
See application file for complete search history.

(56) **References Cited**

**U.S. PATENT DOCUMENTS**

D226,079	S	*	1/1973	Gifford	.....	D12/16
3,777,836	A	*	12/1973	Riza	.....	180/213
D242,439	S	*	11/1976	Gervais	.....	D12/16
D255,111	S	*	5/1980	Palmer	.....	D12/110
D275,380	S	*	9/1984	Flowers, Sr.	.....	D12/85
D301,128	S	*	5/1989	Simon	.....	D12/15
4,852,898	A	*	8/1989	Donoghue et al.	.....	280/216
D337,553	S	*	7/1993	Valentine et al.	.....	D12/107

5,727,642	A	*	3/1998	Abbott	.....	180/65.1
5,788,254	A	*	8/1998	Davis	.....	280/282
D437,364	S	*	2/2001	Jang	.....	D21/433
D464,289	S	*	10/2002	Jager	.....	D12/1
D606,899	S	*	12/2009	Gal et al.	.....	D12/1
D639,711	S	*	6/2011	Chartrand	.....	D12/107
7,954,838	B1	*	6/2011	Long	.....	280/288.4
D694,669	S	*	12/2013	Schwenk	.....	D12/16
2006/0151224	A1	*	7/2006	Vasser	.....	180/205
2010/0314179	A1	*	12/2010	Gibson	.....	180/2.2

\* cited by examiner

*Primary Examiner* — Eric Goodman

*Assistant Examiner* — Clese Moore, Jr.

(74) *Attorney, Agent, or Firm* — Jay P. Hendrickson

(57) **CLAIM**

The ornamental design for a golf cart, as shown.

**DESCRIPTION**

FIG. 1 is a front perspective view of a golf cart showing the design.

FIG. 2 is a front elevational view of the golf cart showing the design.

FIG. 3 is a right side elevational view of the golf cart showing the design.

FIG. 4 is rear elevational view of the golf cart showing the design.

FIG. 5 is a left side elevational view of the golf cart showing the design.

FIG. 6 is a top plan view of the golf cart showing the design; and,

FIG. 7 is a bottom plan view of the golf cart showing the design.

**1 Claim, 6 Drawing Sheets**

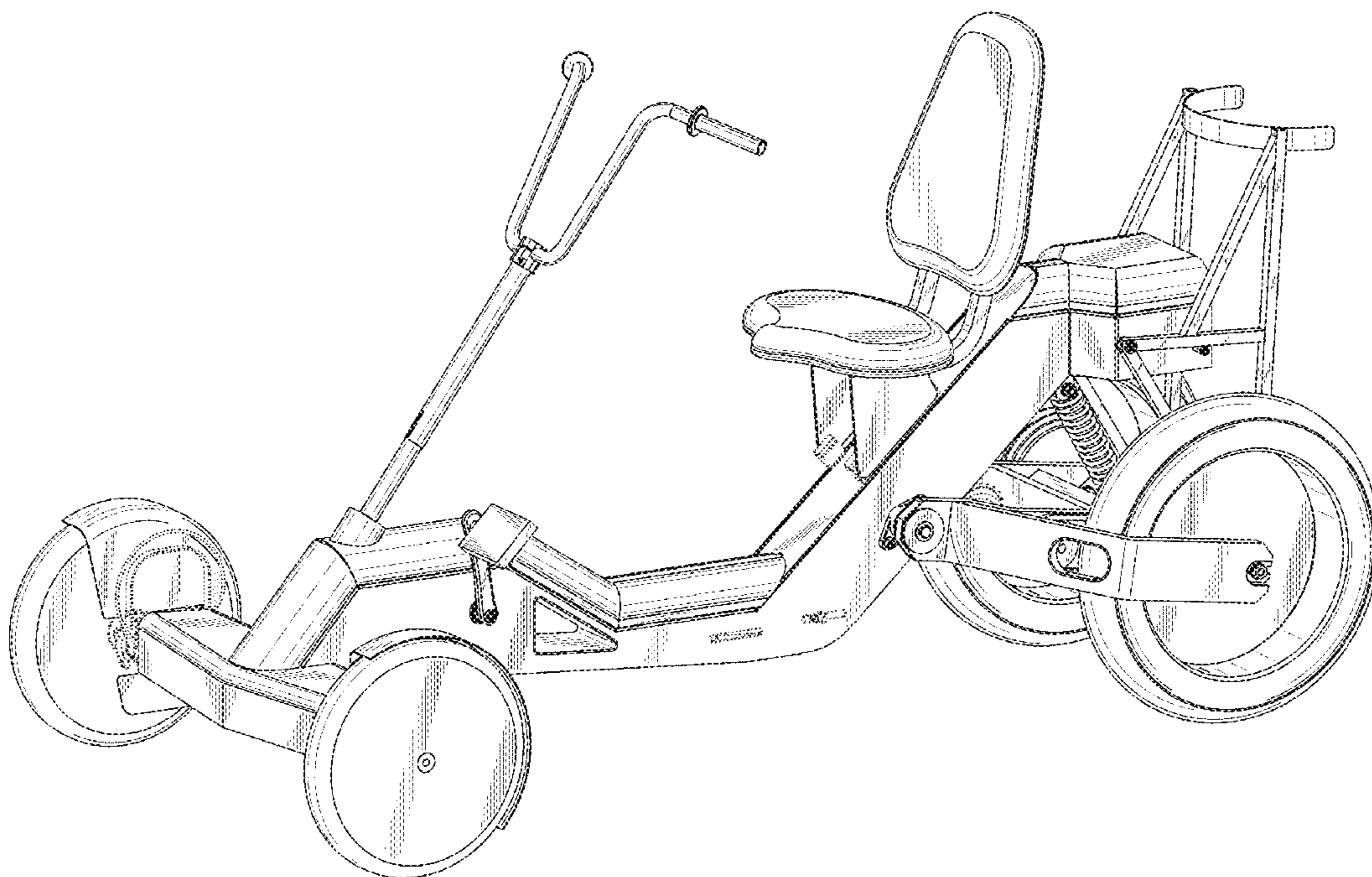

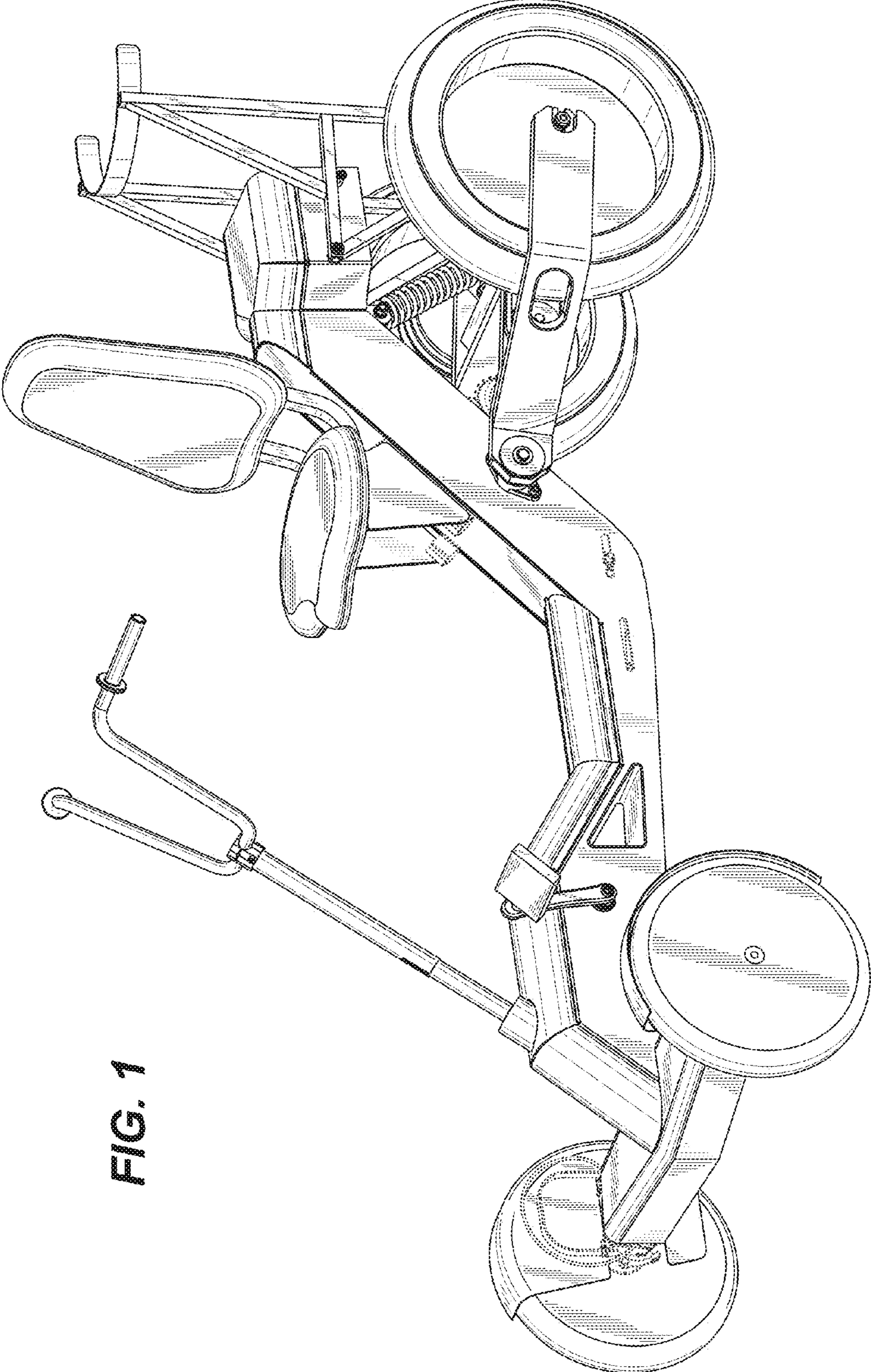

FIG. 1

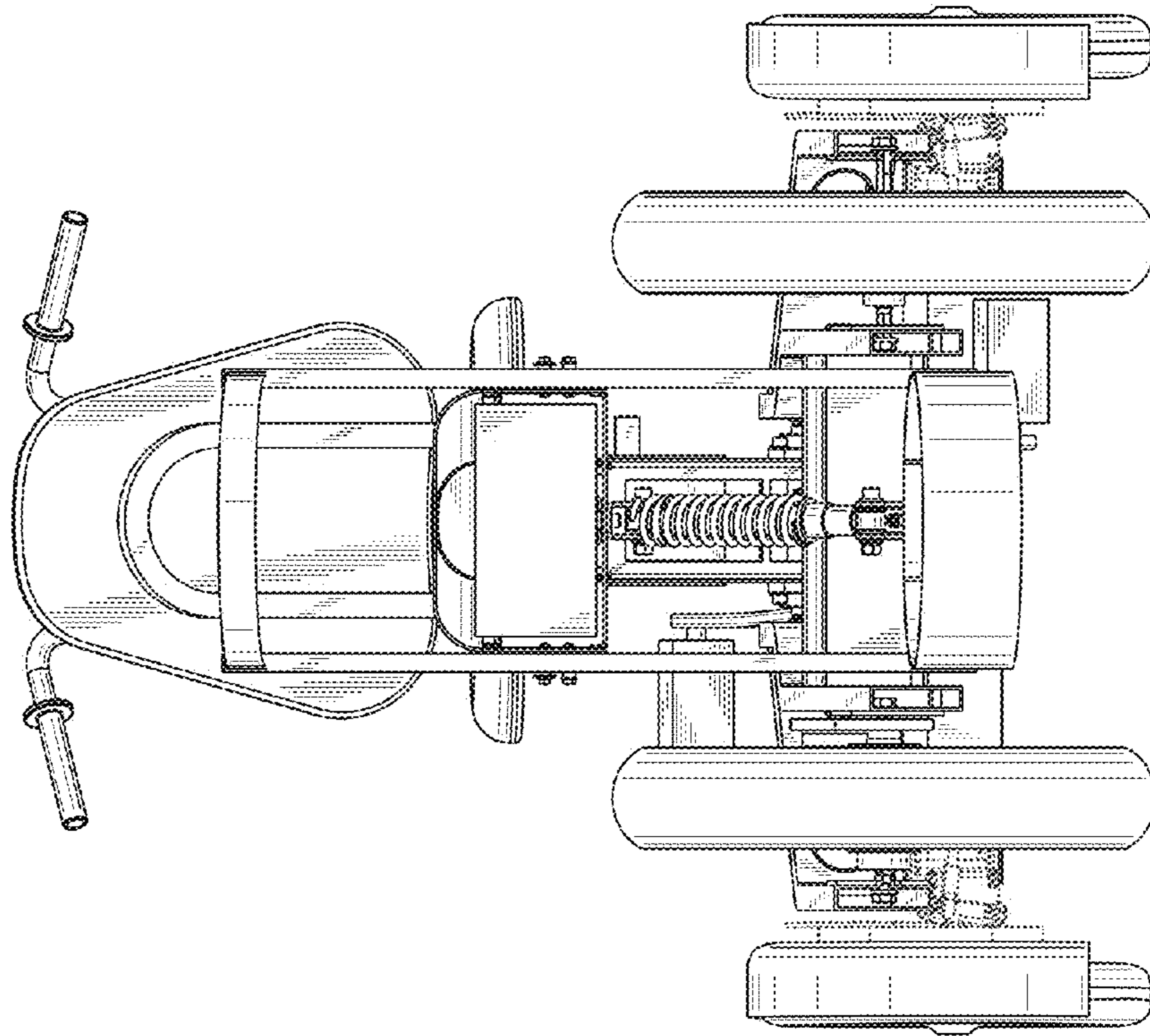

FIG. 4

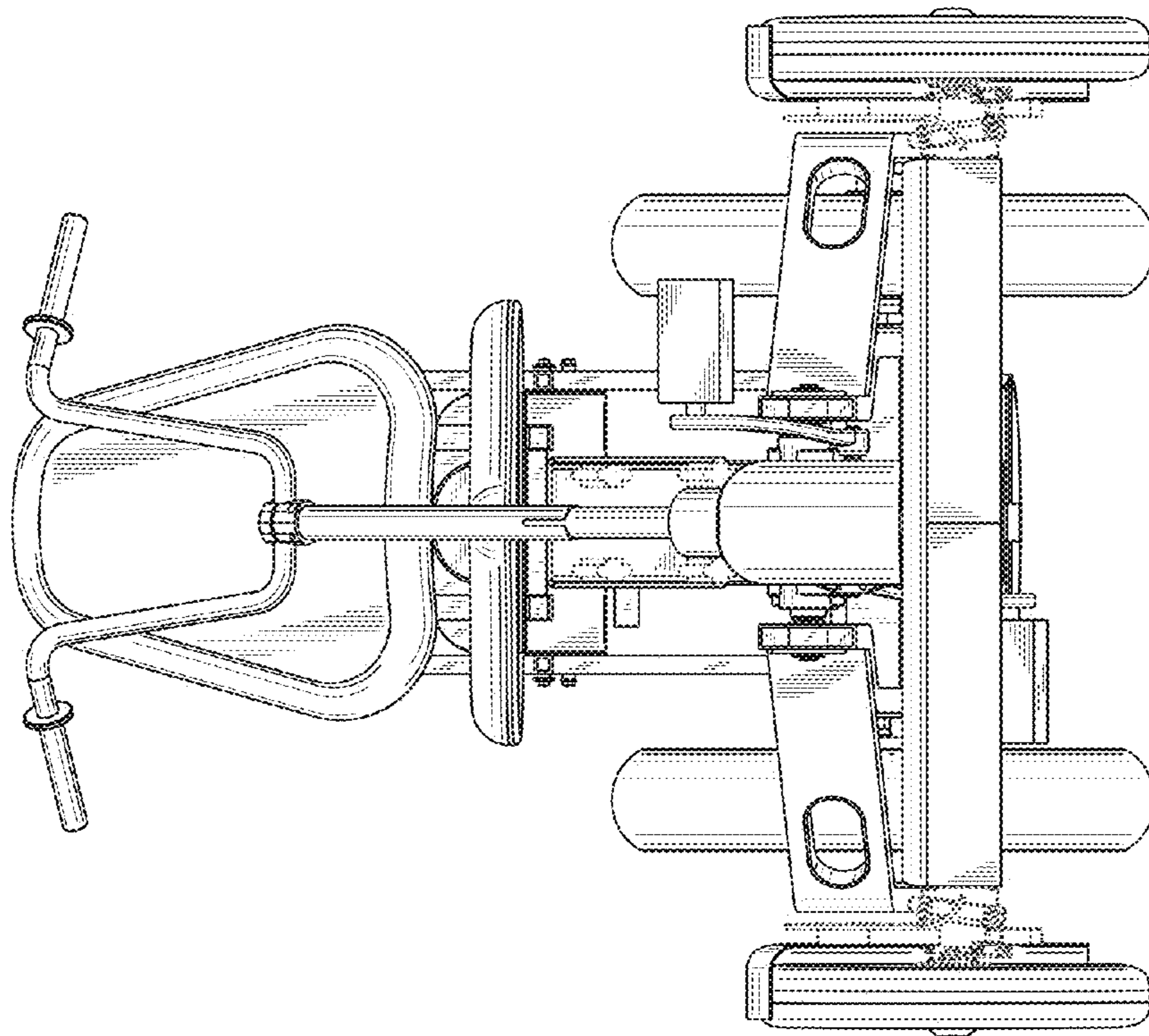

FIG. 2

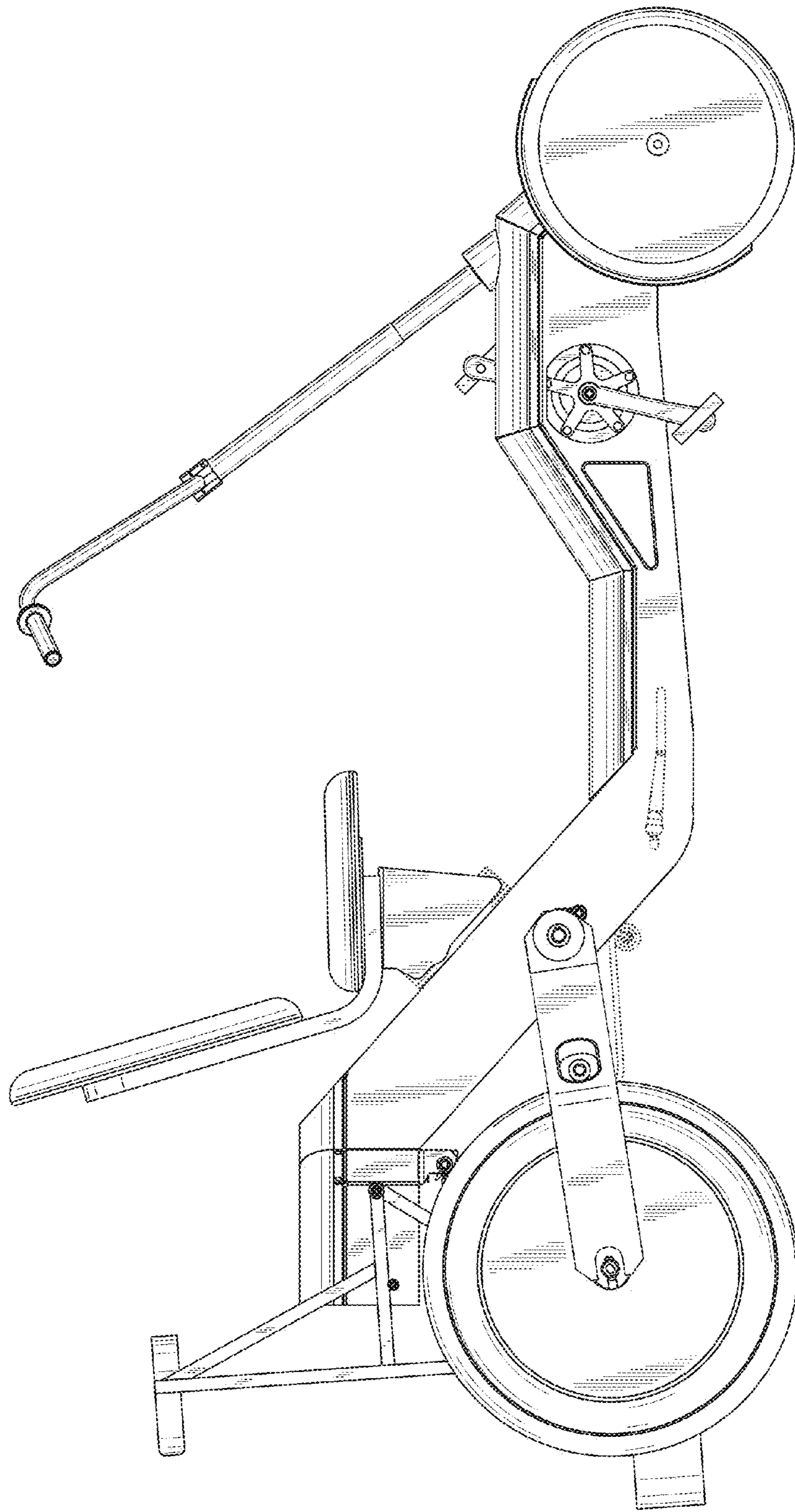

FIG. 3

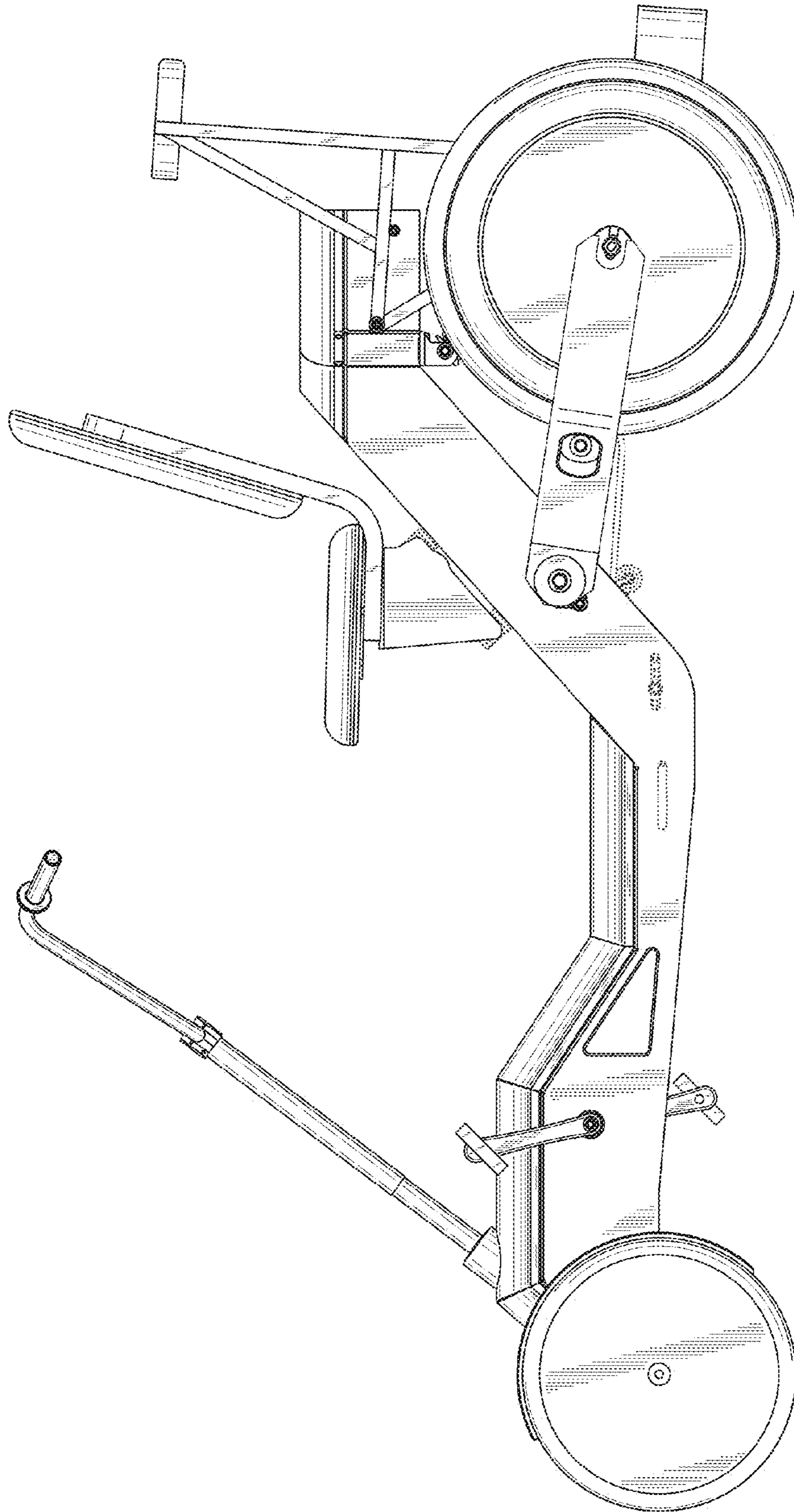
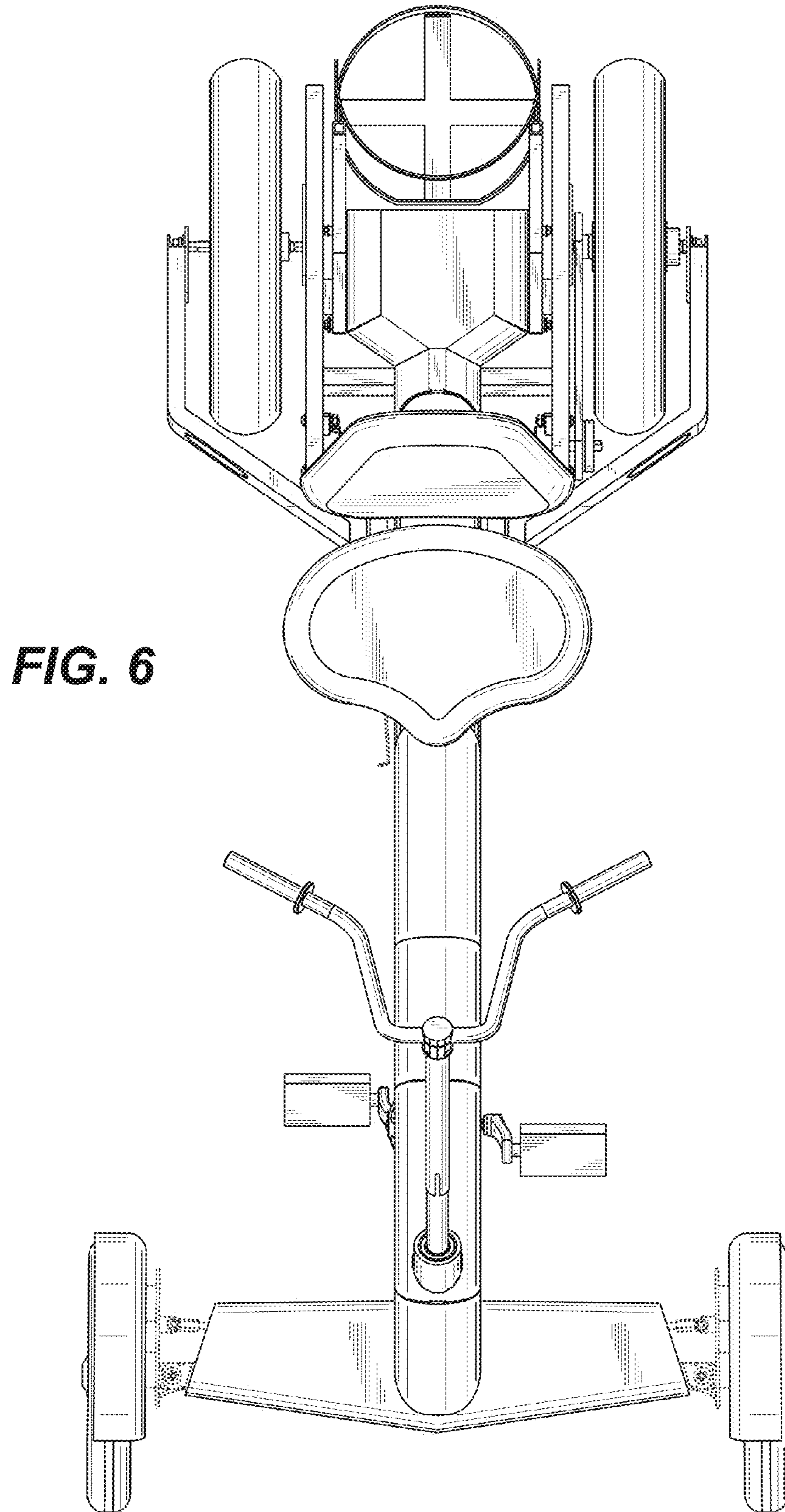

FIG. 5



**FIG. 7**

