



US00D752500S

(12) **United States Design Patent**
Woods

(10) **Patent No.:** **US D752,500 S**
(45) **Date of Patent:** **** Mar. 29, 2016**

- (54) **SELF-PROPELLED PERSONAL WATERCRAFT**
- (71) Applicant: **Inventive Design Group Inc.,**
Sacramento, CA (US)
- (72) Inventor: **Jason Daniel Woods, Pleasanton, CA**
(US)
- (73) Assignee: **Inventive Design Group Inc.,**
Sacramento, CA (US)
- (**) Term: **14 Years**
- (21) Appl. No.: **29/486,394**
- (22) Filed: **Mar. 28, 2014**
- (51) **LOC (10) Cl.** **12-06**
- (52) **U.S. Cl.**
USPC **D12/316; D12/307**
- (58) **Field of Classification Search**
USPC D12/300, 316, 317; D21/769, 770, 801,
D21/803, 810; 114/55.5, 55.51, 55.58, 66,
114/242, 253, 345; 440/1, 6, 84, 87
CPC B63B 7/00; B63B 7/04; B63B 35/00;
B63B 35/73; B63B 35/66; B63B 35/665;
B63B 35/12; B63H 20/00; B63H 20/04
See application file for complete search history.

- D221,485 S * 8/1971 Hutcheson et al. D12/307
- D245,973 S * 10/1977 Vasilatos et al. D12/307
- D245,974 S * 10/1977 Vasilatos et al. D12/307
- 4,350,113 A * 9/1982 Moreau et al. 114/55.56
- D295,279 S * 4/1988 Diamond D12/307
- 5,362,269 A * 11/1994 Leach 441/65
- 5,394,820 A * 3/1995 Dach 114/55.58
- 5,782,664 A * 7/1998 Casters 441/65
- D509,470 S * 9/2005 Weir et al. D12/316
- 7,426,896 B2 * 9/2008 West 114/55.58
- D594,807 S * 6/2009 Smith D12/316

* cited by examiner

Primary Examiner — Cynthia M Chin
(74) *Attorney, Agent, or Firm* — Vested Law LLP

(57) **CLAIM**
The ornamental design for a self-propelled personal watercraft, as shown and described.

DESCRIPTION

FIG. 1 is a right side view of a self-propelled personal watercraft showing my design;
FIG. 2 is a front view thereof;
FIG. 3 is a left side view thereof;
FIG. 4 is a rear view thereof;
FIG. 5 is a top view thereof;
FIG. 6 is a bottom view thereof;
FIG. 7 is a top front perspective view thereof;
FIG. 8 is a top rear perspective view thereof;
FIG. 9 is a bottom rear perspective view thereof; and,
FIG. 10 is a bottom front perspective view thereof.
The portions of the article shown in broken lines form no part of the claimed design.

- (56) **References Cited**
U.S. PATENT DOCUMENTS
3,119,364 A * 1/1964 Brown 440/1
3,270,707 A * 9/1966 Rozanski 440/87
3,324,819 A * 6/1967 Tetyak 440/87
3,371,646 A * 3/1968 Mela 114/55.58

1 Claim, 5 Drawing Sheets

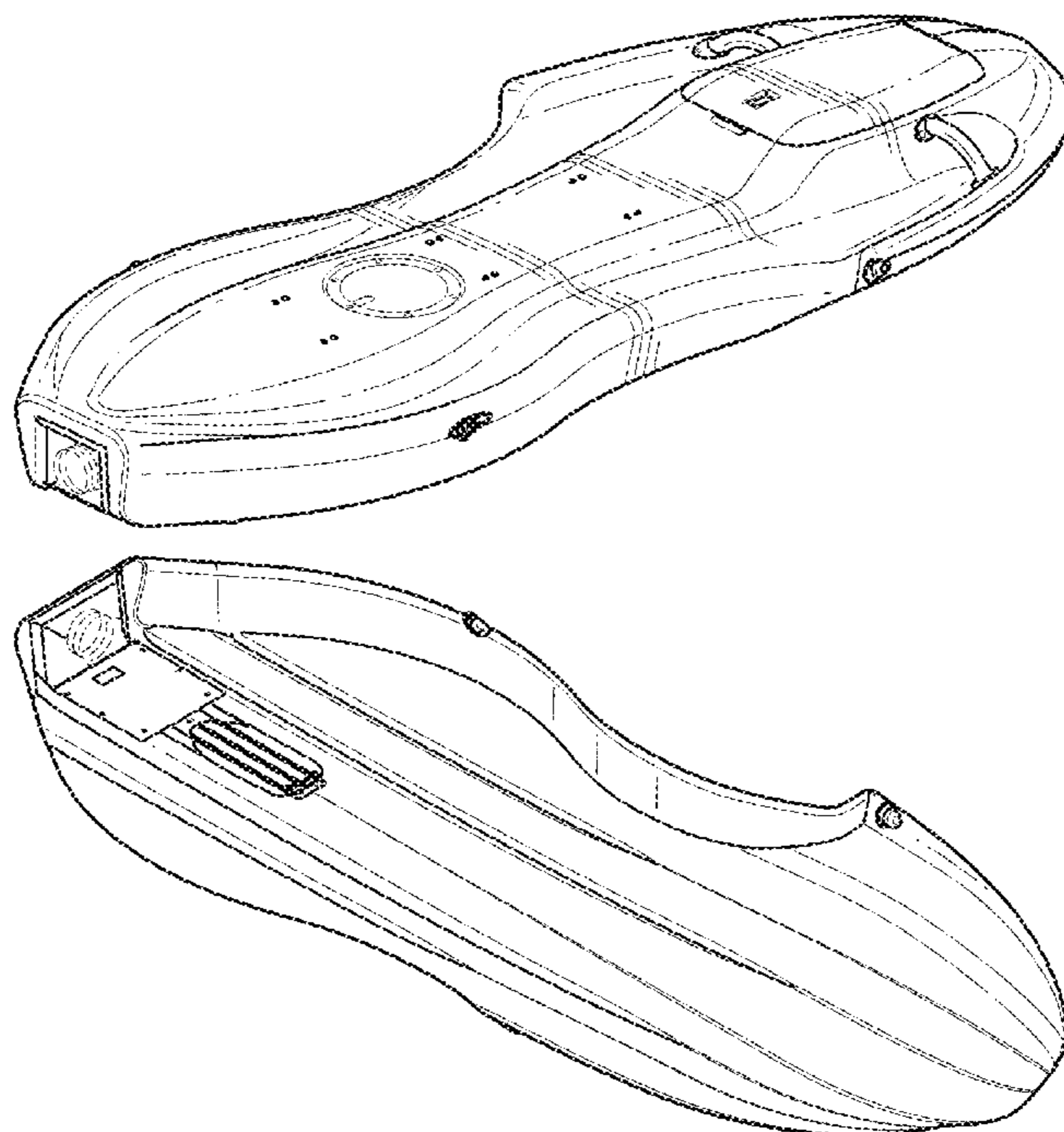

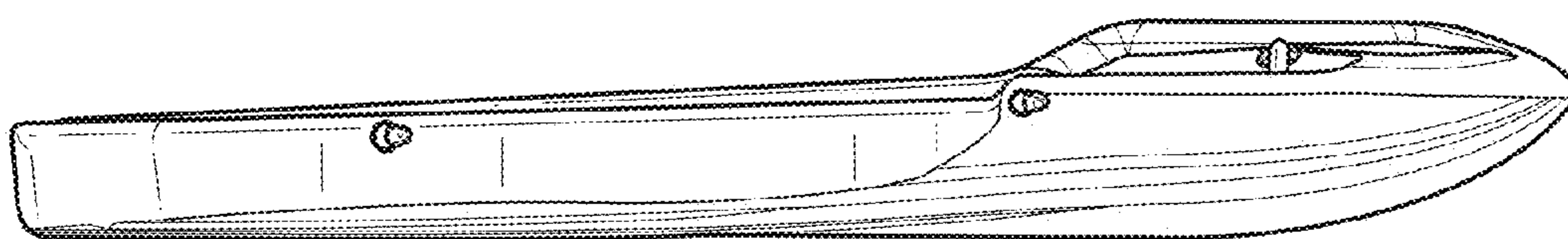

FIG. 1

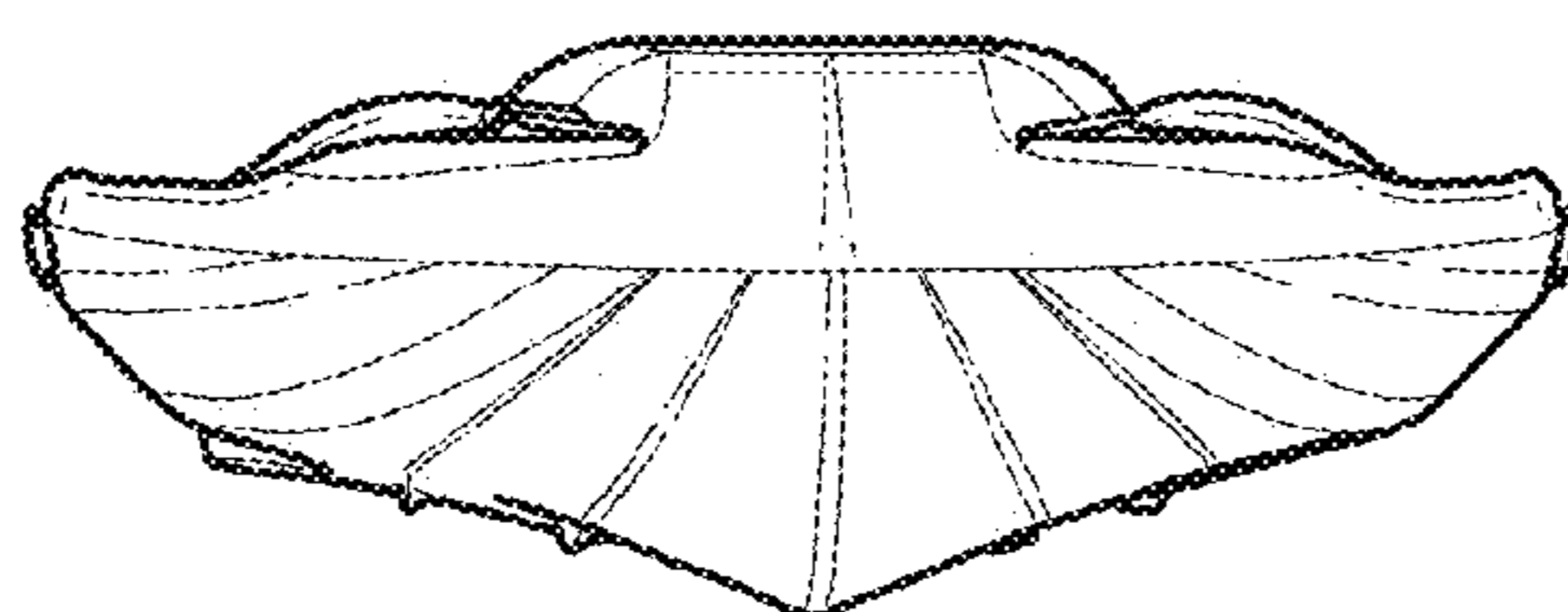

FIG. 2

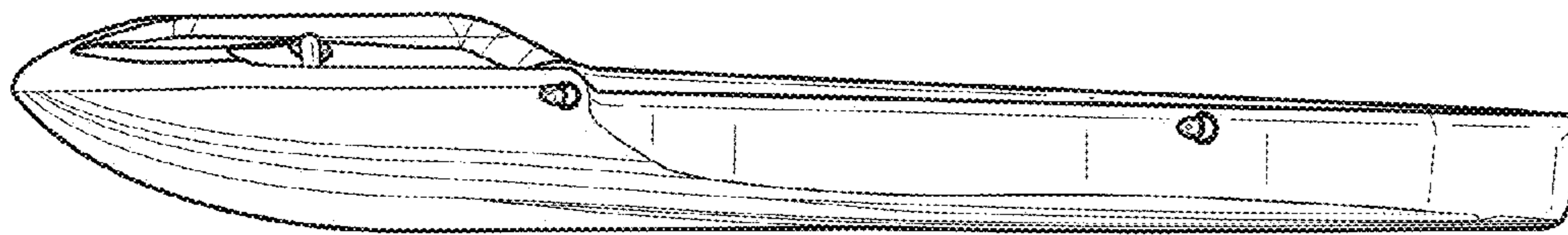

FIG. 3

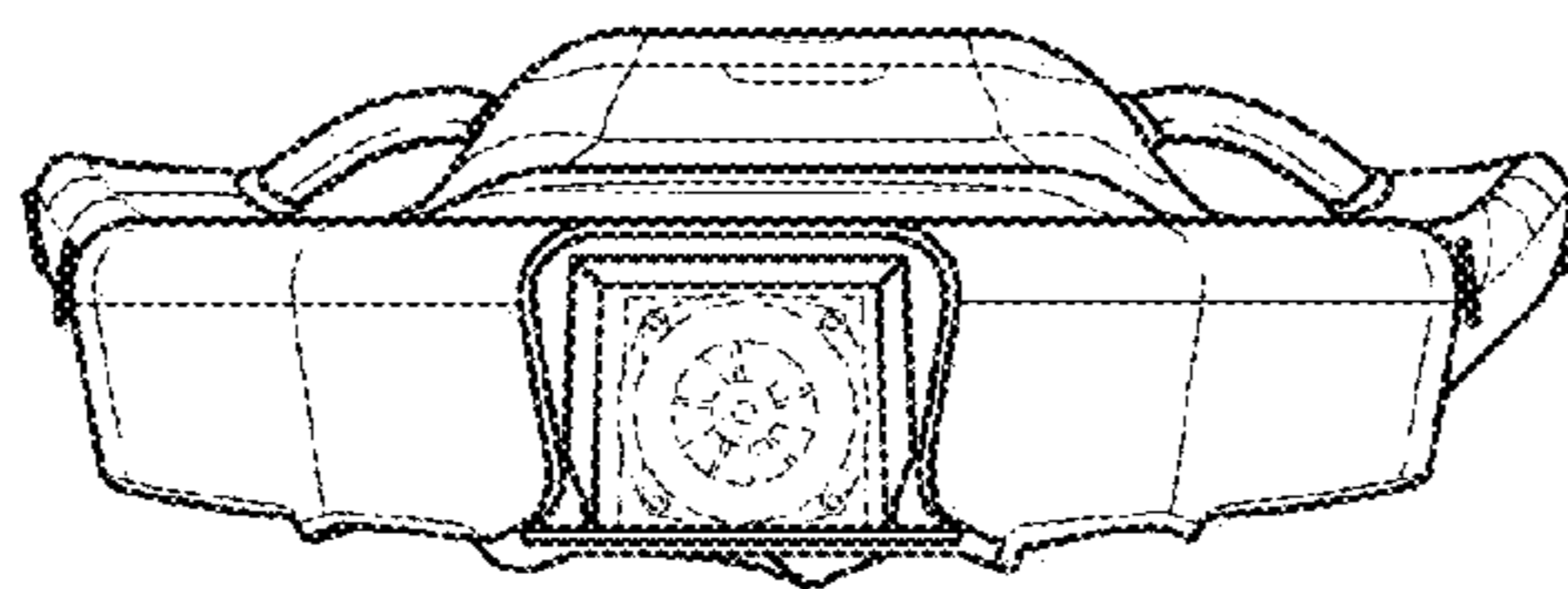

FIG. 4

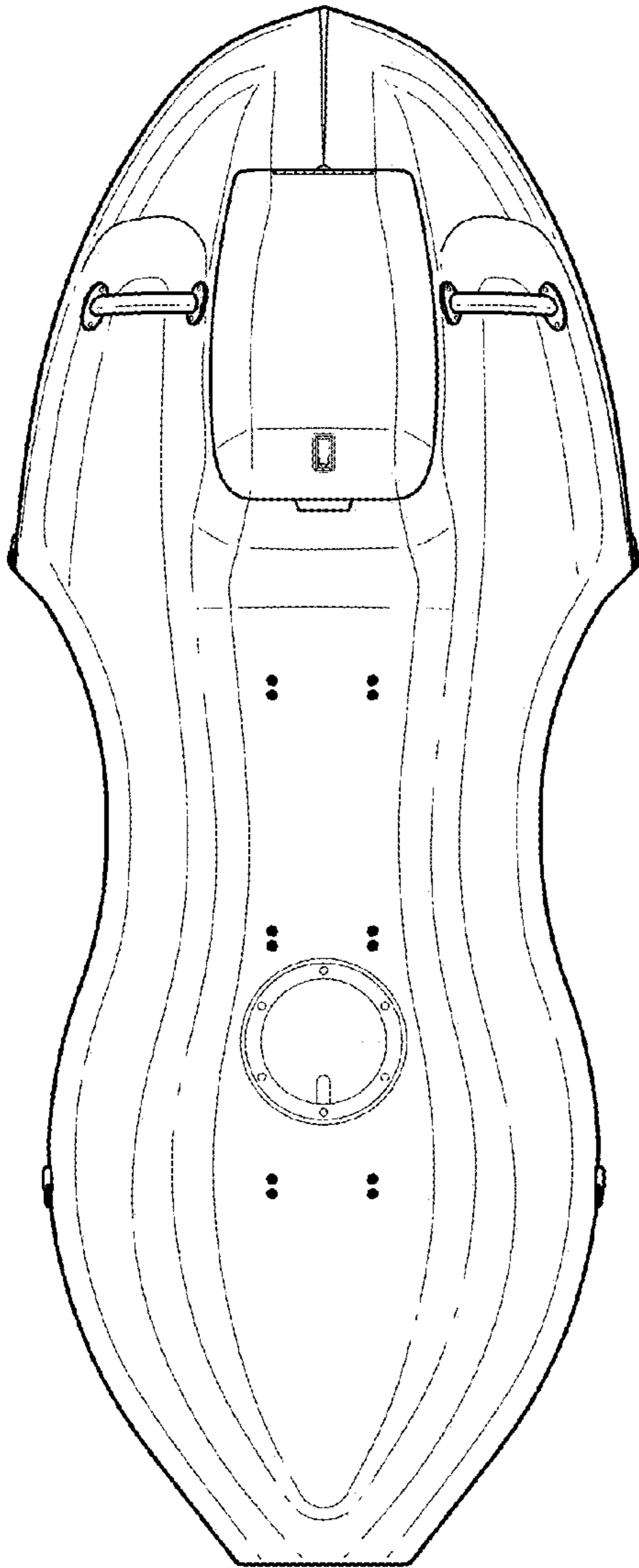

FIG. 5

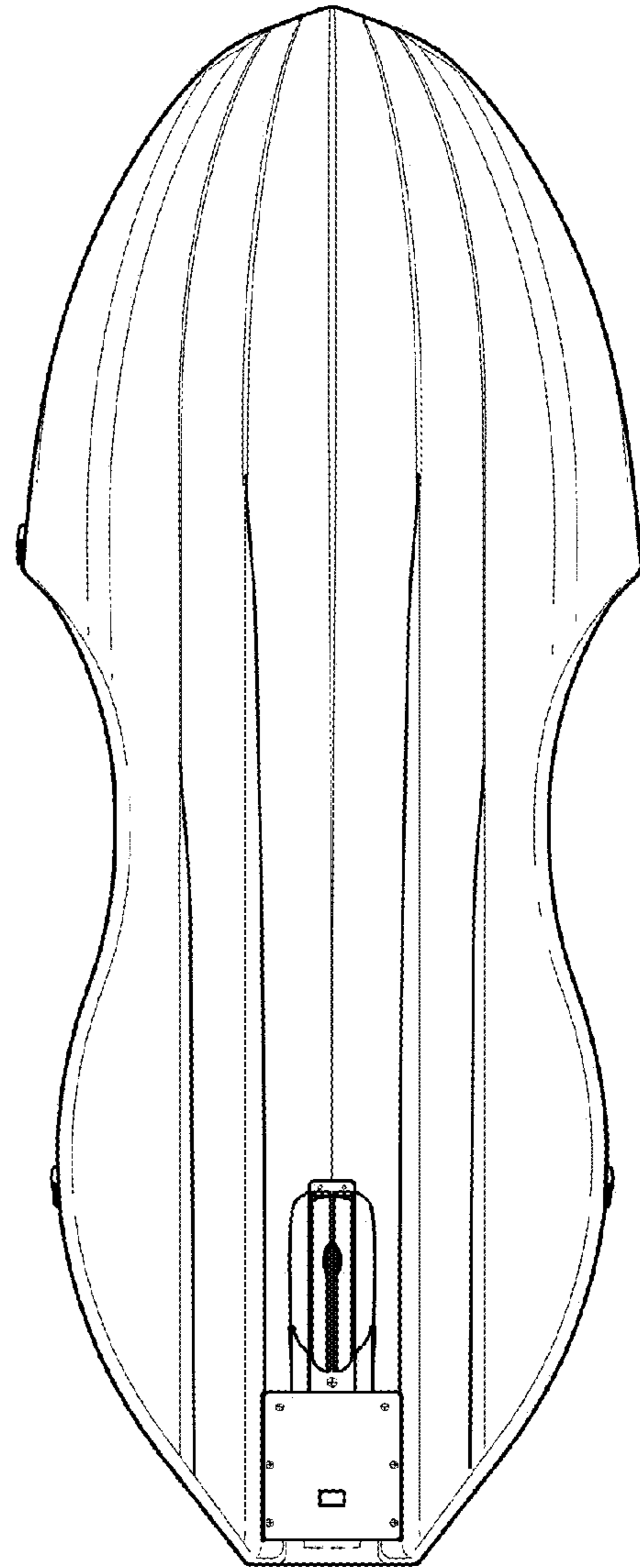

FIG. 6

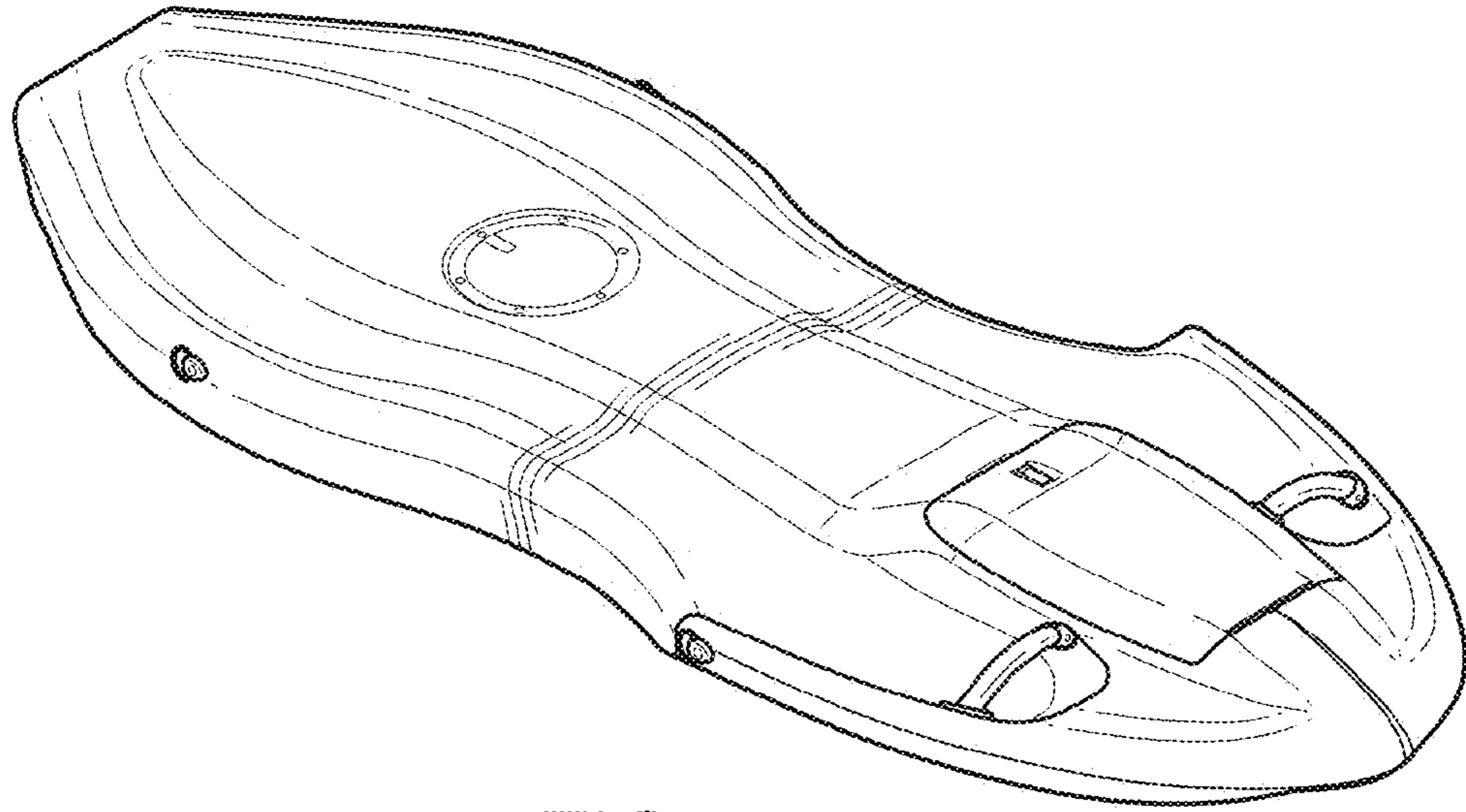

FIG. 7

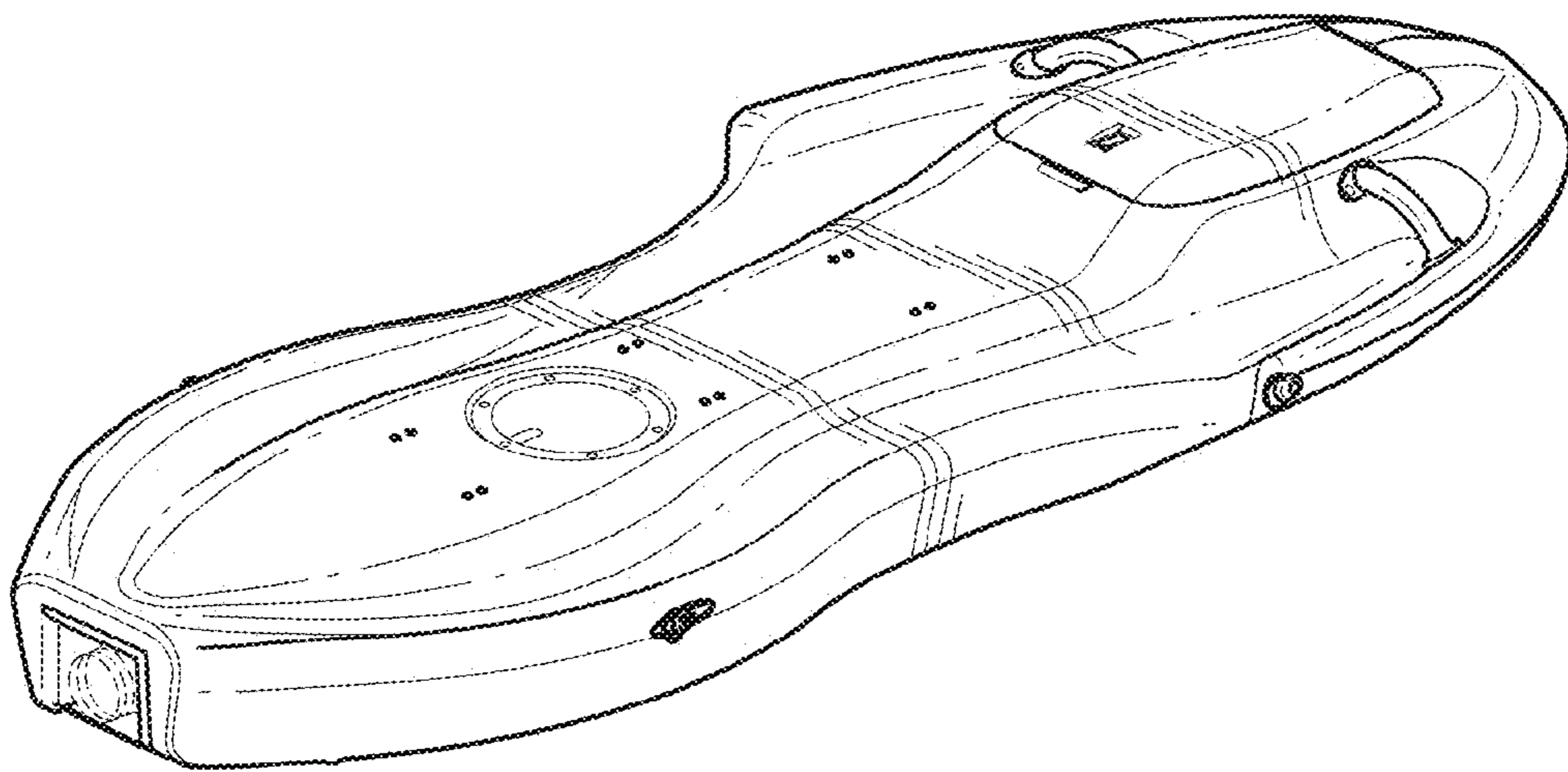

FIG. 8

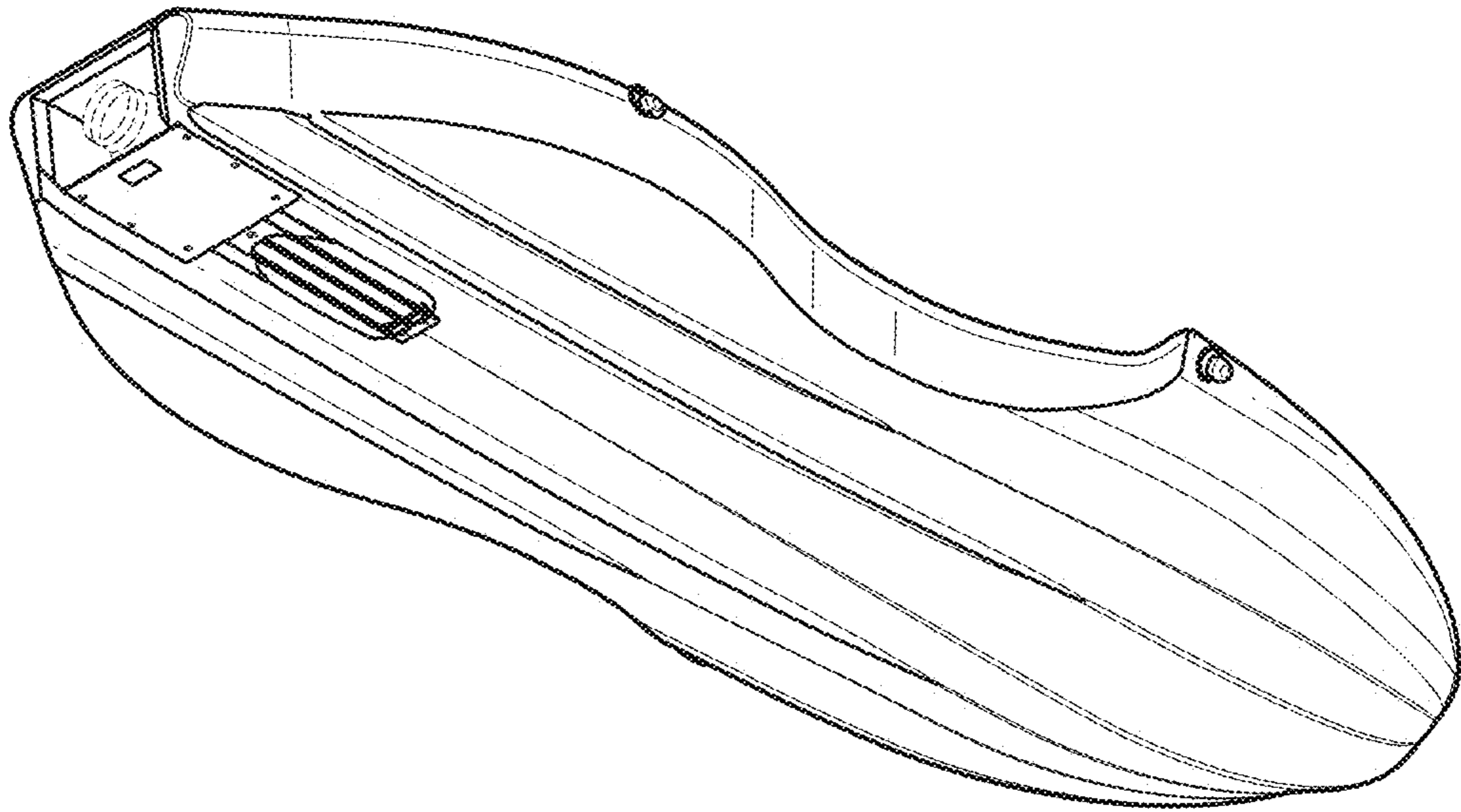

FIG. 9

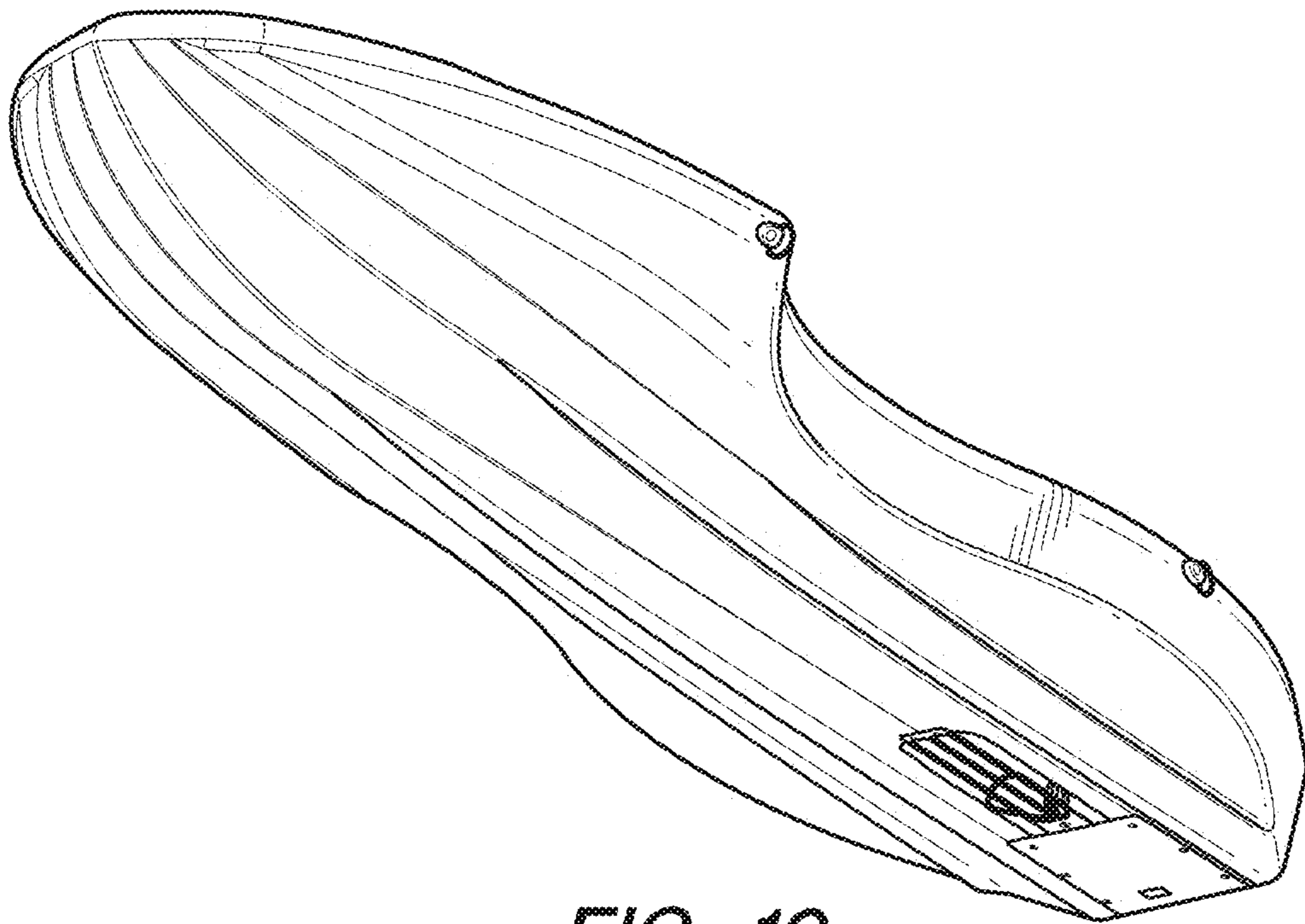

FIG. 10