



US00D752492S

(12) **United States Design Patent**  
**McConnell et al.**

(10) **Patent No.:** **US D752,492 S**  
(45) **Date of Patent:** **\*\* Mar. 29, 2016**

(54) **CONSOLE WITH RECOVERY VEHICLE CONTROLS**

(71) Applicants: **Ralph McConnell**, Chattanooga, TN (US); **Joseph C Brown**, Chattanooga, TN (US); **John L Hawkins**, Hixson, TN (US); **William G Miller, III**, Georgetown, TN (US); **Mark Dyer**, Ooltewah, TN (US); **Aaron C Haluska**, East Ridge, TN (US); **William G Drane, Jr.**, Ooltewah, TN (US); **C. Thomas Luciano**, Pottersville, NY (US)

(72) Inventors: **Ralph McConnell**, Chattanooga, TN (US); **Joseph C Brown**, Chattanooga, TN (US); **John L Hawkins**, Hixson, TN (US); **William G Miller, III**, Georgetown, TN (US); **Mark Dyer**, Ooltewah, TN (US); **Aaron C Haluska**, East Ridge, TN (US); **William G Drane, Jr.**, Ooltewah, TN (US); **C. Thomas Luciano**, Pottersville, NY (US)

(73) Assignee: **Miller Industries Towing Equipment Inc.**, Ooltewah, TN (US)

(\*\*) Term: **14 Years**

(21) Appl. No.: **29/487,208**

(22) Filed: **Apr. 7, 2014**

(51) **LOC (10) Cl.** ..... **12-16**

(52) **U.S. Cl.**  
USPC ..... **D12/192**

(58) **Field of Classification Search**  
USPC ..... D12/192, 415, 110, 114; D15/17, 28; D10/46, 98, 102-103, 122-127  
CPC ... G08G 1/096883; G01C 21/16; G01C 21/30  
See application file for complete search history.

(56) **References Cited**

**U.S. PATENT DOCUMENTS**

D697,847 S \* 1/2014 Waugh ..... D12/192  
D697,862 S \* 1/2014 Nemeth ..... D12/192

D705,146 S \* 5/2014 Takagi ..... D12/192  
D705,147 S \* 5/2014 Kinoshita ..... D12/192  
D727,817 S \* 4/2015 Schroeder ..... D12/192  
D734,697 S \* 7/2015 Hayashi ..... D12/192  
D734,698 S \* 7/2015 Hayashi ..... D12/192  
D746,615 S \* 1/2016 Teeters, II ..... D12/192

**OTHER PUBLICATIONS**

Pending U.S. Appl. No. 14/247,072, which is representative of the state of the art.

\* cited by examiner

*Primary Examiner* — Katrina A Betton

(74) *Attorney, Agent, or Firm* — Michael P. Mazza, LLC

(57) **CLAIM**

The ornamental design for a console with recovery vehicle controls, as shown and described.

**DESCRIPTION**

FIG. 1 is a perspective view of a console with recovery vehicle controls showing my new design;

FIG. 2 is a front, side and top perspective view of the console shown in FIG. 1;

FIG. 3 is a front perspective view of the console shown in FIG. 1;

FIGS. 4-5 are right-side and left-side perspective views, respectively, of the console shown in FIG. 1;

FIG. 6 is a top perspective view of the console shown in FIG. 1;

FIG. 7 is a bottom perspective view of the console shown in FIG. 1; and,

FIG. 8 is a rear perspective view of the console shown in FIG. 1.

In the drawings, the broken lines in depict portions of the article and a vehicle that form no part of the claimed design. The ornamental design for a console with controls (e.g., integrated hydraulic and electrical controls) for use in controlling functions of vehicles used to recover disabled vehicles, such as heavyduty wreckers, as shown and described in the drawings.

**1 Claim, 7 Drawing Sheets**

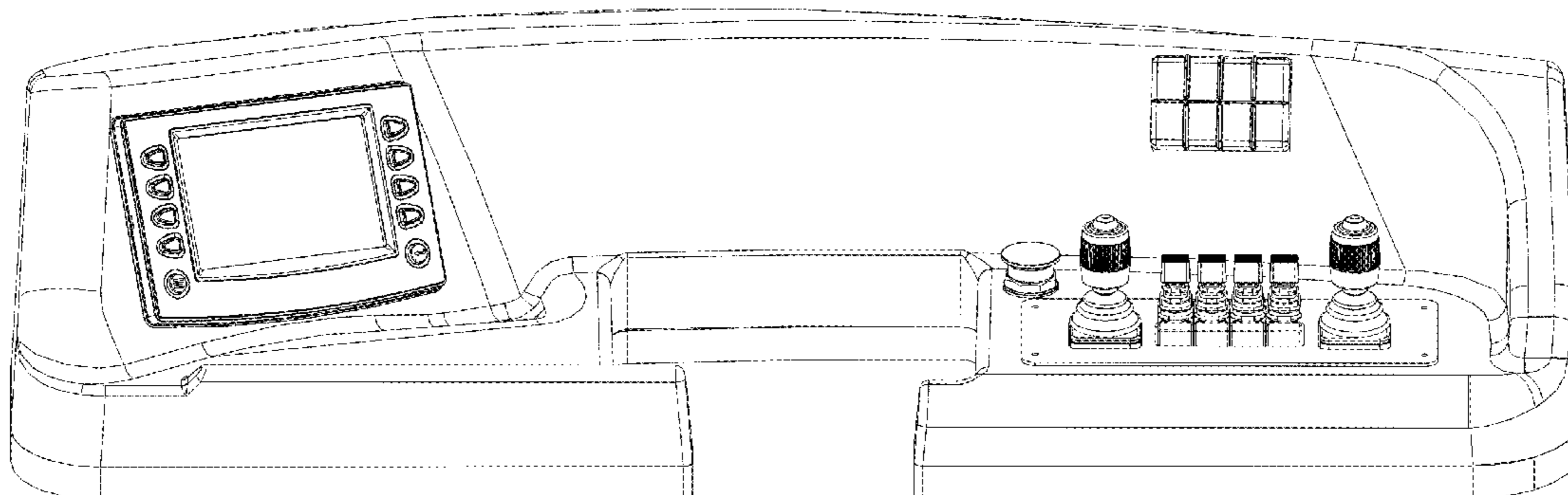

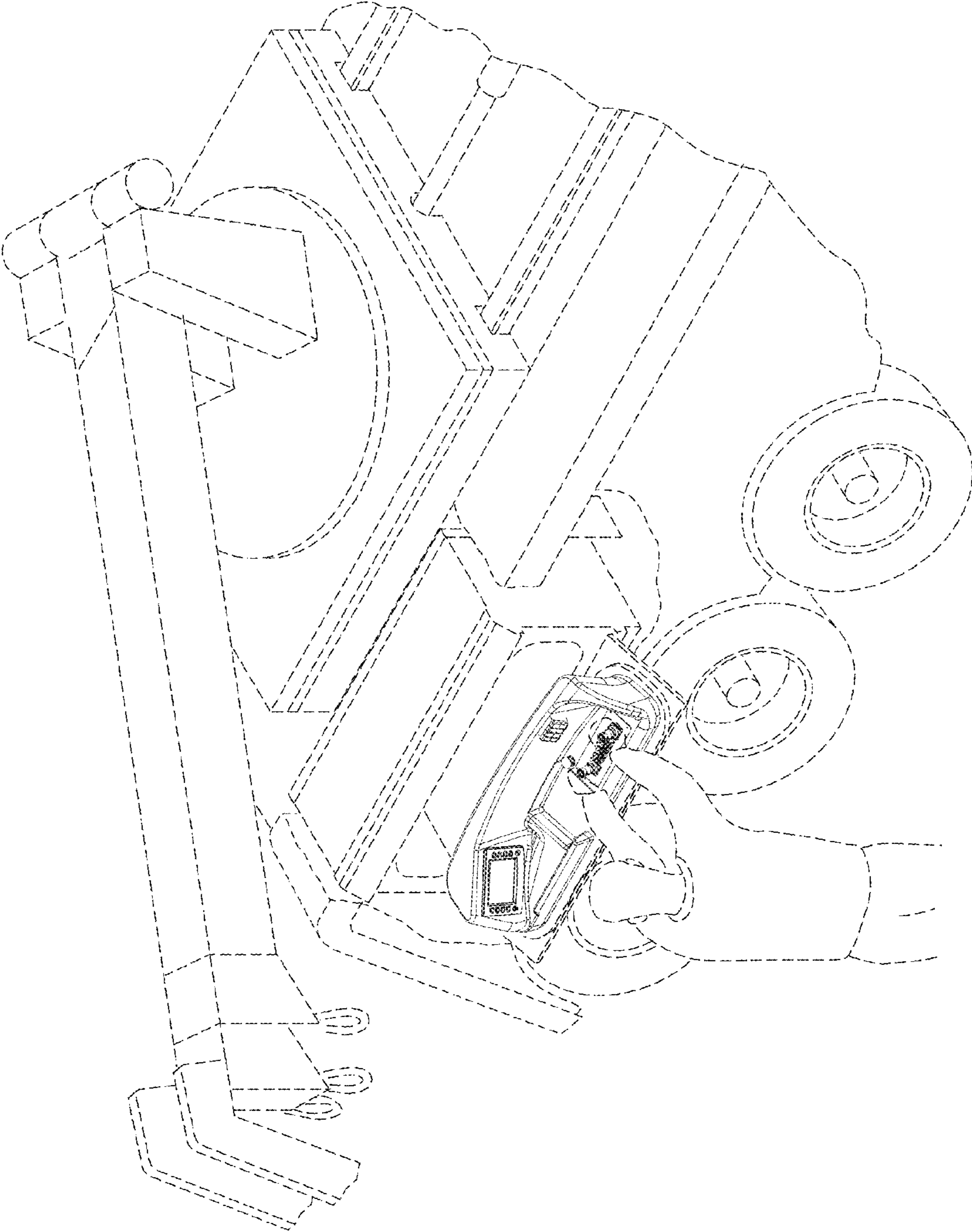

Fig. 1

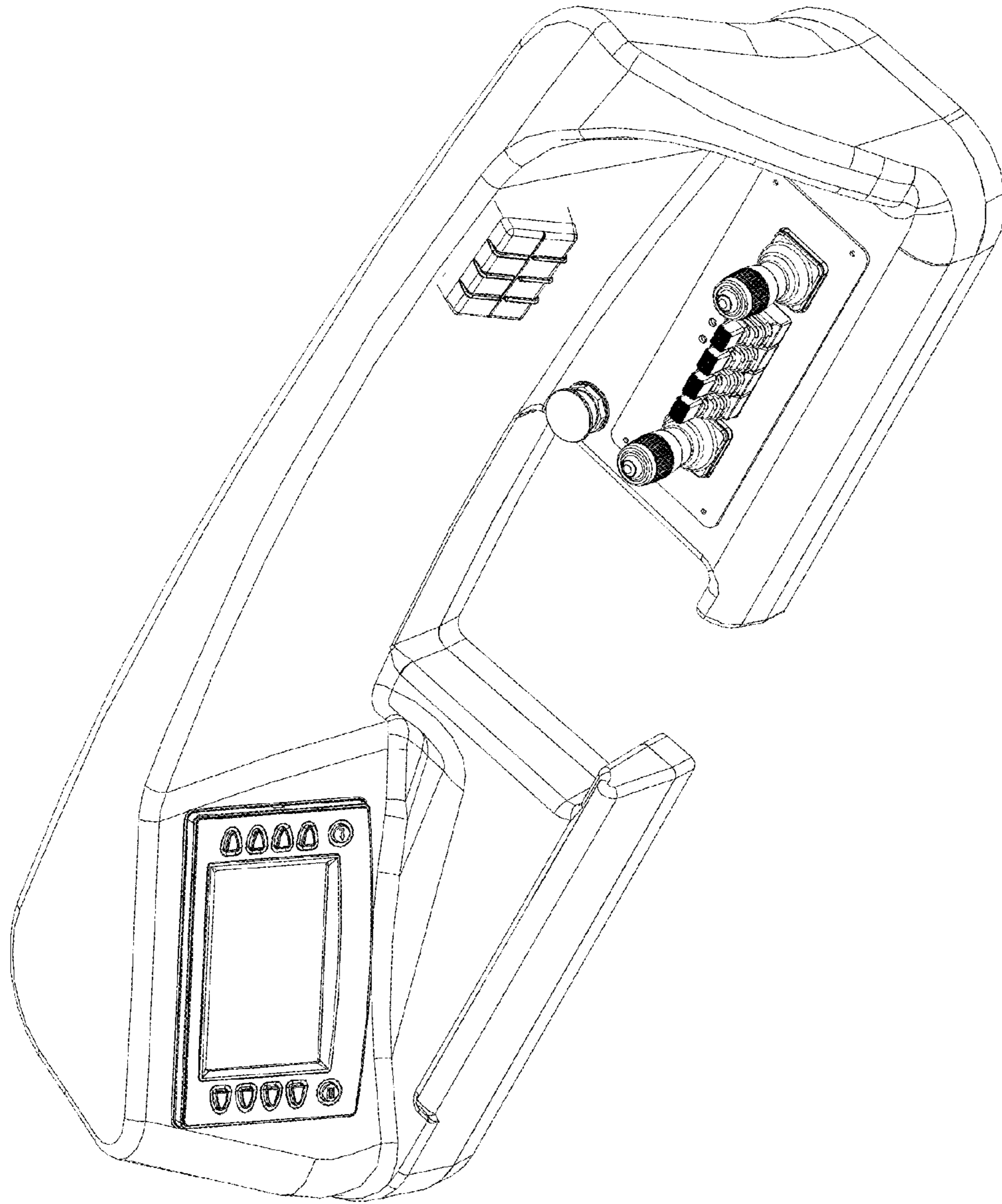

Fig. 2

Fig. 3

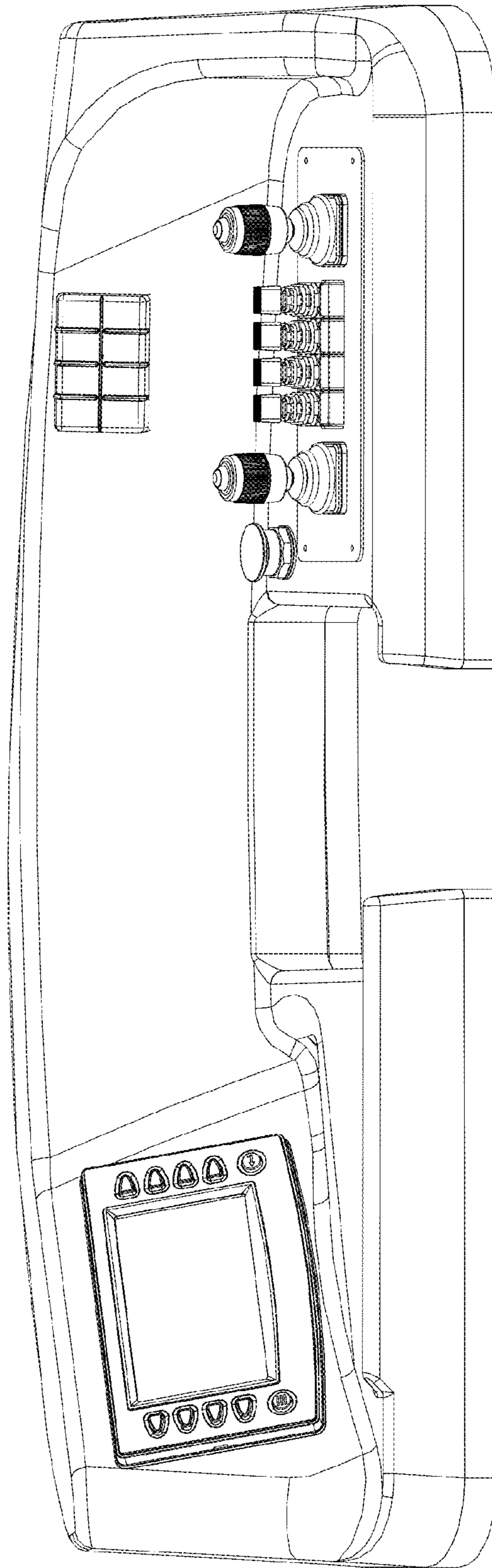

Fig. 4

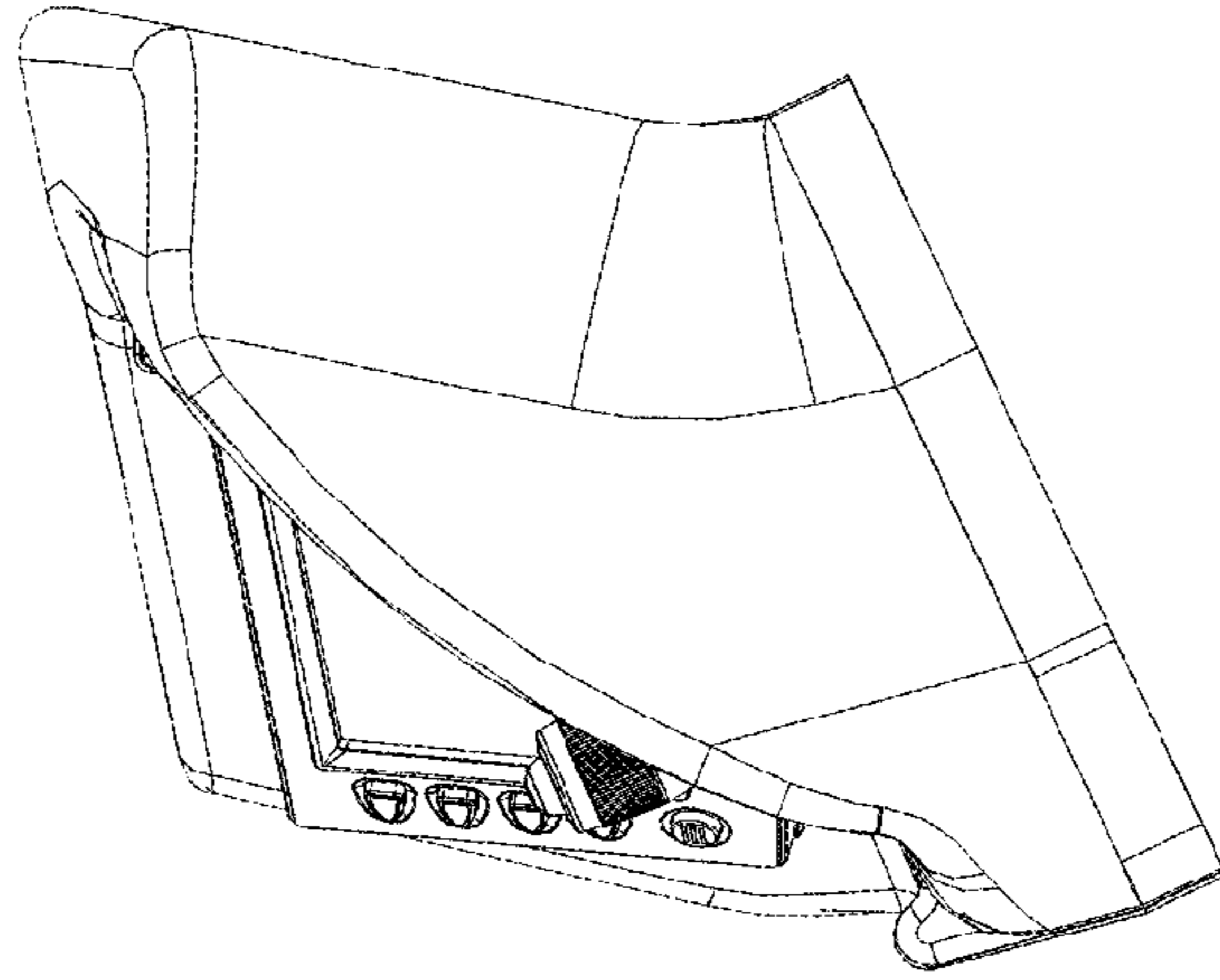

Fig. 5

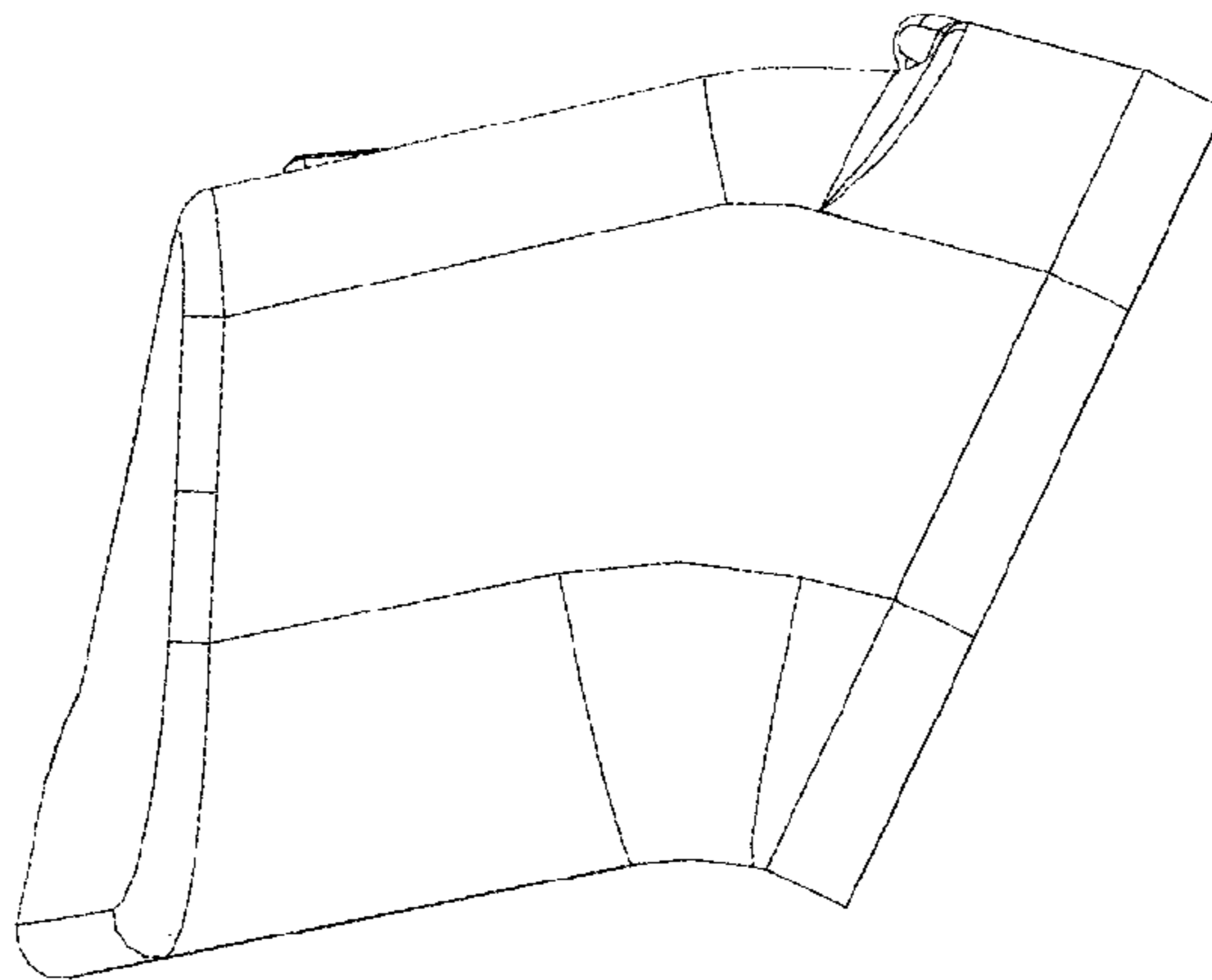

Fig. 6

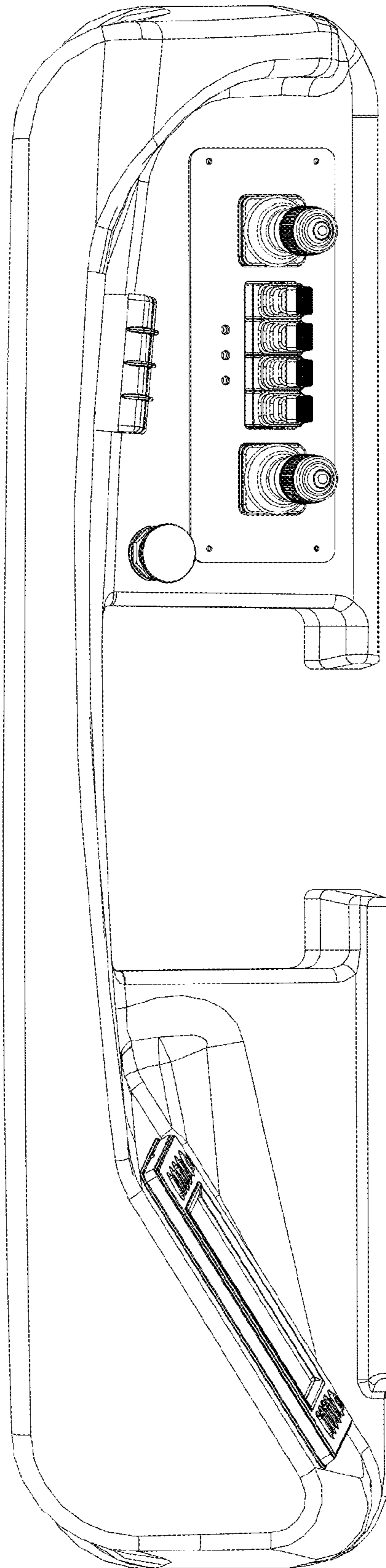

Fig. 7

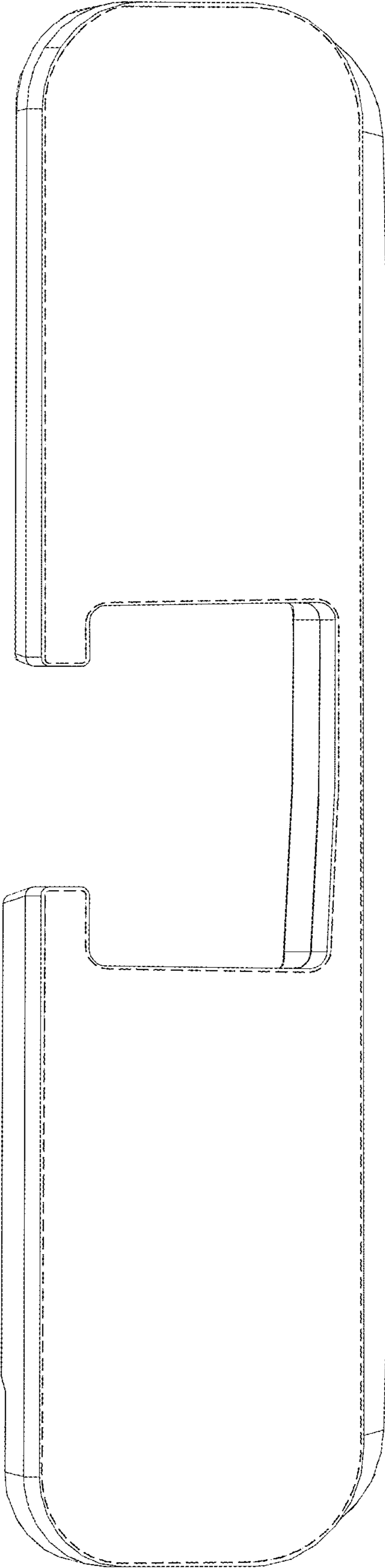

Fig. 8

