



US00D752072S

(12) **United States Design Patent**
Song

(10) **Patent No.:** **US D752,072 S**

(45) **Date of Patent:** **** Mar. 22, 2016**

(54) **PORTION OF A DISPLAY SCREEN WITH ANIMATED GRAPHICAL USER INTERFACE**

D693,837 S * 11/2013 Bouchier D14/486
8,635,547 B2 * 1/2014 Otsuka et al. 715/768
D699,737 S * 2/2014 Pearson et al. D14/486

(71) Applicant: **Tencent Technology (Shenzhen) Company Limited**, Shenzhen, Guangdong (CN)

(Continued)

Primary Examiner — Deanna L Pratt

(74) *Attorney, Agent, or Firm* — Design IP

(72) Inventor: **Lei Song**, Shenzhen (CN)

(57) **CLAIM**

The ornamental design for a portion of a display screen with animated graphical user interface, as shown and described.

(73) Assignee: **Tencent Technology (Shenzhen) Company Limited** (CN)

DESCRIPTION

(**) Term: **14 Years**

FIG. 1 is a front view of a first image of a first embodiment of a portion of a display screen with animated graphical user interface showing my new design;
FIG. 2 is a front view of a second image thereof;
FIG. 3 is a front view of a third image thereof;
FIG. 4 is a front view of a first image of a second embodiment of a portion of a display screen with animated graphical user interface showing my new design;
FIG. 5 is a front view of a second image thereof; and,
FIG. 6 is a front view of a third image thereof.

(21) Appl. No.: **29/458,731**

(22) Filed: **Jun. 21, 2013**

(51) **LOC (10) Cl.** **14-04**

(52) **U.S. Cl.**
USPC **D14/486**

(58) **Field of Classification Search**
USPC D14/485–495; 715/700–867
CPC G01C 21/00; G01C 21/3492; G01C 21/3617; G01C 21/3606; G06F 3/04847
See application file for complete search history.

In the first embodiment, the appearance of the transitional image sequentially transitions between the images shown in FIGS. 1 through 3. In the second embodiment, the appearance of the transitional image sequentially transitions between the images shown in FIGS. 4 through 6. The process or period in which one image transitions to another image forms no part of the claimed design. The broken line showing of a portion of a display screen in FIGS. 1 through 6 forms no part of the claimed design. The broken line showing of text and portions of the graphical user interface in FIGS. 1 through 6 represents environmental subject matter and forms no part of the claimed design. All of the text shown in FIGS. 1-6 is shown in broken lines. The grayscale fill appearing in the circular rings of FIGS. 2-3 and 5-6, signifies that the background of the portion of each of the circular rings is darker than any unfilled portion of each of the circular rings and the background of each of the circular rings in FIGS. 1 and 4.

(56) **References Cited**

U.S. PATENT DOCUMENTS

5,736,984 A * 4/1998 Jellinek et al. 715/710
7,490,295 B2 * 2/2009 Chaudhri et al. 715/764
7,555,476 B2 * 6/2009 Holbrook
D607,008 S * 12/2009 Kocmick D14/489
D611,057 S * 3/2010 Arnell D14/490
D645,471 S * 9/2011 Gardner et al. D14/492
D651,611 S * 1/2012 Ouilhet et al. D14/489
D651,613 S * 1/2012 Ouilhet D14/491
D667,452 S * 9/2012 Wujcik et al. D14/492
D681,669 S * 5/2013 Phelan D14/489
8,495,489 B1 * 7/2013 Everingham 715/230
D687,452 S * 8/2013 Anzures et al. D14/486

1 Claim, 6 Drawing Sheets

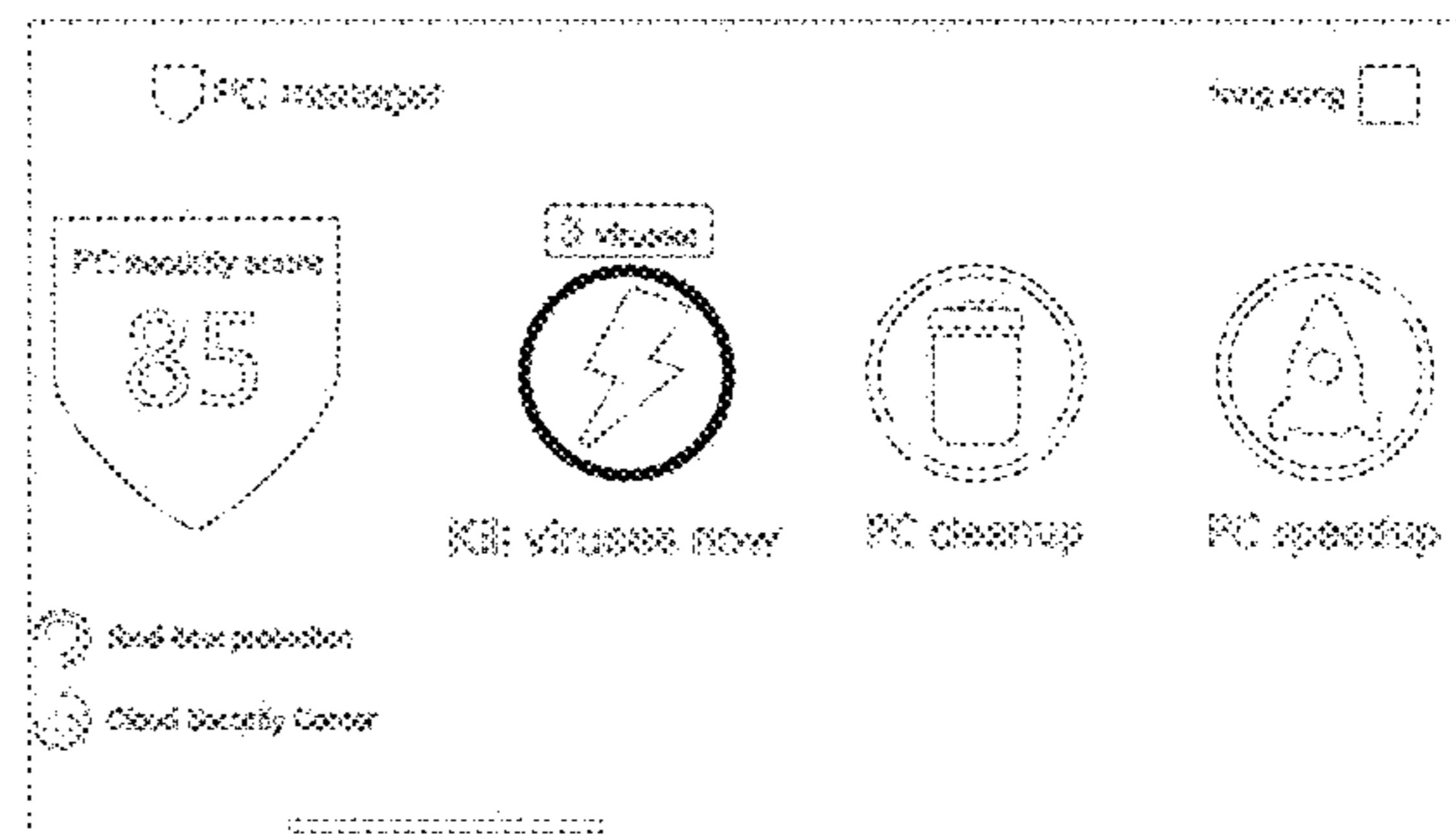
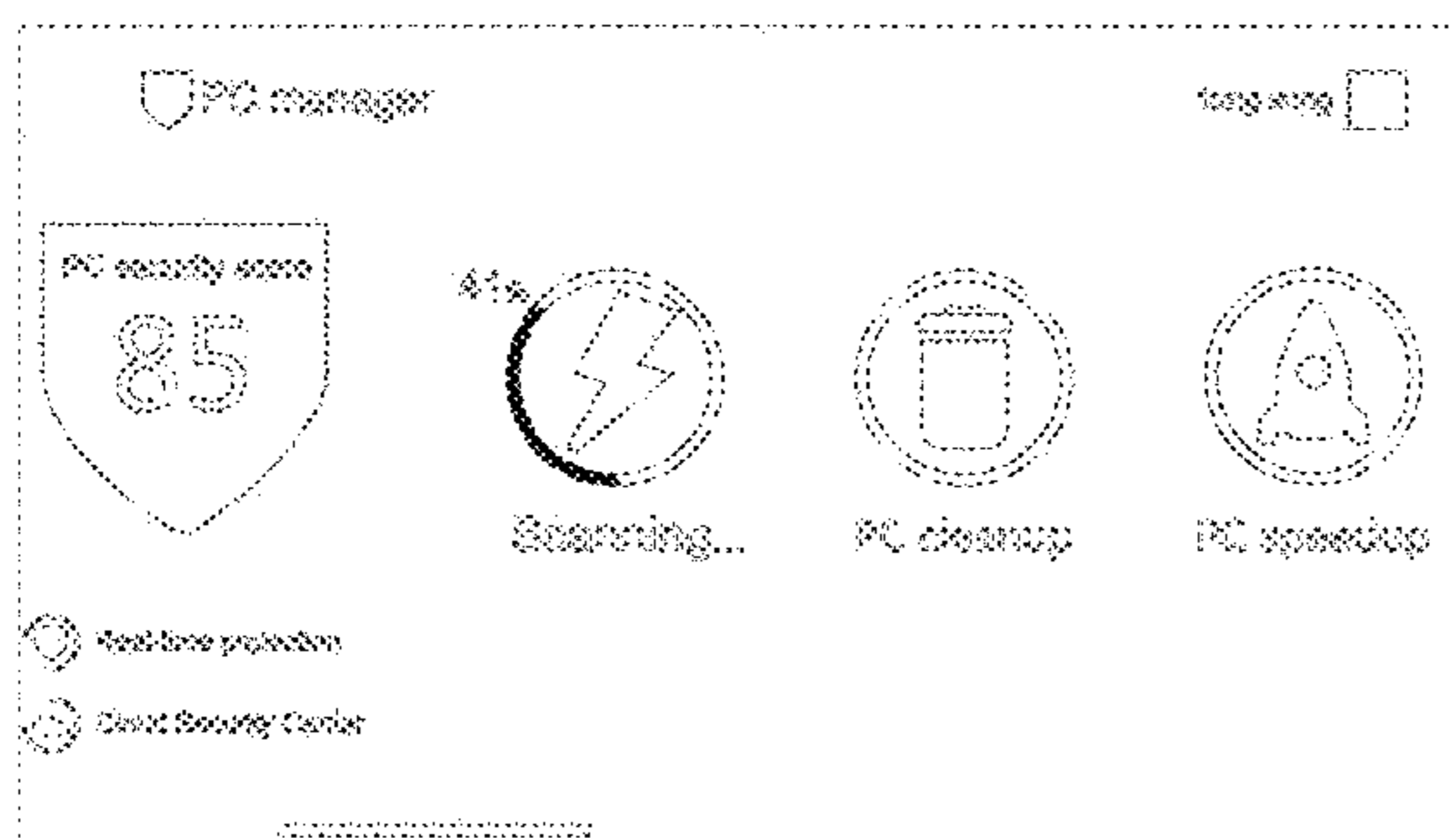

(56)

References Cited

U.S. PATENT DOCUMENTS

D699,746 S * 2/2014 Pearson et al. D14/488
8,830,270 B2 * 9/2014 Zaman et al. 345/649
8,875,054 B2 * 10/2014 Hopkins et al. 715/833
D717,823 S * 11/2014 Brotman et al. D14/486
8,898,630 B2 * 11/2014 Hirsch et al. 717/107
D721,086 S * 1/2015 Hontz, Jr. D14/485

D727,336 S * 4/2015 Allison et al. D14/485
D727,928 S * 4/2015 Allison et al. D14/485
D728,616 S * 5/2015 Gomez et al. D14/491
D729,837 S * 5/2015 Kang D14/487
D731,549 S * 6/2015 Kim et al. D14/492
2014/0195826 A1 * 7/2014 Wojcik et al. 713/300
2014/0278070 A1 * 9/2014 McGavran et al. 701/465
2015/0142490 A1 * 5/2015 Georgiades 705/7.15

* cited by examiner

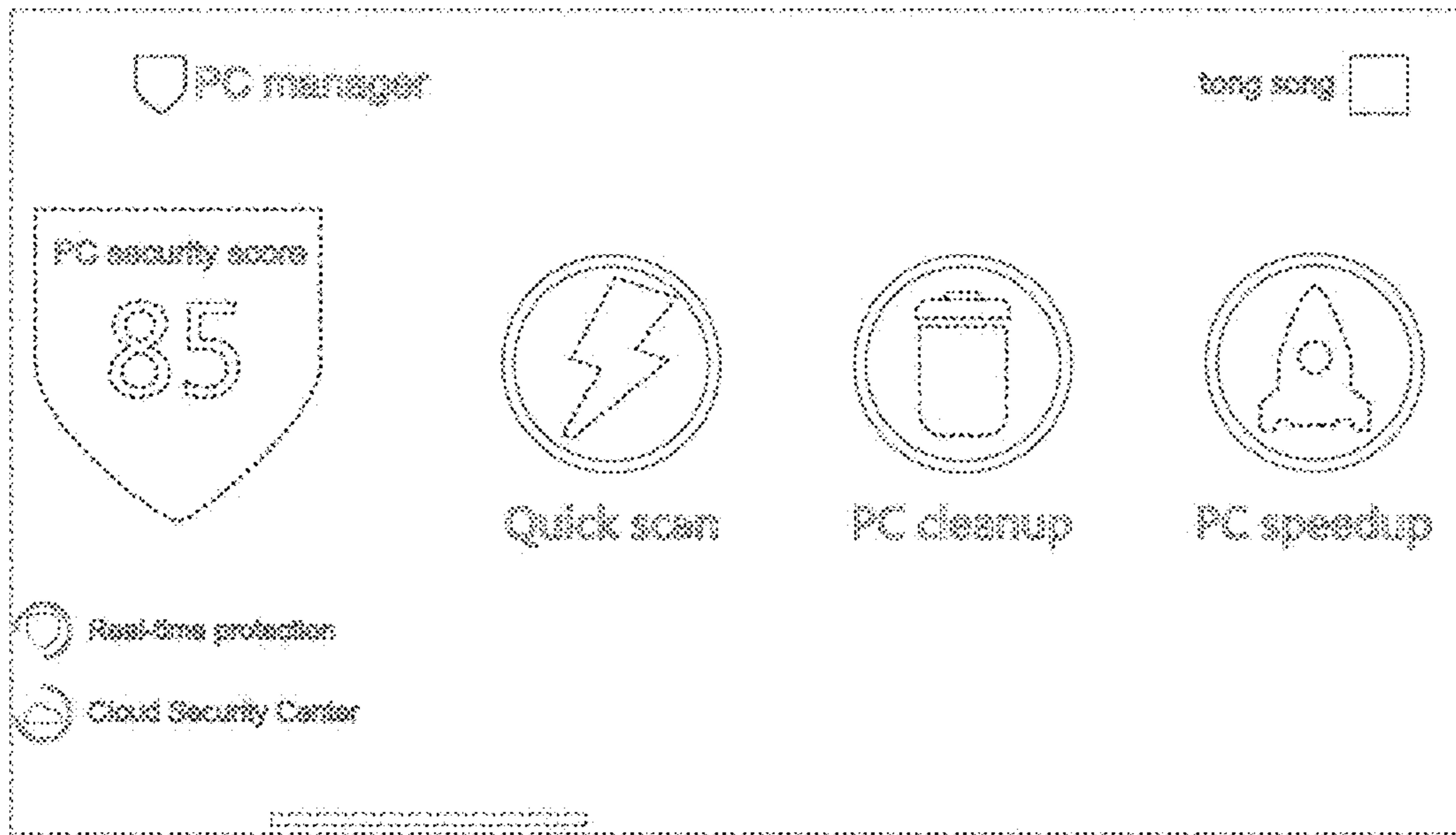

FIG. 1

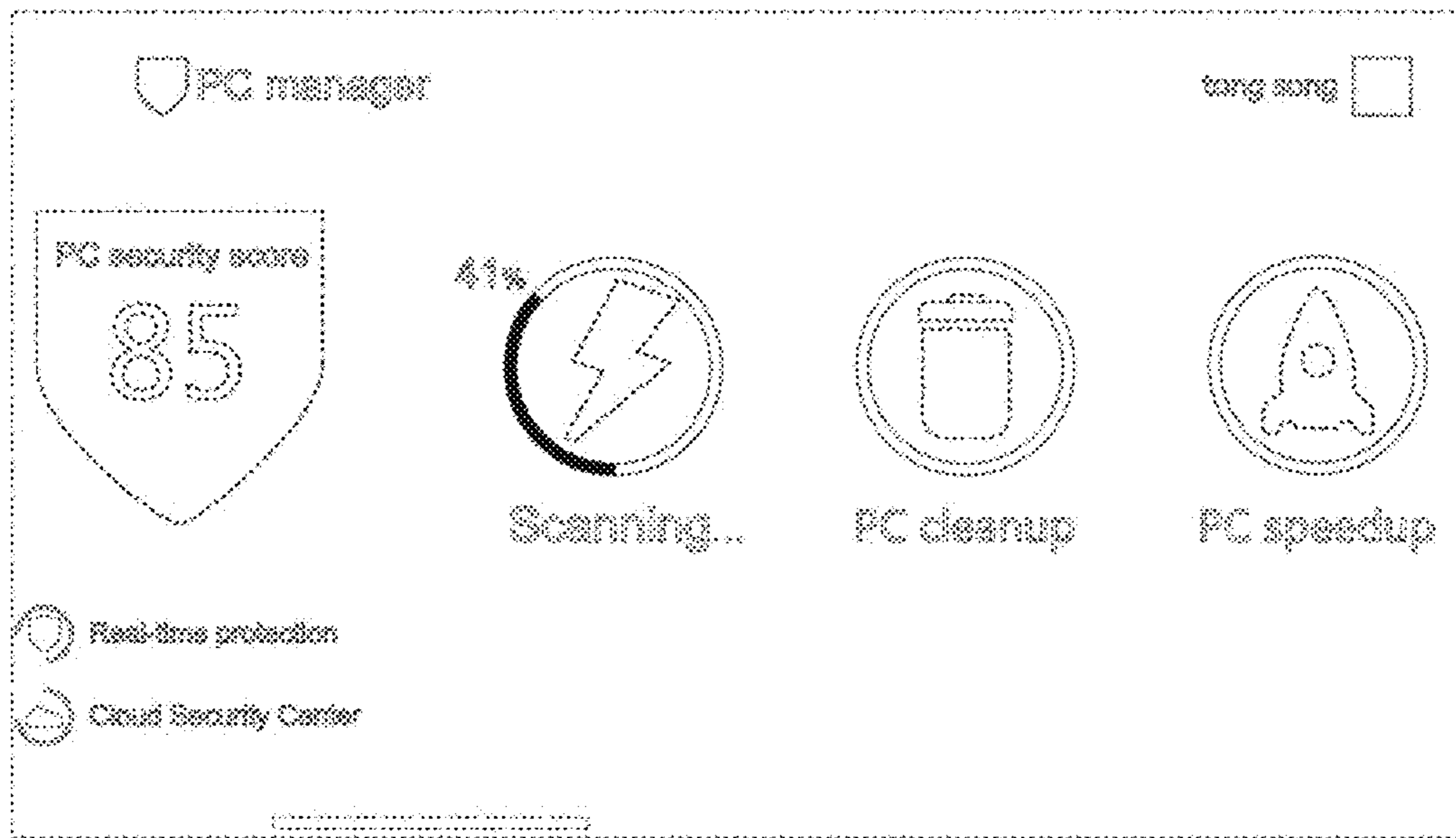

FIG. 2

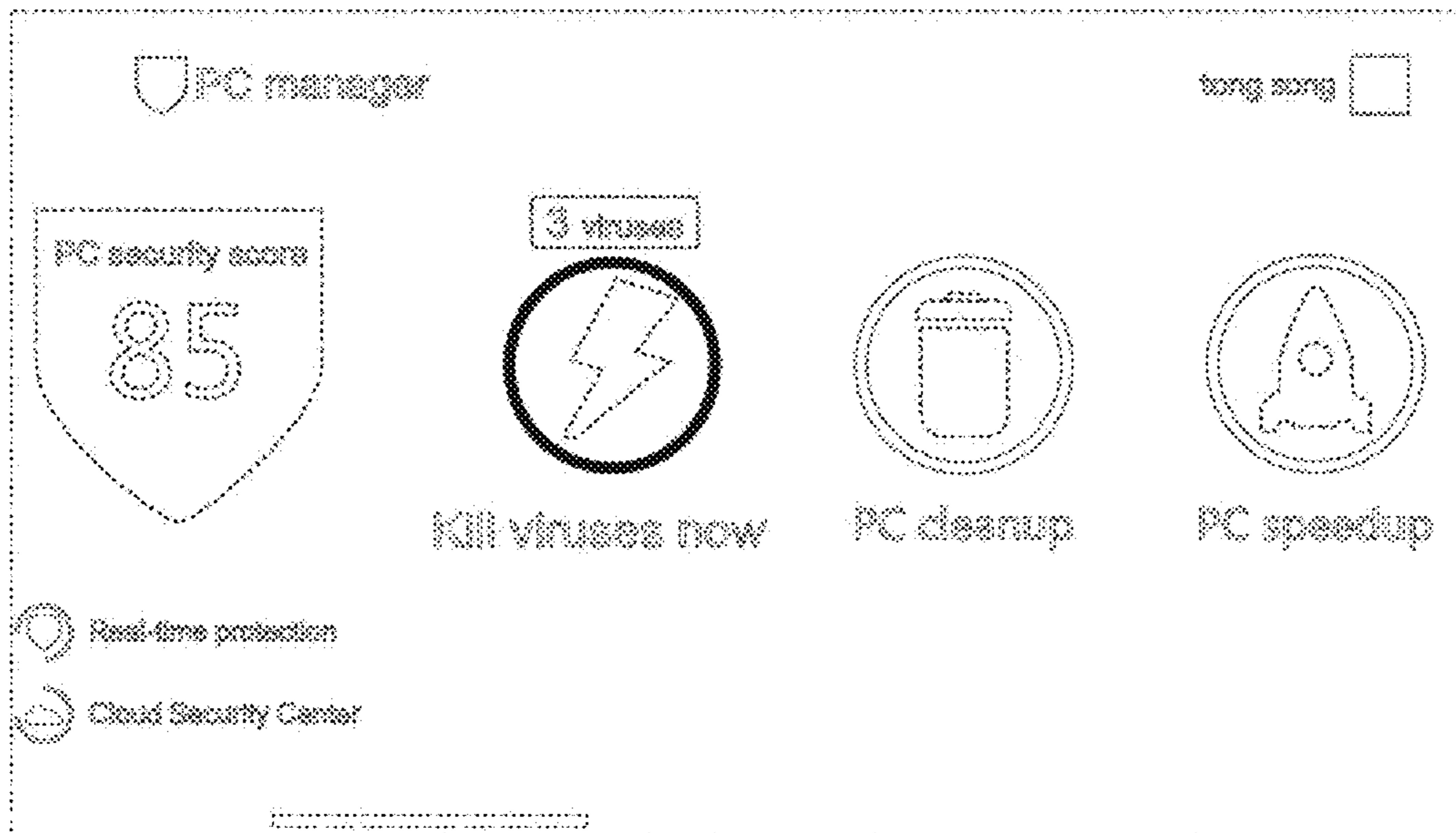

FIG. 3

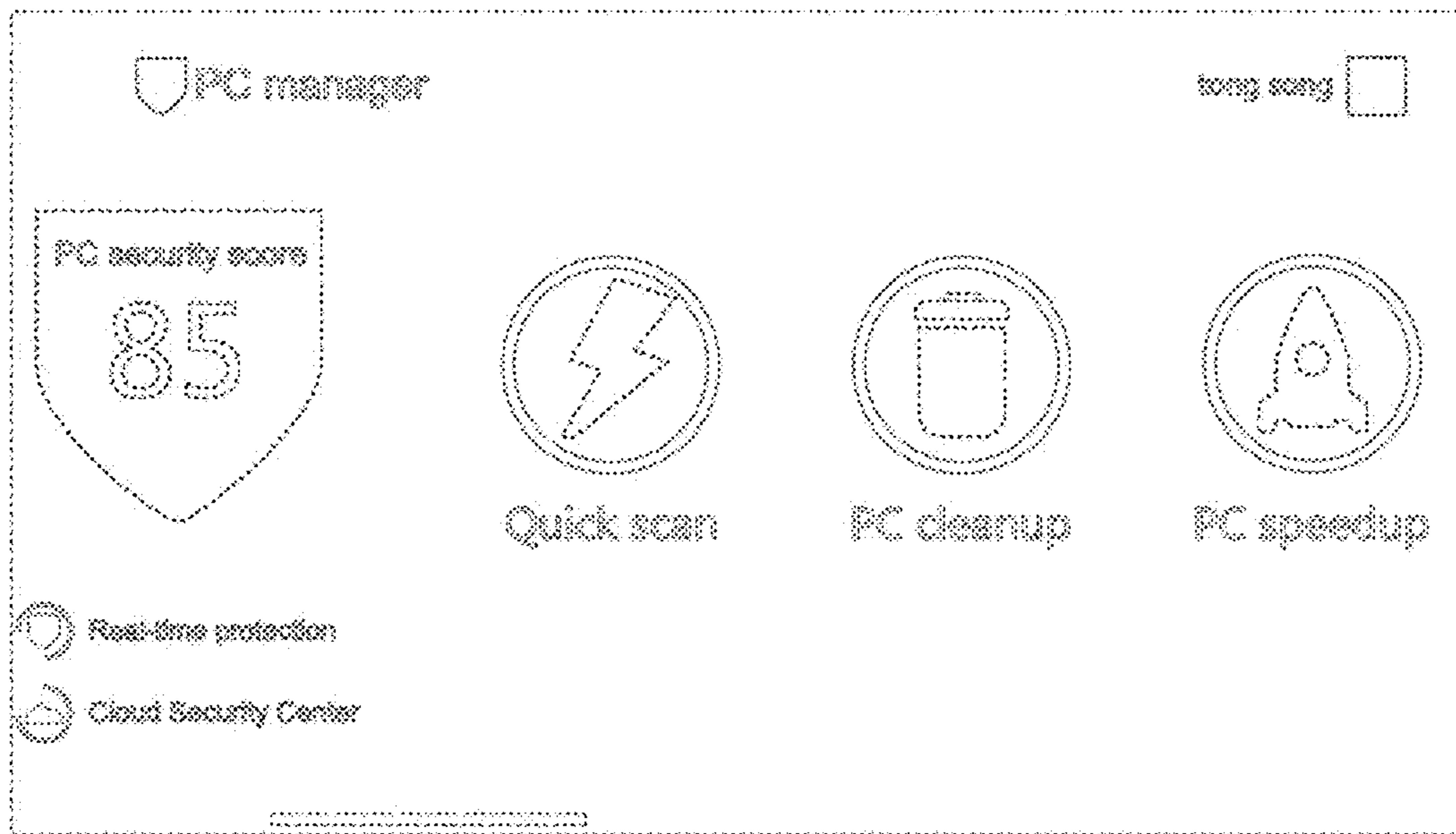

FIG. 4

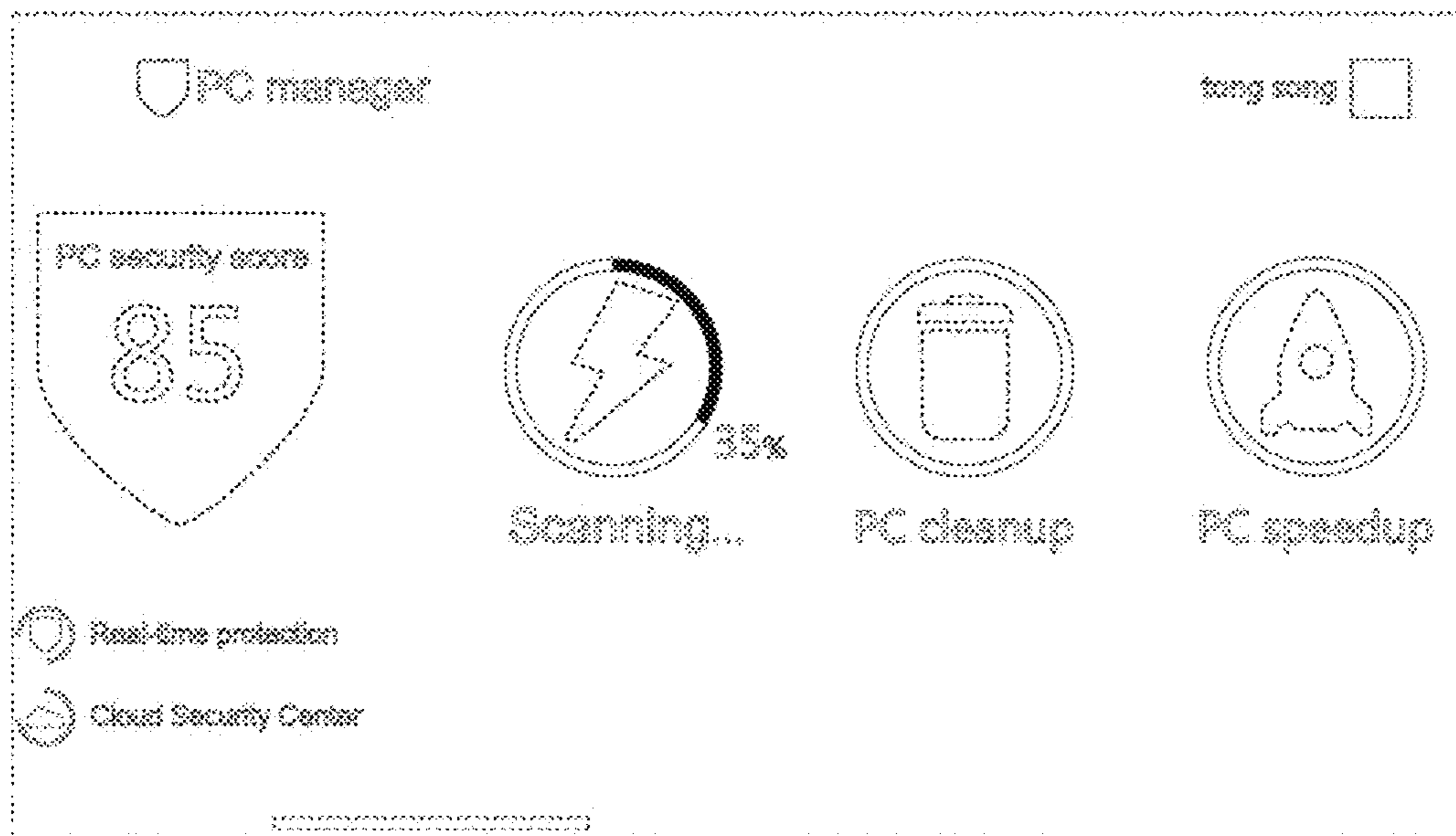

FIG. 5

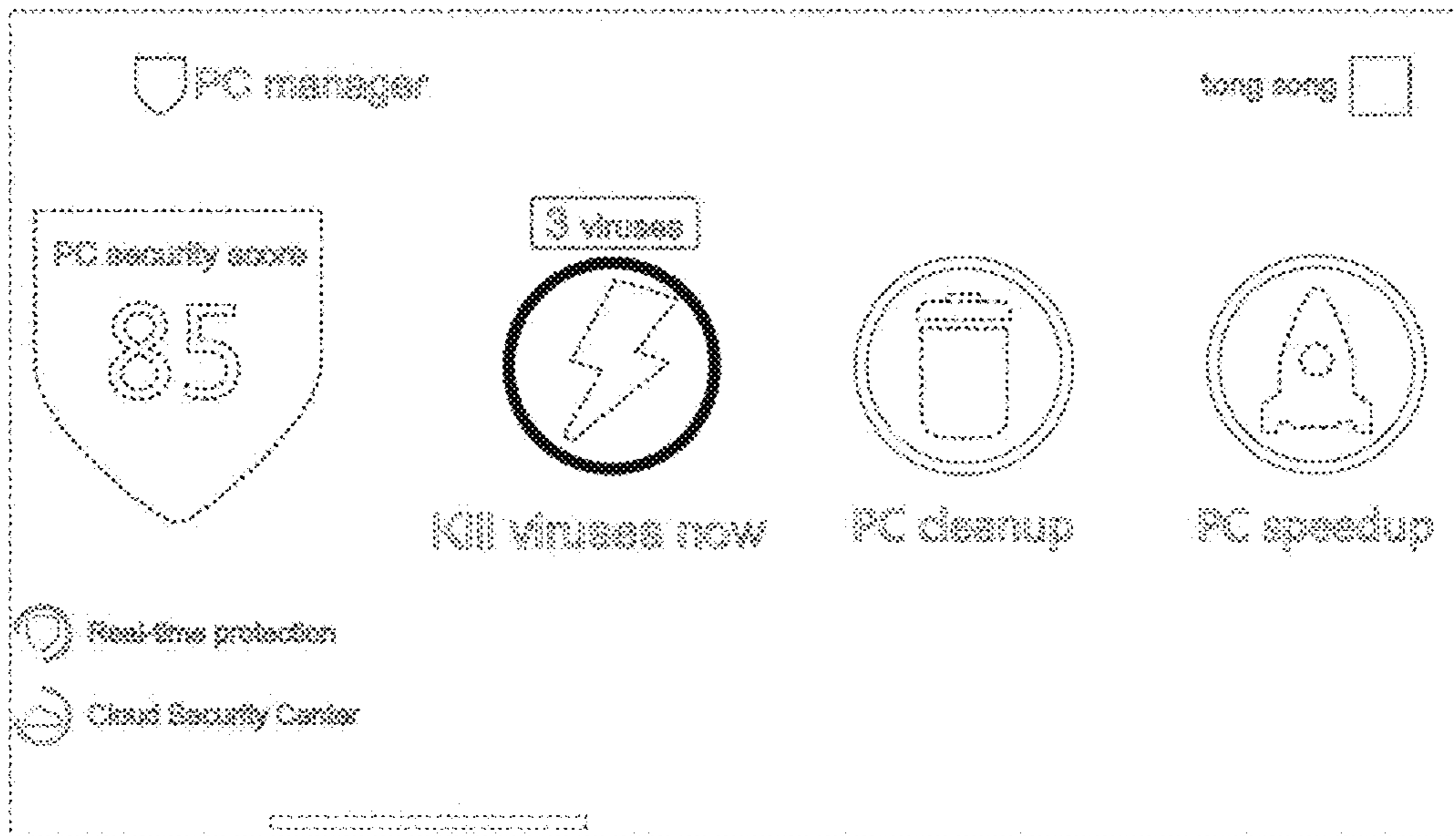

FIG. 6