



US00D751963S

(12) **United States Design Patent**
McConnell et al.

(10) **Patent No.:** **US D751,963 S**
(45) **Date of Patent:** **** Mar. 22, 2016**

(54) **COMPARTMENT AND CONSOLE WITH CONTROLS FOR A RECOVERY VEHICLE**

(71) Applicants: **Ralph McConnell**, Chattanooga, TN (US); **Joseph C Brown**, Chattanooga, TN (US); **John L Hawkins**, Hixson, TN (US); **William G Miller, III**, Georgetown, TN (US); **Mark Dyer**, Ooltewah, TN (US); **Aaron C Haluska, Jr.**, Ooltewah, TN (US); **William G Drane, Jr.**, Ooltewah, TN (US); **C. Thomas Luciano**, Pottersville, NY (US)

(72) Inventors: **Ralph McConnell**, Chattanooga, TN (US); **Joseph C Brown**, Chattanooga, TN (US); **John L Hawkins**, Hixson, TN (US); **William G Miller, III**, Georgetown, TN (US); **Mark Dyer**, Ooltewah, TN (US); **Aaron C Haluska, Jr.**, Ooltewah, TN (US); **C. Thomas Luciano**, Pottersville, NY (US)

(73) Assignee: **Miller Industries Towing Equipment Inc.**, Ooltewah, TN (US)

(**) Term: **14 Years**

(21) Appl. No.: **29/487,210**

(22) Filed: **Apr. 7, 2014**

(51) **LOC (10) Cl.** **12-16**

(52) **U.S. Cl.**
USPC **D12/192**

(58) **Field of Classification Search**
USPC D12/192, 415, 110, 114; D15/17, 28; D10/46, 98, 102-103, 122-127
CPC ... G08G 1/096883; G01C 21/16; G01C 21/30
See application file for complete search history.

(56) **References Cited**

U.S. PATENT DOCUMENTS

D697,847 S * 1/2014 Waugh D12/192
D697,862 S * 1/2014 Nemeth D12/192

D705,146 S * 5/2014 Takagi D12/192
D705,147 S * 5/2014 Kinoshita D12/192
D727,817 S * 4/2015 Schroeder D12/192
D734,697 S * 7/2015 Hayashi D12/192
D734,698 S * 7/2015 Hayashi D12/192
D746,615 S * 1/2016 Teeters, II D12/192

OTHER PUBLICATIONS

Attached is Figure 1 from pending U.S. Appl. No. 14/247,072, which is representative of the state of the art.

* cited by examiner

Primary Examiner — Katrina A Betton

(74) *Attorney, Agent, or Firm* — Michael P. Mazza, LLC

(57) **CLAIM**

The ornamental design for a compartment and console with controls for a recovery vehicle, as shown and described.

DESCRIPTION

FIG. 1 is a perspective view of a compartment and console with controls for a recovery vehicle showing our new design; FIG. 2 is a front, side and top perspective view of the compartment and console with controls for a recovery vehicle shown in FIG. 1;

FIG. 3 is a front perspective view of the compartment and console with controls for a recovery vehicle shown in FIG. 1; FIG. 4 is a top perspective view of the compartment and console with controls for a recovery vehicle shown in FIG. 1; FIG. 5 is a right-side side perspective view of the compartment and console shown in FIG. 1;

FIG. 6 is a left-side side perspective view of the compartment and console shown in FIG. 1;

FIG. 7 is a rear perspective view of the compartment shown in (e.g) FIG. 5; and,

FIG. 8 is a bottom view of the compartment and console shown in the closed position.

In the drawings, the broken lines depict portions of the article and a vehicle that form no part of the claimed design.

The ornamental design for a compartment with a support base mounting a console with controls (e.g., integrated hydraulic and electrical controls) for use in controlling functions of vehicles used to recover disabled vehicles, such as heavy-duty wreckers, as shown and described in the drawings.

1 Claim, 8 Drawing Sheets

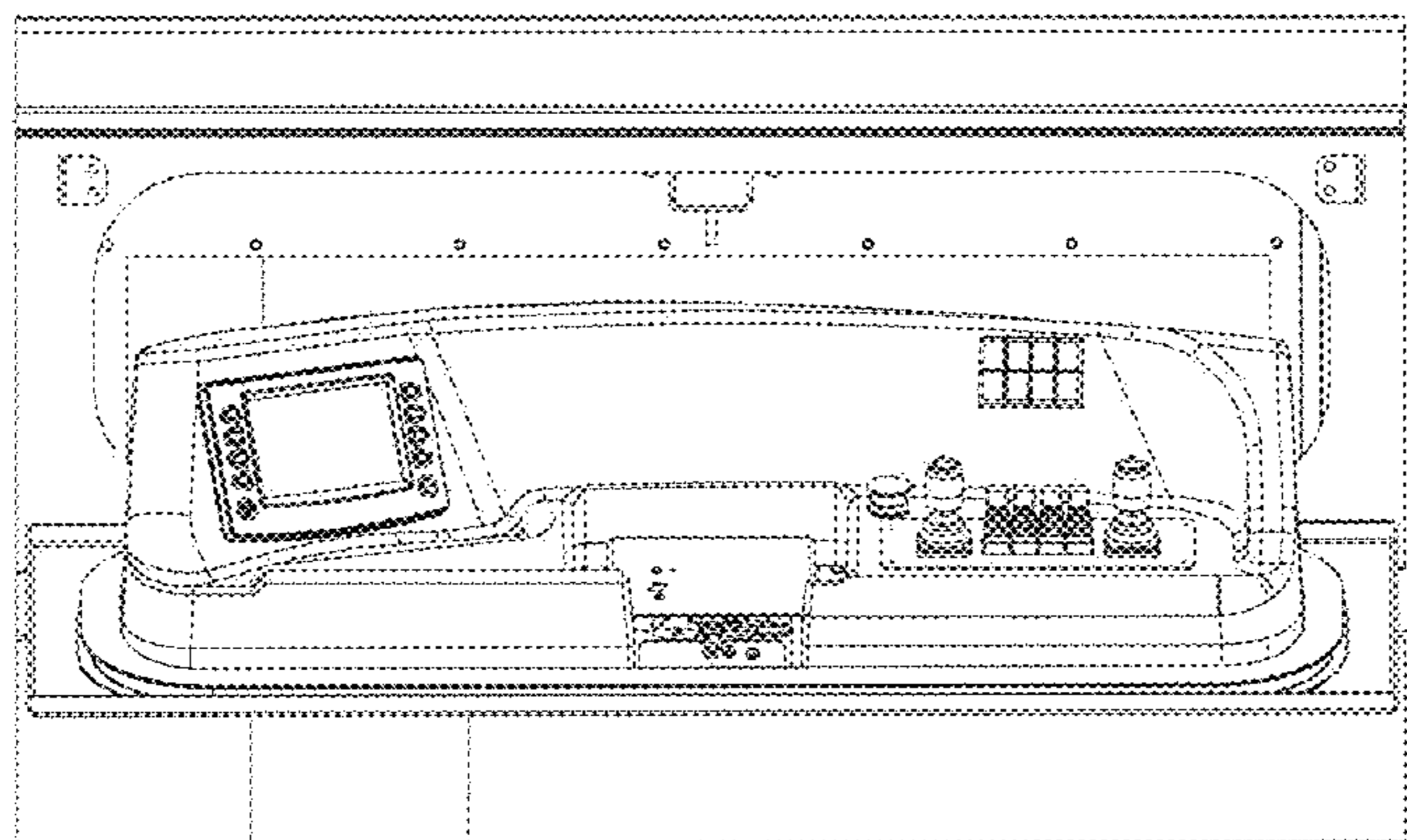

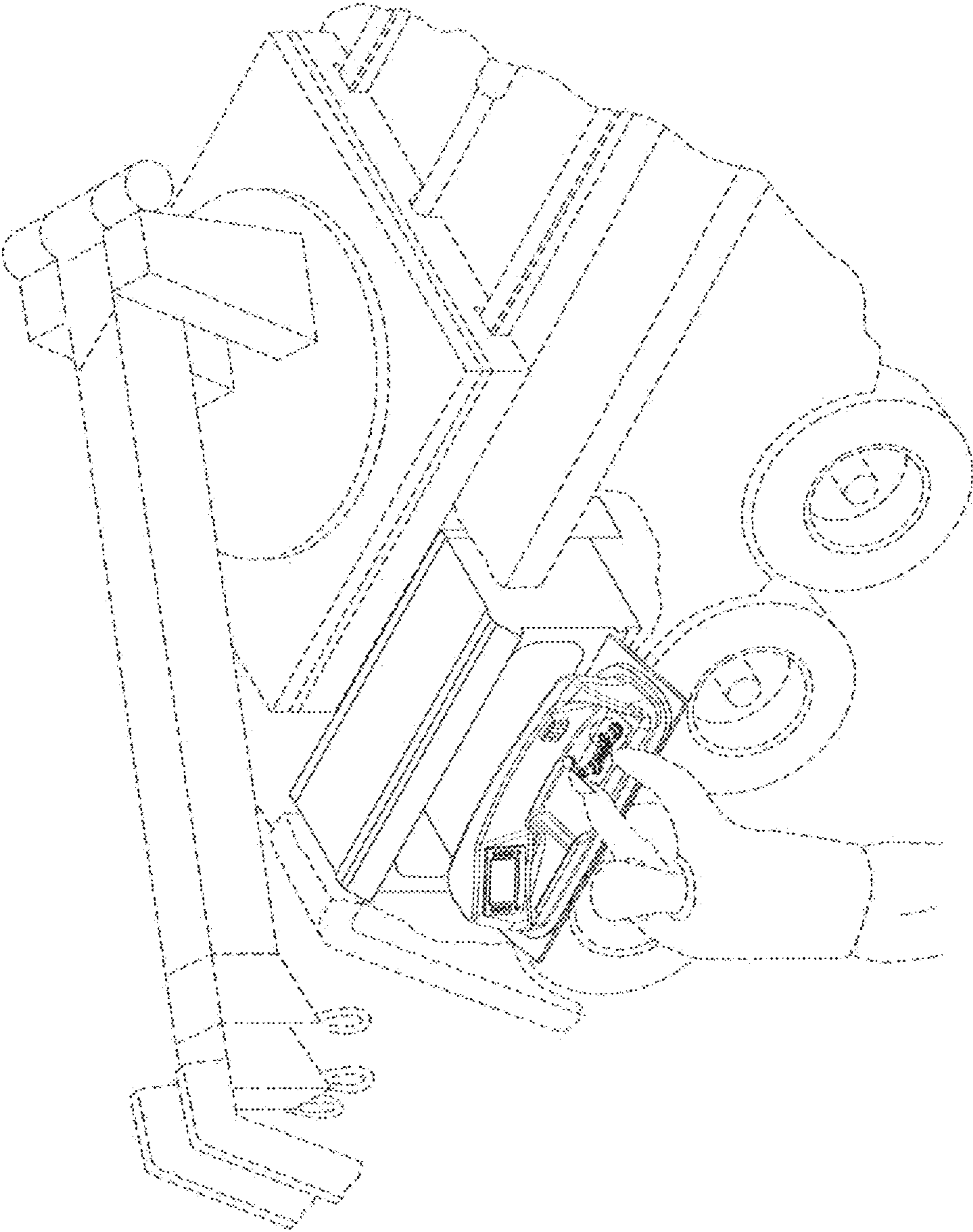

Fig. 1

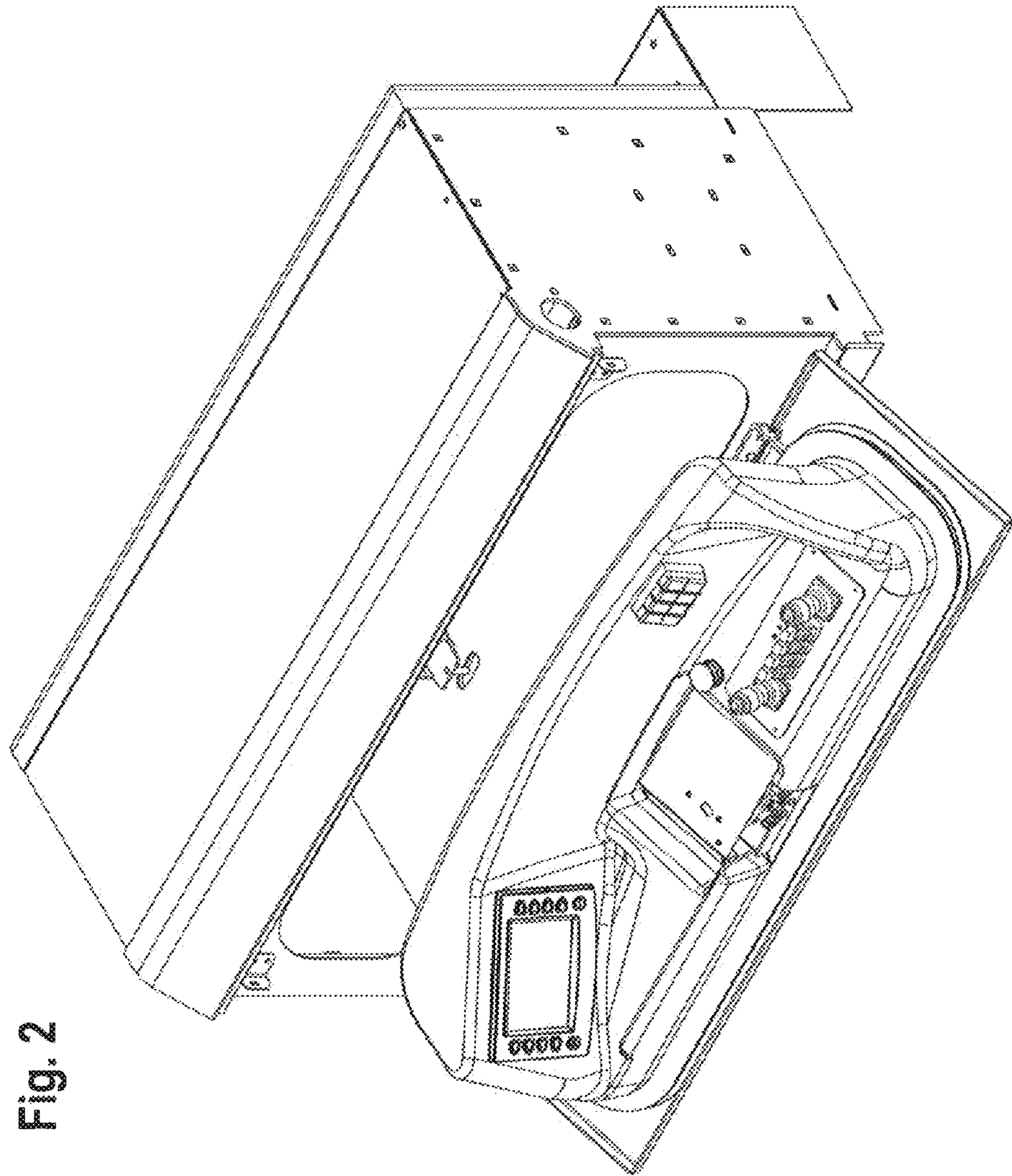

Fig. 2

Fig. 3

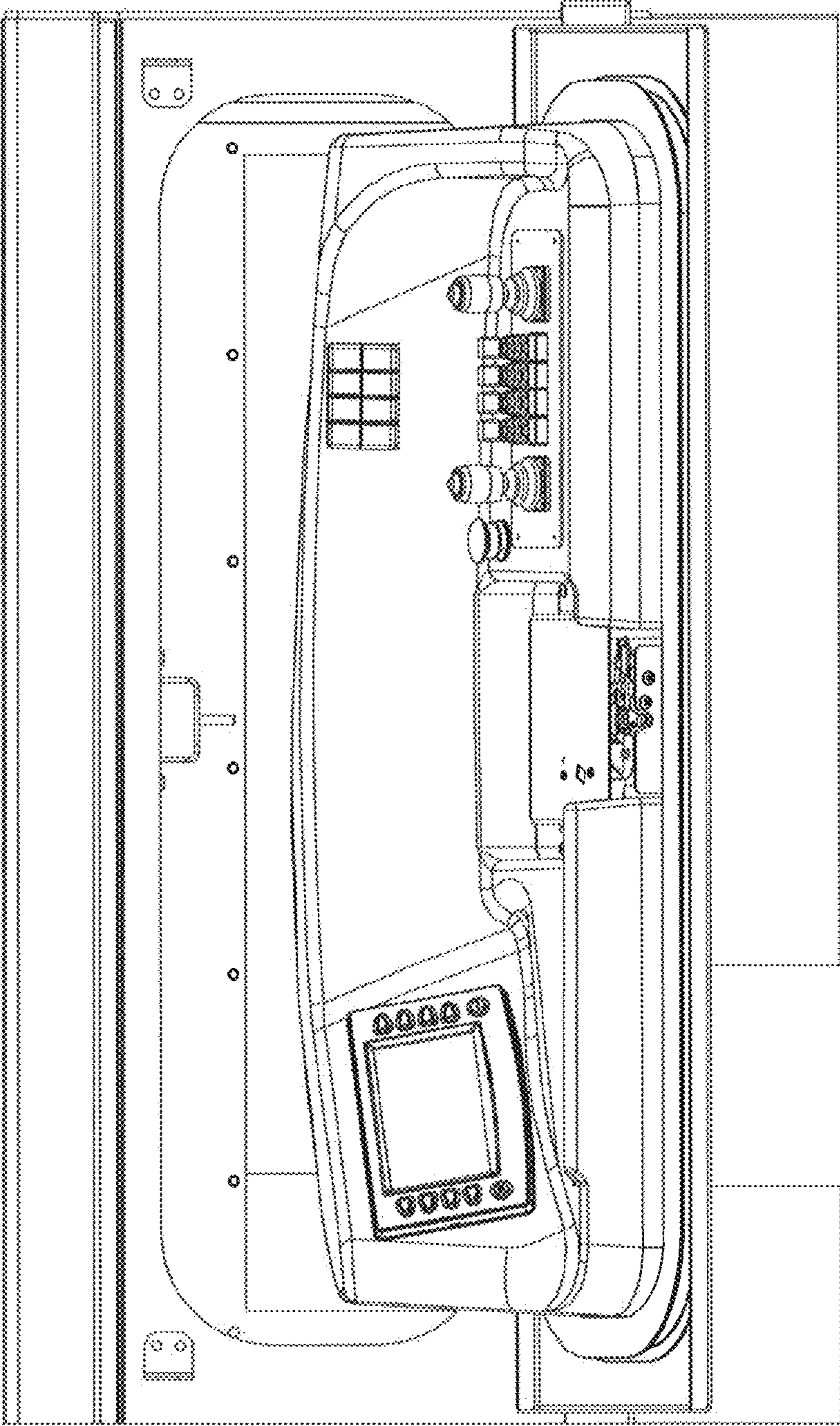

Fig. 4

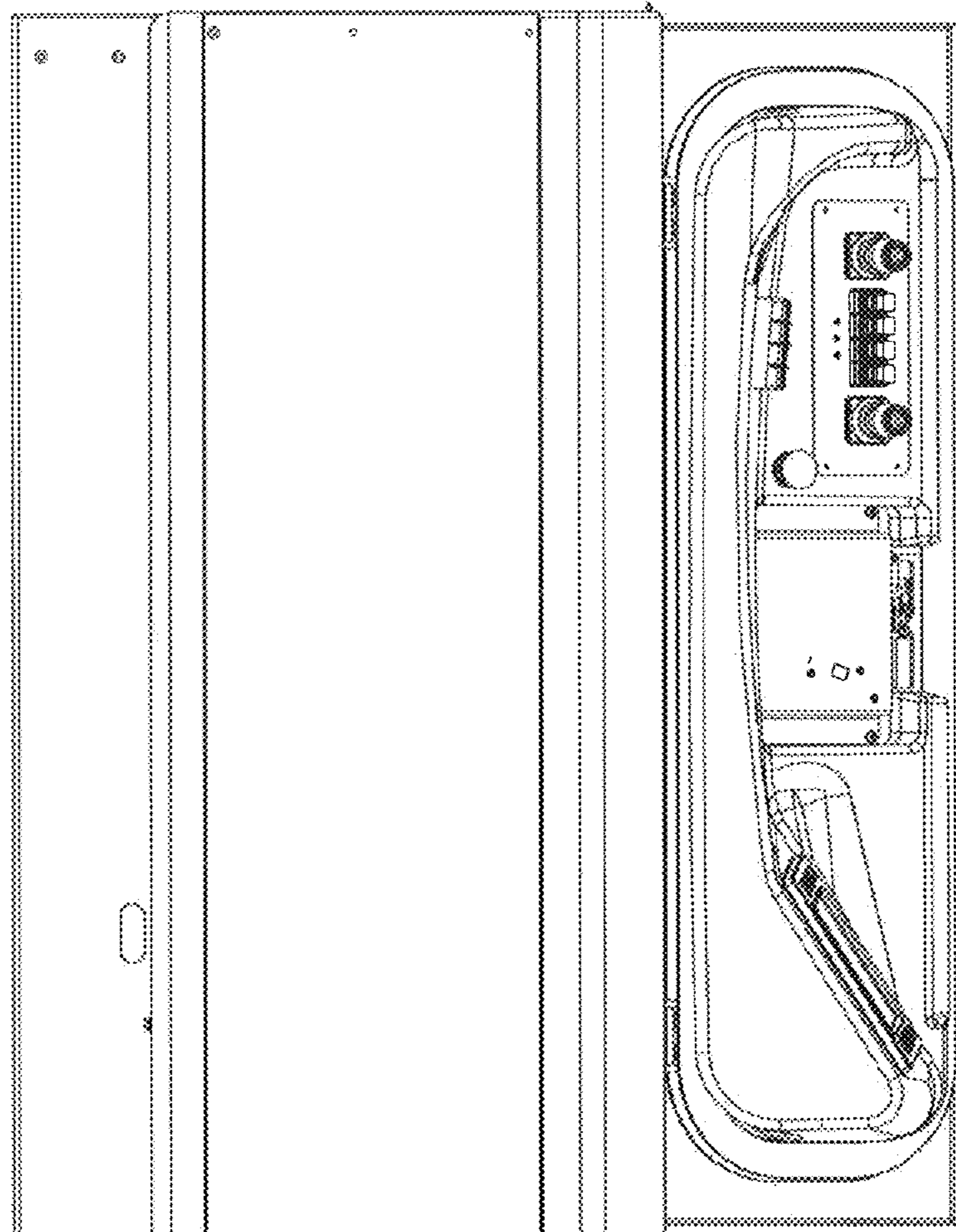
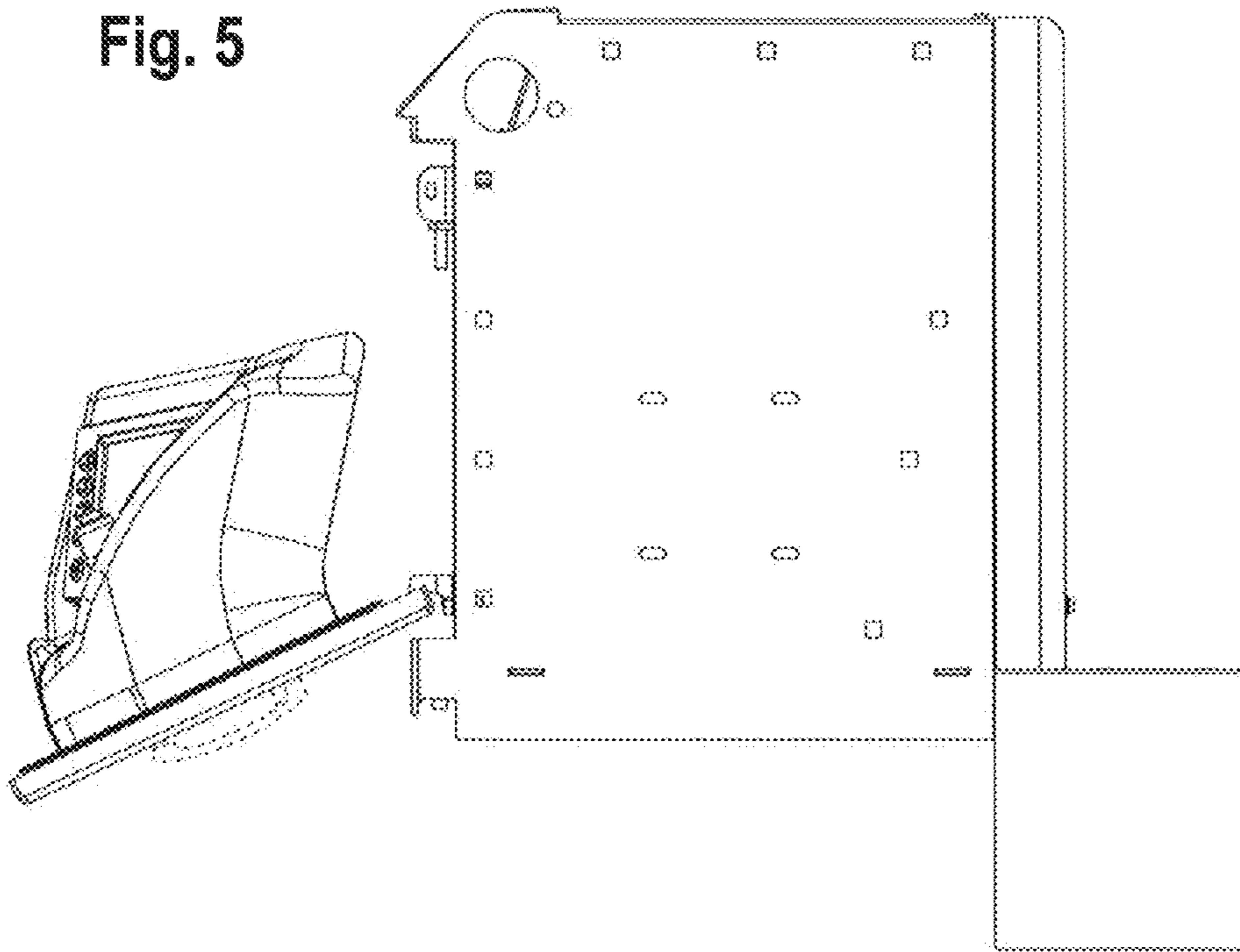

Fig. 5



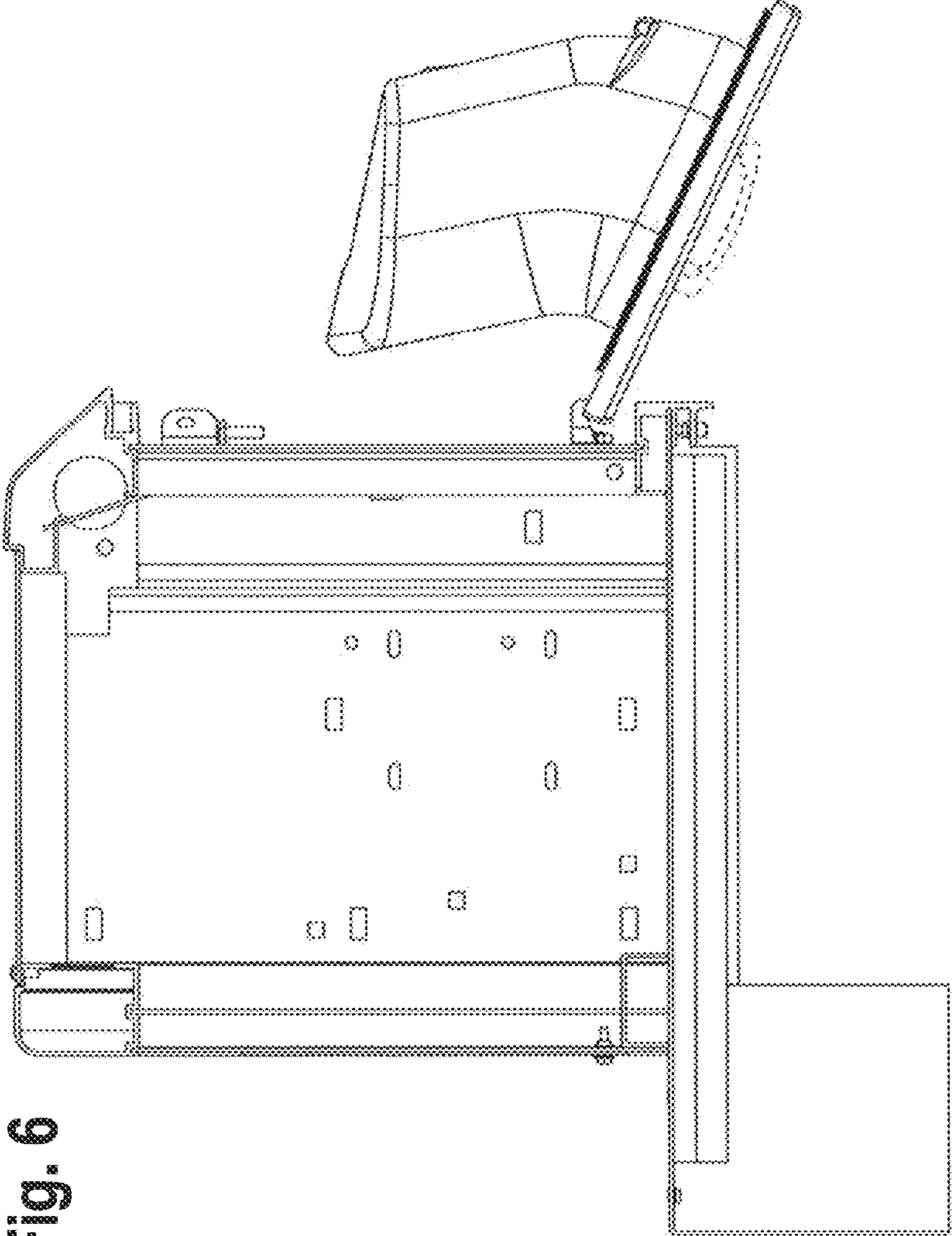

Fig. 6

Fig. 7

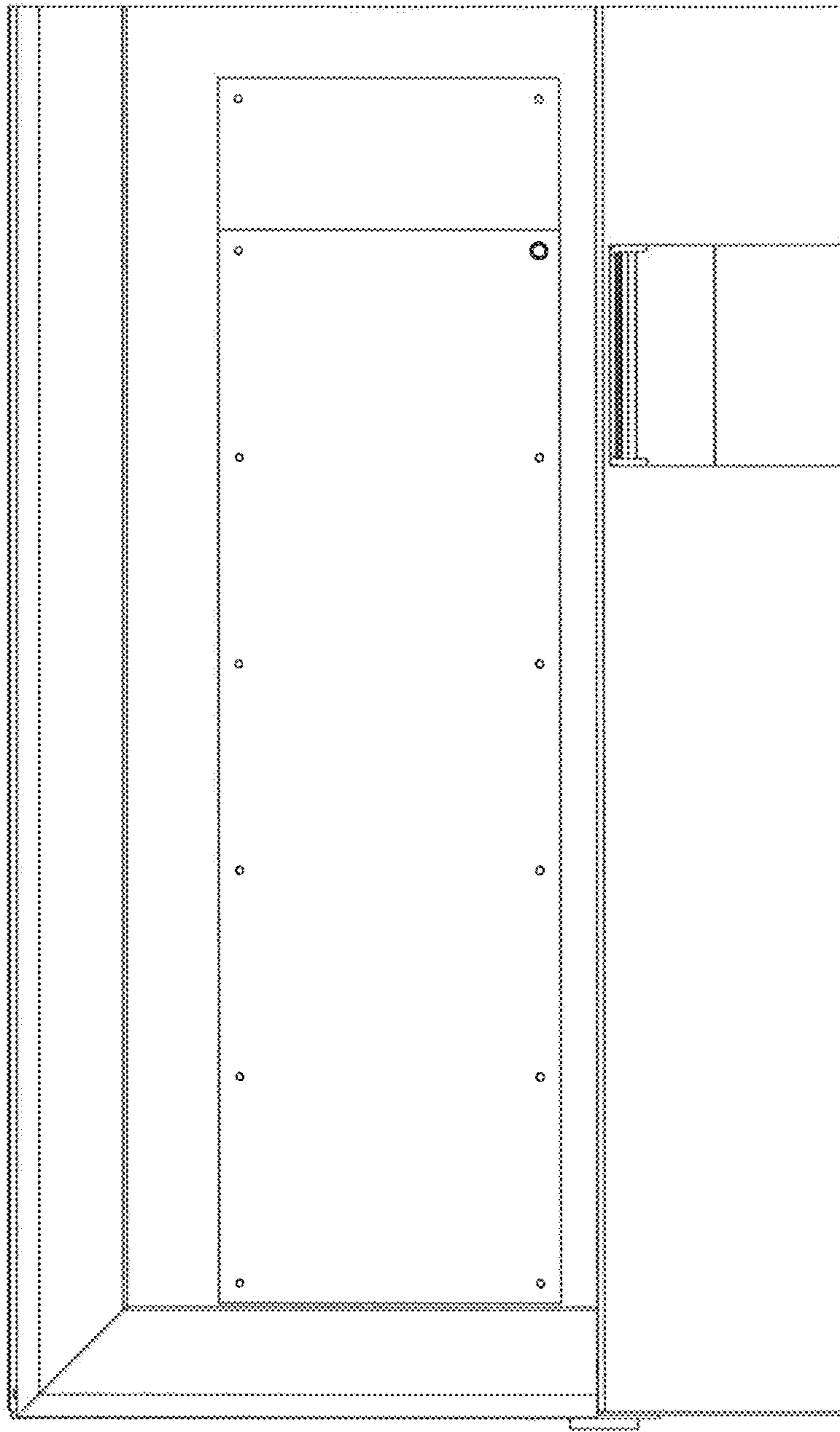

Fig. 8

