



US00D751362S

(12) **United States Design Patent**
Chang

(10) **Patent No.:** **US D751,362 S**
(45) **Date of Patent:** **** Mar. 15, 2016**

(54) **WRENCH**

(71) Applicant: **Chih-Min Chang**, Xiushui Township,
Changhua County (TW)

(72) Inventor: **Chih-Min Chang**, Xiushui Township,
Changhua County (TW)

(**) Term: **14 Years**

(21) Appl. No.: **29/509,479**

(22) Filed: **Nov. 18, 2014**

(30) **Foreign Application Priority Data**

May 19, 2014 (TW) 103302987

(51) **LOC (10) Cl.** **08-05**

(52) **U.S. Cl.**
USPC **D8/27; D8/28; D8/29**

(58) **Field of Classification Search**
USPC D8/29; 81/60, 177.1, 177.85, 121.1,
81/124.3, 165-170, 110.1, 176.2, 124.6,
81/176.1, 176.15, 177.2; 16/110.1

CPC B25B 13/06; B25B 13/065
See application file for complete search history.

(56) **References Cited**

U.S. PATENT DOCUMENTS

5,277,531	A *	1/1994	Krivec	411/403
5,544,555	A *	8/1996	Corley et al.	81/125
6,626,067	B1 *	9/2003	Iwinski et al.	81/121.1
D507,946	S *	8/2005	Hsien	D8/27
D624,796	S *	10/2010	Taylor, Jr.	D8/28
2004/0020332	A1 *	2/2004	Hsieh	81/186

* cited by examiner

Primary Examiner — Randall Gholson

(74) *Attorney, Agent, or Firm* — Muncy, Geissler, Olds & Lowe, P.C.

(57) **CLAIM**

The ornamental design for a wrench, as shown and described.

DESCRIPTION

FIG. 1 is a perspective view of the present design;
FIG. 2 is a front view of the present design;
FIG. 3 is a rear view of the present design;
FIG. 4 is a left side view of the present design;
FIG. 5 is a right side view of the present design;
FIG. 6 is a top view of the present design; and,
FIG. 7 is a bottom view of the present design.
The broken lines depict portions of the wrench that forms no part of the claimed design.

1 Claim, 4 Drawing Sheets

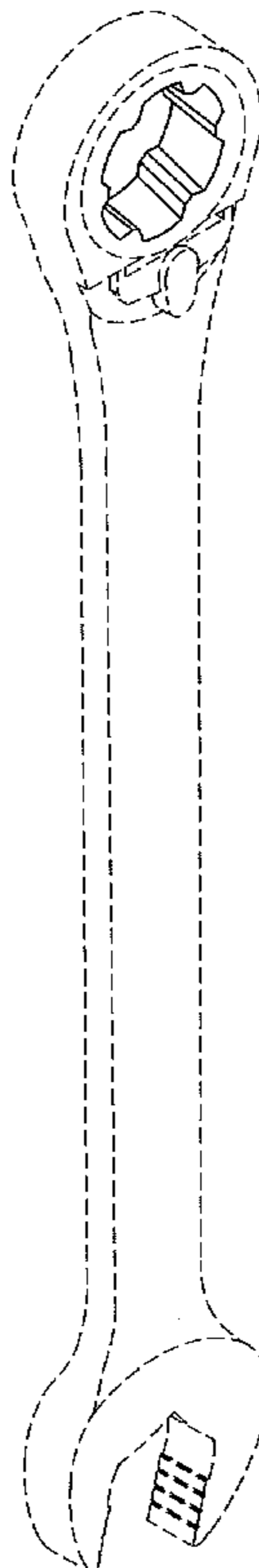

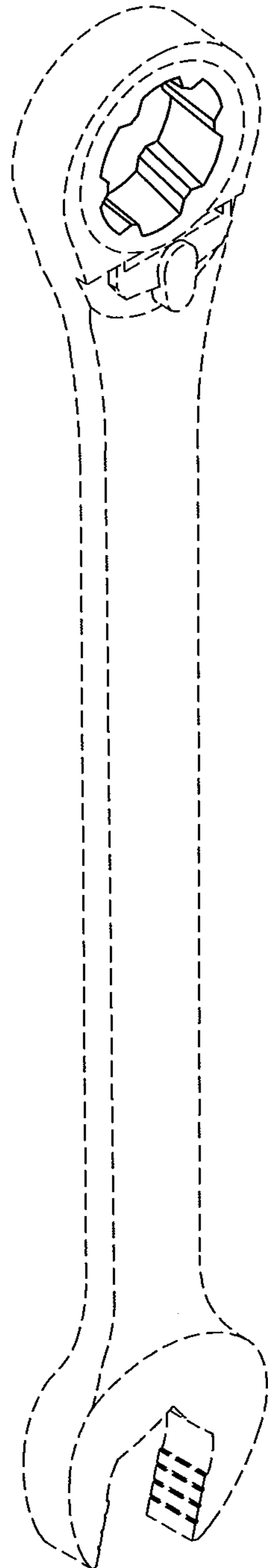

FIG. 1

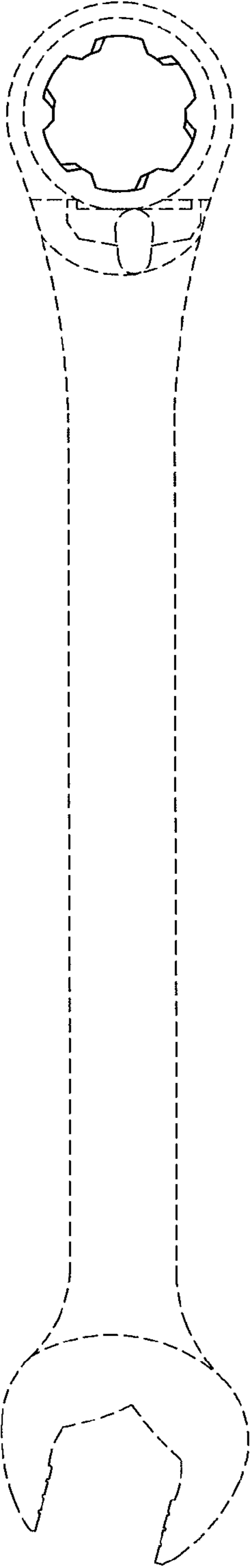

FIG. 2

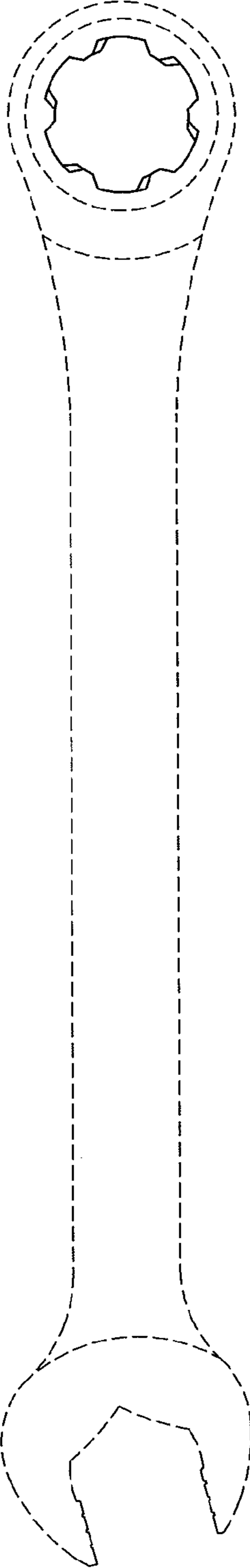

FIG. 3

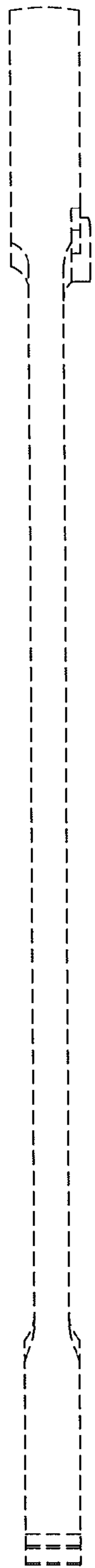

FIG. 4

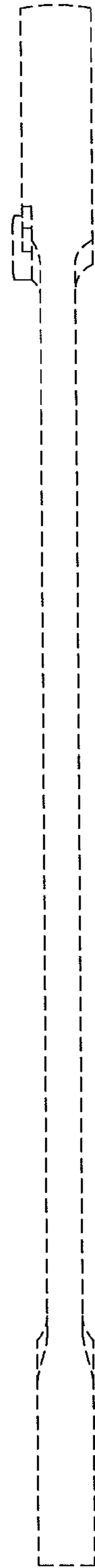

FIG. 5

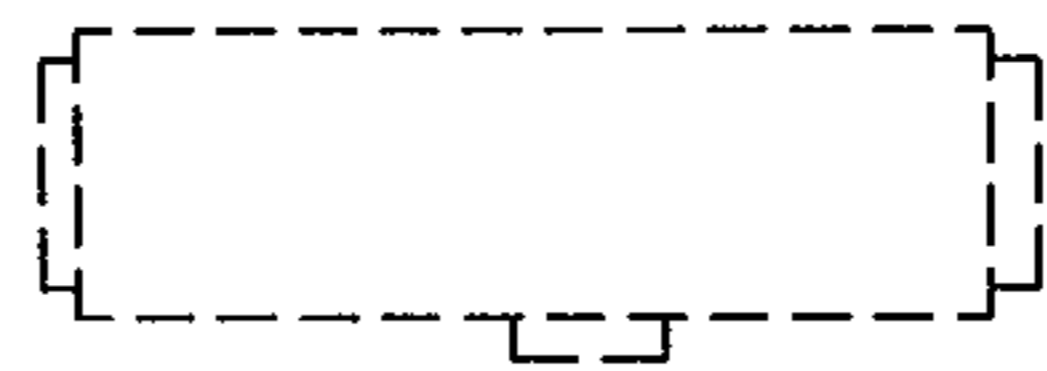

FIG. 6



FIG. 7