



US00D749708S

(12) **United States Design Patent**
Smith

(10) **Patent No.:** **US D749,708 S**

(45) **Date of Patent:** **** Feb. 16, 2016**

(54) **PIPE JOINT SEAL WITH ANNULAR REINFORCEMENT RIDGE**

(71) Applicant: **Steven A Smith**, Alabaster, AL (US)

(72) Inventor: **Steven A Smith**, Alabaster, AL (US)

(**) Term: **14 Years**

(21) Appl. No.: **29/517,470**

(22) Filed: **Feb. 12, 2015**

(51) **LOC (10) Cl.** **23-01**

(52) **U.S. Cl.**
USPC **D23/269**

(58) **Field of Classification Search**

USPC D13/120; D23/259–266, 269, 393
CPC E03F 5/06; F16L 23/036; F16L 23/08;
F16L 9/003; F16L 19/064; F16L 19/10283;
F16L 19/065; B21D 22/16; F16J 15/125
See application file for complete search history.

(56) **References Cited**

U.S. PATENT DOCUMENTS

892,524 A * 7/1908 Jeffreys F16L 23/036
285/364
1,520,028 A * 12/1924 Krause F16L 23/036
285/405
1,942,704 A * 1/1934 Hubbard F16J 15/125
277/601
2,013,293 A * 9/1935 Snell F06L 23/08
285/33
3,638,971 A * 2/1972 Smith E21B 17/18
285/352
4,443,029 A * 4/1984 Laxo F16L 23/08
285/367
4,778,189 A * 10/1988 Udagawa F16J 15/123
277/612
4,962,938 A * 10/1990 Cooper F16J 15/064
137/68.23
D372,033 S * 7/1996 Kanemitsu D15/5

D372,074 S * 7/1996 Wallace D23/269
D374,015 S * 9/1996 Wainer 277/608
D375,150 S * 10/1996 Wainer D23/269
D375,160 S * 10/1996 Sampson D23/262
6,688,337 B2 * 2/2004 Ward F16L 55/265
138/97
D563,206 S * 3/2008 Bakker D8/356
D644,720 S * 9/2011 Bond D23/269
D644,721 S * 9/2011 Bond D23/269
D644,722 S * 9/2011 Bond D23/269
2005/0258642 A1 * 11/2005 Brophy, III F01N 13/1811
285/223
2006/0162326 A1 * 7/2006 Nakagawa F01N 13/1805
60/322
2008/0012324 A1 * 1/2008 Dole F16L 19/0283
285/339
2014/0333035 A1 * 11/2014 Schemmann F16J 15/02
277/602

* cited by examiner

Primary Examiner — George D Kirschbaum

Assistant Examiner — Amy Wierenga

(74) *Attorney, Agent, or Firm* — Gerald M. Walsh; Leo Law Firm, LLC

(57) **CLAIM**

I claim the ornamental design for a pipe joint seal with annular reinforcement ridge, as shown and described.

DESCRIPTION

FIG. 1 is a front left perspective view of a pipe joint seal with annular reinforcement ridge showing my new design; FIG. 2 is a front elevation view thereof, the rear view being a mirror image thereof; FIG. 3 is a top plan view thereof, the bottom view being a mirror image thereof; and, FIG. 4 is a left side elevation view thereof, the right side view being a mirror image thereof. The annular reinforcement ridge encircles the central opening of the pipe joint seal.

1 Claim, 2 Drawing Sheets

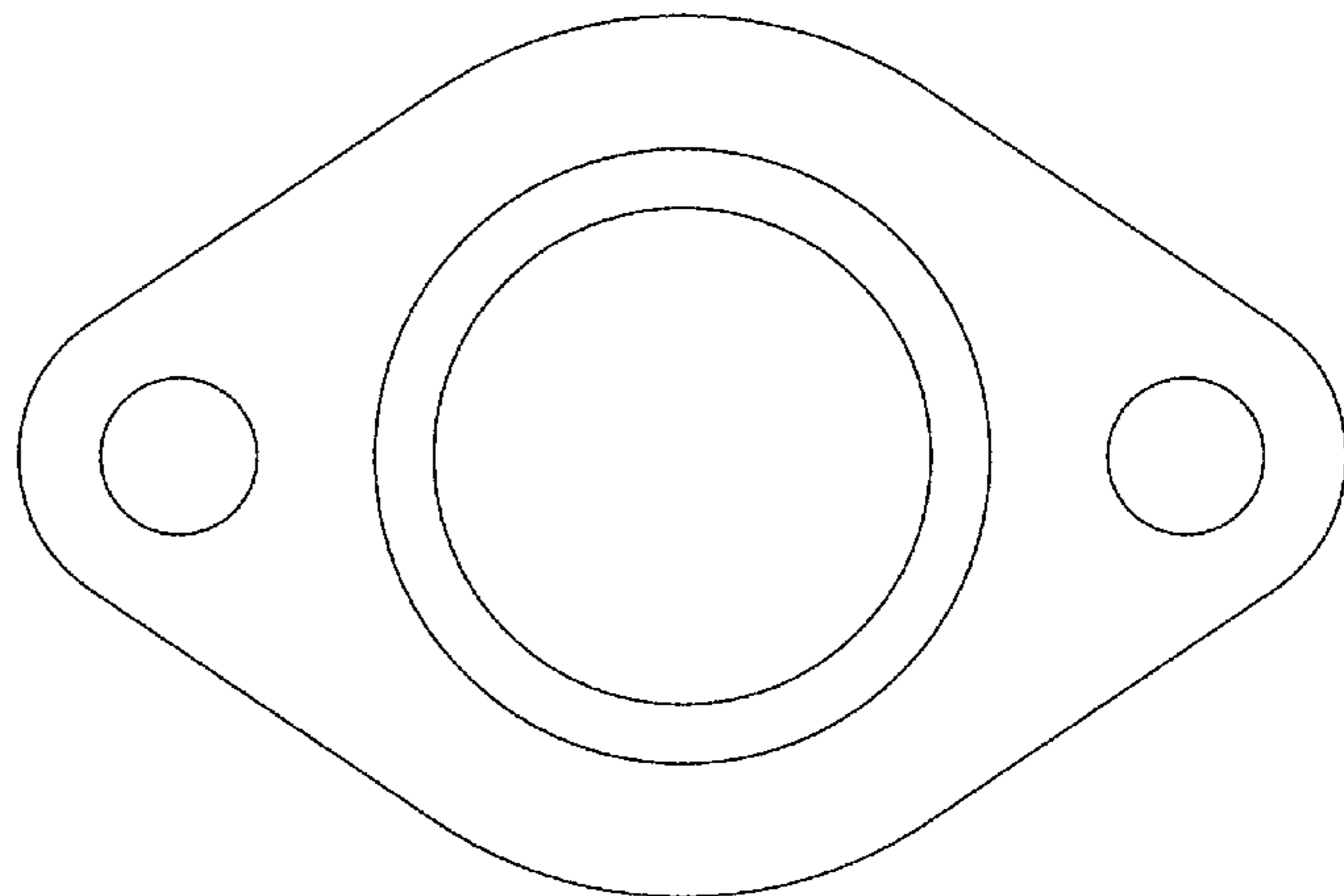
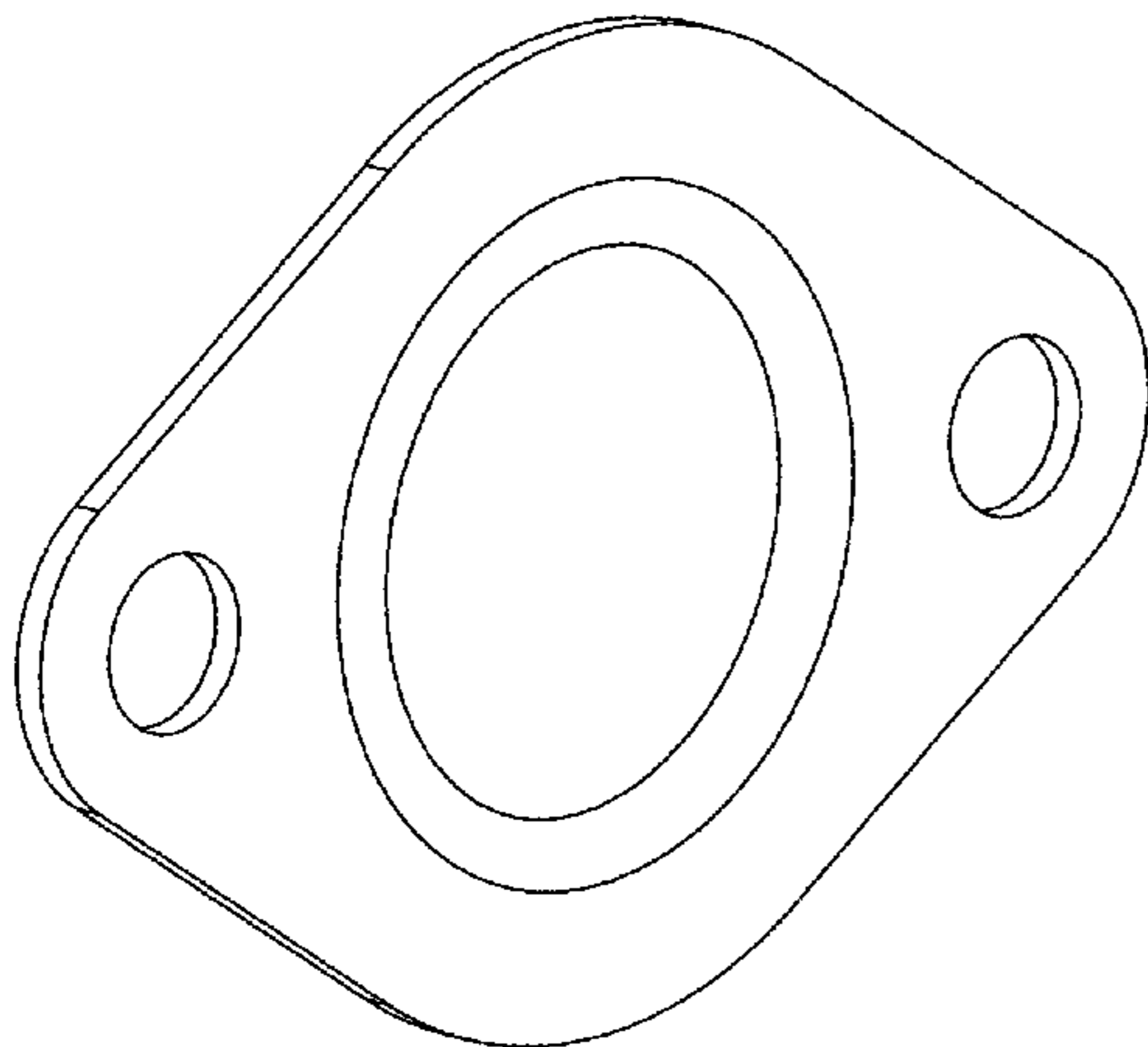

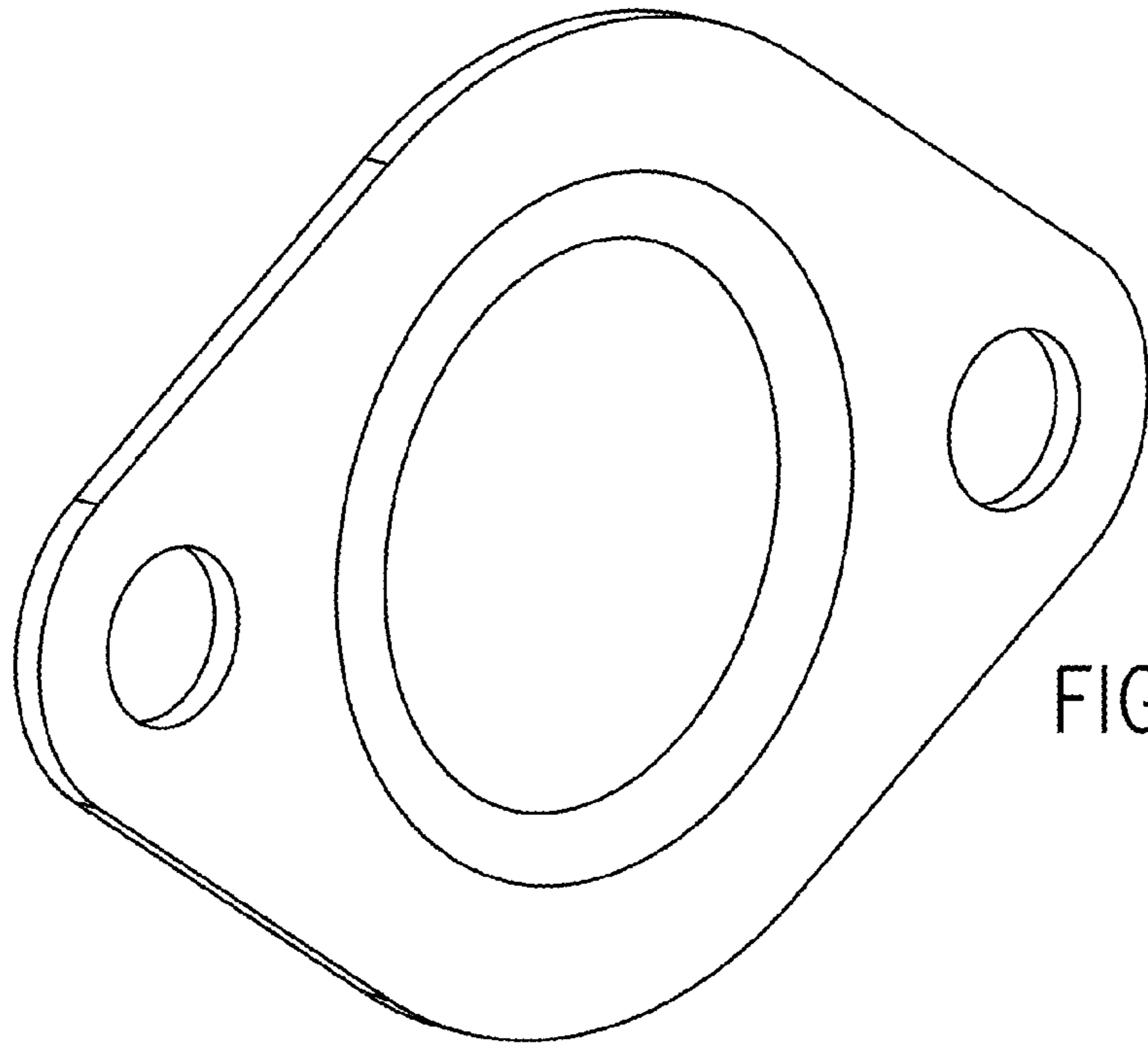

FIG. 1

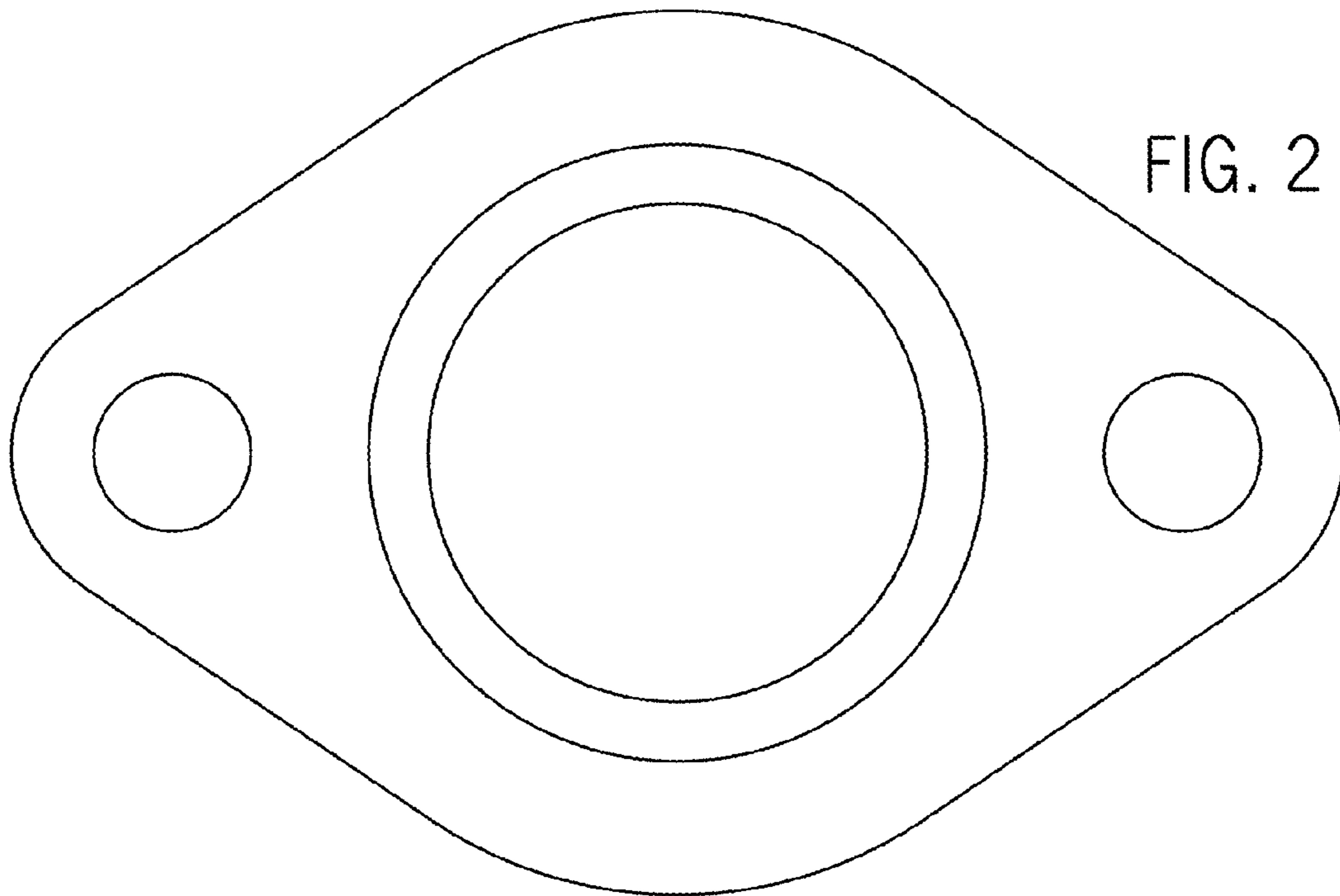

FIG. 2



FIG. 3



FIG. 4