



US00D749683S

(12) **United States Design Patent**
Staal

(10) **Patent No.:** **US D749,683 S**

(45) **Date of Patent:** **** Feb. 16, 2016**

(54) **EXERCISE RAMP**

(71) Applicant: **Robert Staal**, Downey, CA (US)

(72) Inventor: **Robert Staal**, Downey, CA (US)

(**) Term: **14 Years**

(21) Appl. No.: **29/486,523**

(22) Filed: **Mar. 31, 2014**

(51) **LOC (10) Cl.** **21-02**

(52) **U.S. Cl.**
USPC **D21/671**

(58) **Field of Classification Search**
USPC D21/670, 671, 685, 686; D6/675.3,
D6/350; D25/62, 63, 65; D34/30, 32
CPC B66F 7/243; E04H 4/144; E04H 3/12;
E04H 3/123; A47F 5/108; A47F 7/145;
E06C 1/24; E06C 1/393; E06C 7/16; A47C
12/02; A47C 12/00; E04F 11/025; E04F
11/02; E04F 11/06; E04F 11/18; E04F
11/1865; E04F 11/00; E04F 11/002
See application file for complete search history.

(56) **References Cited**

U.S. PATENT DOCUMENTS

| | | | | | | |
|-----------|---|---|---------|----------------|-------|---------|
| D248,290 | S | * | 6/1978 | Guerette | | D34/30 |
| D270,004 | S | * | 8/1983 | Struben et al. | | D25/63 |
| 5,352,166 | A | * | 10/1994 | Chang | | 482/52 |
| D375,290 | S | * | 11/1996 | Hall | | D12/318 |

| | | | | | | |
|--------------|----|---|---------|---------------|-------|---------|
| 5,769,759 | A | * | 6/1998 | Alter et al. | | 482/37 |
| 5,794,391 | A | * | 8/1998 | Howard | | 52/182 |
| D489,786 | S | * | 5/2004 | Pratt | | D21/817 |
| 6,926,119 | B1 | * | 8/2005 | Schrock | | 182/33 |
| D557,936 | S | * | 12/2007 | Van Es | | D6/460 |
| 7,841,447 | B2 | * | 11/2010 | Frame | | 182/16 |
| D644,742 | S | * | 9/2011 | Rivera et al. | | D25/62 |
| D681,850 | S | * | 5/2013 | Daly | | D25/63 |
| D698,463 | S | * | 1/2014 | Porter | | D25/63 |
| 2011/0190104 | A1 | * | 8/2011 | Derrick | | 482/142 |
| 2013/0210588 | A1 | * | 8/2013 | Derrick | | 482/96 |

* cited by examiner

Primary Examiner — George D Kirschbaum

Assistant Examiner — Jennifer Watkins

(74) *Attorney, Agent, or Firm* — Kenneth L. Green; Averill & Green

(57) **CLAIM**

The ornamental design for an exercise ramp, as shown and described.

DESCRIPTION

FIG. 1 is a perspective view showing the front and left sides of an exercise ramp showing my new design.

FIG. 2 is a front view showing my new design.

FIG. 3 is a left side view showing my new design; and,

FIG. 4 is a right side view showing my new design.

The broken lines in the drawings are for the purpose of illustrating environment that forms no part of the claim.

1 Claim, 3 Drawing Sheets

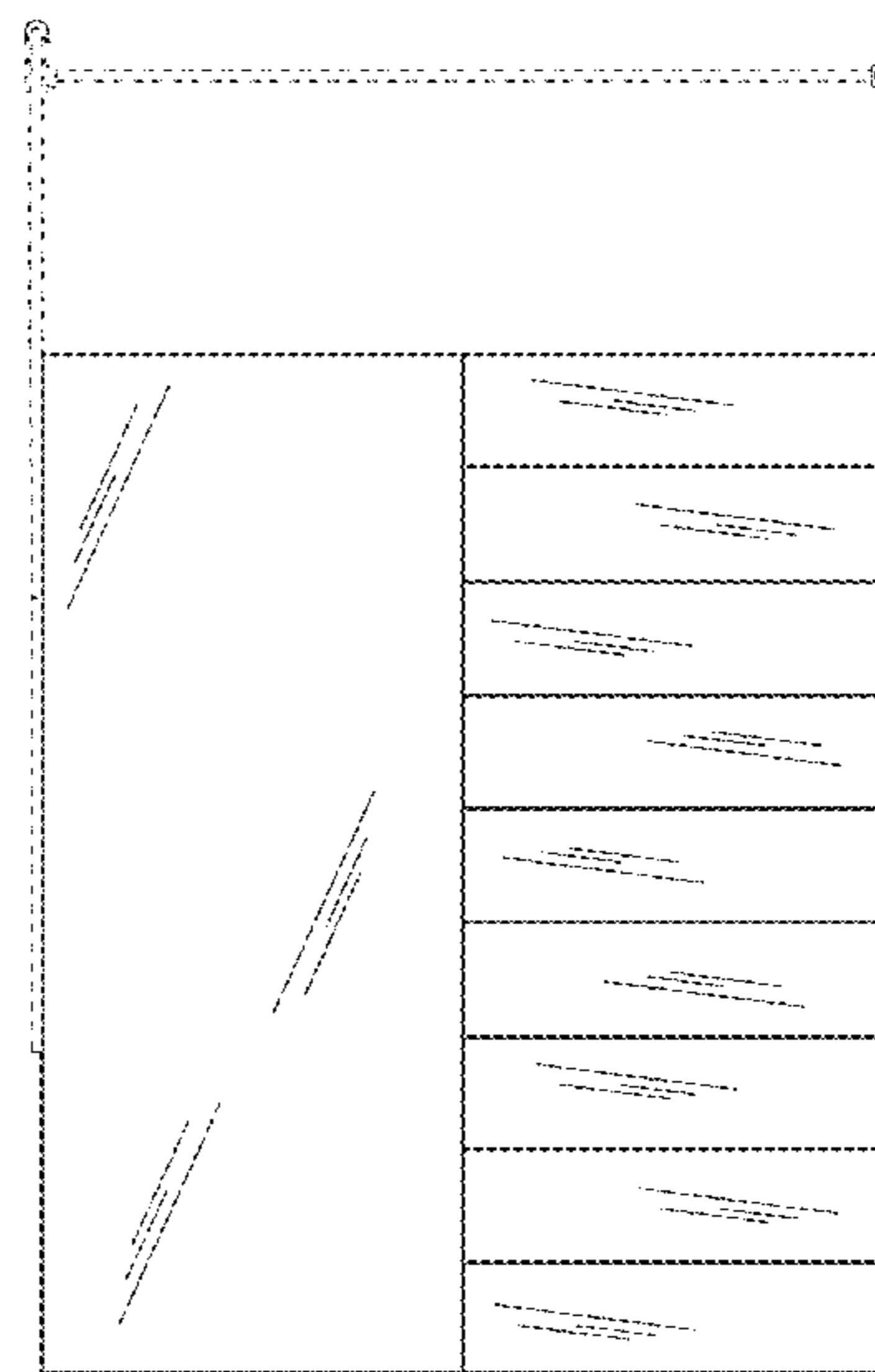
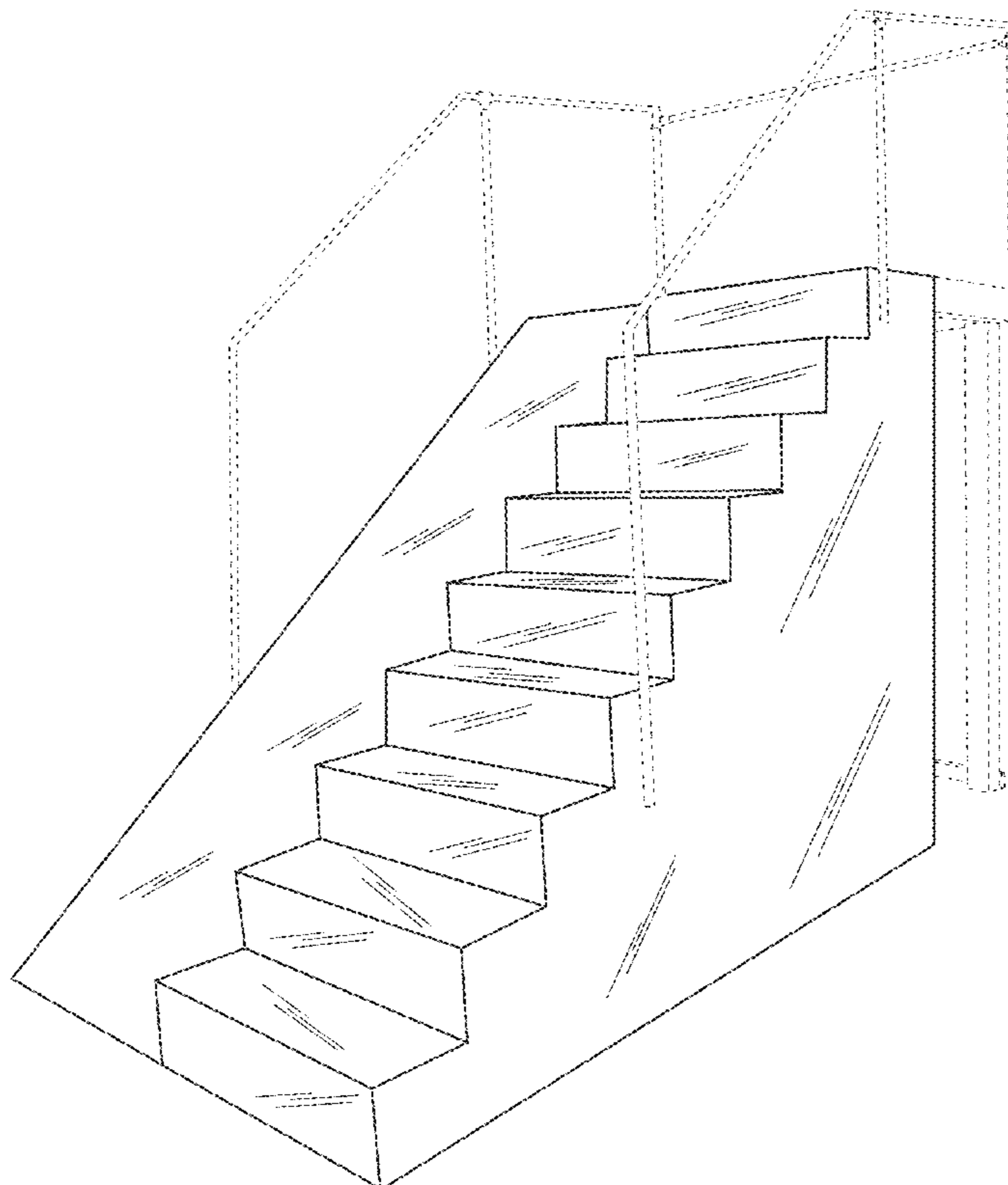

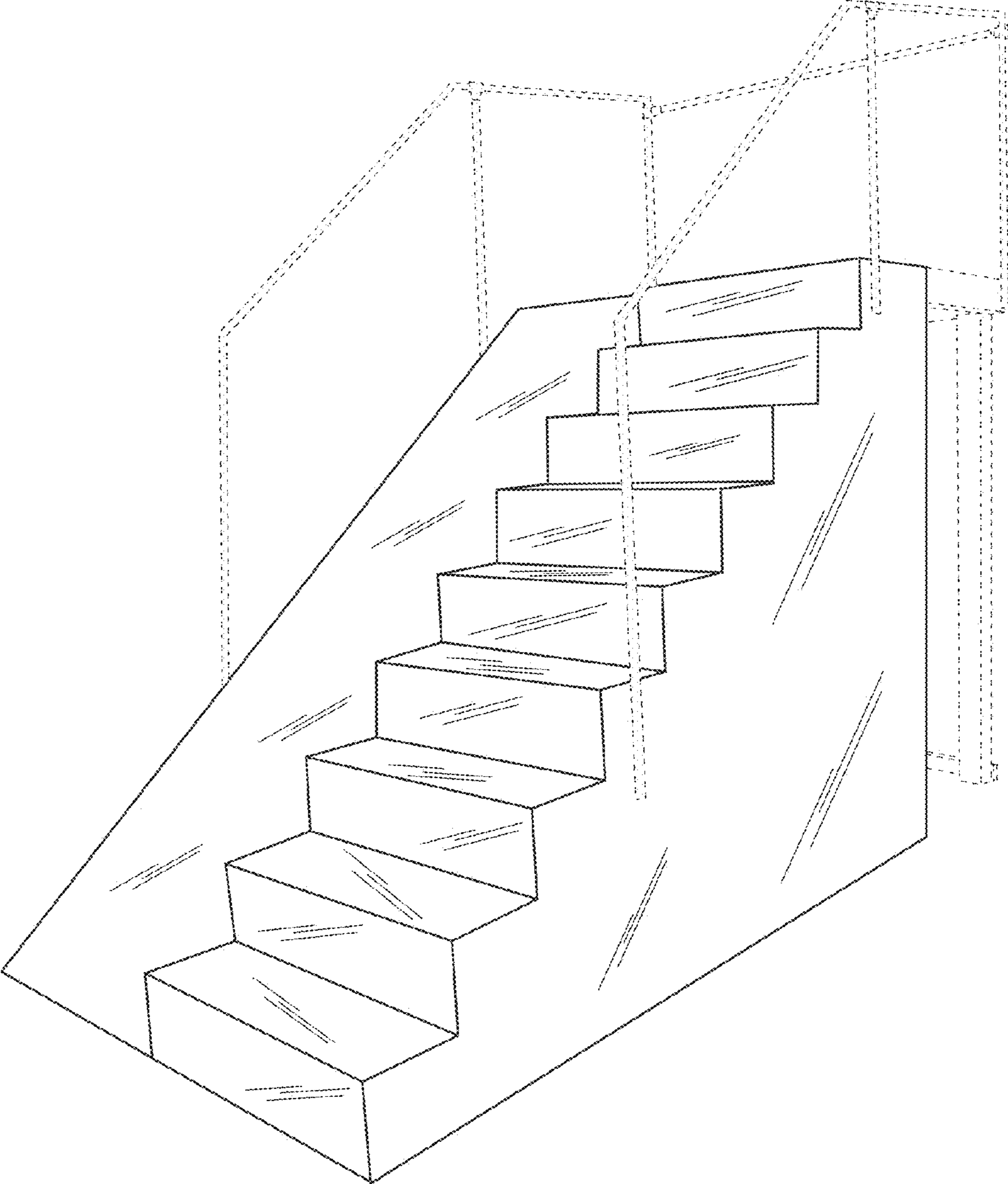

FIG. 1

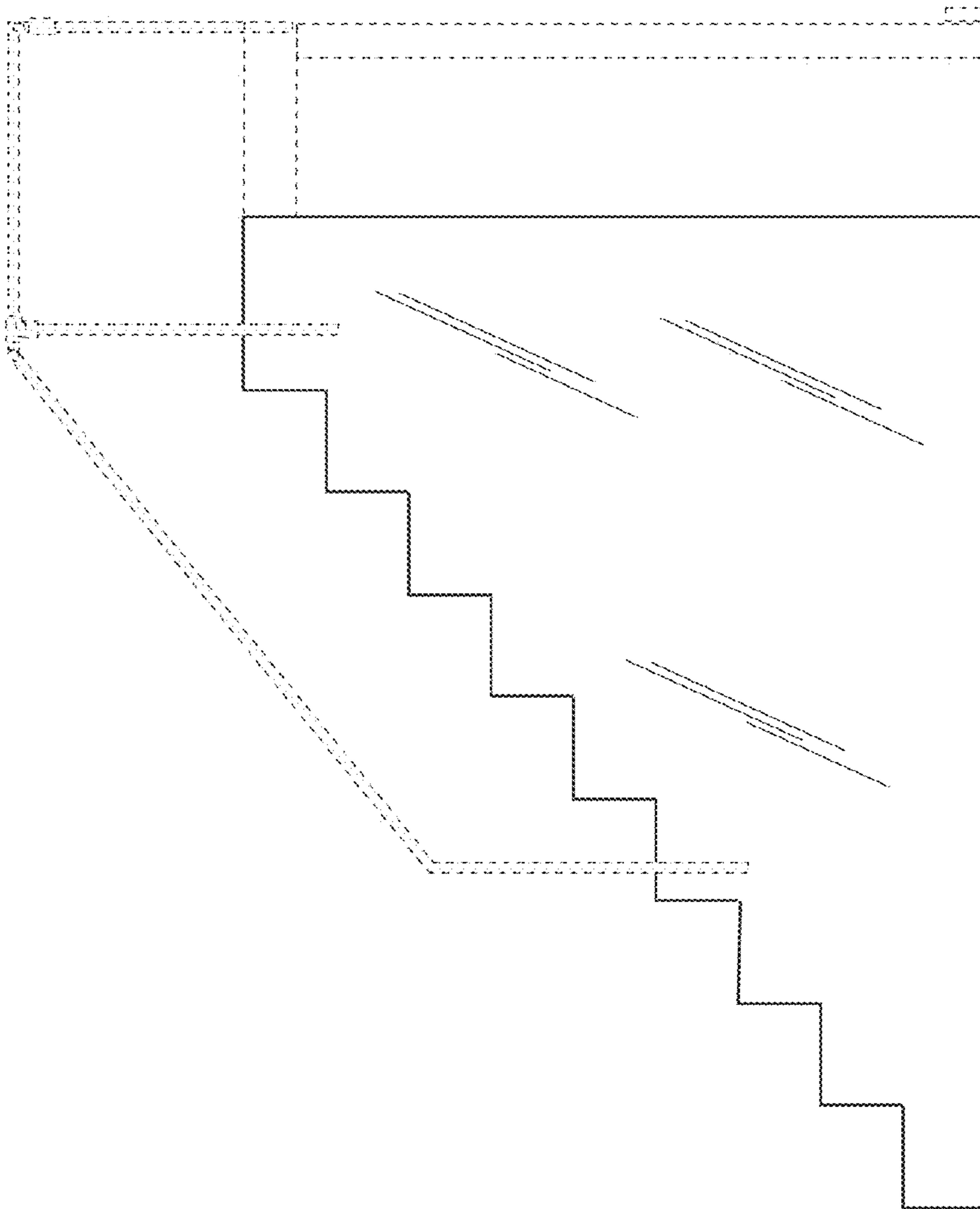

FIG. 2

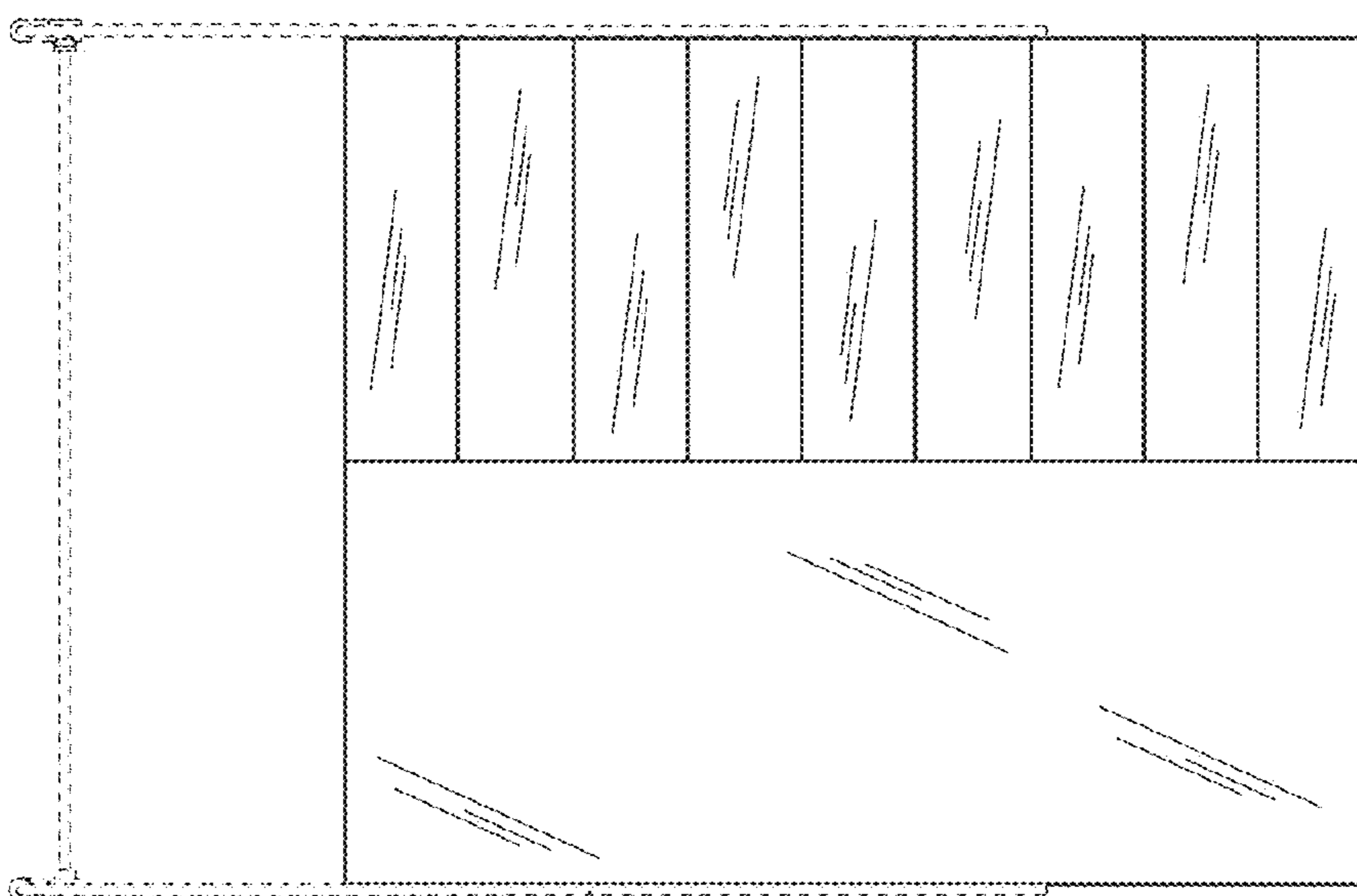

FIG. 3

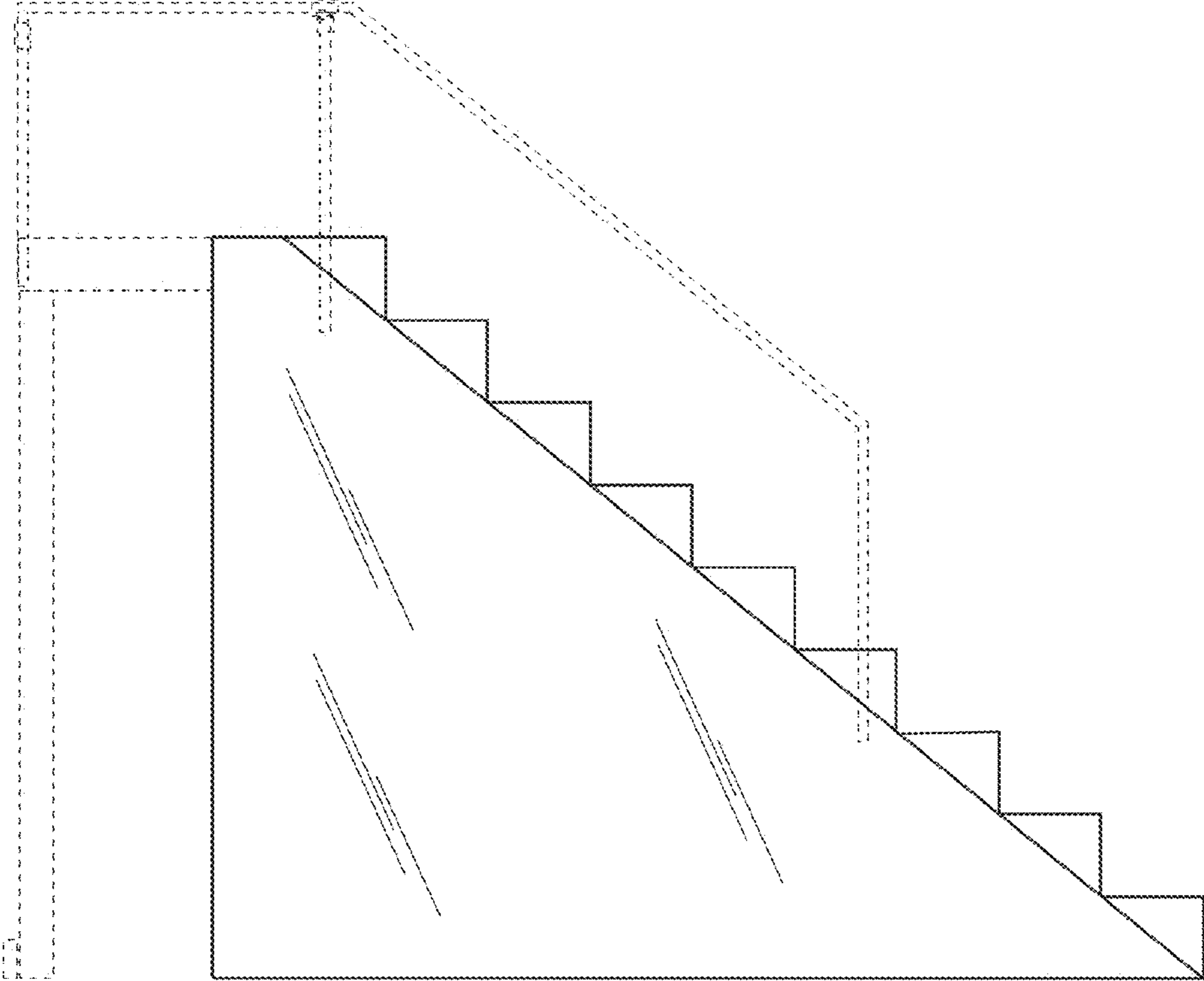

FIG. 4