



US00D748356S

(12) **United States Design Patent**
Tietz

(10) **Patent No.:** **US D748,356 S**
(45) **Date of Patent:** **** Jan. 26, 2016**

(54) **CONTAINER FOR A CLOTHES WASHING MACHINE**

(71) Applicant: **Whirlpool Corporation**, Benton Harbor, MI (US)

(72) Inventor: **Dean L. Tietz**, Saint Joseph, MI (US)

(73) Assignee: **Whirlpool Corporation**, Benton Harbor, MI (US)

(**) Term: **14 Years**

(21) Appl. No.: **29/460,847**

(22) Filed: **Jul. 16, 2013**

(51) **LOC (10) Cl.** **15-05**

(52) **U.S. Cl.**
USPC **D32/29**

(58) **Field of Classification Search**
USPC D32/1, 25, 29; 68/3 R, 5 R, 12.01, 12.08, 68/23 R, 23.5, 24, 58, 139, 142, 212; 34/58, 108, 130, 132

See application file for complete search history.

(56) **References Cited**

U.S. PATENT DOCUMENTS

D174,702 S *	5/1955	Oberg	D32/29
4,888,965 A *	12/1989	Fanson et al.	68/23.4
5,287,989 A *	2/1994	Luther	220/676
D358,204 S *	5/1995	Ferrier	D23/314
5,934,110 A *	8/1999	Nitsche	68/142
D426,686 S	6/2000	Clausen et al.		
D528,719 S	9/2006	No et al.		
D556,404 S	11/2007	Park et al.		

7,444,843 B2 *	11/2008	Ozturk et al.	68/142
7,997,104 B2 *	8/2011	Gracia Bobed	68/142
D652,591 S	1/2012	Kim		
2005/0097927 A1 *	5/2005	Kim et al.	68/24
2006/0150688 A1 *	7/2006	Kim et al.	68/142
2008/0178636 A1 *	7/2008	Lee et al.	68/142
2009/0211313 A1 *	8/2009	Exler et al.	68/142
2009/0249838 A1 *	10/2009	Kim et al.	68/58
2010/0307203 A1 *	12/2010	Gomez Caudevilla et al.		68/142
2010/0326142 A1	12/2010	Geyer et al.		

FOREIGN PATENT DOCUMENTS

CN	201158759 Y	12/2008
CN	101429717 A	5/2009
KR	100644823 B1	11/2006

* cited by examiner

Primary Examiner — John Windmuller
Assistant Examiner — Luqman McNeil

(57) **CLAIM**

The ornamental design for a container for a clothes washing machine, as shown and described.

DESCRIPTION

FIG. 1 is a perspective view of a container for a clothes washing machine having a textured pattern; and, FIG. 2 is a side view of the container from FIG. 1. The broken-line square surrounding the shaded area represents the boundary of the claim. The other broken lines represent portions of the container that are not part of the claimed design.

1 Claim, 2 Drawing Sheets

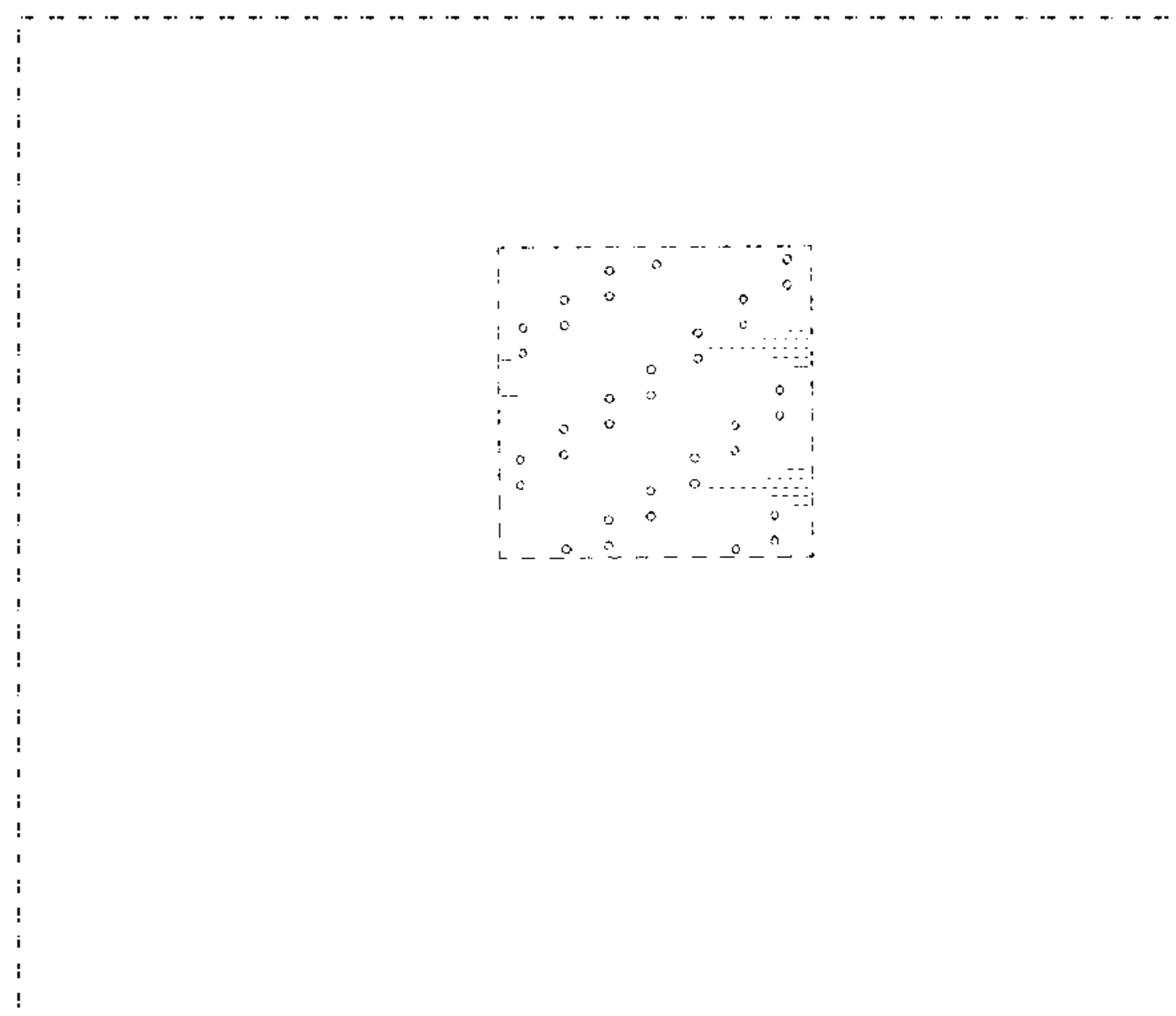
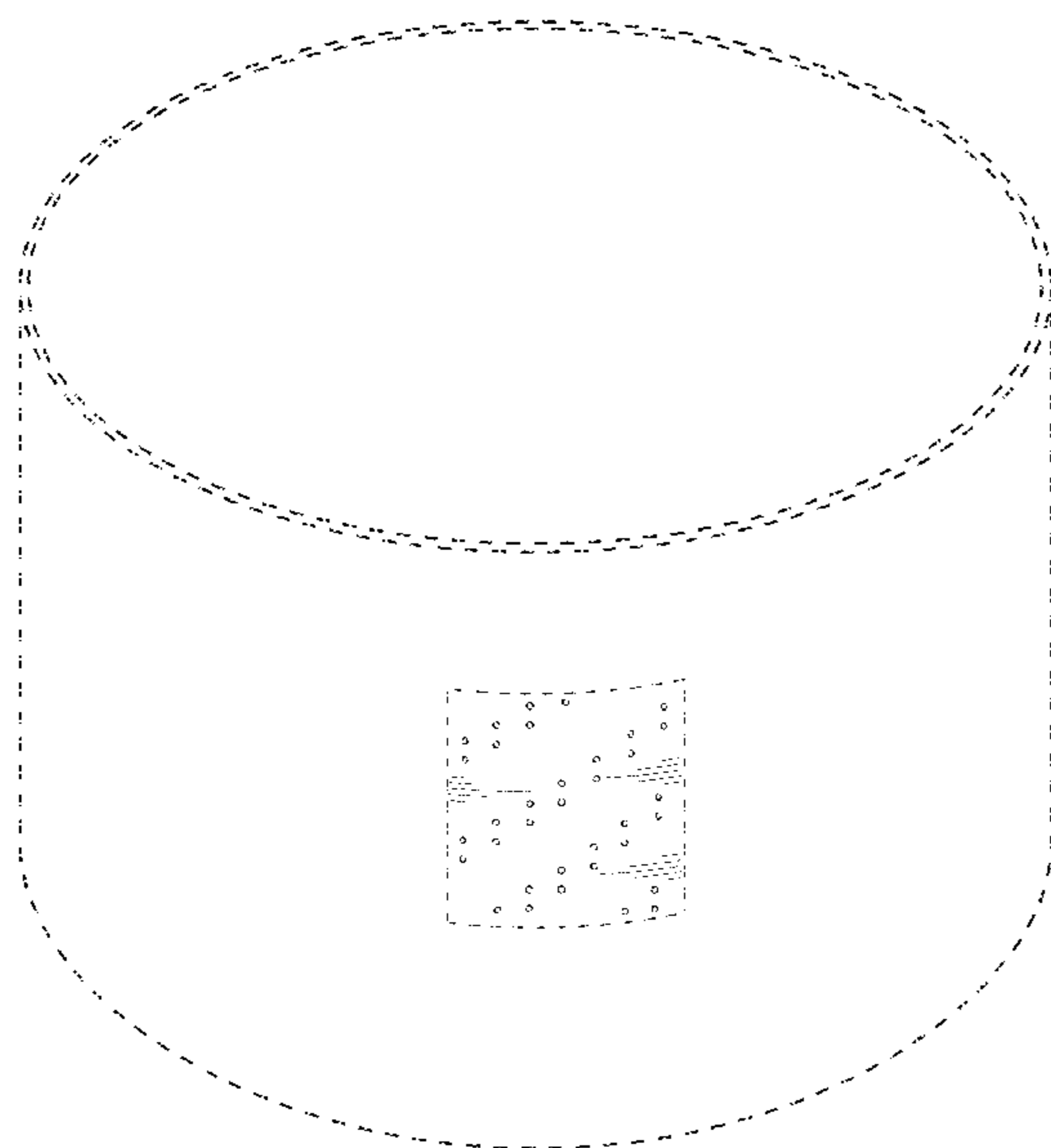

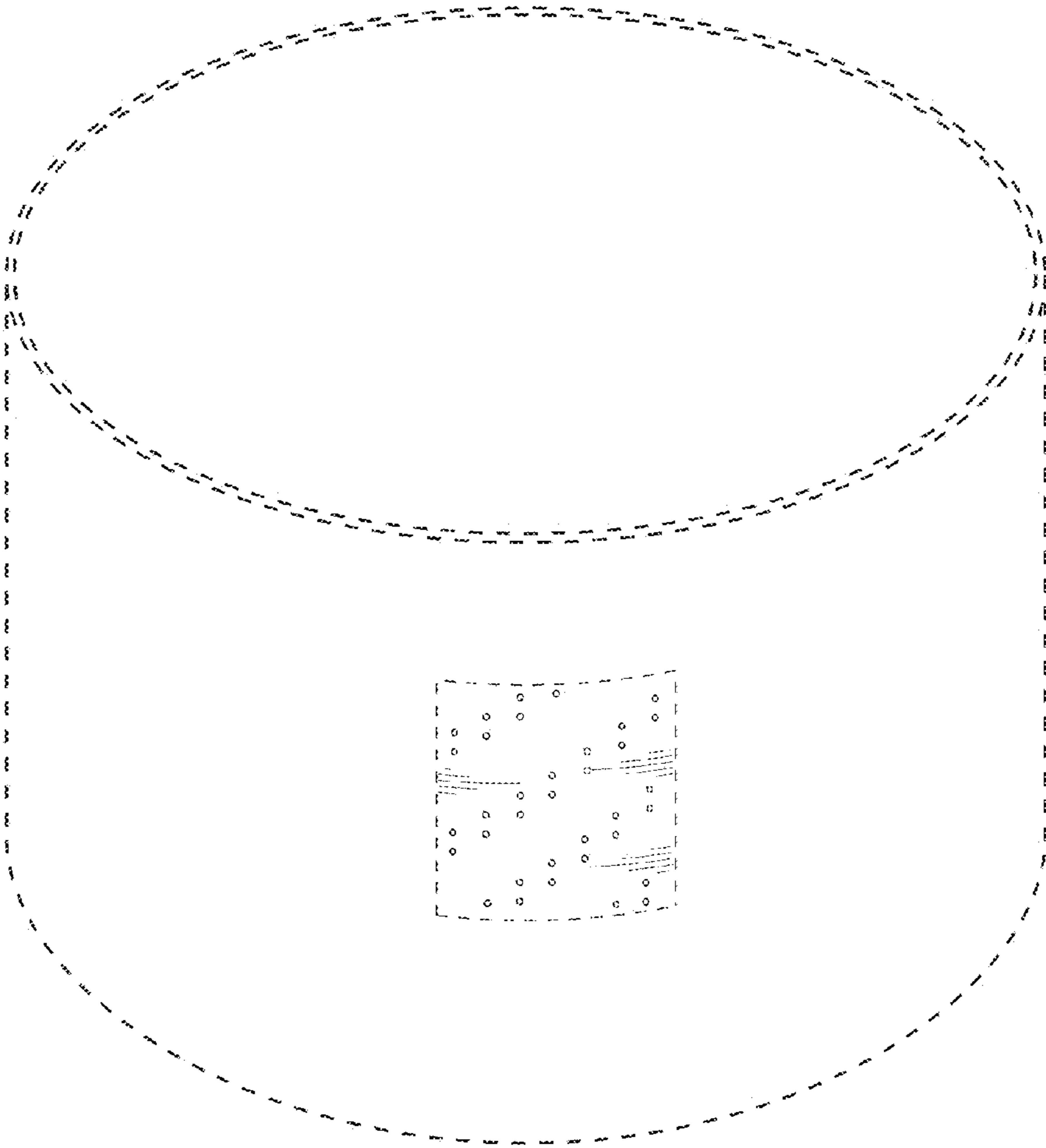

FIG. 1

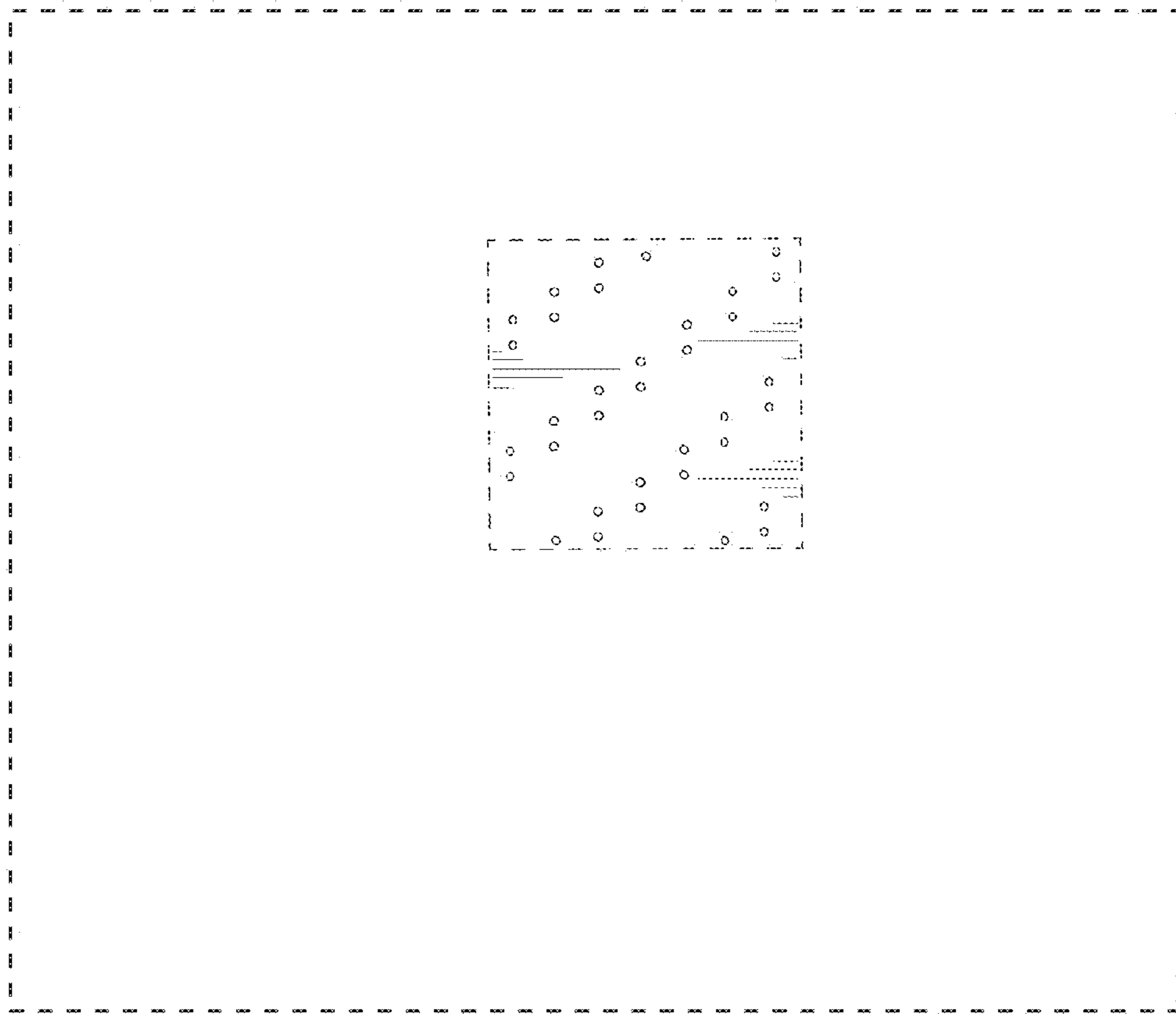

FIG. 2