



US00D746304S

(12) **United States Design Patent**
Gray et al.

(10) **Patent No.:** **US D746,304 S**
(45) **Date of Patent:** **** Dec. 29, 2015**

(54) **DISPLAY SCREEN WITH ANIMATED GRAPHICAL USER INTERFACE**

(71) Applicant: **Microsoft Corporation**, Redmond, WA (US)

(72) Inventors: **Matthew Frederick Gray**, Oslo (NO); **Shasha Tang**, Oslo (NO)

(73) Assignee: **Microsoft Corporation**, Redmond, WA (US)

(**) Term: **14 Years**

(21) Appl. No.: **29/494,585**

(22) Filed: **Jun. 23, 2014**

(51) **LOC (10) Cl.** **14-04**

(52) **U.S. Cl.**
USPC **D14/485**

(58) **Field of Classification Search**
USPC D14/485–495
CPC G06Q 50/01; G06Q 50/91; G06Q 50/101;
G06F 2206/1108; G06T 11/001–11/003;
G06T 11/20–11/80; G06T 13/20; G06T
17/00–17/30

See application file for complete search history.

(56) **References Cited**

U.S. PATENT DOCUMENTS

D528,556	S	*	9/2006	Decombe	D14/486
D667,419	S		9/2012	Rai et al.		
D682,875	S	*	5/2013	Frijlink	D14/488
D689,898	S		9/2013	Gallant et al.		
D692,448	S	*	10/2013	Jung	D14/486
D695,776	S	*	12/2013	Edwards	D14/488
D695,783	S	*	12/2013	Edwards	D14/488
D699,744	S	*	2/2014	Ho Kushner	D14/488
D705,246	S	*	5/2014	Ranz	D14/486
D705,247	S	*	5/2014	McCormack	D14/486
D716,339	S	*	10/2014	Lee	D14/488
D718,781	S	*	12/2014	Arnold	D14/486
D720,363	S	*	12/2014	Ranz	D14/486
8,923,551	B1	*	12/2014	Grosz	H04N 1/00145

						382/100
D721,722	S	*	1/2015	Lee	D14/486
D725,670	S	*	3/2015	Zhang	D14/488
D735,744	S	*	8/2015	Hwang	D14/486

(Continued)

OTHER PUBLICATIONS

Office 365 Team, "Introducing Delve (codename Oslo) and the Office Graph." Office Blogs (blogs.office.com), posted Mar. 11, 2014 [Retrieved from the Internet, Oct. 28, 2015]. Internet URL: <https://blogs.office.com/2014/03/11/introducing-codename-oslo-and-the-office-graph/>.*

(Continued)

Primary Examiner — Eric Goodman

Assistant Examiner — Rachel Voorhies

(74) *Attorney, Agent, or Firm* — Banner & Witcoff, Ltd.

(57) **CLAIM**

The ornamental design for a display screen with animated graphical user interface, as shown and described.

DESCRIPTION

FIG. 1 is the first image in a sequence for a display screen with animated graphical user interface showing our new design; FIG. 2 is the second image thereof; FIG. 3 is the third image thereof; FIG. 4 is the fourth image thereof; FIG. 5 is the fifth image thereof; FIG. 6 is the sixth image thereof; FIG. 7 is the seventh image thereof; and, FIG. 8 is the eighth image thereof.

The appearance of the animated graphical user interface sequentially transitions between the images shown in FIGS. 1-8. The process or period in which one image transitions to another forms no part of the claimed design. The broken line showing of the icons, the remainder of the graphical user interface and the remainder of the display screen is for environmental purposes only and forms no part of the claimed design.

1 Claim, 8 Drawing Sheets

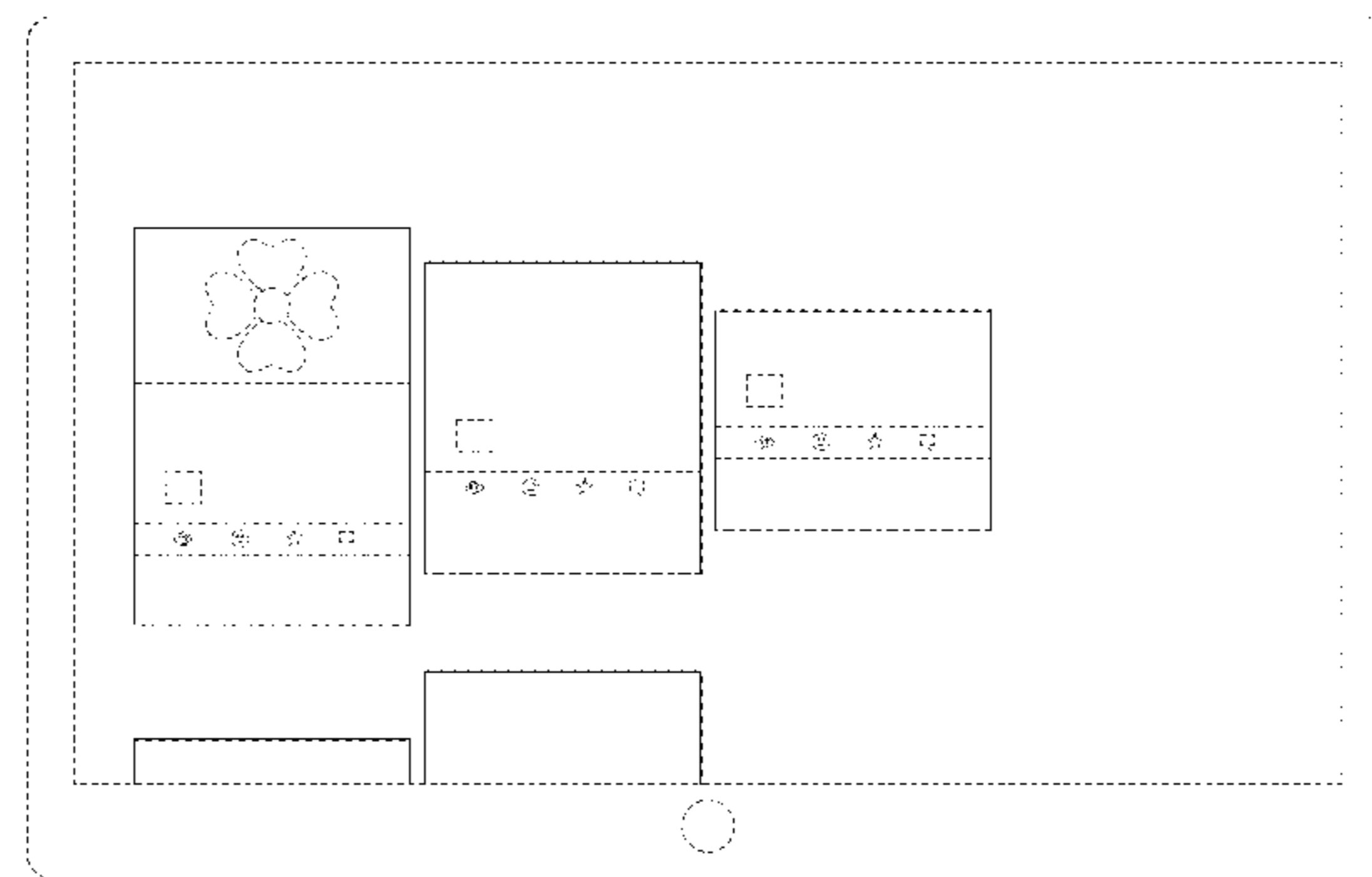
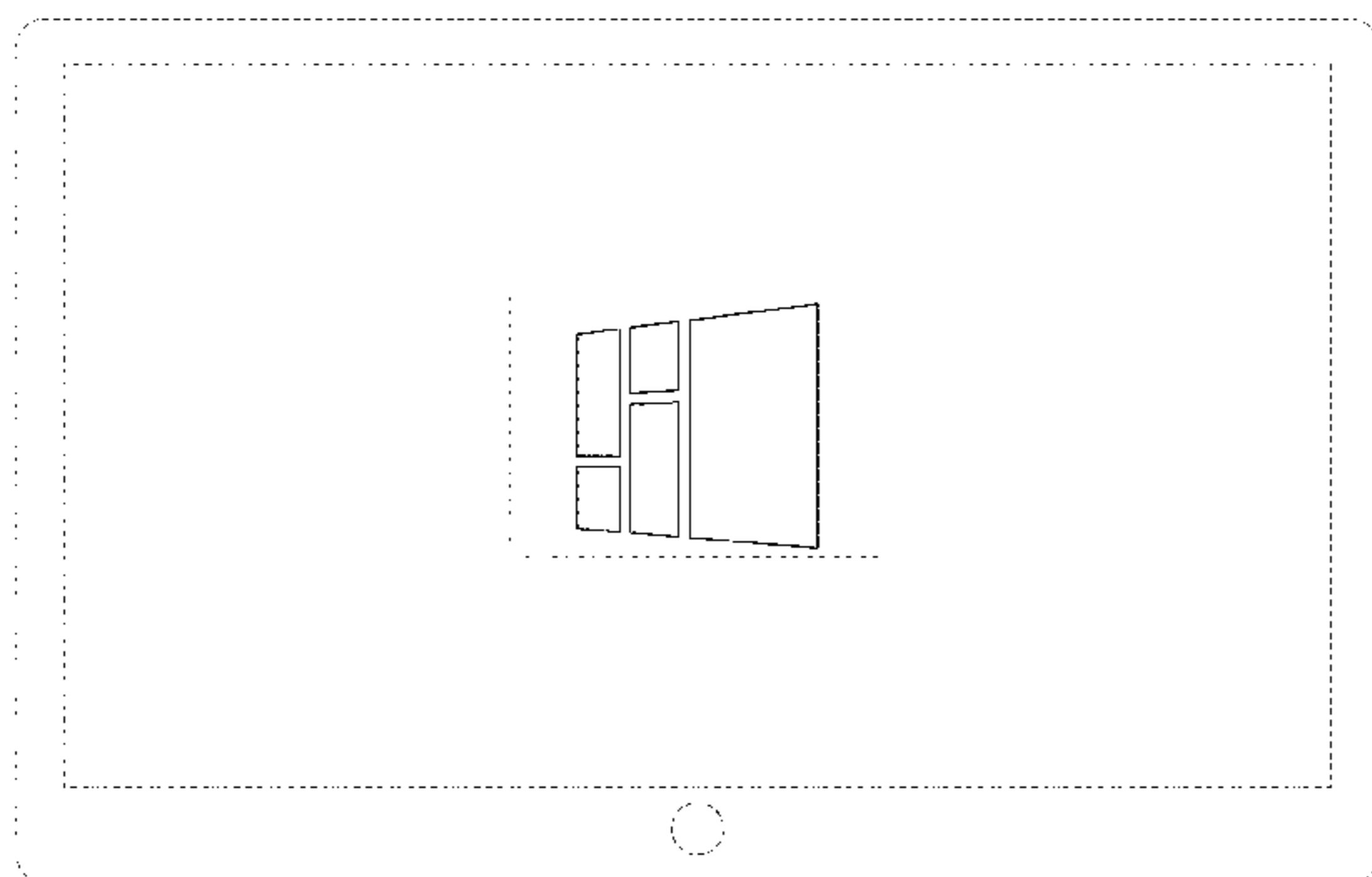

(56)

References Cited

U.S. PATENT DOCUMENTS

D735,751	S *	8/2015	Hwang	D14/487
D735,753	S *	8/2015	Hwang	D14/488
D736,246	S *	8/2015	Zhang	D14/488
D737,315	S *	8/2015	Barling	D14/488
D739,424	S *	9/2015	Ku	D14/486
D741,897	S *	10/2015	Wilkinson	D14/488
9,165,188	B2 *	10/2015	Thrasher	H04N 1/387
2015/0248222	A1 *	9/2015	Stickler	G06Q 10/00 715/763
2015/0248410	A1 *	9/2015	Stickler	G06F 17/3053 707/728
2015/0302533	A1 *	10/2015	Thakur	G06Q 10/00 705/319

OTHER PUBLICATIONS

Joshua Johnson, “30 Beautifully Designed Tumblr Themes.” DesignShack.net, posted Nov. 24, 2009 [Retrieved from the Internet,

Oct. 28, 2015]. Internet URL: <<http://designshack.net/articles/inspiration/30-beautifully-designed-tumblr-themes>>.*

Joshua Johnson, “50 More Beautifully Designed Tumblr Themes.” DesignShack.net, posted Oct. 18, 2011 [Retrieved from the Internet, Oct. 28, 2015]. Internet URL: <<http://designshack.net/articles/inspiration/50-more-beautifully-designed-tumblr-themes/>>.*

Microsoft Mechanics, “Delve (Codename Oslo)—Next Generation Discovery and Search.” YouTube.com, posted Apr. 8, 2014 [Retrieved from the Internet, Oct. 28, 2015]. Internet URL: <<https://youtu.be/dgZcS0z6JAM>>.*

Sgprolab, “Squares rectangle—HD animated background #27.” YouTube.com, posted Feb. 7, 2014 [Retrieved from the Internet, Oct. 28, 2015]. Internet URL: <https://youtu.be/Z6Cdymvgm_c>.*

Sgprolab, “Rising golden squares—HD animated background #15.” YouTube.com, posted Nov. 1, 2013 [Retrieved from the Internet, Oct. 28, 2015]. Internet URL: <<https://youtu.be/UJiJ-IkRkJA>>.*

M. Pir, “Metro Tiles Winforms Controls Scrolling.” YouTube.com, posted Dec. 24, 2011 [Retrieved from the Internet, Oct. 28, 2015]. Internet URL: <<https://youtu.be/L9fqngC61hg>>.*

* cited by examiner

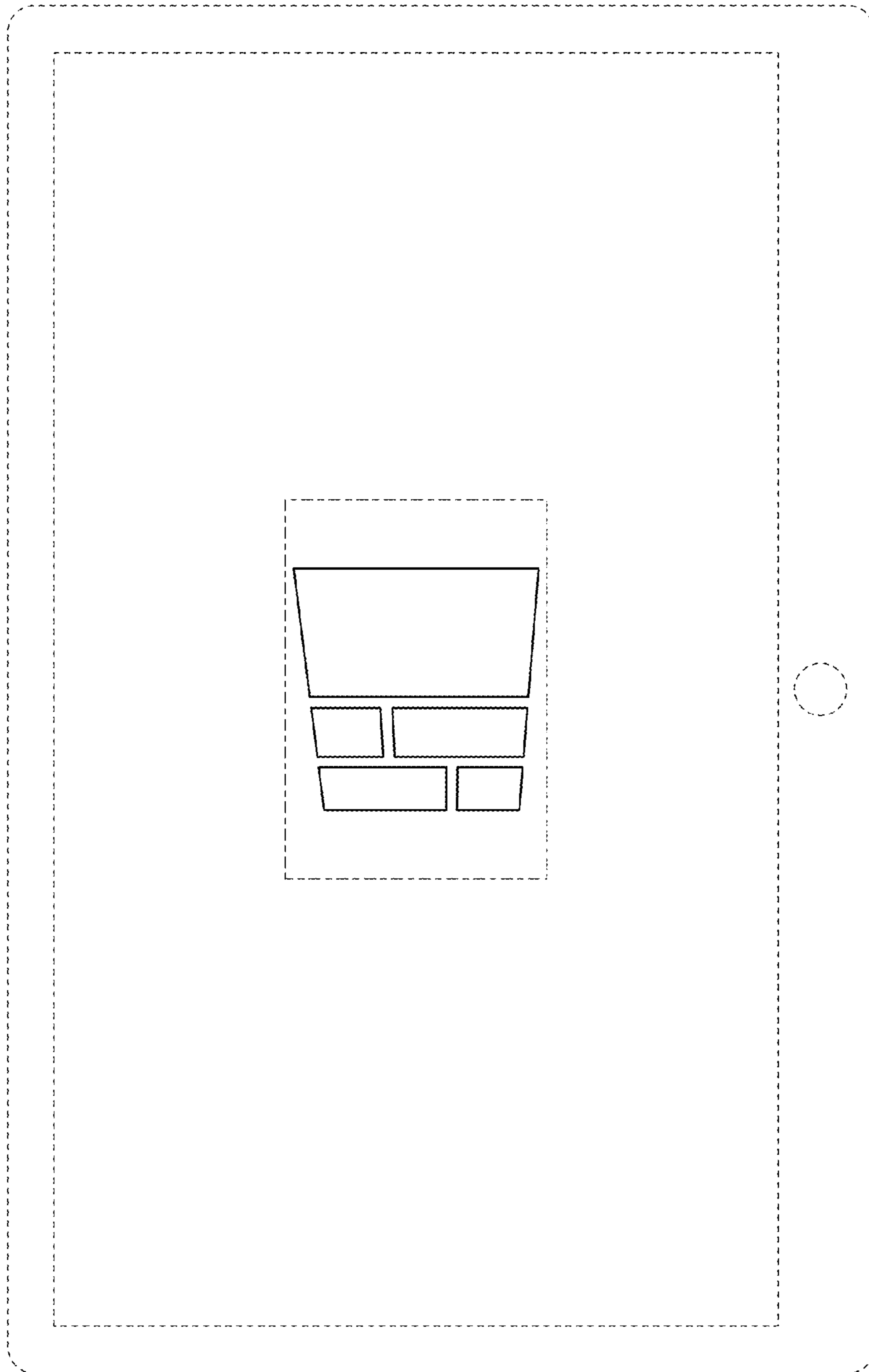

FIGURE 1

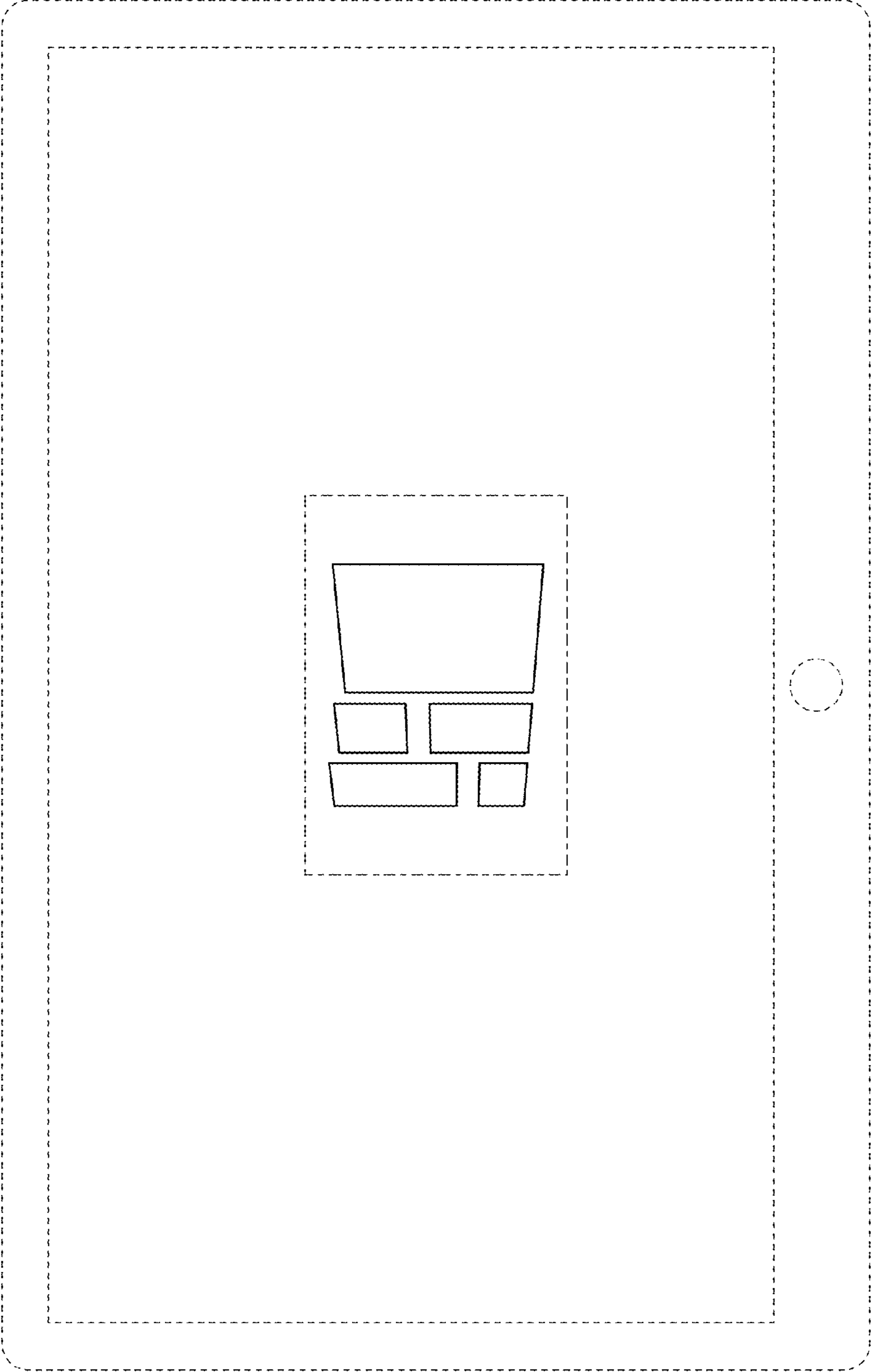

FIGURE 2

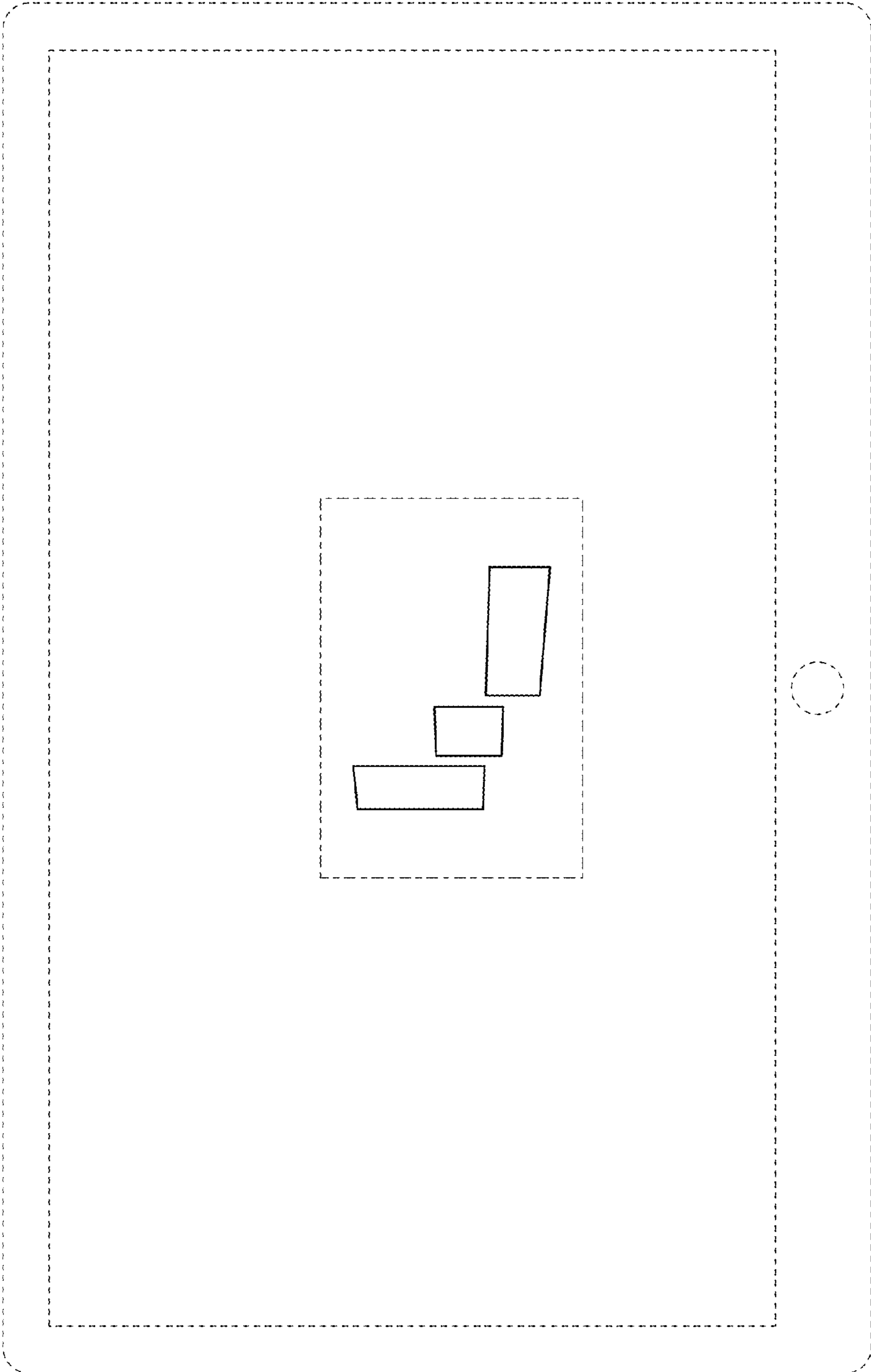

FIGURE 3

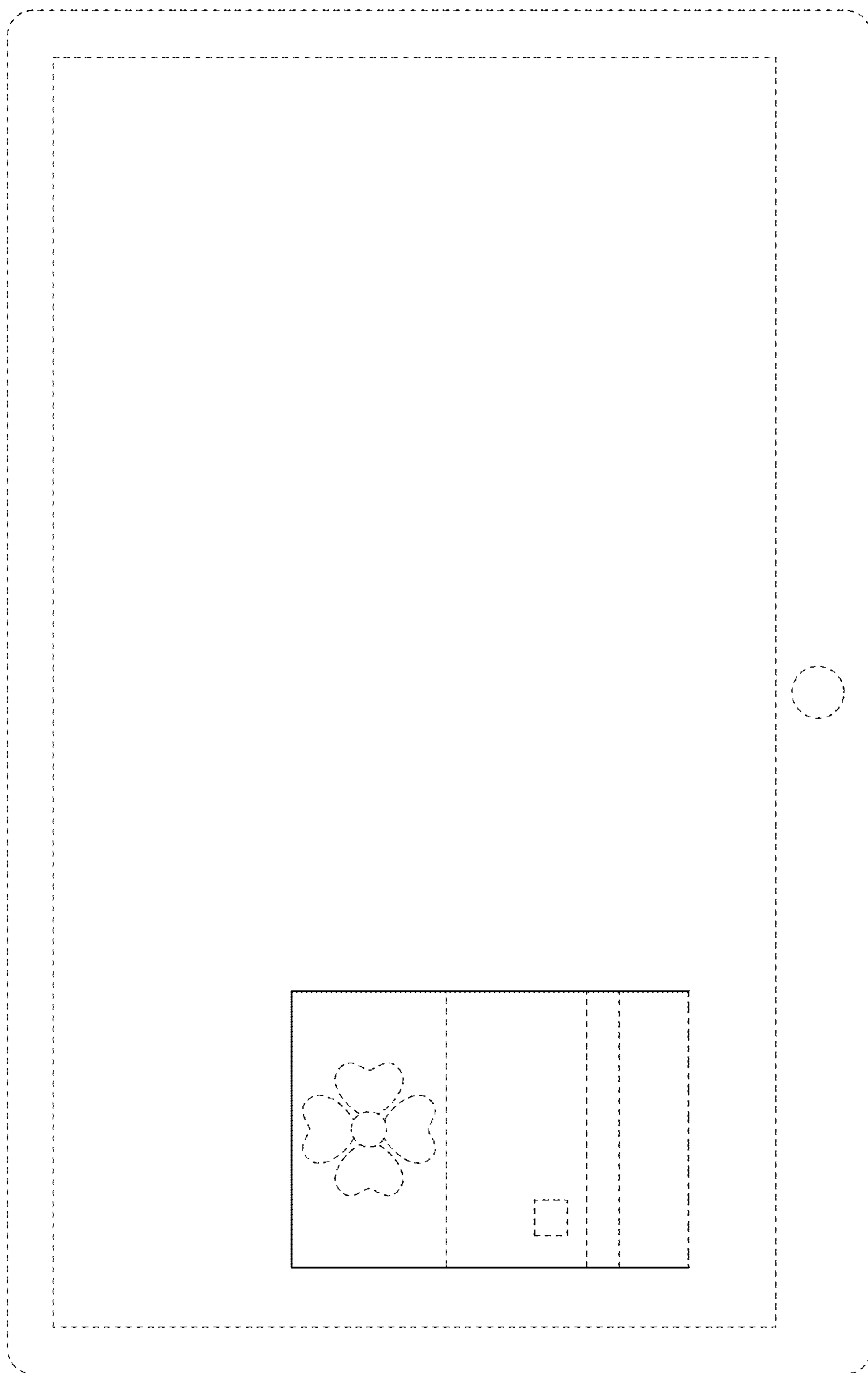

FIGURE 4

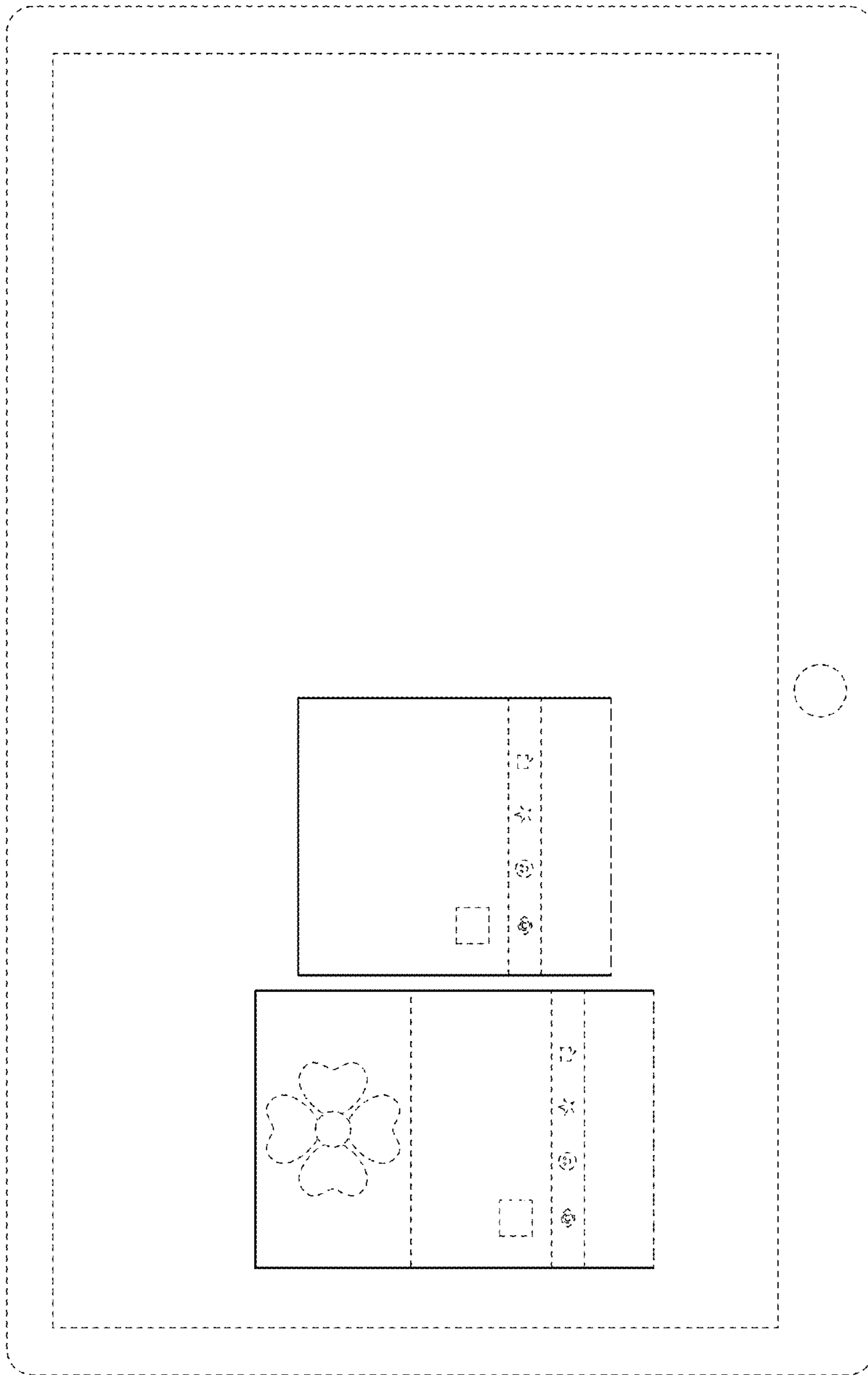

FIGURE 5

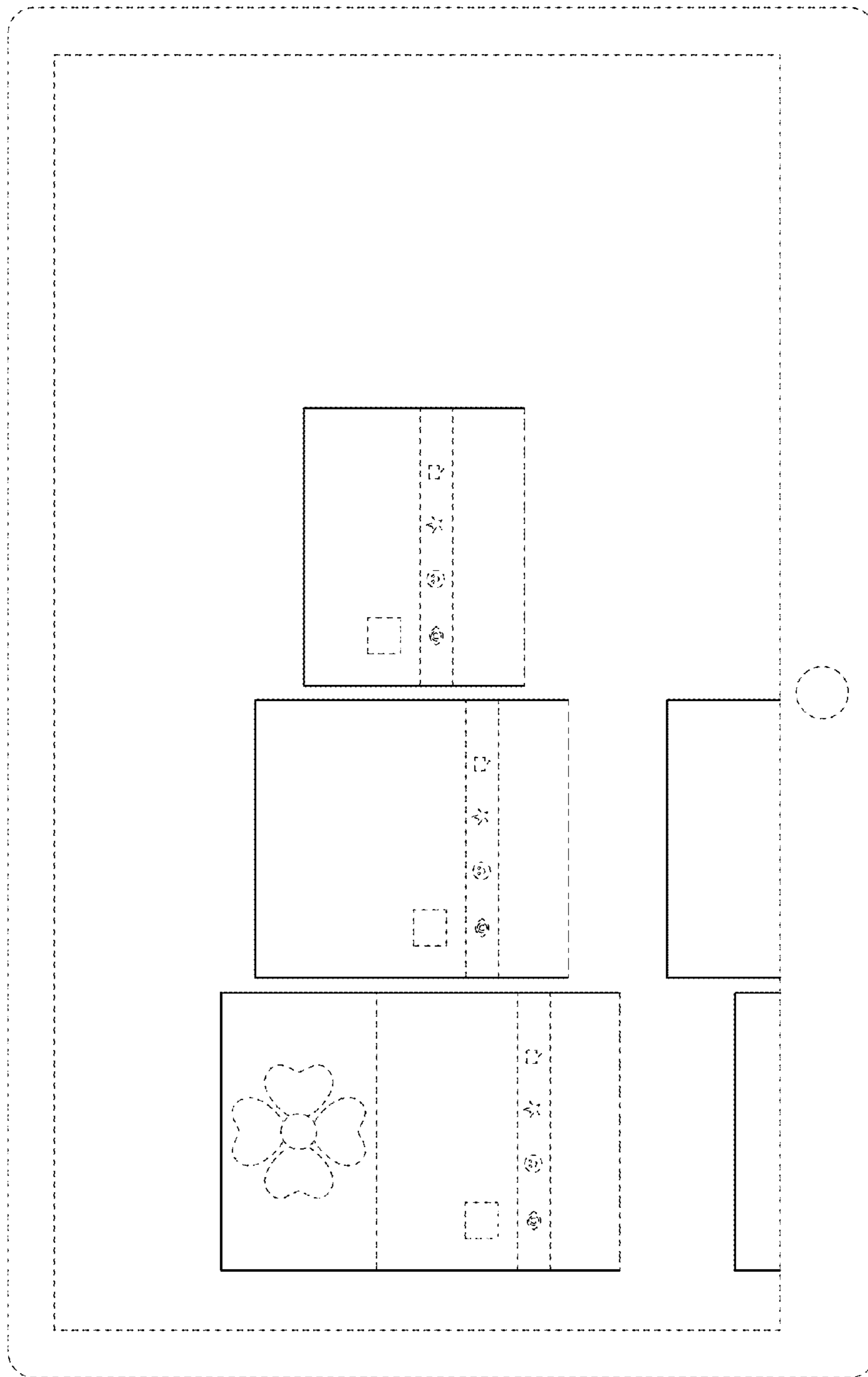

FIGURE 6

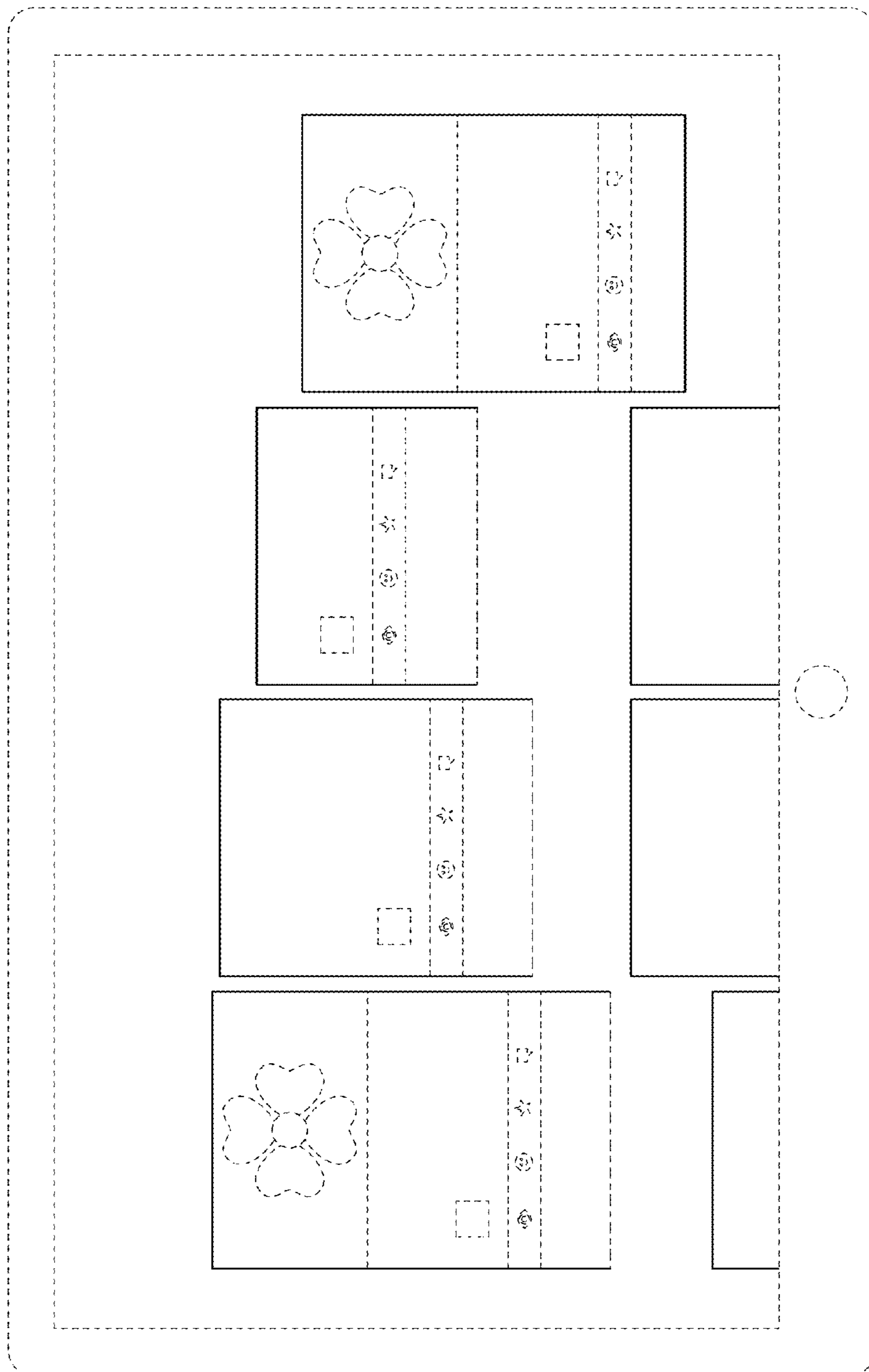

FIGURE 7

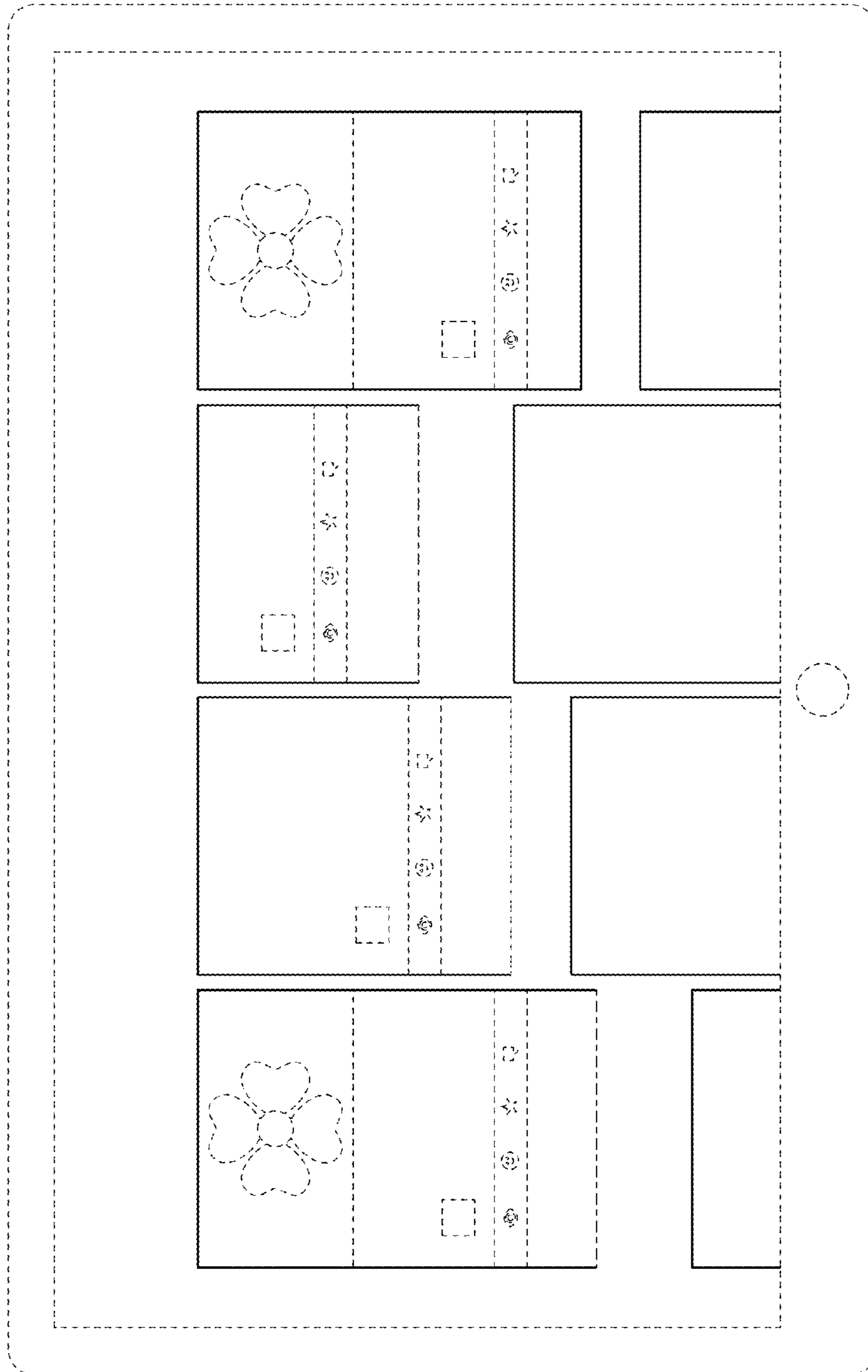

FIGURE 8