



US00D745204S

(12) **United States Design Patent**  
**Skira**

(10) **Patent No.:** **US D745,204 S**

(45) **Date of Patent:** **\*\* Dec. 8, 2015**

(54) **LIGHTING FIXTURE**

(71) Applicant: **IGUZZINI ILLUMINAZIONE S.P.A.**,  
Recanati (IT)

(72) Inventor: **Dean Skira**, Pula (HR)

(73) Assignee: **IGUZZINI ILLUMINAZIONE S.P.A.**,  
Recanati (IT)

(\*\*) Term: **14 Years**

(21) Appl. No.: **29/503,007**

(22) Filed: **Sep. 22, 2014**

(30) **Foreign Application Priority Data**

Mar. 21, 2014 (EM) ..... 0024300900008

(51) **LOC (10) Cl.** ..... **26-05**

(52) **U.S. Cl.**  
USPC ..... **D26/68**

(58) **Field of Classification Search**  
USPC ..... D26/67-70, 89, 93; D10/113.2;  
D25/128, 135

CPC ..... F21S 6/004; F21S 6/005; F21S 6/007;  
F21S 6/008; F21S 8/032; F21S 8/08; F21S  
8/081; F21S 8/083; F21S 8/085  
See application file for complete search history.

(56) **References Cited**

**U.S. PATENT DOCUMENTS**

726,801 A \* 4/1903 Maxwell ..... 138/115  
D205,974 S \* 10/1966 Lawlor ..... D10/114.6

3,578,963 A \* 5/1971 De Vos et al. .... 362/247  
3,950,639 A \* 4/1976 Van Steenhoven ..... 362/309  
D290,410 S \* 6/1987 Haggard ..... D26/68  
D318,136 S \* 7/1991 Kira ..... D26/68  
D330,778 S \* 11/1992 Hall et al. .... D26/68  
D435,130 S \* 12/2000 Landefeld ..... D26/68  
D443,094 S \* 5/2001 Landefeld ..... D26/68  
D697,246 S \* 1/2014 Martzall ..... D26/67  
8,684,571 B1 \* 4/2014 Alaura et al. .... 362/431  
D708,536 S \* 7/2014 Lyhne ..... D10/113.2  
2012/0287610 A1 \* 11/2012 Krogman ..... 362/152

\* cited by examiner

*Primary Examiner* — Clare E Heflin

(74) *Attorney, Agent, or Firm* — Abelman, Frayne &  
Schwab

(57) **CLAIM**

The ornamental design for a lighting fixture, as shown and  
described.

**DESCRIPTION**

FIG. 1 is a top, front and left side perspective view of the  
lighting fixture showing my new design;  
FIG. 2 is a front elevational view thereof;  
FIG. 3 is a right side elevational view thereof;  
FIG. 4 is a left side elevational view thereof;  
FIG. 5 is a rear elevational view thereof;  
FIG. 6 is a top plan view thereof; and,  
FIG. 7 is a bottom view thereof.

**1 Claim, 7 Drawing Sheets**

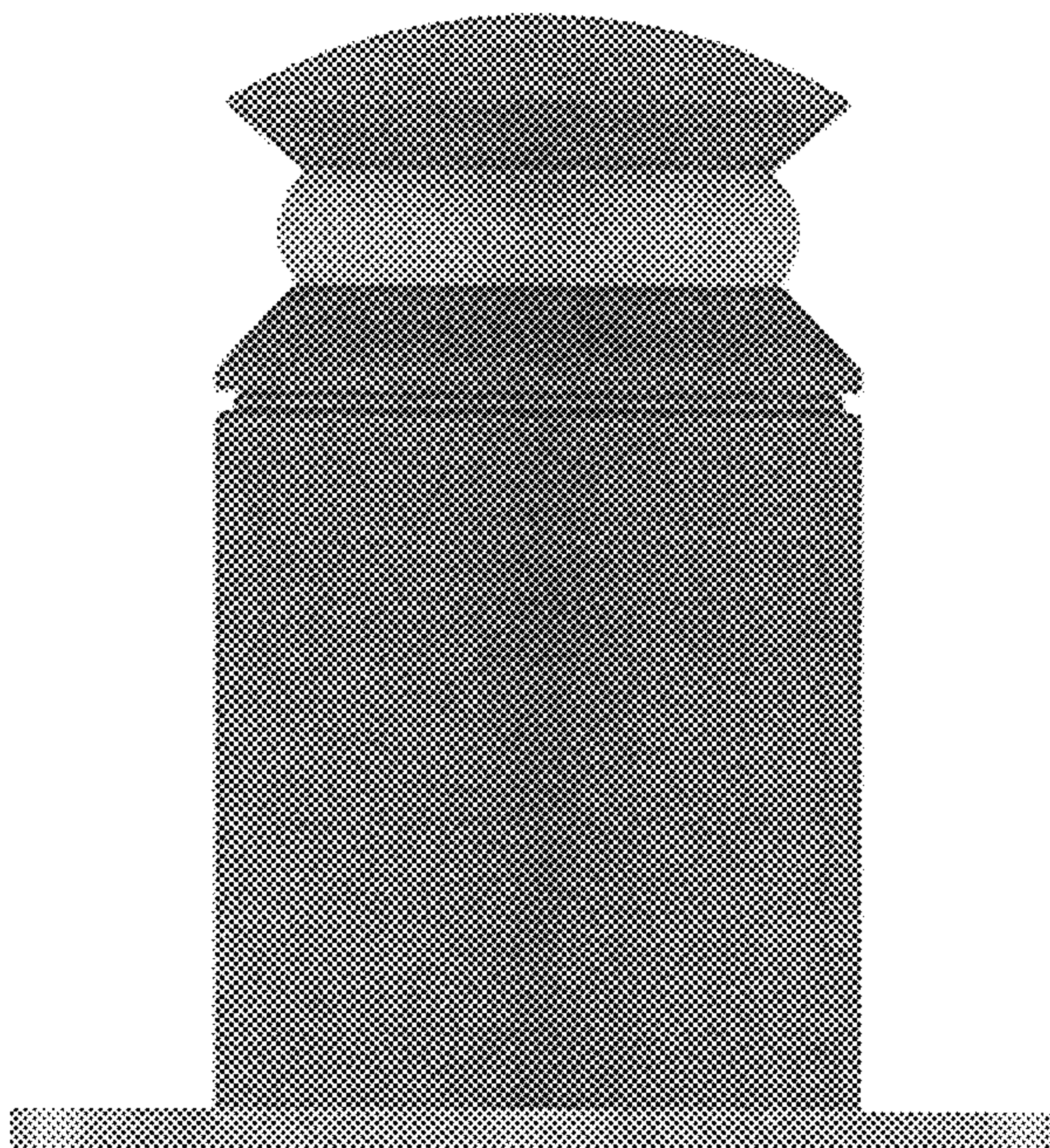
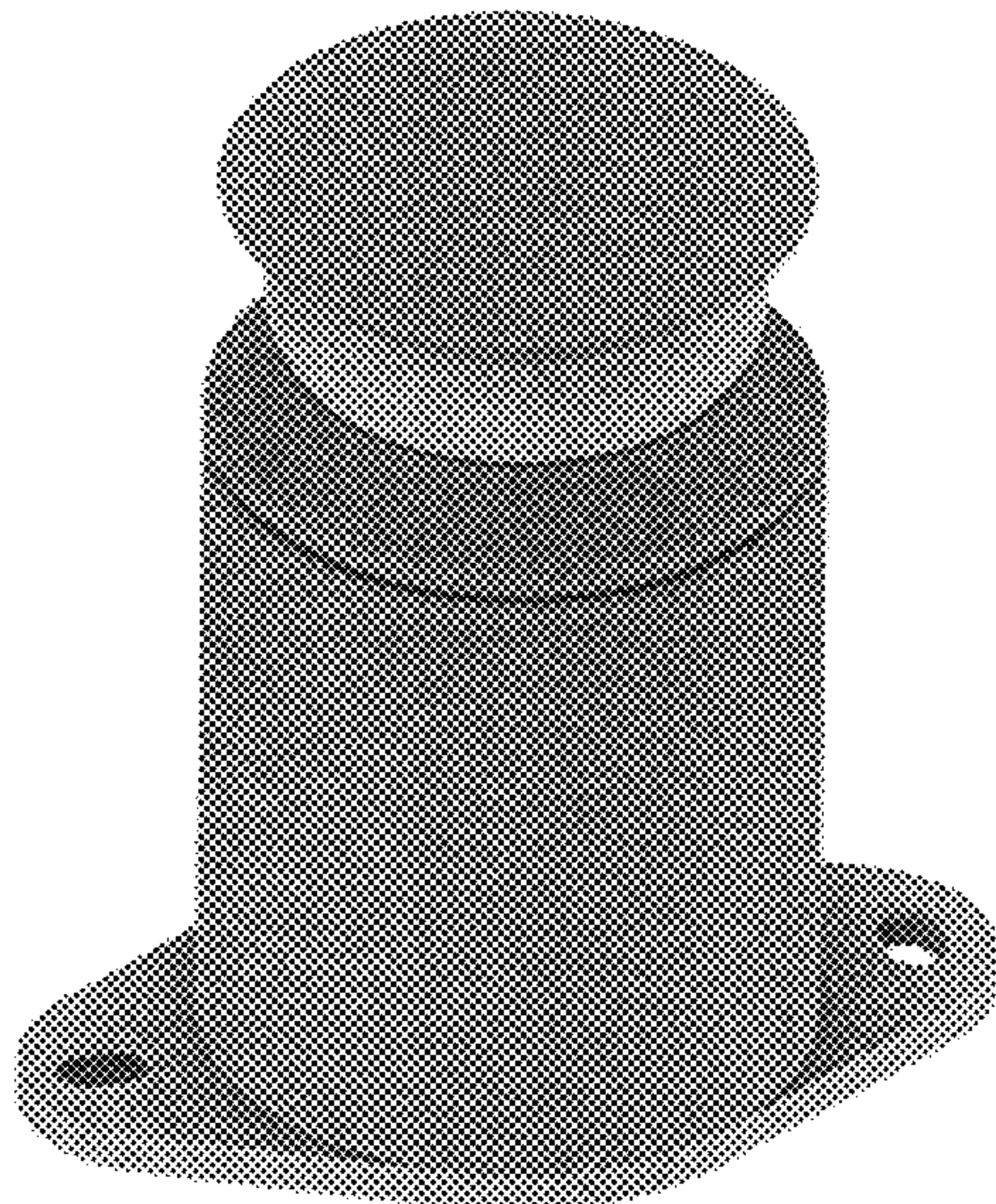



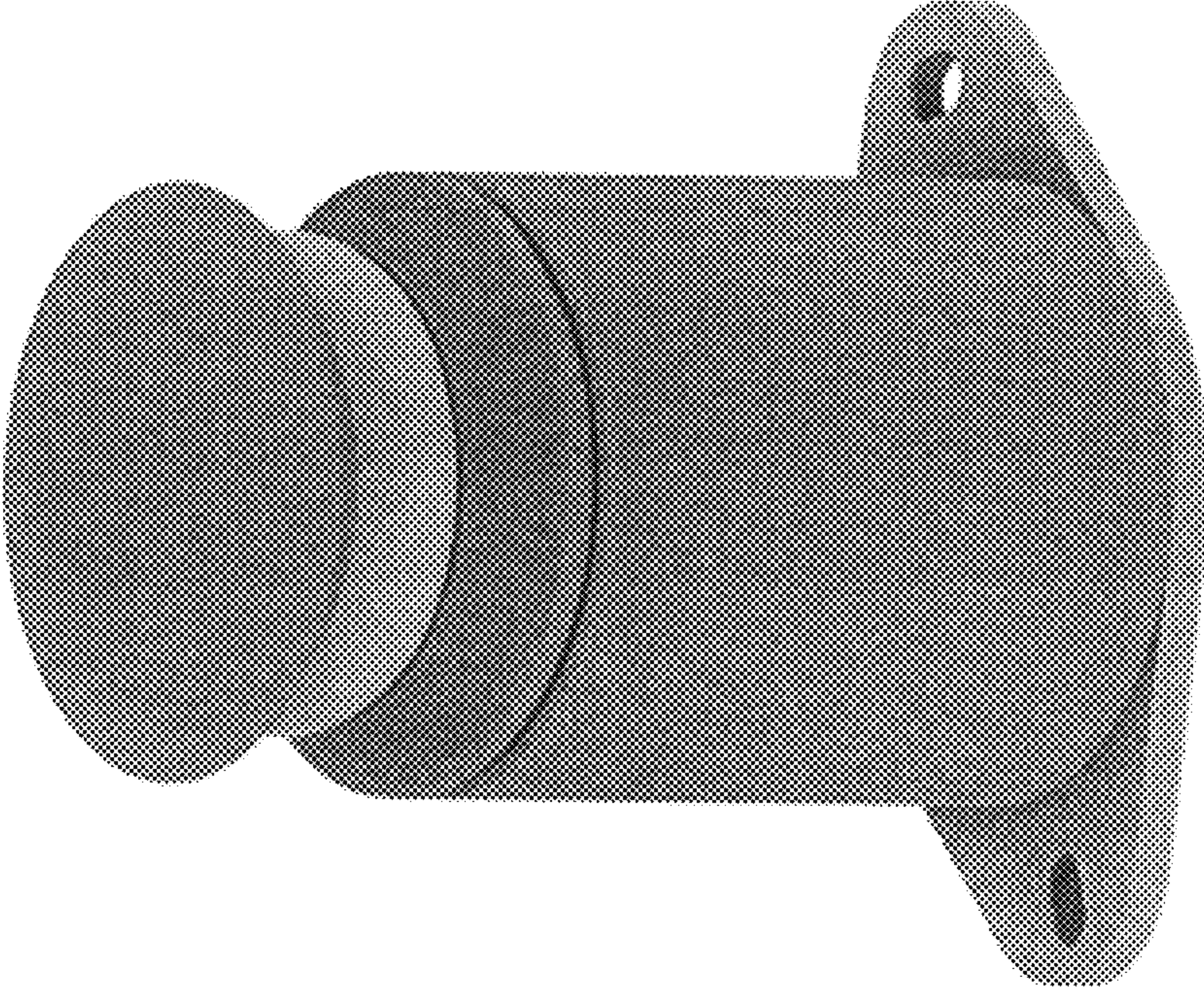

FIG. 1



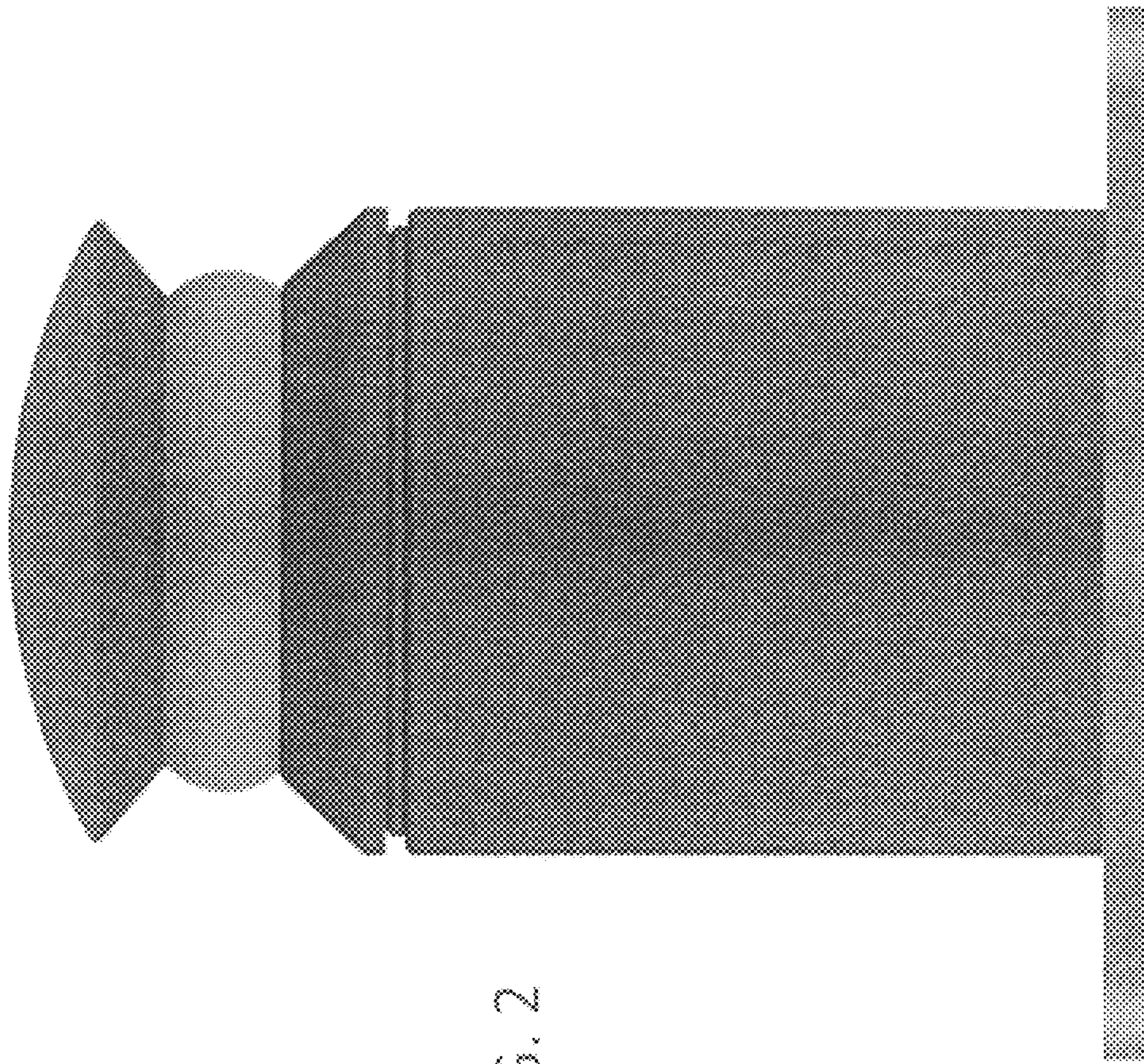

FIG. 2



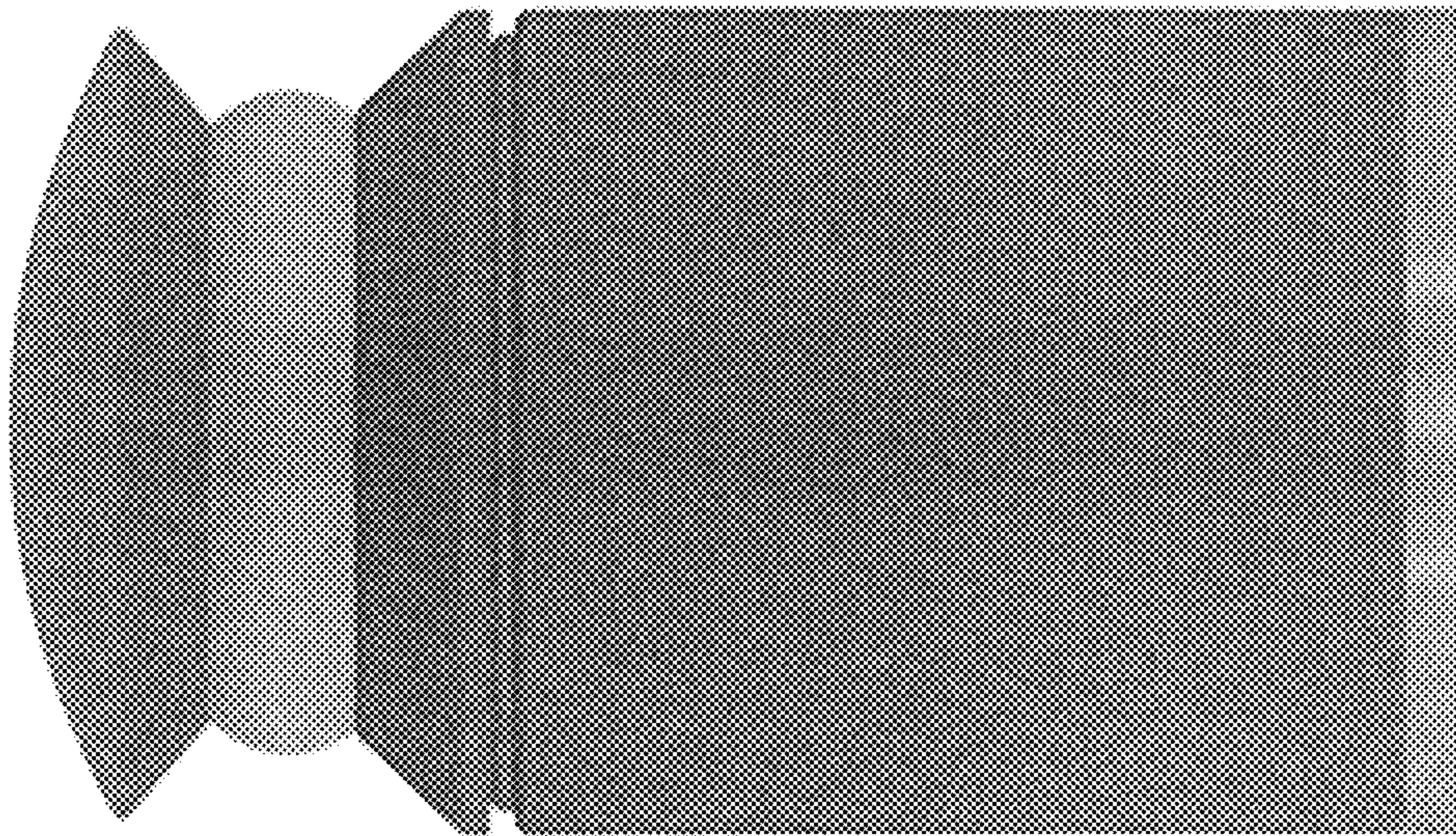

FIG. 3



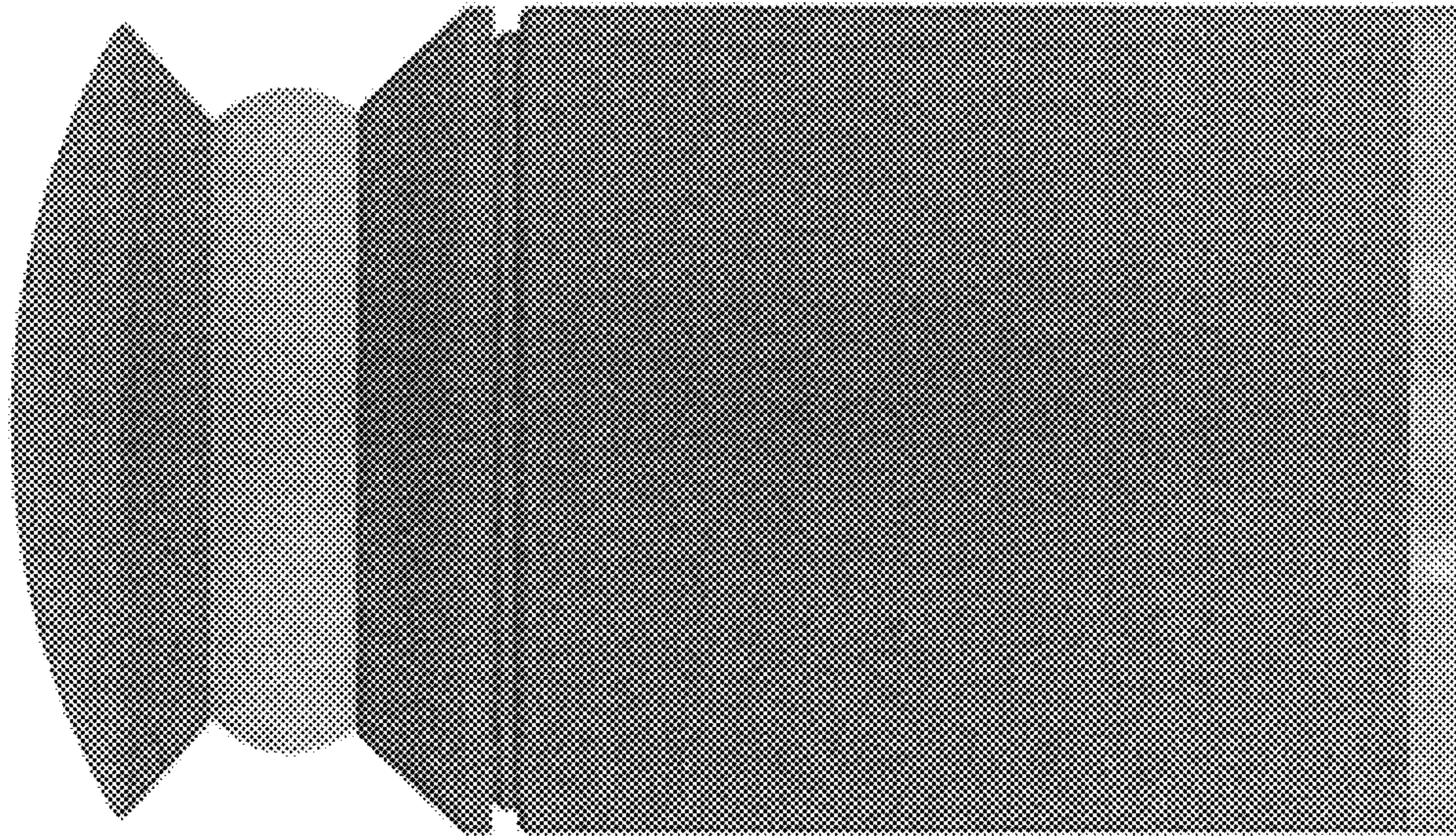

FIG. 4



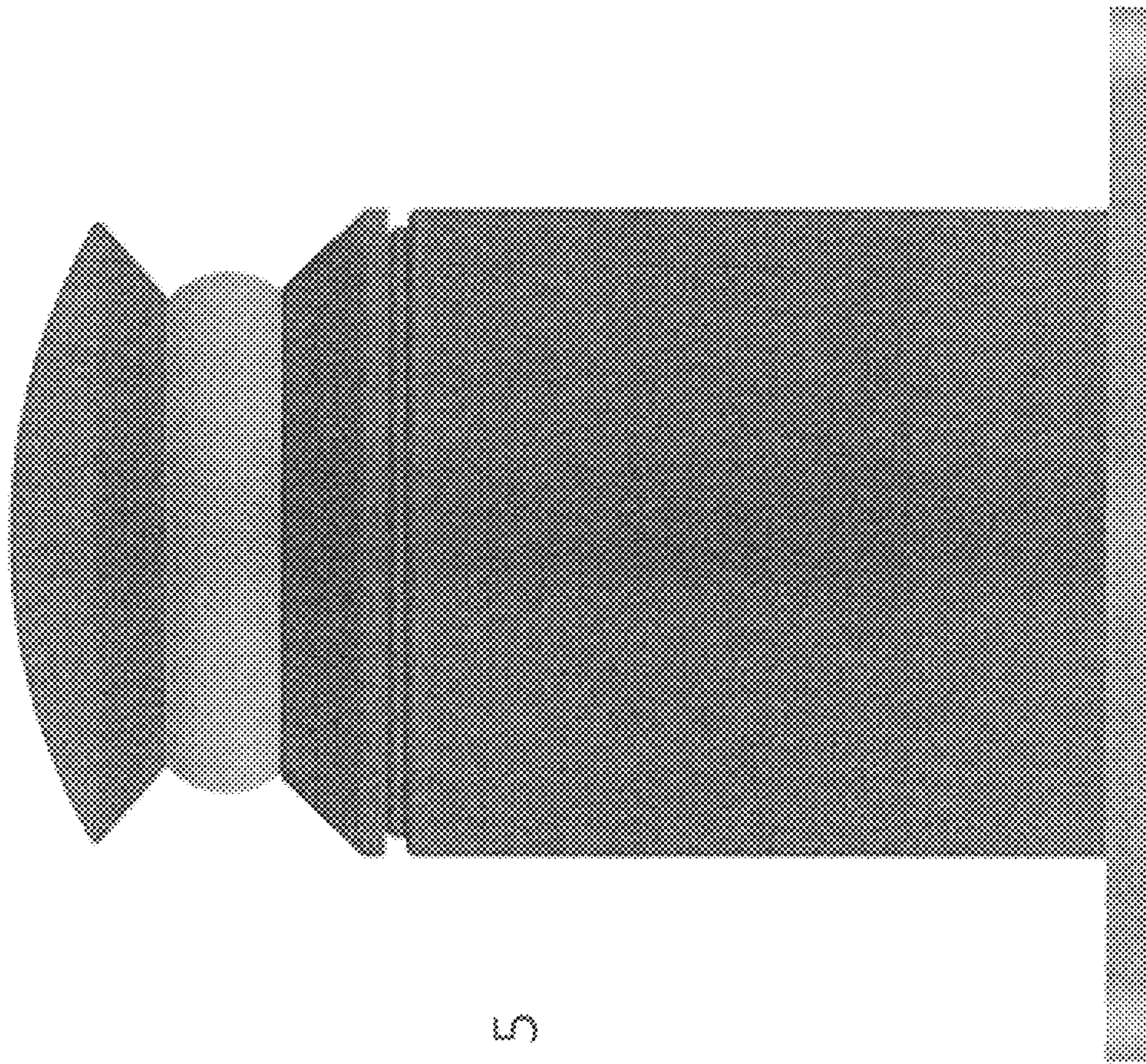

FIG. 5



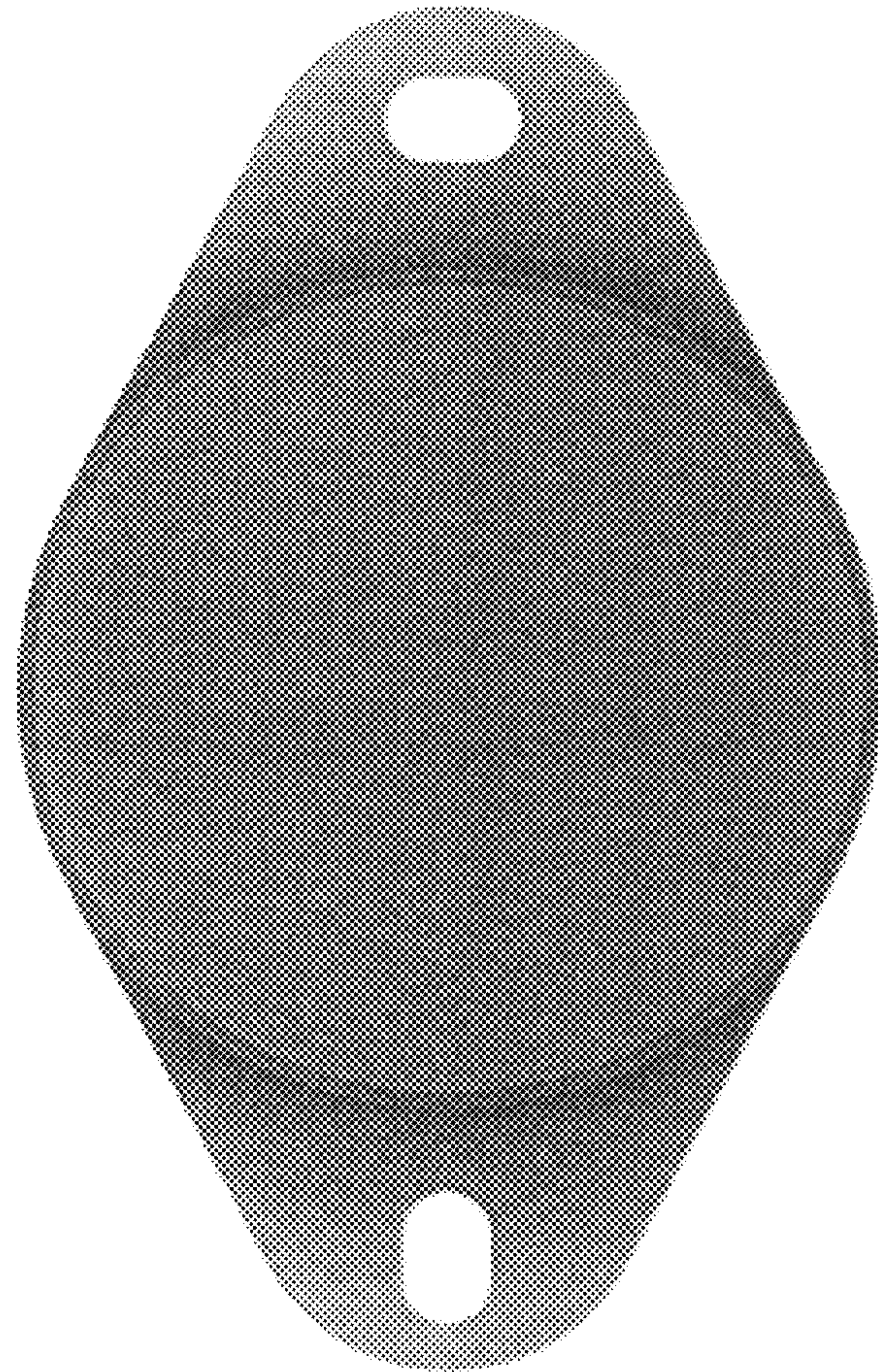

FIG. 6

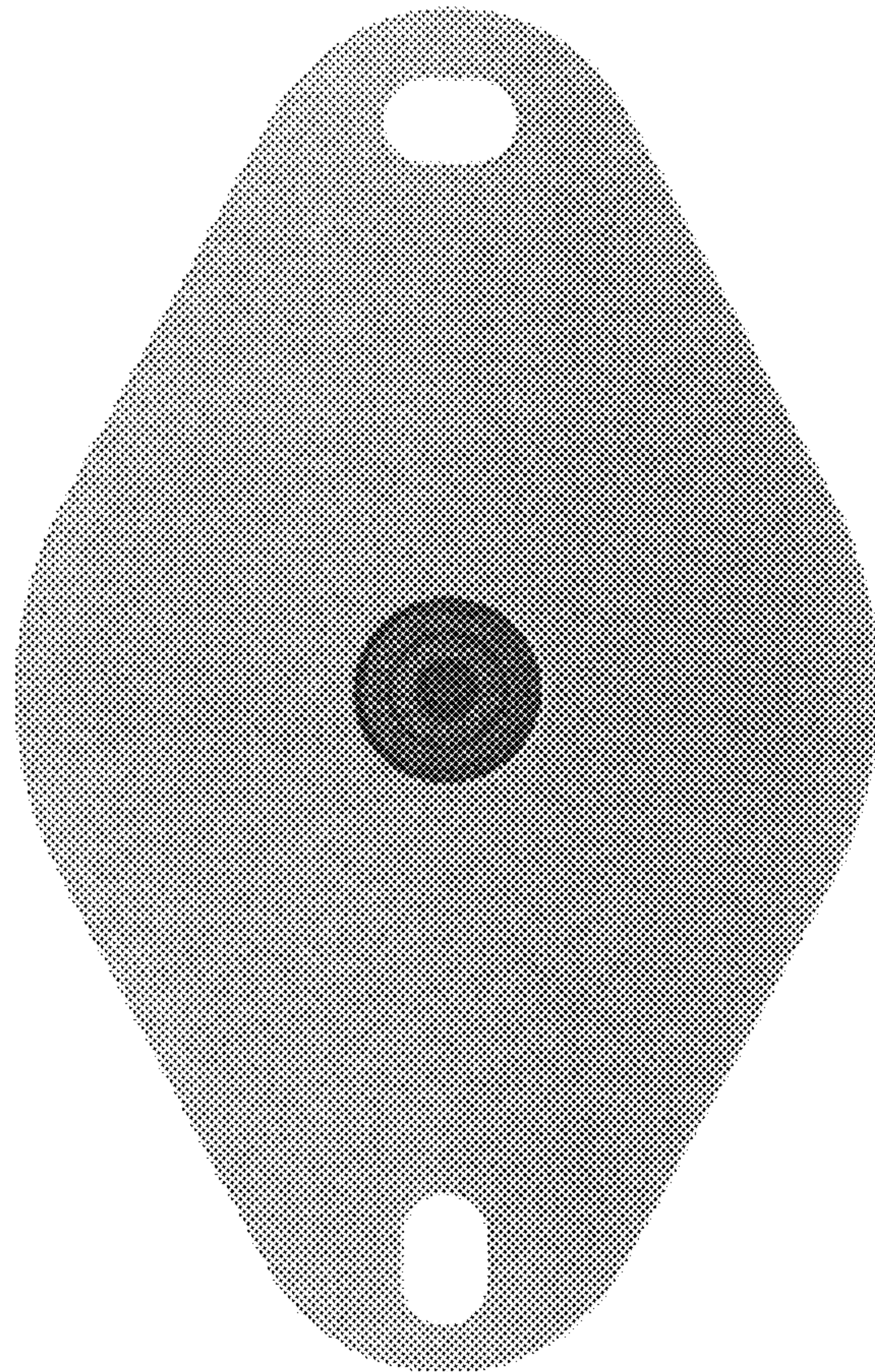

FIG. 7