



US00D744527S

(12) **United States Design Patent**
Sanderson

(10) **Patent No.:** **US D744,527 S**

(45) **Date of Patent:** **** Dec. 1, 2015**

(54) **DISPLAY SCREEN WITH ANIMATED GRAPHICAL USER INTERFACE**

2010/0245651 A1* 9/2010 Minamino 348/333.05

* cited by examiner

(71) Applicant: **Microsoft Corporation**, Redmond, WA (US)

Primary Examiner — Ian Simmons

Assistant Examiner — Richelle G Shelton

(72) Inventor: **Eric Sanderson**, Seattle, WA (US)

(74) *Attorney, Agent, or Firm* — Banner & Witcoff, Ltd.

(73) Assignee: **Microsoft Corporation**, Redmond, WA (US)

(57) **CLAIM**

The ornamental design for a display screen with animated graphical user interface, as shown and described.

(**) Term: **14 Years**

DESCRIPTION

(21) Appl. No.: **29/473,403**

(22) Filed: **Nov. 21, 2013**

(51) **LOC (10) Cl.** **14-04**

(52) **U.S. Cl.**

USPC **D14/488**

(58) **Field of Classification Search**

USPC D14/485–495

CPC G06T 13/00; G06T 13/80; G06F 3/04845;

G06F 3/04847

See application file for complete search history.

FIG. 1 is the first image in a sequence for a display screen with animated graphical user interface showing the new design; FIG. 2 is the second image thereof; FIG. 3 is the third image thereof; FIG. 4 is the fourth image thereof; FIG. 5 is the fifth image thereof; FIG. 6 is the sixth image thereof; and, FIG. 7 is the seventh image thereof.

The appearance of the animated graphical user interface sequentially transitions between the images shown in FIGS. 1-7. The process or period in which one image transitions to another forms no part of the claimed design. The broken-line showing of the text, flowers, stylized humanoids, various icons, car, remainder of the graphical user interface, and the remainder of the display screen is for environmental purposes only and forms no part of the claimed design.

(56) **References Cited**

U.S. PATENT DOCUMENTS

7,885,508 B2 * 2/2011 Toyoda et al. 345/173

D637,604 S * 5/2011 Brinda D14/488

D658,678 S * 5/2012 Gleasman et al. D14/488

1 Claim, 7 Drawing Sheets

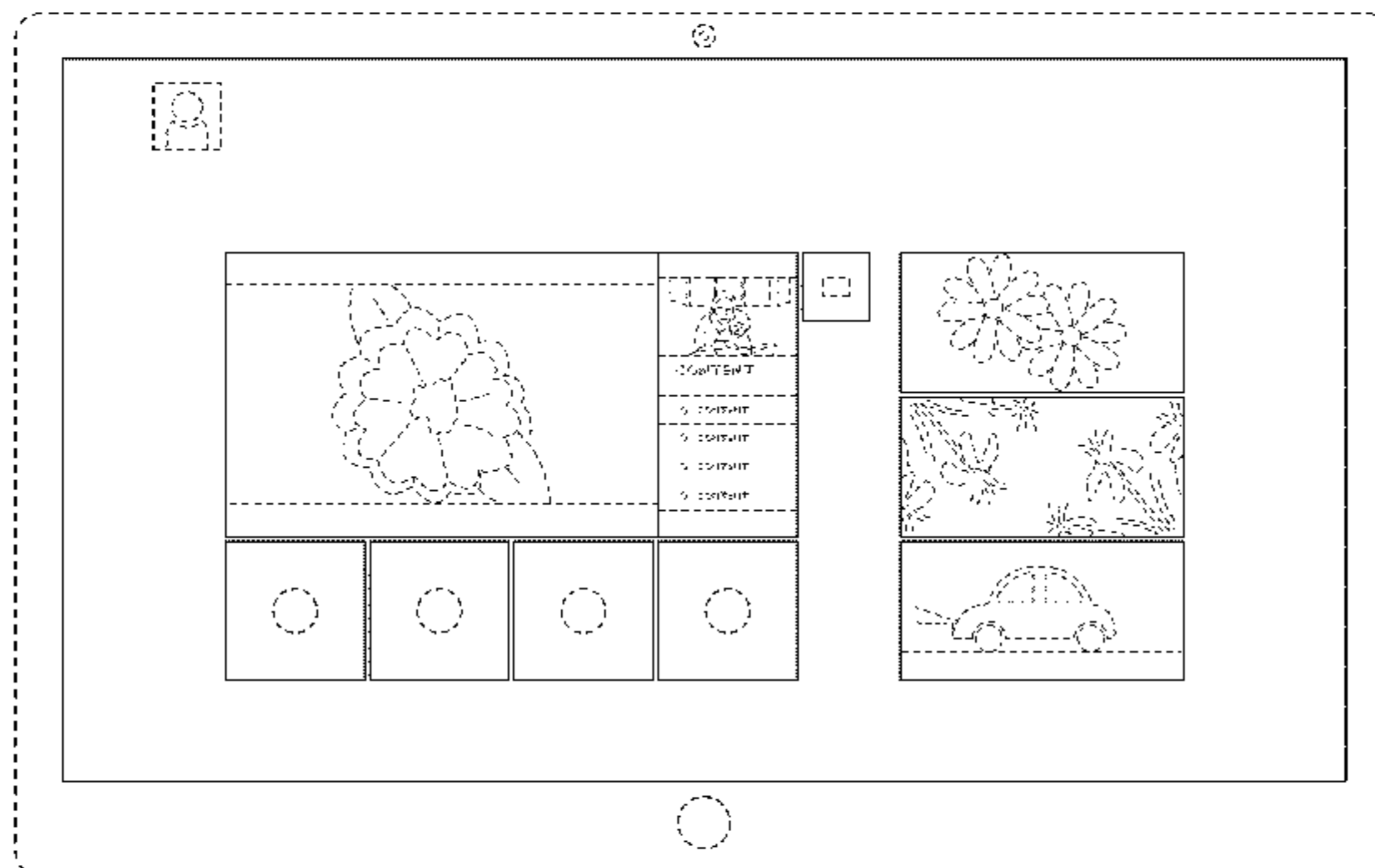
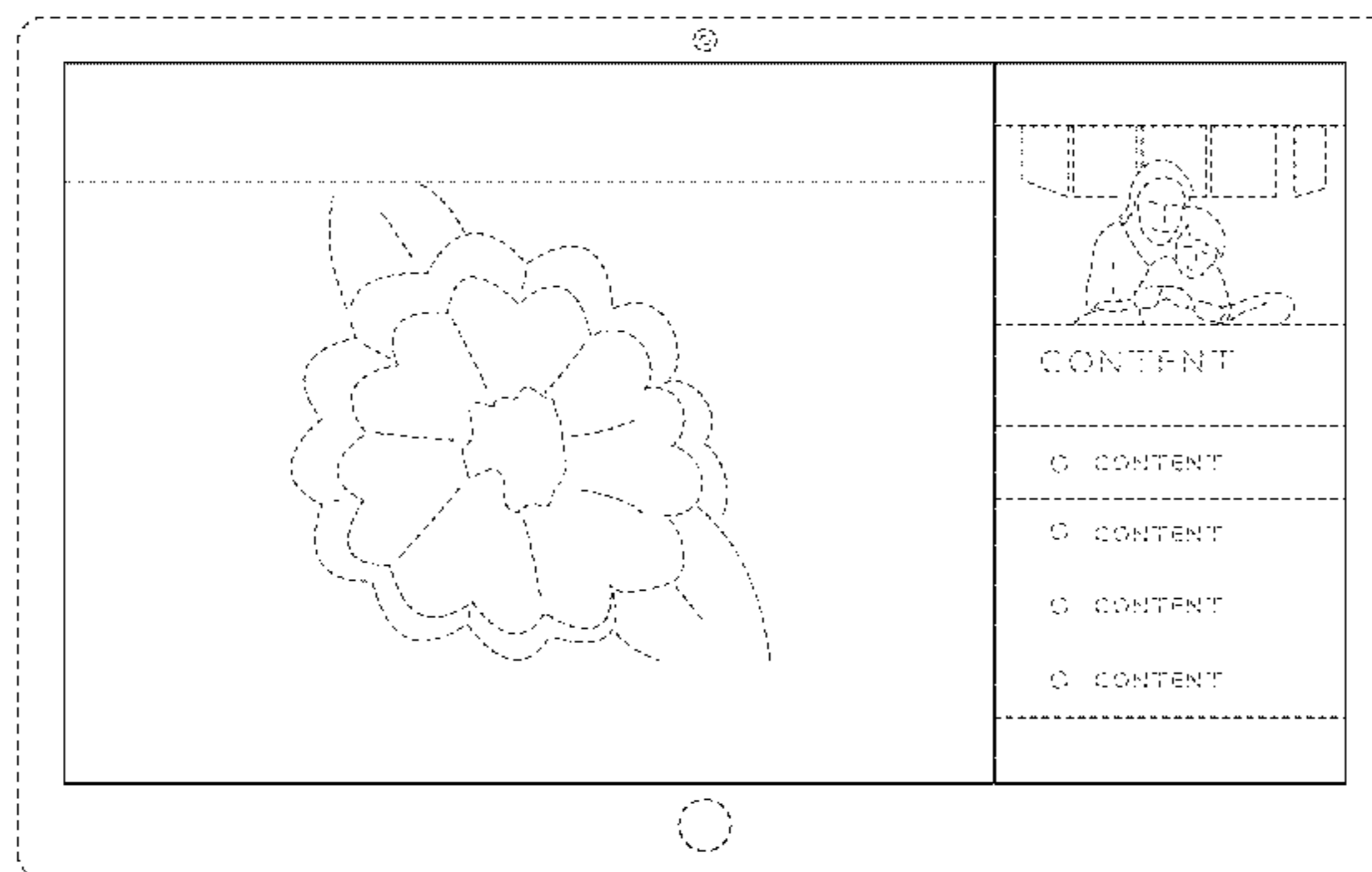

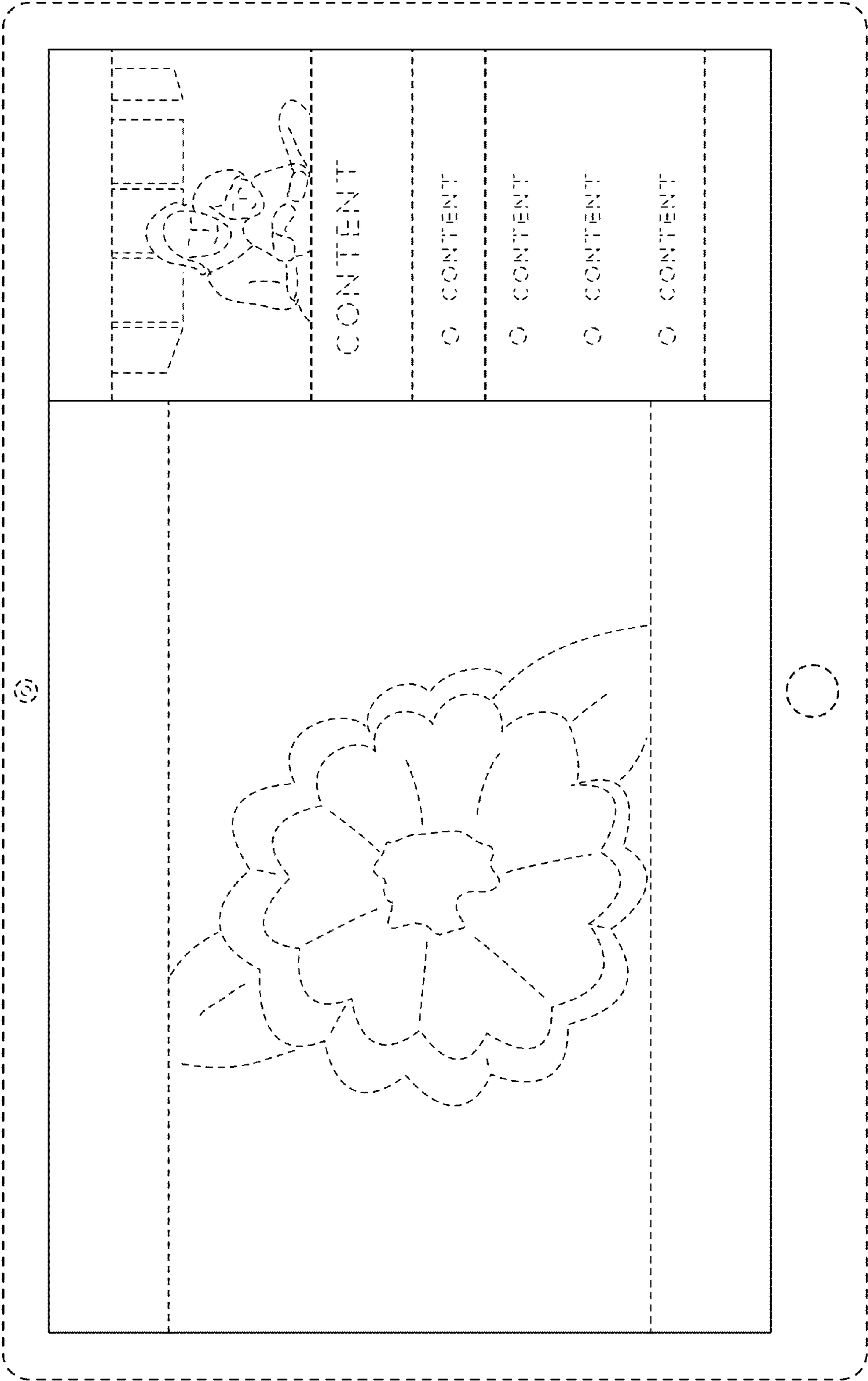

FIG. 1

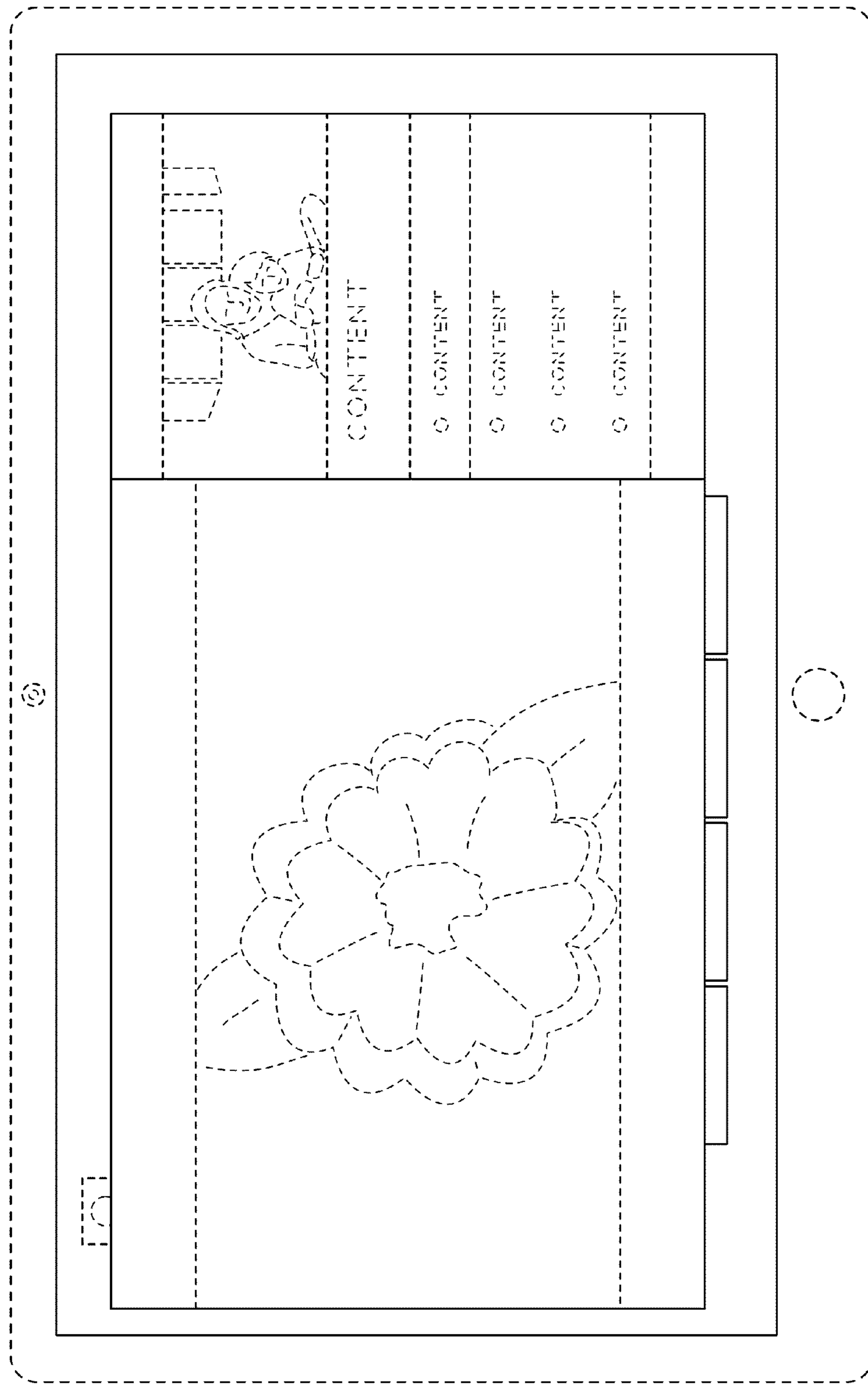

FIG. 2

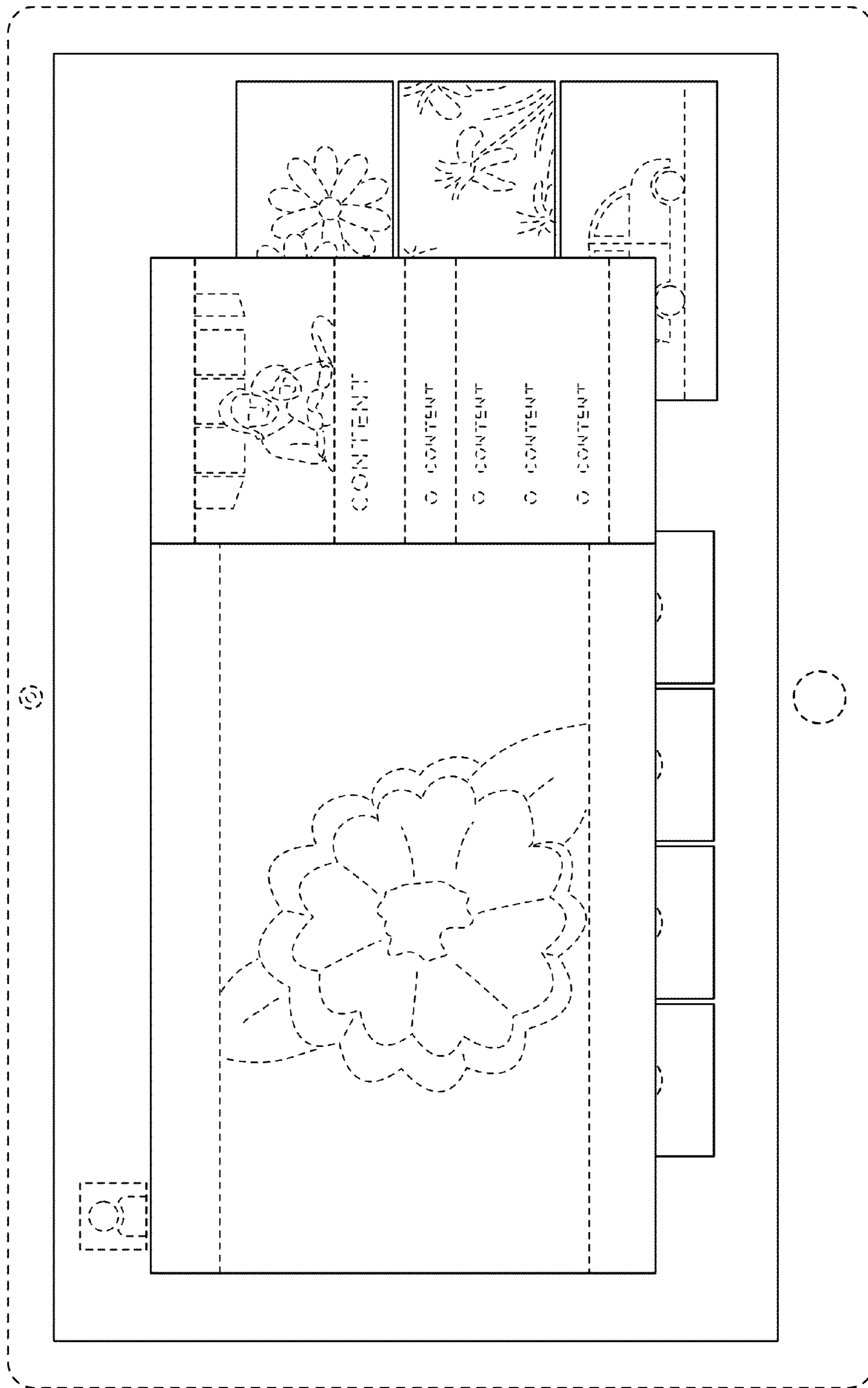

FIG. 3

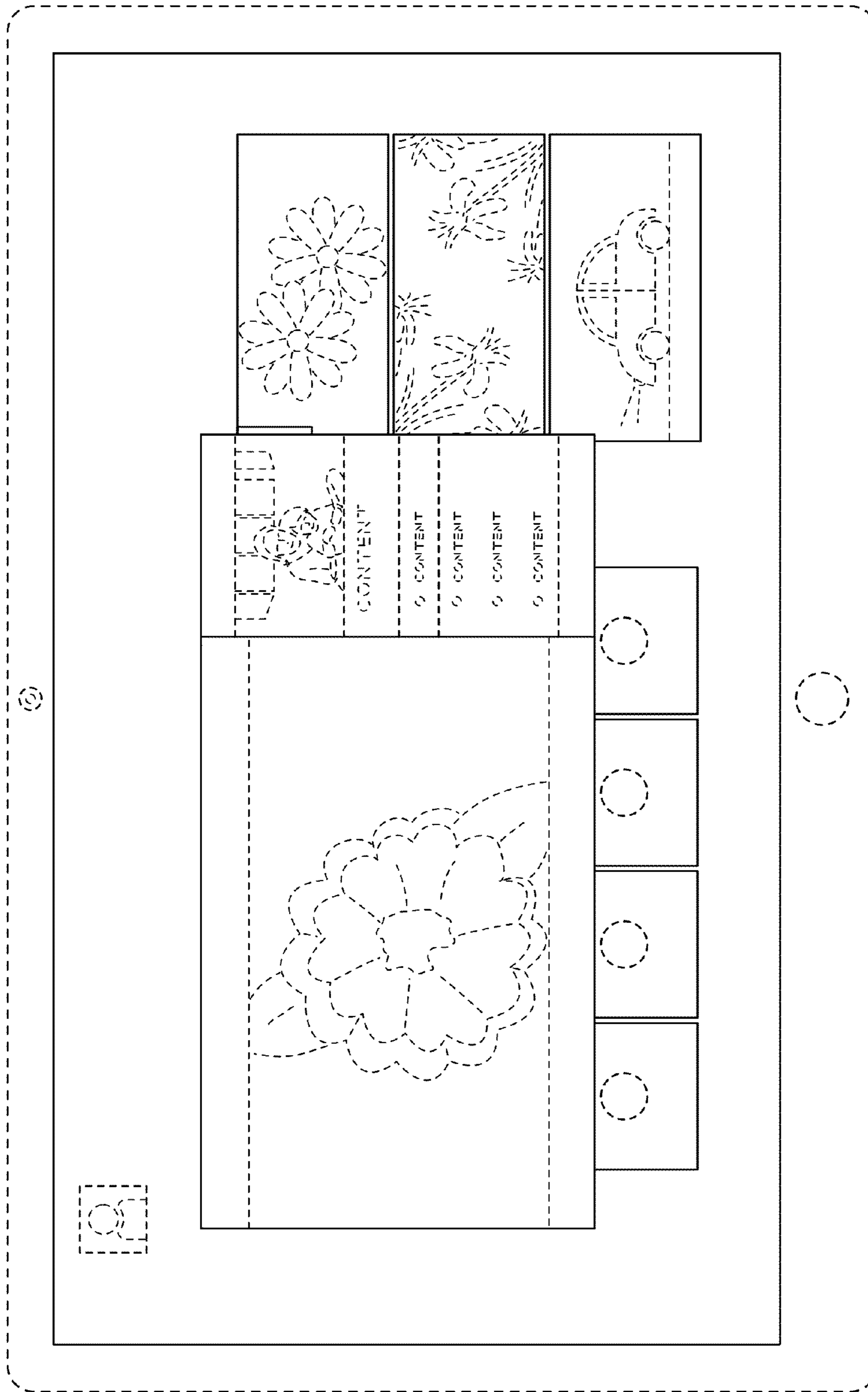

FIG. 4

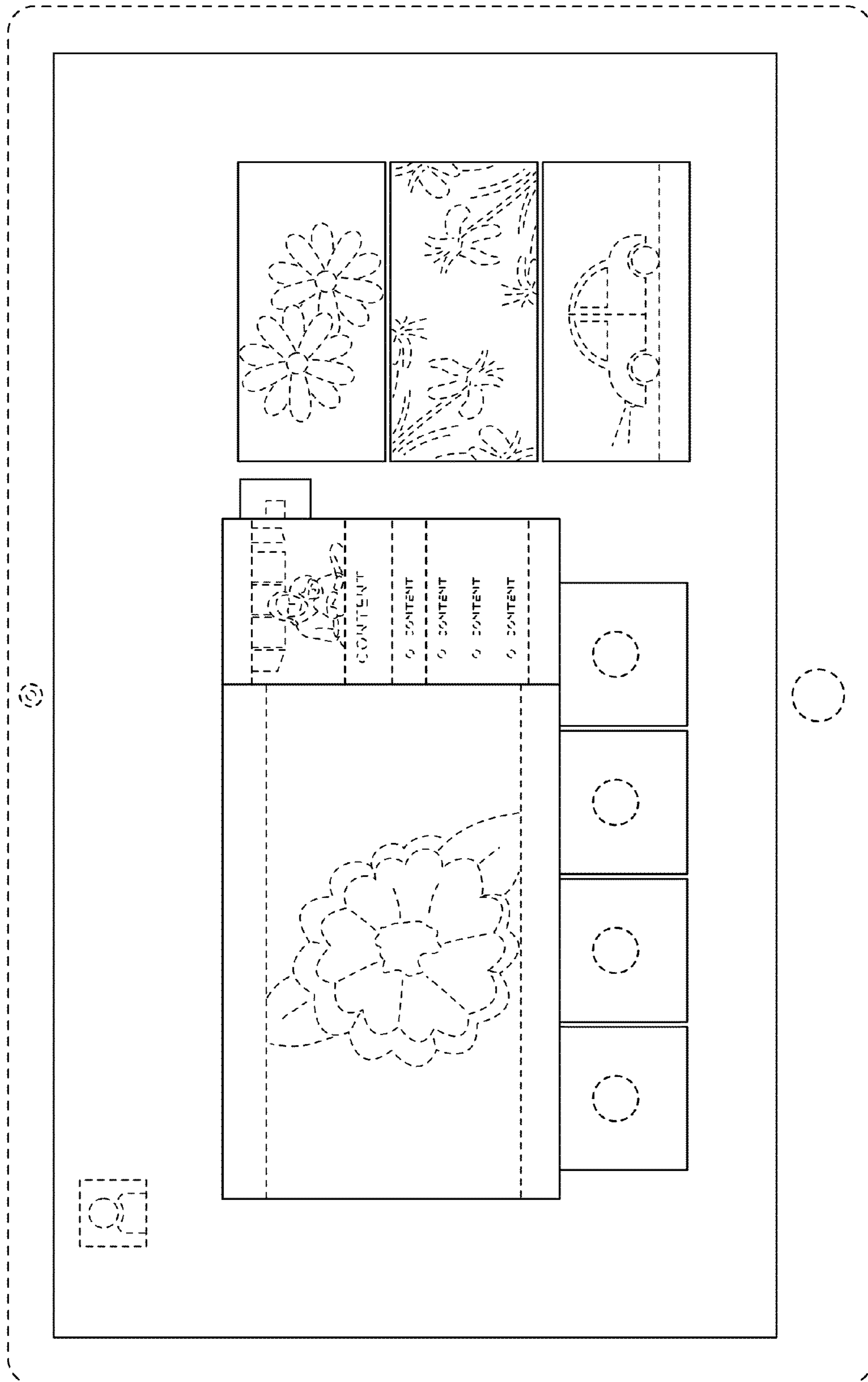

FIG. 5

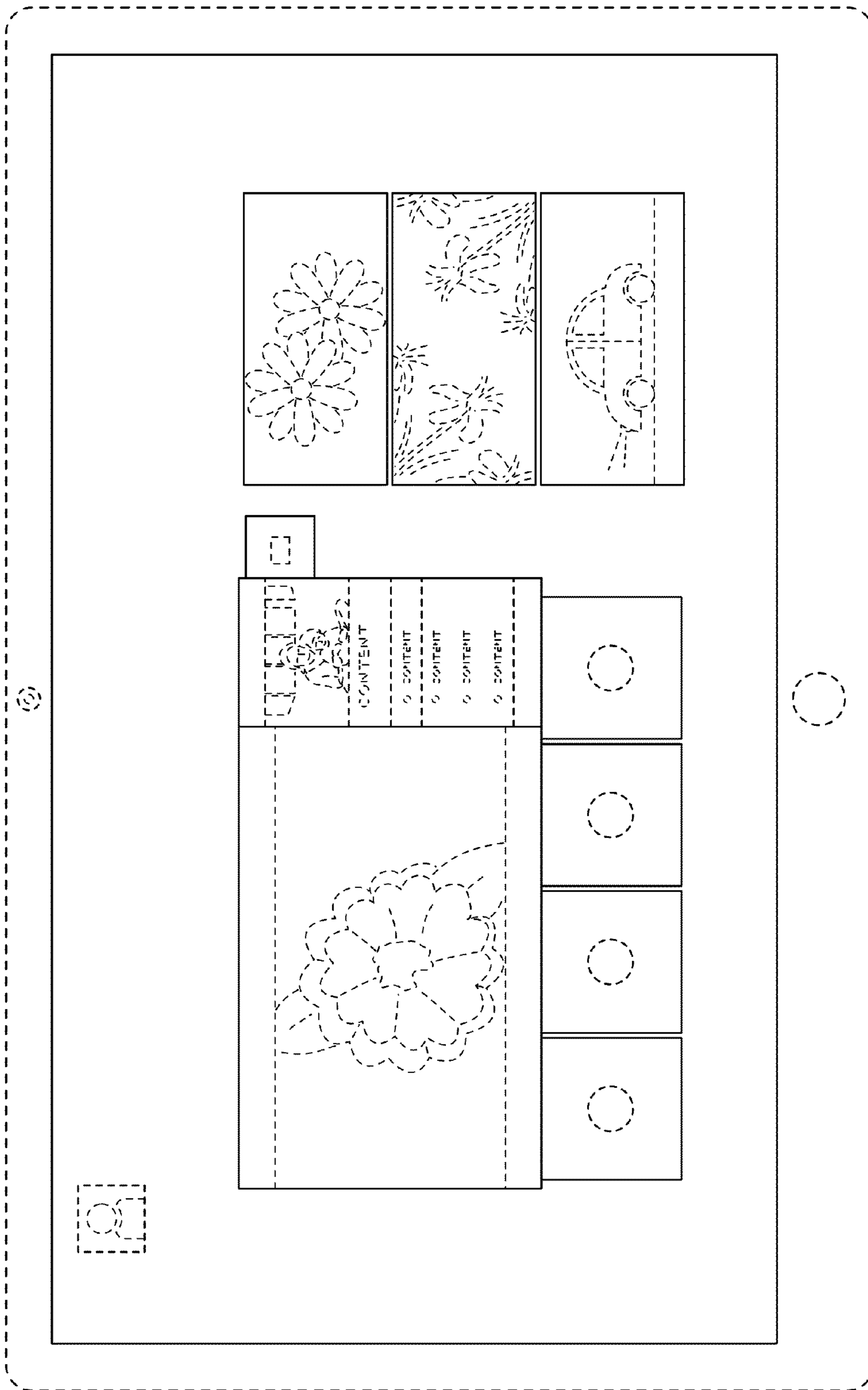

FIG. 6

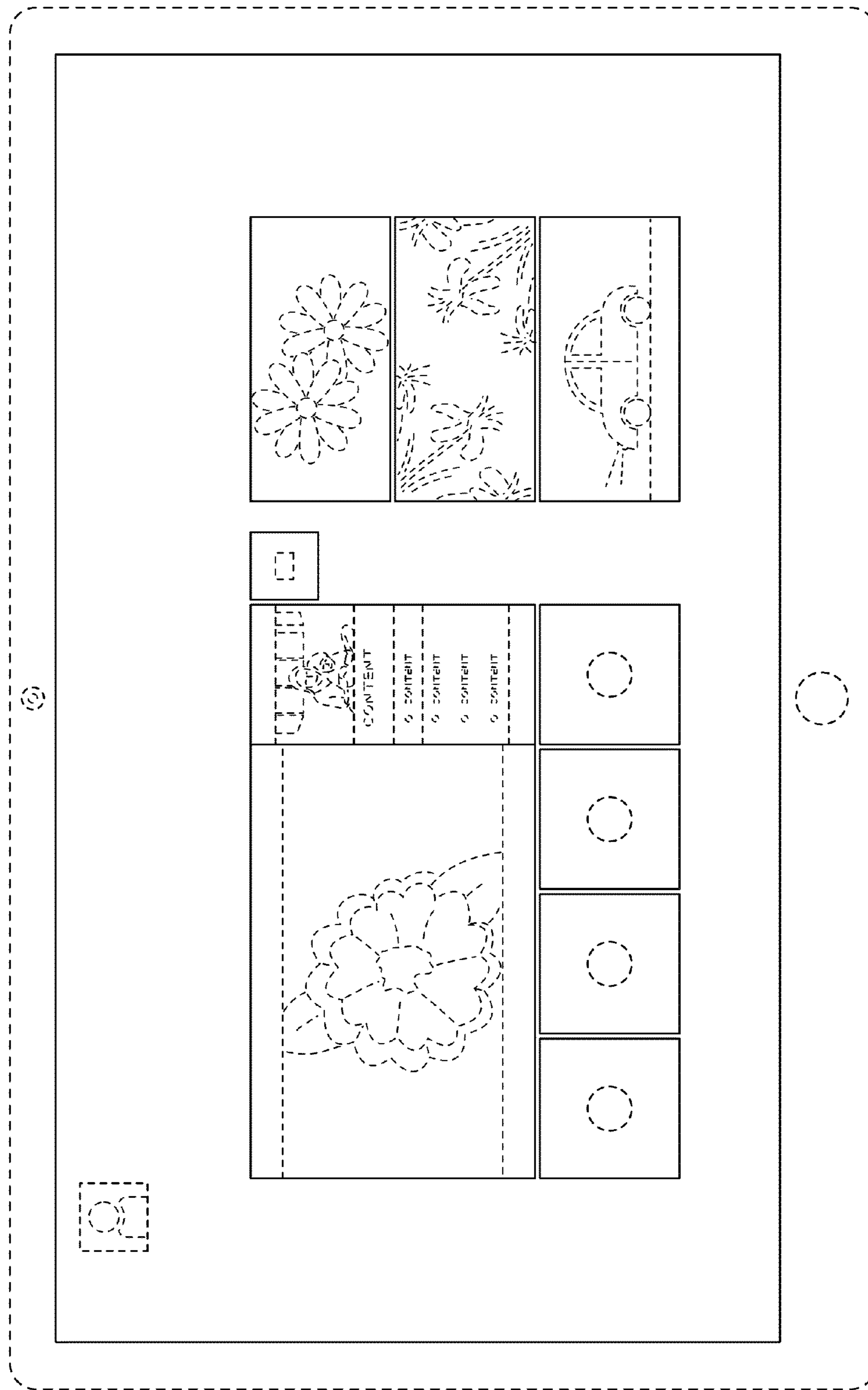

FIG. 7